



PROJECT DETAILS: Weld County, CO NAD 83

Geodetic System: US State Plane 1983  
Datum: North American Datum 1983  
Ellipsoid: GRS 1980  
Zone: Colorado Northern Zone  
System Datum: Mean Sea Level  
Local North: True

Project: Weld County, CO NAD 83  
Site: Fox Creek 28 SWSE Pad  
Well: Fox Creek 12-63-33-0560B  
Wellbore: OH  
Design: Plan 1



Azimuths to True North  
Magnetic North: 8.33°

Magnetic Field  
Strength: 52789.9snT  
Dip Angle: 67.28°  
Date: 9/14/2018  
Model: HDGM



Plan: Plan 1 (Fox Creek 12-63-33-0560B/OH)

Created By: Seth Burstad

### SECTION DETAILS

MD	Inc	Azi	TVD	+N/-S	+E/-W	Dleg	TFace	VSect
0.00	0.00	0.000	0.00	0.00	0.00	0.00	0.00	0.00
500.00	0.00	0.000	500.00	0.00	0.00	0.00	0.00	0.00
750.00	5.00	281.969	749.68	2.26	-10.66	2.00	281.97	-2.33
1703.95	5.00	281.969	1700.00	19.50	-92.00	0.00	0.00	-20.06
2453.74	20.00	281.969	2429.94	53.06	-250.28	2.00	0.00	-54.58
3860.97	20.00	281.969	3752.34	152.85	-721.02	0.00	0.00	-157.22
5194.03	0.00	0.000	5058.50	200.60	-946.28	1.50	180.00	-206.34
7146.57	0.00	0.000	7011.04	200.60	-946.28	0.00	0.00	-206.34
8046.57	90.00	179.652	7584.00	-372.35	-942.80	10.00	179.65	366.61
18405.87	90.00	179.652	7584.00	-10731.46	-879.93	0.00	0.00	10725.91

### WELL DETAILS: Fox Creek 12-63-33-0560B

GL 5470' & KB 20' @ 5490.00ft 5470.00					
+N/-S	+E/-W	Northing	Easting	Latitude	Longitude
0.00	0.00	1599370.66	3294354.58	40° 58' 25.590 N	104° 26' 2.627 W

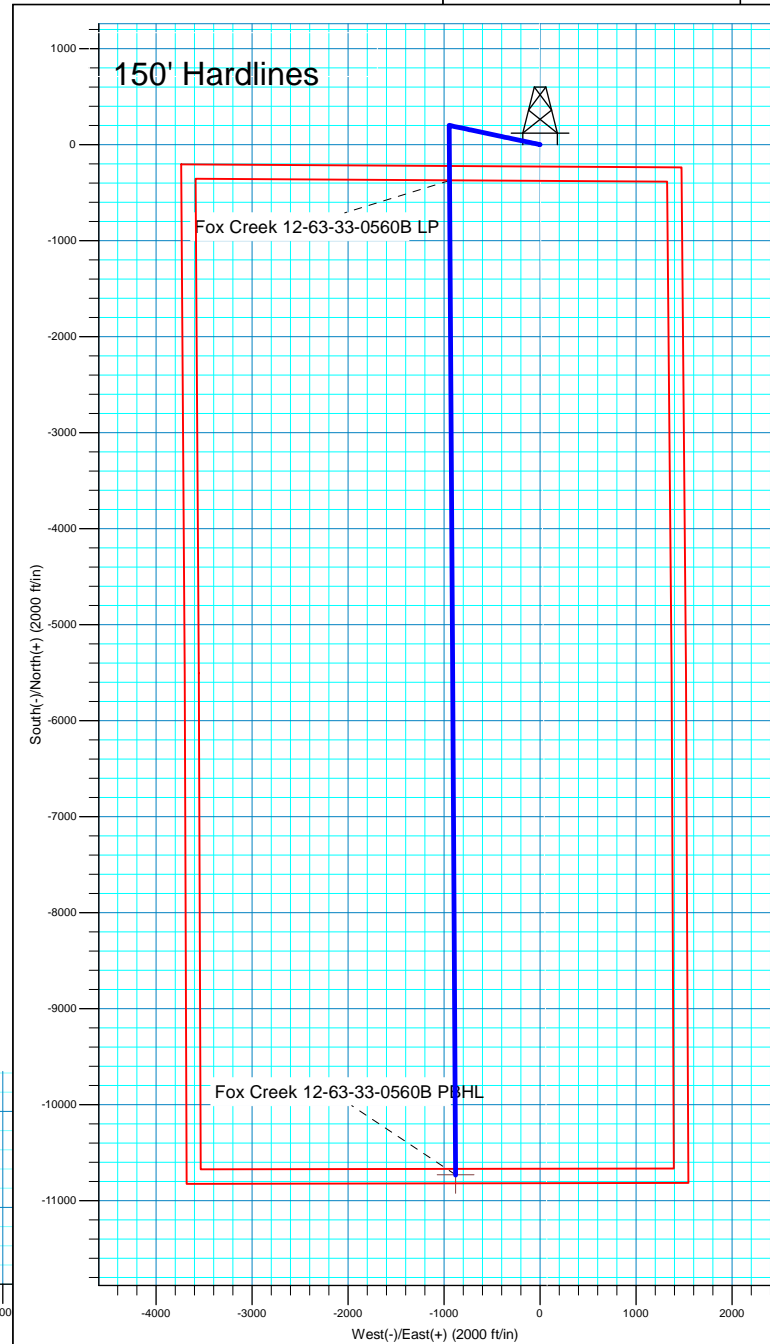
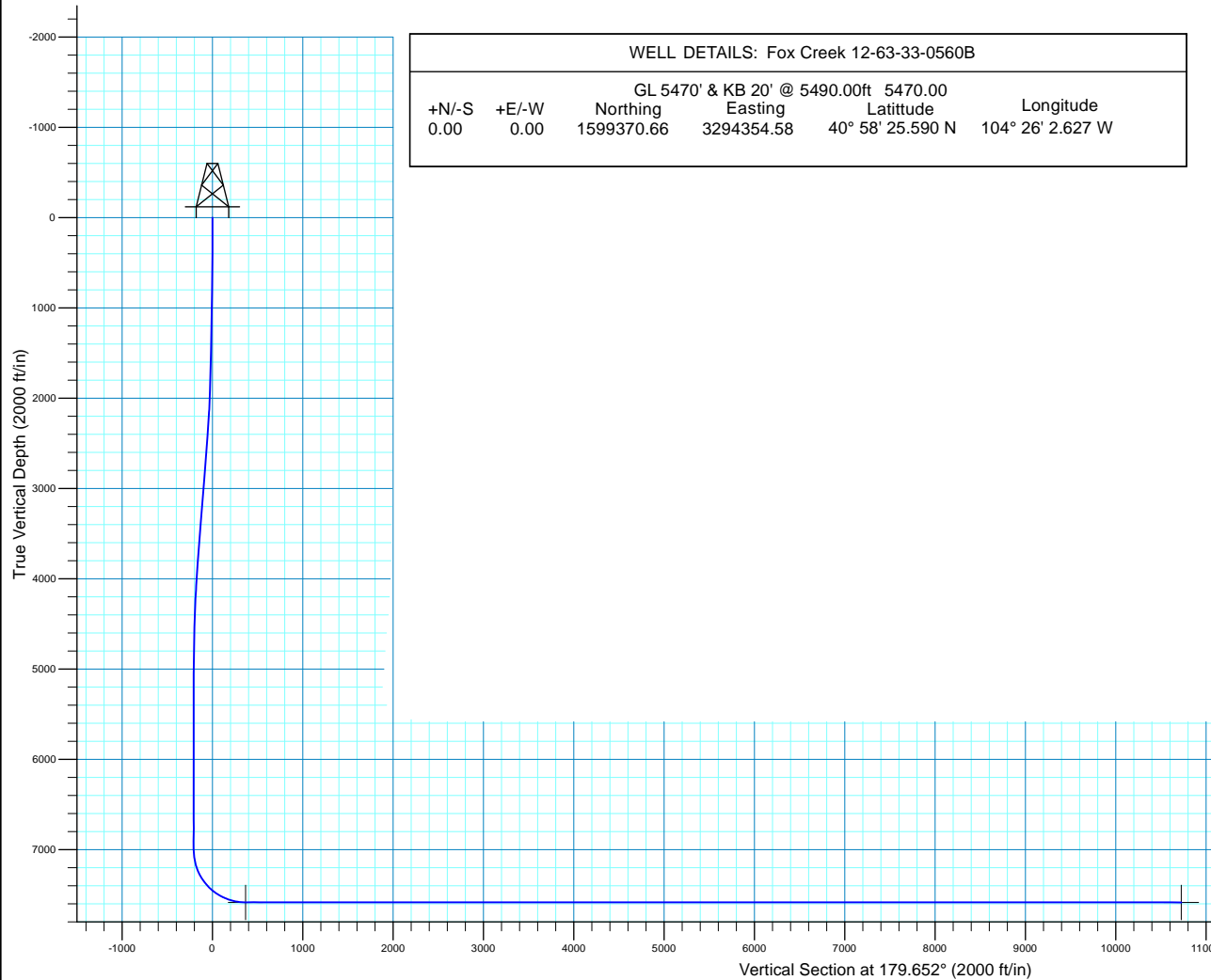



# HighPoint Resources

Weld County, CO NAD 83  
Fox Creek 28 SWSE Pad  
Fox Creek 12-63-33-0560B

OH

Plan: Plan 1

## Standard Planning Report

14 September, 2018



<b>Database:</b>	Casper District	<b>Local Co-ordinate Reference:</b>	Well Fox Creek 12-63-33-0560B
<b>Company:</b>	HighPoint Resources	<b>TVD Reference:</b>	GL 5470' & KB 20' @ 5490.00ft
<b>Project:</b>	Weld County, CO NAD 83	<b>MD Reference:</b>	GL 5470' & KB 20' @ 5490.00ft
<b>Site:</b>	Fox Creek 28 SWSE Pad	<b>North Reference:</b>	True
<b>Well:</b>	Fox Creek 12-63-33-0560B	<b>Survey Calculation Method:</b>	Minimum Curvature
<b>Wellbore:</b>	OH		
<b>Design:</b>	Plan 1		

<b>Project</b>	Weld County, CO NAD 83		
<b>Map System:</b>	US State Plane 1983	<b>System Datum:</b>	Mean Sea Level
<b>Geo Datum:</b>	North American Datum 1983		
<b>Map Zone:</b>	Colorado Northern Zone		

Site	Fox Creek 28 SWSE Pad, Site Center : Fox Creek 12-63-33-0560B				
Site Position:		Northing:	1,599,370.66 usft	Latitude:	40° 58' 25.590 N
From:	Lat/Long	Easting:	3,294,354.58 usft	Longitude:	104° 26' 2.627 W
Position Uncertainty:	0.00 ft	Slot Radius:	13.200 in	Grid Convergence:	0.69 °

Well	Fox Creek 12-63-33-0560B, 228' FSL 1474' FEL Sec 28 T12N R63W					
Well Position	+N/-S	-0.01 ft	Northing:	1,599,370.66 usft	Latitude:	40° 58' 25.590 N
	+E/-W	0.00 ft	Easting:	3,294,354.58 usft	Longitude:	104° 26' 2.627 W
Position Uncertainty		0.00 ft	Wellhead Elevation:	0.00 ft	Ground Level:	5,470.00 ft

<b>Wellbore</b>	OH				
<b>Magnetics</b>	<b>Model Name</b>	<b>Sample Date</b>	<b>Declination (°)</b>	<b>Dip Angle (°)</b>	<b>Field Strength (nT)</b>
	HDGM	9/14/2018	8.33	67.28	52,790

<b>Design</b>	Plan 1			
<b>Audit Notes:</b>				
<b>Version:</b>	<b>Phase:</b>	PLAN	<b>Tie On Depth:</b>	0.00
<b>Vertical Section:</b>	<b>Depth From (TVD) (ft)</b>	<b>+N/-S (ft)</b>	<b>+E/-W (ft)</b>	<b>Direction (°)</b>
	0.00	0.00	0.00	179.652

<b>Plan Sections</b>										
Measured Depth (ft)	Inclination (°)	Azimuth (°)	Vertical Depth (ft)	+N/-S (ft)	+E/-W (ft)	Dogleg Rate (°/100ft)	Build Rate (°/100ft)	Turn Rate (°/100ft)	TFO (°)	Target
0.00	0.00	0.000	0.00	0.00	0.00	0.00	0.00	0.00	0.00	
500.00	0.00	0.000	500.00	0.00	0.00	0.00	0.00	0.00	0.00	
750.00	5.00	281.969	749.68	2.26	-10.66	2.00	2.00	0.00	281.97	
1,703.95	5.00	281.969	1,700.00	19.50	-92.00	0.00	0.00	0.00	0.00	
2,453.74	20.00	281.969	2,429.94	53.06	-250.28	2.00	2.00	0.00	0.00	
3,860.97	20.00	281.969	3,752.34	152.85	-721.02	0.00	0.00	0.00	0.00	
5,194.03	0.00	0.000	5,058.50	200.60	-946.28	1.50	-1.50	0.00	180.00	
7,146.57	0.00	0.000	7,011.04	200.60	-946.28	0.00	0.00	0.00	0.00	
8,046.57	90.00	179.652	7,584.00	-372.35	-942.80	10.00	10.00	19.96	179.65	
18,405.87	90.00	179.652	7,584.00	-10,731.46	-879.93	0.00	0.00	0.00	0.00	Fox Creek 12-63-33-C

<b>Database:</b>	Casper District	<b>Local Co-ordinate Reference:</b>	Well Fox Creek 12-63-33-0560B
<b>Company:</b>	HighPoint Resources	<b>TVD Reference:</b>	GL 5470' & KB 20' @ 5490.00ft
<b>Project:</b>	Weld County, CO NAD 83	<b>MD Reference:</b>	GL 5470' & KB 20' @ 5490.00ft
<b>Site:</b>	Fox Creek 28 SWSE Pad	<b>North Reference:</b>	True
<b>Well:</b>	Fox Creek 12-63-33-0560B	<b>Survey Calculation Method:</b>	Minimum Curvature
<b>Wellbore:</b>	OH		
<b>Design:</b>	Plan 1		

Planned Survey									
Measured Depth (ft)	Inclination (°)	Azimuth (°)	Vertical Depth (ft)	+N/-S (ft)	+E/-W (ft)	Vertical Section (ft)	Dogleg Rate (°/100ft)	Build Rate (°/100ft)	Turn Rate (°/100ft)
0.00	0.00	0.000	0.00	0.00	0.00	0.00	0.00	0.00	0.00
100.00	0.00	0.000	100.00	0.00	0.00	0.00	0.00	0.00	0.00
200.00	0.00	0.000	200.00	0.00	0.00	0.00	0.00	0.00	0.00
300.00	0.00	0.000	300.00	0.00	0.00	0.00	0.00	0.00	0.00
400.00	0.00	0.000	400.00	0.00	0.00	0.00	0.00	0.00	0.00
500.00	0.00	0.000	500.00	0.00	0.00	0.00	0.00	0.00	0.00
Start Build 2.00									
600.00	2.00	281.969	599.98	0.36	-1.71	-0.37	2.00	2.00	0.00
700.00	4.00	281.969	699.84	1.45	-6.83	-1.49	2.00	2.00	0.00
750.00	5.00	281.969	749.68	2.26	-10.66	-2.33	2.00	2.00	0.00
Start 953.95 hold at 750.00 MD									
800.00	5.00	281.969	799.49	3.16	-14.93	-3.26	0.00	0.00	0.00
900.00	5.00	281.969	899.11	4.97	-23.45	-5.11	0.00	0.00	0.00
1,000.00	5.00	281.969	998.73	6.78	-31.98	-6.97	0.00	0.00	0.00
1,100.00	5.00	281.969	1,098.35	8.59	-40.51	-8.83	0.00	0.00	0.00
1,200.00	5.00	281.969	1,197.97	10.39	-49.03	-10.69	0.00	0.00	0.00
1,300.00	5.00	281.969	1,297.59	12.20	-57.56	-12.55	0.00	0.00	0.00
1,400.00	5.00	281.969	1,397.21	14.01	-66.08	-14.41	0.00	0.00	0.00
1,500.00	5.00	281.969	1,496.83	15.82	-74.61	-16.27	0.00	0.00	0.00
1,600.00	5.00	281.969	1,596.45	17.62	-83.14	-18.13	0.00	0.00	0.00
1,700.00	5.00	281.969	1,696.07	19.43	-91.66	-19.99	0.00	0.00	0.00
1,703.95	5.00	281.969	1,700.00	19.50	-92.00	-20.06	0.00	0.00	0.00
Start DLS 2.00 TFO 0.00									
1,800.00	6.92	281.969	1,795.53	21.57	-101.76	-22.19	2.00	2.00	0.00
1,900.00	8.92	281.969	1,894.57	24.43	-115.24	-25.13	2.00	2.00	0.00
2,000.00	10.92	281.969	1,993.07	28.00	-132.09	-28.80	2.00	2.00	0.00
2,100.00	12.92	281.969	2,090.91	32.29	-152.30	-33.21	2.00	2.00	0.00
2,200.00	14.92	281.969	2,187.97	37.27	-175.83	-38.34	2.00	2.00	0.00
2,300.00	16.92	281.969	2,284.12	42.96	-202.66	-44.19	2.00	2.00	0.00
2,400.00	18.92	281.969	2,379.27	49.34	-232.76	-50.76	2.00	2.00	0.00
2,453.74	20.00	281.969	2,429.94	53.06	-250.28	-54.58	2.00	2.00	0.00
Start 1407.23 hold at 2453.74 MD									
2,500.00	20.00	281.969	2,473.41	56.34	-265.75	-57.95	0.00	0.00	0.00
2,600.00	20.00	281.969	2,567.38	63.43	-299.20	-65.24	0.00	0.00	0.00
2,700.00	20.00	281.969	2,661.35	70.52	-332.66	-72.54	0.00	0.00	0.00
2,800.00	20.00	281.969	2,755.32	77.61	-366.11	-79.83	0.00	0.00	0.00
2,900.00	20.00	281.969	2,849.30	84.70	-399.56	-87.13	0.00	0.00	0.00
3,000.00	20.00	281.969	2,943.27	91.79	-433.01	-94.42	0.00	0.00	0.00
3,100.00	20.00	281.969	3,037.24	98.88	-466.46	-101.72	0.00	0.00	0.00
3,200.00	20.00	281.969	3,131.21	105.98	-499.92	-109.01	0.00	0.00	0.00
3,300.00	20.00	281.969	3,225.18	113.07	-533.37	-116.31	0.00	0.00	0.00
3,400.00	20.00	281.969	3,319.15	120.16	-566.82	-123.60	0.00	0.00	0.00
3,500.00	20.00	281.969	3,413.13	127.25	-600.27	-130.89	0.00	0.00	0.00
3,600.00	20.00	281.969	3,507.10	134.34	-633.72	-138.19	0.00	0.00	0.00
3,700.00	20.00	281.969	3,601.07	141.43	-667.17	-145.48	0.00	0.00	0.00
3,800.00	20.00	281.969	3,695.04	148.52	-700.63	-152.78	0.00	0.00	0.00
3,860.97	20.00	281.969	3,752.34	152.85	-721.02	-157.22	0.00	0.00	0.00
Start Drop -1.50									
3,900.00	19.41	281.969	3,789.08	155.58	-733.89	-160.03	1.50	-1.50	0.00
4,000.00	17.91	281.969	3,883.82	162.21	-765.19	-166.86	1.50	-1.50	0.00
4,100.00	16.41	281.969	3,979.37	168.33	-794.06	-173.15	1.50	-1.50	0.00
4,200.00	14.91	281.969	4,075.65	173.93	-820.46	-178.91	1.50	-1.50	0.00
4,300.00	13.41	281.969	4,172.61	179.00	-844.39	-184.13	1.50	-1.50	0.00
4,400.00	11.91	281.969	4,270.18	183.55	-865.83	-188.80	1.50	-1.50	0.00

<b>Database:</b>	Casper District	<b>Local Co-ordinate Reference:</b>	Well Fox Creek 12-63-33-0560B
<b>Company:</b>	HighPoint Resources	<b>TVD Reference:</b>	GL 5470' & KB 20' @ 5490.00ft
<b>Project:</b>	Weld County, CO NAD 83	<b>MD Reference:</b>	GL 5470' & KB 20' @ 5490.00ft
<b>Site:</b>	Fox Creek 28 SWSE Pad	<b>North Reference:</b>	True
<b>Well:</b>	Fox Creek 12-63-33-0560B	<b>Survey Calculation Method:</b>	Minimum Curvature
<b>Wellbore:</b>	OH		
<b>Design:</b>	Plan 1		

Planned Survey									
Measured Depth (ft)	Inclination (°)	Azimuth (°)	Vertical Depth (ft)	+N/-S (ft)	+E/-W (ft)	Vertical Section (ft)	Dogleg Rate (°/100ft)	Build Rate (°/100ft)	Turn Rate (°/100ft)
4,500.00	10.41	281.969	4,368.28	187.56	-884.77	-192.93	1.50	-1.50	0.00
4,600.00	8.91	281.969	4,466.86	191.04	-901.18	-196.51	1.50	-1.50	0.00
4,700.00	7.41	281.969	4,565.85	193.98	-915.07	-199.54	1.50	-1.50	0.00
4,800.00	5.91	281.969	4,665.17	196.39	-926.42	-202.01	1.50	-1.50	0.00
4,900.00	4.41	281.969	4,764.76	198.25	-935.21	-203.93	1.50	-1.50	0.00
5,000.00	2.91	281.969	4,864.55	199.58	-941.46	-205.29	1.50	-1.50	0.00
5,100.00	1.41	281.969	4,964.48	200.36	-945.15	-206.10	1.50	-1.50	0.00
5,194.03	0.00	0.000	5,058.50	200.60	-946.28	-206.34	1.50	-1.50	0.00
Start 1952.54 hold at 5194.03 MD									
5,200.00	0.00	0.000	5,064.47	200.60	-946.28	-206.34	0.00	0.00	0.00
5,300.00	0.00	0.000	5,164.47	200.60	-946.28	-206.34	0.00	0.00	0.00
5,400.00	0.00	0.000	5,264.47	200.60	-946.28	-206.34	0.00	0.00	0.00
5,500.00	0.00	0.000	5,364.47	200.60	-946.28	-206.34	0.00	0.00	0.00
5,600.00	0.00	0.000	5,464.47	200.60	-946.28	-206.34	0.00	0.00	0.00
5,700.00	0.00	0.000	5,564.47	200.60	-946.28	-206.34	0.00	0.00	0.00
5,800.00	0.00	0.000	5,664.47	200.60	-946.28	-206.34	0.00	0.00	0.00
5,900.00	0.00	0.000	5,764.47	200.60	-946.28	-206.34	0.00	0.00	0.00
6,000.00	0.00	0.000	5,864.47	200.60	-946.28	-206.34	0.00	0.00	0.00
6,100.00	0.00	0.000	5,964.47	200.60	-946.28	-206.34	0.00	0.00	0.00
6,200.00	0.00	0.000	6,064.47	200.60	-946.28	-206.34	0.00	0.00	0.00
6,300.00	0.00	0.000	6,164.47	200.60	-946.28	-206.34	0.00	0.00	0.00
6,400.00	0.00	0.000	6,264.47	200.60	-946.28	-206.34	0.00	0.00	0.00
6,500.00	0.00	0.000	6,364.47	200.60	-946.28	-206.34	0.00	0.00	0.00
6,600.00	0.00	0.000	6,464.47	200.60	-946.28	-206.34	0.00	0.00	0.00
6,700.00	0.00	0.000	6,564.47	200.60	-946.28	-206.34	0.00	0.00	0.00
6,800.00	0.00	0.000	6,664.47	200.60	-946.28	-206.34	0.00	0.00	0.00
6,900.00	0.00	0.000	6,764.47	200.60	-946.28	-206.34	0.00	0.00	0.00
7,000.00	0.00	0.000	6,864.47	200.60	-946.28	-206.34	0.00	0.00	0.00
7,100.00	0.00	0.000	6,964.47	200.60	-946.28	-206.34	0.00	0.00	0.00
7,146.57	0.00	0.000	7,011.04	200.60	-946.28	-206.34	0.00	0.00	0.00
Start DLS 10.00 TFO 179.65									
7,200.00	5.34	179.652	7,064.39	198.11	-946.26	-203.85	10.00	10.00	0.00
7,300.00	15.34	179.652	7,162.64	180.18	-946.16	-185.92	10.00	10.00	0.00
7,400.00	25.34	179.652	7,256.29	145.46	-945.95	-151.20	10.00	10.00	0.00
7,500.00	35.34	179.652	7,342.48	95.01	-945.64	-100.75	10.00	10.00	0.00
7,600.00	45.34	179.652	7,418.60	30.36	-945.25	-36.10	10.00	10.00	0.00
7,700.00	55.34	179.652	7,482.34	-46.53	-944.78	40.79	10.00	10.00	0.00
7,800.00	65.34	179.652	7,531.76	-133.32	-944.25	127.58	10.00	10.00	0.00
7,900.00	75.34	179.652	7,565.35	-227.37	-943.68	221.64	10.00	10.00	0.00
8,000.00	85.34	179.652	7,582.11	-325.83	-943.09	320.10	10.00	10.00	0.00
8,046.57	90.00	179.652	7,584.00	-372.35	-942.80	366.61	10.00	10.00	0.00
Start 10359.30 hold at 8046.57 MD									
8,100.00	90.00	179.652	7,584.00	-425.78	-942.48	420.04	0.00	0.00	0.00
8,200.00	90.00	179.652	7,584.00	-525.77	-941.87	520.04	0.00	0.00	0.00
8,300.00	90.00	179.652	7,584.00	-625.77	-941.26	620.04	0.00	0.00	0.00
8,400.00	90.00	179.652	7,584.00	-725.77	-940.66	720.04	0.00	0.00	0.00
8,500.00	90.00	179.652	7,584.00	-825.77	-940.05	820.04	0.00	0.00	0.00
8,600.00	90.00	179.652	7,584.00	-925.77	-939.44	920.04	0.00	0.00	0.00
8,700.00	90.00	179.652	7,584.00	-1,025.77	-938.84	1,020.04	0.00	0.00	0.00
8,800.00	90.00	179.652	7,584.00	-1,125.76	-938.23	1,120.04	0.00	0.00	0.00
8,900.00	90.00	179.652	7,584.00	-1,225.76	-937.62	1,220.04	0.00	0.00	0.00
9,000.00	90.00	179.652	7,584.00	-1,325.76	-937.02	1,320.04	0.00	0.00	0.00
9,100.00	90.00	179.652	7,584.00	-1,425.76	-936.41	1,420.04	0.00	0.00	0.00

<b>Database:</b>	Casper District	<b>Local Co-ordinate Reference:</b>	Well Fox Creek 12-63-33-0560B
<b>Company:</b>	HighPoint Resources	<b>TVD Reference:</b>	GL 5470' & KB 20' @ 5490.00ft
<b>Project:</b>	Weld County, CO NAD 83	<b>MD Reference:</b>	GL 5470' & KB 20' @ 5490.00ft
<b>Site:</b>	Fox Creek 28 SWSE Pad	<b>North Reference:</b>	True
<b>Well:</b>	Fox Creek 12-63-33-0560B	<b>Survey Calculation Method:</b>	Minimum Curvature
<b>Wellbore:</b>	OH		
<b>Design:</b>	Plan 1		

Planned Survey									
Measured Depth (ft)	Inclination (°)	Azimuth (°)	Vertical Depth (ft)	+N/-S (ft)	+E/-W (ft)	Vertical Section (ft)	Dogleg Rate (°/100ft)	Build Rate (°/100ft)	Turn Rate (°/100ft)
9,200.00	90.00	179.652	7,584.00	-1,525.76	-935.80	1,520.04	0.00	0.00	0.00
9,300.00	90.00	179.652	7,584.00	-1,625.75	-935.20	1,620.04	0.00	0.00	0.00
9,400.00	90.00	179.652	7,584.00	-1,725.75	-934.59	1,720.04	0.00	0.00	0.00
9,500.00	90.00	179.652	7,584.00	-1,825.75	-933.98	1,820.04	0.00	0.00	0.00
9,600.00	90.00	179.652	7,584.00	-1,925.75	-933.38	1,920.04	0.00	0.00	0.00
9,700.00	90.00	179.652	7,584.00	-2,025.75	-932.77	2,020.04	0.00	0.00	0.00
9,800.00	90.00	179.652	7,584.00	-2,125.74	-932.16	2,120.04	0.00	0.00	0.00
9,900.00	90.00	179.652	7,584.00	-2,225.74	-931.55	2,220.04	0.00	0.00	0.00
10,000.00	90.00	179.652	7,584.00	-2,325.74	-930.95	2,320.04	0.00	0.00	0.00
10,100.00	90.00	179.652	7,584.00	-2,425.74	-930.34	2,420.04	0.00	0.00	0.00
10,200.00	90.00	179.652	7,584.00	-2,525.74	-929.73	2,520.04	0.00	0.00	0.00
10,300.00	90.00	179.652	7,584.00	-2,625.74	-929.13	2,620.04	0.00	0.00	0.00
10,400.00	90.00	179.652	7,584.00	-2,725.73	-928.52	2,720.04	0.00	0.00	0.00
10,500.00	90.00	179.652	7,584.00	-2,825.73	-927.91	2,820.04	0.00	0.00	0.00
10,600.00	90.00	179.652	7,584.00	-2,925.73	-927.31	2,920.04	0.00	0.00	0.00
10,700.00	90.00	179.652	7,584.00	-3,025.73	-926.70	3,020.04	0.00	0.00	0.00
10,800.00	90.00	179.652	7,584.00	-3,125.73	-926.09	3,120.04	0.00	0.00	0.00
10,900.00	90.00	179.652	7,584.00	-3,225.72	-925.49	3,220.04	0.00	0.00	0.00
11,000.00	90.00	179.652	7,584.00	-3,325.72	-924.88	3,320.04	0.00	0.00	0.00
11,100.00	90.00	179.652	7,584.00	-3,425.72	-924.27	3,420.04	0.00	0.00	0.00
11,200.00	90.00	179.652	7,584.00	-3,525.72	-923.67	3,520.04	0.00	0.00	0.00
11,300.00	90.00	179.652	7,584.00	-3,625.72	-923.06	3,620.04	0.00	0.00	0.00
11,400.00	90.00	179.652	7,584.00	-3,725.72	-922.45	3,720.04	0.00	0.00	0.00
11,500.00	90.00	179.652	7,584.00	-3,825.71	-921.84	3,820.04	0.00	0.00	0.00
11,600.00	90.00	179.652	7,584.00	-3,925.71	-921.24	3,920.04	0.00	0.00	0.00
11,700.00	90.00	179.652	7,584.00	-4,025.71	-920.63	4,020.04	0.00	0.00	0.00
11,800.00	90.00	179.652	7,584.00	-4,125.71	-920.02	4,120.04	0.00	0.00	0.00
11,900.00	90.00	179.652	7,584.00	-4,225.71	-919.42	4,220.04	0.00	0.00	0.00
12,000.00	90.00	179.652	7,584.00	-4,325.70	-918.81	4,320.04	0.00	0.00	0.00
12,100.00	90.00	179.652	7,584.00	-4,425.70	-918.20	4,420.04	0.00	0.00	0.00
12,200.00	90.00	179.652	7,584.00	-4,525.70	-917.60	4,520.04	0.00	0.00	0.00
12,300.00	90.00	179.652	7,584.00	-4,625.70	-916.99	4,620.04	0.00	0.00	0.00
12,400.00	90.00	179.652	7,584.00	-4,725.70	-916.38	4,720.04	0.00	0.00	0.00
12,500.00	90.00	179.652	7,584.00	-4,825.70	-915.78	4,820.04	0.00	0.00	0.00
12,600.00	90.00	179.652	7,584.00	-4,925.69	-915.17	4,920.04	0.00	0.00	0.00
12,700.00	90.00	179.652	7,584.00	-5,025.69	-914.56	5,020.04	0.00	0.00	0.00
12,800.00	90.00	179.652	7,584.00	-5,125.69	-913.96	5,120.04	0.00	0.00	0.00
12,900.00	90.00	179.652	7,584.00	-5,225.69	-913.35	5,220.04	0.00	0.00	0.00
13,000.00	90.00	179.652	7,584.00	-5,325.69	-912.74	5,320.04	0.00	0.00	0.00
13,100.00	90.00	179.652	7,584.00	-5,425.68	-912.13	5,420.04	0.00	0.00	0.00
13,200.00	90.00	179.652	7,584.00	-5,525.68	-911.53	5,520.04	0.00	0.00	0.00
13,300.00	90.00	179.652	7,584.00	-5,625.68	-910.92	5,620.04	0.00	0.00	0.00
13,400.00	90.00	179.652	7,584.00	-5,725.68	-910.31	5,720.04	0.00	0.00	0.00
13,500.00	90.00	179.652	7,584.00	-5,825.68	-909.71	5,820.04	0.00	0.00	0.00
13,600.00	90.00	179.652	7,584.00	-5,925.68	-909.10	5,920.04	0.00	0.00	0.00
13,700.00	90.00	179.652	7,584.00	-6,025.67	-908.49	6,020.04	0.00	0.00	0.00
13,800.00	90.00	179.652	7,584.00	-6,125.67	-907.89	6,120.04	0.00	0.00	0.00
13,900.00	90.00	179.652	7,584.00	-6,225.67	-907.28	6,220.04	0.00	0.00	0.00
14,000.00	90.00	179.652	7,584.00	-6,325.67	-906.67	6,320.04	0.00	0.00	0.00
14,100.00	90.00	179.652	7,584.00	-6,425.67	-906.07	6,420.04	0.00	0.00	0.00
14,200.00	90.00	179.652	7,584.00	-6,525.66	-905.46	6,520.04	0.00	0.00	0.00
14,300.00	90.00	179.652	7,584.00	-6,625.66	-904.85	6,620.04	0.00	0.00	0.00
14,400.00	90.00	179.652	7,584.00	-6,725.66	-904.25	6,720.04	0.00	0.00	0.00
14,500.00	90.00	179.652	7,584.00	-6,825.66	-903.64	6,820.04	0.00	0.00	0.00

<b>Database:</b>	Casper District	<b>Local Co-ordinate Reference:</b>	Well Fox Creek 12-63-33-0560B
<b>Company:</b>	HighPoint Resources	<b>TVD Reference:</b>	GL 5470' & KB 20' @ 5490.00ft
<b>Project:</b>	Weld County, CO NAD 83	<b>MD Reference:</b>	GL 5470' & KB 20' @ 5490.00ft
<b>Site:</b>	Fox Creek 28 SWSE Pad	<b>North Reference:</b>	True
<b>Well:</b>	Fox Creek 12-63-33-0560B	<b>Survey Calculation Method:</b>	Minimum Curvature
<b>Wellbore:</b>	OH		
<b>Design:</b>	Plan 1		

Planned Survey									
Measured Depth (ft)	Inclination (°)	Azimuth (°)	Vertical Depth (ft)	+N/-S (ft)	+E/-W (ft)	Vertical Section (ft)	Dogleg Rate (°/100ft)	Build Rate (°/100ft)	Turn Rate (°/100ft)
14,600.00	90.00	179.652	7,584.00	-6,925.66	-903.03	6,920.04	0.00	0.00	0.00
14,700.00	90.00	179.652	7,584.00	-7,025.65	-902.42	7,020.04	0.00	0.00	0.00
14,800.00	90.00	179.652	7,584.00	-7,125.65	-901.82	7,120.04	0.00	0.00	0.00
14,900.00	90.00	179.652	7,584.00	-7,225.65	-901.21	7,220.04	0.00	0.00	0.00
15,000.00	90.00	179.652	7,584.00	-7,325.65	-900.60	7,320.04	0.00	0.00	0.00
15,100.00	90.00	179.652	7,584.00	-7,425.65	-900.00	7,420.04	0.00	0.00	0.00
15,200.00	90.00	179.652	7,584.00	-7,525.65	-899.39	7,520.04	0.00	0.00	0.00
15,300.00	90.00	179.652	7,584.00	-7,625.64	-898.78	7,620.04	0.00	0.00	0.00
15,400.00	90.00	179.652	7,584.00	-7,725.64	-898.18	7,720.04	0.00	0.00	0.00
15,500.00	90.00	179.652	7,584.00	-7,825.64	-897.57	7,820.04	0.00	0.00	0.00
15,600.00	90.00	179.652	7,584.00	-7,925.64	-896.96	7,920.04	0.00	0.00	0.00
15,700.00	90.00	179.652	7,584.00	-8,025.64	-896.36	8,020.04	0.00	0.00	0.00
15,800.00	90.00	179.652	7,584.00	-8,125.63	-895.75	8,120.04	0.00	0.00	0.00
15,900.00	90.00	179.652	7,584.00	-8,225.63	-895.14	8,220.04	0.00	0.00	0.00
16,000.00	90.00	179.652	7,584.00	-8,325.63	-894.54	8,320.04	0.00	0.00	0.00
16,100.00	90.00	179.652	7,584.00	-8,425.63	-893.93	8,420.04	0.00	0.00	0.00
16,200.00	90.00	179.652	7,584.00	-8,525.63	-893.32	8,520.04	0.00	0.00	0.00
16,300.00	90.00	179.652	7,584.00	-8,625.63	-892.71	8,620.04	0.00	0.00	0.00
16,400.00	90.00	179.652	7,584.00	-8,725.62	-892.11	8,720.04	0.00	0.00	0.00
16,500.00	90.00	179.652	7,584.00	-8,825.62	-891.50	8,820.04	0.00	0.00	0.00
16,600.00	90.00	179.652	7,584.00	-8,925.62	-890.89	8,920.04	0.00	0.00	0.00
16,700.00	90.00	179.652	7,584.00	-9,025.62	-890.29	9,020.04	0.00	0.00	0.00
16,800.00	90.00	179.652	7,584.00	-9,125.62	-889.68	9,120.04	0.00	0.00	0.00
16,900.00	90.00	179.652	7,584.00	-9,225.61	-889.07	9,220.04	0.00	0.00	0.00
17,000.00	90.00	179.652	7,584.00	-9,325.61	-888.47	9,320.04	0.00	0.00	0.00
17,100.00	90.00	179.652	7,584.00	-9,425.61	-887.86	9,420.04	0.00	0.00	0.00
17,200.00	90.00	179.652	7,584.00	-9,525.61	-887.25	9,520.04	0.00	0.00	0.00
17,300.00	90.00	179.652	7,584.00	-9,625.61	-886.65	9,620.04	0.00	0.00	0.00
17,400.00	90.00	179.652	7,584.00	-9,725.61	-886.04	9,720.04	0.00	0.00	0.00
17,500.00	90.00	179.652	7,584.00	-9,825.60	-885.43	9,820.04	0.00	0.00	0.00
17,600.00	90.00	179.652	7,584.00	-9,925.60	-884.83	9,920.04	0.00	0.00	0.00
17,700.00	90.00	179.652	7,584.00	-10,025.60	-884.22	10,020.04	0.00	0.00	0.00
17,800.00	90.00	179.652	7,584.00	-10,125.60	-883.61	10,120.04	0.00	0.00	0.00
17,900.00	90.00	179.652	7,584.00	-10,225.60	-883.00	10,220.04	0.00	0.00	0.00
18,000.00	90.00	179.652	7,584.00	-10,325.59	-882.40	10,320.04	0.00	0.00	0.00
18,100.00	90.00	179.652	7,584.00	-10,425.59	-881.79	10,420.04	0.00	0.00	0.00
18,200.00	90.00	179.652	7,584.00	-10,525.59	-881.18	10,520.04	0.00	0.00	0.00
18,300.00	90.00	179.652	7,584.00	-10,625.59	-880.58	10,620.04	0.00	0.00	0.00
18,400.00	90.00	179.652	7,584.00	-10,725.59	-879.97	10,720.04	0.00	0.00	0.00
18,405.87	90.00	179.652	7,584.00	-10,731.46	-879.93	10,725.92	0.00	0.00	0.00
TD at 18405.87									

<b>Database:</b>	Casper District	<b>Local Co-ordinate Reference:</b>	Well Fox Creek 12-63-33-0560B
<b>Company:</b>	HighPoint Resources	<b>TVD Reference:</b>	GL 5470' & KB 20' @ 5490.00ft
<b>Project:</b>	Weld County, CO NAD 83	<b>MD Reference:</b>	GL 5470' & KB 20' @ 5490.00ft
<b>Site:</b>	Fox Creek 28 SWSE Pad	<b>North Reference:</b>	True
<b>Well:</b>	Fox Creek 12-63-33-0560B	<b>Survey Calculation Method:</b>	Minimum Curvature
<b>Wellbore:</b>	OH		
<b>Design:</b>	Plan 1		

Design Targets									
Target Name	Dip Angle	Dip Dir.	TVD	+N/-S	+E/-W	Northing	Easting	Latitude	Longitude
- hit/miss target	(°)	(°)	(ft)	(ft)	(ft)	(usft)	(usft)		
- Shape									
Fox Creek 12-63-33-056	0.00	0.000	7,584.00	-372.35	-942.80	1,598,987.00	3,293,416.32	40° 58' 21.911 N	104° 26' 14.917 W
- plan hits target center									
- Point									
Fox Creek 12-63-33-056	0.00	0.000	7,584.00	-10,731.46	-879.93	1,588,629.42	3,293,603.71	40° 56' 39.559 N	104° 26' 14.093 W
- plan hits target center									
- Point									

Plan Annotations				
Measured Depth	Vertical Depth	Local Coordinates		Comment
(ft)	(ft)	+N/-S (ft)	+E/-W (ft)	
500.00	500.00	0.00	0.00	Start Build 2.00
750.00	749.68	2.26	-10.66	Start 953.95 hold at 750.00 MD
1,703.95	1,700.00	19.50	-92.00	Start DLS 2.00 TFO 0.00
2,453.74	2,429.94	53.06	-250.28	Start 1407.23 hold at 2453.74 MD
3,860.97	3,752.34	152.85	-721.02	Start Drop -1.50
5,194.03	5,058.50	200.60	-946.28	Start 1952.54 hold at 5194.03 MD
7,146.57	7,011.04	200.60	-946.28	Start DLS 10.00 TFO 179.65
8,046.57	7,584.00	-372.35	-942.80	Start 10359.30 hold at 8046.57 MD
18,405.87	7,584.00	-10,731.46	-879.93	TD at 18405.87