



PROJECT DETAILS: Weld County, CO NAD 83

Geodetic System: US State Plane 1983  
Datum: North American Datum 1983  
Ellipsoid: GRS 1980  
Zone: Colorado Northern Zone  
System Datum: Mean Sea Level  
Local North: True

Project: Weld County, CO NAD 83  
Site: Fox Creek 33 NWNW Pad  
Well: Fox Creek 33-0362D  
Wellbore: OH  
Design: Plan 1



Azimuths to True North  
Magnetic North: 8.35°

Magnetic Field  
Strength: 52782.9snT  
Dip Angle: 67.28°  
Date: 9/14/2018  
Model: HDGM



Plan: Plan 1 (Fox Creek 33-0362D/OH)

Created By: Seth Burstad

### SECTION DETAILS

MD	Inc	Azi	TVD	+N/-S	+E/-W	Dleg	TFace	VSect
0.00	0.00	0.000	0.00	0.00	0.00	0.00	0.00	0.00
500.00	0.00	0.000	500.00	0.00	0.00	0.00	0.00	0.00
750.00	5.00	42.747	749.68	8.01	7.40	2.00	42.75	-7.96
1703.95	5.00	42.747	1700.00	69.06	63.83	0.00	0.00	-68.69
2454.16	20.00	42.747	2430.33	187.98	173.75	2.00	0.00	-186.96
3730.65	20.00	42.747	3629.81	508.66	470.15	0.00	0.00	-505.90
5064.27	0.00	0.000	4936.50	677.90	626.57	1.50	180.00	-674.22
7315.81	0.00	0.000	7188.04	677.90	626.57	0.00	0.00	-674.22
8215.81	90.00	179.665	7761.00	104.95	629.92	10.00	179.67	-101.27
18282.86	90.00	179.665	7761.00	-9961.92	688.75	0.00	0.00	9965.78

### WELL DETAILS: Fox Creek 33-0362D

GL 5473' & KB 20' @ 5493.00ft 5473.00				Longitude	
+N/-S	+E/-W	Northing	Easting	Latitude	
0.00	0.00	1598718.78	3291798.64	40° 58' 19.452 N	104° 26' 36.046 W

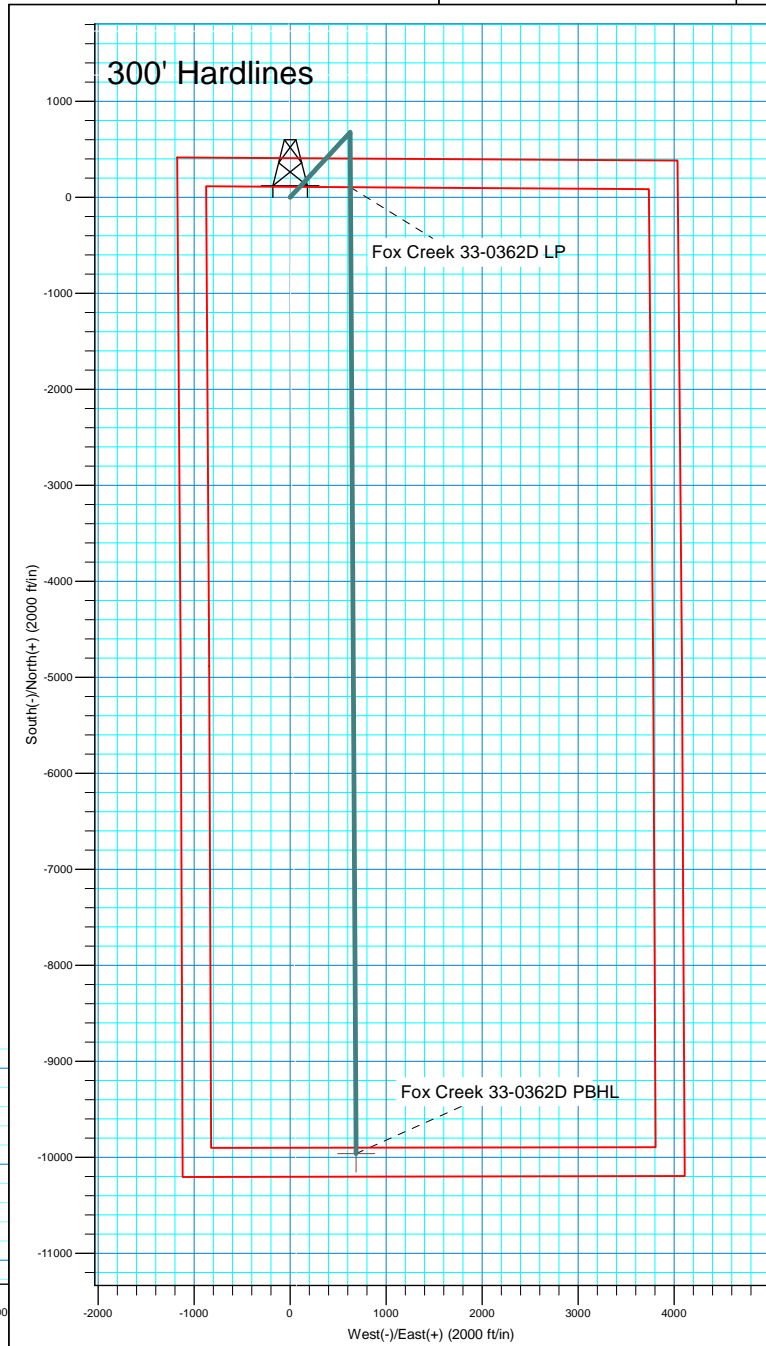
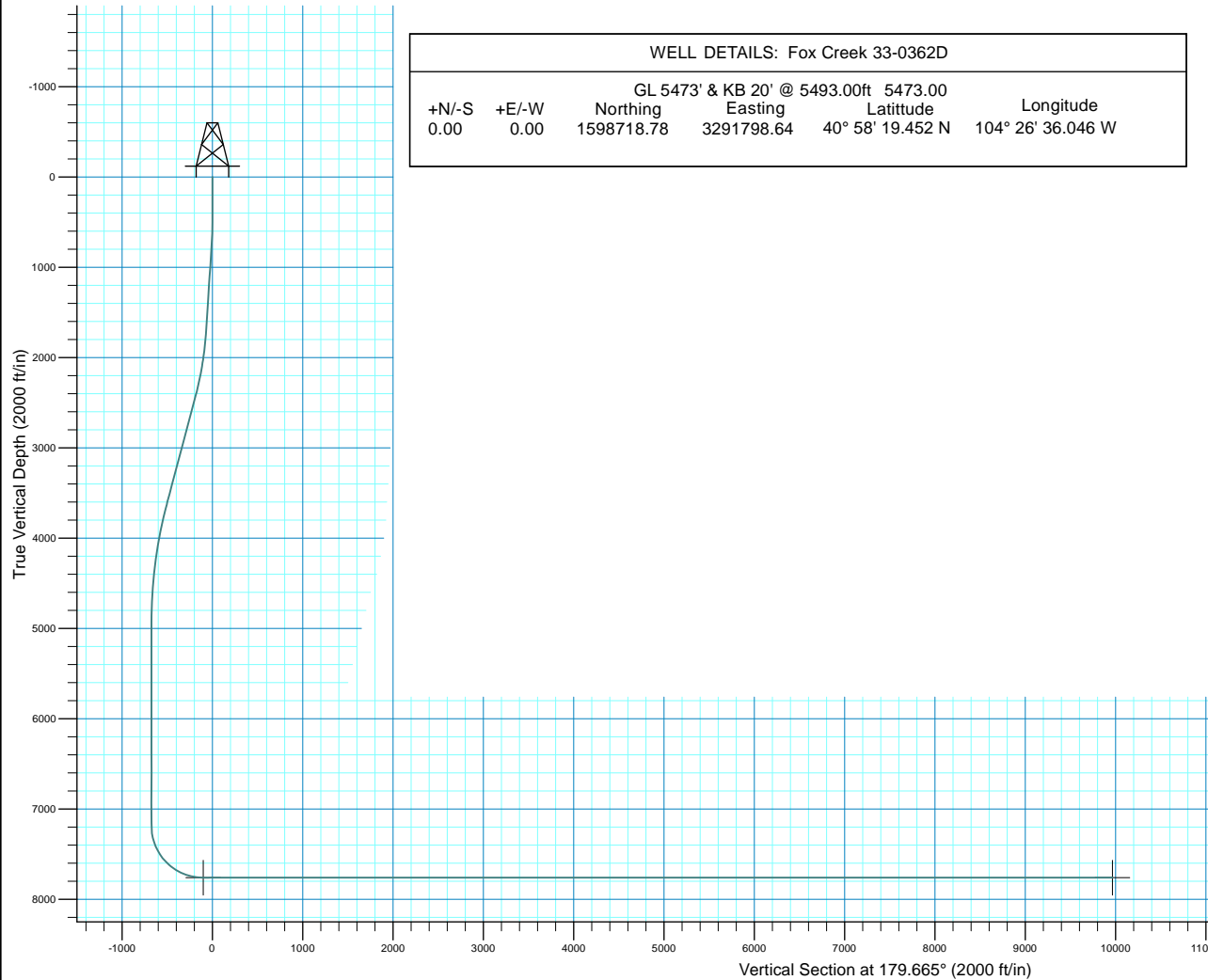



# HighPoint Resources

Weld County, CO NAD 83  
Fox Creek 33 NWNW Pad  
Fox Creek 33-0362D

OH

Plan: Plan 1

## Standard Planning Report

14 September, 2018



<b>Database:</b>	Casper District	<b>Local Co-ordinate Reference:</b>	Well Fox Creek 33-0362D
<b>Company:</b>	HighPoint Resources	<b>TVD Reference:</b>	GL 5473' & KB 20' @ 5493.00ft
<b>Project:</b>	Weld County, CO NAD 83	<b>MD Reference:</b>	GL 5473' & KB 20' @ 5493.00ft
<b>Site:</b>	Fox Creek 33 NWNW Pad	<b>North Reference:</b>	True
<b>Well:</b>	Fox Creek 33-0362D	<b>Survey Calculation Method:</b>	Minimum Curvature
<b>Wellbore:</b>	OH		
<b>Design:</b>	Plan 1		

<b>Project</b>	Weld County, CO NAD 83		
<b>Map System:</b>	US State Plane 1983	<b>System Datum:</b>	Mean Sea Level
<b>Geo Datum:</b>	North American Datum 1983		
<b>Map Zone:</b>	Colorado Northern Zone		

Site	Fox Creek 33 NWNW Pad, Site Center : Fox Creek 33-0461B				
Site Position:		Northing:	1,598,718.97 usft	Latitude:	40° 58' 19.452 N
From:	Lat/Long	Easting:	3,291,813.55 usft	Longitude:	104° 26' 35.851 W
Position Uncertainty:	0.00 ft	Slot Radius:	13.200 in	Grid Convergence:	0.68 °

Well	Fox Creek 33-0362D, 409' FNL 1173' FWL Sec 33 T12N R63W					
Well Position	+N/-S	-0.02 ft	Northing:	1,598,718.78 usft	Latitude:	40° 58' 19.452 N
	+E/-W	-14.91 ft	Easting:	3,291,798.64 usft	Longitude:	104° 26' 36.046 W
Position Uncertainty		0.00 ft	Wellhead Elevation:	0.00 ft	Ground Level:	5,473.00 ft

<b>Wellbore</b>	OH				
<b>Magnetics</b>	<b>Model Name</b>	<b>Sample Date</b>	<b>Declination (°)</b>	<b>Dip Angle (°)</b>	<b>Field Strength (nT)</b>
	HDGM	9/14/2018	8.35	67.28	52,783

<b>Design</b>	Plan 1			
<b>Audit Notes:</b>				
<b>Version:</b>	<b>Phase:</b>	PLAN	<b>Tie On Depth:</b>	0.00
<b>Vertical Section:</b>	<b>Depth From (TVD) (ft)</b>	<b>+N/-S (ft)</b>	<b>+E/-W (ft)</b>	<b>Direction (°)</b>
	0.00	0.00	0.00	179.665

<b>Plan Sections</b>										
Measured Depth (ft)	Inclination (°)	Azimuth (°)	Vertical Depth (ft)	+N/-S (ft)	+E/-W (ft)	Dogleg Rate (°/100ft)	Build Rate (°/100ft)	Turn Rate (°/100ft)	TFO (°)	Target
0.00	0.00	0.000	0.00	0.00	0.00	0.00	0.00	0.00	0.00	
500.00	0.00	0.000	500.00	0.00	0.00	0.00	0.00	0.00	0.00	
750.00	5.00	42.747	749.68	8.01	7.40	2.00	2.00	0.00	42.75	
1,703.95	5.00	42.747	1,700.00	69.06	63.83	0.00	0.00	0.00	0.00	
2,454.16	20.00	42.747	2,430.33	187.98	173.75	2.00	2.00	0.00	0.00	
3,730.65	20.00	42.747	3,629.81	508.66	470.15	0.00	0.00	0.00	0.00	
5,064.27	0.00	0.000	4,936.50	677.90	626.57	1.50	-1.50	0.00	180.00	
7,315.81	0.00	0.000	7,188.04	677.90	626.57	0.00	0.00	0.00	0.00	
8,215.81	90.00	179.665	7,761.00	104.95	629.92	10.00	10.00	19.96	179.67	
18,282.86	90.00	179.665	7,761.00	-9,961.93	688.75	0.00	0.00	0.00	0.00	Fox Creek 33-0362D

<b>Database:</b>	Casper District	<b>Local Co-ordinate Reference:</b>	Well Fox Creek 33-0362D
<b>Company:</b>	HighPoint Resources	<b>TVD Reference:</b>	GL 5473' & KB 20' @ 5493.00ft
<b>Project:</b>	Weld County, CO NAD 83	<b>MD Reference:</b>	GL 5473' & KB 20' @ 5493.00ft
<b>Site:</b>	Fox Creek 33 NWNW Pad	<b>North Reference:</b>	True
<b>Well:</b>	Fox Creek 33-0362D	<b>Survey Calculation Method:</b>	Minimum Curvature
<b>Wellbore:</b>	OH		
<b>Design:</b>	Plan 1		

Planned Survey									
Measured Depth (ft)	Inclination (°)	Azimuth (°)	Vertical Depth (ft)	+N/-S (ft)	+E/-W (ft)	Vertical Section (ft)	Dogleg Rate (°/100ft)	Build Rate (°/100ft)	Turn Rate (°/100ft)
0.00	0.00	0.000	0.00	0.00	0.00	0.00	0.00	0.00	0.00
100.00	0.00	0.000	100.00	0.00	0.00	0.00	0.00	0.00	0.00
200.00	0.00	0.000	200.00	0.00	0.00	0.00	0.00	0.00	0.00
300.00	0.00	0.000	300.00	0.00	0.00	0.00	0.00	0.00	0.00
400.00	0.00	0.000	400.00	0.00	0.00	0.00	0.00	0.00	0.00
500.00	0.00	0.000	500.00	0.00	0.00	0.00	0.00	0.00	0.00
Start Build 2.00									
600.00	2.00	42.747	599.98	1.28	1.18	-1.27	2.00	2.00	0.00
700.00	4.00	42.747	699.84	5.12	4.74	-5.10	2.00	2.00	0.00
750.00	5.00	42.747	749.68	8.01	7.40	-7.96	2.00	2.00	0.00
Start 953.95 hold at 750.00 MD									
800.00	5.00	42.747	799.49	11.21	10.36	-11.14	0.00	0.00	0.00
900.00	5.00	42.747	899.11	17.61	16.27	-17.51	0.00	0.00	0.00
1,000.00	5.00	42.747	998.73	24.01	22.19	-23.88	0.00	0.00	0.00
1,100.00	5.00	42.747	1,098.35	30.41	28.10	-30.24	0.00	0.00	0.00
1,200.00	5.00	42.747	1,197.97	36.81	34.02	-36.61	0.00	0.00	0.00
1,300.00	5.00	42.747	1,297.59	43.21	39.94	-42.97	0.00	0.00	0.00
1,400.00	5.00	42.747	1,397.21	49.61	45.85	-49.34	0.00	0.00	0.00
1,500.00	5.00	42.747	1,496.83	56.01	51.77	-55.70	0.00	0.00	0.00
1,600.00	5.00	42.747	1,596.45	62.41	57.68	-62.07	0.00	0.00	0.00
1,700.00	5.00	42.747	1,696.07	68.81	63.60	-68.44	0.00	0.00	0.00
1,703.95	5.00	42.747	1,700.00	69.06	63.83	-68.69	0.00	0.00	0.00
Start DLS 2.00 TFO 0.00									
1,800.00	6.92	42.747	1,795.53	76.39	70.60	-75.97	2.00	2.00	0.00
1,900.00	8.92	42.747	1,894.57	86.51	79.96	-86.04	2.00	2.00	0.00
2,000.00	10.92	42.747	1,993.07	99.16	91.65	-98.62	2.00	2.00	0.00
2,100.00	12.92	42.747	2,090.91	114.33	105.67	-113.71	2.00	2.00	0.00
2,200.00	14.92	42.747	2,187.97	131.99	122.00	-131.28	2.00	2.00	0.00
2,300.00	16.92	42.747	2,284.12	152.14	140.62	-151.31	2.00	2.00	0.00
2,400.00	18.92	42.747	2,379.27	174.73	161.50	-173.78	2.00	2.00	0.00
2,454.16	20.00	42.747	2,430.33	187.98	173.75	-186.96	2.00	2.00	0.00
Start 1276.49 hold at 2454.16 MD									
2,500.00	20.00	42.747	2,473.41	199.50	184.39	-198.42	0.00	0.00	0.00
2,600.00	20.00	42.747	2,567.37	224.62	207.61	-223.40	0.00	0.00	0.00
2,700.00	20.00	42.747	2,661.34	249.74	230.83	-248.39	0.00	0.00	0.00
2,800.00	20.00	42.747	2,755.31	274.87	254.05	-273.37	0.00	0.00	0.00
2,900.00	20.00	42.747	2,849.27	299.99	277.27	-298.36	0.00	0.00	0.00
3,000.00	20.00	42.747	2,943.24	325.11	300.49	-323.35	0.00	0.00	0.00
3,100.00	20.00	42.747	3,037.21	350.23	323.71	-348.33	0.00	0.00	0.00
3,200.00	20.00	42.747	3,131.17	375.35	346.93	-373.32	0.00	0.00	0.00
3,300.00	20.00	42.747	3,225.14	400.47	370.15	-398.30	0.00	0.00	0.00
3,400.00	20.00	42.747	3,319.11	425.60	393.37	-423.29	0.00	0.00	0.00
3,500.00	20.00	42.747	3,413.07	450.72	416.59	-448.27	0.00	0.00	0.00
3,600.00	20.00	42.747	3,507.04	475.84	439.81	-473.26	0.00	0.00	0.00
3,700.00	20.00	42.747	3,601.01	500.96	463.03	-498.25	0.00	0.00	0.00
3,730.65	20.00	42.747	3,629.81	508.66	470.15	-505.90	0.00	0.00	0.00
Start Drop -1.50									
3,800.00	18.96	42.747	3,695.19	525.65	485.85	-522.80	1.50	-1.50	0.00
3,900.00	17.46	42.747	3,790.17	548.60	507.06	-545.63	1.50	-1.50	0.00
4,000.00	15.96	42.747	3,885.95	569.72	526.58	-566.63	1.50	-1.50	0.00
4,100.00	14.46	42.747	3,982.44	588.99	544.39	-585.80	1.50	-1.50	0.00
4,200.00	12.96	42.747	4,079.58	606.40	560.49	-603.11	1.50	-1.50	0.00
4,300.00	11.46	42.747	4,177.32	621.94	574.85	-618.57	1.50	-1.50	0.00
4,400.00	9.96	42.747	4,275.57	635.59	587.46	-632.14	1.50	-1.50	0.00

<b>Database:</b>	Casper District	<b>Local Co-ordinate Reference:</b>	Well Fox Creek 33-0362D
<b>Company:</b>	HighPoint Resources	<b>TVD Reference:</b>	GL 5473' & KB 20' @ 5493.00ft
<b>Project:</b>	Weld County, CO NAD 83	<b>MD Reference:</b>	GL 5473' & KB 20' @ 5493.00ft
<b>Site:</b>	Fox Creek 33 NWNW Pad	<b>North Reference:</b>	True
<b>Well:</b>	Fox Creek 33-0362D	<b>Survey Calculation Method:</b>	Minimum Curvature
<b>Wellbore:</b>	OH		
<b>Design:</b>	Plan 1		

Planned Survey									
Measured Depth (ft)	Inclination (°)	Azimuth (°)	Vertical Depth (ft)	+N/-S (ft)	+E/-W (ft)	Vertical Section (ft)	Dogleg Rate (°/100ft)	Build Rate (°/100ft)	Turn Rate (°/100ft)
4,500.00	8.46	42.747	4,374.28	647.35	598.33	-643.84	1.50	-1.50	0.00
4,600.00	6.96	42.747	4,473.37	657.21	607.44	-653.64	1.50	-1.50	0.00
4,700.00	5.46	42.747	4,572.78	665.15	614.79	-661.55	1.50	-1.50	0.00
4,800.00	3.96	42.747	4,672.44	671.19	620.37	-667.55	1.50	-1.50	0.00
4,900.00	2.46	42.747	4,772.28	675.31	624.17	-671.65	1.50	-1.50	0.00
5,000.00	0.96	42.747	4,872.23	677.50	626.20	-673.83	1.50	-1.50	0.00
5,064.27	0.00	0.000	4,936.50	677.90	626.57	-674.22	1.50	-1.50	0.00
Start 2251.54 hold at 5064.27 MD									
5,100.00	0.00	0.000	4,972.23	677.90	626.57	-674.22	0.00	0.00	0.00
5,200.00	0.00	0.000	5,072.23	677.90	626.57	-674.22	0.00	0.00	0.00
5,300.00	0.00	0.000	5,172.23	677.90	626.57	-674.22	0.00	0.00	0.00
5,400.00	0.00	0.000	5,272.23	677.90	626.57	-674.22	0.00	0.00	0.00
5,500.00	0.00	0.000	5,372.23	677.90	626.57	-674.22	0.00	0.00	0.00
5,600.00	0.00	0.000	5,472.23	677.90	626.57	-674.22	0.00	0.00	0.00
5,700.00	0.00	0.000	5,572.23	677.90	626.57	-674.22	0.00	0.00	0.00
5,800.00	0.00	0.000	5,672.23	677.90	626.57	-674.22	0.00	0.00	0.00
5,900.00	0.00	0.000	5,772.23	677.90	626.57	-674.22	0.00	0.00	0.00
6,000.00	0.00	0.000	5,872.23	677.90	626.57	-674.22	0.00	0.00	0.00
6,100.00	0.00	0.000	5,972.23	677.90	626.57	-674.22	0.00	0.00	0.00
6,200.00	0.00	0.000	6,072.23	677.90	626.57	-674.22	0.00	0.00	0.00
6,300.00	0.00	0.000	6,172.23	677.90	626.57	-674.22	0.00	0.00	0.00
6,400.00	0.00	0.000	6,272.23	677.90	626.57	-674.22	0.00	0.00	0.00
6,500.00	0.00	0.000	6,372.23	677.90	626.57	-674.22	0.00	0.00	0.00
6,600.00	0.00	0.000	6,472.23	677.90	626.57	-674.22	0.00	0.00	0.00
6,700.00	0.00	0.000	6,572.23	677.90	626.57	-674.22	0.00	0.00	0.00
6,800.00	0.00	0.000	6,672.23	677.90	626.57	-674.22	0.00	0.00	0.00
6,900.00	0.00	0.000	6,772.23	677.90	626.57	-674.22	0.00	0.00	0.00
7,000.00	0.00	0.000	6,872.23	677.90	626.57	-674.22	0.00	0.00	0.00
7,100.00	0.00	0.000	6,972.23	677.90	626.57	-674.22	0.00	0.00	0.00
7,200.00	0.00	0.000	7,072.23	677.90	626.57	-674.22	0.00	0.00	0.00
7,300.00	0.00	0.000	7,172.23	677.90	626.57	-674.22	0.00	0.00	0.00
7,315.81	0.00	0.000	7,188.04	677.90	626.57	-674.22	0.00	0.00	0.00
Start DLS 10.00 TFO 179.67									
7,400.00	8.42	179.665	7,271.93	671.73	626.61	-668.05	10.00	10.00	0.00
7,500.00	18.42	179.665	7,369.07	648.55	626.74	-644.87	10.00	10.00	0.00
7,600.00	28.42	179.665	7,460.72	608.86	626.97	-605.18	10.00	10.00	0.00
7,700.00	38.42	179.665	7,544.08	553.85	627.29	-550.17	10.00	10.00	0.00
7,800.00	48.42	179.665	7,616.62	485.21	627.70	-481.53	10.00	10.00	0.00
7,900.00	58.42	179.665	7,676.14	405.01	628.16	-401.33	10.00	10.00	0.00
8,000.00	68.42	179.665	7,720.83	315.69	628.69	-312.01	10.00	10.00	0.00
8,100.00	78.42	179.665	7,749.33	219.97	629.25	-216.29	10.00	10.00	0.00
8,200.00	88.42	179.665	7,760.78	120.76	629.83	-117.08	10.00	10.00	0.00
8,215.81	90.00	179.665	7,761.00	104.95	629.92	-101.27	10.00	10.00	0.00
Start 10067.06 hold at 8215.81 MD									
8,300.00	90.00	179.665	7,761.00	20.77	630.41	-17.08	0.00	0.00	0.00
8,400.00	90.00	179.665	7,761.00	-79.23	630.99	82.92	0.00	0.00	0.00
8,500.00	90.00	179.665	7,761.00	-179.23	631.58	182.92	0.00	0.00	0.00
8,600.00	90.00	179.665	7,761.00	-279.23	632.16	282.92	0.00	0.00	0.00
8,700.00	90.00	179.665	7,761.00	-379.23	632.75	382.92	0.00	0.00	0.00
8,800.00	90.00	179.665	7,761.00	-479.23	633.33	482.92	0.00	0.00	0.00
8,900.00	90.00	179.665	7,761.00	-579.22	633.92	582.92	0.00	0.00	0.00
9,000.00	90.00	179.665	7,761.00	-679.22	634.50	682.92	0.00	0.00	0.00
9,100.00	90.00	179.665	7,761.00	-779.22	635.09	782.92	0.00	0.00	0.00

<b>Database:</b>	Casper District	<b>Local Co-ordinate Reference:</b>	Well Fox Creek 33-0362D
<b>Company:</b>	HighPoint Resources	<b>TVD Reference:</b>	GL 5473' & KB 20' @ 5493.00ft
<b>Project:</b>	Weld County, CO NAD 83	<b>MD Reference:</b>	GL 5473' & KB 20' @ 5493.00ft
<b>Site:</b>	Fox Creek 33 NWNW Pad	<b>North Reference:</b>	True
<b>Well:</b>	Fox Creek 33-0362D	<b>Survey Calculation Method:</b>	Minimum Curvature
<b>Wellbore:</b>	OH		
<b>Design:</b>	Plan 1		

Planned Survey									
Measured Depth (ft)	Inclination (°)	Azimuth (°)	Vertical Depth (ft)	+N/-S (ft)	+E/-W (ft)	Vertical Section (ft)	Dogleg Rate (°/100ft)	Build Rate (°/100ft)	Turn Rate (°/100ft)
9,200.00	90.00	179.665	7,761.00	-879.22	635.67	882.92	0.00	0.00	0.00
9,300.00	90.00	179.665	7,761.00	-979.22	636.25	982.92	0.00	0.00	0.00
9,400.00	90.00	179.665	7,761.00	-1,079.22	636.84	1,082.92	0.00	0.00	0.00
9,500.00	90.00	179.665	7,761.00	-1,179.21	637.42	1,182.92	0.00	0.00	0.00
9,600.00	90.00	179.665	7,761.00	-1,279.21	638.01	1,282.92	0.00	0.00	0.00
9,700.00	90.00	179.665	7,761.00	-1,379.21	638.59	1,382.92	0.00	0.00	0.00
9,800.00	90.00	179.665	7,761.00	-1,479.21	639.18	1,482.92	0.00	0.00	0.00
9,900.00	90.00	179.665	7,761.00	-1,579.21	639.76	1,582.92	0.00	0.00	0.00
10,000.00	90.00	179.665	7,761.00	-1,679.21	640.34	1,682.92	0.00	0.00	0.00
10,100.00	90.00	179.665	7,761.00	-1,779.20	640.93	1,782.92	0.00	0.00	0.00
10,200.00	90.00	179.665	7,761.00	-1,879.20	641.51	1,882.92	0.00	0.00	0.00
10,300.00	90.00	179.665	7,761.00	-1,979.20	642.10	1,982.92	0.00	0.00	0.00
10,400.00	90.00	179.665	7,761.00	-2,079.20	642.68	2,082.92	0.00	0.00	0.00
10,500.00	90.00	179.665	7,761.00	-2,179.20	643.27	2,182.92	0.00	0.00	0.00
10,600.00	90.00	179.665	7,761.00	-2,279.20	643.85	2,282.92	0.00	0.00	0.00
10,700.00	90.00	179.665	7,761.00	-2,379.19	644.44	2,382.92	0.00	0.00	0.00
10,800.00	90.00	179.665	7,761.00	-2,479.19	645.02	2,482.92	0.00	0.00	0.00
10,900.00	90.00	179.665	7,761.00	-2,579.19	645.60	2,582.92	0.00	0.00	0.00
11,000.00	90.00	179.665	7,761.00	-2,679.19	646.19	2,682.92	0.00	0.00	0.00
11,100.00	90.00	179.665	7,761.00	-2,779.19	646.77	2,782.92	0.00	0.00	0.00
11,200.00	90.00	179.665	7,761.00	-2,879.19	647.36	2,882.92	0.00	0.00	0.00
11,300.00	90.00	179.665	7,761.00	-2,979.18	647.94	2,982.92	0.00	0.00	0.00
11,400.00	90.00	179.665	7,761.00	-3,079.18	648.53	3,082.92	0.00	0.00	0.00
11,500.00	90.00	179.665	7,761.00	-3,179.18	649.11	3,182.92	0.00	0.00	0.00
11,600.00	90.00	179.665	7,761.00	-3,279.18	649.69	3,282.92	0.00	0.00	0.00
11,700.00	90.00	179.665	7,761.00	-3,379.18	650.28	3,382.92	0.00	0.00	0.00
11,800.00	90.00	179.665	7,761.00	-3,479.18	650.86	3,482.92	0.00	0.00	0.00
11,900.00	90.00	179.665	7,761.00	-3,579.17	651.45	3,582.92	0.00	0.00	0.00
12,000.00	90.00	179.665	7,761.00	-3,679.17	652.03	3,682.92	0.00	0.00	0.00
12,100.00	90.00	179.665	7,761.00	-3,779.17	652.62	3,782.92	0.00	0.00	0.00
12,200.00	90.00	179.665	7,761.00	-3,879.17	653.20	3,882.92	0.00	0.00	0.00
12,300.00	90.00	179.665	7,761.00	-3,979.17	653.79	3,982.92	0.00	0.00	0.00
12,400.00	90.00	179.665	7,761.00	-4,079.16	654.37	4,082.92	0.00	0.00	0.00
12,500.00	90.00	179.665	7,761.00	-4,179.16	654.95	4,182.92	0.00	0.00	0.00
12,600.00	90.00	179.665	7,761.00	-4,279.16	655.54	4,282.92	0.00	0.00	0.00
12,700.00	90.00	179.665	7,761.00	-4,379.16	656.12	4,382.92	0.00	0.00	0.00
12,800.00	90.00	179.665	7,761.00	-4,479.16	656.71	4,482.92	0.00	0.00	0.00
12,900.00	90.00	179.665	7,761.00	-4,579.16	657.29	4,582.92	0.00	0.00	0.00
13,000.00	90.00	179.665	7,761.00	-4,679.15	657.88	4,682.92	0.00	0.00	0.00
13,100.00	90.00	179.665	7,761.00	-4,779.15	658.46	4,782.92	0.00	0.00	0.00
13,200.00	90.00	179.665	7,761.00	-4,879.15	659.04	4,882.92	0.00	0.00	0.00
13,300.00	90.00	179.665	7,761.00	-4,979.15	659.63	4,982.92	0.00	0.00	0.00
13,400.00	90.00	179.665	7,761.00	-5,079.15	660.21	5,082.92	0.00	0.00	0.00
13,500.00	90.00	179.665	7,761.00	-5,179.15	660.80	5,182.92	0.00	0.00	0.00
13,600.00	90.00	179.665	7,761.00	-5,279.14	661.38	5,282.92	0.00	0.00	0.00
13,700.00	90.00	179.665	7,761.00	-5,379.14	661.97	5,382.92	0.00	0.00	0.00
13,800.00	90.00	179.665	7,761.00	-5,479.14	662.55	5,482.92	0.00	0.00	0.00
13,900.00	90.00	179.665	7,761.00	-5,579.14	663.14	5,582.92	0.00	0.00	0.00
14,000.00	90.00	179.665	7,761.00	-5,679.14	663.72	5,682.92	0.00	0.00	0.00
14,100.00	90.00	179.665	7,761.00	-5,779.14	664.30	5,782.92	0.00	0.00	0.00
14,200.00	90.00	179.665	7,761.00	-5,879.13	664.89	5,882.92	0.00	0.00	0.00
14,300.00	90.00	179.665	7,761.00	-5,979.13	665.47	5,982.92	0.00	0.00	0.00
14,400.00	90.00	179.665	7,761.00	-6,079.13	666.06	6,082.92	0.00	0.00	0.00
14,500.00	90.00	179.665	7,761.00	-6,179.13	666.64	6,182.92	0.00	0.00	0.00

<b>Database:</b>	Casper District	<b>Local Co-ordinate Reference:</b>	Well Fox Creek 33-0362D
<b>Company:</b>	HighPoint Resources	<b>TVD Reference:</b>	GL 5473' & KB 20' @ 5493.00ft
<b>Project:</b>	Weld County, CO NAD 83	<b>MD Reference:</b>	GL 5473' & KB 20' @ 5493.00ft
<b>Site:</b>	Fox Creek 33 NWNW Pad	<b>North Reference:</b>	True
<b>Well:</b>	Fox Creek 33-0362D	<b>Survey Calculation Method:</b>	Minimum Curvature
<b>Wellbore:</b>	OH		
<b>Design:</b>	Plan 1		

Planned Survey										
Measured Depth (ft)	Inclination (°)	Azimuth (°)	Vertical Depth (ft)	+N/-S (ft)	+E/-W (ft)	Vertical Section (ft)	Dogleg Rate (°/100ft)	Build Rate (°/100ft)	Turn Rate (°/100ft)	
14,600.00	90.00	179.665	7,761.00	-6,279.13	667.23	6,282.92	0.00	0.00	0.00	
14,700.00	90.00	179.665	7,761.00	-6,379.13	667.81	6,382.92	0.00	0.00	0.00	
14,800.00	90.00	179.665	7,761.00	-6,479.12	668.40	6,482.92	0.00	0.00	0.00	
14,900.00	90.00	179.665	7,761.00	-6,579.12	668.98	6,582.92	0.00	0.00	0.00	
15,000.00	90.00	179.665	7,761.00	-6,679.12	669.56	6,682.92	0.00	0.00	0.00	
15,100.00	90.00	179.665	7,761.00	-6,779.12	670.15	6,782.92	0.00	0.00	0.00	
15,200.00	90.00	179.665	7,761.00	-6,879.12	670.73	6,882.92	0.00	0.00	0.00	
15,300.00	90.00	179.665	7,761.00	-6,979.12	671.32	6,982.92	0.00	0.00	0.00	
15,400.00	90.00	179.665	7,761.00	-7,079.11	671.90	7,082.92	0.00	0.00	0.00	
15,500.00	90.00	179.665	7,761.00	-7,179.11	672.49	7,182.92	0.00	0.00	0.00	
15,600.00	90.00	179.665	7,761.00	-7,279.11	673.07	7,282.92	0.00	0.00	0.00	
15,700.00	90.00	179.665	7,761.00	-7,379.11	673.65	7,382.92	0.00	0.00	0.00	
15,800.00	90.00	179.665	7,761.00	-7,479.11	674.24	7,482.92	0.00	0.00	0.00	
15,900.00	90.00	179.665	7,761.00	-7,579.11	674.82	7,582.92	0.00	0.00	0.00	
16,000.00	90.00	179.665	7,761.00	-7,679.10	675.41	7,682.92	0.00	0.00	0.00	
16,100.00	90.00	179.665	7,761.00	-7,779.10	675.99	7,782.92	0.00	0.00	0.00	
16,200.00	90.00	179.665	7,761.00	-7,879.10	676.58	7,882.92	0.00	0.00	0.00	
16,300.00	90.00	179.665	7,761.00	-7,979.10	677.16	7,982.92	0.00	0.00	0.00	
16,400.00	90.00	179.665	7,761.00	-8,079.10	677.75	8,082.92	0.00	0.00	0.00	
16,500.00	90.00	179.665	7,761.00	-8,179.09	678.33	8,182.92	0.00	0.00	0.00	
16,600.00	90.00	179.665	7,761.00	-8,279.09	678.91	8,282.92	0.00	0.00	0.00	
16,700.00	90.00	179.665	7,761.00	-8,379.09	679.50	8,382.92	0.00	0.00	0.00	
16,800.00	90.00	179.665	7,761.00	-8,479.09	680.08	8,482.92	0.00	0.00	0.00	
16,900.00	90.00	179.665	7,761.00	-8,579.09	680.67	8,582.92	0.00	0.00	0.00	
17,000.00	90.00	179.665	7,761.00	-8,679.09	681.25	8,682.92	0.00	0.00	0.00	
17,100.00	90.00	179.665	7,761.00	-8,779.08	681.84	8,782.92	0.00	0.00	0.00	
17,200.00	90.00	179.665	7,761.00	-8,879.08	682.42	8,882.92	0.00	0.00	0.00	
17,300.00	90.00	179.665	7,761.00	-8,979.08	683.00	8,982.92	0.00	0.00	0.00	
17,400.00	90.00	179.665	7,761.00	-9,079.08	683.59	9,082.92	0.00	0.00	0.00	
17,500.00	90.00	179.665	7,761.00	-9,179.08	684.17	9,182.92	0.00	0.00	0.00	
17,600.00	90.00	179.665	7,761.00	-9,279.08	684.76	9,282.92	0.00	0.00	0.00	
17,700.00	90.00	179.665	7,761.00	-9,379.07	685.34	9,382.92	0.00	0.00	0.00	
17,800.00	90.00	179.665	7,761.00	-9,479.07	685.93	9,482.92	0.00	0.00	0.00	
17,900.00	90.00	179.665	7,761.00	-9,579.07	686.51	9,582.92	0.00	0.00	0.00	
18,000.00	90.00	179.665	7,761.00	-9,679.07	687.10	9,682.92	0.00	0.00	0.00	
18,100.00	90.00	179.665	7,761.00	-9,779.07	687.68	9,782.92	0.00	0.00	0.00	
18,200.00	90.00	179.665	7,761.00	-9,879.07	688.26	9,882.92	0.00	0.00	0.00	
18,282.86	90.00	179.665	7,761.00	-9,961.93	688.75	9,965.79	0.00	0.00	0.00	
TD at 18282.87										

Design Targets										
Target Name	Dip Angle (°)	Dip Dir. (°)	TVD (ft)	+N/-S (ft)	+E/-W (ft)	Northing (usft)	Easting (usft)	Latitude	Longitude	
- hit/miss target										
- Shape										
Fox Creek 33-0362D PB	0.00	0.000	7,761.00	-9,961.93	688.75	1,588,765.78	3,292,606.04	40° 56' 41.024 N	104° 26' 27.071 W	
- plan hits target center										
- Point										
Fox Creek 33-0362D LP	0.00	0.000	7,761.00	104.96	629.92	1,598,831.24	3,292,427.26	40° 58' 20.489 N	104° 26' 27.834 W	
- plan hits target center										
- Point										

<b>Database:</b>	Casper District	<b>Local Co-ordinate Reference:</b>	Well Fox Creek 33-0362D
<b>Company:</b>	HighPoint Resources	<b>TVD Reference:</b>	GL 5473' & KB 20' @ 5493.00ft
<b>Project:</b>	Weld County, CO NAD 83	<b>MD Reference:</b>	GL 5473' & KB 20' @ 5493.00ft
<b>Site:</b>	Fox Creek 33 NWNW Pad	<b>North Reference:</b>	True
<b>Well:</b>	Fox Creek 33-0362D	<b>Survey Calculation Method:</b>	Minimum Curvature
<b>Wellbore:</b>	OH		
<b>Design:</b>	Plan 1		

Plan Annotations				
Measured Depth (ft)	Vertical Depth (ft)	Local Coordinates		Comment
		+N/-S (ft)	+E/-W (ft)	
500.00	500.00	0.00	0.00	Start Build 2.00
750.00	749.68	8.01	7.40	Start 953.95 hold at 750.00 MD
1,703.95	1,700.00	69.06	63.83	Start DLS 2.00 TFO 0.00
2,454.16	2,430.33	187.98	173.75	Start 1276.49 hold at 2454.16 MD
3,730.65	3,629.81	508.66	470.15	Start Drop -1.50
5,064.27	4,936.50	677.90	626.57	Start 2251.54 hold at 5064.27 MD
7,315.81	7,188.04	677.90	626.57	Start DLS 10.00 TFO 179.67
8,215.81	7,761.00	104.95	629.92	Start 10067.06 hold at 8215.81 MD
18,282.86	7,761.00	-9,961.93	688.75	TD at 18282.87