



Crestone Peak Resources

Well Name:

SHELEY 3D-4H-M267

Project Name:

Sec 4 T2N-R67W

Pad Name:

Sheley Pad

ANNOTATIONS

MD	Inc	Azi	TVD	+N/-S	+E/-W	VSect	Departure	Annotation
300.00	0.00	0.00	300.00	0.00	0.00	0.00	0.00	Start Build 2.00
1215.78	18.32	311.77	1200.27	96.68	-108.24	-82.36	145.13	Hold 18.32 Inc, 311.77 Az
6693.47	18.32	311.77	6400.45	1243.33	-1392.12	-1059.16	1866.51	KOP 8/100
8000.85	90.00	95.05	7280.00	1355.71	-686.38	-346.84	2661.15	LP 90 Inc, 95.05 Az
12613.32	90.00	95.05	7280.00	949.72	3908.18	4021.92	7273.62	TD at 12613.32

Geodetic Datum:

North American Datum 1983
US State Plane 1983, Colorado Northern Zone

Elevation:

Ground Elevation: 4909.00
KB Elevation: WELL @ 4932.00usft (Original Well Elev)

DESIGN TARGET DETAILS

Name	TVD	+N/-S	+E/-W	Northing	Easting	Latitude	Longitude	Shape
SHELEY 3D-4H-M267 BHL	7280.00	949.72	3908.18	1303475.81	3171188.46	40.164813	-104.887462	Point
SHELEY 3D-4H-M267 TPZ	7280.00	1355.71	-686.38	1303850.79	3166592.26	40.165929	-104.903899	Point

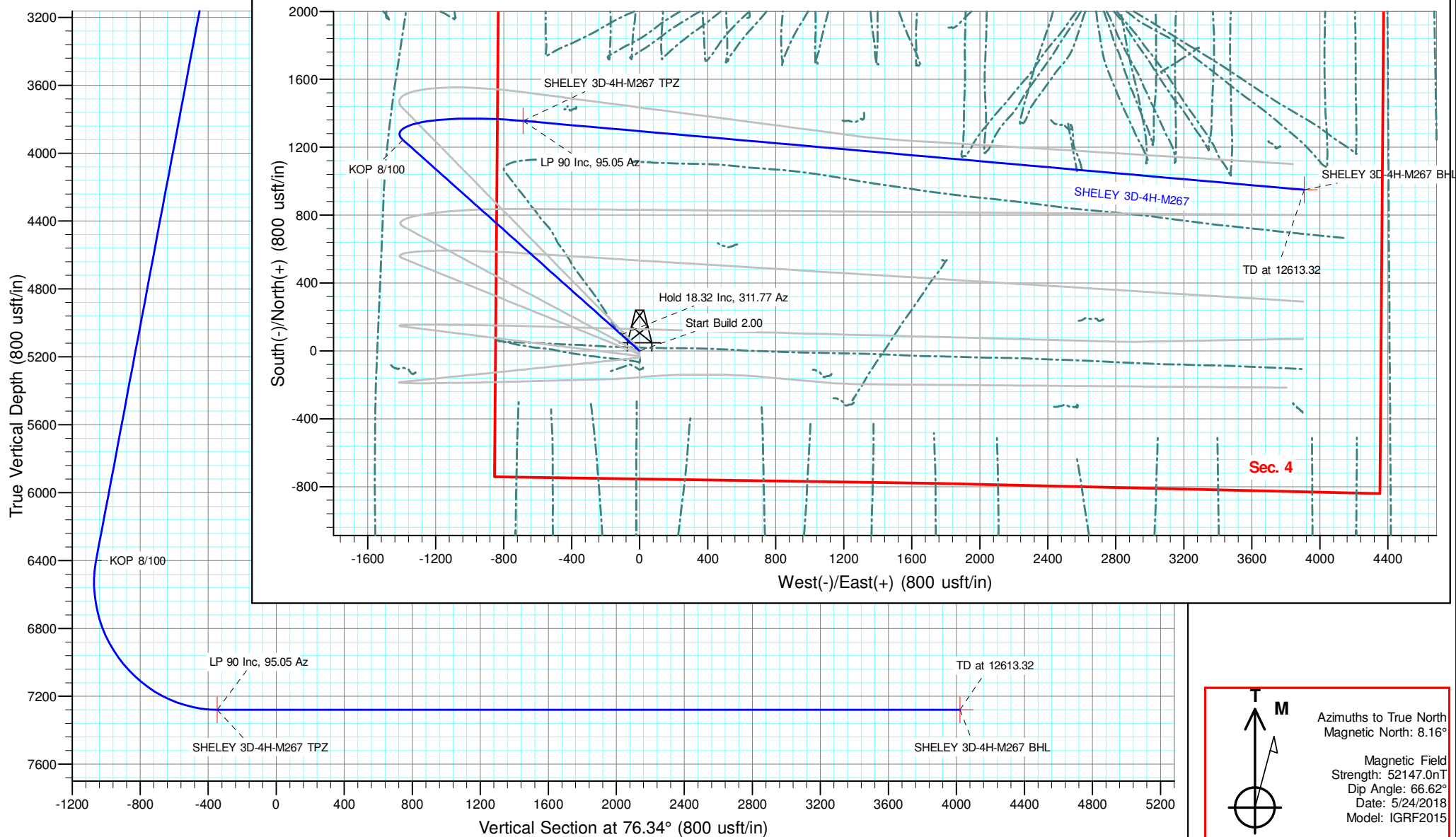



Crestone Peak Resources

Sec 4 T2N-R67W

Sheley Pad

SHELEY 3D-4H-M267

Wellbore #1

Plan: Plan #3 25Jun18 kjs

Standard Planning Report - Geographic

29 June, 2018

Database:	EDM 5000.15 Single User Db	Local Co-ordinate Reference:	Well SHELEY 3D-4H-M267
Company:	Crestone Peak Resources	TVD Reference:	WELL @ 4932.00usft (Original Well Elev)
Project:	Sec 4 T2N-R67W	MD Reference:	WELL @ 4932.00usft (Original Well Elev)
Site:	Sheley Pad	North Reference:	True
Well:	SHELEY 3D-4H-M267	Survey Calculation Method:	Minimum Curvature
Wellbore:	Wellbore #1		
Design:	Plan #3 25Jun18 kjs		

Project	Sec 4 T2N-R67W, Weld County, CO		
Map System:	US State Plane 1983	System Datum:	Mean Sea Level
Geo Datum:	North American Datum 1983		
Map Zone:	Colorado Northern Zone		

Site	Sheley Pad				
Site Position:		Northing:	1,302,549.65 usft	Latitude:	40.162344
From:	Lat/Long	Easting:	3,167,287.72 usft	Longitude:	-104.901442
Position Uncertainty:	0.00 usft	Slot Radius:	13-3/16 "	Grid Convergence:	0.39 °

Well	SHELEY 3D-4H-M267					
Well Position	+N/-S	0.00 usft	Northing:	1,302,499.73 usft	Latitude:	40.162207
	+E/-W	0.00 usft	Easting:	3,167,287.78 usft	Longitude:	-104.901443
Position Uncertainty		0.00 usft	Wellhead Elevation:		Ground Level:	4,909.00 usft

Wellbore	Wellbore #1				
Magnetics	Model Name	Sample Date	Declination (°)	Dip Angle (°)	Field Strength (nT)
	IGRF2015	5/24/2018	8.16	66.62	52,146.97206601

Design	Plan #3 25Jun18 kjs			
Audit Notes:				
Version:	Phase:	PLAN	Tie On Depth:	0.00
Vertical Section:	Depth From (TVD) (usft)	+N/-S (usft)	+E/-W (usft)	Direction (°)
	0.00	0.00	0.00	76.34

Plan Survey Tool Program	Date	6/29/2018		
Depth From (usft)	Depth To (usft)	Survey (Wellbore)	Tool Name	Remarks
1	0.00	12,613.32 Plan #3 25Jun18 kjs (Wellbore #	MWD	
			OWSG MWD - Standard	

Plan Sections										
Measured Depth (usft)	Inclination (°)	Azimuth (°)	Vertical Depth (usft)	+N/-S (usft)	+E/-W (usft)	Dogleg Rate (°/100usft)	Build Rate (°/100usft)	Turn Rate (°/100usft)	TFO (°)	Target
0.00	0.00	0.00	0.00	0.00	0.00	0.00	0.00	0.00	0.00	
300.00	0.00	0.00	300.00	0.00	0.00	0.00	0.00	0.00	0.00	
1,215.78	18.32	311.77	1,200.27	96.68	-108.24	2.00	2.00	0.00	311.77	
6,693.47	18.32	311.77	6,400.45	1,243.33	-1,392.12	0.00	0.00	0.00	0.00	
8,000.85	90.00	95.05	7,280.00	1,355.71	-686.38	8.00	5.48	10.96	141.84	SHELEY 3D-4H-M267
12,613.32	90.00	95.05	7,280.00	949.72	3,908.18	0.00	0.00	0.00	0.00	SHELEY 3D-4H-M267

Database:	EDM 5000.15 Single User Db	Local Co-ordinate Reference:	Well SHELEY 3D-4H-M267
Company:	Crestone Peak Resources	TVD Reference:	WELL @ 4932.00usft (Original Well Elev)
Project:	Sec 4 T2N-R67W	MD Reference:	WELL @ 4932.00usft (Original Well Elev)
Site:	Sheley Pad	North Reference:	True
Well:	SHELEY 3D-4H-M267	Survey Calculation Method:	Minimum Curvature
Wellbore:	Wellbore #1		
Design:	Plan #3 25Jun18 kjs		

Planned Survey									
Measured Depth (usft)	Inclination (°)	Azimuth (°)	Vertical Depth (usft)	+N/-S (usft)	+E/-W (usft)	Map Northing (usft)	Map Easting (usft)	Latitude	Longitude
0.00	0.00	0.00	0.00	0.00	0.00	1,302,499.73	3,167,287.78	40.162207	-104.901443
100.00	0.00	0.00	100.00	0.00	0.00	1,302,499.73	3,167,287.78	40.162207	-104.901443
200.00	0.00	0.00	200.00	0.00	0.00	1,302,499.73	3,167,287.78	40.162207	-104.901443
300.00	0.00	0.00	300.00	0.00	0.00	1,302,499.73	3,167,287.78	40.162207	-104.901443
Start Build 2.00									
400.00	2.00	311.77	399.98	1.16	-1.30	1,302,500.89	3,167,286.47	40.162210	-104.901448
500.00	4.00	311.77	499.84	4.65	-5.20	1,302,504.35	3,167,282.54	40.162220	-104.901462
600.00	6.00	311.77	599.45	10.45	-11.70	1,302,510.11	3,167,276.00	40.162236	-104.901485
700.00	8.00	311.77	698.70	18.57	-20.79	1,302,518.16	3,167,266.86	40.162258	-104.901518
800.00	10.00	311.77	797.47	28.99	-32.46	1,302,528.51	3,167,255.12	40.162287	-104.901559
900.00	12.00	311.77	895.62	41.70	-46.69	1,302,541.12	3,167,240.80	40.162322	-104.901610
1,000.00	14.00	311.77	993.06	56.68	-63.47	1,302,555.99	3,167,223.93	40.162363	-104.901670
1,100.00	16.00	311.77	1,089.64	73.92	-82.77	1,302,573.10	3,167,204.51	40.162410	-104.901739
1,200.00	18.00	311.77	1,185.27	93.40	-104.58	1,302,592.43	3,167,182.57	40.162463	-104.901817
1,215.78	18.32	311.77	1,200.27	96.68	-108.24	1,302,595.68	3,167,178.88	40.162472	-104.901831
Hold 18.32 Inc, 311.77 Az									
1,300.00	18.32	311.77	1,280.22	114.30	-127.98	1,302,613.17	3,167,159.02	40.162521	-104.901901
1,400.00	18.32	311.77	1,375.15	135.24	-151.42	1,302,633.95	3,167,135.45	40.162578	-104.901985
1,500.00	18.32	311.77	1,470.08	156.17	-174.86	1,302,654.72	3,167,111.87	40.162636	-104.902069
1,600.00	18.32	311.77	1,565.02	177.10	-198.30	1,302,675.50	3,167,088.29	40.162693	-104.902153
1,700.00	18.32	311.77	1,659.95	198.04	-221.74	1,302,696.27	3,167,064.71	40.162751	-104.902237
1,800.00	18.32	311.77	1,754.89	218.97	-245.17	1,302,717.04	3,167,041.13	40.162808	-104.902321
1,900.00	18.32	311.77	1,849.82	239.90	-268.61	1,302,737.82	3,167,017.55	40.162866	-104.902404
2,000.00	18.32	311.77	1,944.75	260.84	-292.05	1,302,758.59	3,166,993.97	40.162923	-104.902488
2,100.00	18.32	311.77	2,039.69	281.77	-315.49	1,302,779.37	3,166,970.39	40.162981	-104.902572
2,200.00	18.32	311.77	2,134.62	302.70	-338.93	1,302,800.14	3,166,946.81	40.163038	-104.902656
2,300.00	18.32	311.77	2,229.56	323.64	-362.37	1,302,820.92	3,166,923.23	40.163095	-104.902740
2,400.00	18.32	311.77	2,324.49	344.57	-385.80	1,302,841.69	3,166,899.66	40.163153	-104.902824
2,500.00	18.32	311.77	2,419.42	365.50	-409.24	1,302,862.47	3,166,876.08	40.163210	-104.902908
2,600.00	18.32	311.77	2,514.36	386.44	-432.68	1,302,883.24	3,166,852.50	40.163268	-104.902991
2,700.00	18.32	311.77	2,609.29	407.37	-456.12	1,302,904.01	3,166,828.92	40.163325	-104.903075
2,800.00	18.32	311.77	2,704.23	428.30	-479.56	1,302,924.79	3,166,805.34	40.163383	-104.903159
2,900.00	18.32	311.77	2,799.16	449.23	-502.99	1,302,945.56	3,166,781.76	40.163440	-104.903243
3,000.00	18.32	311.77	2,894.09	470.17	-526.43	1,302,966.34	3,166,758.18	40.163498	-104.903327
3,100.00	18.32	311.77	2,989.03	491.10	-549.87	1,302,987.11	3,166,734.60	40.163555	-104.903411
3,200.00	18.32	311.77	3,083.96	512.03	-573.31	1,303,007.89	3,166,711.02	40.163613	-104.903495
3,300.00	18.32	311.77	3,178.90	532.97	-596.75	1,303,028.66	3,166,687.45	40.163670	-104.903578
3,400.00	18.32	311.77	3,273.83	553.90	-620.19	1,303,049.44	3,166,663.87	40.163728	-104.903662
3,500.00	18.32	311.77	3,368.76	574.83	-643.62	1,303,070.21	3,166,640.29	40.163785	-104.903746
3,600.00	18.32	311.77	3,463.70	595.77	-667.06	1,303,090.98	3,166,616.71	40.163842	-104.903830
3,700.00	18.32	311.77	3,558.63	616.70	-690.50	1,303,111.76	3,166,593.13	40.163900	-104.903914
3,800.00	18.32	311.77	3,653.56	637.63	-713.94	1,303,132.53	3,166,569.55	40.163957	-104.903998
3,900.00	18.32	311.77	3,748.50	658.57	-737.38	1,303,153.31	3,166,545.97	40.164015	-104.904082
4,000.00	18.32	311.77	3,843.43	679.50	-760.81	1,303,174.08	3,166,522.39	40.164072	-104.904166
4,100.00	18.32	311.77	3,938.37	700.43	-784.25	1,303,194.86	3,166,498.81	40.164130	-104.904249
4,200.00	18.32	311.77	4,033.30	721.37	-807.69	1,303,215.63	3,166,475.23	40.164187	-104.904333
4,300.00	18.32	311.77	4,128.23	742.30	-831.13	1,303,236.41	3,166,451.66	40.164245	-104.904417
4,400.00	18.32	311.77	4,223.17	763.23	-854.57	1,303,257.18	3,166,428.08	40.164302	-104.904501
4,500.00	18.32	311.77	4,318.10	784.16	-878.01	1,303,277.95	3,166,404.50	40.164360	-104.904585
4,600.00	18.32	311.77	4,413.04	805.10	-901.44	1,303,298.73	3,166,380.92	40.164417	-104.904669
4,700.00	18.32	311.77	4,507.97	826.03	-924.88	1,303,319.50	3,166,357.34	40.164475	-104.904753
4,800.00	18.32	311.77	4,602.90	846.96	-948.32	1,303,340.28	3,166,333.76	40.164532	-104.904836
4,900.00	18.32	311.77	4,697.84	867.90	-971.76	1,303,361.05	3,166,310.18	40.164589	-104.904920
5,000.00	18.32	311.77	4,792.77	888.83	-995.20	1,303,381.83	3,166,286.60	40.164647	-104.905004

Database:	EDM 5000.15 Single User Db	Local Co-ordinate Reference:	Well SHELEY 3D-4H-M267
Company:	Crestone Peak Resources	TVD Reference:	WELL @ 4932.00usft (Original Well Elev)
Project:	Sec 4 T2N-R67W	MD Reference:	WELL @ 4932.00usft (Original Well Elev)
Site:	Sheley Pad	North Reference:	True
Well:	SHELEY 3D-4H-M267	Survey Calculation Method:	Minimum Curvature
Wellbore:	Wellbore #1		
Design:	Plan #3 25Jun18 kjs		

Planned Survey										
Measured Depth (usft)	Inclination (°)	Azimuth (°)	Vertical Depth (usft)	+N/-S (usft)	+E/-W (usft)	Map Northing (usft)	Map Easting (usft)	Latitude	Longitude	
5,100.00	18.32	311.77	4,887.71	909.76	-1,018.63	1,303,402.60	3,166,263.02	40.164704	-104.905088	
5,200.00	18.32	311.77	4,982.64	930.70	-1,042.07	1,303,423.38	3,166,239.44	40.164762	-104.905172	
5,300.00	18.32	311.77	5,077.57	951.63	-1,065.51	1,303,444.15	3,166,215.87	40.164819	-104.905256	
5,400.00	18.32	311.77	5,172.51	972.56	-1,088.95	1,303,464.92	3,166,192.29	40.164877	-104.905340	
5,500.00	18.32	311.77	5,267.44	993.50	-1,112.39	1,303,485.70	3,166,168.71	40.164934	-104.905424	
5,600.00	18.32	311.77	5,362.38	1,014.43	-1,135.83	1,303,506.47	3,166,145.13	40.164992	-104.905507	
5,700.00	18.32	311.77	5,457.31	1,035.36	-1,159.26	1,303,527.25	3,166,121.55	40.165049	-104.905591	
5,800.00	18.32	311.77	5,552.24	1,056.30	-1,182.70	1,303,548.02	3,166,097.97	40.165107	-104.905675	
5,900.00	18.32	311.77	5,647.18	1,077.23	-1,206.14	1,303,568.80	3,166,074.39	40.165164	-104.905759	
6,000.00	18.32	311.77	5,742.11	1,098.16	-1,229.58	1,303,589.57	3,166,050.81	40.165222	-104.905843	
6,100.00	18.32	311.77	5,837.05	1,119.09	-1,253.02	1,303,610.35	3,166,027.23	40.165279	-104.905927	
6,200.00	18.32	311.77	5,931.98	1,140.03	-1,276.46	1,303,631.12	3,166,003.66	40.165336	-104.906011	
6,300.00	18.32	311.77	6,026.91	1,160.96	-1,299.89	1,303,651.89	3,165,980.08	40.165394	-104.906094	
6,400.00	18.32	311.77	6,121.85	1,181.89	-1,323.33	1,303,672.67	3,165,956.50	40.165451	-104.906178	
6,500.00	18.32	311.77	6,216.78	1,202.83	-1,346.77	1,303,693.44	3,165,932.92	40.165509	-104.906262	
6,600.00	18.32	311.77	6,311.72	1,223.76	-1,370.21	1,303,714.22	3,165,909.34	40.165566	-104.906346	
6,693.47	18.32	311.77	6,400.45	1,243.33	-1,392.12	1,303,733.64	3,165,887.30	40.165620	-104.906424	
KOP 8/100										
6,700.00	17.91	312.82	6,406.66	1,244.69	-1,393.62	1,303,734.99	3,165,885.79	40.165624	-104.906430	
6,800.00	12.72	336.35	6,503.17	1,265.26	-1,409.34	1,303,755.45	3,165,869.93	40.165680	-104.906486	
6,900.00	11.36	14.91	6,601.12	1,284.88	-1,411.22	1,303,775.06	3,165,867.92	40.165734	-104.906493	
7,000.00	14.92	47.10	6,698.61	1,303.20	-1,399.23	1,303,793.45	3,165,879.78	40.165784	-104.906450	
7,100.00	21.04	64.09	6,793.75	1,319.83	-1,373.61	1,303,810.26	3,165,905.29	40.165830	-104.906358	
7,200.00	28.09	73.29	6,884.67	1,334.47	-1,334.85	1,303,825.17	3,165,943.95	40.165870	-104.906220	
7,300.00	35.52	78.95	6,969.61	1,346.83	-1,283.71	1,303,837.87	3,165,995.00	40.165904	-104.906037	
7,400.00	43.13	82.85	7,046.92	1,356.67	-1,221.18	1,303,848.13	3,166,057.47	40.165931	-104.905813	
7,500.00	50.84	85.78	7,115.10	1,363.79	-1,148.48	1,303,855.74	3,166,130.12	40.165951	-104.905553	
7,600.00	58.61	88.11	7,172.80	1,368.05	-1,067.02	1,303,860.55	3,166,211.55	40.165962	-104.905261	
7,700.00	66.42	90.09	7,218.92	1,369.38	-978.39	1,303,862.48	3,166,300.17	40.165966	-104.904944	
7,800.00	74.25	91.85	7,252.55	1,367.75	-884.32	1,303,861.49	3,166,394.25	40.165962	-104.904608	
7,900.00	82.09	93.47	7,273.05	1,363.19	-786.63	1,303,857.59	3,166,491.97	40.165949	-104.904258	
8,000.00	89.93	95.04	7,280.00	1,355.79	-687.23	1,303,850.85	3,166,591.41	40.165929	-104.903902	
8,000.85	90.00	95.05	7,280.00	1,355.71	-686.38	1,303,850.78	3,166,592.26	40.165929	-104.903899	
LP 90 Inc, 95.05 Az - SHELEY 3D-4H-M267 TPZ										
8,100.00	90.00	95.05	7,280.00	1,346.99	-587.61	1,303,842.72	3,166,691.08	40.165905	-104.903546	
8,200.00	90.00	95.05	7,280.00	1,338.18	-488.00	1,303,834.59	3,166,790.75	40.165881	-104.903189	
8,300.00	90.00	95.05	7,280.00	1,329.38	-388.39	1,303,826.46	3,166,890.42	40.165856	-104.902833	
8,400.00	90.00	95.05	7,280.00	1,320.58	-288.78	1,303,818.33	3,166,990.09	40.165832	-104.902477	
8,500.00	90.00	95.05	7,280.00	1,311.78	-189.17	1,303,810.20	3,167,089.76	40.165808	-104.902120	
8,600.00	90.00	95.05	7,280.00	1,302.97	-89.55	1,303,802.07	3,167,189.43	40.165784	-104.901764	
8,700.00	90.00	95.05	7,280.00	1,294.17	10.06	1,303,793.94	3,167,289.10	40.165760	-104.901407	
8,800.00	90.00	95.05	7,280.00	1,285.37	109.67	1,303,785.81	3,167,388.77	40.165736	-104.901051	
8,900.00	90.00	95.05	7,280.00	1,276.57	209.28	1,303,777.68	3,167,488.44	40.165711	-104.900694	
9,000.00	90.00	95.05	7,280.00	1,267.76	308.89	1,303,769.55	3,167,588.10	40.165687	-104.900338	
9,100.00	90.00	95.05	7,280.00	1,258.96	408.50	1,303,761.42	3,167,687.77	40.165663	-104.899982	
9,200.00	90.00	95.05	7,280.00	1,250.16	508.12	1,303,753.29	3,167,787.44	40.165639	-104.899625	
9,300.00	90.00	95.05	7,280.00	1,241.36	607.73	1,303,745.16	3,167,887.11	40.165615	-104.899269	
9,400.00	90.00	95.05	7,280.00	1,232.55	707.34	1,303,737.03	3,167,986.78	40.165591	-104.898912	
9,500.00	90.00	95.05	7,280.00	1,223.75	806.95	1,303,728.90	3,168,086.45	40.165566	-104.898556	
9,600.00	90.00	95.05	7,280.00	1,214.95	906.56	1,303,720.78	3,168,186.12	40.165542	-104.898199	
9,700.00	90.00	95.05	7,280.00	1,206.15	1,006.18	1,303,712.65	3,168,285.79	40.165518	-104.897843	
9,800.00	90.00	95.05	7,280.00	1,197.34	1,105.79	1,303,704.52	3,168,385.46	40.165494	-104.897487	
9,900.00	90.00	95.05	7,280.00	1,188.54	1,205.40	1,303,696.39	3,168,485.13	40.165470	-104.897130	
10,000.00	90.00	95.05	7,280.00	1,179.74	1,305.01	1,303,688.26	3,168,584.79	40.165446	-104.896774	

Database:	EDM 5000.15 Single User Db	Local Co-ordinate Reference:	Well SHELEY 3D-4H-M267
Company:	Crestone Peak Resources	TVD Reference:	WELL @ 4932.00usft (Original Well Elev)
Project:	Sec 4 T2N-R67W	MD Reference:	WELL @ 4932.00usft (Original Well Elev)
Site:	Sheley Pad	North Reference:	True
Well:	SHELEY 3D-4H-M267	Survey Calculation Method:	Minimum Curvature
Wellbore:	Wellbore #1		
Design:	Plan #3 25Jun18 kjs		

Planned Survey									
Measured Depth (usft)	Inclination (°)	Azimuth (°)	Vertical Depth (usft)	+N/-S (usft)	+E/-W (usft)	Map Northing (usft)	Map Easting (usft)	Latitude	Longitude
10,100.00	90.00	95.05	7,280.00	1,170.94	1,404.62	1,303,680.13	3,168,684.46	40.165421	-104.896417
10,200.00	90.00	95.05	7,280.00	1,162.13	1,504.23	1,303,672.00	3,168,784.13	40.165397	-104.896061
10,300.00	90.00	95.05	7,280.00	1,153.33	1,603.85	1,303,663.87	3,168,883.80	40.165373	-104.895704
10,400.00	90.00	95.05	7,280.00	1,144.53	1,703.46	1,303,655.74	3,168,983.47	40.165349	-104.895348
10,500.00	90.00	95.05	7,280.00	1,135.73	1,803.07	1,303,647.61	3,169,083.14	40.165325	-104.894992
10,600.00	90.00	95.05	7,280.00	1,126.92	1,902.68	1,303,639.48	3,169,182.81	40.165300	-104.894635
10,700.00	90.00	95.05	7,280.00	1,118.12	2,002.29	1,303,631.35	3,169,282.48	40.165276	-104.894279
10,800.00	90.00	95.05	7,280.00	1,109.32	2,101.91	1,303,623.22	3,169,382.15	40.165252	-104.893922
10,900.00	90.00	95.05	7,280.00	1,100.52	2,201.52	1,303,615.09	3,169,481.82	40.165228	-104.893566
11,000.00	90.00	95.05	7,280.00	1,091.71	2,301.13	1,303,606.96	3,169,581.48	40.165204	-104.893210
11,100.00	90.00	95.05	7,280.00	1,082.91	2,400.74	1,303,598.83	3,169,681.15	40.165179	-104.892853
11,200.00	90.00	95.05	7,280.00	1,074.11	2,500.35	1,303,590.70	3,169,780.82	40.165155	-104.892497
11,300.00	90.00	95.05	7,280.00	1,065.31	2,599.96	1,303,582.57	3,169,880.49	40.165131	-104.892140
11,400.00	90.00	95.05	7,280.00	1,056.50	2,699.58	1,303,574.44	3,169,980.16	40.165107	-104.891784
11,500.00	90.00	95.05	7,280.00	1,047.70	2,799.19	1,303,566.31	3,170,079.83	40.165083	-104.891427
11,600.00	90.00	95.05	7,280.00	1,038.90	2,898.80	1,303,558.18	3,170,179.50	40.165059	-104.891071
11,700.00	90.00	95.05	7,280.00	1,030.10	2,998.41	1,303,550.05	3,170,279.17	40.165034	-104.890715
11,800.00	90.00	95.05	7,280.00	1,021.29	3,098.02	1,303,541.92	3,170,378.84	40.165010	-104.890358
11,900.00	90.00	95.05	7,280.00	1,012.49	3,197.64	1,303,533.79	3,170,478.50	40.164986	-104.890002
12,000.00	90.00	95.05	7,280.00	1,003.69	3,297.25	1,303,525.66	3,170,578.17	40.164962	-104.889645
12,100.00	90.00	95.05	7,280.00	994.89	3,396.86	1,303,517.53	3,170,677.84	40.164938	-104.889289
12,200.00	90.00	95.05	7,280.00	986.08	3,496.47	1,303,509.40	3,170,777.51	40.164913	-104.888932
12,300.00	90.00	95.05	7,280.00	977.28	3,596.08	1,303,501.27	3,170,877.18	40.164889	-104.888576
12,400.00	90.00	95.05	7,280.00	968.48	3,695.69	1,303,493.14	3,170,976.85	40.164865	-104.888220
12,500.00	90.00	95.05	7,280.00	959.68	3,795.31	1,303,485.01	3,171,076.52	40.164841	-104.887863
12,600.00	90.00	95.05	7,280.00	950.87	3,894.92	1,303,476.88	3,171,176.19	40.164816	-104.887507
12,613.32	90.00	95.05	7,280.00	949.72	3,908.18	1,303,475.81	3,171,188.46	40.164813	-104.887462
TD at 12613.32 - SHELEY 3D-4H-M267 BHL									

Design Targets									
Target Name	Dip Angle (°)	Dip Dir. (°)	TVD (usft)	+N/-S (usft)	+E/-W (usft)	Northing (usft)	Easting (usft)	Latitude	Longitude
SHELEY 3D-4H-M267 T - hit/miss target - Shape	0.00	0.00	7,280.00	1,355.71	-686.38	1,303,850.78	3,166,592.26	40.165929	-104.903899
SHELEY 3D-4H-M267 B - plan hits target center - Point	0.00	0.00	7,280.00	949.72	3,908.18	1,303,475.81	3,171,188.46	40.164813	-104.887462

Plan Annotations					
Measured Depth (usft)	Vertical Depth (usft)	Local Coordinates			
		+N/-S (usft)	+E/-W (usft)	Comment	
300.00	300.00	0.00	0.00	Start Build 2.00	
1,215.78	1,200.27	96.68	-108.24	Hold 18.32 Inc, 311.77 Az	
6,693.47	6,400.45	1,243.33	-1,392.12	KOP 8/100	
8,000.85	7,280.00	1,355.71	-686.38	LP 90 Inc, 95.05 Az	
12,613.32	7,280.00	949.72	3,908.18	TD at 12613.32	