

# HYDROLOGY MAP BLUE PAINTBRUSH PRODUCTION FACILITY PAD

NW1/4 SW1/4 SECTION 18, TOWNSHIP 2 NORTH, RANGE 68 WEST, 6TH P.M.

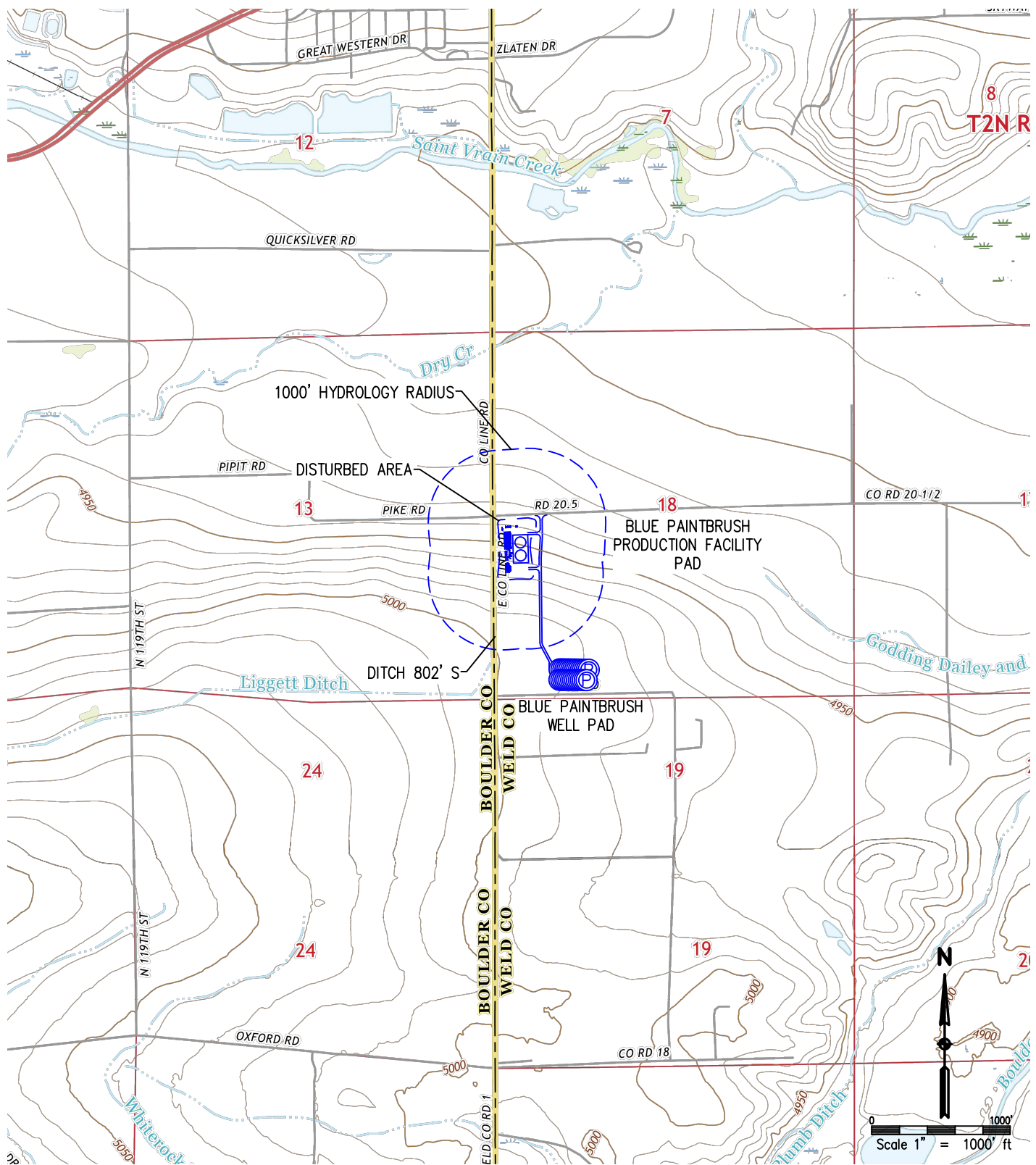

## LEGEND

- 1000' HYDROLOGY RADIUS
- WETLAND AREA



DRAWN BY	RPM	CHECKED BY	AAD
INITIAL SUBMITTAL	5/18/2017	REVISED	N/A
DRAWING SIZE	8.5" X 11"	JOB NO.	EXT02N68W18-01
SHEET	1 OF 1		

**BASELINE**  
Engineering - Planning - Surveying

4007 S. LINCOLN AVENUE, SUITE 405 - LOVELAND, COLORADO 80537  
P: 970.353.7800 - F: 970.353.7801 - www.baselinecorp.com