

LEGEND:

 **PROPOSED LOCATION**



Caerus Oil & Gas LLC

NPR B16 596 PAD
NW 1/4 NE 1/4, SECTION 16, T5S, R96W, 6th P.M.
GARFIELD COUNTY, COLORADO

UELS, LLC
 Corporate Office * 85 South 200 East
 Vernal, UT 84078 * (435) 789-1017

SURVEYED BY	BART HUNTING, D.P.	03-20-18	SCALE
DRAWN BY	T.S.	08-20-18	1 : 100,000
ACCESS ROAD MAP			TOPO A

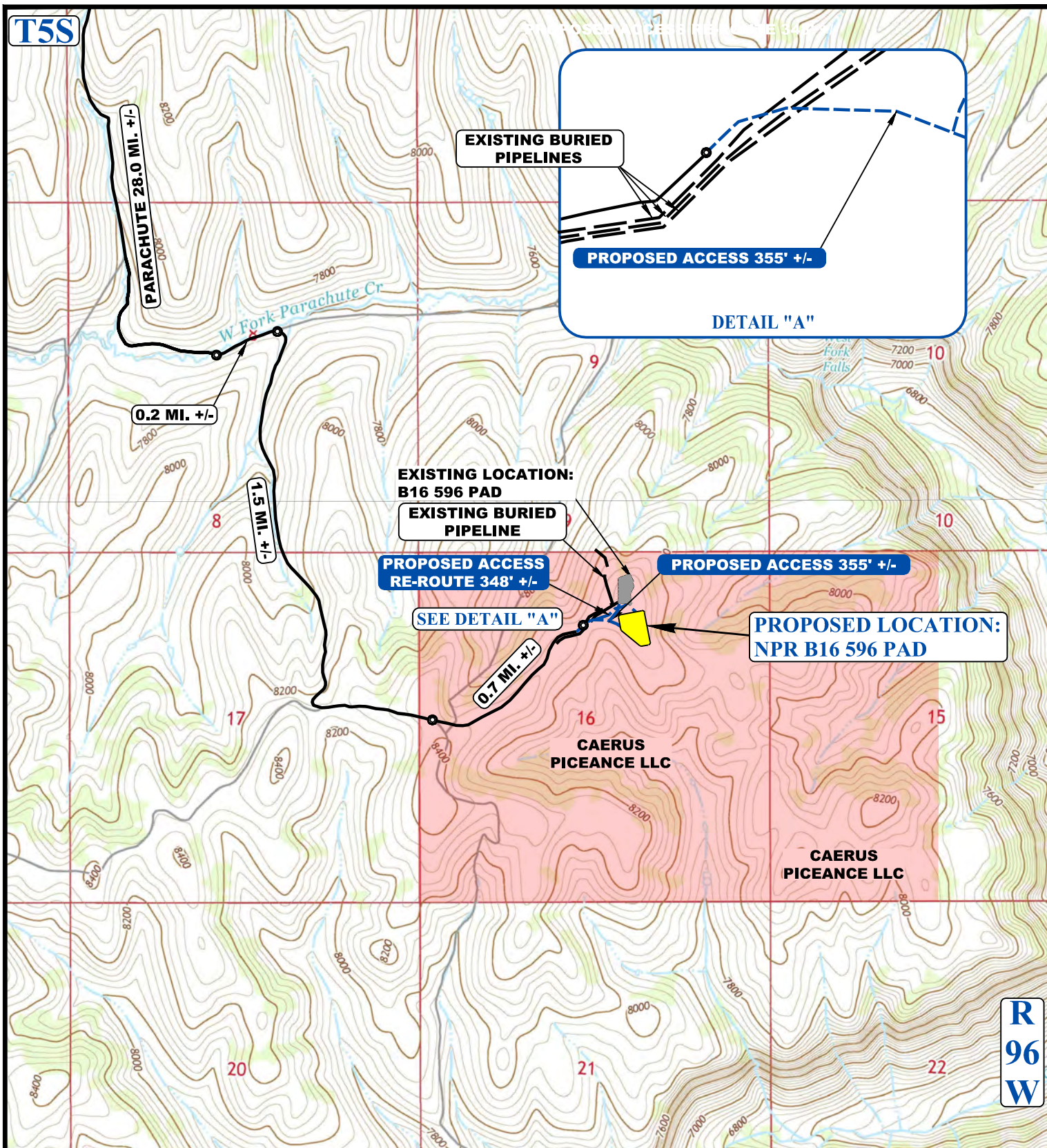

NOTE: PARCEL DATA SHOWN HAS BEEN OBTAINED FROM VARIOUS SOURCES AND SHOULD BE USED FOR MAPPING, GRAPHIC AND PLANNING PURPOSES ONLY. NO WARRANTY IS MADE BY UINTAH ENGINEERING AND LAND SURVEYING (UELS) FOR ACCURACY OF THE PARCEL DATA.

LEGEND:

— EXISTING ROAD
 - - - PROPOSED ROAD



Caerus Oil & Gas LLC

NPR B16 596 PAD
 NW 1/4 NE 1/4, SECTION 16, T5S, R96W, 6th P.M.
 GARFIELD COUNTY, COLORADO

SURVEYED BY	BART HUNTING, D.P.	03-20-18	SCALE
DRAWN BY	T.S.	08-20-18	1 : 24,000
ACCESS ROAD MAP			TOPO B



UELS, LLC
 Corporate Office * 85 South 200 East
 Vernal, UT 84078 * (435) 789-1017