



PROJECT DETAILS: Weld County, CO NAD 83

Geodetic System: US State Plane 1983  
Datum: North American Datum 1983  
Ellipsoid: GRS 1980  
Zone: Colorado Northern Zone  
System Datum: Mean Sea Level  
Local North: True

Plan: Plan 1 (Wetco 4-63-5-4033CB/OH)

Created By: Seth Burstad

Project: Weld County, CO NAD 83  
Site: Wetco 4-63 4 SW Pad  
Well: Wetco 4-63-5-4033CB  
Wellbore: OH  
Design: Plan 1

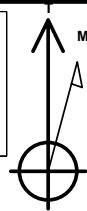

Azimuths to True North  
Magnetic North: 8.05°

Magnetic Field  
Strength: 52211.3snT  
Dip Angle: 66.88°  
Date: 8/7/2018  
Model: HDGM



SECTION DETAILS

MD	Inc	Azi	TVD	+N/-S	+E/-W	Dleg	TFace	VSect
0.00	0.00	0.000	0.00	0.00	0.00	0.00	0.00	0.00
500.00	0.00	0.000	500.00	0.00	0.00	0.00	0.00	0.00
1000.00	5.00	300.026	999.37	10.91	-18.88	1.00	300.03	19.02
1703.31	5.00	300.026	1700.00	41.58	-71.95	0.00	0.00	72.50
2453.40	20.00	300.026	2430.22	122.60	-212.12	2.00	0.00	213.74
3311.93	20.00	300.026	3236.96	269.54	-466.37	0.00	0.00	469.92
4645.39	0.00	0.000	4543.50	384.83	-665.85	1.50	180.00	670.92
6007.97	0.00	0.000	5906.08	384.83	-665.85	0.00	0.00	670.92
6901.03	89.31	270.764	6479.00	392.38	-1231.81	10.00	270.76	1236.94
16391.55	89.31	270.764	6594.00	518.91	-10720.79	0.00	0.00	10726.76

WELL DETAILS: Wetco 4-63-5-4033CB

GL 4629' & KB 20 @ 4649.00ft 4629.00				Longitude
+N/-S	+E/-W	Northing	Easting	
0.00	0.00	1368417.01	3292780.90	40° 20' 23.805 N 104° 26' 58.801 W

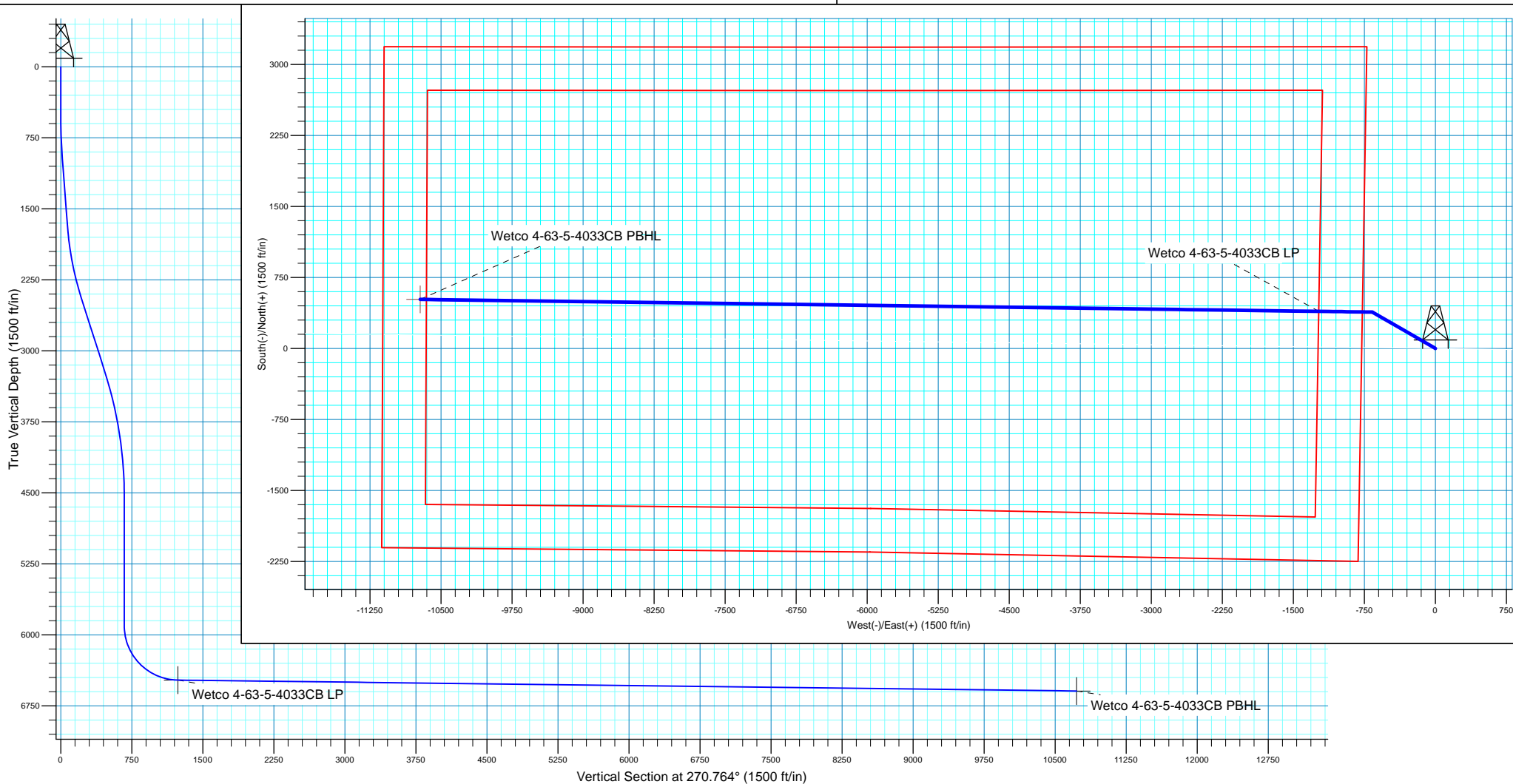



# HighPoint Resources

Weld County, CO NAD 83

Wetco 4-63 4 SW Pad

Wetco 4-63-5-4033CB

OH

Plan: Plan 1

## Standard Planning Report

07 August, 2018



<b>Database:</b>	Casper District	<b>Local Co-ordinate Reference:</b>	Well Wetco 4-63-5-4033CB
<b>Company:</b>	HighPoint Resources	<b>TVD Reference:</b>	GL 4629' & KB 20 @ 4649.00ft
<b>Project:</b>	Weld County, CO NAD 83	<b>MD Reference:</b>	GL 4629' & KB 20 @ 4649.00ft
<b>Site:</b>	Wetco 4-63 4 SW Pad	<b>North Reference:</b>	True
<b>Well:</b>	Wetco 4-63-5-4033CB	<b>Survey Calculation Method:</b>	Minimum Curvature
<b>Wellbore:</b>	OH		
<b>Design:</b>	Plan 1		

<b>Project</b>	Weld County, CO NAD 83		
<b>Map System:</b>	US State Plane 1983	<b>System Datum:</b>	Mean Sea Level
<b>Geo Datum:</b>	North American Datum 1983		
<b>Map Zone:</b>	Colorado Northern Zone		

Site		Wetco 4-63 4 SW Pad, Site Center : Wetco 4-63-5-4033CB			
Site Position:		Northing:	1,368,417.03 usft	Latitude:	40° 20' 23.806 N
From:	Lat/Long	Easting:	3,292,780.91 usft	Longitude:	104° 26' 58.801 W
Position Uncertainty:	0.00 ft	Slot Radius:	13.200 in	Grid Convergence:	0.68 °

Well	Wetco 4-63-5-4033CB, 2244' FSL 779' FWL Sec 4 T4N R63W					
Well Position	+N/-S	-0.01 ft	Northing:	1,368,417.02 usft	Latitude:	40° 20' 23.805 N
	+E/-W	0.00 ft	Easting:	3,292,780.91 usft	Longitude:	104° 26' 58.801 W
Position Uncertainty		0.00 ft	Wellhead Elevation:	0.00 ft	Ground Level:	4,629.00 ft

<b>Wellbore</b>	OH				
<b>Magnetics</b>	<b>Model Name</b>	<b>Sample Date</b>	<b>Declination (°)</b>	<b>Dip Angle (°)</b>	<b>Field Strength (nT)</b>
	HDGM	8/7/2018	8.05	66.88	52,211

<b>Design</b>	Plan 1			
<b>Audit Notes:</b>				
<b>Version:</b>	<b>Phase:</b>	PLAN	<b>Tie On Depth:</b>	0.00
<b>Vertical Section:</b>	<b>Depth From (TVD) (ft)</b>	<b>+N/-S (ft)</b>	<b>+E/-W (ft)</b>	<b>Direction (°)</b>
	0.00	0.00	0.00	270.764

<b>Plan Sections</b>										
Measured Depth (ft)	Inclination (°)	Azimuth (°)	Vertical Depth (ft)	+N/-S (ft)	+E/-W (ft)	Dogleg Rate (°/100ft)	Build Rate (°/100ft)	Turn Rate (°/100ft)	TFO (°)	Target
0.00	0.00	0.000	0.00	0.00	0.00	0.00	0.00	0.00	0.00	
500.00	0.00	0.000	500.00	0.00	0.00	0.00	0.00	0.00	0.00	
1,000.00	5.00	300.026	999.37	10.91	-18.88	1.00	1.00	0.00	300.03	
1,703.31	5.00	300.026	1,700.00	41.58	-71.95	0.00	0.00	0.00	0.00	
2,453.40	20.00	300.026	2,430.22	122.60	-212.12	2.00	2.00	0.00	0.00	
3,311.93	20.00	300.026	3,236.96	269.54	-466.37	0.00	0.00	0.00	0.00	
4,645.39	0.00	0.000	4,543.50	384.83	-665.85	1.50	-1.50	0.00	180.00	
6,007.97	0.00	0.000	5,906.08	384.83	-665.85	0.00	0.00	0.00	0.00	
6,901.03	89.31	270.764	6,479.00	392.38	-1,231.81	10.00	10.00	-9.99	270.76	
16,391.55	89.31	270.764	6,594.00	518.90	-10,720.79	0.00	0.00	0.00	0.00	Wetco 4-63-5-4033CB

<b>Database:</b>	Casper District	<b>Local Co-ordinate Reference:</b>	Well Wetco 4-63-5-4033CB
<b>Company:</b>	HighPoint Resources	<b>TVD Reference:</b>	GL 4629' & KB 20 @ 4649.00ft
<b>Project:</b>	Weld County, CO NAD 83	<b>MD Reference:</b>	GL 4629' & KB 20 @ 4649.00ft
<b>Site:</b>	Wetco 4-63 4 SW Pad	<b>North Reference:</b>	True
<b>Well:</b>	Wetco 4-63-5-4033CB	<b>Survey Calculation Method:</b>	Minimum Curvature
<b>Wellbore:</b>	OH		
<b>Design:</b>	Plan 1		

Planned Survey									
Measured Depth (ft)	Inclination (°)	Azimuth (°)	Vertical Depth (ft)	+N/-S (ft)	+E/-W (ft)	Vertical Section (ft)	Dogleg Rate (°/100ft)	Build Rate (°/100ft)	Turn Rate (°/100ft)
0.00	0.00	0.000	0.00	0.00	0.00	0.00	0.00	0.00	0.00
100.00	0.00	0.000	100.00	0.00	0.00	0.00	0.00	0.00	0.00
200.00	0.00	0.000	200.00	0.00	0.00	0.00	0.00	0.00	0.00
300.00	0.00	0.000	300.00	0.00	0.00	0.00	0.00	0.00	0.00
400.00	0.00	0.000	400.00	0.00	0.00	0.00	0.00	0.00	0.00
500.00	0.00	0.000	500.00	0.00	0.00	0.00	0.00	0.00	0.00
600.00	1.00	300.026	599.99	0.44	-0.76	0.76	1.00	1.00	0.00
700.00	2.00	300.026	699.96	1.75	-3.02	3.04	1.00	1.00	0.00
800.00	3.00	300.026	799.86	3.93	-6.80	6.85	1.00	1.00	0.00
900.00	4.00	300.026	899.68	6.98	-12.08	12.18	1.00	1.00	0.00
1,000.00	5.00	300.026	999.37	10.91	-18.88	19.02	1.00	1.00	0.00
1,100.00	5.00	300.026	1,098.99	15.27	-26.42	26.62	0.00	0.00	0.00
1,200.00	5.00	300.026	1,198.60	19.63	-33.97	34.23	0.00	0.00	0.00
1,300.00	5.00	300.026	1,298.22	23.99	-41.51	41.83	0.00	0.00	0.00
1,400.00	5.00	300.026	1,397.84	28.35	-49.06	49.43	0.00	0.00	0.00
1,500.00	5.00	300.026	1,497.46	32.72	-56.61	57.04	0.00	0.00	0.00
1,600.00	5.00	300.026	1,597.08	37.08	-64.15	64.64	0.00	0.00	0.00
1,700.00	5.00	300.026	1,696.70	41.44	-71.70	72.24	0.00	0.00	0.00
1,703.31	5.00	300.026	1,700.00	41.58	-71.95	72.50	0.00	0.00	0.00
1,800.00	6.93	300.026	1,796.16	46.61	-80.65	81.26	2.00	2.00	0.00
1,900.00	8.93	300.026	1,895.20	53.52	-92.60	93.31	2.00	2.00	0.00
2,000.00	10.93	300.026	1,993.69	62.15	-107.54	108.35	2.00	2.00	0.00
2,100.00	12.93	300.026	2,091.53	72.50	-125.44	126.39	2.00	2.00	0.00
2,200.00	14.93	300.026	2,188.58	84.55	-146.28	147.40	2.00	2.00	0.00
2,300.00	16.93	300.026	2,284.73	98.28	-170.05	171.35	2.00	2.00	0.00
2,400.00	18.93	300.026	2,379.87	113.69	-196.71	198.21	2.00	2.00	0.00
2,453.40	20.00	300.026	2,430.22	122.60	-212.12	213.74	2.00	2.00	0.00
2,500.00	20.00	300.026	2,474.01	130.57	-225.92	227.64	0.00	0.00	0.00
2,600.00	20.00	300.026	2,567.97	147.69	-255.53	257.48	0.00	0.00	0.00
2,700.00	20.00	300.026	2,661.94	164.80	-285.15	287.32	0.00	0.00	0.00
2,800.00	20.00	300.026	2,755.91	181.92	-314.76	317.16	0.00	0.00	0.00
2,900.00	20.00	300.026	2,849.88	199.03	-344.38	347.00	0.00	0.00	0.00
3,000.00	20.00	300.026	2,943.85	216.15	-373.99	376.84	0.00	0.00	0.00
3,100.00	20.00	300.026	3,037.81	233.27	-403.61	406.68	0.00	0.00	0.00
3,200.00	20.00	300.026	3,131.78	250.38	-433.22	436.52	0.00	0.00	0.00
3,300.00	20.00	300.026	3,225.75	267.50	-462.84	466.36	0.00	0.00	0.00
3,311.93	20.00	300.026	3,236.96	269.54	-466.37	469.92	0.00	0.00	0.00
3,400.00	18.68	300.026	3,320.06	284.14	-491.62	495.37	1.50	-1.50	0.00
3,500.00	17.18	300.026	3,415.20	299.54	-518.28	522.23	1.50	-1.50	0.00
3,600.00	15.68	300.026	3,511.11	313.69	-542.77	546.90	1.50	-1.50	0.00
3,700.00	14.18	300.026	3,607.73	326.59	-565.07	569.38	1.50	-1.50	0.00
3,800.00	12.68	300.026	3,705.00	338.21	-585.18	589.64	1.50	-1.50	0.00
3,900.00	11.18	300.026	3,802.83	348.55	-603.08	607.68	1.50	-1.50	0.00
4,000.00	9.68	300.026	3,901.18	357.61	-618.76	623.47	1.50	-1.50	0.00
4,100.00	8.18	300.026	3,999.96	365.38	-632.20	637.01	1.50	-1.50	0.00
4,200.00	6.68	300.026	4,099.12	371.85	-643.39	648.29	1.50	-1.50	0.00
4,300.00	5.18	300.026	4,198.58	377.02	-652.34	657.31	1.50	-1.50	0.00
4,400.00	3.68	300.026	4,298.28	380.89	-659.03	664.05	1.50	-1.50	0.00
4,500.00	2.18	300.026	4,398.15	383.45	-663.45	668.51	1.50	-1.50	0.00
4,600.00	0.68	300.026	4,498.11	384.70	-665.62	670.69	1.50	-1.50	0.00
4,645.39	0.00	0.000	4,543.50	384.83	-665.85	670.92	1.50	-1.50	0.00
4,700.00	0.00	0.000	4,598.11	384.83	-665.85	670.92	0.00	0.00	0.00
4,800.00	0.00	0.000	4,698.11	384.83	-665.85	670.92	0.00	0.00	0.00
4,900.00	0.00	0.000	4,798.11	384.83	-665.85	670.92	0.00	0.00	0.00

<b>Database:</b>	Casper District	<b>Local Co-ordinate Reference:</b>	Well Wetco 4-63-5-4033CB
<b>Company:</b>	HighPoint Resources	<b>TVD Reference:</b>	GL 4629' & KB 20 @ 4649.00ft
<b>Project:</b>	Weld County, CO NAD 83	<b>MD Reference:</b>	GL 4629' & KB 20 @ 4649.00ft
<b>Site:</b>	Wetco 4-63 4 SW Pad	<b>North Reference:</b>	True
<b>Well:</b>	Wetco 4-63-5-4033CB	<b>Survey Calculation Method:</b>	Minimum Curvature
<b>Wellbore:</b>	OH		
<b>Design:</b>	Plan 1		

Planned Survey									
Measured Depth (ft)	Inclination (°)	Azimuth (°)	Vertical Depth (ft)	+N/-S (ft)	+E/-W (ft)	Vertical Section (ft)	Dogleg Rate (°/100ft)	Build Rate (°/100ft)	Turn Rate (°/100ft)
5,000.00	0.00	0.000	4,898.11	384.83	-665.85	670.92	0.00	0.00	0.00
5,100.00	0.00	0.000	4,998.11	384.83	-665.85	670.92	0.00	0.00	0.00
5,200.00	0.00	0.000	5,098.11	384.83	-665.85	670.92	0.00	0.00	0.00
5,300.00	0.00	0.000	5,198.11	384.83	-665.85	670.92	0.00	0.00	0.00
5,400.00	0.00	0.000	5,298.11	384.83	-665.85	670.92	0.00	0.00	0.00
5,500.00	0.00	0.000	5,398.11	384.83	-665.85	670.92	0.00	0.00	0.00
5,600.00	0.00	0.000	5,498.11	384.83	-665.85	670.92	0.00	0.00	0.00
5,700.00	0.00	0.000	5,598.11	384.83	-665.85	670.92	0.00	0.00	0.00
5,800.00	0.00	0.000	5,698.11	384.83	-665.85	670.92	0.00	0.00	0.00
5,900.00	0.00	0.000	5,798.11	384.83	-665.85	670.92	0.00	0.00	0.00
6,000.00	0.00	0.000	5,898.11	384.83	-665.85	670.92	0.00	0.00	0.00
6,007.97	0.00	0.000	5,906.08	384.83	-665.85	670.92	0.00	0.00	0.00
6,100.00	9.20	270.764	5,997.72	384.93	-673.22	678.30	10.00	10.00	0.00
6,200.00	19.20	270.764	6,094.54	385.26	-697.73	702.80	10.00	10.00	0.00
6,300.00	29.20	270.764	6,185.63	385.80	-738.67	743.75	10.00	10.00	0.00
6,400.00	39.20	270.764	6,268.23	386.55	-794.81	799.89	10.00	10.00	0.00
6,500.00	49.20	270.764	6,339.83	387.48	-864.43	869.52	10.00	10.00	0.00
6,600.00	59.20	270.764	6,398.24	388.56	-945.43	950.53	10.00	10.00	0.00
6,700.00	69.20	270.764	6,441.71	389.76	-1,035.34	1,040.45	10.00	10.00	0.00
6,800.00	79.20	270.764	6,468.90	391.04	-1,131.44	1,136.55	10.00	10.00	0.00
6,900.00	89.20	270.764	6,478.98	392.36	-1,230.79	1,235.91	10.00	10.00	0.00
6,901.03	89.31	270.764	6,479.00	392.38	-1,231.81	1,236.94	10.00	10.00	0.00
7,000.00	89.31	270.764	6,480.20	393.70	-1,330.77	1,335.90	0.00	0.00	0.00
7,100.00	89.31	270.764	6,481.41	395.03	-1,430.76	1,435.90	0.00	0.00	0.00
7,200.00	89.31	270.764	6,482.62	396.36	-1,530.74	1,535.89	0.00	0.00	0.00
7,300.00	89.31	270.764	6,483.83	397.70	-1,630.72	1,635.88	0.00	0.00	0.00
7,400.00	89.31	270.764	6,485.04	399.03	-1,730.71	1,735.87	0.00	0.00	0.00
7,500.00	89.31	270.764	6,486.25	400.36	-1,830.69	1,835.87	0.00	0.00	0.00
7,600.00	89.31	270.764	6,487.47	401.70	-1,930.68	1,935.86	0.00	0.00	0.00
7,700.00	89.31	270.764	6,488.68	403.03	-2,030.66	2,035.85	0.00	0.00	0.00
7,800.00	89.31	270.764	6,489.89	404.36	-2,130.64	2,135.85	0.00	0.00	0.00
7,900.00	89.31	270.764	6,491.10	405.70	-2,230.63	2,235.84	0.00	0.00	0.00
8,000.00	89.31	270.764	6,492.31	407.03	-2,330.61	2,335.83	0.00	0.00	0.00
8,100.00	89.31	270.764	6,493.52	408.36	-2,430.59	2,435.82	0.00	0.00	0.00
8,200.00	89.31	270.764	6,494.74	409.69	-2,530.58	2,535.82	0.00	0.00	0.00
8,300.00	89.31	270.764	6,495.95	411.03	-2,630.56	2,635.81	0.00	0.00	0.00
8,400.00	89.31	270.764	6,497.16	412.36	-2,730.55	2,735.80	0.00	0.00	0.00
8,500.00	89.31	270.764	6,498.37	413.69	-2,830.53	2,835.79	0.00	0.00	0.00
8,600.00	89.31	270.764	6,499.58	415.03	-2,930.51	2,935.79	0.00	0.00	0.00
8,700.00	89.31	270.764	6,500.80	416.36	-3,030.50	3,035.78	0.00	0.00	0.00
8,800.00	89.31	270.764	6,502.01	417.69	-3,130.48	3,135.77	0.00	0.00	0.00
8,900.00	89.31	270.764	6,503.22	419.03	-3,230.46	3,235.76	0.00	0.00	0.00
9,000.00	89.31	270.764	6,504.43	420.36	-3,330.45	3,335.76	0.00	0.00	0.00
9,100.00	89.31	270.764	6,505.64	421.69	-3,430.43	3,435.75	0.00	0.00	0.00
9,200.00	89.31	270.764	6,506.85	423.03	-3,530.42	3,535.74	0.00	0.00	0.00
9,300.00	89.31	270.764	6,508.07	424.36	-3,630.40	3,635.74	0.00	0.00	0.00
9,400.00	89.31	270.764	6,509.28	425.69	-3,730.38	3,735.73	0.00	0.00	0.00
9,500.00	89.31	270.764	6,510.49	427.03	-3,830.37	3,835.72	0.00	0.00	0.00
9,600.00	89.31	270.764	6,511.70	428.36	-3,930.35	3,935.71	0.00	0.00	0.00
9,700.00	89.31	270.764	6,512.91	429.69	-4,030.33	4,035.71	0.00	0.00	0.00
9,800.00	89.31	270.764	6,514.13	431.03	-4,130.32	4,135.70	0.00	0.00	0.00
9,900.00	89.31	270.764	6,515.34	432.36	-4,230.30	4,235.69	0.00	0.00	0.00
10,000.00	89.31	270.764	6,516.55	433.69	-4,330.29	4,335.68	0.00	0.00	0.00
10,100.00	89.31	270.764	6,517.76	435.03	-4,430.27	4,435.68	0.00	0.00	0.00

<b>Database:</b>	Casper District	<b>Local Co-ordinate Reference:</b>	Well Wetco 4-63-5-4033CB
<b>Company:</b>	HighPoint Resources	<b>TVD Reference:</b>	GL 4629' & KB 20 @ 4649.00ft
<b>Project:</b>	Weld County, CO NAD 83	<b>MD Reference:</b>	GL 4629' & KB 20 @ 4649.00ft
<b>Site:</b>	Wetco 4-63 4 SW Pad	<b>North Reference:</b>	True
<b>Well:</b>	Wetco 4-63-5-4033CB	<b>Survey Calculation Method:</b>	Minimum Curvature
<b>Wellbore:</b>	OH		
<b>Design:</b>	Plan 1		

Planned Survey									
Measured Depth (ft)	Inclination (°)	Azimuth (°)	Vertical Depth (ft)	+N/-S (ft)	+E/-W (ft)	Vertical Section (ft)	Dogleg Rate (°/100ft)	Build Rate (°/100ft)	Turn Rate (°/100ft)
10,200.00	89.31	270.764	6,518.97	436.36	-4,530.25	4,535.67	0.00	0.00	0.00
10,300.00	89.31	270.764	6,520.18	437.69	-4,630.24	4,635.66	0.00	0.00	0.00
10,400.00	89.31	270.764	6,521.40	439.03	-4,730.22	4,735.65	0.00	0.00	0.00
10,500.00	89.31	270.764	6,522.61	440.36	-4,830.20	4,835.65	0.00	0.00	0.00
10,600.00	89.31	270.764	6,523.82	441.69	-4,930.19	4,935.64	0.00	0.00	0.00
10,700.00	89.31	270.764	6,525.03	443.02	-5,030.17	5,035.63	0.00	0.00	0.00
10,800.00	89.31	270.764	6,526.24	444.36	-5,130.16	5,135.63	0.00	0.00	0.00
10,900.00	89.31	270.764	6,527.45	445.69	-5,230.14	5,235.62	0.00	0.00	0.00
11,000.00	89.31	270.764	6,528.67	447.02	-5,330.12	5,335.61	0.00	0.00	0.00
11,100.00	89.31	270.764	6,529.88	448.36	-5,430.11	5,435.60	0.00	0.00	0.00
11,200.00	89.31	270.764	6,531.09	449.69	-5,530.09	5,535.60	0.00	0.00	0.00
11,300.00	89.31	270.764	6,532.30	451.02	-5,630.08	5,635.59	0.00	0.00	0.00
11,400.00	89.31	270.764	6,533.51	452.36	-5,730.06	5,735.58	0.00	0.00	0.00
11,500.00	89.31	270.764	6,534.73	453.69	-5,830.04	5,835.57	0.00	0.00	0.00
11,600.00	89.31	270.764	6,535.94	455.02	-5,930.03	5,935.57	0.00	0.00	0.00
11,700.00	89.31	270.764	6,537.15	456.36	-6,030.01	6,035.56	0.00	0.00	0.00
11,800.00	89.31	270.764	6,538.36	457.69	-6,129.99	6,135.55	0.00	0.00	0.00
11,900.00	89.31	270.764	6,539.57	459.02	-6,229.98	6,235.54	0.00	0.00	0.00
12,000.00	89.31	270.764	6,540.78	460.36	-6,329.96	6,335.54	0.00	0.00	0.00
12,100.00	89.31	270.764	6,542.00	461.69	-6,429.95	6,435.53	0.00	0.00	0.00
12,200.00	89.31	270.764	6,543.21	463.02	-6,529.93	6,535.52	0.00	0.00	0.00
12,300.00	89.31	270.764	6,544.42	464.36	-6,629.91	6,635.52	0.00	0.00	0.00
12,400.00	89.31	270.764	6,545.63	465.69	-6,729.90	6,735.51	0.00	0.00	0.00
12,500.00	89.31	270.764	6,546.84	467.02	-6,829.88	6,835.50	0.00	0.00	0.00
12,600.00	89.31	270.764	6,548.05	468.36	-6,929.86	6,935.49	0.00	0.00	0.00
12,700.00	89.31	270.764	6,549.27	469.69	-7,029.85	7,035.49	0.00	0.00	0.00
12,800.00	89.31	270.764	6,550.48	471.02	-7,129.83	7,135.48	0.00	0.00	0.00
12,900.00	89.31	270.764	6,551.69	472.36	-7,229.82	7,235.47	0.00	0.00	0.00
13,000.00	89.31	270.764	6,552.90	473.69	-7,329.80	7,335.46	0.00	0.00	0.00
13,100.00	89.31	270.764	6,554.11	475.02	-7,429.78	7,435.46	0.00	0.00	0.00
13,200.00	89.31	270.764	6,555.33	476.35	-7,529.77	7,535.45	0.00	0.00	0.00
13,300.00	89.31	270.764	6,556.54	477.69	-7,629.75	7,635.44	0.00	0.00	0.00
13,400.00	89.31	270.764	6,557.75	479.02	-7,729.73	7,735.43	0.00	0.00	0.00
13,500.00	89.31	270.764	6,558.96	480.35	-7,829.72	7,835.43	0.00	0.00	0.00
13,600.00	89.31	270.764	6,560.17	481.69	-7,929.70	7,935.42	0.00	0.00	0.00
13,700.00	89.31	270.764	6,561.38	483.02	-8,029.69	8,035.41	0.00	0.00	0.00
13,800.00	89.31	270.764	6,562.60	484.35	-8,129.67	8,135.40	0.00	0.00	0.00
13,900.00	89.31	270.764	6,563.81	485.69	-8,229.65	8,235.40	0.00	0.00	0.00
14,000.00	89.31	270.764	6,565.02	487.02	-8,329.64	8,335.39	0.00	0.00	0.00
14,100.00	89.31	270.764	6,566.23	488.35	-8,429.62	8,435.38	0.00	0.00	0.00
14,200.00	89.31	270.764	6,567.44	489.69	-8,529.60	8,535.38	0.00	0.00	0.00
14,300.00	89.31	270.764	6,568.66	491.02	-8,629.59	8,635.37	0.00	0.00	0.00
14,400.00	89.31	270.764	6,569.87	492.35	-8,729.57	8,735.36	0.00	0.00	0.00
14,500.00	89.31	270.764	6,571.08	493.69	-8,829.56	8,835.35	0.00	0.00	0.00
14,600.00	89.31	270.764	6,572.29	495.02	-8,929.54	8,935.35	0.00	0.00	0.00
14,700.00	89.31	270.764	6,573.50	496.35	-9,029.52	9,035.34	0.00	0.00	0.00
14,800.00	89.31	270.764	6,574.71	497.69	-9,129.51	9,135.33	0.00	0.00	0.00
14,900.00	89.31	270.764	6,575.93	499.02	-9,229.49	9,235.32	0.00	0.00	0.00
15,000.00	89.31	270.764	6,577.14	500.35	-9,329.47	9,335.32	0.00	0.00	0.00
15,100.00	89.31	270.764	6,578.35	501.69	-9,429.46	9,435.31	0.00	0.00	0.00
15,200.00	89.31	270.764	6,579.56	503.02	-9,529.44	9,535.30	0.00	0.00	0.00
15,300.00	89.31	270.764	6,580.77	504.35	-9,629.43	9,635.29	0.00	0.00	0.00
15,400.00	89.31	270.764	6,581.98	505.69	-9,729.41	9,735.29	0.00	0.00	0.00
15,500.00	89.31	270.764	6,583.20	507.02	-9,829.39	9,835.28	0.00	0.00	0.00

<b>Database:</b>	Casper District	<b>Local Co-ordinate Reference:</b>	Well Wetco 4-63-5-4033CB
<b>Company:</b>	HighPoint Resources	<b>TVD Reference:</b>	GL 4629' & KB 20 @ 4649.00ft
<b>Project:</b>	Weld County, CO NAD 83	<b>MD Reference:</b>	GL 4629' & KB 20 @ 4649.00ft
<b>Site:</b>	Wetco 4-63 4 SW Pad	<b>North Reference:</b>	True
<b>Well:</b>	Wetco 4-63-5-4033CB	<b>Survey Calculation Method:</b>	Minimum Curvature
<b>Wellbore:</b>	OH		
<b>Design:</b>	Plan 1		

Planned Survey									
Measured Depth (ft)	Inclination (°)	Azimuth (°)	Vertical Depth (ft)	+N/-S (ft)	+E/-W (ft)	Vertical Section (ft)	Dogleg Rate (°/100ft)	Build Rate (°/100ft)	Turn Rate (°/100ft)
15,600.00	89.31	270.764	6,584.41	508.35	-9,929.38	9,935.27	0.00	0.00	0.00
15,700.00	89.31	270.764	6,585.62	509.69	-10,029.36	10,035.27	0.00	0.00	0.00
15,800.00	89.31	270.764	6,586.83	511.02	-10,129.34	10,135.26	0.00	0.00	0.00
15,900.00	89.31	270.764	6,588.04	512.35	-10,229.33	10,235.25	0.00	0.00	0.00
16,000.00	89.31	270.764	6,589.26	513.68	-10,329.31	10,335.24	0.00	0.00	0.00
16,100.00	89.31	270.764	6,590.47	515.02	-10,429.30	10,435.24	0.00	0.00	0.00
16,200.00	89.31	270.764	6,591.68	516.35	-10,529.28	10,535.23	0.00	0.00	0.00
16,300.00	89.31	270.764	6,592.89	517.68	-10,629.26	10,635.22	0.00	0.00	0.00
16,391.55	89.31	270.764	6,594.00	518.90	-10,720.79	10,726.76	0.00	0.00	0.00

Design Targets									
Target Name	Dip Angle (°)	Dip Dir. (°)	TVD (ft)	+N/-S (ft)	+E/-W (ft)	Northing (usft)	Easting (usft)	Latitude	Longitude
Wetco 4-63-5-4033CB L - hit/miss target - Shape - Point	0.00	0.000	6,479.00	392.39	-1,231.81	1,368,794.78	3,291,544.54	40° 20' 27.683 N	104° 27' 14.710 W
Wetco 4-63-5-4033CB P - plan misses target center by 0.01ft at 6901.02ft MD (6479.00 TVD, 392.38 N, -1231.81 E) - Point	0.00	0.000	6,594.00	518.90	-10,720.79	1,368,808.90	3,282,054.74	40° 20' 28.910 N	104° 29' 17.257 W