



# FRANE SURVEYING INC.

Physical Address: 34834 Annie Cir.  
Mail to: Box 2372, Elizabeth, CO 80107  
Ph. 303-243-0037  
www.franesurveying.com  
Job # 17-011-Red Poll 8-21

Frane Surveying, in accordance with a request from **Murfin Drilling Co.** has determined the location of **Red Poll #8-21** to be **1900 feet FNL**, and **605 feet FEL**, (90° off Section lines) of SECTION **21**, Township **10s**, Range **56w** of the 6th Principal Meridian, **Lincoln County**, Colorado.

Date: Staked on 09/05/18 drawn on 09/11/18.

Re: Staked by Elijah Frane  
Drawn: Drawn by Elijah Frane

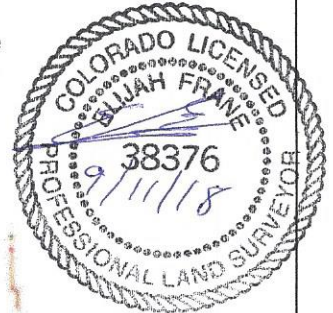

## Location Drawing

A barbed wire fence exists approx. 471' East of the proposed well pad.

Murfin Drilling Co.  
NE 1/4 SEC. 21-10S-56W  
Red Poll #8-21  
LINCOLN, Co. COLORADO

