



123-28692



# KERR MCGEE RECEIVED

**BAKER HUGHES**  
INTEQ

Location: COLORADO  
 Field: WELD COUNTY (KERR MCGEE)  
 Facility: SEC.27-T3N-R68W  
 Slot: Slot #12 Waterfront 37-27 605'FSL & 560'FEL  
 Well: Waterfront 37-27  
 Wellbore: Waterfront 37-27 PWB

OCT 27 2008

COGCC

Plot reference wellpath is Waterfront 37-27 PWP Rev. A-2	
True vertical depths are referenced to Xtreme 11 (RT)	Grid System: NAD83 / Lambert Colorado State Planes, Northern Zone (501), US feet
Measured depths are referenced to Xtreme 11 (RT)	North Reference: True north
Xtreme 11 (RT) to Mean Sea Level: 4970 feet	Scale: True distance
Mean Sea Level to Mud line (Facility: SEC.27-T3N-R68W): 0 feet	Depths are in feet
Coordinates are in feet referenced to Slot	Created by: buscnat on 6/19/2008

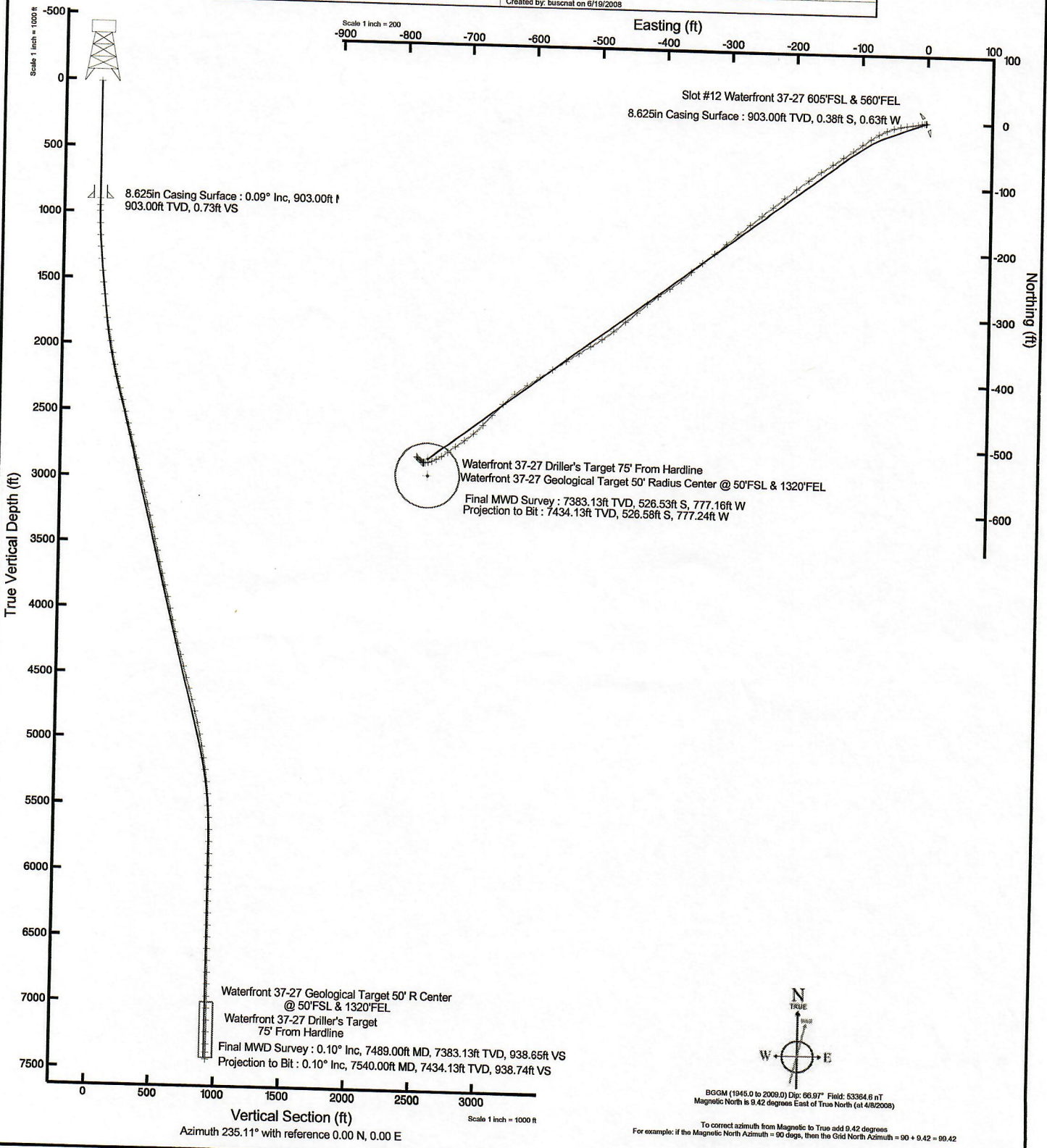



# Actual Wellpath Report

Waterfront 37-27 AWP  
Page 1 of 4

  
**RECEIVED**  
 OCT 27 2008  
**COGCC**  
**INTEQ**



## REFERENCE WELLPATH IDENTIFICATION

Operator	KERR MCGEE	Slot	Slot #12 Waterfront 37-27 605'FSL & 560'FEL
Area	COLORADO	Well	Waterfront 37-27
Field	WELD COUNTY (KERR MCGEE)	Wellbore	Waterfront 37-27 AWB
Facility	SEC.27-T3N-R68W		

## REPORT SETUP INFORMATION

Projection System	NAD83 / Lambert Colorado State Planes, Northern Zone (501), US feet	Software System	WellArchitect® 2.0
North Reference	True	User	Buscnat
Scale	0.999957	Report Generated	6/19/2008 at 2:37:17 PM
Convergence at slot	0.33° East	Database/Source file	WellArchitect_Denver/Waterfront_37-27_AWB.xml

## WELLPATH LOCATION

	Local coordinates		Grid coordinates		Geographic coordinates	
	North[ft]	East[ft]	Easting[USft]	Northing[USft]	Latitude	Longitude
Slot Location	-538.88	3760.45	3144806.54	1312974.64	40°11'28.860"N	104°58'53.976"W
Facility Reference Pt			3141043.24	1313492.07	40°11'34.188"N	104°59'42.432"W
Field Reference Pt			3197771.84	1268891.29	40°04'09.600"N	104°47'36.000"W

## WELLPATH DATUM

Calculation method	Minimum curvature	Xtreme 11 (RT) to Facility Vertical Datum	4970.00ft
Horizontal Reference Pt	Slot	Xtreme 11 (RT) to Mean Sea Level	4970.00ft
Vertical Reference Pt	Xtreme 11 (RT)	Facility Vertical Datum to Mud Line (Facility)	0.00ft
MD Reference Pt	Xtreme 11 (RT)	Section Origin	N 0.00, E 0.00 ft
Field Vertical Reference	Mean Sea Level	Section Azimuth	235.11°



# Actual Wellpath Report

Waterfront 37-27 AWP

Page 2 of 4

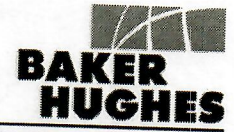

INTEQ

## REFERENCE WELLPATH IDENTIFICATION

Operator	KERR MCGEE	Slot	Slot #12 Waterfront 37-27 605'FSL & 560'FEL
Area	COLORADO	Well	Waterfront 37-27
Field	WELD COUNTY (KERR MCGEE)	Wellbore	Waterfront 37-27 AWB
Facility	SEC.27-T3N-R68W		

## WELLPATH DATA (77 stations) † = interpolated/extrapolated station

MD [ft]	Inclination [°]	Azimuth [°]	TVD [ft]	Vert Sect [ft]	North [ft]	East [ft]	DLS [°/100ft]
0.00†	0.000	238.600	0.00	0.00	0.00	0.00	0.00
15.00	0.000	238.600	15.00	0.00	0.00	0.00	0.00
954.00	0.100	238.600	954.00	0.82	-0.43	-0.70	0.01
999.00	0.500	305.800	999.00	0.92	-0.33	-0.89	1.05
1090.00	2.200	272.700	1089.97	2.44	-0.02	-2.96	1.98
1181.00	3.400	252.400	1180.86	6.40	-0.75	-7.28	1.69
1271.00	4.700	260.100	1270.64	12.29	-2.19	-13.45	1.56
1362.00	5.600	264.300	1361.27	19.54	-3.27	-21.54	1.07
1452.00	5.800	258.000	1450.82	27.57	-4.66	-30.36	0.73
1543.00	6.500	260.100	1541.30	36.47	-6.50	-39.93	0.81
1633.00	6.900	253.100	1630.69	46.23	-8.95	-50.12	1.01
1724.00	7.800	248.100	1720.94	57.45	-12.84	-61.08	1.21
1814.00	8.900	241.100	1809.99	70.32	-18.48	-72.85	1.66
1905.00	9.400	233.700	1899.83	84.75	-26.28	-85.00	1.40
1995.00	10.300	236.500	1988.50	100.15	-35.07	-97.63	1.13
2085.00	11.600	232.700	2076.87	117.23	-45.00	-111.54	1.65
2176.00	11.700	235.100	2165.99	135.60	-55.82	-126.39	0.54
2267.00	13.000	238.600	2254.88	155.04	-66.44	-142.69	1.65
2357.00	14.300	237.600	2342.34	176.25	-77.67	-160.72	1.47
2448.00	14.800	233.400	2430.42	199.10	-90.62	-179.54	1.28
2538.00	15.200	232.000	2517.36	222.37	-104.74	-198.06	0.60
2629.00	14.600	230.600	2605.30	245.72	-119.36	-216.33	0.77
2720.00	14.000	232.000	2693.48	268.14	-133.42	-233.86	0.76
2810.00	14.100	230.600	2780.79	289.94	-147.08	-250.91	0.39
2901.00	14.400	233.700	2868.99	312.30	-160.81	-268.60	0.90
2991.00	15.600	229.500	2955.92	335.53	-175.30	-286.82	1.80
3082.00	15.100	228.800	3043.68	359.49	-191.05	-305.04	0.59
3172.00	15.000	230.900	3130.59	382.76	-206.12	-322.90	0.62
3263.00	14.800	232.000	3218.53	406.11	-220.70	-341.20	0.38
3354.00	12.800	228.100	3306.90	427.72	-234.59	-357.86	2.42
3444.00	13.400	230.900	3394.56	448.02	-247.83	-373.38	0.97
3535.00	14.500	236.200	3482.88	469.93	-260.81	-391.03	1.85
3625.00	13.300	235.800	3570.24	491.55	-272.90	-408.95	1.34
3716.00	12.600	230.900	3658.93	511.91	-285.05	-425.31	1.43
3806.00	14.300	228.400	3746.46	532.74	-298.62	-441.25	2.00
3897.00	15.000	230.200	3834.50	555.64	-313.62	-458.70	0.92
3987.00	14.800	231.600	3921.47	578.72	-328.21	-476.65	0.46
4078.00	13.100	236.200	4009.79	600.63	-341.17	-494.33	2.23
4168.00	12.900	238.600	4097.48	620.85	-352.08	-511.39	0.64
4259.00	13.500	236.200	4186.08	641.61	-363.28	-528.88	0.89
4349.00	15.900	237.600	4273.13	664.44	-375.73	-548.02	2.70
4440.00	15.600	237.900	4360.71	689.11	-388.91	-568.91	0.34
4530.00	14.500	236.800	4447.62	712.46	-401.51	-588.59	1.26
4621.00	15.000	236.200	4535.62	735.62	-414.30	-607.91	0.57
4711.00	14.900	231.300	4622.58	758.81	-428.02	-626.62	1.41



# Actual Wellpath Report

Waterfront 37-27 AWP

Page 3 of 4



INTEQ

## REFERENCE WELLPATH IDENTIFICATION

Operator	KERR MCGEE	Slot	Slot #12 Waterfront 37-27 605'FSL & 560'FEL
Area	COLORADO	Well	Waterfront 37-27
Field	WELD COUNTY (KERR MCGEE)	Wellbore	Waterfront 37-27 AWB
Facility	SEC.27-T3N-R68W		

## WELLPATH DATA (77 stations)

MD [ft]	Inclination [°]	Azimuth [°]	TVD [ft]	Vert Sect [ft]	North [ft]	East [ft]	DLS [°/100ft]
4801.00	15.800	225.300	4709.37	782.44	-443.87	-644.36	2.03
4891.00	14.500	223.500	4796.24	805.55	-460.66	-660.83	1.54
4982.00	12.400	222.100	4884.74	826.23	-476.18	-675.22	2.34
5073.00	12.000	231.300	4973.70	845.19	-489.34	-689.16	2.18
5163.00	10.600	234.400	5061.95	862.80	-500.01	-703.19	1.70
5254.00	10.600	232.700	5151.40	879.53	-509.96	-716.65	0.34
5344.00	8.300	234.400	5240.17	894.30	-518.76	-728.52	2.57
5435.00	6.600	237.600	5330.40	906.09	-525.38	-738.28	1.92
5525.00	5.000	241.500	5419.94	915.16	-530.03	-746.09	1.83
5616.00	4.400	248.500	5510.63	922.50	-533.20	-752.83	0.91
5706.00	3.500	261.500	5600.42	928.32	-534.87	-758.76	1.40
5797.00	2.200	264.000	5691.30	932.33	-535.46	-763.24	1.43
5888.00	0.900	285.400	5782.27	934.32	-535.45	-765.67	1.54
5978.00	0.900	289.300	5872.26	935.19	-535.03	-767.01	0.07
6069.00	0.700	114.200	5963.25	935.32	-535.02	-767.18	1.76
6159.00	0.500	118.100	6053.25	934.86	-535.44	-766.33	0.23
6250.00	0.100	181.700	6144.25	934.72	-535.70	-765.99	0.51
6340.00	0.300	288.200	6234.25	934.91	-535.71	-766.21	0.38
6430.00	0.400	288.600	6324.25	935.24	-535.53	-766.73	0.11
6521.00	0.500	282.200	6415.24	935.70	-535.35	-767.42	0.12
6612.00	0.700	295.900	6506.24	936.24	-535.02	-768.31	0.27
6702.00	0.800	314.900	6596.23	936.62	-534.34	-769.25	0.30
6793.00	1.100	318.400	6687.22	936.84	-533.24	-770.28	0.34
6883.00	1.100	308.300	6777.20	937.19	-532.05	-771.53	0.22
6973.00	1.300	302.600	6867.18	937.83	-530.97	-773.07	0.26
7064.00	1.200	318.100	6958.16	938.34	-529.70	-774.58	0.39
7154.00	1.000	316.200	7048.14	938.58	-528.43	-775.75	0.23
7244.00	0.800	314.900	7138.13	938.81	-527.42	-776.74	0.22
→ 7334.00	0.300	335.000	7228.13	938.88	-526.77	-777.28	0.59
7424.00	0.200	78.300	7318.13	938.70	-526.52	-777.23	0.44
✓ 7489.00	0.100	236.200	7383.13	938.65	-526.53	-777.16	0.45
✓ 7540.00	0.100	236.200	✓ 7434.13	938.74	✓ -526.58	✓ -777.24	0.00

## HOLE & CASING SECTIONS Ref Wellbore: Waterfront 37-27 AWB Ref Wellpath: Waterfront 37-27 AWP

String/Diameter	Start MD [ft]	End MD [ft]	Interval [ft]	Start TVD [ft]	End TVD [ft]	Start N/S [ft]	Start E/W [ft]	End N/S [ft]	End E/W [ft]
8.625in Casing Surface	0.00	903.00	903.00	0.00	903.00	0.00	0.00	-0.38	-0.63



# Actual Wellpath Report

Waterfront 37-27 AWP

Page 4 of 4

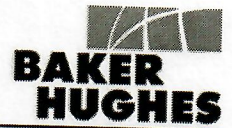

INTEQ

## REFERENCE WELLPATH IDENTIFICATION

Operator	KERR MCGEE	Slot	Slot #12 Waterfront 37-27 605'FSL & 560'FEL
Area	COLORADO	Well	Waterfront 37-27
Field	WELD COUNTY (KERR MCGEE)	Wellbore	Waterfront 37-27 AWB
Facility	SEC.27-T3N-R68W		

## TARGETS

Name	MD [ft]	TVD [ft]	North [ft]	East [ft]	Grid East [srv ft]	Grid North [srv ft]	Latitude	Longitude	Shape
Waterfront 37-27 Driller's Target 75' From Hardline		7002.00	-530.00	-760.00	3144049.68	1312440.23	40°11'23.622"N	104°59'03.769"W	point
Waterfront 37-27 Geological Target 50' Radius Center @ 50'FSL & 1320'FEL		7002.00	-555.00	-760.00	3144049.83	1312415.23	40°11'23.375"N	104°59'03.769"W	circle

## WELLPATH COMPOSITION

Start MD [ft]	End MD [ft]	Positional Uncertainty Model	Log Name/Comment	Wellbore
15.00	7540.00	MTC (Collar, post-2000) (Standard)	bhi mwd (7-7/8)<954-7540	Waterfront 37-27 AWB