

HYDROLOGY MAP: STATE BDB #1

SECTION 36, TOWNSHIP 12 NORTH, RANGE 55 WEST, 6TH P.M.

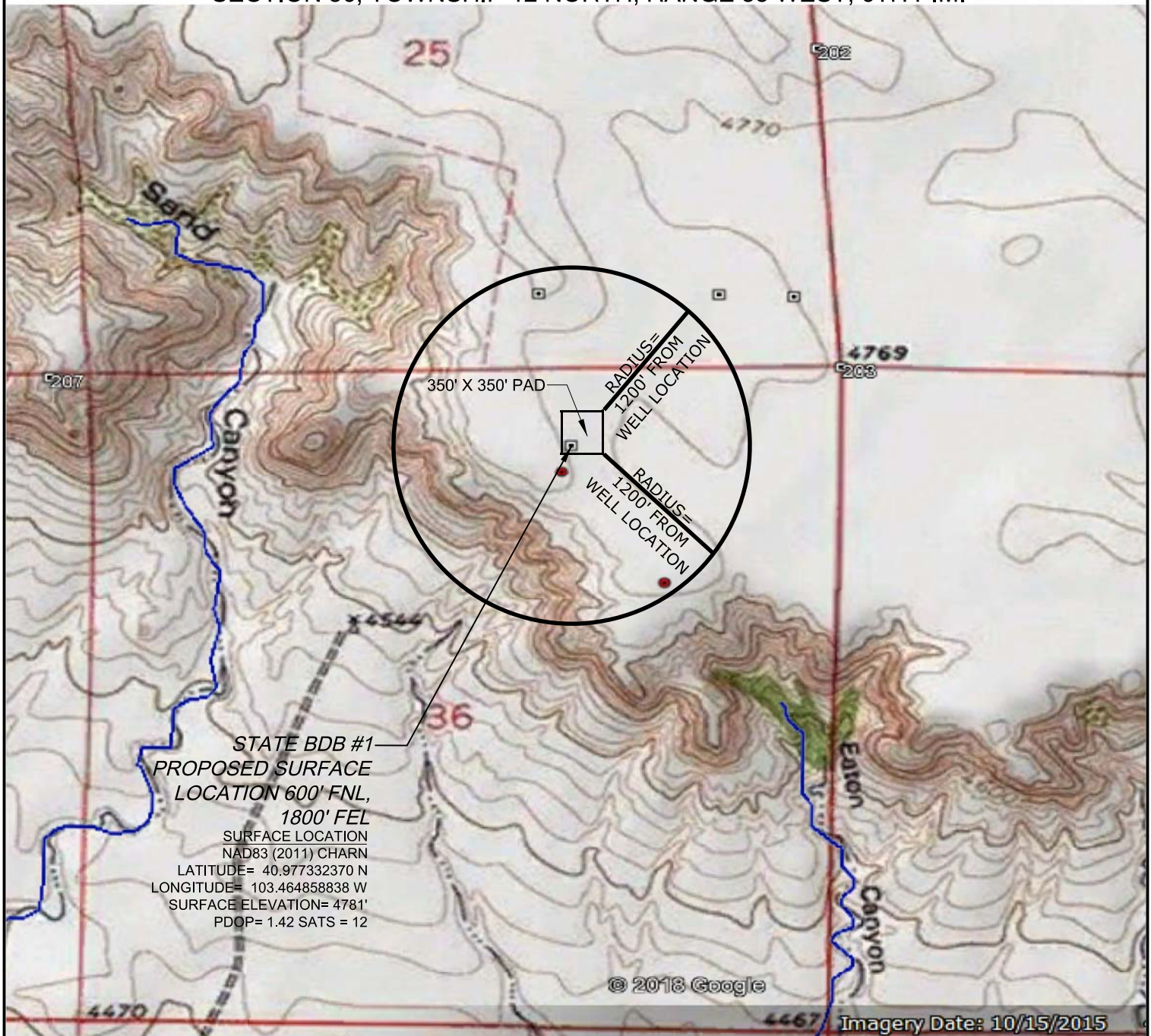

CERTIFICATE FOR HYDROLOGY OF SITE

I, _____, HEREBY CERTIFY THAT THE ABOVE WELL CERTIFICATE & SITE LISTED BELOW WAS REVIEWED FOR APPARENT SURFACE WATER AREAS AND RIPARIAN AREAS WITHIN 1000 FEET OF THE PROPOSED WELL SITE. THIS SITE WAS REVIEWED ON _____, 2018 AND THAT IT CORRECTLY MAP CORRECTLY DEPICTS THE LOCATION OF ALL SURFACE WATER AREAS AND RIPARIAN AREAS. THE SUBJECT WELL SITE IS THE STATE BDB #1 WELL IN SECTION 36, TOWNSHIP 12 NORTH, RANGE 55 WEST OF THE 6TH PRINCIPAL MERIDIAN, IN LOGAN COUNTY, COLORADO.

NAME _____

DATE _____

MAP PREPARED BY:

Wildcat Surveying
307 Church Street,
Harrisburg NE 68345
Phone: 308-279-2072
www.wildcatsurveying.com



FIELD DATE:

07-12-2018

DRAWING DATE:

07-12-2018

BY:

CJG

CHECKED:

CJG

WELL NAME:

STATE BDB #1

OPERATOR:

H&M PETROLEUM CORPORATION

SURFACE LOCATION:

SECTION 36, TOWNSHIP 12 NORTH,
RANGE 55 WEST OF THE 6TH P.M.
LOGAN COUNTY, COLORADO