

LINE TABLE		
LINE	DIRECTION	LENGTH
L1	WEST	127'
L2	NORTH	516'
L3	NORTH	532'
L4	N02°E	539'
L5	N01°E	552'

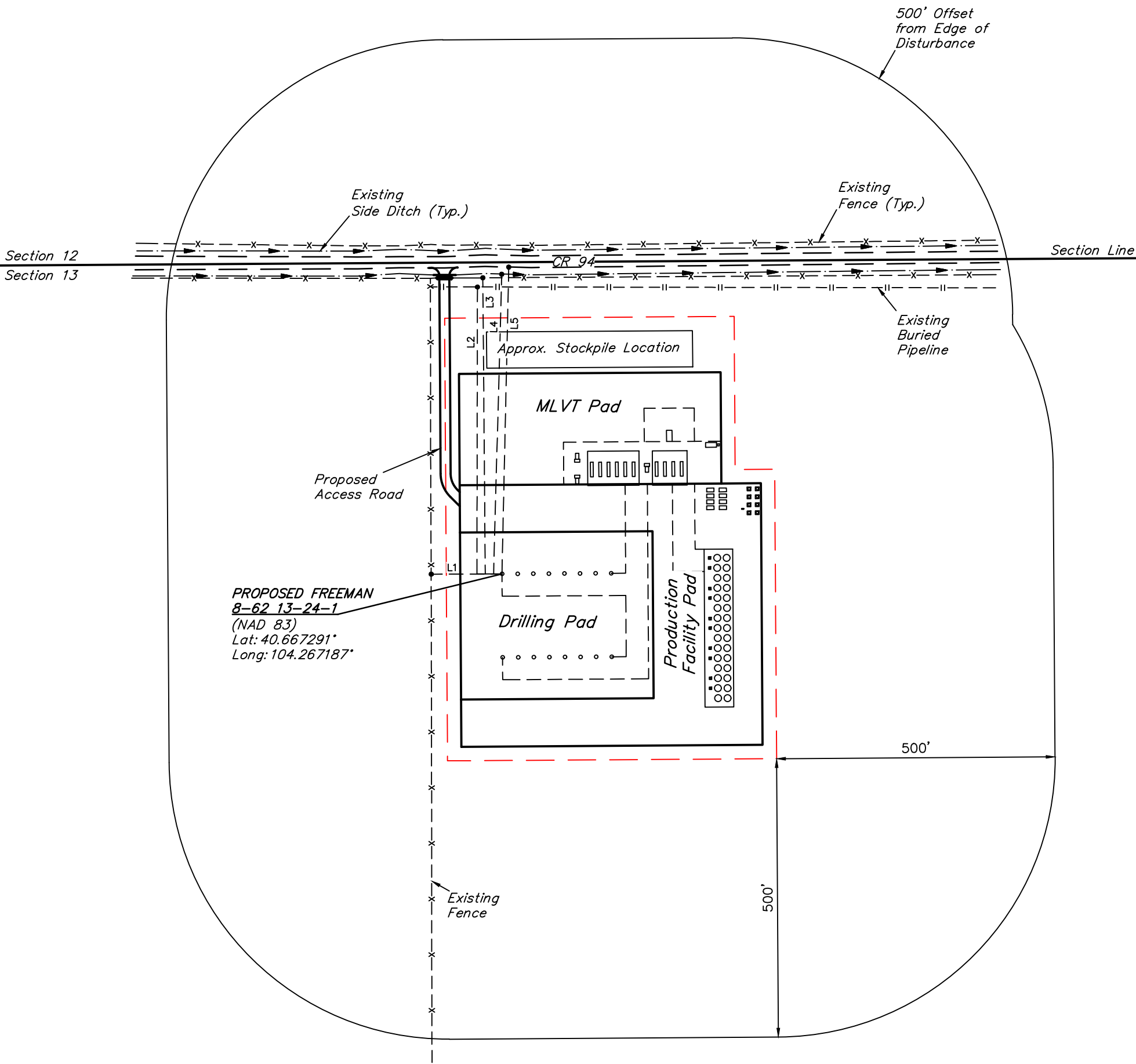

REV: 1 08-29-18 C.IVIE (FUTURE LAND USE CORRECTION)

PLANT COMMUNITY
<input type="checkbox"/> DISTURBED GRASSLAND
<input checked="" type="checkbox"/> NATIVE GRASSLAND
<input type="checkbox"/> SHRUB LAND
<input type="checkbox"/> PLAINS RIPARIAN
<input type="checkbox"/> MOUNTAIN RIPARIAN
<input type="checkbox"/> FOREST LAND
<input type="checkbox"/> WETLANDS AQUATIC
<input type="checkbox"/> ALPINE
<input type="checkbox"/> OTHER (Describe): _____

CURRENT LAND USE					
CROP LAND:	<input type="checkbox"/> IRRIGATED	<input type="checkbox"/> DRY LAND	<input type="checkbox"/> IMPROVED PASTURE	<input type="checkbox"/> HAY MEADOW	<input type="checkbox"/> CRP
NON-CROP LAND:	<input checked="" type="checkbox"/> RANGELAND	<input type="checkbox"/> TIMBER	<input type="checkbox"/> RECREATIONAL	<input type="checkbox"/> OTHER (Describe)	
SUBDIVIDED:	<input type="checkbox"/> INDUSTRIAL	<input type="checkbox"/> COMMERCIAL	<input type="checkbox"/> RESIDENTIAL		

FUTURE LAND USE					
CROP LAND:	<input type="checkbox"/> IRRIGATED	<input type="checkbox"/> DRY LAND	<input type="checkbox"/> IMPROVED PASTURE	<input type="checkbox"/> HAY MEADOW	<input type="checkbox"/> CRP
NON-CROP LAND:	<input checked="" type="checkbox"/> RANGELAND	<input type="checkbox"/> TIMBER	<input type="checkbox"/> RECREATIONAL	<input type="checkbox"/> OTHER (Describe)	
SUBDIVIDED:	<input type="checkbox"/> INDUSTRIAL	<input type="checkbox"/> COMMERCIAL	<input type="checkbox"/> RESIDENTIAL		

BISON OIL & GAS II

FREEMAN 8-62 13 PAD
NW 1/4 NE 1/4, SECTION 13, T8N, R62W, 6th P.M.
WELD COUNTY, COLORADO



UELS, LLC
Corporate Office * 85 South 200 East
Vernal, UT 84078 * (435) 789-1017

SURVEYED BY	JARED CHRISTOPHER, O.R.	08-20-18	SCALE
DRAWN BY	C.IVIE	08-23-18	1" = 200'

LOCATION DRAWING

FIGURE #2