

LEGEND:

 PROPOSED LOCATION



BISON OIL & GAS II

FREEMAN 8-62 13 PAD
NW 1/4 NE 1/4, SECTION 13, T8N, R62W, 6th P.M.
WELD COUNTY, COLORADO



UELS, LLC
Corporate Office * 85 South 200 East
Vernal, UT 84078 * (435) 789-1017

SURVEYED BY	J.C., O.R.	08-20-18	SCALE
DRAWN BY	J.L.G.	08-24-18	1 : 100,000
ACCESS ROAD MAP			TOPO A

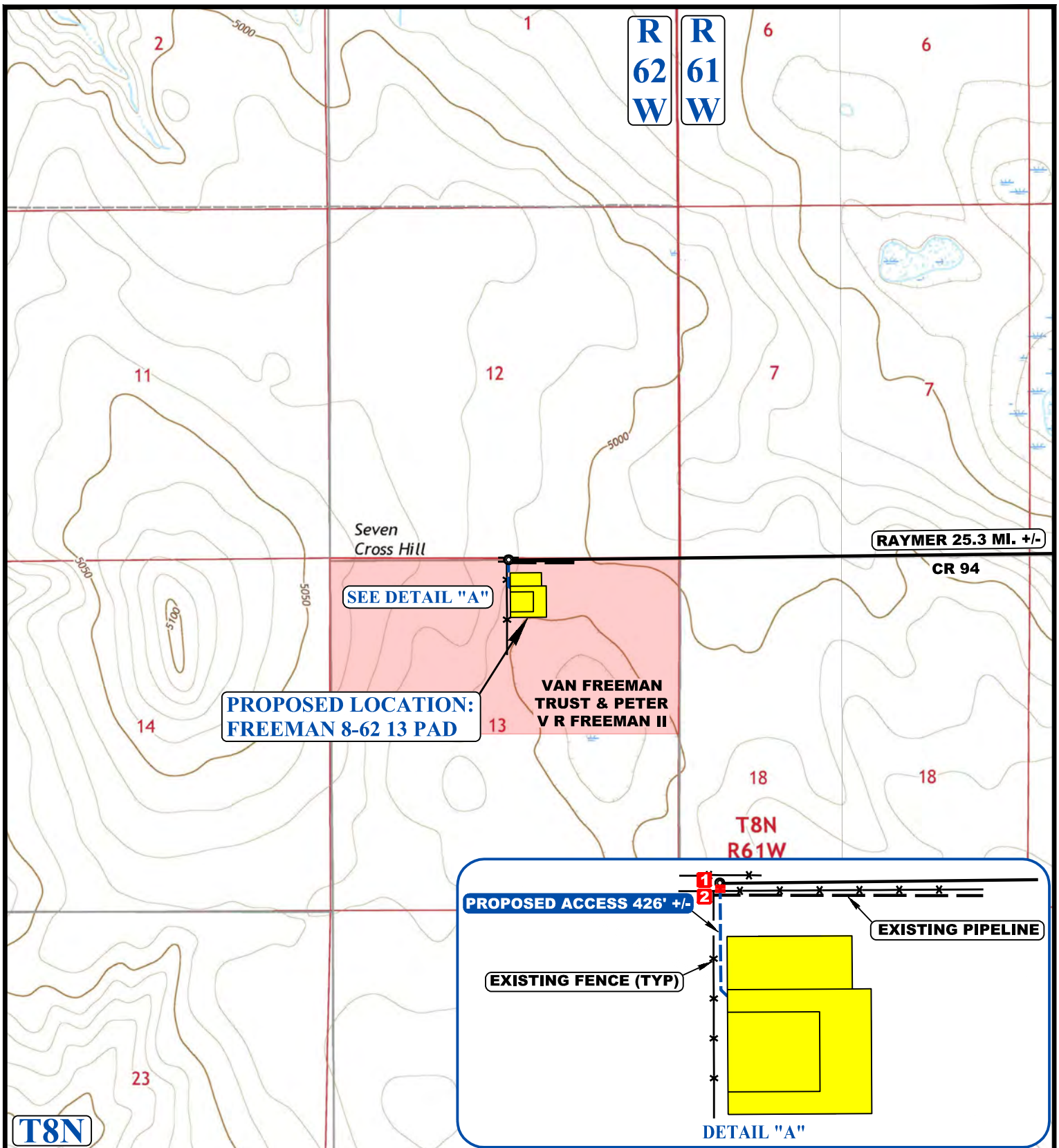

NOTE: PARCEL DATA SHOWN HAS BEEN OBTAINED FROM VARIOUS SOURCES AND SHOULD BE USED FOR MAPPING, GRAPHIC AND PLANNING PURPOSES ONLY. NO WARRANTY IS MADE BY UINTAH ENGINEERING AND LAND SURVEYING (UELS) FOR ACCURACY OF THE PARCEL DATA.

LEGEND:

- EXISTING ROAD
- EXISTING PIPELINE
- PROPOSED ROAD
- EXISTING FENCE
- 1** INSTALL 18" CULVERT
- 2** INSTALL CATTLE GUARD



UELS, LLC
Corporate Office * 85 South 200 East
Vernal, UT 84078 * (435) 789-1017



BISON OIL & GAS II

FREEMAN 8-62 13 PAD
NW 1/4 NE 1/4, SECTION 13, T8N, R62W, 6th P.M.
WELD COUNTY, COLORADO

SURVEYED BY	J.C., O.R.	08-20-18	SCALE
DRAWN BY	J.L.G.	08-24-18	1 : 24,000
ACCESS ROAD MAP			TOPO B