

Location:	COLORADO	Slot:	SLOT#21 GEORGE 25-5HZ(2311'FNL. & 2050'FEL,SEC.25)
Field:	WELD COUNTY (UTM/TRUE NORTH)	Well:	GEORGE 25-5HZ
Facility:	SEC.25-T2N-R65W	Wellbore:	GEORGE 25-5HZ PWB
Plot reference wellpath is GEORGE 25-5HZ PWP Rev-B.0			
True vertical depths are referenced to Xreme 22 (17') (RT)			
Measured depths are referenced to Xreme 22 (17') (RT)			
Xreme 22 (17') (RT) to Mean Sea Level: 4918 feet			
Mean Sea Level to Midline (At Slot: SLOT#21 GEORGE 25-5HZ(2311'FNL. & 2050'FEL,SEC.25): 0 feet			
Coordinates are in feet referenced to Slot			
Grid System: NAD83 / UTM Zone 13 North, US feet		" = Wellpath was transformed from a different geoidic datum	
North Reference: True north		Scale: True distance	
Depths are in feet		Created by: painrest on 2018-06-29	
		Database: WA_DEN_Anadarko_Defn	

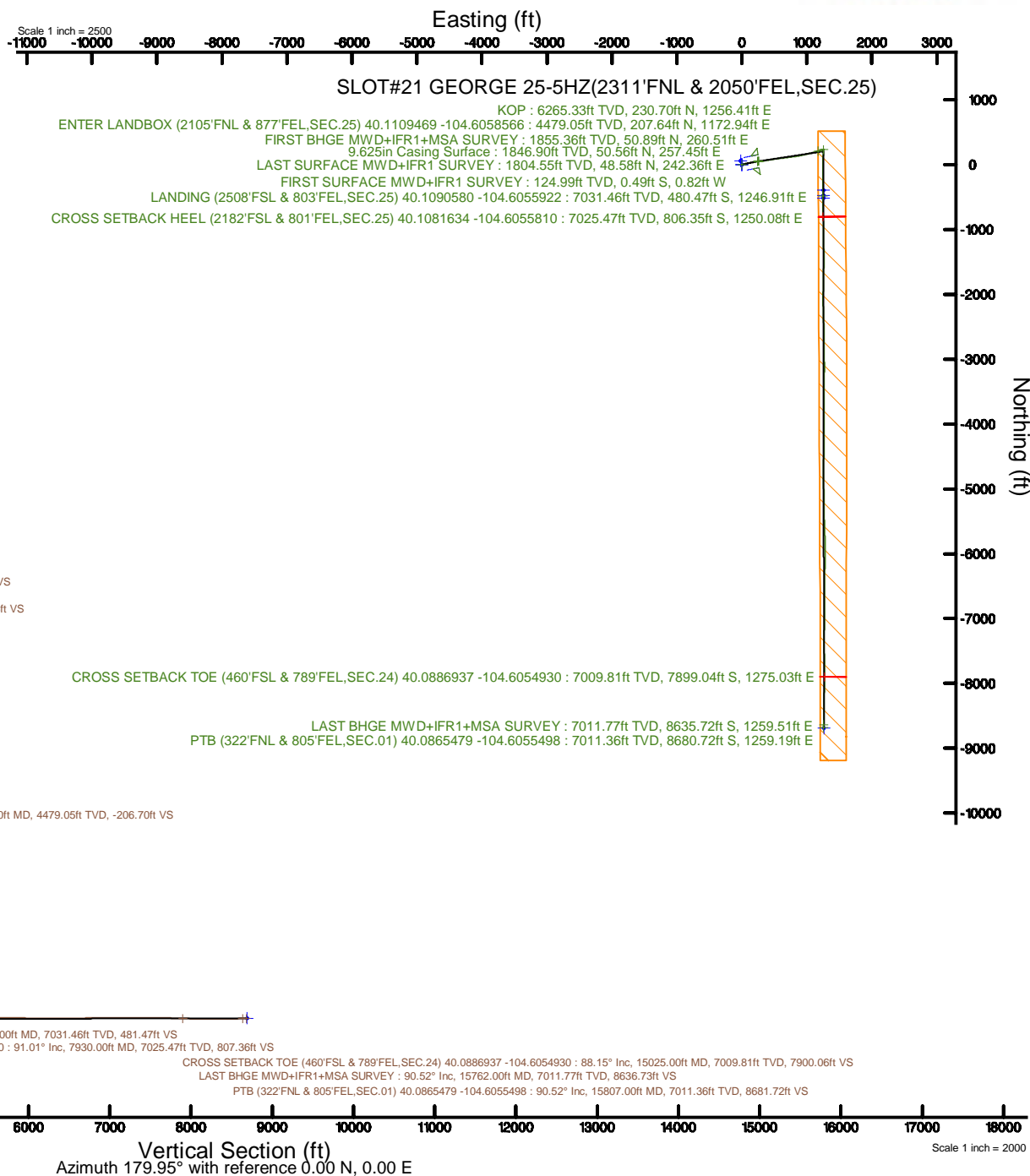

REFERENCE WELLPATH IDENTIFICATION			
Operator	KERR-MCGEE OIL & GAS ONSHORE LP (WA)	Slot	SLOT#21 GEORGE 25-5HZ(2311'FNL & 2050'FEL,SEC.25)
Area	COLORADO	Well	GEORGE 25-5HZ
Field	WELD COUNTY (UTM/TRUE NORTH)	Wellbore	GEORGE 25-5HZ AWP
Facility	SEC.25-T2N-R65W		

REPORT SETUP INFORMATION			
Projection System	NAD83 / UTM Zone 13 North, US feet	Software System	WellArchitect® 5.0
North Reference	True	User	Painsetr
Scale	0.999614	Report Generated	6/29/2018 at 7:53 AM
Convergence at slot	0.26° East	Database/Source file	WA_DEN_Anadarko_Defn/GEORGE_25-5HZ_AWP.xml

WELLPATH LOCATION						
	Local coordinates		Grid coordinates		Geographic coordinates	
	North[ft]	East[ft]	Easting[US ft]	Northing[US ft]	Latitude	Longitude
Slot Location	-1866.25	-1569.18	1749446.64	14567165.60	40°06'37.357"N	104°36'36.180"W
Facility Reference Pt			1751006.90	14569038.09	40°06'55.800"N	104°36'15.984"W
Field Reference Pt			1698235.31	14552047.82	40°04'09.600"N	104°47'36.000"W

WELLPATH DATUM			
Calculation method	Minimum curvature	Xtreme 22 (17') (RT) to Facility Vertical Datum	4918.00ft
Horizontal Reference Pt	Slot	Xtreme 22 (17') (RT) to Mean Sea Level	4918.00ft
Vertical Reference Pt	Xtreme 22 (17') (RT)	Xtreme 22 (17') (RT) to Mud Line at Slot (SLOT#21 GEORGE 25-5HZ(2311'FNL & 2050'FEL,SEC.25))	4918.00ft
MD Reference Pt	Xtreme 22 (17') (RT)	Section Origin	N 0.00, E 0.00 ft
Field Vertical Reference	Mean Sea Level	Section Azimuth	179.95°

REFERENCE WELLPATH IDENTIFICATION			
Operator	KERR-MCGEE OIL & GAS ONSHORE LP (WA)	Slot	SLOT#21 GEORGE 25-5HZ(2311'FNL & 2050'FEL,SEC.25)
Area	COLORADO	Well	GEORGE 25-5HZ
Field	WELD COUNTY (UTM/TRUE NORTH)	Wellbore	GEORGE 25-5HZ AWB
Facility	SEC.25-T2N-R65W		

WELLPATH DATA (218 stations) † = interpolated/extrapolated station												
MD [ft]	Inclination [°]	Azimuth [°]	TVD [ft]	Vert Sect [ft]	North [ft]	East [ft]	Grid East [US ft]	Grid North [US ft]	Latitude	Longitude	DLS [°/100ft]	Comments
0.00	0.00	239.180	0.00	0.00	0.00	0.00	1749446.64	14567165.60	40°06'37.357"N	104°36'36.180"W	0.00	
17.00	0.00	239.180	17.00	0.00	0.00	0.00	1749446.64	14567165.60	40°06'37.357"N	104°36'36.180"W	0.00	
125.00	1.010	239.180	124.99	0.49	-0.49	-0.82	1749445.83	14567165.11	40°06'37.352"N	104°36'36.191"W	0.94	FIRST SURFACE MWD+IFR1 SURVEY
157.00	0.970	244.100	156.99	0.75	-0.75	-1.30	1749445.34	14567164.85	40°06'37.350"N	104°36'36.197"W	0.29	
189.00	0.530	189.520	188.99	1.01	-1.01	-1.57	1749445.08	14567164.58	40°06'37.347"N	104°36'36.200"W	2.47	
221.00	0.440	158.150	220.99	1.27	-1.27	-1.55	1749445.10	14567164.32	40°06'37.344"N	104°36'36.200"W	0.86	
252.00	0.920	143.210	251.98	1.58	-1.58	-1.36	1749445.29	14567164.01	40°06'37.341"N	104°36'36.197"W	1.64	
284.00	1.270	130.550	283.98	2.02	-2.02	-0.93	1749445.72	14567163.58	40°06'37.337"N	104°36'36.192"W	1.32	
315.00	1.490	113.500	314.97	2.40	-2.40	-0.30	1749446.35	14567163.20	40°06'37.333"N	104°36'36.184"W	1.49	
347.00	1.670	103.040	346.96	2.68	-2.68	0.53	1749447.19	14567162.93	40°06'37.331"N	104°36'36.173"W	1.06	
379.00	1.490	76.670	378.95	2.69	-2.69	1.39	1749448.04	14567162.93	40°06'37.330"N	104°36'36.162"W	2.32	
411.00	1.010	77.380	410.94	2.53	-2.53	2.07	1749448.72	14567163.09	40°06'37.332"N	104°36'36.153"W	1.50	
442.00	1.050	81.420	441.93	2.43	-2.43	2.62	1749449.27	14567163.19	40°06'37.333"N	104°36'36.146"W	0.27	
474.00	0.750	70.780	473.93	2.32	-2.31	3.11	1749449.76	14567163.30	40°06'37.334"N	104°36'36.140"W	1.07	
505.00	1.140	68.500	504.92	2.14	-2.13	3.59	1749450.24	14567163.49	40°06'37.336"N	104°36'36.134"W	1.26	
537.00	1.230	72.280	536.92	1.92	-1.91	4.21	1749450.86	14567163.71	40°06'37.338"N	104°36'36.126"W	0.37	
569.00	1.320	67.090	568.91	1.67	-1.66	4.88	1749451.52	14567163.96	40°06'37.341"N	104°36'36.117"W	0.46	
600.00	1.800	61.560	599.90	1.30	-1.29	5.63	1749452.28	14567164.34	40°06'37.344"N	104°36'36.108"W	1.62	
632.00	2.240	75.710	631.88	0.90	-0.90	6.68	1749453.32	14567164.73	40°06'37.348"N	104°36'36.094"W	2.07	
664.00	2.590	77.110	663.85	0.59	-0.58	7.99	1749454.63	14567165.05	40°06'37.351"N	104°36'36.077"W	1.11	
696.00	3.210	70.610	695.81	0.13	-0.12	9.54	1749456.18	14567165.52	40°06'37.356"N	104°36'36.057"W	2.19	
728.00	3.780	74.650	727.75	-0.44	0.45	11.40	1749458.04	14567166.10	40°06'37.361"N	104°36'36.033"W	1.94	
759.00	3.820	72.280	758.68	-1.03	1.04	13.37	1749460.00	14567166.70	40°06'37.367"N	104°36'36.008"W	0.52	
791.00	4.610	73.770	790.59	-1.71	1.72	15.62	1749462.25	14567167.39	40°06'37.374"N	104°36'35.979"W	2.49	
823.00	5.490	73.950	822.47	-2.49	2.50	18.33	1749464.95	14567168.19	40°06'37.382"N	104°36'35.944"W	2.75	
854.00	5.930	76.150	853.32	-3.28	3.30	21.31	1749467.93	14567168.99	40°06'37.390"N	104°36'35.906"W	1.59	
886.00	6.420	74.040	885.13	-4.16	4.18	24.63	1749471.25	14567169.89	40°06'37.398"N	104°36'35.863"W	1.69	
918.00	6.550	78.170	916.93	-5.03	5.05	28.14	1749474.75	14567170.77	40°06'37.407"N	104°36'35.818"W	1.51	
949.00	6.900	77.200	947.71	-5.80	5.83	31.69	1749478.29	14567171.57	40°06'37.415"N	104°36'35.772"W	1.19	
980.00	7.250	75.970	978.48	-6.68	6.71	35.40	1749482.00	14567172.47	40°06'37.423"N	104°36'35.724"W	1.23	
1012.00	7.780	77.460	1010.20	-7.64	7.67	39.47	1749486.07	14567173.44	40°06'37.433"N	104°36'35.672"W	1.76	
1044.00	8.440	78.430	1041.88	-8.58	8.61	43.89	1749490.47	14567174.41	40°06'37.442"N	104°36'35.615"W	2.11	
1076.00	9.100	75.970	1073.51	-9.66	9.70	48.64	1749495.22	14567175.51	40°06'37.453"N	104°36'35.554"W	2.37	
1139.00	9.400	76.670	1135.69	-12.04	12.09	58.48	1749505.05	14567177.95	40°06'37.476"N	104°36'35.427"W	0.51	
1171.00	10.010	74.390	1167.23	-13.39	13.44	63.71	1749510.26	14567179.32	40°06'37.490"N	104°36'35.360"W	2.25	
1203.00	10.280	76.060	1198.73	-14.82	14.88	69.15	1749515.70	14567180.78	40°06'37.504"N	104°36'35.290"W	1.25	
1234.00	10.850	76.670	1229.20	-16.16	16.22	74.68	1749521.22	14567182.14	40°06'37.517"N	104°36'35.219"W	1.87	
1266.00	11.690	78.080	1260.59	-17.52	17.58	80.78	1749527.31	14567183.53	40°06'37.531"N	104°36'35.140"W	2.76	
1298.00	12.080	79.660	1291.90	-18.78	18.85	87.25	1749533.77	14567184.83	40°06'37.543"N	104°36'35.057"W	1.59	
1329.00	12.220	79.850	1322.21	-19.94	20.01	93.67	1749540.18	14567186.02	40°06'37.555"N	104°36'34.974"W	0.47	
1361.00	13.010	77.990	1353.43	-21.28	21.36	100.53	1749547.03	14567187.39	40°06'37.568"N	104°36'34.886"W	2.78	
1392.00	14.060	78.870	1383.57	-22.73	22.81	107.63	1749554.13	14567188.88	40°06'37.582"N	104°36'34.795"W	3.45	
1424.00	14.900	78.080	1414.56	-24.32	24.41	115.47	1749561.96	14567190.51	40°06'37.598"N	104°36'34.694"W	2.70	
1455.00	15.250	77.460	1444.49	-26.02	26.12	123.35	1749569.83	14567192.25	40°06'37.615"N	104°36'34.592"W	1.24	
1487.00	15.910	78.870	1475.31	-27.78	27.88	131.76	1749578.23	14567194.05	40°06'37.633"N	104°36'34.484"W	2.38	

REFERENCE WELLPATH IDENTIFICATION			
Operator	KERR-MCGEE OIL & GAS ONSHORE LP (WA)	Slot	SLOT#21 GEORGE 25-5HZ(2311'FNL & 2050'FEL,SEC.25)
Area	COLORADO	Well	GEORGE 25-5HZ
Field	WELD COUNTY (UTM/TRUE NORTH)	Wellbore	GEORGE 25-5HZ AWB
Facility	SEC.25-T2N-R65W		

WELLPATH DATA (218 stations) † = interpolated/extrapolated station												
MD [ft]	Inclination [°]	Azimuth [°]	TVD [ft]	Vert Sect [ft]	North [ft]	East [ft]	Grid East [US ft]	Grid North [US ft]	Latitude	Longitude	DLS [°/100ft]	Comments
1519.00	17.050	77.900	1506.00	-29.60	29.71	140.65	1749587.11	14567195.92	40°06'37.651"N	104°36'34.370"W	3.66	
1550.00	18.020	79.660	1535.56	-31.40	31.52	149.82	1749596.26	14567197.77	40°06'37.669"N	104°36'34.252"W	3.57	
1614.00	18.810	79.050	1596.28	-35.12	35.26	169.68	1749616.10	14567201.59	40°06'37.705"N	104°36'33.996"W	1.27	
1646.00	19.380	79.920	1626.52	-37.03	37.17	179.98	1749626.38	14567203.55	40°06'37.724"N	104°36'33.864"W	1.99	
1677.00	20.040	78.870	1655.70	-38.94	39.10	190.25	1749636.65	14567205.52	40°06'37.743"N	104°36'33.731"W	2.42	
1709.00	19.950	78.610	1685.77	-41.07	41.23	200.98	1749647.36	14567207.70	40°06'37.764"N	104°36'33.593"W	0.40	
1740.00	19.860	79.050	1714.92	-43.11	43.28	211.34	1749657.71	14567209.79	40°06'37.785"N	104°36'33.460"W	0.56	
1772.00	19.200	80.010	1745.08	-45.04	45.22	221.86	1749668.21	14567211.78	40°06'37.804"N	104°36'33.325"W	2.29	
1800.00	19.070	80.630	1771.53	-46.58	46.77	230.90	1749677.25	14567213.36	40°06'37.819"N	104°36'33.208"W	0.86	
1835.00	19.640	81.330	1804.55	-48.39	48.58	242.36	1749688.69	14567215.23	40°06'37.837"N	104°36'33.061"W	1.76	LAST SURFACE MWD+IFR1 SURVEY
1889.00	19.970	84.180	1855.36	-50.68	50.89	260.51	1749706.82	14567217.61	40°06'37.860"N	104°36'32.827"W	1.89	FIRST BHGE MWD+IFR1+MSA SURVEY
1977.00	18.920	81.840	1938.34	-54.20	54.44	289.58	1749735.87	14567221.29	40°06'37.895"N	104°36'32.453"W	1.49	
2064.00	20.110	84.360	2020.34	-57.65	57.91	318.43	1749764.69	14567224.88	40°06'37.929"N	104°36'32.082"W	1.68	
2152.00	18.810	83.810	2103.32	-60.65	60.92	347.59	1749793.82	14567228.03	40°06'37.959"N	104°36'31.706"W	1.49	
2239.00	19.510	81.240	2185.50	-64.35	64.65	375.89	1749822.10	14567231.87	40°06'37.996"N	104°36'31.342"W	1.26	
2326.00	20.090	79.830	2267.35	-69.17	69.50	404.96	1749851.13	14567236.85	40°06'38.044"N	104°36'30.968"W	0.86	
2414.00	20.400	81.400	2349.92	-74.11	74.46	435.00	1749881.14	14567241.94	40°06'38.093"N	104°36'30.581"W	0.71	
2502.00	20.620	78.220	2432.34	-79.55	79.92	465.33	1749911.44	14567247.53	40°06'38.147"N	104°36'30.191"W	1.29	
2589.00	19.120	77.670	2514.16	-85.69	86.09	494.25	1749940.32	14567253.83	40°06'38.208"N	104°36'29.819"W	1.74	
2676.00	18.970	84.110	2596.41	-90.16	90.58	522.24	1749968.28	14567258.44	40°06'38.252"N	104°36'29.459"W	2.42	
2764.00	19.430	84.140	2679.51	-93.10	93.55	551.03	1749997.04	14567261.53	40°06'38.281"N	104°36'29.088"W	0.52	
2852.00	19.840	82.250	2762.40	-96.59	97.05	580.39	1750026.37	14567265.16	40°06'38.316"N	104°36'28.710"W	0.86	
2939.00	21.040	84.600	2843.92	-100.02	100.52	610.56	1750056.52	14567268.75	40°06'38.350"N	104°36'28.322"W	1.67	
3026.00	21.630	85.220	2924.96	-102.81	103.32	642.09	1750088.02	14567271.70	40°06'38.378"N	104°36'27.916"W	0.73	
3114.00	21.210	82.780	3006.88	-106.13	106.67	674.05	1750119.95	14567275.19	40°06'38.411"N	104°36'27.505"W	1.12	
3201.00	21.050	81.340	3088.03	-110.44	111.00	705.11	1750150.98	14567279.65	40°06'38.454"N	104°36'27.105"W	0.62	
3289.00	21.340	82.830	3170.08	-114.79	115.38	736.62	1750182.46	14567284.17	40°06'38.497"N	104°36'26.699"W	0.70	
3377.00	19.270	82.330	3252.61	-118.70	119.32	766.90	1750212.71	14567288.24	40°06'38.536"N	104°36'26.310"W	2.36	
3464.00	20.730	82.500	3334.36	-122.61	123.24	796.39	1750242.18	14567292.29	40°06'38.575"N	104°36'25.930"W	1.68	
3578.00	19.840	82.210	3441.29	-127.83	128.50	835.56	1750281.31	14567297.72	40°06'38.627"N	104°36'25.426"W	0.79	
3666.00	18.470	78.530	3524.41	-132.60	133.30	864.02	1750309.74	14567302.63	40°06'38.674"N	104°36'25.060"W	2.07	
3754.00	18.460	80.160	3607.88	-137.73	138.45	891.41	1750337.09	14567307.91	40°06'38.725"N	104°36'24.707"W	0.59	
3841.00	18.820	78.550	3690.32	-142.85	143.59	918.74	1750364.38	14567313.16	40°06'38.776"N	104°36'24.355"W	0.72	
3929.00	19.670	77.100	3773.40	-148.95	149.71	947.09	1750392.69	14567319.41	40°06'38.836"N	104°36'23.991"W	1.11	
4017.00	20.030	77.070	3856.17	-155.61	156.39	976.21	1750421.78	14567326.21	40°06'38.902"N	104°36'23.616"W	0.41	
4104.00	20.330	77.300	3937.83	-162.24	163.05	1005.48	1750451.00	14567332.99	40°06'38.968"N	104°36'23.239"W	0.36	
4192.00	21.150	76.510	4020.13	-169.28	170.11	1035.83	1750481.31	14567340.19	40°06'39.038"N	104°36'22.848"W	0.98	
4279.00	20.800	76.040	4101.37	-176.65	177.50	1066.08	1750511.52	14567347.71	40°06'39.111"N	104°36'22.459"W	0.45	
4367.00	19.090	76.090	4184.08	-183.85	184.73	1095.21	1750540.61	14567355.06	40°06'39.182"N	104°36'22.084"W	1.94	
4455.00	15.570	74.890	4268.08	-190.37	191.27	1120.59	1750565.95	14567361.71	40°06'39.247"N	104°36'21.757"W	4.02	
4542.00	14.680	73.720	4352.06	-196.49	197.40	1142.45	1750587.77	14567367.94	40°06'39.308"N	104°36'21.476"W	1.08	
4630.00	14.230	70.460	4437.28	-203.21	204.15	1163.34	1750608.63	14567374.77	40°06'39.374"N	104°36'21.207"W	1.06	
4673.00†	13.244	69.468	4479.05	-206.70	207.64	1172.94	1750618.20	14567378.31	40°06'39.409"N	104°36'21.084"W	2.36	ENTER LANDBOX (2105'FNL & 877'FEL,SEC.25) 40.1109469 -104.6058566
4717.00	12.240	68.290	4521.96	-210.19	211.14	1181.99	1750627.24	14567381.84	40°06'39.443"N	104°36'20.967"W	2.36	
4805.00	11.510	66.350	4608.08	-217.15	218.11	1198.70	1750643.91	14567388.88	40°06'39.512"N	104°36'20.752"W	0.95	

REFERENCE WELLPATH IDENTIFICATION			
Operator	KERR-MCGEE OIL & GAS ONSHORE LP (WA)	Slot	SLOT#21 GEORGE 25-5HZ(2311'FNL & 2050'FEL,SEC.25)
Area	COLORADO	Well	GEORGE 25-5HZ
Field	WELD COUNTY (UTM/TRUE NORTH)	Wellbore	GEORGE 25-5HZ AWB
Facility	SEC.25-T2N-R65W		

WELLPATH DATA (218 stations) † = interpolated/extrapolated station												
MD (ft)	Inclination (°)	Azimuth (°)	TVD (ft)	Vert Sect (ft)	North (ft)	East (ft)	Grid East (US ft)	Grid North (US ft)	Latitude	Longitude	DLS ("/100ft)	Comments
4893.00	10.390	70.820	4694.48	-223.26	224.24	1214.24	1750659.41	14567395.08	40°06'39.573"N	104°36'20.552"W	1.60	
4980.00	8.680	75.890	4780.27	-227.43	228.42	1228.02	1750673.17	14567399.31	40°06'39.614"N	104°36'20.375"W	2.19	
5068.00	7.340	85.400	4867.42	-229.49	230.49	1240.06	1750685.20	14567401.43	40°06'39.634"N	104°36'20.220"W	2.14	
5155.00	5.660	90.110	4953.86	-229.92	230.92	1249.89	1750695.02	14567401.91	40°06'39.639"N	104°36'20.093"W	2.02	
5243.00	3.540	82.970	5041.57	-230.24	231.25	1256.93	1750702.06	14567402.27	40°06'39.642"N	104°36'20.003"W	2.49	
5330.00	1.910	87.540	5128.47	-230.63	231.64	1261.04	1750706.17	14567402.68	40°06'39.646"N	104°36'19.950"W	1.89	
5418.00	0.830	85.730	5216.45	-231.33	232.34	1262.50	1750707.62	14567403.38	40°06'39.653"N	104°36'19.931"W	2.33	
5505.00	1.420	287.270	5303.43	-232.28	233.29	1261.47	1750706.59	14567404.33	40°06'39.662"N	104°36'19.944"W	1.62	
5593.00	1.260	297.390	5391.41	-233.05	234.06	1259.57	1750704.69	14567405.09	40°06'39.670"N	104°36'19.969"W	0.32	
5680.00	0.750	296.140	5478.40	-233.74	234.75	1258.21	1750703.32	14567405.77	40°06'39.677"N	104°36'19.986"W	0.59	
5767.00	0.610	275.660	5565.39	-234.04	235.05	1257.24	1750702.35	14567406.07	40°06'39.679"N	104°36'19.999"W	0.32	
5854.00	0.580	291.110	5652.39	-234.24	235.25	1256.37	1750701.48	14567406.27	40°06'39.681"N	104°36'20.010"W	0.19	
5942.00	0.680	210.670	5740.38	-233.95	234.96	1255.69	1750700.80	14567405.98	40°06'39.679"N	104°36'20.019"W	0.93	
6030.00	0.350	225.510	5828.38	-233.32	234.32	1255.23	1750700.34	14567405.34	40°06'39.672"N	104°36'20.025"W	0.40	
6117.00	0.580	329.540	5915.38	-233.51	234.52	1254.81	1750699.93	14567405.53	40°06'39.674"N	104°36'20.030"W	0.86	
6205.00	0.940	134.400	6003.37	-233.39	234.40	1255.10	1750700.22	14567405.41	40°06'39.673"N	104°36'20.026"W	1.71	
6292.00	1.120	118.920	6090.36	-232.48	233.49	1256.36	1750701.48	14567404.50	40°06'39.664"N	104°36'20.010"W	0.38	
6380.00	1.000	206.590	6178.35	-231.37	232.38	1256.77	1750701.89	14567403.40	40°06'39.653"N	104°36'20.005"W	1.67	
6467.00	1.330	180.740	6265.33	-229.69	230.70	1256.41	1750701.55	14567401.71	40°06'39.636"N	104°36'20.009"W	0.70	KOP
6554.00	9.710	173.710	6351.85	-221.37	222.38	1257.21	1750702.37	14567393.40	40°06'39.554"N	104°36'19.999"W	9.65	
6642.00	14.050	180.500	6437.95	-203.30	204.31	1257.93	1750703.17	14567375.35	40°06'39.376"N	104°36'19.990"W	5.17	
6730.00	20.940	188.380	6521.84	-177.03	178.04	1255.54	1750700.90	14567349.07	40°06'39.116"N	104°36'20.021"W	8.26	
6817.00	27.800	184.860	6601.05	-141.39	142.40	1251.55	1750697.07	14567313.43	40°06'38.764"N	104°36'20.072"W	8.06	
6905.00	35.330	178.890	6675.99	-95.43	96.43	1250.30	1750696.02	14567267.48	40°06'38.310"N	104°36'20.088"W	9.26	
6992.00	41.360	182.100	6744.20	-41.50	42.50	1249.74	1750695.69	14567213.57	40°06'37.777"N	104°36'20.095"W	7.30	
7079.00	48.210	183.520	6805.91	19.67	-18.67	1246.69	1750692.91	14567152.41	40°06'37.172"N	104°36'20.135"W	7.96	
7167.00	52.450	181.620	6862.08	87.32	-86.32	1243.68	1750690.21	14567084.77	40°06'36.504"N	104°36'20.173"W	5.10	
7254.00	56.240	177.940	6912.79	157.97	-156.98	1244.01	1750690.84	14567014.14	40°06'35.805"N	104°36'20.169"W	5.55	
7342.00	60.070	176.000	6959.22	232.61	-231.60	1247.99	1750695.15	14566939.56	40°06'35.068"N	104°36'20.118"W	4.74	
7429.00	68.640	181.330	6996.86	310.91	-309.90	1249.68	1750697.18	14566861.30	40°06'34.294"N	104°36'20.096"W	11.29	
7517.00	78.210	181.120	7021.93	395.13	-394.13	1247.88	1750695.76	14566777.10	40°06'33.462"N	104°36'20.120"W	10.88	
7604.00	89.200	180.180	7031.46	481.47	-480.47	1246.91	1750695.16	14566690.79	40°06'32.609"N	104°36'20.132"W	12.68	LANDING (2508'FSL & 803'FEL,SEC.25) 40.1090580 -104.6055922
7691.00	92.620	180.240	7030.08	568.44	-567.44	1246.59	1750695.23	14566603.85	40°06'31.749"N	104°36'20.136"W	3.93	
7779.00	90.740	179.040	7027.50	656.40	-655.40	1247.15	1750696.16	14566515.93	40°06'30.880"N	104°36'20.129"W	2.53	
7866.00	90.680	178.880	7026.42	743.38	-742.38	1248.72	1750698.12	14566429.00	40°06'30.020"N	104°36'20.109"W	0.20	
7930.00†	91.015	178.684	7025.47	807.36	-806.35	1250.08	1750699.76	14566365.05	40°06'29.388"N	104°36'20.091"W	0.61	CROSS SETBACK HEEL (2182'FSL & 801'FEL,SEC.25) 40.1081634 -104.6055810
7954.00	91.140	178.610	7025.02	831.35	-830.34	1250.65	1750700.44	14566341.07	40°06'29.151"N	104°36'20.084"W	0.61	
8041.00	89.510	179.280	7024.53	918.33	-917.32	1252.25	1750702.42	14566254.13	40°06'28.292"N	104°36'20.064"W	2.03	
8128.00	89.410	178.790	7025.35	1005.31	-1004.31	1253.72	1750704.26	14566167.19	40°06'27.432"N	104°36'20.045"W	0.57	
8216.00	89.750	180.090	7025.99	1093.31	-1092.30	1254.58	1750705.51	14566079.24	40°06'26.562"N	104°36'20.034"W	1.53	
8303.00	88.330	178.310	7027.45	1180.28	-1179.27	1255.79	1750707.10	14565992.30	40°06'25.703"N	104°36'20.018"W	2.62	
8391.00	88.610	178.090	7029.80	1268.21	-1267.20	1258.56	1750710.25	14565904.43	40°06'24.834"N	104°36'19.983"W	0.40	
8478.00	88.550	177.460	7031.96	1355.12	-1354.10	1261.93	1750714.01	14565817.57	40°06'23.975"N	104°36'19.939"W	0.73	
8566.00	88.610	180.510	7034.14	1443.07	-1442.05	1263.49	1750715.95	14565729.66	40°06'23.106"N	104°36'19.919"W	3.47	
8653.00	89.320	181.260	7035.71	1530.04	-1529.03	1262.15	1750714.99	14565642.72	40°06'22.247"N	104°36'19.937"W	1.19	

REFERENCE WELLPATH IDENTIFICATION			
Operator	KERR-MCGEE OIL & GAS ONSHORE LP (WA)	Slot	SLOT#21 GEORGE 25-5HZ(2311'FNL & 2050'FEL,SEC.25)
Area	COLORADO	Well	GEORGE 25-5HZ
Field	WELD COUNTY (UTM/TRUE NORTH)	Wellbore	GEORGE 25-5HZ AWB
Facility	SEC.25-T2N-R65W		

### WELLPATH DATA (218 stations)

MD [ft]	Inclination [°]	Azimuth [°]	TVD [ft]	Vert Sect [ft]	North [ft]	East [ft]	Grid East [US ft]	Grid North [US ft]	Latitude	Longitude	DLS [°/100ft]	Comments
8741.00	91.050	182.670	7035.42	1617.98	-1616.97	1259.13	1750712.36	14565554.80	40°06'21.378"N	104°36'19.976"W	2.54	
8828.00	90.460	181.190	7034.28	1704.92	-1703.91	1256.20	1750709.81	14565467.88	40°06'20.518"N	104°36'20.013"W	1.83	
8916.00	90.800	181.200	7033.31	1792.89	-1791.89	1254.37	1750708.36	14565379.93	40°06'19.649"N	104°36'20.037"W	0.39	
9003.00	91.050	181.160	7031.91	1879.86	-1878.86	1252.57	1750706.95	14565292.99	40°06'18.790"N	104°36'20.060"W	0.29	
9091.00	91.600	180.660	7029.87	1967.82	-1966.82	1251.18	1750705.94	14565205.05	40°06'17.920"N	104°36'20.078"W	0.84	
9179.00	90.370	180.230	7028.36	2055.81	-2054.80	1250.49	1750705.64	14565117.10	40°06'17.051"N	104°36'20.087"W	1.48	
9266.00	90.580	179.480	7027.64	2142.80	-2141.80	1250.71	1750706.25	14565030.14	40°06'16.191"N	104°36'20.084"W	0.90	
9353.00	89.600	178.320	7027.50	2229.79	-2228.78	1252.38	1750708.30	14564943.20	40°06'15.332"N	104°36'20.063"W	1.75	
9441.00	89.510	178.220	7028.18	2317.74	-2316.74	1255.04	1750711.34	14564855.29	40°06'14.462"N	104°36'20.029"W	0.15	
9532.00	88.860	177.440	7029.48	2408.67	-2407.66	1258.49	1750715.18	14564764.42	40°06'13.564"N	104°36'19.984"W	1.12	
9622.00	89.110	178.620	7031.07	2498.61	-2497.59	1261.58	1750718.67	14564674.53	40°06'12.675"N	104°36'19.945"W	1.34	
9713.00	88.210	178.240	7033.20	2589.55	-2588.53	1264.07	1750721.56	14564583.64	40°06'11.776"N	104°36'19.913"W	1.07	
9804.00	88.920	179.870	7035.48	2680.50	-2679.49	1265.57	1750723.45	14564492.73	40°06'10.878"N	104°36'19.893"W	1.95	
9896.00	90.800	180.380	7035.70	2772.50	-2771.48	1265.37	1750723.66	14564400.77	40°06'09.969"N	104°36'19.896"W	2.12	
9984.00	90.710	179.680	7034.54	2860.49	-2859.48	1265.32	1750724.00	14564312.81	40°06'09.099"N	104°36'19.897"W	0.80	
10071.00	90.740	179.320	7033.44	2947.48	-2946.46	1266.08	1750725.14	14564225.86	40°06'08.239"N	104°36'19.887"W	0.42	
10159.00	91.110	178.590	7032.02	3035.45	-3034.44	1267.69	1750727.13	14564137.93	40°06'07.370"N	104°36'19.866"W	0.93	
10246.00	90.590	180.040	7030.73	3122.44	-3121.42	1268.73	1750728.55	14564050.99	40°06'06.510"N	104°36'19.853"W	1.77	
10334.00	90.920	181.120	7029.57	3210.42	-3209.41	1267.84	1750728.04	14563963.03	40°06'05.641"N	104°36'19.865"W	1.28	
10421.00	91.080	180.450	7028.05	3297.40	-3296.38	1266.65	1750727.23	14563876.08	40°06'04.781"N	104°36'19.880"W	0.79	
10509.00	91.170	180.710	7026.33	3385.38	-3384.36	1265.75	1750726.73	14563788.14	40°06'03.912"N	104°36'19.891"W	0.31	
10596.00	91.140	180.780	7024.57	3472.35	-3471.34	1264.62	1750725.98	14563701.19	40°06'03.052"N	104°36'19.906"W	0.09	
10684.00	90.980	180.100	7022.95	3560.33	-3559.32	1263.95	1750725.69	14563613.24	40°06'02.183"N	104°36'19.915"W	0.79	
10772.00	90.430	179.950	7021.86	3648.33	-3647.31	1263.91	1750726.04	14563525.28	40°06'01.313"N	104°36'19.915"W	0.65	
10860.00	90.560	179.860	7021.10	3736.32	-3735.31	1264.06	1750726.57	14563437.32	40°06'00.444"N	104°36'19.914"W	0.18	
10947.00	90.770	179.940	7020.09	3823.32	-3822.30	1264.21	1750727.10	14563350.36	40°05'59.584"N	104°36'19.912"W	0.26	
11034.00	89.850	179.240	7019.62	3910.31	-3909.30	1264.83	1750728.10	14563263.41	40°05'58.724"N	104°36'19.904"W	1.33	
11122.00	89.570	179.500	7020.07	3998.31	-3997.29	1265.80	1750729.46	14563175.45	40°05'57.855"N	104°36'19.891"W	0.43	
11210.00	88.860	179.020	7021.27	4086.29	-4085.27	1266.93	1750730.98	14563087.51	40°05'56.985"N	104°36'19.877"W	0.97	
11297.00	89.720	180.180	7022.35	4173.28	-4172.26	1267.54	1750731.97	14563000.56	40°05'56.126"N	104°36'19.869"W	1.66	
11385.00	89.170	180.320	7023.20	4261.27	-4260.26	1267.16	1750731.97	14562912.59	40°05'55.256"N	104°36'19.874"W	0.64	
11472.00	90.520	181.530	7023.44	4348.26	-4347.24	1265.75	1750730.95	14562825.64	40°05'54.397"N	104°36'19.892"W	2.08	
11560.00	90.620	181.850	7022.56	4436.21	-4435.20	1263.16	1750728.74	14562737.70	40°05'53.527"N	104°36'19.926"W	0.38	
11647.00	90.680	181.660	7021.58	4523.16	-4522.15	1260.49	1750726.45	14562650.77	40°05'52.668"N	104°36'19.960"W	0.23	
11735.00	90.590	182.710	7020.60	4611.09	-4610.08	1257.14	1750723.49	14562562.87	40°05'51.799"N	104°36'20.003"W	1.20	
11822.00	91.170	180.260	7019.26	4698.04	-4697.04	1254.88	1750721.61	14562475.94	40°05'50.940"N	104°36'20.032"W	2.89	
11909.00	90.950	179.220	7017.66	4785.03	-4784.02	1255.28	1750722.39	14562388.99	40°05'50.080"N	104°36'20.027"W	1.22	
11997.00	90.460	179.000	7016.57	4873.01	-4872.00	1256.65	1750724.14	14562301.05	40°05'49.211"N	104°36'20.010"W	0.61	
12084.00	90.220	178.370	7016.06	4959.99	-4958.98	1258.64	1750726.52	14562214.12	40°05'48.351"N	104°36'19.984"W	0.77	
12172.00	91.480	180.050	7014.75	5047.96	-5046.95	1259.86	1750728.12	14562126.18	40°05'47.482"N	104°36'19.968"W	2.39	
12259.00	91.170	179.200	7012.74	5134.94	-5133.93	1260.43	1750729.07	14562039.24	40°05'46.622"N	104°36'19.961"W	1.04	
12347.00	91.140	179.350	7010.96	5222.91	-5221.90	1261.54	1750730.57	14561951.31	40°05'45.753"N	104°36'19.947"W	0.17	
12434.00	91.660	178.720	7008.84	5309.88	-5308.86	1263.00	1750732.41	14561864.39	40°05'44.894"N	104°36'19.928"W	0.94	
12522.00	92.090	178.180	7005.96	5397.80	-5396.78	1265.38	1750735.17	14561776.51	40°05'44.025"N	104°36'19.898"W	0.78	
12609.00	90.090	178.100	7004.31	5484.73	-5483.72	1268.21	1750738.38	14561689.63	40°05'43.166"N	104°36'19.861"W	2.30	

REFERENCE WELLPATH IDENTIFICATION			
Operator	KERR-MCGEE OIL & GAS ONSHORE LP (WA)	Slot	SLOT#21 GEORGE 25-5HZ(2311'FNL & 2050'FEL,SEC.25)
Area	COLORADO	Well	GEORGE 25-5HZ
Field	WELD COUNTY (UTM/TRUE NORTH)	Wellbore	GEORGE 25-5HZ AWB
Facility	SEC.25-T2N-R65W		

WELLPATH DATA (218 stations) † = interpolated/extrapolated station												
MD [ft]	Inclination [°]	Azimuth [°]	TVD [ft]	Vert Sect [ft]	North [ft]	East [ft]	Grid East [US ft]	Grid North [US ft]	Latitude	Longitude	DLS [°/100ft]	Comments
12697.00	90.250	178.100	7004.04	5572.69	-5571.67	1271.12	1750741.68	14561601.72	40°05'42.297"N	104°36'19.824"W	0.18	
12784.00	90.340	178.170	7003.60	5659.64	-5658.62	1273.95	1750744.89	14561514.82	40°05'41.437"N	104°36'19.787"W	0.13	
12872.00	90.580	177.780	7002.89	5747.59	-5746.56	1277.06	1750748.38	14561426.92	40°05'40.568"N	104°36'19.747"W	0.52	
12960.00	88.890	178.860	7003.30	5835.55	-5834.52	1279.64	1750751.35	14561339.01	40°05'39.699"N	104°36'19.714"W	2.28	
13047.00	89.170	180.130	7004.77	5922.53	-5921.50	1280.41	1750752.50	14561252.07	40°05'38.840"N	104°36'19.704"W	1.49	
13134.00	88.580	179.700	7006.48	6009.51	-6008.49	1280.54	1750753.01	14561165.12	40°05'37.980"N	104°36'19.703"W	0.84	
13222.00	89.630	181.650	7007.85	6097.49	-6096.46	1279.50	1750752.36	14561077.17	40°05'37.111"N	104°36'19.716"W	2.52	
13309.00	88.860	180.930	7009.00	6184.46	-6183.43	1277.54	1750750.78	14560990.23	40°05'36.251"N	104°36'19.742"W	1.21	
13397.00	90.920	181.690	7009.17	6272.43	-6271.40	1275.53	1750749.15	14560902.29	40°05'35.382"N	104°36'19.767"W	2.50	
13484.00	90.340	180.610	7008.21	6359.40	-6358.38	1273.79	1750747.79	14560815.34	40°05'34.522"N	104°36'19.790"W	1.41	
13572.00	89.750	180.050	7008.14	6447.40	-6446.38	1273.28	1750747.67	14560727.37	40°05'33.653"N	104°36'19.797"W	0.92	
13659.00	89.230	179.550	7008.92	6534.39	-6533.37	1273.58	1750748.35	14560640.41	40°05'32.793"N	104°36'19.793"W	0.83	
13746.00	91.570	180.830	7008.31	6621.38	-6620.36	1273.29	1750748.45	14560553.46	40°05'31.933"N	104°36'19.796"W	3.07	
13834.00	92.220	180.400	7005.40	6709.33	-6708.31	1272.35	1750747.89	14560465.54	40°05'31.064"N	104°36'19.809"W	0.89	
13921.00	90.490	180.490	7003.34	6796.30	-6795.28	1271.68	1750747.60	14560378.60	40°05'30.205"N	104°36'19.817"W	1.99	
14009.00	90.960	180.290	7002.23	6884.29	-6883.27	1271.08	1750747.38	14560290.65	40°05'29.335"N	104°36'19.825"W	0.58	
14096.00	89.810	180.830	7001.64	6971.28	-6970.26	1270.23	1750746.91	14560203.68	40°05'28.476"N	104°36'19.836"W	1.46	
14184.00	89.290	180.580	7002.33	7059.27	-7058.25	1269.14	1750746.22	14560115.72	40°05'27.606"N	104°36'19.850"W	0.66	
14271.00	89.510	180.510	7003.25	7146.26	-7145.24	1268.32	1750745.77	14560028.76	40°05'26.746"N	104°36'19.861"W	0.27	
14358.00	90.120	180.730	7003.53	7233.25	-7232.24	1267.37	1750745.21	14559941.80	40°05'25.887"N	104°36'19.873"W	0.75	
14446.00	90.180	180.320	7003.30	7321.25	-7320.23	1266.57	1750744.79	14559853.84	40°05'25.017"N	104°36'19.883"W	0.47	
14533.00	90.580	179.510	7002.72	7408.24	-7407.23	1266.70	1750745.30	14559766.87	40°05'24.157"N	104°36'19.882"W	1.04	
14620.00	89.660	179.600	7002.54	7495.24	-7494.23	1267.37	1750746.36	14559679.92	40°05'23.298"N	104°36'19.873"W	1.06	
14708.00	90.280	178.990	7002.58	7583.23	-7582.22	1268.46	1750747.83	14559591.96	40°05'22.428"N	104°36'19.859"W	0.99	
14795.00	88.430	177.590	7003.56	7670.19	-7669.17	1271.05	1750750.80	14559505.06	40°05'21.569"N	104°36'19.826"W	2.67	
14883.00	88.830	179.520	7005.67	7758.13	-7757.11	1273.27	1750753.40	14559417.16	40°05'20.700"N	104°36'19.798"W	2.24	
14971.00	88.090	178.890	7008.03	7846.09	-7845.07	1274.49	1750755.01	14559329.24	40°05'19.831"N	104°36'19.782"W	1.10	
15025.00†	88.146	179.958	7009.81	7900.06	-7899.04	1275.03	1750755.79	14559275.30	40°05'19.297"N	104°36'19.775"W	1.98	CROSS SETBACK TOE (460'FSL & 789'FEL,SEC.24) 40.0886937 -104.6054930
15058.00	88.180	180.610	7010.86	7933.04	-7932.02	1274.87	1750755.77	14559242.33	40°05'18.971"N	104°36'19.777"W	1.98	
15146.00	88.890	181.240	7013.11	8021.00	-8019.98	1273.45	1750754.74	14559154.40	40°05'18.102"N	104°36'19.795"W	1.08	
15234.00	89.480	183.470	7014.37	8108.91	-8107.89	1269.83	1750751.51	14559066.51	40°05'17.233"N	104°36'19.842"W	2.62	
15321.00	90.310	181.570	7014.52	8195.81	-8194.80	1266.01	1750748.07	14558979.61	40°05'16.374"N	104°36'19.891"W	2.38	
15409.00	90.030	180.830	7014.26	8283.79	-8282.78	1264.17	1750746.61	14558891.66	40°05'15.505"N	104°36'19.915"W	0.90	
15496.00	89.260	180.810	7014.80	8370.78	-8369.77	1262.92	1750745.75	14558804.70	40°05'14.645"N	104°36'19.931"W	0.89	
15584.00	91.080	181.030	7014.54	8458.76	-8457.75	1261.51	1750744.72	14558716.75	40°05'13.776"N	104°36'19.949"W	2.08	
15672.00	90.990	180.570	7012.95	8546.74	-8545.73	1260.28	1750743.88	14558628.80	40°05'12.907"N	104°36'19.965"W	0.53	
15762.00	90.520	180.410	7011.77	8636.73	-8635.72	1259.51	1750743.50	14558538.84	40°05'12.017"N	104°36'19.975"W	0.55	LAST BHGE MWD+IFR1+MSA SURVEY
15807.00	90.520	180.410	7011.36	8681.72	-8680.72	1259.19	1750743.38	14558493.86	40°05'11.573"N	104°36'19.979"W	0.00	PTB (322'FNL & 805'FEL,SEC.01) 40.0865479 -104.6055498

HOLE & CASING SECTIONS - Ref Wellbore: GEORGE 25-5HZ AWB Ref Wellpath: GEORGE 25-5HZ AWP									
String/Diameter	Start MD [ft]	End MD [ft]	Interval [ft]	Start TVD [ft]	End TVD [ft]	Start N/S [ft]	Start E/W [ft]	End N/S [ft]	End E/W [ft]
9.625in Casing Surface	17.00	1880.00	1863.00	17.00	1846.90	0.00	0.00	50.56	257.45



REFERENCE WELLPATH IDENTIFICATION			
Operator	KERR-MCGEE OIL & GAS ONSHORE LP (WA)	Slot	SLOT#21 GEORGE 25-5HZ(2311'FNL & 2050'FEL,SEC.25)
Area	COLORADO	Well	GEORGE 25-5HZ
Field	WELD COUNTY (UTM/TRUE NORTH)	Wellbore	GEORGE 25-5HZ AWB
Facility	SEC.25-T2N-R65W		

TARGETS								
Name	TVD [ft]	North [ft]	East [ft]	Grid East [US ft]	Grid North [US ft]	Latitude	Longitude	Shape
SEC.36-T2N-R65W	0.00	57.17	-18.18	1749428.22	14567222.67	40°06'37.922"N	104°36'36.414"W	polygon
SEC.25-T2N-R65W	20.00	9975.13	-1343.64	1748059.81	14577130.87	40°08'15.932"N	104°36'53.480"W	polygon
GEORGE 25-5HZ BHL REV-1(332'FNL & 802'FEL,SEC.01)	7006.00	-8690.89	1261.65	1750745.89	14558483.70	40°05'11.472"N	104°36'19.948"W	point
GEORGE 25-5HZ HEEL REV-1(2594'FSL & 798'FEL,SEC.25)	7033.00	-393.75	1255.09	1750702.96	14566777.51	40°06'33.466"N	104°36'20.027"W	point
GEORGE 25-5HZ HEEL REV-2(2514'FSL & 798'FEL,SEC.25)	7033.00	-473.75	1255.09	1750703.31	14566697.54	40°06'32.675"N	104°36'20.027"W	point
GEORGE 25-5HZ HEEL REV-3(2474'FSL & 798'FEL,SEC.25)	7033.00	-513.75	1255.09	1750703.48	14566657.56	40°06'32.280"N	104°36'20.027"W	point
GEORGE 25-5HZ LANDBOX	7033.00	0.00	0.00	1749446.64	14567165.60	40°06'37.357"N	104°36'36.180"W	polygon
GEORGE 25-5HZ SETBACK 1	7033.00	0.00	0.00	1749446.64	14567165.60	40°06'37.357"N	104°36'36.180"W	polygon
GEORGE 25-5HZ SETBACK 2	7033.00	0.00	0.00	1749446.64	14567165.60	40°06'37.357"N	104°36'36.180"W	polygon

WELLPATH COMPOSITION - Ref Wellbore: GEORGE 25-5HZ AWB      Ref Wellpath: GEORGE 25-5HZ AWP				
Start MD [ft]	End MD [ft]	Positional Uncertainty Model	Log Name/Comment	Wellbore
17.00	1835.00	Custom APC_ISCWSA REV 2 MWD+IFR1 (approximation)	Custom APC_ISCWSA Rev-2 MWD+IFR1 <125 - 1835>	GEORGE 25-5HZ AWB
1835.00	15762.00	Custom APC_ISCWSA REV 2 MWD+IFR1+MSA (approximation)	BHGE Custom APC_ISCWSA Rev-2 MWD+IFR1+MSA <1889 - 15762>	GEORGE 25-5HZ AWB
15762.00	15807.00	Blind Drilling (std)	Projection to bit	GEORGE 25-5HZ AWB



REFERENCE WELLPATH IDENTIFICATION			
Operator	KERR-MCGEE OIL & GAS ONSHORE LP (WA)	Slot	SLOT#21 GEORGE 25-5HZ(2311'FNL & 2050'FEL,SEC.25)
Area	COLORADO	Well	GEORGE 25-5HZ
Field	WELD COUNTY (UTM/TRUE NORTH)	Wellbore	GEORGE 25-5HZ AWB
Facility	SEC.25-T2N-R65W		

WELLPATH COMMENTS				
MD [ft]	Inclination [°]	Azimuth [°]	TVD [ft]	Comment
125.00	1.010	239.180	124.99	FIRST SURFACE MWD+IFR1 SURVEY
1835.00	19.640	81.330	1804.55	LAST SURFACE MWD+IFR1 SURVEY
1889.00	19.970	84.180	1855.36	FIRST BHGE MWD+IFR1+MSA SURVEY
4673.00	13.244	69.468	4479.05	ENTER LANDBOX (2105'FNL & 877'FEL,SEC.25) 40.1109469 -104.6058566
6467.00	1.330	180.740	6265.33	KOP
7604.00	89.200	180.180	7031.46	LANDING (2508'FSL & 803'FEL,SEC.25) 40.1090580 -104.6055922
7930.00	91.015	178.684	7025.47	CROSS SETBACK HEEL (2182'FSL & 801'FEL,SEC.25) 40.1081634 -104.6055810
15025.00	88.146	179.958	7009.81	CROSS SETBACK TOE (460'FSL & 789'FEL,SEC.24) 40.0886937 -104.6054930
15762.00	90.520	180.410	7011.77	LAST BHGE MWD+IFR1+MSA SURVEY
15807.00	90.520	180.410	7011.36	PTB (322'FNL & 805'FEL,SEC.01) 40.0865479 -104.6055498