

Plot reference wellpath is TROUTD 2N-29B-L (REV-B.0) PWP	Grid System: NAD83 / Lambert Colorado SP, Northern Zone (501), US feet
True vertical depths are referenced to PRECISION 562 (25') (RKB)	* = Wellpath was transformed from a different geodetic datum
Measured depths are referenced to PRECISION 562 (25') (RKB)	North Reference: True north
PRECISION 562 (25') (RKB) to Mean Sea Level: 4739 feet	Scale: True distance
Mean Sea Level to Mud line (At Slot: SLOT#28 TROUTD 2N-29B-L (2122FNL & 1689FWL SEC.27)): 0 feet	Depths are in feet
Coordinates are in feet referenced to Slot	Created by: doddanna on 2018-08-02
	Database: WellArchitectDB

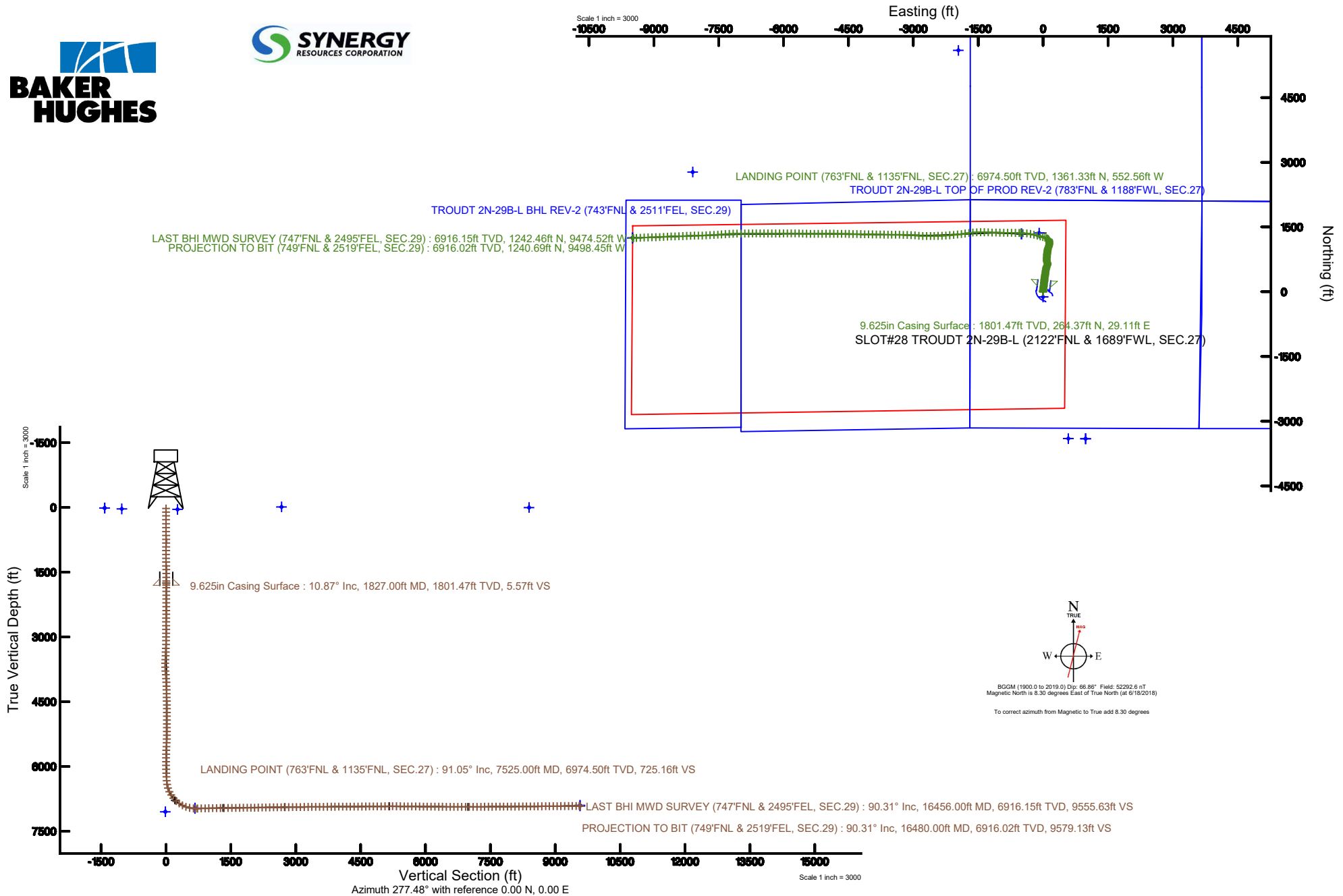



Actual Wellpath Report

TROUDT 2N-29B-L AWP

Page 1 of 11



REFERENCE WELLPATH IDENTIFICATION

Operator	SRC ENERGY	Slot	SLOT#28 TROUDT 2N-29B-L (2122'FNL & 1689'FWL, SEC.27)
Area	COLORADO	Well	TROUDT 2N-29B-L
Field	WELD COUNTY (NAD83, TRUE NORTH)	Wellbore	TROUDT 2N-29B-L AWB
Facility	SEC.27-T06N-R66W		

REPORT SETUP INFORMATION

Projection System	NAD83 / Lambert Colorado SP, Northern Zone (501), US feet	Software System	WellArchitect® 5.0
North Reference	True	User	Doddanna
Scale	0.999964	Report Generated	8/2/2018 at 4:42:01 PM
Convergence at slot	0.47° East	Database/Source file	WellArchitectDB/TROUDT_2N-29B-L_AWP.xml

WELLPATH LOCATION

	Local coordinates		Grid coordinates		Geographic coordinates	
	North[ft]	East[ft]	Easting[US ft]	Northing[US ft]	Latitude	Longitude
Slot Location	-1361.04	92.36	3203877.33	1411572.53	40°27'39.082"N	104°46'02.302"W
Facility Reference Pt			3203773.74	1412932.71	40°27'52.531"N	104°46'03.497"W
Field Reference Pt			3171284.48	1426358.81	40°30'07.643"N	104°53'02.634"W

WELLPATH DATUM

Calculation method	Minimum curvature	PRECISION 562 (25') (RKB) to Facility Vertical Datum	4739.00ft
Horizontal Reference Pt	Slot	PRECISION 562 (25') (RKB) to Mean Sea Level	4739.00ft
Vertical Reference Pt	PRECISION 562 (25') (RKB)	PRECISION 562 (25') (RKB) to Mud Line at Slot (SLOT#28 TROUDT 2N-29B-L (2122'FNL & 1689'FWL, SEC.27))	4739.00ft
MD Reference Pt	PRECISION 562 (25') (RKB)	Section Origin	N 0.00, E 0.00 ft
Field Vertical Reference	Mean Sea Level	Section Azimuth	277.48°



SRC ENERGY

Actual Wellpath Report

TROUDT 2N-29B-L AWP

Page 2 of 11

**BAKER
HUGHES****REFERENCE WELLPATH IDENTIFICATION**

Operator	SRC ENERGY	Slot	SLOT#28 TROUDT 2N-29B-L (2122'FNL & 1689'FWL, SEC.27)
Area	COLORADO	Well	TROUDT 2N-29B-L
Field	WELD COUNTY (NAD83,TRUE NORTH)	Wellbore	TROUDT 2N-29B-L AWB
Facility	SEC.27-T06N-R66W		

WELLPATH DATA (188 stations) † = interpolated/extrapolated station

MD [ft]	Inclination [°]	Azimuth [°]	TVD [ft]	Vert Sect [ft]	North [ft]	East [ft]	DLS [°/100ft]	Comments
0.00†	0.000	274.210	0.00	0.00	0.00	0.00	0.00	
25.00	0.000	274.210	25.00	0.00	0.00	0.00	0.00	
107.00	0.270	274.210	107.00	0.19	0.01	-0.19	0.33	
194.00	0.610	291.350	194.00	0.85	0.20	-0.83	0.41	
285.00	1.450	342.250	284.98	1.81	1.47	-1.63	1.28	
378.00	2.510	2.460	377.93	2.49	4.63	-1.90	1.35	
469.00	3.960	6.100	468.78	2.74	9.74	-1.48	1.61	
559.00	6.310	2.920	558.41	3.21	17.77	-0.90	2.63	
649.00	8.360	5.290	647.67	3.85	29.23	-0.05	2.30	
739.00	10.370	6.360	736.47	4.26	43.79	1.46	2.24	
829.00	12.040	8.410	824.75	4.27	61.13	3.73	1.91	
919.00	11.610	7.860	912.84	4.06	79.39	6.34	0.49	
1009.00	11.750	9.230	1000.98	3.72	97.41	9.05	0.35	
1099.00	11.700	8.010	1089.10	3.35	115.49	11.79	0.28	
1189.00	12.070	7.540	1177.17	3.26	133.85	14.29	0.42	
1279.00	11.470	5.160	1265.28	3.61	152.09	16.33	0.86	
1369.00	12.890	5.010	1353.25	4.41	171.01	18.01	1.58	
1459.00	12.280	5.120	1441.09	5.24	190.54	19.75	0.68	
1549.00	12.120	9.050	1529.05	5.37	209.40	22.09	0.94	
1639.00	10.850	8.090	1617.25	5.03	227.12	24.76	1.43	
1729.00	12.020	7.320	1705.46	4.96	244.80	27.15	1.31	
1773.00	11.770	5.500	1748.52	5.13	253.81	28.16	1.02	
1885.00	9.900	3.700	1858.52	6.16	274.79	29.88	1.70	
1974.00	11.870	4.810	1945.91	7.09	291.55	31.14	2.23	
2064.00	11.810	5.960	2034.00	7.77	309.94	32.87	0.27	
2153.00	11.270	10.050	2121.20	7.62	327.56	35.34	1.10	
2244.00	10.380	10.690	2210.58	6.77	344.37	38.41	0.99	
2334.00	11.160	7.180	2298.99	6.36	360.98	41.00	1.13	
2424.00	10.500	6.490	2387.39	6.55	377.77	43.02	0.75	
2513.00	11.780	11.940	2474.71	5.98	394.72	45.81	1.86	



Actual Wellpath Report

TROUDT 2N-29B-L AWP

Page 3 of 11



REFERENCE WELLPATH IDENTIFICATION

Operator	SRC ENERGY	Slot	SLOT#28 TROUDT 2N-29B-L (2122'FNL & 1689'FWL, SEC.27)
Area	COLORADO	Well	TROUDT 2N-29B-L
Field	WELD COUNTY (NAD83,TRUE NORTH)	Wellbore	TROUDT 2N-29B-L AWB
Facility	SEC.27-T06N-R66W		

WELLPATH DATA (188 stations)

MD [ft]	Inclination [°]	Azimuth [°]	TVD [ft]	Vert Sect [ft]	North [ft]	East [ft]	DLS [°/100ft]	Comments
2603.00	12.510	9.720	2562.70	4.89	413.31	49.36	0.96	
2692.00	12.640	9.360	2649.56	4.19	432.42	52.57	0.17	
2782.00	12.800	6.590	2737.36	4.03	452.04	55.32	0.70	
2871.00	12.450	4.280	2824.20	4.72	471.40	57.17	0.69	
2961.00	12.190	11.230	2912.14	4.64	490.40	59.74	1.67	
3050.00	12.710	10.760	2999.04	3.46	509.23	63.40	0.60	
3140.00	12.520	12.920	3086.87	1.97	528.47	67.43	0.57	
3229.00	11.010	13.660	3174.00	0.15	546.13	71.59	1.71	
3319.00	11.570	17.890	3262.26	-2.41	563.07	76.39	1.11	
3408.00	11.350	15.320	3349.48	-5.22	580.01	81.45	0.62	
3497.00	11.230	25.840	3436.77	-9.14	596.26	87.54	2.31	
3587.00	11.490	25.950	3525.01	-14.74	612.21	95.28	0.29	
3676.00	11.480	20.200	3612.23	-19.50	628.49	102.22	1.29	
3766.00	12.320	357.700	3700.34	-19.84	646.50	104.93	5.20	
3856.00	11.480	334.180	3788.46	-13.28	664.16	100.64	5.43	
3945.00	11.440	339.840	3875.69	-4.32	680.42	93.74	1.26	
4034.00	11.600	346.000	3962.90	3.05	697.39	88.53	1.39	
4124.00	11.360	353.210	4051.10	8.55	714.97	85.30	1.62	
4213.00	12.240	359.520	4138.22	12.02	733.11	84.18	1.75	
4303.00	12.410	359.780	4226.15	14.63	752.32	84.06	0.20	
4392.00	12.720	2.890	4313.02	16.70	771.67	84.52	0.84	
4482.00	12.860	3.900	4400.79	18.12	791.56	85.70	0.29	
4571.00	12.840	4.160	4487.56	19.31	811.30	87.09	0.07	
4661.00	12.900	4.670	4575.30	20.38	831.29	88.64	0.14	
4750.00	11.400	2.730	4662.30	21.60	849.98	89.87	1.75	
4840.00	11.640	7.330	4750.49	22.36	867.87	91.45	1.05	
4929.00	11.530	9.060	4837.68	22.14	885.56	93.99	0.41	
5019.00	11.450	7.850	4925.87	21.84	903.29	96.63	0.28	
5108.00	11.390	6.950	5013.11	21.86	920.77	98.90	0.21	
5198.00	11.320	7.090	5101.35	22.01	938.35	101.07	0.08	



Actual Wellpath Report

TROUDT 2N-29B-L AWP

Page 4 of 11



REFERENCE WELLPATH IDENTIFICATION			
Operator	SRC ENERGY	Slot	SLOT#28 TROUDT 2N-29B-L (2122'FNL & 1689'FWL, SEC.27)
Area	COLORADO	Well	TROUDT 2N-29B-L
Field	WELD COUNTY (NAD83,TRUE NORTH)	Wellbore	TROUDT 2N-29B-L AWB
Facility	SEC.27-T06N-R66W		

WELLPATH DATA (188 stations)								
MD [ft]	Inclination [°]	Azimuth [°]	TVD [ft]	Vert Sect [ft]	North [ft]	East [ft]	DLS [°/100ft]	Comments
5287.00	10.870	10.410	5188.69	21.64	955.27	103.66	0.88	
5377.00	11.850	9.360	5276.92	20.90	972.74	106.70	1.11	
5467.00	11.740	12.310	5365.02	19.83	990.80	110.15	0.68	
5556.00	11.820	18.180	5452.15	17.37	1008.31	114.93	1.35	
5645.00	11.600	22.930	5539.30	13.30	1025.21	121.26	1.11	
5735.00	12.150	23.540	5627.37	8.27	1042.23	128.56	0.63	
5825.00	12.320	16.590	5715.34	4.13	1060.11	135.09	1.65	
5914.00	12.340	11.740	5802.28	1.92	1078.53	139.73	1.16	
6004.00	11.870	6.350	5890.29	1.39	1097.14	142.72	1.36	
6093.00	11.780	3.060	5977.40	2.27	1115.31	144.21	0.76	
6183.00	11.910	2.180	6065.48	3.84	1133.77	145.06	0.25	
6273.00	11.940	358.290	6153.54	6.19	1152.35	145.13	0.89	
6362.00	12.170	351.990	6240.58	10.16	1170.84	143.55	1.50	
6452.00	12.340	345.300	6328.54	16.33	1189.54	139.79	1.59	
6541.00	13.810	321.550	6415.29	27.56	1207.07	130.76	6.21	
6630.00	18.710	307.990	6500.73	47.51	1224.19	112.89	6.93	
6720.00	25.320	293.910	6584.18	78.46	1240.91	83.87	9.35	
6809.00	32.590	284.810	6662.04	120.57	1254.78	43.22	9.53	
6899.00	39.970	282.810	6734.55	173.47	1267.40	-8.47	8.30	
6988.00	47.360	284.890	6798.89	234.48	1282.17	-68.07	8.46	
7078.00	55.020	286.250	6855.25	303.85	1301.02	-135.56	8.59	
7167.00	62.960	284.730	6901.07	379.33	1321.34	-209.02	9.04	
7257.00	72.200	279.780	6935.38	462.12	1338.85	-290.22	11.45	
7346.00	76.740	275.590	6959.21	547.83	1350.28	-375.17	6.83	
7436.00	85.380	273.390	6973.18	636.52	1357.21	-463.71	9.90	
7481.00	90.120	272.690	6974.95	681.34	1359.60	-508.60	10.65	
7525.00	91.050	271.830	6974.50	725.16	1361.33	-552.56	2.88	LANDING POINT (763'FNL & 1135'FNL, SEC.27)
7615.00	91.140	271.570	6972.78	814.68	1364.00	-642.51	0.31	
7704.00	91.080	271.030	6971.06	903.15	1366.02	-731.47	0.61	
7793.00	91.230	270.780	6969.26	991.54	1367.42	-820.44	0.33	



Actual Wellpath Report

TROUDT 2N-29B-L AWP

Page 5 of 11



REFERENCE WELLPATH IDENTIFICATION

Operator	SRC ENERGY	Slot	SLOT#28 TROUDT 2N-29B-L (2122'FNL & 1689'FWL, SEC.27)
Area	COLORADO	Well	TROUDT 2N-29B-L
Field	WELD COUNTY (NAD83,TRUE NORTH)	Wellbore	TROUDT 2N-29B-L AWB
Facility	SEC.27-T06N-R66W		

WELLPATH DATA (188 stations)

MD [ft]	Inclination [°]	Azimuth [°]	TVD [ft]	Vert Sect [ft]	North [ft]	East [ft]	DLS [°/100ft]	Comments
7883.00	91.110	270.790	6967.43	1080.91	1368.66	-910.41	0.13	
7972.00	91.170	270.320	6965.66	1169.24	1369.52	-999.39	0.53	
8061.00	90.650	271.790	6964.24	1257.67	1371.16	-1088.36	1.75	
8151.00	90.740	271.370	6963.15	1347.18	1373.64	-1178.32	0.48	
8240.00	90.620	271.850	6962.09	1435.71	1376.14	-1267.28	0.56	
8330.00	90.620	271.720	6961.12	1525.26	1378.94	-1357.23	0.14	
8419.00	90.680	269.410	6960.11	1613.60	1379.82	-1446.21	2.60	
8509.00	90.710	267.320	6959.02	1702.45	1377.25	-1536.16	2.32	
8598.00	90.590	264.490	6958.01	1789.63	1370.90	-1624.92	3.18	
8688.00	90.800	262.580	6956.92	1876.96	1360.77	-1714.34	2.13	
8777.00	90.680	262.610	6955.77	1962.97	1349.30	-1802.59	0.14	
8866.00	90.650	262.370	6954.73	2048.93	1337.66	-1890.82	0.27	
8956.00	90.890	262.980	6953.52	2135.93	1326.19	-1980.08	0.73	
9045.00	91.020	264.640	6952.04	2222.40	1316.60	-2068.54	1.87	
9135.00	90.990	265.840	6950.46	2310.33	1309.13	-2158.22	1.33	
9224.00	90.830	266.190	6949.05	2397.55	1302.94	-2246.99	0.43	
9314.00	90.920	267.290	6947.67	2485.96	1297.83	-2336.83	1.23	
9403.00	90.920	268.650	6946.25	2573.72	1294.68	-2425.76	1.53	
9493.00	90.650	268.880	6945.01	2662.67	1292.74	-2515.73	0.39	
9582.00	90.490	269.390	6944.13	2750.72	1291.39	-2604.72	0.60	
9672.00	90.520	270.560	6943.33	2839.95	1291.35	-2694.71	1.30	
9761.00	90.680	271.630	6942.40	2928.39	1293.05	-2783.69	1.22	
9850.00	90.650	274.170	6941.37	3017.09	1297.56	-2872.56	2.85	
9940.00	90.710	275.650	6940.30	3106.99	1305.26	-2962.22	1.65	
10029.00	90.770	273.270	6939.15	3195.85	1312.18	-3050.94	2.67	
10119.00	90.580	271.660	6938.09	3285.50	1316.05	-3140.85	1.80	
10208.00	90.520	271.430	6937.24	3374.02	1318.45	-3229.81	0.27	
10298.00	90.520	271.370	6936.42	3463.51	1320.65	-3319.78	0.07	
10387.00	90.520	270.340	6935.61	3551.91	1321.97	-3408.77	1.16	
10477.00	90.340	270.230	6934.94	3641.19	1322.42	-3498.76	0.23	



SRC ENERGY

Actual Wellpath Report

TROUDT 2N-29B-L AWP

Page 6 of 11

**BAKER
HUGHES****REFERENCE WELLPATH IDENTIFICATION**

Operator	SRC ENERGY	Slot	SLOT#28 TROUDT 2N-29B-L (2122'FNL & 1689'FWL, SEC.27)
Area	COLORADO	Well	TROUDT 2N-29B-L
Field	WELD COUNTY (NAD83,TRUE NORTH)	Wellbore	TROUDT 2N-29B-L AWB
Facility	SEC.27-T06N-R66W		

WELLPATH DATA (188 stations)

MD [ft]	Inclination [°]	Azimuth [°]	TVD [ft]	Vert Sect [ft]	North [ft]	East [ft]	DLS [°/100ft]	Comments
10566.00	90.550	270.500	6934.25	3729.51	1322.99	-3587.76	0.38	
10656.00	90.310	271.020	6933.57	3818.88	1324.18	-3677.75	0.64	
10745.00	90.310	271.500	6933.09	3907.36	1326.14	-3766.72	0.54	
10835.00	90.220	271.200	6932.67	3996.84	1328.26	-3856.70	0.35	
10924.00	90.370	271.170	6932.21	4085.30	1330.10	-3945.68	0.17	
11014.00	90.280	270.570	6931.70	4174.70	1331.47	-4035.67	0.67	
11103.00	90.370	270.850	6931.20	4263.08	1332.57	-4124.66	0.33	
11192.00	90.220	271.060	6930.74	4351.50	1334.05	-4213.64	0.29	
11282.00	90.490	271.310	6930.18	4440.96	1335.92	-4303.62	0.41	
11371.00	90.490	271.140	6929.42	4529.42	1337.82	-4392.60	0.19	
11461.00	90.460	271.080	6928.68	4618.86	1339.56	-4482.58	0.07	
11550.00	90.520	270.670	6927.91	4707.27	1340.92	-4571.57	0.47	
11640.00	90.650	270.970	6927.00	4796.66	1342.21	-4661.55	0.36	
11729.00	90.520	270.820	6926.09	4885.06	1343.60	-4750.54	0.22	
11819.00	90.520	270.360	6925.27	4974.41	1344.52	-4840.53	0.51	
11908.00	90.550	269.720	6924.44	5062.65	1344.59	-4929.52	0.72	
11998.00	90.490	269.650	6923.62	5151.82	1344.09	-5019.52	0.10	
12087.00	90.250	269.390	6923.05	5239.96	1343.35	-5108.51	0.40	
12177.00	89.350	268.980	6923.36	5329.01	1342.07	-5198.50	1.10	
12266.00	89.420	270.000	6924.32	5417.14	1341.27	-5287.49	1.15	
12356.00	89.410	271.100	6925.24	5506.48	1342.14	-5377.48	1.22	
12445.00	89.480	272.030	6926.10	5595.00	1344.57	-5466.44	1.05	
12535.00	89.450	272.130	6926.94	5684.60	1347.84	-5556.38	0.12	
12624.00	89.420	271.670	6927.82	5773.17	1350.79	-5645.33	0.52	
12714.00	89.380	270.390	6928.76	5862.59	1352.40	-5735.31	1.42	
12803.00	89.350	269.780	6929.74	5950.84	1352.54	-5824.30	0.69	
12893.00	89.450	268.970	6930.69	6039.94	1351.55	-5914.29	0.91	
12982.00	89.450	269.370	6931.54	6128.00	1350.26	-6003.27	0.45	
13072.00	89.320	269.710	6932.51	6217.13	1349.54	-6093.27	0.40	
13161.00	89.380	269.770	6933.52	6305.31	1349.14	-6182.26	0.10	



Actual Wellpath Report

TROUDT 2N-29B-L AWP

Page 7 of 11



REFERENCE WELLPATH IDENTIFICATION

Operator	SRC ENERGY	Slot	SLOT#28 TROUDT 2N-29B-L (2122'FNL & 1689'FWL, SEC.27)
Area	COLORADO	Well	TROUDT 2N-29B-L
Field	WELD COUNTY (NAD83,TRUE NORTH)	Wellbore	TROUDT 2N-29B-L AWB
Facility	SEC.27-T06N-R66W		

WELLPATH DATA (188 stations)

MD [ft]	Inclination [°]	Azimuth [°]	TVD [ft]	Vert Sect [ft]	North [ft]	East [ft]	DLS [°/100ft]	Comments
13250.00	89.410	270.090	6934.46	6393.54	1349.03	-6271.25	0.36	
13339.00	89.750	270.410	6935.11	6481.83	1349.42	-6360.25	0.52	
13429.00	89.750	270.320	6935.50	6571.13	1349.99	-6450.25	0.10	
13518.00	89.630	270.520	6935.98	6659.45	1350.64	-6539.24	0.26	
13608.00	89.630	270.040	6936.56	6748.74	1351.08	-6629.24	0.53	
13697.00	89.850	269.350	6936.97	6836.92	1350.61	-6718.24	0.81	
13786.00	89.690	269.310	6937.33	6925.02	1349.57	-6807.23	0.19	
13876.00	90.770	269.920	6936.96	7014.17	1348.96	-6897.23	1.38	
13965.00	90.460	269.520	6936.01	7102.35	1348.53	-6986.22	0.57	
14055.00	90.310	268.790	6935.40	7191.40	1347.20	-7076.21	0.83	
14144.00	90.550	267.620	6934.74	7279.23	1344.41	-7165.16	1.34	
14234.00	90.250	266.400	6934.11	7367.72	1339.72	-7255.03	1.40	
14323.00	90.220	266.570	6933.74	7455.09	1334.26	-7343.87	0.19	
14413.00	90.400	266.540	6933.26	7543.46	1328.86	-7433.70	0.20	
14502.00	90.280	266.430	6932.73	7630.82	1323.40	-7522.53	0.18	
14592.00	90.310	266.000	6932.26	7719.08	1317.46	-7612.34	0.48	
14681.00	90.400	266.370	6931.71	7806.36	1311.54	-7701.14	0.43	
14771.00	90.490	266.820	6931.01	7894.73	1306.19	-7790.97	0.51	
14860.00	90.550	268.810	6930.21	7982.46	1302.80	-7879.90	2.24	
14950.00	90.520	269.700	6929.37	8071.53	1301.63	-7969.89	0.99	
15039.00	90.520	269.310	6928.56	8159.66	1300.86	-8058.88	0.44	
15129.00	90.430	267.660	6927.81	8248.55	1298.48	-8148.84	1.84	
15218.00	90.460	266.460	6927.12	8336.08	1293.92	-8237.72	1.35	
15308.00	90.710	267.450	6926.20	8424.56	1289.13	-8327.59	1.13	
15398.00	90.680	268.400	6925.11	8513.30	1285.88	-8417.52	1.06	
15487.00	90.400	268.400	6924.27	8601.18	1283.39	-8506.48	0.31	
15577.00	90.620	268.170	6923.47	8690.02	1280.70	-8596.44	0.35	
15666.00	90.580	267.140	6922.54	8777.71	1277.06	-8685.36	1.16	
15756.00	90.490	266.780	6921.70	8866.19	1272.28	-8775.23	0.41	
15845.00	90.460	267.260	6920.96	8953.71	1267.66	-8864.11	0.54	



Actual Wellpath Report

TROUDT 2N-29B-L AWP

Page 8 of 11



REFERENCE WELLPATH IDENTIFICATION

Operator	SRC ENERGY	Slot	SLOT#28 TROUDT 2N-29B-L (2122'FNL & 1689'FWL, SEC.27)
Area	COLORADO	Well	TROUDT 2N-29B-L
Field	WELD COUNTY (NAD83,TRUE NORTH)	Wellbore	TROUDT 2N-29B-L AWP
Facility	SEC.27-T06N-R66W		

WELLPATH DATA (188 stations)

MD [ft]	Inclination [°]	Azimuth [°]	TVD [ft]	Vert Sect [ft]	North [ft]	East [ft]	DLS [°/100ft]	Comments
15934.00	90.620	268.260	6920.12	9041.42	1264.18	-8953.03	1.14	
16024.00	90.370	268.490	6919.34	9130.28	1261.63	-9042.99	0.38	
16113.00	90.400	268.410	6918.75	9218.18	1259.22	-9131.96	0.10	
16203.00	90.310	267.540	6918.19	9306.94	1256.04	-9221.90	0.97	
16293.00	90.400	267.350	6917.63	9395.56	1252.03	-9311.81	0.23	
16382.00	90.680	266.640	6916.79	9483.07	1247.36	-9400.68	0.86	
16456.00	90.310	265.770	6916.15	9555.63	1242.46	-9474.52	1.28	LAST BHI MWD SURVEY (747'FNL & 2495'FEL, SEC.29)
16480.00	90.310	265.770	6916.02	9579.13	1240.69	-9498.45	0.00	PROJECTION TO BIT (749'FNL & 2519'FEL, SEC.29)

HOLE & CASING SECTIONS - Ref Wellbore: TROUDT 2N-29B-L AWP Ref Wellpath: TROUDT 2N-29B-L AWP

String/Diameter	Start MD [ft]	End MD [ft]	Interval [ft]	Start TVD [ft]	End TVD [ft]	Start N/S [ft]	Start E/W [ft]	End N/S [ft]	End E/W [ft]
13.5in Open Hole	25.00	1827.00	1802.00	25.00	1801.47	0.00	0.00	264.37	29.11
9.625in Casing Surface	25.00	1827.00	1802.00	25.00	1801.47	0.00	0.00	264.37	29.11
8.5in Open Hole	1827.00	16480.00	14653.00	1801.47	6916.02	264.37	29.11	1240.69	-9498.45



Actual Wellpath Report

TROUDT 2N-29B-L AWP

Page 9 of 11



REFERENCE WELLPATH IDENTIFICATION

Operator	SRC ENERGY	Slot	SLOT#28 TROUDT 2N-29B-L (2122'FNL & 1689'FWL, SEC.27)
Area	COLORADO	Well	TROUDT 2N-29B-L
Field	WELD COUNTY (NAD83,TRUE NORTH)	Wellbore	TROUDT 2N-29B-L AWP
Facility	SEC.27-T06N-R66W		

TARGETS

Name	TVD [ft]	North [ft]	East [ft]	Grid East [US ft]	Grid North [US ft]	Latitude	Longitude	Shape
SEC.23-T06N-R66W	-13.00	5592.34	-1959.67	3201871.60	1417148.27	40°28'34.342"N	104°46'27.660"W	polygon
SEC.22-T06N-R66W	1.00	2773.78	-8101.49	3195753.51	1414279.17	40°28'06.478"N	104°47'47.123"W	polygon
SEC.27-T06N-R66W	14.00	-3405.32	983.05	3204888.45	1408175.58	40°27'05.432"N	104°45'49.586"W	polygon
SEC.28-T06N-R66W	14.00	-3405.32	983.05	3204888.45	1408175.58	40°27'05.432"N	104°45'49.586"W	polygon
SEC.26-T06N-R66W	33.00	-3401.99	582.83	3204488.23	1408175.60	40°27'05.465"N	104°45'54.763"W	polygon
SEC.29-T06N-R66W EAST HALF	45.00	1361.04	-92.35	3203773.74	1412932.71	40°27'52.531"N	104°46'03.497"W	polygon
TROUDT 2N-29B-L BHL ON PLAT (743'FNL & 2511'FEL, SEC.29)	6899.00	1246.65	-9490.48	3194377.24	1412740.68	40°27'51.383"N	104°48'05.087"W	point
TROUDT 2N-29B-L BHL REV-2 (743'FNL & 2511'FEL, SEC.29)	6915.27	1246.65	-9490.48	3194377.24	1412740.68	40°27'51.383"N	104°48'05.087"W	point
TROUDT 2N-29B-L TOP OF PROD ON PLAT (783'FNL & 1188'FWL, SEC.27)	6964.00	1341.38	-499.16	3203367.13	1412909.68	40°27'52.337"N	104°46'08.760"W	point
TROUDT 2N-29B-L TOP OF PROD REV-2 (783'FNL & 1188'FWL, SEC.27)	6970.78	1341.38	-499.16	3203367.13	1412909.68	40°27'52.337"N	104°46'08.760"W	point
TROUDT 7N-29B-L HARDLINE BOX	7049.85	-120.22	0.00	3203878.33	1411452.31	40°27'37.894"N	104°46'02.302"W	polygon



Actual Wellpath Report

TROUDT 2N-29B-L AWP

Page 10 of 11



REFERENCE WELLPATH IDENTIFICATION

Operator	SRC ENERGY	Slot	SLOT#28 TROUDT 2N-29B-L (2122'FNL & 1689'FWL, SEC.27)
Area	COLORADO	Well	TROUDT 2N-29B-L
Field	WELD COUNTY (NAD83,TRUE NORTH)	Wellbore	TROUDT 2N-29B-L AWB
Facility	SEC.27-T06N-R66W		

WELLPATH COMPOSITION - Ref Wellbore: TROUDT 2N-29B-L AWB Ref Wellpath: TROUDT 2N-29B-L AWP

Start MD [ft]	End MD [ft]	Positional Uncertainty Model	Log Name/Comment	Wellbore
25.00	1773.00	BHI NaviTrak (Standard)	13 1/2" SURFACE SECTION <86'-1752'>	TROUDT 2N-29B-L AWB
1773.00	16456.00	BHI AutoTrak Curve (MagCAD+IFR1, Short spacing)	8 1/2" ATC MONOBORE SURVEYS <1885-16456>	TROUDT 2N-29B-L AWB
16456.00	16480.00	Blind Drilling (std)	Projection to bit	TROUDT 2N-29B-L AWB



Actual Wellpath Report

TROUDT 2N-29B-L AWP

Page 11 of 11



REFERENCE WELLPATH IDENTIFICATION

Operator	SRC ENERGY	Slot	SLOT#28 TROUDT 2N-29B-L (2122'FNL & 1689'FWL, SEC.27)
Area	COLORADO	Well	TROUDT 2N-29B-L
Field	WELD COUNTY (NAD83,TRUE NORTH)	Wellbore	TROUDT 2N-29B-L AWB
Facility	SEC.27-T06N-R66W		

WELLPATH COMMENTS

MD [ft]	Inclination [°]	Azimuth [°]	TVD [ft]	Comment
7525.00	91.050	271.830	6974.50	LANDING POINT (763'FNL & 1135'FNL, SEC.27)
16456.00	90.310	265.770	6916.15	LAST BHI MWD SURVEY (747'FNL & 2495'FEL, SEC.29)
16480.00	90.310	265.770	6916.02	PROJECTION TO BIT (749'FNL & 2519'FEL, SEC.29)