

| | | | |
|--|------------------|--|--|
| Location: | COLORADO | Slot: | SLOT#04 ANTELOPE T34-19-18MRNLB (225°FSL & 1228°FEL, SEC.19) |
| Field: | WELD COUNTY | Well: | ANTELOPE T34-19-18MRNLB |
| Facility: | SEC-19-T05N-R62W | Wellbore: | ANTELOPE T34-19-18MRNLB PWB |
| Plot reference wellpath is ANTELOPE T34-19-18MRNLB PWP (REV-A.0) | | Grid System: NAD83 / Lambert Colorado SP, Northern Zone (501), US feet | |
| True vertical depths are referenced to RIG (17KB) (RKB) | | * = Wellpath was transformed from a different geodetic datum | |
| Measured depths are referenced to RIG (17KB) (RKB) | | North Reference: True north | |
| RIG (17KB) (RKB) to Mean Sea Level: 4675 feet | | Scale: True distance | |
| Mean Sea Level to Mud line (At Slot: SLOT#04 ANTELOPE T34-19-18MRNLB (225°FSL & 1228°FEL, SEC.19)): 0 feet | | Depths are in feet | |
| Coordinates are in feet referenced to Slot | | Created by: ingmmr on 2018-01-10 | |
| | | Database: Denver | |

| Facility Name | | | | Grid East (US ft) | Grid North (US ft) | Latitude | Longitude |
|---|--------------|--------------|-------------------|--------------------|--------------------|-----------------|-----------------|
| SEC.19-T05N-R62W | | | | 3317343.701 | 1362714.207 | 40°22'42.085"N | 104°21'39.240"W |
| Spot | Local N (ft) | Local E (ft) | Grid East (US ft) | Grid North (US ft) | Latitude | Longitude | |
| SLOT#04 ANTELOPE T34-19-18MRLN (225FSL & 1228FEL, SEC.19) | -1.42 | -60.21 | 3317283.516 | 1362712.017 | 40°22'42.071"N | 104°21'40.018"W | |
| RIG (17KB) (R0K) to Mud line (A Slot SLOT#04 ANTELOPE T34-19-18MRLN (225FSL & 1228FEL, SEC.19)) | | | | | | 4675R | |
| Mean Sea Level to Mud line (A Slot SLOT#04 ANTELOPE T34-19-18MRLN (225FSL & 1228FEL, SEC.19)) | | | | | | 0ft | |
| RIG (17KB) (R0K) to Mean Sea Level | | | | | | 4675ft | |

| Design Comment | MD (ft) | Inc (°) | Az (°) | TVD (ft) | Local N (ft) | Local E (ft) | DLS (°/100ft) | VS (ft) |
|---------------------|----------|---------|---------|----------|--------------|--------------|---------------|---------|
| Tie On | 17.00 | 0.000 | 195.927 | 17.00 | 0.00 | 0.00 | 0.00 | 0.00 |
| End of Tangent | 2000.00 | 0.000 | 195.927 | 2000.00 | 0.00 | 0.00 | 0.00 | 0.00 |
| End of Build (XS) | 2269.55 | 5.391 | 195.927 | 2269.16 | -12.19 | -3.48 | 2.00 | -11.94 |
| End of Tangent (XS) | 5767.00 | 5.391 | 195.927 | 5751.13 | -328.17 | -93.65 | 0.00 | -321.57 |
| End of 3D Arc (XS) | 6718.25 | 90.000 | 357.857 | 6375.00 | 241.42 | -133.24 | 10.00 | 249.38 |
| End of Tangent (XS) | 11231.40 | 90.000 | 357.857 | 6375.00 | 4751.42 | -302.00 | 0.00 | 4761.00 |

| Name | Start MD (ft) | End MD (ft) | Interval (ft) | Start TVD (ft) | End TVD (ft) | Start Local N (ft) | Start Local E (ft) | End Local N (ft) | End Local E (ft) | Wellbore |
|------------------------|---------------|-------------|---------------|----------------|--------------|--------------------|--------------------|------------------|------------------|----------------------------|
| 9.625in Casing Surface | 17.00 | 1550.00 | 1533.00 | 17.00 | 1550.00 | 0.00 | 0.00 | 0.00 | 0.00 | ANTELOPE T34-19-18MRNB PWB |
| 8.5in Open Hole | 1550.00 | 11231.40 | 9681.40 | 1550.00 | 6375.00 | 0.00 | 0.00 | 4751.41 | -302.00 | ANTELOPE T34-19-18MRNB PWB |

| Start MD (ft) | End MD (ft) | Tool | Model | Log Name/Comment | Wellbore |
|---------------|-------------|--------------------|--|------------------|------------------------------|
| 17.00 | 1550.00 | BH1 NavTrak | Custom BH1 NavTrak (Standard Rotating+Axial Core) (Rockies 0.03G model) | | ANTELOPE T34-19-18MR/LRN PWB |
| 1550.00 | 11231.40 | BH1 AutoTrak Curve | Custom BH1 AutoTrak Curve (Axial Core, Short spacing) (Rockies 0.030G model) | | ANTELOPE T34-19-18MR/LRN PWB |

| MD (ft) | Inc (°) | Az (°) | TVD (ft) | Local N (ft) | Local E (ft) | Grid East (US ft) | Grid North (US ft) | Latitude | Longitude |
|----------|---------|---------|----------|--------------|--------------|-------------------|--------------------|----------------|-----------------|
| 11231.40 | 90.000 | 357.857 | 6375.00 | 4751.42 | -302.00 | 3316920.53 | 1387458.96 | 40°23'29.023"N | 104°21'43.921"W |

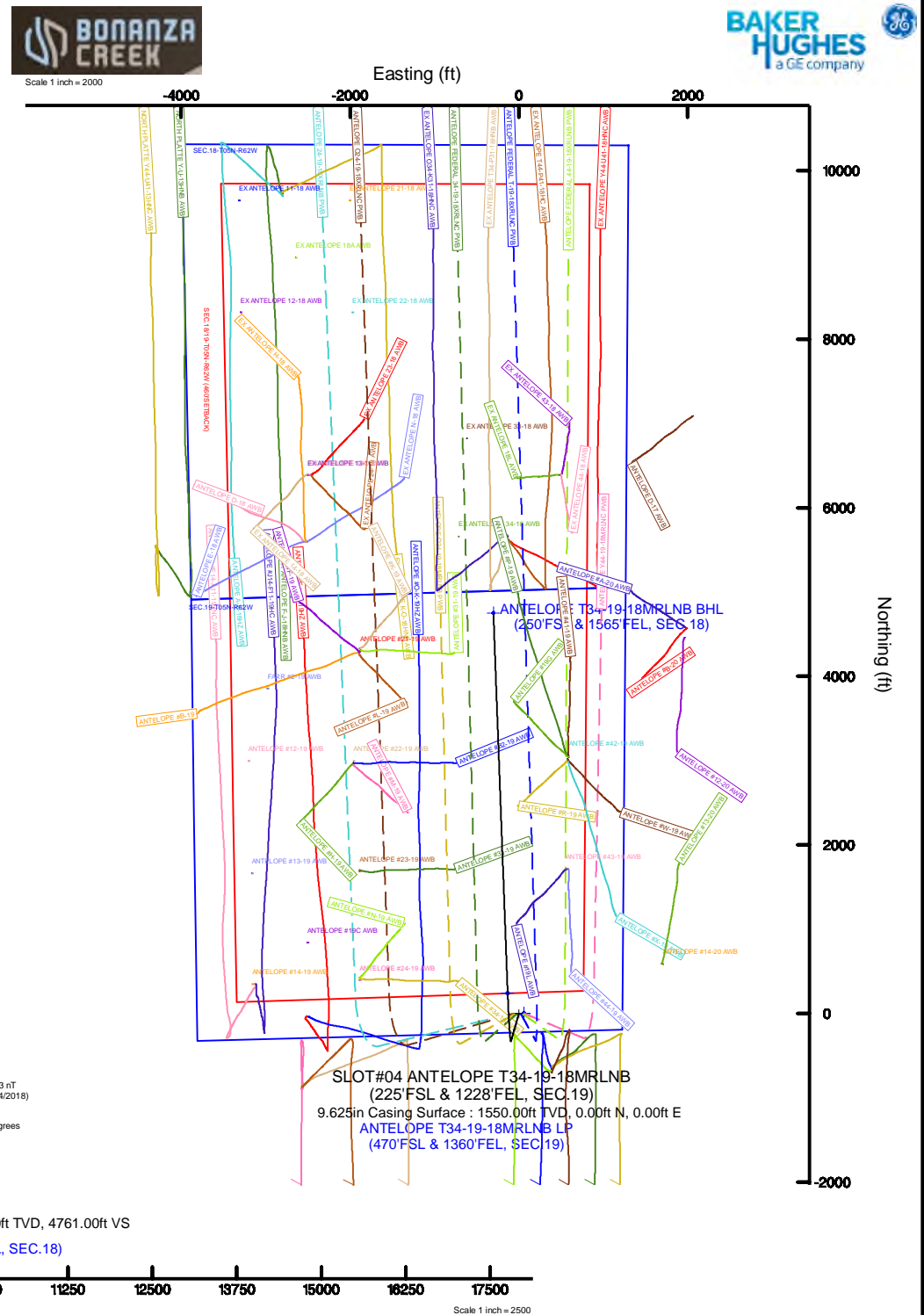
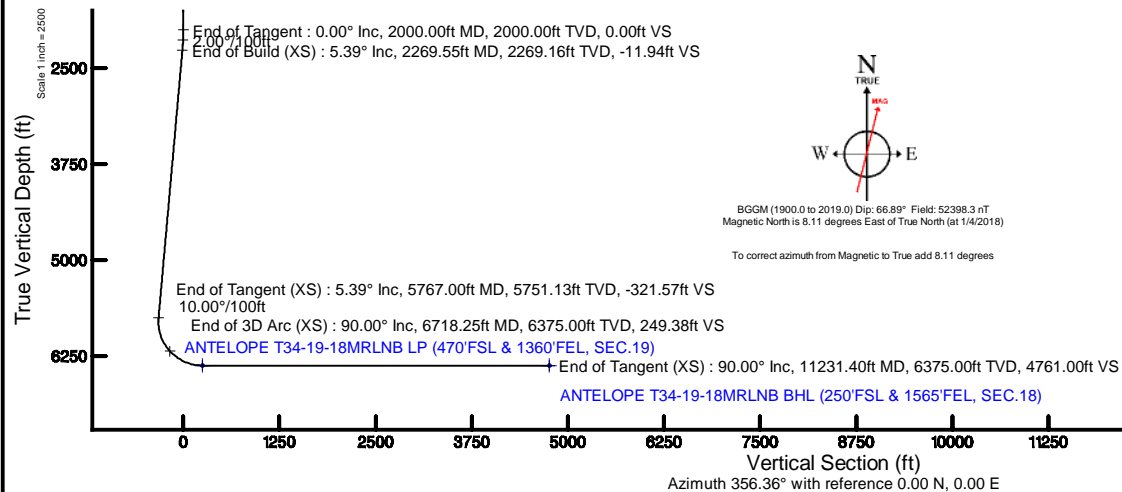



Planned Wellpath Report

ANTELOPE T34-19-18MRLNB PWP (REV-A.0)

Page 1 of 6



REFERENCE WELLPATH IDENTIFICATION

| | | | |
|----------|---------------------------|----------|--|
| Operator | BONANZA CREEK OIL COMPANY | Slot | SLOT#04 ANTELOPE T34-19-18MRLNB (225'FSL & 1228'FEL, SEC.19) |
| Area | COLORADO | Well | ANTELOPE T34-19-18MRLNB |
| Field | WELD COUNTY | Wellbore | ANTELOPE T34-19-18MRLNB PWB |
| Facility | SEC.19-T05N-R62W | | |

REPORT SETUP INFORMATION

| | | | |
|---------------------|---|----------------------|--|
| Projection System | NAD83 / Lambert Colorado SP, Northern Zone (501), US feet | Software System | WellArchitect® 5.0 |
| North Reference | True | User | Ingmjmr |
| Scale | 0.999959 | Report Generated | 1/10/2018 at 12:11:22 PM |
| Convergence at slot | 0.74° East | Database/Source file | Denver/ANTELOPE_T34-19-18MRLNB_PWP__REV-A.0_.xml |

WELLPATH LOCATION

| | Local coordinates | | Grid coordinates | | Geographic coordinates | |
|-----------------------|-------------------|----------|------------------|-----------------|------------------------|-----------------|
| | North[ft] | East[ft] | Easting[US ft] | Northing[US ft] | Latitude | Longitude |
| Slot Location | -1.42 | -60.21 | 3317283.52 | 1382712.02 | 40°22'42.071"N | 104°21'40.018"W |
| Facility Reference Pt | | | 3317343.70 | 1382714.21 | 40°22'42.085"N | 104°21'39.240"W |
| Field Reference Pt | | | 3224525.77 | 1254425.87 | 40°01'44.400"N | 104°41'53.556"W |

WELLPATH DATUM

| | | | |
|--------------------------|-------------------|--|-------------------|
| Calculation method | Minimum curvature | RIG (17'KB) (RKB) to Facility Vertical Datum | 4675.00ft |
| Horizontal Reference Pt | Slot | RIG (17'KB) (RKB) to Mean Sea Level | 4675.00ft |
| Vertical Reference Pt | RIG (17'KB) (RKB) | RIG (17'KB) (RKB) to Mud Line at Slot (SLOT#04 ANTELOPE T34-19-18MRLNB (225'FSL & 1228'FEL, SEC.19)) | 4675.00ft |
| MD Reference Pt | RIG (17'KB) (RKB) | Section Origin | N 0.00, E 0.00 ft |
| Field Vertical Reference | Mean Sea Level | Section Azimuth | 356.36° |



Planned Wellpath Report

ANTELOPE T34-19-18MRLNB PWP (REV-A.0)

Page 2 of 6



| REFERENCE WELLPATH IDENTIFICATION | | | |
|-----------------------------------|---------------------------|----------|--|
| Operator | BONANZA CREEK OIL COMPANY | Slot | SLOT#04 ANTELOPE T34-19-18MRLNB (225'FSL & 1228'FEL, SEC.19) |
| Area | COLORADO | Well | ANTELOPE T34-19-18MRLNB |
| Field | WELD COUNTY | Wellbore | ANTELOPE T34-19-18MRLNB PWB |
| Facility | SEC.19-T05N-R62W | | |

| WELLPATH DATA (119 stations) † = interpolated/extrapolated station | | | | | | | | | | |
|--|--------------------|----------------|-------------|-------------------|---------------|--------------|----------------|-----------------|------------------|-------------------|
| MD [ft] | Inclination [°] | Azimuth [°] | TVD [ft] | Vert Sect [ft] | North [ft] | East [ft] | Latitude | Longitude | DLS [°/100ft] | Comments |
| 0.00† | 0.000 | 195.927 | 0.00 | 0.00 | 0.00 | 0.00 | 40°22'42.071"N | 104°21'40.018"W | 0.00 | |
| 17.00 | 0.000 | 195.927 | 17.00 | 0.00 | 0.00 | 0.00 | 40°22'42.071"N | 104°21'40.018"W | 0.00 | Tie On |
| 117.00† | 0.000 | 195.927 | 117.00 | 0.00 | 0.00 | 0.00 | 40°22'42.071"N | 104°21'40.018"W | 0.00 | |
| 217.00† | 0.000 | 195.927 | 217.00 | 0.00 | 0.00 | 0.00 | 40°22'42.071"N | 104°21'40.018"W | 0.00 | |
| 317.00† | 0.000 | 195.927 | 317.00 | 0.00 | 0.00 | 0.00 | 40°22'42.071"N | 104°21'40.018"W | 0.00 | |
| 417.00† | 0.000 | 195.927 | 417.00 | 0.00 | 0.00 | 0.00 | 40°22'42.071"N | 104°21'40.018"W | 0.00 | |
| 517.00† | 0.000 | 195.927 | 517.00 | 0.00 | 0.00 | 0.00 | 40°22'42.071"N | 104°21'40.018"W | 0.00 | |
| 617.00† | 0.000 | 195.927 | 617.00 | 0.00 | 0.00 | 0.00 | 40°22'42.071"N | 104°21'40.018"W | 0.00 | |
| 717.00† | 0.000 | 195.927 | 717.00 | 0.00 | 0.00 | 0.00 | 40°22'42.071"N | 104°21'40.018"W | 0.00 | |
| 817.00† | 0.000 | 195.927 | 817.00 | 0.00 | 0.00 | 0.00 | 40°22'42.071"N | 104°21'40.018"W | 0.00 | |
| 917.00† | 0.000 | 195.927 | 917.00 | 0.00 | 0.00 | 0.00 | 40°22'42.071"N | 104°21'40.018"W | 0.00 | |
| 1017.00† | 0.000 | 195.927 | 1017.00 | 0.00 | 0.00 | 0.00 | 40°22'42.071"N | 104°21'40.018"W | 0.00 | |
| 1117.00† | 0.000 | 195.927 | 1117.00 | 0.00 | 0.00 | 0.00 | 40°22'42.071"N | 104°21'40.018"W | 0.00 | |
| 1217.00† | 0.000 | 195.927 | 1217.00 | 0.00 | 0.00 | 0.00 | 40°22'42.071"N | 104°21'40.018"W | 0.00 | |
| 1317.00† | 0.000 | 195.927 | 1317.00 | 0.00 | 0.00 | 0.00 | 40°22'42.071"N | 104°21'40.018"W | 0.00 | |
| 1417.00† | 0.000 | 195.927 | 1417.00 | 0.00 | 0.00 | 0.00 | 40°22'42.071"N | 104°21'40.018"W | 0.00 | |
| 1517.00† | 0.000 | 195.927 | 1517.00 | 0.00 | 0.00 | 0.00 | 40°22'42.071"N | 104°21'40.018"W | 0.00 | |
| 1617.00† | 0.000 | 195.927 | 1617.00 | 0.00 | 0.00 | 0.00 | 40°22'42.071"N | 104°21'40.018"W | 0.00 | |
| 1717.00† | 0.000 | 195.927 | 1717.00 | 0.00 | 0.00 | 0.00 | 40°22'42.071"N | 104°21'40.018"W | 0.00 | |
| 1817.00† | 0.000 | 195.927 | 1817.00 | 0.00 | 0.00 | 0.00 | 40°22'42.071"N | 104°21'40.018"W | 0.00 | |
| 1917.00† | 0.000 | 195.927 | 1917.00 | 0.00 | 0.00 | 0.00 | 40°22'42.071"N | 104°21'40.018"W | 0.00 | |
| 2000.00 | 0.000 | 195.927 | 2000.00 | 0.00 | 0.00 | 0.00 | 40°22'42.071"N | 104°21'40.018"W | 0.00 | End of Tangent |
| 2017.00† | 0.340 | 195.927 | 2017.00 | -0.05 | -0.05 | -0.01 | 40°22'42.071"N | 104°21'40.018"W | 2.00 | |
| 2117.00† | 2.340 | 195.927 | 2116.97 | -2.25 | -2.30 | -0.66 | 40°22'42.048"N | 104°21'40.026"W | 2.00 | |
| 2217.00† | 4.340 | 195.927 | 2216.79 | -7.74 | -7.90 | -2.25 | 40°22'41.993"N | 104°21'40.047"W | 2.00 | |
| 2269.55 | 5.391 | 195.927 | 2269.16 | -11.94 | -12.19 | -3.48 | 40°22'41.951"N | 104°21'40.063"W | 2.00 | End of Build (XS) |
| 2317.00† | 5.391 | 195.927 | 2316.39 | -16.14 | -16.47 | -4.70 | 40°22'41.908"N | 104°21'40.079"W | 0.00 | |
| 2417.00† | 5.391 | 195.927 | 2415.95 | -24.99 | -25.51 | -7.28 | 40°22'41.819"N | 104°21'40.112"W | 0.00 | |
| 2517.00† | 5.391 | 195.927 | 2515.51 | -33.85 | -34.54 | -9.86 | 40°22'41.730"N | 104°21'40.145"W | 0.00 | |
| 2617.00† | 5.391 | 195.927 | 2615.07 | -42.70 | -43.58 | -12.44 | 40°22'41.640"N | 104°21'40.179"W | 0.00 | |



Planned Wellpath Report

ANTELOPE T34-19-18MRLNB PWP (REV-A.0)

Page 3 of 6



| REFERENCE WELLPATH IDENTIFICATION | | | |
|-----------------------------------|---------------------------|----------|--|
| Operator | BONANZA CREEK OIL COMPANY | Slot | SLOT#04 ANTELOPE T34-19-18MRLNB (225'FSL & 1228'FEL, SEC.19) |
| Area | COLORADO | Well | ANTELOPE T34-19-18MRLNB |
| Field | WELD COUNTY | Wellbore | ANTELOPE T34-19-18MRLNB PWB |
| Facility | SEC.19-T05N-R62W | | |

| WELLPATH DATA (119 stations) † = interpolated/extrapolated station | | | | | | | | | | |
|--|--------------------|----------------|-------------|-------------------|---------------|--------------|----------------|-----------------|------------------|----------|
| MD [ft] | Inclination [°] | Azimuth [°] | TVD [ft] | Vert Sect [ft] | North [ft] | East [ft] | Latitude | Longitude | DLS [°/100ft] | Comments |
| 2717.00† | 5.391 | 195.927 | 2714.62 | -51.55 | -52.61 | -15.01 | 40°22'41.551"N | 104°21'40.212"W | 0.00 | |
| 2817.00† | 5.391 | 195.927 | 2814.18 | -60.41 | -61.65 | -17.59 | 40°22'41.462"N | 104°21'40.245"W | 0.00 | |
| 2917.00† | 5.391 | 195.927 | 2913.74 | -69.26 | -70.68 | -20.17 | 40°22'41.373"N | 104°21'40.279"W | 0.00 | |
| 3017.00† | 5.391 | 195.927 | 3013.30 | -78.11 | -79.72 | -22.75 | 40°22'41.283"N | 104°21'40.312"W | 0.00 | |
| 3117.00† | 5.391 | 195.927 | 3112.85 | -86.96 | -88.75 | -25.33 | 40°22'41.194"N | 104°21'40.345"W | 0.00 | |
| 3217.00† | 5.391 | 195.927 | 3212.41 | -95.82 | -97.78 | -27.90 | 40°22'41.105"N | 104°21'40.379"W | 0.00 | |
| 3317.00† | 5.391 | 195.927 | 3311.97 | -104.67 | -106.82 | -30.48 | 40°22'41.015"N | 104°21'40.412"W | 0.00 | |
| 3417.00† | 5.391 | 195.927 | 3411.53 | -113.52 | -115.85 | -33.06 | 40°22'40.926"N | 104°21'40.445"W | 0.00 | |
| 3517.00† | 5.391 | 195.927 | 3511.08 | -122.38 | -124.89 | -35.64 | 40°22'40.837"N | 104°21'40.478"W | 0.00 | |
| 3617.00† | 5.391 | 195.927 | 3610.64 | -131.23 | -133.92 | -38.22 | 40°22'40.748"N | 104°21'40.512"W | 0.00 | |
| 3717.00† | 5.391 | 195.927 | 3710.20 | -140.08 | -142.96 | -40.79 | 40°22'40.658"N | 104°21'40.545"W | 0.00 | |
| 3817.00† | 5.391 | 195.927 | 3809.76 | -148.94 | -151.99 | -43.37 | 40°22'40.569"N | 104°21'40.578"W | 0.00 | |
| 3917.00† | 5.391 | 195.927 | 3909.32 | -157.79 | -161.03 | -45.95 | 40°22'40.480"N | 104°21'40.612"W | 0.00 | |
| 4017.00† | 5.391 | 195.927 | 4008.87 | -166.64 | -170.06 | -48.53 | 40°22'40.391"N | 104°21'40.645"W | 0.00 | |
| 4117.00† | 5.391 | 195.927 | 4108.43 | -175.49 | -179.10 | -51.11 | 40°22'40.301"N | 104°21'40.678"W | 0.00 | |
| 4217.00† | 5.391 | 195.927 | 4207.99 | -184.35 | -188.13 | -53.69 | 40°22'40.212"N | 104°21'40.712"W | 0.00 | |
| 4317.00† | 5.391 | 195.927 | 4307.55 | -193.20 | -197.17 | -56.26 | 40°22'40.123"N | 104°21'40.745"W | 0.00 | |
| 4417.00† | 5.391 | 195.927 | 4407.10 | -202.05 | -206.20 | -58.84 | 40°22'40.033"N | 104°21'40.778"W | 0.00 | |
| 4517.00† | 5.391 | 195.927 | 4506.66 | -210.91 | -215.24 | -61.42 | 40°22'39.944"N | 104°21'40.812"W | 0.00 | |
| 4617.00† | 5.391 | 195.927 | 4606.22 | -219.76 | -224.27 | -64.00 | 40°22'39.855"N | 104°21'40.845"W | 0.00 | |
| 4717.00† | 5.391 | 195.927 | 4705.78 | -228.61 | -233.30 | -66.58 | 40°22'39.766"N | 104°21'40.878"W | 0.00 | |
| 4817.00† | 5.391 | 195.927 | 4805.33 | -237.46 | -242.34 | -69.15 | 40°22'39.676"N | 104°21'40.912"W | 0.00 | |
| 4917.00† | 5.391 | 195.927 | 4904.89 | -246.32 | -251.37 | -71.73 | 40°22'39.587"N | 104°21'40.945"W | 0.00 | |
| 5017.00† | 5.391 | 195.927 | 5004.45 | -255.17 | -260.41 | -74.31 | 40°22'39.498"N | 104°21'40.978"W | 0.00 | |
| 5117.00† | 5.391 | 195.927 | 5104.01 | -264.02 | -269.44 | -76.89 | 40°22'39.408"N | 104°21'41.011"W | 0.00 | |
| 5217.00† | 5.391 | 195.927 | 5203.56 | -272.88 | -278.48 | -79.47 | 40°22'39.319"N | 104°21'41.045"W | 0.00 | |
| 5317.00† | 5.391 | 195.927 | 5303.12 | -281.73 | -287.51 | -82.05 | 40°22'39.230"N | 104°21'41.078"W | 0.00 | |
| 5417.00† | 5.391 | 195.927 | 5402.68 | -290.58 | -296.55 | -84.62 | 40°22'39.141"N | 104°21'41.111"W | 0.00 | |
| 5517.00† | 5.391 | 195.927 | 5502.24 | -299.44 | -305.58 | -87.20 | 40°22'39.051"N | 104°21'41.145"W | 0.00 | |
| 5617.00† | 5.391 | 195.927 | 5601.80 | -308.29 | -314.62 | -89.78 | 40°22'38.962"N | 104°21'41.178"W | 0.00 | |



Planned Wellpath Report

ANTELOPE T34-19-18MRLNB PWP (REV-A.0)

Page 4 of 6



| REFERENCE WELLPATH IDENTIFICATION | | | |
|-----------------------------------|---------------------------|----------|--|
| Operator | BONANZA CREEK OIL COMPANY | Slot | SLOT#04 ANTELOPE T34-19-18MRLNB (225'FSL & 1228'FEL, SEC.19) |
| Area | COLORADO | Well | ANTELOPE T34-19-18MRLNB |
| Field | WELD COUNTY | Wellbore | ANTELOPE T34-19-18MRLNB PWB |
| Facility | SEC.19-T05N-R62W | | |

| WELLPATH DATA (119 stations) † = interpolated/extrapolated station | | | | | | | | | | |
|--|--------------------|----------------|-------------|-------------------|---------------|--------------|----------------|-----------------|------------------|---------------------|
| MD [ft] | Inclination [°] | Azimuth [°] | TVD [ft] | Vert Sect [ft] | North [ft] | East [ft] | Latitude | Longitude | DLS [°/100ft] | Comments |
| 5717.00† | 5.391 | 195.927 | 5701.35 | -317.14 | -323.65 | -92.36 | 40°22'38.873"N | 104°21'41.211"W | 0.00 | |
| 5767.00 | 5.391 | 195.927 | 5751.13 | -321.57 | -328.17 | -93.65 | 40°22'38.828"N | 104°21'41.228"W | 0.00 | End of Tangent (XS) |
| 5817.00† | 1.681 | 263.606 | 5801.04 | -323.82 | -330.51 | -95.02 | 40°22'38.805"N | 104°21'41.246"W | 10.00 | |
| 5917.00† | 10.015 | 348.316 | 5900.51 | -315.26 | -322.14 | -98.25 | 40°22'38.888"N | 104°21'41.287"W | 10.00 | |
| 6017.00† | 19.943 | 353.230 | 5997.00 | -289.55 | -296.62 | -102.03 | 40°22'39.140"N | 104°21'41.336"W | 10.00 | |
| 6117.00† | 29.918 | 354.941 | 6087.56 | -247.49 | -254.74 | -106.25 | 40°22'39.554"N | 104°21'41.391"W | 10.00 | |
| 6217.00† | 39.905 | 355.851 | 6169.47 | -190.34 | -197.76 | -110.78 | 40°22'40.117"N | 104°21'41.449"W | 10.00 | |
| 6317.00† | 49.896 | 356.444 | 6240.21 | -119.84 | -127.42 | -115.49 | 40°22'40.812"N | 104°21'41.510"W | 10.00 | |
| 6417.00† | 59.890 | 356.884 | 6297.65 | -38.14 | -45.86 | -120.22 | 40°22'41.618"N | 104°21'41.571"W | 10.00 | |
| 6517.00† | 69.884 | 357.243 | 6340.03 | 52.29 | 44.46 | -124.84 | 40°22'42.510"N | 104°21'41.631"W | 10.00 | |
| 6617.00† | 79.880 | 357.558 | 6366.08 | 148.69 | 140.78 | -129.21 | 40°22'43.462"N | 104°21'41.688"W | 10.00 | |
| 6717.00† | 89.875 | 357.853 | 6375.00 | 248.14 | 240.17 | -133.19 | 40°22'44.444"N | 104°21'41.739"W | 10.00 | |
| 6718.25 | 90.000 | 357.857 | 6375.00† | 249.38 | 241.42 | -133.24 | 40°22'44.457"N | 104°21'41.740"W | 10.00 | End of 3D Arc (XS) |
| 6817.00† | 90.000 | 357.857 | 6375.00 | 348.10 | 340.10 | -136.93 | 40°22'45.432"N | 104°21'41.787"W | 0.00 | |
| 6917.00† | 90.000 | 357.857 | 6375.00 | 448.07 | 440.03 | -140.67 | 40°22'46.419"N | 104°21'41.836"W | 0.00 | |
| 7017.00† | 90.000 | 357.857 | 6375.00 | 548.03 | 539.96 | -144.41 | 40°22'47.407"N | 104°21'41.884"W | 0.00 | |
| 7117.00† | 90.000 | 357.857 | 6375.00 | 648.00 | 639.89 | -148.15 | 40°22'48.394"N | 104°21'41.932"W | 0.00 | |
| 7217.00† | 90.000 | 357.857 | 6375.00 | 747.97 | 739.82 | -151.89 | 40°22'49.382"N | 104°21'41.981"W | 0.00 | |
| 7317.00† | 90.000 | 357.857 | 6375.00 | 847.93 | 839.75 | -155.63 | 40°22'50.369"N | 104°21'42.029"W | 0.00 | |
| 7417.00† | 90.000 | 357.857 | 6375.00 | 947.90 | 939.68 | -159.37 | 40°22'51.357"N | 104°21'42.077"W | 0.00 | |
| 7517.00† | 90.000 | 357.857 | 6375.00 | 1047.86 | 1039.61 | -163.10 | 40°22'52.344"N | 104°21'42.126"W | 0.00 | |
| 7617.00† | 90.000 | 357.857 | 6375.00 | 1147.83 | 1139.54 | -166.84 | 40°22'53.332"N | 104°21'42.174"W | 0.00 | |
| 7717.00† | 90.000 | 357.857 | 6375.00 | 1247.80 | 1239.47 | -170.58 | 40°22'54.319"N | 104°21'42.222"W | 0.00 | |
| 7817.00† | 90.000 | 357.857 | 6375.00 | 1347.76 | 1339.40 | -174.32 | 40°22'55.307"N | 104°21'42.271"W | 0.00 | |
| 7917.00† | 90.000 | 357.857 | 6375.00 | 1447.73 | 1439.33 | -178.06 | 40°22'56.294"N | 104°21'42.319"W | 0.00 | |
| 8017.00† | 90.000 | 357.857 | 6375.00 | 1547.69 | 1539.26 | -181.80 | 40°22'57.281"N | 104°21'42.367"W | 0.00 | |
| 8117.00† | 90.000 | 357.857 | 6375.00 | 1647.66 | 1639.19 | -185.54 | 40°22'58.269"N | 104°21'42.416"W | 0.00 | |
| 8217.00† | 90.000 | 357.857 | 6375.00 | 1747.63 | 1739.12 | -189.28 | 40°22'59.256"N | 104°21'42.464"W | 0.00 | |
| 8317.00† | 90.000 | 357.857 | 6375.00 | 1847.59 | 1839.05 | -193.02 | 40°23'00.244"N | 104°21'42.512"W | 0.00 | |
| 8417.00† | 90.000 | 357.857 | 6375.00 | 1947.56 | 1938.98 | -196.76 | 40°23'01.231"N | 104°21'42.561"W | 0.00 | |



Planned Wellpath Report

ANTELOPE T34-19-18MRLNB PWP (REV-A.0)

Page 5 of 6



| REFERENCE WELLPATH IDENTIFICATION | | | |
|-----------------------------------|---------------------------|----------|--|
| Operator | BONANZA CREEK OIL COMPANY | Slot | SLOT#04 ANTELOPE T34-19-18MRLNB (225'FSL & 1228'FEL, SEC.19) |
| Area | COLORADO | Well | ANTELOPE T34-19-18MRLNB |
| Field | WELD COUNTY | Wellbore | ANTELOPE T34-19-18MRLNB PWB |
| Facility | SEC.19-T05N-R62W | | |

| WELLPATH DATA (119 stations) † = interpolated/extrapolated station | | | | | | | | | | |
|--|--------------------|----------------|----------------------|-------------------|---------------|--------------|----------------|-----------------|------------------|---------------------|
| MD [ft] | Inclination [°] | Azimuth [°] | TVD [ft] | Vert Sect [ft] | North [ft] | East [ft] | Latitude | Longitude | DLS [°/100ft] | Comments |
| 8517.00† | 90.000 | 357.857 | 6375.00 | 2047.52 | 2038.91 | -200.50 | 40°23'02.219"N | 104°21'42.609"W | 0.00 | |
| 8617.00† | 90.000 | 357.857 | 6375.00 | 2147.49 | 2138.84 | -204.24 | 40°23'03.206"N | 104°21'42.657"W | 0.00 | |
| 8717.00† | 90.000 | 357.857 | 6375.00 | 2247.46 | 2238.77 | -207.98 | 40°23'04.194"N | 104°21'42.706"W | 0.00 | |
| 8817.00† | 90.000 | 357.857 | 6375.00 | 2347.42 | 2338.70 | -211.72 | 40°23'05.181"N | 104°21'42.754"W | 0.00 | |
| 8917.00† | 90.000 | 357.857 | 6375.00 | 2447.39 | 2438.63 | -215.46 | 40°23'06.169"N | 104°21'42.802"W | 0.00 | |
| 9017.00† | 90.000 | 357.857 | 6375.00 | 2547.35 | 2538.56 | -219.20 | 40°23'07.156"N | 104°21'42.851"W | 0.00 | |
| 9117.00† | 90.000 | 357.857 | 6375.00 | 2647.32 | 2638.49 | -222.94 | 40°23'08.144"N | 104°21'42.899"W | 0.00 | |
| 9217.00† | 90.000 | 357.857 | 6375.00 | 2747.29 | 2738.42 | -226.68 | 40°23'09.131"N | 104°21'42.947"W | 0.00 | |
| 9317.00† | 90.000 | 357.857 | 6375.00 | 2847.25 | 2838.35 | -230.42 | 40°23'10.119"N | 104°21'42.996"W | 0.00 | |
| 9417.00† | 90.000 | 357.857 | 6375.00 | 2947.22 | 2938.28 | -234.15 | 40°23'11.106"N | 104°21'43.044"W | 0.00 | |
| 9517.00† | 90.000 | 357.857 | 6375.00 | 3047.18 | 3038.21 | -237.89 | 40°23'12.094"N | 104°21'43.092"W | 0.00 | |
| 9617.00† | 90.000 | 357.857 | 6375.00 | 3147.15 | 3138.14 | -241.63 | 40°23'13.081"N | 104°21'43.141"W | 0.00 | |
| 9717.00† | 90.000 | 357.857 | 6375.00 | 3247.12 | 3238.07 | -245.37 | 40°23'14.069"N | 104°21'43.189"W | 0.00 | |
| 9817.00† | 90.000 | 357.857 | 6375.00 | 3347.08 | 3338.00 | -249.11 | 40°23'15.056"N | 104°21'43.237"W | 0.00 | |
| 9917.00† | 90.000 | 357.857 | 6375.00 | 3447.05 | 3437.93 | -252.85 | 40°23'16.043"N | 104°21'43.286"W | 0.00 | |
| 10017.00† | 90.000 | 357.857 | 6375.00 | 3547.01 | 3537.86 | -256.59 | 40°23'17.031"N | 104°21'43.334"W | 0.00 | |
| 10117.00† | 90.000 | 357.857 | 6375.00 | 3646.98 | 3637.79 | -260.33 | 40°23'18.018"N | 104°21'43.382"W | 0.00 | |
| 10217.00† | 90.000 | 357.857 | 6375.00 | 3746.95 | 3737.72 | -264.07 | 40°23'19.006"N | 104°21'43.431"W | 0.00 | |
| 10317.00† | 90.000 | 357.857 | 6375.00 | 3846.91 | 3837.65 | -267.81 | 40°23'19.993"N | 104°21'43.479"W | 0.00 | |
| 10417.00† | 90.000 | 357.857 | 6375.00 | 3946.88 | 3937.58 | -271.55 | 40°23'20.981"N | 104°21'43.527"W | 0.00 | |
| 10517.00† | 90.000 | 357.857 | 6375.00 | 4046.84 | 4037.51 | -275.29 | 40°23'21.968"N | 104°21'43.576"W | 0.00 | |
| 10617.00† | 90.000 | 357.857 | 6375.00 | 4146.81 | 4137.44 | -279.03 | 40°23'22.956"N | 104°21'43.624"W | 0.00 | |
| 10717.00† | 90.000 | 357.857 | 6375.00 | 4246.78 | 4237.37 | -282.77 | 40°23'23.943"N | 104°21'43.672"W | 0.00 | |
| 10817.00† | 90.000 | 357.857 | 6375.00 | 4346.74 | 4337.30 | -286.51 | 40°23'24.931"N | 104°21'43.721"W | 0.00 | |
| 10917.00† | 90.000 | 357.857 | 6375.00 | 4446.71 | 4437.23 | -290.25 | 40°23'25.918"N | 104°21'43.769"W | 0.00 | |
| 11017.00† | 90.000 | 357.857 | 6375.00 | 4546.67 | 4537.16 | -293.99 | 40°23'26.906"N | 104°21'43.817"W | 0.00 | |
| 11117.00† | 90.000 | 357.857 | 6375.00 | 4646.64 | 4637.09 | -297.73 | 40°23'27.893"N | 104°21'43.866"W | 0.00 | |
| 11217.00† | 90.000 | 357.857 | 6375.00 | 4746.61 | 4737.02 | -301.47 | 40°23'28.881"N | 104°21'43.914"W | 0.00 | |
| 11231.40 | 90.000 | 357.857 | 6375.00 ² | 4761.00 | 4751.42 | -302.00 | 40°23'29.023"N | 104°21'43.921"W | 0.00 | End of Tangent (XS) |

| HOLE & CASING SECTIONS - Ref Wellbore: ANTELOPE T34-19-18MRLNB PWB Ref Wellpath: ANTELOPE T34-19-18MRLNB PWP (REV-A.0) | | | | | | | | | |
|---|------------------|----------------|------------------|-------------------|-----------------|-------------------|-------------------|-----------------|-----------------|
| String/Diameter | Start MD [ft] | End MD [ft] | Interval [ft] | Start TVD [ft] | End TVD [ft] | Start N/S [ft] | Start E/W [ft] | End N/S [ft] | End E/W [ft] |
| 9.625in Casing Surface | 17.00 | 1550.00 | 1533.00 | 17.00 | 1550.00 | 0.00 | 0.00 | 0.00 | 0.00 |
| 8.5in Open Hole | 1550.00 | 11231.40 | 9681.40 | 1550.00 | 6375.00 | 0.00 | 0.00 | 4751.41 | -302.00 |

| TARGETS | | | | | | | | | |
|--|------------|-------------|---------------|--------------|----------------------|-----------------------|----------------|-----------------|---------|
| Name | MD [ft] | TVD [ft] | North [ft] | East [ft] | Grid East [US ft] | Grid North [US ft] | Latitude | Longitude | Shape |
| SEC.18-T05N-R62W | | 0.00 | 1.42 | 60.21 | 3317343.70 | 1382714.21 | 40°22'42.085"N | 104°21'39.240"W | polygon |
| | | | | | | | | | |
| SEC.19-T05N-R62W | | 0.00 | 1.42 | 60.21 | 3317343.70 | 1382714.21 | 40°22'42.085"N | 104°21'39.240"W | polygon |
| | | | | | | | | | |
| 2) ANTELOPE T34-19-18MRLNB BHL (250'FSL & 1565'FEL, SEC.18) | 11231.40 | 6375.00 | 4751.42 | -302.00 | 3316920.53 | 1387458.96 | 40°23'29.023"N | 104°21'43.921"W | point |
| | | | | | | | | | |
| 1) ANTELOPE T34-19-18MRLNB LP (470'FSL & 1360'FEL, SEC.19) | 6718.25 | 6375.00 | 241.42 | -133.24 | 3317147.20 | 1382951.69 | 40°22'44.457"N | 104°21'41.740"W | point |
| | | | | | | | | | |
| SEC.18/19-T05N-R62W (460'SETBACK) | | 6475.00 | 1.42 | 60.21 | 3317343.70 | 1382714.21 | 40°22'42.085"N | 104°21'39.240"W | polygon |
| | | | | | | | | | |

| SURVEY PROGRAM - Ref Wellbore: ANTELOPE T34-19-18MRLNB PWB Ref Wellpath: ANTELOPE T34-19-18MRLNB PWP (REV-A.0) | | | | |
|---|----------------|--|------------------|-----------------------------|
| Start MD [ft] | End MD [ft] | Positional Uncertainty Model | Log Name/Comment | Wellbore |
| 17.00 | 1550.00 | Custom BHI NaviTrak (Standard Rotating+Axial Corr) (Rockies 0.03Gt model) | | ANTELOPE T34-19-18MRLNB PWB |
| 1550.00 | 11231.40 | Custom BHI AutoTrak Curve (Axial Corr, Short spacing) (Rockies 0.03Gt model) | | ANTELOPE T34-19-18MRLNB PWB |



Planned Wellpath Report

ANTELOPE T34-19-18MRLNB PWP (REV-A.0)

Page 6 of 6



| REFERENCE WELLPATH IDENTIFICATION | | | |
|-----------------------------------|---------------------------|----------|--|
| Operator | BONANZA CREEK OIL COMPANY | Slot | SLOT#04 ANTELOPE T34-19-18MRLNB (225'FSL & 1228'FEL, SEC.19) |
| Area | COLORADO | Well | ANTELOPE T34-19-18MRLNB |
| Field | WELD COUNTY | Wellbore | ANTELOPE T34-19-18MRLNB PWB |
| Facility | SEC.19-T05N-R62W | | |

| DESIGN COMMENTS | | | | |
|-----------------|--------------------|----------------|-------------|---------------------|
| MD [ft] | Inclination [°] | Azimuth [°] | TVD [ft] | Comment |
| 17.00 | 0.000 | 195.927 | 17.00 | Tie On |
| 2000.00 | 0.000 | 195.927 | 2000.00 | End of Tangent |
| 2269.55 | 5.391 | 195.927 | 2269.16 | End of Build (XS) |
| 5767.00 | 5.391 | 195.927 | 5751.13 | End of Tangent (XS) |
| 6718.25 | 90.000 | 357.857 | 6375.00 | End of 3D Arc (XS) |
| 11231.40 | 90.000 | 357.857 | 6375.00 | End of Tangent (XS) |