

SandRidge Exploration & Production, LLC  
CONSTRUCTION LAYOUT  
MARMOT 0880 S19 CTB  
SE1/4SE1/4 of Section 19, T8N, R80W, 6th P.M.,  
Jackson County, Colorado.

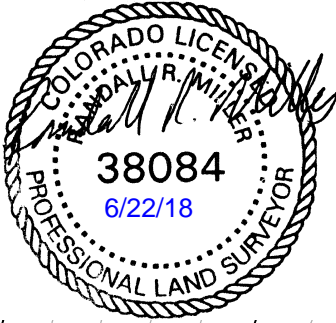

BASIS OF ELEVATION  
NAVD88 Computed using GE01D12B as measured  
using a combination of Static and Kinematic GPS  
based on an OPUS Solution Report.

Earthwork:  
Final Pad Elevation = 8104'  
Total Excavation - 51,349.4 Cu. Yd.  
Pad Fill/Borrow - 27,000.9 Cu. Yd.  
Berm/Stockpile - 24,348.5 Cu. Yd.  
Total Graded Area = 10.46 acres

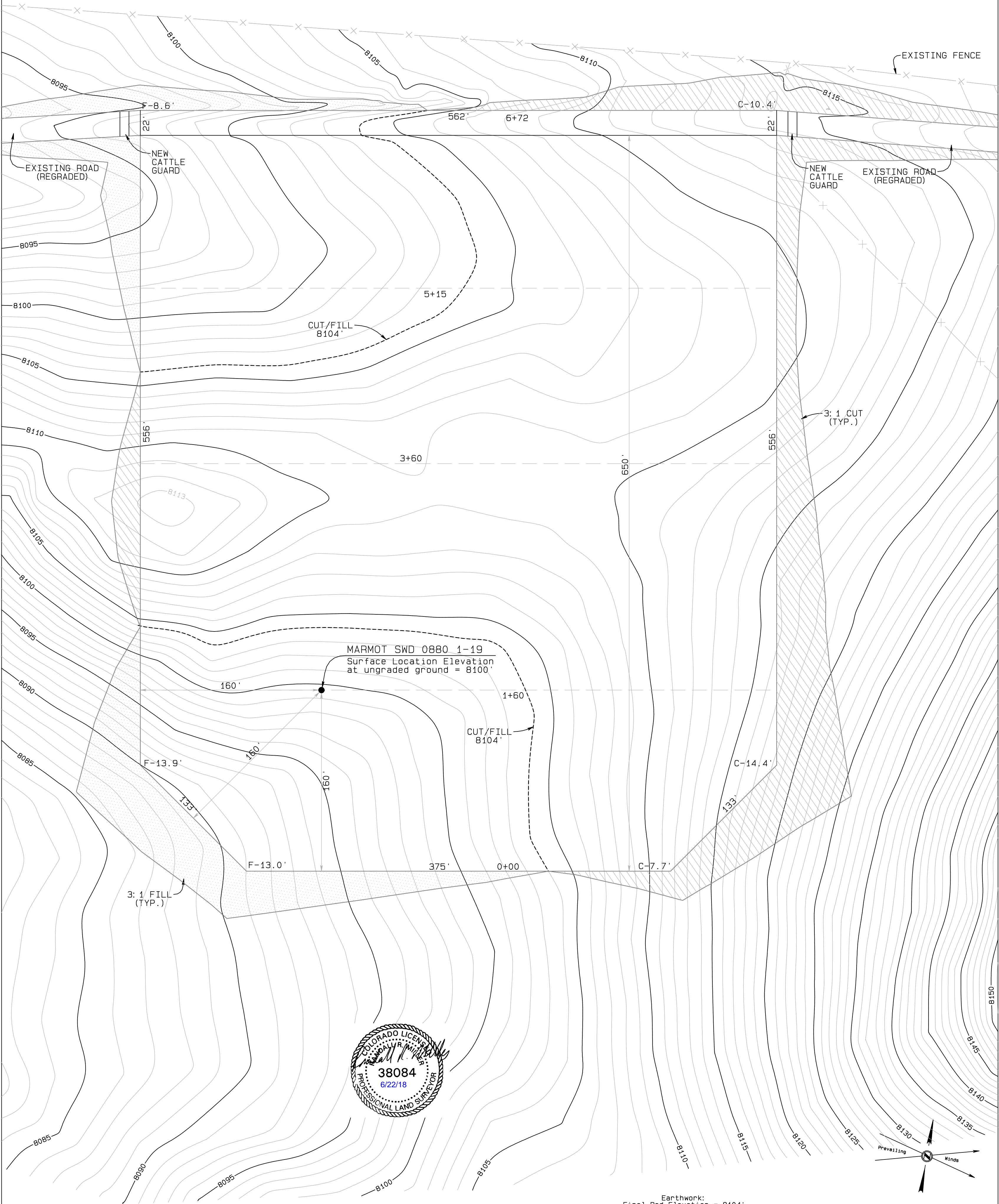
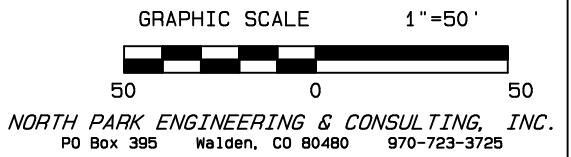

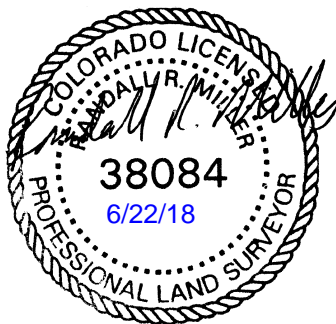
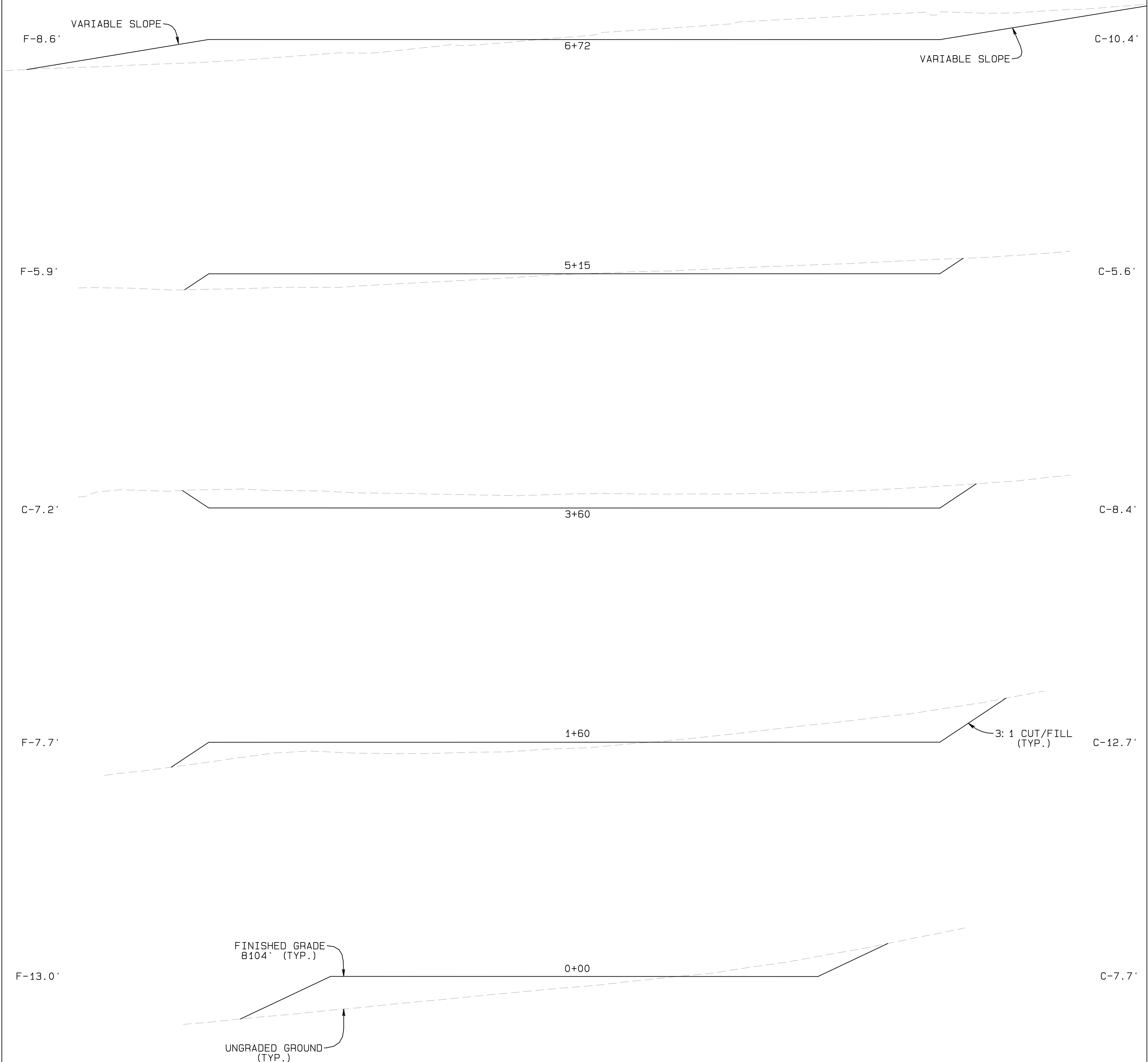

Vertical Exaggeration = 2 Times

BASIS OF ELEVATION  
NAVD88 Computed using GEIOD12B as measured  
using a combination of Static and Kinematic GPS  
based on an OPUS Solution Report.

GRAPHIC SCALE 1"=50'  
50 0 50  
NORTH PARK ENGINEERING & CONSULTING, INC.  
PO Box 395 Walden, CO 80480 970-723-3725

TYPICAL RIG LAYOUT  
MARMOT 0880 S19 PAD  
SE1/4SE1/4 of Section 19, T8N, R80W, 6th P.M.,  
Jackson County, Colorado.

