

Company Name: SandRidge Energy

PRU 0880 6-29H17

Jackson County, Colorado

Rig:

Created By: Shane Robbins

Date: 7/2/2018

PRU 0880 6-29H17

Jackson County, Colorado

Q180\*\*\* & RM-180\*\*\*

Design #1



WELL DETAILS: PRU 0880 6-29H17						
			8084.3			
+N/-S	+E/-W	Northing	Easting	Latitude	Longitude	
0.0	0.0	1473562.81	2751473.40	40° 37' 47.575 N	106° 23' 43.418 W	

PROJECT DETAILS: Jackson County, Colorado	
Geodetic System:	US State Plane 1983
Datum:	North American Datum 1983
Ellipsoid:	GRS 1980
Zone:	Colorado Northern Zone
System Datum:	Mean Sea Level

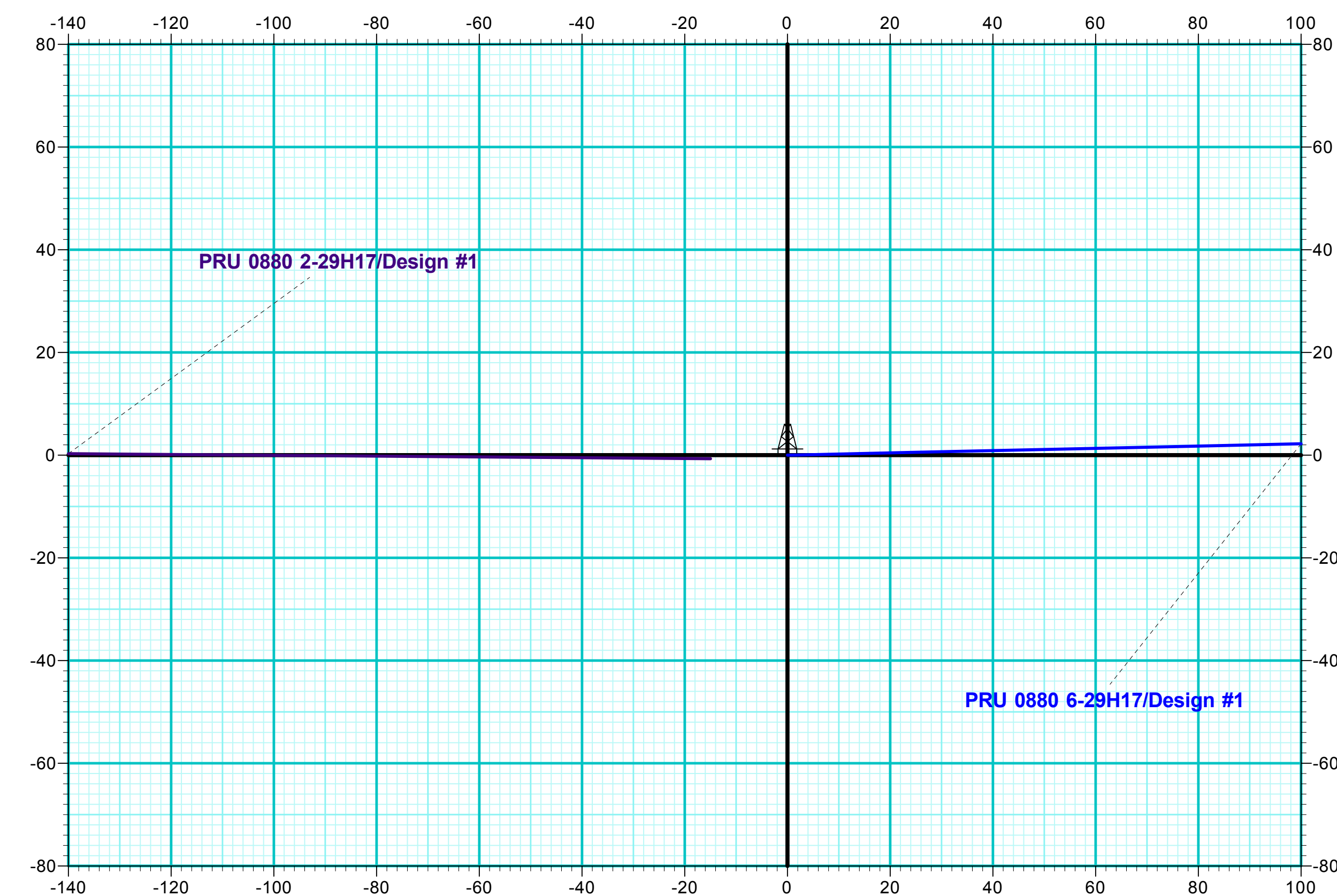
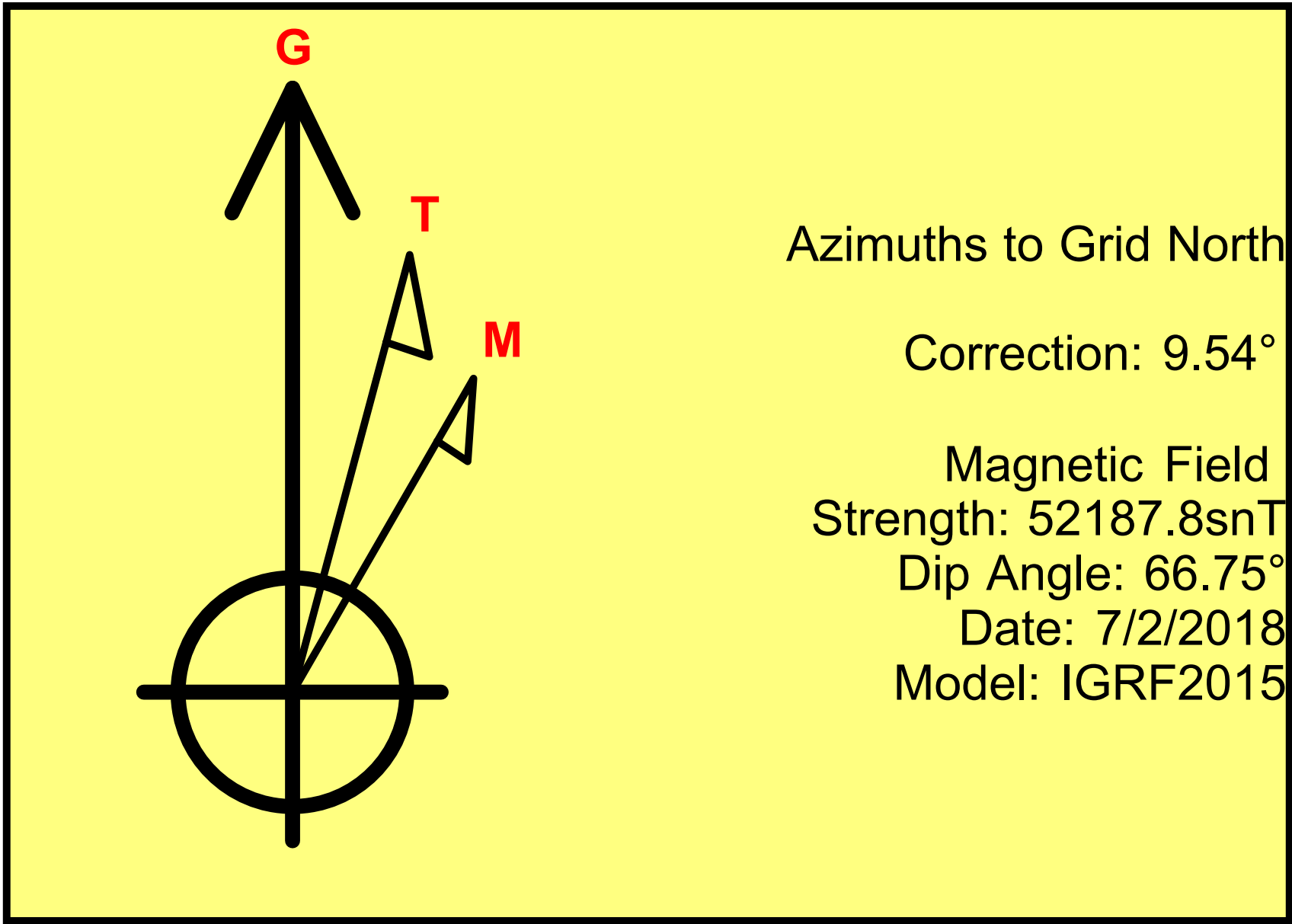

SECTION DETAILS										
Sec	MD	Inc	Azi	TVD	+N/-S	+E/-W	Dleg	TFace	VSect	Annotation
1	0.0	0.00	0.00	0.0	0.0	0.0	0.00	0.00	0.0	Build 2°/100'
2	2500.0	0.00	0.00	2500.0	0.0	0.0	0.00	0.00	0.0	
3	2895.8	7.72	88.72	2894.7	0.6	25.9	2.00	88.72	1.8	EOB @ 7.72° Inc / 88.72° Azm
4	6630.4	7.72	88.72	6595.3	11.8	528.6	0.00	0.00	36.2	Drop 2°/100'
5	7016.2	0.00	360.00	6980.0	12.4	554.5	2.00	180.00	38.0	VP PRU 0880 6-29H17
6	7941.2	92.50	0.20	7552.4	610.3	556.6	10.00	0.20	635.4	EOD @ Vertical
7	20320.2	92.50	0.20	7012.8	12977.4	600.1	0.00	0.00	12991.3	EOC @ 92.5° Inc / 2° Azm / 7552' TVD
										TD @ 20320' MD / 7013' TVD

DESIGN TARGET DETAILS							
Name	TVD	+N/-S	+E/-W	Northing	Easting	Latitude	Longitude
VP PRU 0880 6-29H17 - plan hits target center	6980.0	12.4	554.5	1473575.17	2752027.93	40° 37' 47.753 N	106° 23' 36.228 W
PBHL PRU 0880 6-29H17 - plan hits target center	7012.8	12977.4	600.1	1486540.25	2752073.52	40° 39' 55.864 N	106° 23' 37.331 W

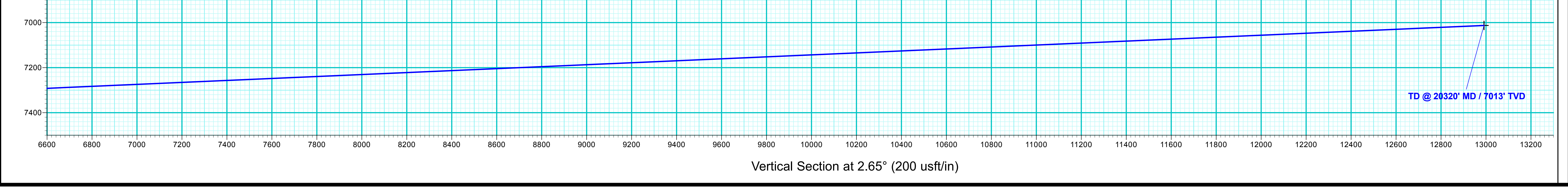
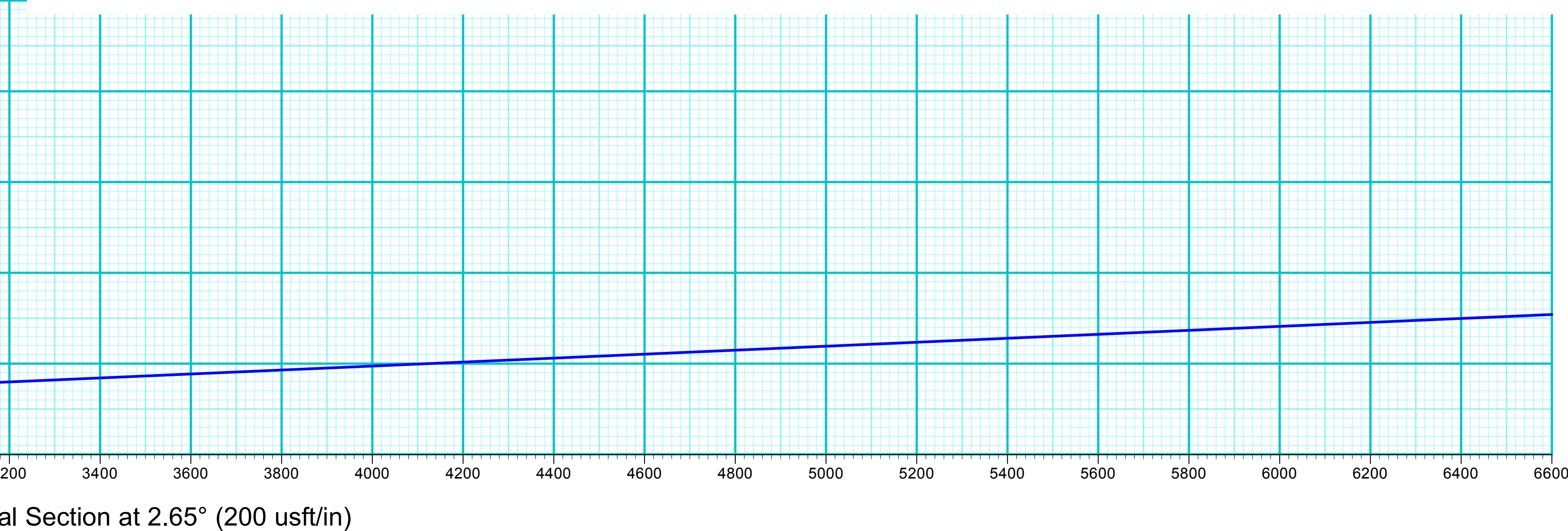
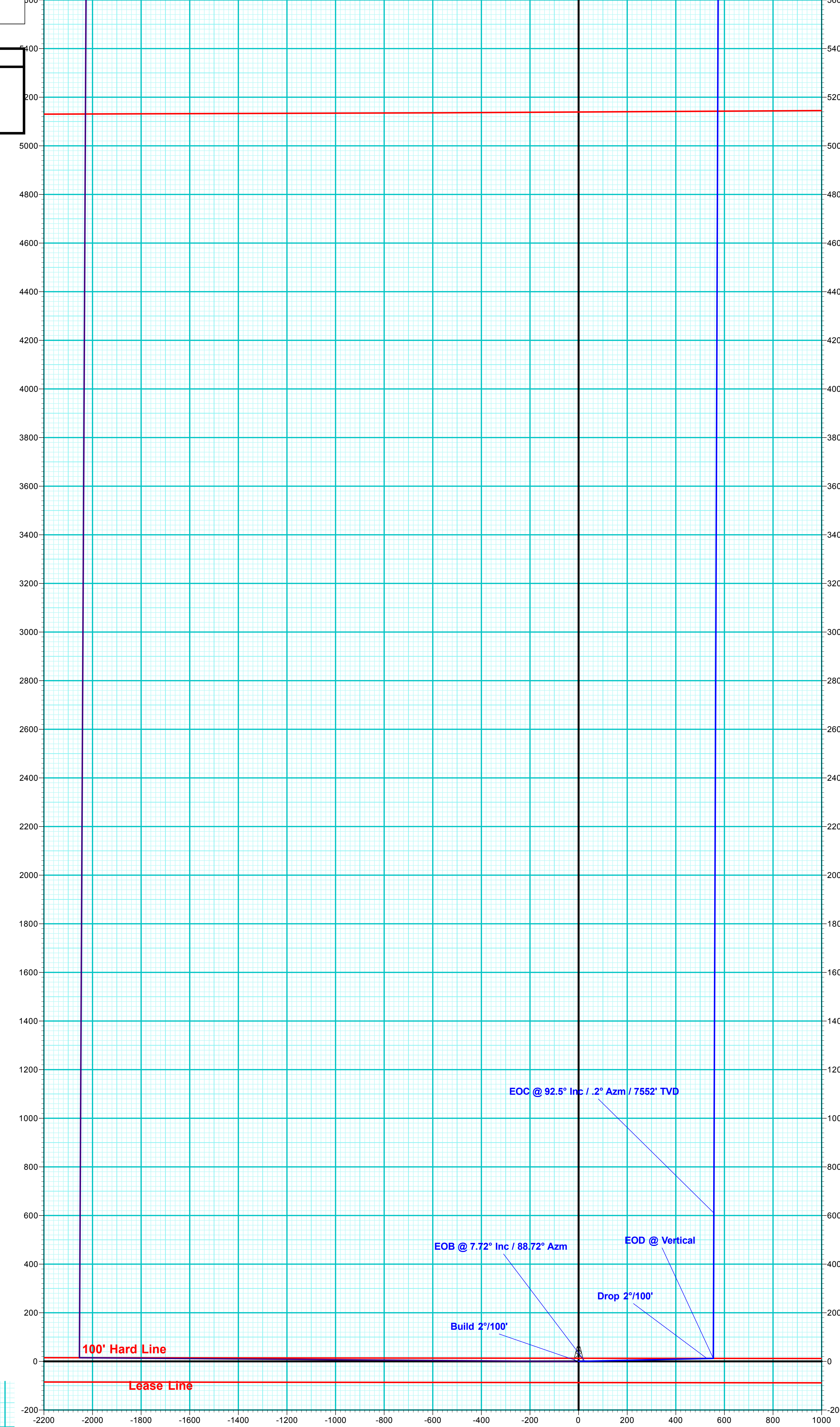
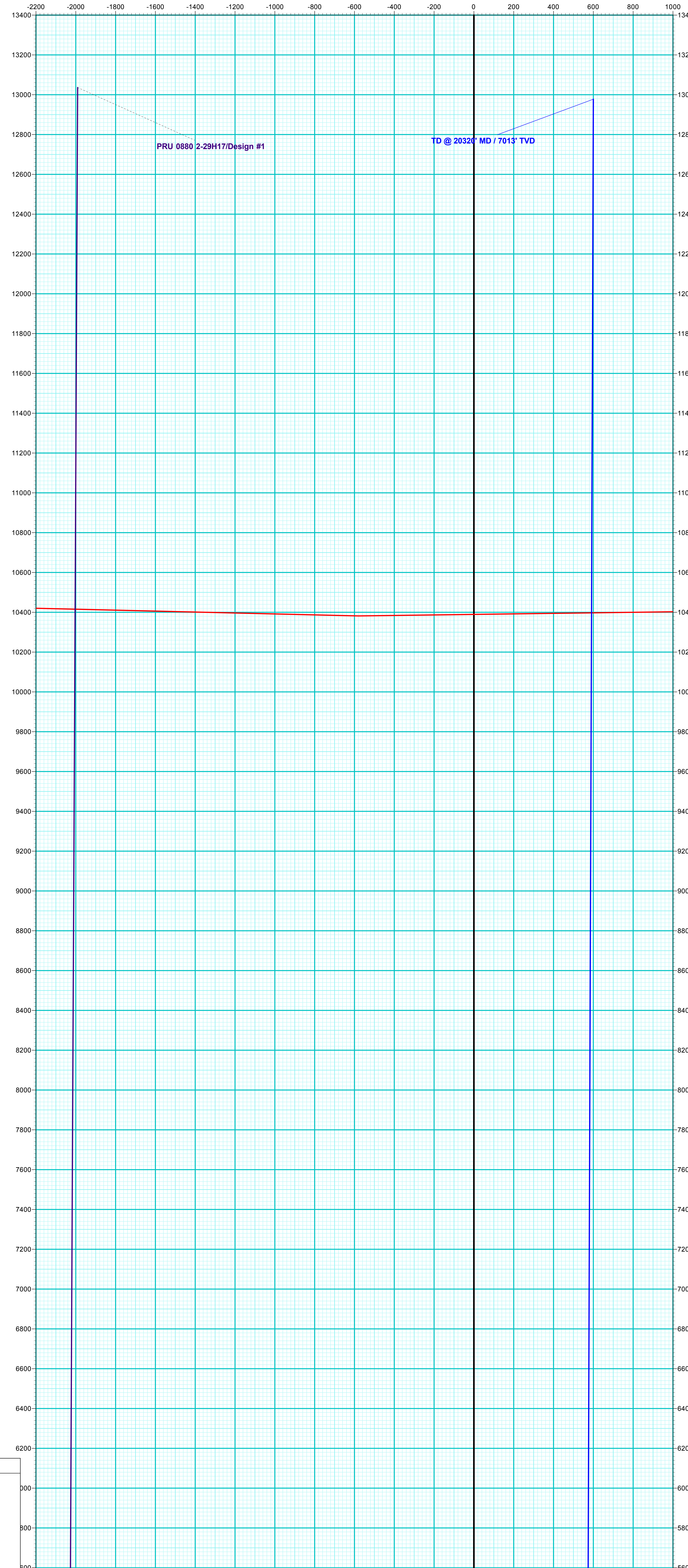
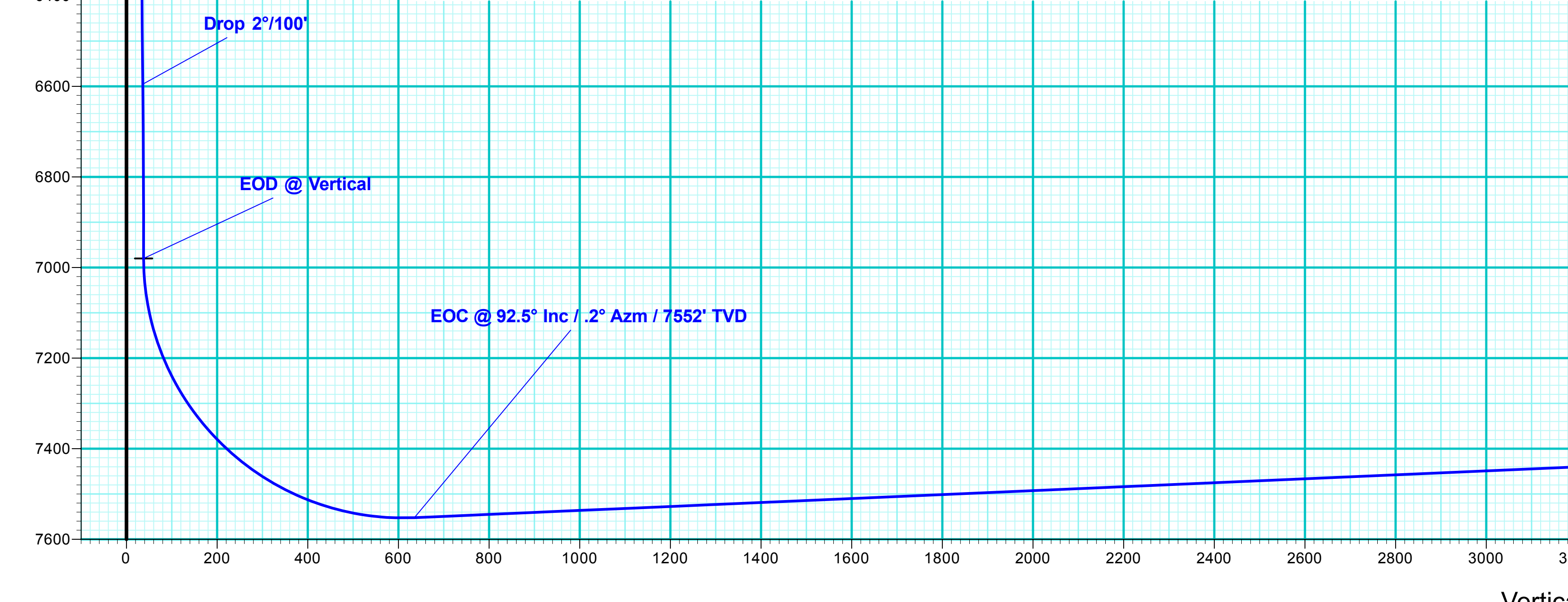
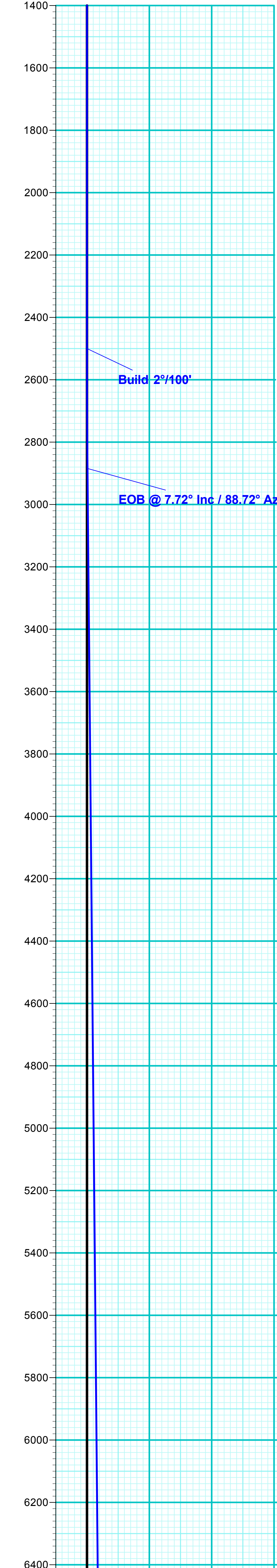

# **SandRidge Energy**

**Jackson County, Colorado  
Sec 29, T8N, R80W, 6th PM  
PRU 0880 6-29H17**

**Wellbore #1**

**Plan: Design #1**

## **QES Well Planning Report**

**02 July, 2018**





# Well Planning Report



<b>Database:</b>	EDM 5000.1 Single User Db	<b>Local Co-ordinate Reference:</b>	Well PRU 0880 6-29H17
<b>Company:</b>	SandRidge Energy	<b>TVD Reference:</b>	WELL @ 8109.3usft
<b>Project:</b>	Jackson County, Colorado	<b>MD Reference:</b>	WELL @ 8109.3usft
<b>Site:</b>	Sec 29, T8N, R80W, 6th PM	<b>North Reference:</b>	Grid
<b>Well:</b>	PRU 0880 6-29H17	<b>Survey Calculation Method:</b>	Minimum Curvature
<b>Wellbore:</b>	Wellbore #1		
<b>Design:</b>	Design #1		

Project	Jackson County, Colorado		
Map System:	US State Plane 1983	System Datum:	Mean Sea Level
Geo Datum:	North American Datum 1983		
Map Zone:	Colorado Northern Zone		

Site		Sec 29, T8N, R80W, 6th PM			
Site Position:		Northing:	1,473,562.81 usft	Latitude:	40° 37' 47.575 N
From:	Map	Easting:	2,751,473.40 usft	Longitude:	106° 23' 43.418 W
Position Uncertainty:	0.0 usft	Slot Radius:	13-3/16 "	Grid Convergence:	-0.58 °

Well	PRU 0880 6-29H17					
Well Position	+N/-S	0.0 usft	Northing:	1,473,562.81 usft	Latitude:	40° 37' 47.575 N
	+E/-W	0.0 usft	Easting:	2,751,473.40 usft	Longitude:	106° 23' 43.418 W
Position Uncertainty	0.0 usft		Wellhead Elevation:		Ground Level:	8,084.3 usft

Wellbore	Wellbore #1				
Magnetics	Model Name	Sample Date	Declination (°)	Dip Angle (°)	Field Strength (nT)
	IGRF2015	7/2/2018	8.96	66.75	52,187.78074673

Design	Design #1			
Audit Notes:				
Version:	Phase:	PLAN	Tie On Depth:	0.0
Vertical Section:	Depth From (TVD) (usft)	+N/-S (usft)	+E/-W (usft)	Direction (°)
	0.0	0.0	0.0	2.65

Plan Sections										
Measured Depth (usft)	Inclination (°)	Azimuth (°)	Vertical Depth (usft)	+N/-S (usft)	+E/-W (usft)	Dogleg Rate (°/100usft)	Build Rate (°/100usft)	Turn Rate (°/100usft)	TFO (°)	Target
0.0	0.00	0.00	0.0	0.0	0.0	0.00	0.00	0.00	0.00	
2,500.0	0.00	0.00	2,500.0	0.0	0.0	0.00	0.00	0.00	0.00	
2,885.8	7.72	88.72	2,884.7	0.6	25.9	2.00	2.00	0.00	88.72	
6,630.4	7.72	88.72	6,595.3	11.8	528.6	0.00	0.00	0.00	0.00	
7,016.2	0.00	360.00	6,980.0	12.4	554.5	2.00	-2.00	0.00	180.00	VP PRU 0880 6-29H17
7,941.2	92.50	0.20	7,552.4	610.3	556.6	10.00	10.00	0.02	0.20	
20,320.2	92.50	0.20	7,012.8	12,977.4	600.1	0.00	0.00	0.00	0.00	PBHL PRU 0880 6-29H17

# Well Planning Report



<b>Database:</b>	EDM 5000.1 Single User Db	<b>Local Co-ordinate Reference:</b>	Well PRU 0880 6-29H17
<b>Company:</b>	SandRidge Energy	<b>TVD Reference:</b>	WELL @ 8109.3usft
<b>Project:</b>	Jackson County, Colorado	<b>MD Reference:</b>	WELL @ 8109.3usft
<b>Site:</b>	Sec 29, T8N, R80W, 6th PM	<b>North Reference:</b>	Grid
<b>Well:</b>	PRU 0880 6-29H17	<b>Survey Calculation Method:</b>	Minimum Curvature
<b>Wellbore:</b>	Wellbore #1		
<b>Design:</b>	Design #1		

Planned Survey									
Measured Depth (usft)	Inclination (°)	Azimuth (°)	Vertical Depth (usft)	+N/-S (usft)	+E/-W (usft)	Vertical Section (usft)	Dogleg Rate (°/100usft)	Build Rate (°/100usft)	Turn Rate (°/100usft)
0.0	0.00	0.00	0.0	0.0	0.0	0.0	0.00	0.00	0.00
100.0	0.00	0.00	100.0	0.0	0.0	0.0	0.00	0.00	0.00
200.0	0.00	0.00	200.0	0.0	0.0	0.0	0.00	0.00	0.00
300.0	0.00	0.00	300.0	0.0	0.0	0.0	0.00	0.00	0.00
400.0	0.00	0.00	400.0	0.0	0.0	0.0	0.00	0.00	0.00
500.0	0.00	0.00	500.0	0.0	0.0	0.0	0.00	0.00	0.00
600.0	0.00	0.00	600.0	0.0	0.0	0.0	0.00	0.00	0.00
700.0	0.00	0.00	700.0	0.0	0.0	0.0	0.00	0.00	0.00
800.0	0.00	0.00	800.0	0.0	0.0	0.0	0.00	0.00	0.00
900.0	0.00	0.00	900.0	0.0	0.0	0.0	0.00	0.00	0.00
1,000.0	0.00	0.00	1,000.0	0.0	0.0	0.0	0.00	0.00	0.00
1,100.0	0.00	0.00	1,100.0	0.0	0.0	0.0	0.00	0.00	0.00
1,200.0	0.00	0.00	1,200.0	0.0	0.0	0.0	0.00	0.00	0.00
1,300.0	0.00	0.00	1,300.0	0.0	0.0	0.0	0.00	0.00	0.00
1,400.0	0.00	0.00	1,400.0	0.0	0.0	0.0	0.00	0.00	0.00
1,500.0	0.00	0.00	1,500.0	0.0	0.0	0.0	0.00	0.00	0.00
1,600.0	0.00	0.00	1,600.0	0.0	0.0	0.0	0.00	0.00	0.00
1,700.0	0.00	0.00	1,700.0	0.0	0.0	0.0	0.00	0.00	0.00
1,800.0	0.00	0.00	1,800.0	0.0	0.0	0.0	0.00	0.00	0.00
1,900.0	0.00	0.00	1,900.0	0.0	0.0	0.0	0.00	0.00	0.00
2,000.0	0.00	0.00	2,000.0	0.0	0.0	0.0	0.00	0.00	0.00
2,100.0	0.00	0.00	2,100.0	0.0	0.0	0.0	0.00	0.00	0.00
2,200.0	0.00	0.00	2,200.0	0.0	0.0	0.0	0.00	0.00	0.00
2,300.0	0.00	0.00	2,300.0	0.0	0.0	0.0	0.00	0.00	0.00
2,400.0	0.00	0.00	2,400.0	0.0	0.0	0.0	0.00	0.00	0.00
<b>Build 2°/100'</b>									
2,500.0	0.00	0.00	2,500.0	0.0	0.0	0.0	0.00	0.00	0.00
2,600.0	2.00	88.72	2,600.0	0.0	1.7	0.1	2.00	2.00	0.00
2,700.0	4.00	88.72	2,699.8	0.2	7.0	0.5	2.00	2.00	0.00
2,800.0	6.00	88.72	2,799.5	0.3	15.7	1.1	2.00	2.00	0.00
<b>EOB @ 7.72° Inc / 88.72° Azm</b>									
2,885.8	7.72	88.72	2,884.7	0.6	25.9	1.8	2.00	2.00	0.00
2,900.0	7.72	88.72	2,898.7	0.6	27.8	1.9	0.00	0.00	0.00
3,000.0	7.72	88.72	2,997.8	0.9	41.3	2.8	0.00	0.00	0.00
3,100.0	7.72	88.72	3,096.9	1.2	54.7	3.7	0.00	0.00	0.00
3,200.0	7.72	88.72	3,196.0	1.5	68.1	4.7	0.00	0.00	0.00
3,300.0	7.72	88.72	3,295.1	1.8	81.5	5.6	0.00	0.00	0.00
3,400.0	7.72	88.72	3,394.2	2.1	95.0	6.5	0.00	0.00	0.00
<b>LNCE</b>									
3,405.6	7.72	88.72	3,399.7	2.1	95.7	6.6	0.00	0.00	0.00
3,500.0	7.72	88.72	3,493.3	2.4	108.4	7.4	0.00	0.00	0.00
3,600.0	7.72	88.72	3,592.4	2.7	121.8	8.3	0.00	0.00	0.00
3,700.0	7.72	88.72	3,691.5	3.0	135.2	9.3	0.00	0.00	0.00
3,800.0	7.72	88.72	3,790.6	3.3	148.7	10.2	0.00	0.00	0.00
3,900.0	7.72	88.72	3,889.7	3.6	162.1	11.1	0.00	0.00	0.00
4,000.0	7.72	88.72	3,988.7	3.9	175.5	12.0	0.00	0.00	0.00
4,100.0	7.72	88.72	4,087.8	4.2	188.9	12.9	0.00	0.00	0.00
4,200.0	7.72	88.72	4,186.9	4.5	202.3	13.9	0.00	0.00	0.00
<b>FXHLS</b>									
4,242.8	7.72	88.72	4,229.4	4.6	208.1	14.2	0.00	0.00	0.00
4,300.0	7.72	88.72	4,286.0	4.8	215.8	14.8	0.00	0.00	0.00
4,400.0	7.72	88.72	4,385.1	5.1	229.2	15.7	0.00	0.00	0.00
<b>PIRR</b>									
4,464.8	7.72	88.72	4,449.3	5.3	237.9	16.3	0.00	0.00	0.00

# Well Planning Report



<b>Database:</b>	EDM 5000.1 Single User Db	<b>Local Co-ordinate Reference:</b>	Well PRU 0880 6-29H17
<b>Company:</b>	SandRidge Energy	<b>TVD Reference:</b>	WELL @ 8109.3usft
<b>Project:</b>	Jackson County, Colorado	<b>MD Reference:</b>	WELL @ 8109.3usft
<b>Site:</b>	Sec 29, T8N, R80W, 6th PM	<b>North Reference:</b>	Grid
<b>Well:</b>	PRU 0880 6-29H17	<b>Survey Calculation Method:</b>	Minimum Curvature
<b>Wellbore:</b>	Wellbore #1		
<b>Design:</b>	Design #1		

Planned Survey									
Measured Depth (usft)	Inclination (°)	Azimuth (°)	Vertical Depth (usft)	+N/-S (usft)	+E/-W (usft)	Vertical Section (usft)	Dogleg Rate (°/100usft)	Build Rate (°/100usft)	Turn Rate (°/100usft)
4,500.0	7.72	88.72	4,484.2	5.4	242.6	16.6	0.00	0.00	0.00
4,600.0	7.72	88.72	4,583.3	5.7	256.0	17.5	0.00	0.00	0.00
4,700.0	7.72	88.72	4,682.4	6.0	269.5	18.4	0.00	0.00	0.00
4,800.0	7.72	88.72	4,781.5	6.3	282.9	19.4	0.00	0.00	0.00
4,900.0	7.72	88.72	4,880.6	6.6	296.3	20.3	0.00	0.00	0.00
5,000.0	7.72	88.72	4,979.7	6.9	309.7	21.2	0.00	0.00	0.00
5,100.0	7.72	88.72	5,078.8	7.2	323.2	22.1	0.00	0.00	0.00
SSSX									
5,191.0	7.72	88.72	5,169.0	7.5	335.4	23.0	0.00	0.00	0.00
5,200.0	7.72	88.72	5,177.9	7.5	336.6	23.0	0.00	0.00	0.00
5,300.0	7.72	88.72	5,277.0	7.8	350.0	24.0	0.00	0.00	0.00
5,400.0	7.72	88.72	5,376.1	8.1	363.4	24.9	0.00	0.00	0.00
5,500.0	7.72	88.72	5,475.2	8.4	376.9	25.8	0.00	0.00	0.00
5,600.0	7.72	88.72	5,574.3	8.7	390.3	26.7	0.00	0.00	0.00
SNNN									
5,695.4	7.72	88.72	5,668.8	9.0	403.1	27.6	0.00	0.00	0.00
5,700.0	7.72	88.72	5,673.4	9.0	403.7	27.6	0.00	0.00	0.00
5,800.0	7.72	88.72	5,772.4	9.3	417.1	28.6	0.00	0.00	0.00
PIRRL									
5,897.1	7.72	88.72	5,868.7	9.6	430.2	29.5	0.00	0.00	0.00
5,900.0	7.72	88.72	5,871.5	9.6	430.5	29.5	0.00	0.00	0.00
6,000.0	7.72	88.72	5,970.6	9.9	444.0	30.4	0.00	0.00	0.00
6,100.0	7.72	88.72	6,069.7	10.2	457.4	31.3	0.00	0.00	0.00
6,200.0	7.72	88.72	6,168.8	10.5	470.8	32.2	0.00	0.00	0.00
6,300.0	7.72	88.72	6,267.9	10.8	484.2	33.2	0.00	0.00	0.00
6,400.0	7.72	88.72	6,367.0	11.1	497.7	34.1	0.00	0.00	0.00
6,500.0	7.72	88.72	6,466.1	11.4	511.1	35.0	0.00	0.00	0.00
6,600.0	7.72	88.72	6,565.2	11.7	524.5	35.9	0.00	0.00	0.00
Drop 2°/100'									
6,630.4	7.72	88.72	6,595.3	11.8	528.6	36.2	0.00	0.00	0.00
6,700.0	6.32	88.72	6,664.4	12.0	537.1	36.8	2.00	-2.00	0.00
6,800.0	4.32	88.72	6,764.0	12.2	546.4	37.4	2.00	-2.00	0.00
6,900.0	2.32	88.72	6,863.8	12.3	552.2	37.8	2.00	-2.00	0.00
7,000.0	0.32	88.72	6,963.8	12.4	554.5	38.0	2.00	-2.00	0.00
EOD @ Vertical									
7,016.2	0.00	360.00	6,980.0	12.4	554.5	38.0	2.00	-2.00	0.00
MNCS									
7,049.6	3.33	0.20	7,013.3	13.3	554.5	38.9	10.00	10.00	0.00
7,050.0	3.38	0.20	7,013.7	13.4	554.5	39.0	10.00	10.00	0.00
7,100.0	8.38	0.20	7,063.5	18.5	554.6	44.1	10.00	10.00	0.00
7,150.0	13.38	0.20	7,112.5	27.9	554.6	53.5	10.00	10.00	0.00
7,200.0	18.38	0.20	7,160.6	41.6	554.6	67.2	10.00	10.00	0.00
7,250.0	23.38	0.20	7,207.3	59.4	554.7	85.0	10.00	10.00	0.00
7,300.0	28.38	0.20	7,252.3	81.2	554.8	106.7	10.00	10.00	0.00
NBRR									
7,303.4	28.71	0.20	7,255.3	82.8	554.8	108.4	10.00	10.00	0.00
7,350.0	33.38	0.20	7,295.2	106.9	554.9	132.4	10.00	10.00	0.00
7,400.0	38.38	0.20	7,335.7	136.1	555.0	161.6	10.00	10.00	0.00
7,450.0	43.38	0.20	7,373.5	168.9	555.1	194.3	10.00	10.00	0.00
7,500.0	48.38	0.20	7,408.3	204.7	555.2	230.2	10.00	10.00	0.00
7,550.0	53.38	0.20	7,439.8	243.5	555.3	268.9	10.00	10.00	0.00
7,600.0	58.38	0.20	7,467.9	284.9	555.5	310.3	10.00	10.00	0.00
7,650.0	63.38	0.20	7,492.2	328.6	555.6	353.9	10.00	10.00	0.00

# Well Planning Report



<b>Database:</b>	EDM 5000.1 Single User Db	<b>Local Co-ordinate Reference:</b>	Well PRU 0880 6-29H17
<b>Company:</b>	SandRidge Energy	<b>TVD Reference:</b>	WELL @ 8109.3usft
<b>Project:</b>	Jackson County, Colorado	<b>MD Reference:</b>	WELL @ 8109.3usft
<b>Site:</b>	Sec 29, T8N, R80W, 6th PM	<b>North Reference:</b>	Grid
<b>Well:</b>	PRU 0880 6-29H17	<b>Survey Calculation Method:</b>	Minimum Curvature
<b>Wellbore:</b>	Wellbore #1		
<b>Design:</b>	Design #1		

Planned Survey									
Measured Depth (usft)	Inclination (°)	Azimuth (°)	Vertical Depth (usft)	+N/-S (usft)	+E/-W (usft)	Vertical Section (usft)	Dogleg Rate (°/100usft)	Build Rate (°/100usft)	Turn Rate (°/100usft)
7,700.0	68.38	0.20	7,512.6	374.2	555.8	399.5	10.00	10.00	0.00
7,750.0	73.38	0.20	7,529.0	421.4	556.0	446.6	10.00	10.00	0.00
7,800.0	78.38	0.20	7,541.2	469.9	556.1	495.1	10.00	10.00	0.00
7,850.0	83.38	0.20	7,549.1	519.2	556.3	544.4	10.00	10.00	0.00
7,900.0	88.38	0.20	7,552.7	569.1	556.5	594.2	10.00	10.00	0.00
EOC @ 92.5° Inc / .2° Azm / 7552' TVD									
7,941.2	92.50	0.20	7,552.4	610.3	556.6	635.4	10.00	10.00	0.00
8,000.0	92.50	0.20	7,549.9	669.0	556.8	694.0	0.00	0.00	0.00
8,100.0	92.50	0.20	7,545.5	768.9	557.2	793.8	0.00	0.00	0.00
8,200.0	92.50	0.20	7,541.1	868.8	557.5	893.7	0.00	0.00	0.00
8,300.0	92.50	0.20	7,536.8	968.7	557.9	993.5	0.00	0.00	0.00
8,400.0	92.50	0.20	7,532.4	1,068.6	558.2	1,093.3	0.00	0.00	0.00
8,500.0	92.50	0.20	7,528.1	1,168.5	558.6	1,193.1	0.00	0.00	0.00
8,600.0	92.50	0.20	7,523.7	1,268.4	558.9	1,292.9	0.00	0.00	0.00
8,700.0	92.50	0.20	7,519.3	1,368.3	559.3	1,392.7	0.00	0.00	0.00
8,800.0	92.50	0.20	7,515.0	1,468.2	559.7	1,492.5	0.00	0.00	0.00
8,900.0	92.50	0.20	7,510.6	1,568.2	560.0	1,592.3	0.00	0.00	0.00
9,000.0	92.50	0.20	7,506.3	1,668.1	560.4	1,692.2	0.00	0.00	0.00
9,100.0	92.50	0.20	7,501.9	1,768.0	560.7	1,792.0	0.00	0.00	0.00
9,200.0	92.50	0.20	7,497.5	1,867.9	561.1	1,891.8	0.00	0.00	0.00
9,300.0	92.50	0.20	7,493.2	1,967.8	561.4	1,991.6	0.00	0.00	0.00
9,400.0	92.50	0.20	7,488.8	2,067.7	561.8	2,091.4	0.00	0.00	0.00
9,500.0	92.50	0.20	7,484.5	2,167.6	562.1	2,191.2	0.00	0.00	0.00
9,600.0	92.50	0.20	7,480.1	2,267.5	562.5	2,291.0	0.00	0.00	0.00
9,700.0	92.50	0.20	7,475.7	2,367.4	562.8	2,390.9	0.00	0.00	0.00
9,800.0	92.50	0.20	7,471.4	2,467.3	563.2	2,490.7	0.00	0.00	0.00
9,900.0	92.50	0.20	7,467.0	2,567.2	563.5	2,590.5	0.00	0.00	0.00
10,000.0	92.50	0.20	7,462.7	2,667.1	563.9	2,690.3	0.00	0.00	0.00
10,100.0	92.50	0.20	7,458.3	2,767.0	564.2	2,790.1	0.00	0.00	0.00
10,200.0	92.50	0.20	7,453.9	2,866.9	564.6	2,889.9	0.00	0.00	0.00
10,300.0	92.50	0.20	7,449.6	2,966.8	564.9	2,989.7	0.00	0.00	0.00
10,400.0	92.50	0.20	7,445.2	3,066.7	565.3	3,089.6	0.00	0.00	0.00
10,500.0	92.50	0.20	7,440.9	3,166.6	565.6	3,189.4	0.00	0.00	0.00
10,600.0	92.50	0.20	7,436.5	3,266.5	566.0	3,289.2	0.00	0.00	0.00
10,700.0	92.50	0.20	7,432.2	3,366.4	566.3	3,389.0	0.00	0.00	0.00
10,800.0	92.50	0.20	7,427.8	3,466.3	566.7	3,488.8	0.00	0.00	0.00
10,900.0	92.50	0.20	7,423.4	3,566.2	567.0	3,588.6	0.00	0.00	0.00
11,000.0	92.50	0.20	7,419.1	3,666.1	567.4	3,688.4	0.00	0.00	0.00
11,100.0	92.50	0.20	7,414.7	3,766.0	567.7	3,788.3	0.00	0.00	0.00
11,200.0	92.50	0.20	7,410.4	3,866.0	568.1	3,888.1	0.00	0.00	0.00
11,300.0	92.50	0.20	7,406.0	3,965.9	568.4	3,987.9	0.00	0.00	0.00
11,400.0	92.50	0.20	7,401.6	4,065.8	568.8	4,087.7	0.00	0.00	0.00
11,500.0	92.50	0.20	7,397.3	4,165.7	569.1	4,187.5	0.00	0.00	0.00
11,600.0	92.50	0.20	7,392.9	4,265.6	569.5	4,287.3	0.00	0.00	0.00
11,700.0	92.50	0.20	7,388.6	4,365.5	569.8	4,387.1	0.00	0.00	0.00
11,800.0	92.50	0.20	7,384.2	4,465.4	570.2	4,487.0	0.00	0.00	0.00
11,900.0	92.50	0.20	7,379.8	4,565.3	570.5	4,586.8	0.00	0.00	0.00
12,000.0	92.50	0.20	7,375.5	4,665.2	570.9	4,686.6	0.00	0.00	0.00
12,100.0	92.50	0.20	7,371.1	4,765.1	571.2	4,786.4	0.00	0.00	0.00
12,200.0	92.50	0.20	7,366.8	4,865.0	571.6	4,886.2	0.00	0.00	0.00
12,300.0	92.50	0.20	7,362.4	4,964.9	571.9	4,986.0	0.00	0.00	0.00
12,400.0	92.50	0.20	7,358.0	5,064.8	572.3	5,085.8	0.00	0.00	0.00
12,500.0	92.50	0.20	7,353.7	5,164.7	572.6	5,185.6	0.00	0.00	0.00
12,600.0	92.50	0.20	7,349.3	5,264.6	573.0	5,285.5	0.00	0.00	0.00

# Well Planning Report



<b>Database:</b>	EDM 5000.1 Single User Db	<b>Local Co-ordinate Reference:</b>	Well PRU 0880 6-29H17
<b>Company:</b>	SandRidge Energy	<b>TVD Reference:</b>	WELL @ 8109.3usft
<b>Project:</b>	Jackson County, Colorado	<b>MD Reference:</b>	WELL @ 8109.3usft
<b>Site:</b>	Sec 29, T8N, R80W, 6th PM	<b>North Reference:</b>	Grid
<b>Well:</b>	PRU 0880 6-29H17	<b>Survey Calculation Method:</b>	Minimum Curvature
<b>Wellbore:</b>	Wellbore #1		
<b>Design:</b>	Design #1		

Planned Survey									
Measured Depth (usft)	Inclination (°)	Azimuth (°)	Vertical Depth (usft)	+N/-S (usft)	+E/-W (usft)	Vertical Section (usft)	Dogleg Rate (°/100usft)	Build Rate (°/100usft)	Turn Rate (°/100usft)
12,700.0	92.50	0.20	7,345.0	5,364.5	573.4	5,385.3	0.00	0.00	0.00
12,800.0	92.50	0.20	7,340.6	5,464.4	573.7	5,485.1	0.00	0.00	0.00
12,900.0	92.50	0.20	7,336.2	5,564.3	574.1	5,584.9	0.00	0.00	0.00
13,000.0	92.50	0.20	7,331.9	5,664.2	574.4	5,684.7	0.00	0.00	0.00
13,100.0	92.50	0.20	7,327.5	5,764.1	574.8	5,784.5	0.00	0.00	0.00
13,200.0	92.50	0.20	7,323.2	5,864.0	575.1	5,884.3	0.00	0.00	0.00
13,300.0	92.50	0.20	7,318.8	5,963.9	575.5	5,984.2	0.00	0.00	0.00
13,400.0	92.50	0.20	7,314.5	6,063.8	575.8	6,084.0	0.00	0.00	0.00
13,500.0	92.50	0.20	7,310.1	6,163.8	576.2	6,183.8	0.00	0.00	0.00
13,600.0	92.50	0.20	7,305.7	6,263.7	576.5	6,283.6	0.00	0.00	0.00
13,700.0	92.50	0.20	7,301.4	6,363.6	576.9	6,383.4	0.00	0.00	0.00
13,800.0	92.50	0.20	7,297.0	6,463.5	577.2	6,483.2	0.00	0.00	0.00
13,900.0	92.50	0.20	7,292.7	6,563.4	577.6	6,583.0	0.00	0.00	0.00
14,000.0	92.50	0.20	7,288.3	6,663.3	577.9	6,682.9	0.00	0.00	0.00
14,100.0	92.50	0.20	7,283.9	6,763.2	578.3	6,782.7	0.00	0.00	0.00
14,200.0	92.50	0.20	7,279.6	6,863.1	578.6	6,882.5	0.00	0.00	0.00
14,300.0	92.50	0.20	7,275.2	6,963.0	579.0	6,982.3	0.00	0.00	0.00
14,400.0	92.50	0.20	7,270.9	7,062.9	579.3	7,082.1	0.00	0.00	0.00
14,500.0	92.50	0.20	7,266.5	7,162.8	579.7	7,181.9	0.00	0.00	0.00
14,600.0	92.50	0.20	7,262.1	7,262.7	580.0	7,281.7	0.00	0.00	0.00
14,700.0	92.50	0.20	7,257.8	7,362.6	580.4	7,381.6	0.00	0.00	0.00
14,800.0	92.50	0.20	7,253.4	7,462.5	580.7	7,481.4	0.00	0.00	0.00
14,900.0	92.50	0.20	7,249.1	7,562.4	581.1	7,581.2	0.00	0.00	0.00
15,000.0	92.50	0.20	7,244.7	7,662.3	581.4	7,681.0	0.00	0.00	0.00
15,100.0	92.50	0.20	7,240.3	7,762.2	581.8	7,780.8	0.00	0.00	0.00
15,200.0	92.50	0.20	7,236.0	7,862.1	582.1	7,880.6	0.00	0.00	0.00
15,300.0	92.50	0.20	7,231.6	7,962.0	582.5	7,980.4	0.00	0.00	0.00
15,400.0	92.50	0.20	7,227.3	8,061.9	582.8	8,080.3	0.00	0.00	0.00
15,500.0	92.50	0.20	7,222.9	8,161.8	583.2	8,180.1	0.00	0.00	0.00
15,600.0	92.50	0.20	7,218.6	8,261.7	583.5	8,279.9	0.00	0.00	0.00
15,700.0	92.50	0.20	7,214.2	8,361.6	583.9	8,379.7	0.00	0.00	0.00
15,800.0	92.50	0.20	7,209.8	8,461.6	584.2	8,479.5	0.00	0.00	0.00
15,900.0	92.50	0.20	7,205.5	8,561.5	584.6	8,579.3	0.00	0.00	0.00
16,000.0	92.50	0.20	7,201.1	8,661.4	584.9	8,679.1	0.00	0.00	0.00
16,100.0	92.50	0.20	7,196.8	8,761.3	585.3	8,778.9	0.00	0.00	0.00
16,200.0	92.50	0.20	7,192.4	8,861.2	585.6	8,878.8	0.00	0.00	0.00
16,300.0	92.50	0.20	7,188.0	8,961.1	586.0	8,978.6	0.00	0.00	0.00
16,400.0	92.50	0.20	7,183.7	9,061.0	586.3	9,078.4	0.00	0.00	0.00
16,500.0	92.50	0.20	7,179.3	9,160.9	586.7	9,178.2	0.00	0.00	0.00
16,600.0	92.50	0.20	7,175.0	9,260.8	587.1	9,278.0	0.00	0.00	0.00
16,700.0	92.50	0.20	7,170.6	9,360.7	587.4	9,377.8	0.00	0.00	0.00
16,800.0	92.50	0.20	7,166.2	9,460.6	587.8	9,477.6	0.00	0.00	0.00
16,900.0	92.50	0.20	7,161.9	9,560.5	588.1	9,577.5	0.00	0.00	0.00
17,000.0	92.50	0.20	7,157.5	9,660.4	588.5	9,677.3	0.00	0.00	0.00
17,100.0	92.50	0.20	7,153.2	9,760.3	588.8	9,777.1	0.00	0.00	0.00
17,200.0	92.50	0.20	7,148.8	9,860.2	589.2	9,876.9	0.00	0.00	0.00
17,300.0	92.50	0.20	7,144.4	9,960.1	589.5	9,976.7	0.00	0.00	0.00
17,400.0	92.50	0.20	7,140.1	10,060.0	589.9	10,076.5	0.00	0.00	0.00
17,500.0	92.50	0.20	7,135.7	10,159.9	590.2	10,176.3	0.00	0.00	0.00
17,600.0	92.50	0.20	7,131.4	10,259.8	590.6	10,276.2	0.00	0.00	0.00
17,700.0	92.50	0.20	7,127.0	10,359.7	590.9	10,376.0	0.00	0.00	0.00
17,800.0	92.50	0.20	7,122.6	10,459.6	591.3	10,475.8	0.00	0.00	0.00
17,900.0	92.50	0.20	7,118.3	10,559.5	591.6	10,575.6	0.00	0.00	0.00
18,000.0	92.50	0.20	7,113.9	10,659.4	592.0	10,675.4	0.00	0.00	0.00

# Well Planning Report



<b>Database:</b>	EDM 5000.1 Single User Db	<b>Local Co-ordinate Reference:</b>	Well PRU 0880 6-29H17
<b>Company:</b>	SandRidge Energy	<b>TVD Reference:</b>	WELL @ 8109.3usft
<b>Project:</b>	Jackson County, Colorado	<b>MD Reference:</b>	WELL @ 8109.3usft
<b>Site:</b>	Sec 29, T8N, R80W, 6th PM	<b>North Reference:</b>	Grid
<b>Well:</b>	PRU 0880 6-29H17	<b>Survey Calculation Method:</b>	Minimum Curvature
<b>Wellbore:</b>	Wellbore #1		
<b>Design:</b>	Design #1		

Planned Survey									
Measured Depth (usft)	Inclination (°)	Azimuth (°)	Vertical Depth (usft)	+N/-S (usft)	+E/-W (usft)	Vertical Section (usft)	Dogleg Rate (°/100usft)	Build Rate (°/100usft)	Turn Rate (°/100usft)
18,100.0	92.50	0.20	7,109.6	10,759.4	592.3	10,775.2	0.00	0.00	0.00
18,200.0	92.50	0.20	7,105.2	10,859.3	592.7	10,875.0	0.00	0.00	0.00
18,300.0	92.50	0.20	7,100.9	10,959.2	593.0	10,974.9	0.00	0.00	0.00
18,400.0	92.50	0.20	7,096.5	11,059.1	593.4	11,074.7	0.00	0.00	0.00
18,500.0	92.50	0.20	7,092.1	11,159.0	593.7	11,174.5	0.00	0.00	0.00
18,600.0	92.50	0.20	7,087.8	11,258.9	594.1	11,274.3	0.00	0.00	0.00
18,700.0	92.50	0.20	7,083.4	11,358.8	594.4	11,374.1	0.00	0.00	0.00
18,800.0	92.50	0.20	7,079.1	11,458.7	594.8	11,473.9	0.00	0.00	0.00
18,900.0	92.50	0.20	7,074.7	11,558.6	595.1	11,573.7	0.00	0.00	0.00
19,000.0	92.50	0.20	7,070.3	11,658.5	595.5	11,673.6	0.00	0.00	0.00
19,100.0	92.50	0.20	7,066.0	11,758.4	595.8	11,773.4	0.00	0.00	0.00
19,200.0	92.50	0.20	7,061.6	11,858.3	596.2	11,873.2	0.00	0.00	0.00
19,300.0	92.50	0.20	7,057.3	11,958.2	596.5	11,973.0	0.00	0.00	0.00
19,400.0	92.50	0.20	7,052.9	12,058.1	596.9	12,072.8	0.00	0.00	0.00
19,500.0	92.50	0.20	7,048.5	12,158.0	597.2	12,172.6	0.00	0.00	0.00
19,600.0	92.50	0.20	7,044.2	12,257.9	597.6	12,272.4	0.00	0.00	0.00
19,700.0	92.50	0.20	7,039.8	12,357.8	597.9	12,372.2	0.00	0.00	0.00
19,800.0	92.50	0.20	7,035.5	12,457.7	598.3	12,472.1	0.00	0.00	0.00
19,900.0	92.50	0.20	7,031.1	12,557.6	598.6	12,571.9	0.00	0.00	0.00
20,000.0	92.50	0.20	7,026.7	12,657.5	599.0	12,671.7	0.00	0.00	0.00
20,100.0	92.50	0.20	7,022.4	12,757.4	599.3	12,771.5	0.00	0.00	0.00
20,200.0	92.50	0.20	7,018.0	12,857.3	599.7	12,871.3	0.00	0.00	0.00
20,300.0	92.50	0.20	7,013.7	12,957.2	600.0	12,971.1	0.00	0.00	0.00
<b>TD @ 20320' MD / 7013' TVD</b>									
20,320.2	92.50	0.20	7,012.8	12,977.4	600.1	12,991.3	0.00	0.00	0.00

Design Targets									
Target Name	Dip Angle (°)	Dip Dir. (°)	TVD (usft)	+N/-S (usft)	+E/-W (usft)	Northing (usft)	Easting (usft)	Latitude	Longitude
VP PRU 0880 6-29H1 - hit/miss target - plan hits target center - Shape - Point	0.00	360.00	6,980.0	12.4	554.5	1,473,575.18	2,752,027.93	40° 37' 47.753 N	106° 23' 36.228 W
PBHL PRU 0880 6-29 - plan hits target center - Point	0.00	360.00	7,012.8	12,977.4	600.1	1,486,540.25	2,752,073.52	40° 39' 55.864 N	106° 23' 37.331 W



<b>Database:</b>	EDM 5000.1 Single User Db	<b>Local Co-ordinate Reference:</b>	Well PRU 0880 6-29H17
<b>Company:</b>	SandRidge Energy	<b>TVD Reference:</b>	WELL @ 8109.3usft
<b>Project:</b>	Jackson County, Colorado	<b>MD Reference:</b>	WELL @ 8109.3usft
<b>Site:</b>	Sec 29, T8N, R80W, 6th PM	<b>North Reference:</b>	Grid
<b>Well:</b>	PRU 0880 6-29H17	<b>Survey Calculation Method:</b>	Minimum Curvature
<b>Wellbore:</b>	Wellbore #1		
<b>Design:</b>	Design #1		

## Formations

Measured Depth (usft)	Vertical Depth (usft)	Name	Lithology	Dip (°)	Dip Direction (°)
3,405.6	3,399.7	LNCE		-2.50	2.65
4,242.8	4,229.4	FXHLS		-2.50	2.65
4,464.8	4,449.3	PIRR		-2.50	2.65
5,191.0	5,169.0	SSSX		-2.50	2.65
5,695.4	5,668.8	SNNN		-2.50	2.65
5,897.1	5,868.7	PIRRL		-2.50	2.65
7,049.6	7,013.3	MNCS		-2.50	2.65
7,303.4	7,255.3	NBRR		-2.50	2.65

## Plan Annotations

Measured Depth (usft)	Vertical Depth (usft)	Local Coordinates		Comment
		+N/-S (usft)	+E/-W (usft)	
2,500.0	2,500.0	0.0	0.0	Build 2°/100'
2,885.8	2,884.7	0.6	25.9	EOB @ 7.72° Inc / 88.72° Azm
6,630.4	6,595.3	11.8	528.6	Drop 2°/100'
7,016.2	6,980.0	12.4	554.5	EOD @ Vertical
7,941.2	7,552.4	610.3	556.6	EOC @ 92.5° Inc / .2° Azm / 7552' TVD
20,320.2	7,012.8	12,977.4	600.1	TD @ 20320' MD / 7013' TVD