

# Facility Layout Drawing

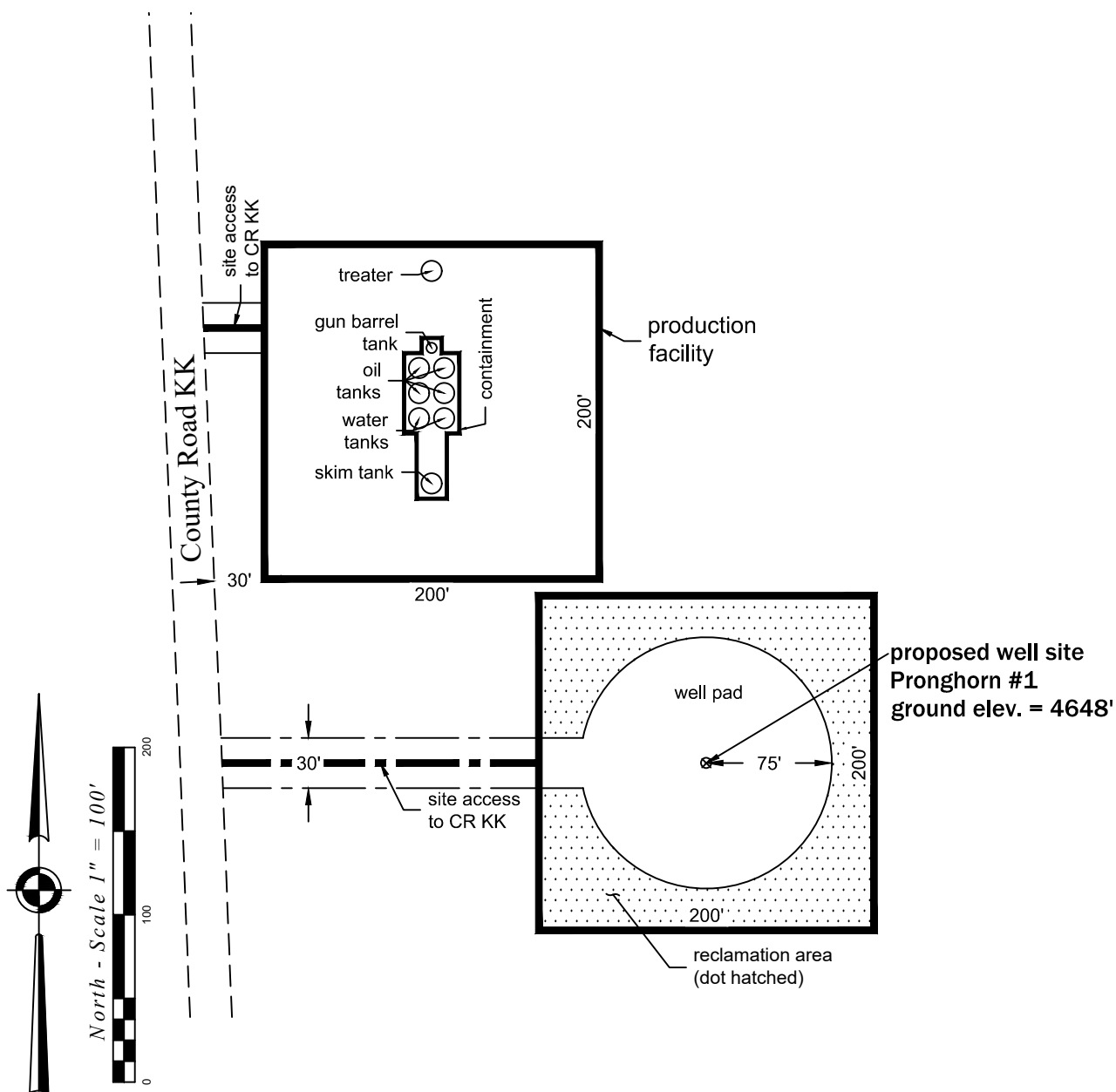

Size of disturbed area during construction in acres: 2.0 acres  
 Size of location after interim reclamation in acres: 1.5 acres  
 Estimated location ground elevation: 4648' [NAVD88]

P:\Project\2018\18050\dwg\18050\_Lay.dwg July 18, 2018 - 8:40am

Well Name: <b>Pronghorn #1</b>	Field Date <b>6.1.2018</b>	Prepared for: <b>St. Croix Operating, Inc.</b>  PLS Group 6843 North Franklin Avenue Loveland, Colorado 80538 970.669.2100 office - 970.669.3652 fax
Section 15-T3S-R51W-6th PM, SW-SW	Party Chief <b>ADS</b>	
Washington County, Colorado	Proj. Manager <b>ZNB</b>	
	Drawing Date <b>6.13.2018</b>	