

Great Western Operating Company, LLC

Location Colorado
Field Wattenburg
Installation Ottesen
Slot S19 - Ottesen LE 06-111HNX
Well Ottesen LE 06-111HNX
Wellbore Ottesen LE 06-111HNX (PWB)

Created by admin
Date plotted 28-Dec-2017
Plot reference is Ottesen LE 06-111HNX (PWB).
Ref wellpath is Ottesen LE 06-111HNX (PWP#1).
Coordinates are in Feet reference S19 - Ottesen LE 06-111HNX.
True Vertical Depths are reference Rig Datum.
Measured Depths are reference Rig Datum.
Rig Datum: Planned Datum #1
Rig Datum to Mean Sea Level: 5093.60 ft.
Plot North is aligned to TRUE North.

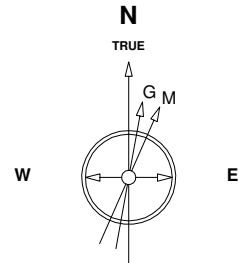

Scale 1 cm = 500 ft

East (Feet) ->

-15000 -14000 -13000 -12000 -11000 -10000 -9000 -8000 -7000 -6000 -5000 -4000 -3000 -2000 -1000 0 1000 2000

8-Aug-2016
IGRF Model [1900.0-2020.0] Dip: 66.56 deg Field: 52280.9 nT
Lat: N40 0 16.5600 Long: W104 46 43.1184 Elev: 5073.60 ft
Magnetic North is 8.28 deg East of TRUE North
To correct azimuth from Magnetic to TRUE add 8.28 deg

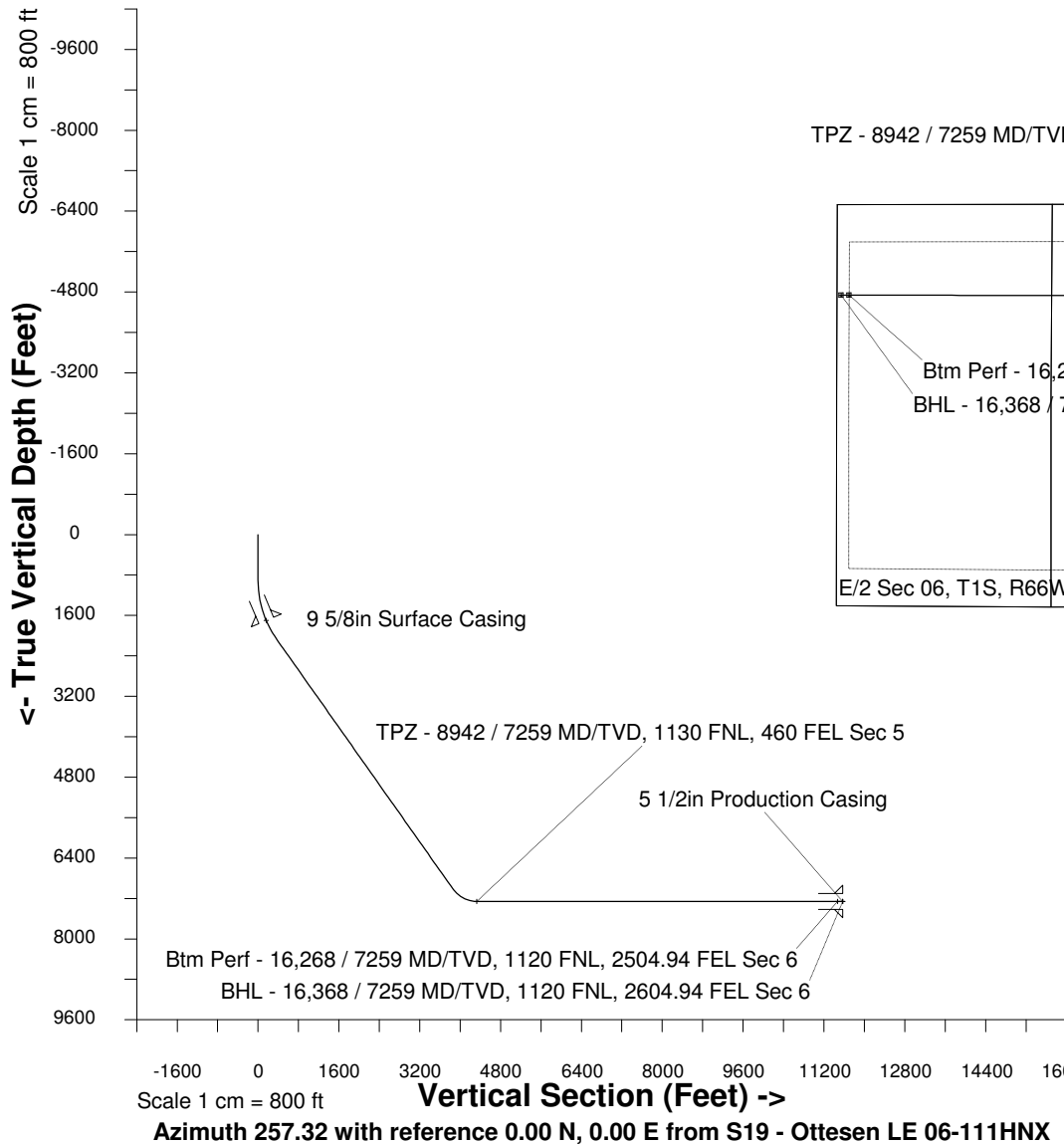

TPZ - 8942 / 7259 MD/TVD, 1130 FNL, 460 FEL Sec 5

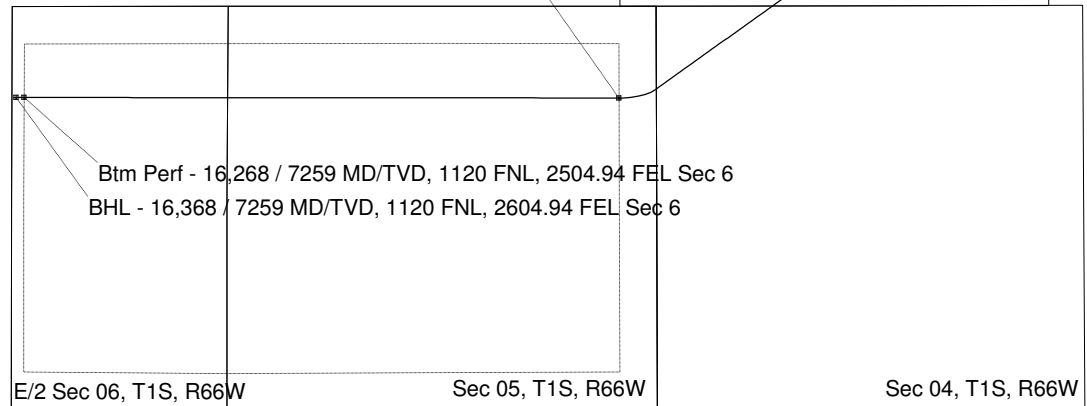

<- North(Feet)

Scale 1 cm = 500 ft

WELL PROFILE DATA

| Point | MD | Inc | Azi | TVD | North | East | deg/100ft | V. Sect |
|-------------------------|----------|-------|--------|---------|-----------|------------|-----------|----------|
| Tie on | 0.00 | 0.00 | 0.00 | 0.00 | S 0.00 | W 0.00 | | -0.00 |
| KOP | 900.00 | 0.00 | 234.43 | 900.00 | S 0.00 | W 0.00 | 0.00 | -0.00 |
| End of Build | 2148.69 | 37.46 | 234.43 | 2061.61 | S 229.14 | W 320.36 | 9.84 | 362.84 |
| End of Hold | 8393.45 | 37.46 | 234.43 | 7018.52 | S 2438.75 | W 3409.65 | 0.00 | 3861.82 |
| Target TPZ - ... Sec 5 | 8942.25 | 90.00 | 270.05 | 7259.00 | S 2545.70 | W 3862.49 | 36.09 | 4327.09 |
| Target Btm Pe... Sec 6 | 16267.70 | 90.00 | 270.05 | 7259.00 | S 2539.84 | W 11187.93 | 0.00 | 11472.58 |
| End of Turn | 16267.88 | 90.00 | 270.03 | 7259.00 | S 2539.84 | W 11188.11 | 36.09 | 11472.76 |
| T.D. & Target BHL...c 6 | 16367.72 | 90.00 | 270.03 | 7259.00 | S 2539.79 | W 11287.95 | 0.00 | 11570.15 |