

Lowe B2

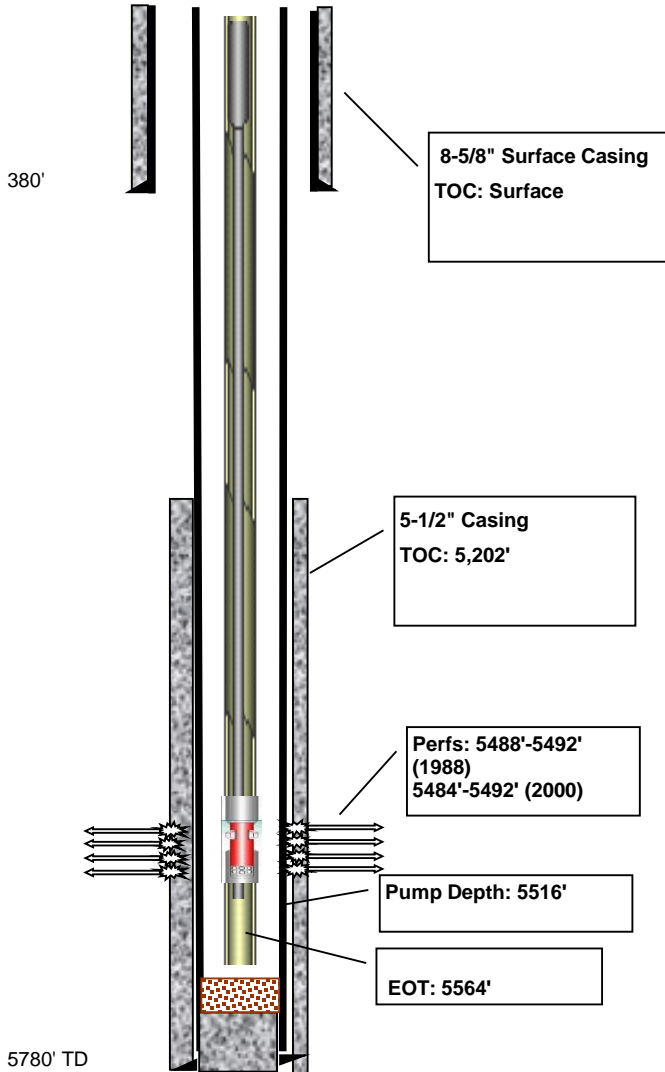

SI

API #	Lease ID	Permit #	County	KB	GL	Current production	Sec N/ Sec E/W	Sec	Formation	
05-063-06192			Kit Carson	4459'	4454'	0 BOPD			Morrow	
	Pumping Unit	Motor	State	TD	PBTD	Initial production	Lease	Lease E/W	Blk	Svy
KB = 5'	AM 320		CO	5780'		250 BOPD				



Perforations

Top	Bottom	SPF	Stimulation	OPEN?
5488	5492			1988
5484	5492			2000

Casing

Depth	Size	Wgt (# Grade)	Description
380'	8-5/8"		
570'	5-1/2"		

Cement

Casing	Sacks	TOC	Description	OD Hole	Washout
8-5/8"	275				
5-1/2"	150	5202			

Tubing

Description	Size	Length	Top	Bot
168 Joints 2-7/8"		5388'	0'	5388'
TAC		3'	5388'	5391'
5 Joint 2-7/8"		157'	5391'	5548'
SN		1'	5548'	5549'
Perf MA		15'	5549'	5564'

Rods

Description	Size	Length	Top	Bot
22"x1-1/4" Polished Rod	22		-3	19
22'-7/8" Pony Rods	22'		19'	41'
102 7/8" Rods		2550	41'	2591'
107-3/4" Rods		2675	2591'	5266'
6-7/8" Rods	150		5266'	5416'
4-1-1/2" K Bars	100'		5416'	5516'
2-1/2"x1-1/2"x20'	20'		5516'	5536'

Pump

2-1/2"x1-1/2"x20'

Job Type	Date	Summar
Perforate	1/1/1988	Perforate Morrow Sand
Frac	4/1/1990	Frac Morrow Sand
Perforate	1/1/2000	RePerf Morrow Sand
Treatment	1/27/2010	Chemical Treatment Down Backside in Hopes to Restore Production
Treatment	3/19/2010	Phase 2 Clean Up 750 Gallons of REAX Acid to clean formation, Didn't Work

Job Type	Date	Summar
Pump Change	3/26/1996	Pump Change, Pump was leaking
Rod Part	12/2/1997	Rod Part, Body Break 9th 3/4"
Rod Part	5/14/1998	Rod Part, 94 Rods Down
Rod Part	7/20/1998	Parted Rod, 90th Rod Down
Pump Change	9/10/1998	Pump Failure, Gas Interference likely cause of failure
Rod Part	11/17/2000	Rod Part, 144th Rod Pin Break



API #	Lease ID	Permit #	County	KB	GL	Current production	Sec N/	Sec E/W	Sec	Formation
05-063-06192			Kit Carson	4459'	4454'	0 BOPD				Morrow
	Pumping Unit	Motor	State	TD	PBTD	Initial production	Lease	Lease E/W	Blk	Svy
KB = 5'	AM 320		CO	5780'		250 BOPD				
Rod Part	10/8/2001		Rod Part 119th Rod Down, Pin Break							
Rod Part	4/23/2002		Rod Part 213th Rod Down							
Rod Part	2/20/2003		Rod Part 156th Rod, Pin Break							
Tbg Leak	7/18/2005		Tbg Leak, Ruptured Joints							
Rod Part	11/29/2007		Rod Part, Pin Break 33rd Rod Down							
Rod Part	1/31/2008		Rod Part, Body Break 43 Rod Down							
Rod Part	2/19/2008		Rod Part, Pin Break 12th 3/4" Rod							
Tbg Leak	5/15/2008		Tbg Leak, Ruptured 8 Joints							
Rod Part	7/1/2008		Rod Part, 5th 3/4" Rod							
Rod Part	10/17/2008		Rod Part, 118th Rod Shoulder Break							
Rod Part	1/9/2009		Rod Part, Body Break 176th Rod							
Pump Change	10/15/2010		Pump Change, Barrel Out of Spec							
Tbg Leak	12/27/2010		Tbg Leak. Hydrotester Blew 15 Joints, Split in Joint 125							
Tbg Leak	6/2/2011		Leaking Tbg, Pump Good, Did not find a tbg leak							
Rod Part	8/21/2014		Parted Rod on 157th 3/4" Rod, Body Break							
Pump Change	1/15/2015		Pump Problems							

AVG Run
Time 10

Lowe B2



SI

API #	Lease ID	Permit #	County	KB	GL	Current production	Sec N/ Sec E/W	Sec	Formation	
05-063-06192			Kit Carson	4459'	4454'	0 BOPD			Morrow	
	Pumping Unit	Motor	State	TD	PBTD	Initial production	Lease	Lease E/W	Blk	Svy
KB = 5'	AM 320		CO	5780'		250 BOPD				