

BOST FARM 5-7 PAD RECLAMATION PLAN NORTH WELL PAD

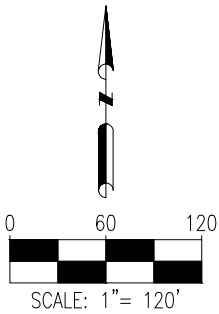
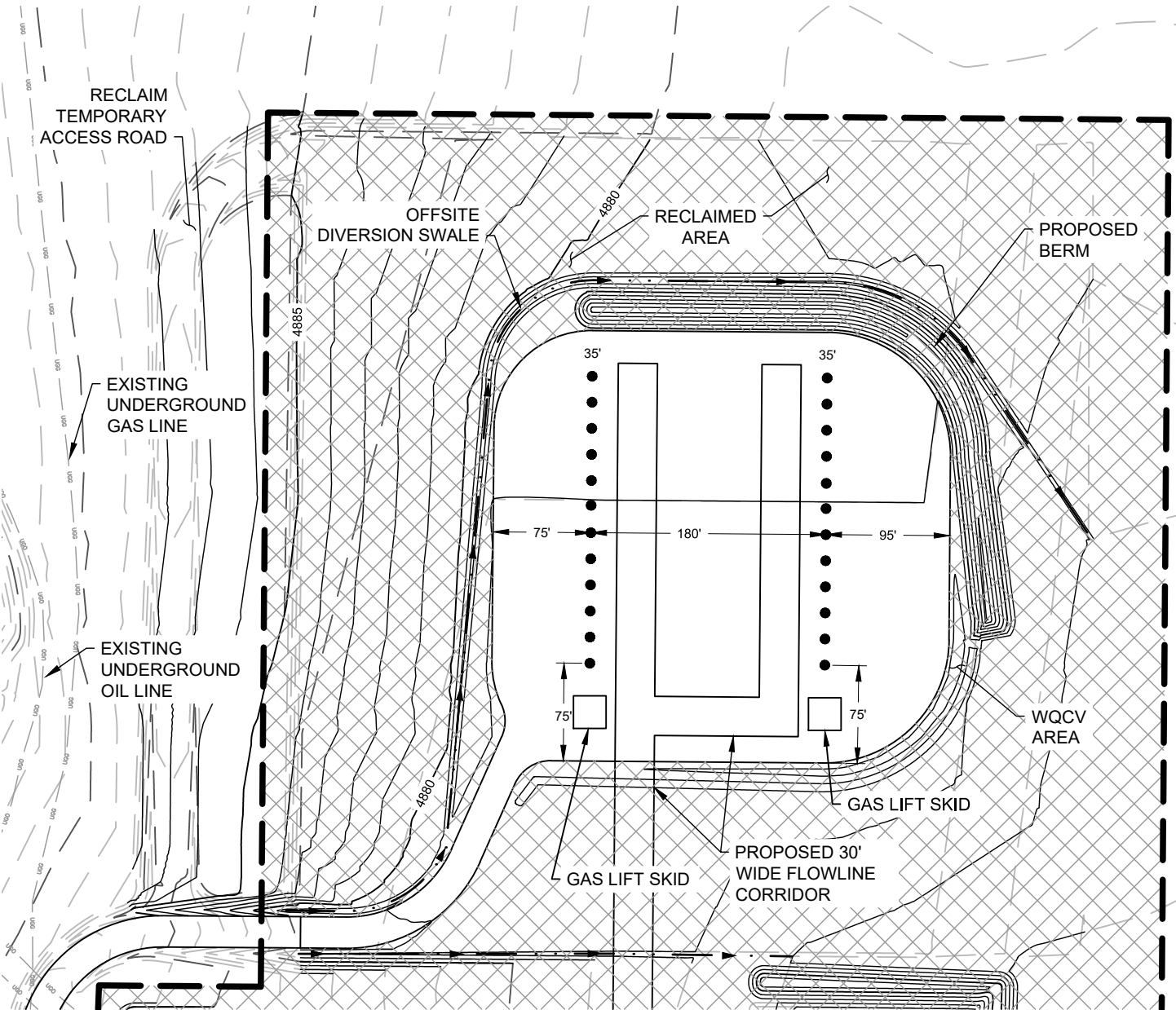

ACREAGES

TOTAL DISTURBANCE AREA	10.62 ACRES
RECLAIMED AREA	7.95 ACRES
PERMANENT WELL PAD AREA	2.67 ACRES

DISCLAIMER:
THIS PLOT DOES NOT REPRESENT A MONUMENTED LAND SURVEY AND SHOULD NOT BE
RELIED UPON TO DETERMINE BOUNDARY LINES, PROPERTY OWNERSHIP OR OTHER
PROPERTY INTERESTS. PARCEL LINES, IF DEPICTED HAVE NOT BEEN FIELD VERIFIED AND
MAY BE BASED UPON PUBLICLY AVAILABLE DATA THAT ALSO HAS NOT BEEN
INDEPENDENTLY VERIFIED.

BOST FARM 5-7 PAD RECLAMATION PLAN PRODUCTION FACILITY

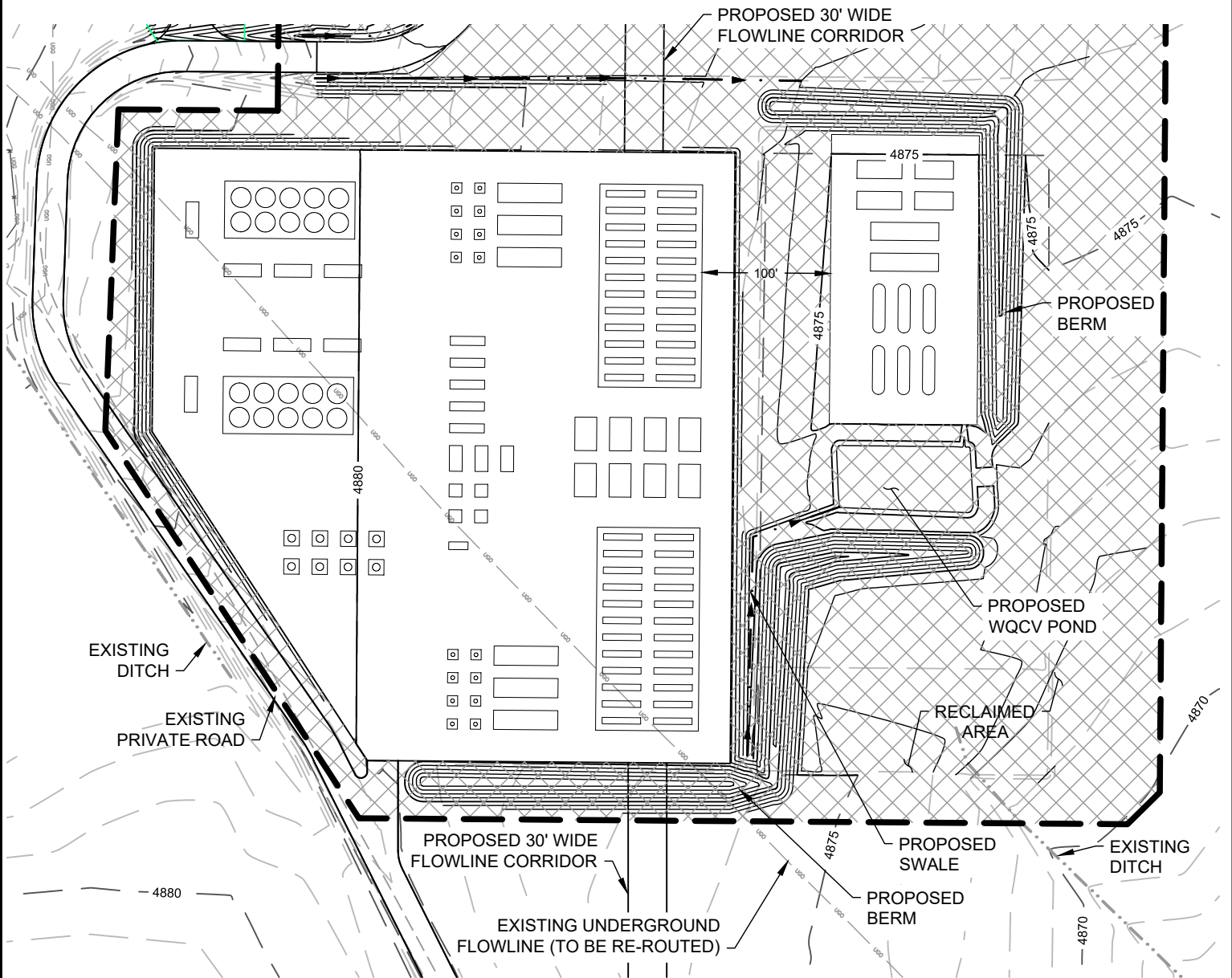

ACREAGES

TOTAL DISTURBANCE AREA	9.67 ACRES
RECLAIMED AREA	4.64 ACRES
PERMANENT WELL PAD AREA	5.03 ACRES

DISCLAIMER:
THIS PLAN DOES NOT REPRESENT A MONUMENTED LAND SURVEY AND SHOULD NOT BE
RELIED UPON TO DETERMINE BOUNDARY LINES, PROPERTY OWNERSHIP OR OTHER
PROPERTY INTERESTS. PARCEL LINES, IF DEPICTED HAVE NOT BEEN FIELD VERIFIED AND
MAY BE BASED UPON PUBLICLY AVAILABLE DATA THAT ALSO HAS NOT BEEN
INDEPENDENTLY VERIFIED.

FIELD DATE:
06-15-17

DRAWING DATE:
02-23-18

BY:
KAD

CHECKED BY:
MLP

SITE NAME:
BOST FARM 5-7 PAD

SURFACE LOCATION:
**LOT 2 NW 1/4 SEC. 7, T5N, R66W, 6TH P.M.
WELD COUNTY, COLORADO**

PREPARED FOR:

BOST FARM 5-7 PAD RECLAMATION PLAN SOUTH WELL PAD

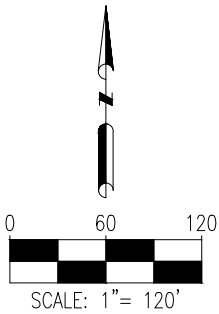
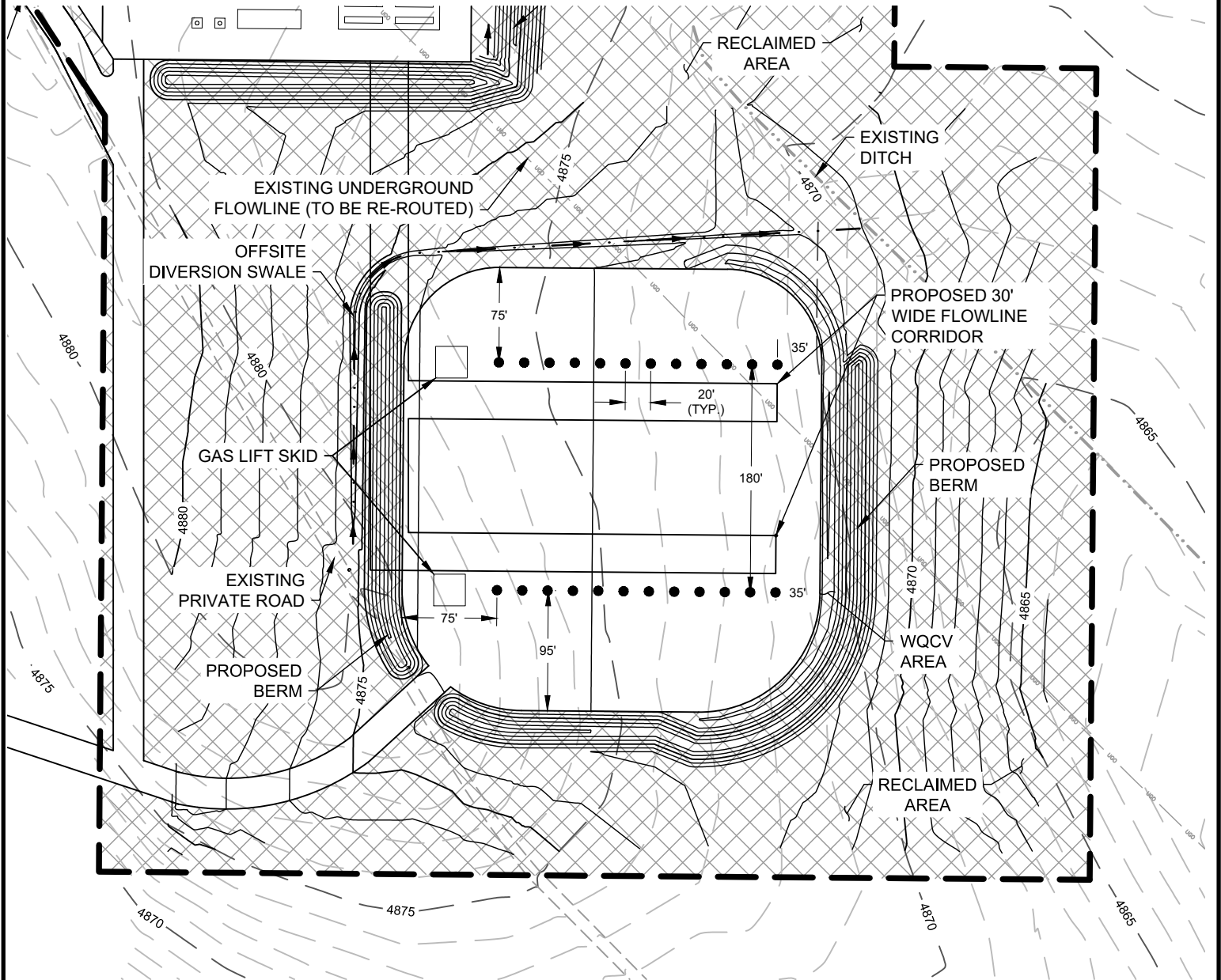

ACREAGES

TOTAL DISTURBANCE AREA	10.90 ACRES
RECLAIMED AREA	8.26 ACRES
PERMANENT WELL PAD AREA	2.64 ACRES

DISCLAIMER:
THIS PLOT DOES NOT REPRESENT A MONUMENTED LAND SURVEY AND SHOULD NOT BE
RELIED UPON TO DETERMINE BOUNDARY LINES, PROPERTY OWNERSHIP OR OTHER
PROPERTY INTERESTS. PARCEL LINES, IF DEPICTED HAVE NOT BEEN FIELD VERIFIED AND
MAY BE BASED UPON PUBLICLY AVAILABLE DATA THAT ALSO HAS NOT BEEN
INDEPENDENTLY VERIFIED.