



VIA EFORMS

Ms. Julie Murphy
Colorado Oil & Gas Conservation Commission
1120 Lincoln Street, Suite 801
Denver, CO 80203

August 14, 2018

RE: Wellbore Spacing Unit
Confluence DJ LLC
70 Ranch 10-11-3
API#: 05-123-45328
Sec. 10 T4N R63W
Weld County, Colorado
Surface: Fee
Mineral Lease: Fee

Dear Director Murphy,

Dear Ms. Murphy,

Confluence DJ LLC ("Confluence") is planning to drill the captioned well in accordance with the provisions of COGCC Rule 318A.e.

Confluence's proposed wellbore spacing unit consists of all of Sec. 11, T4N, R63W, creating a 640- acre wellbore spacing unit for the Codell formation. Confluence is the only working interest owner within the proposed Wellbore Spacing Unit, therefore Confluence hereby attests that no notice letters are required under COGCC Rule 318A.e.(5).

The filing contains the following documents to assist you in your review and approval of Confluence's proposed Wellbore Spacing Unit for the captioned well: Plat illustrating the Proposed Wellbore Spacing Unit and the 70 Ranch 10 East Spacing Exhibit

Thank you for your attention to the enclosed information. Confluence respectfully requests that the COGCC review the enclosed information and approve the Proposed Wellbore Spacing Unit for the captioned well. Please contact me or Kim Rodll at 303-942-0506 or at tjenkins@upstreampm.com or krodell@upstreampm.com, respectively, if you have any questions.

Sincerely,

Tishany K Jenkins
Permit Agent for Confluence DJ LLC

Your Assets / Our Expertise

- Regulatory
- Storm-water Management Plans
- Project Coordination
- Permitting
- Government Relations
- EA/EIS Assistance

PROPOSED WELLBORE SPACING UNIT 70 RANCH 10-11-3

SECTION 11, TOWNSHIP 4 NORTH, RANGE 63 WEST OF THE 6TH P.M.

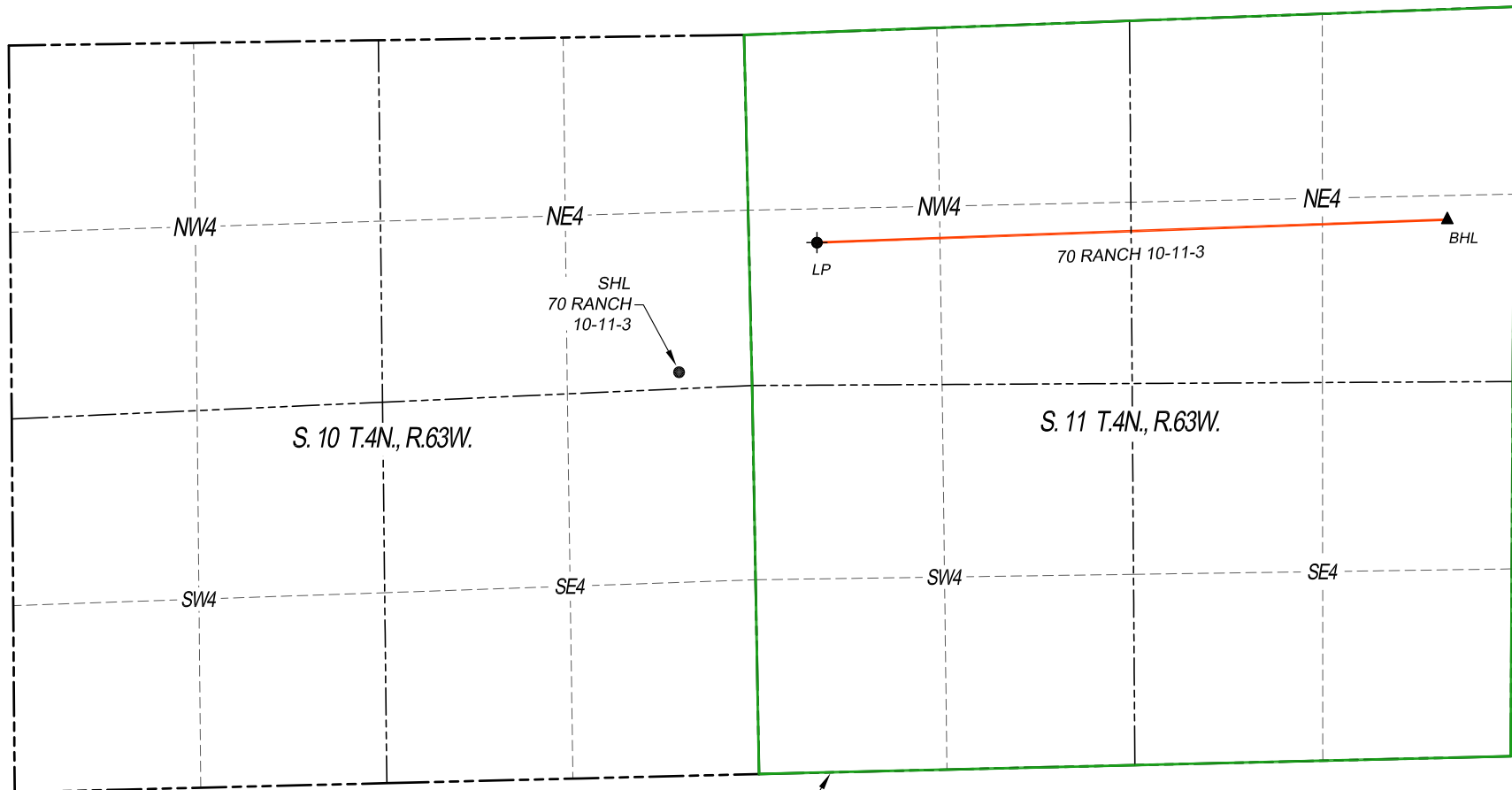

PROPOSED
WELLBORE
SPACING UNIT

LEGEND

- PROPOSED WELL
- ▲ BOTTOM HOLE
- ⊙ ABANDONED WELL
- SHL SURFACE HOLE
- LP LANDING POINT
- BHL BOTTOM HOLE

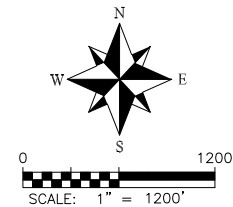

**DALEY LAND
SURVEYING, INC.**
PARKER, COLORADO
303.953.9841