



PROJECT DETAILS: Weld County, CO NAD 83

Geodetic System: US State Plane 1983  
Datum: North American Datum 1983  
Ellipsoid: GRS 1980  
Zone: Colorado Northern Zone  
System Datum: Mean Sea Level  
Local North: True

Project: Weld County, CO NAD 83  
Site: Critter Creek 17 SW Pad  
Well: Critter Creek 17-6401B  
Wellbore: OH  
Design: Plan 1



Azimuths to True North  
Magnetic North: 8.32°

Magnetic Field  
Strength: 52747.9nT  
Dip Angle: 67.18°  
Date: 6/25/2018  
Model: HDGM



Plan: Plan 1 (Critter Creek 17-6401B/OH)

Created By: Seth Burstad

### SECTION DETAILS

MD	Inc	Azi	TVD	+N/-S	+E/-W	Dleg	TFace	VSect
0.00	0.00	0.000	0.00	0.00	0.00	0.00	0.00	0.00
1000.00	0.00	0.000	1000.00	0.00	0.00	0.00	0.00	0.00
2289.99	25.80	227.005	2246.84	-194.74	-208.86	2.00	227.00	-195.12
2590.01	25.80	227.005	2516.95	-283.78	-304.37	0.00	0.00	-284.34
4310.00	0.00	0.000	4179.40	-543.43	-582.85	1.50	180.00	-544.50
7008.64	0.00	0.000	6878.04	-543.43	-582.85	0.00	0.00	-544.50
7908.64	90.00	0.105	7451.00	29.53	-581.80	10.00	0.11	28.46
17937.91	90.00	0.105	7451.00	10058.78	-563.33	0.00	0.00	10057.73

### WELL DETAILS: Critter Creek 17-6401B

GL 5321.9' & KB 20' @ 5341.90ft 5321.90					
+N/-S	+E/-W	Northing	Easting	Latitude	Longitude
0.00	0.00	1578157.79	3286581.50	40° 54' 56.923 N	104° 27' 47.185 W

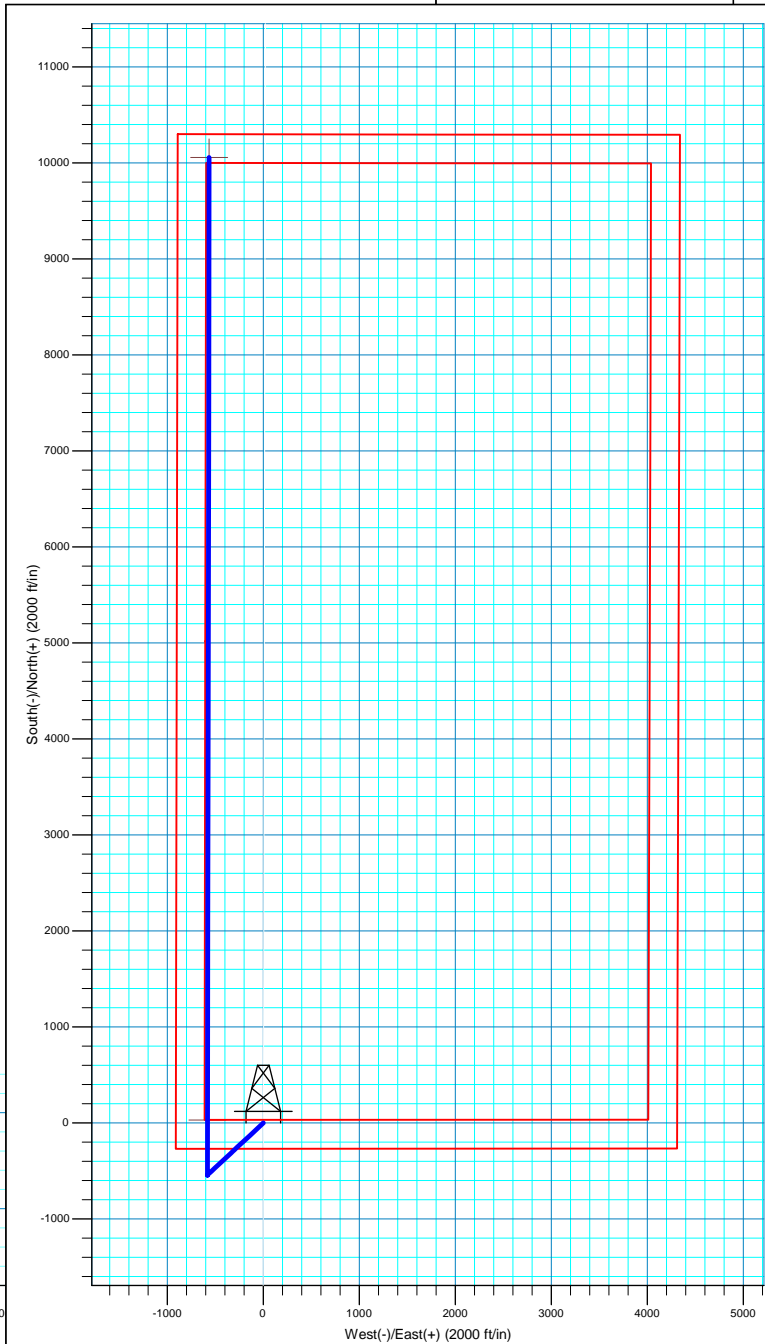
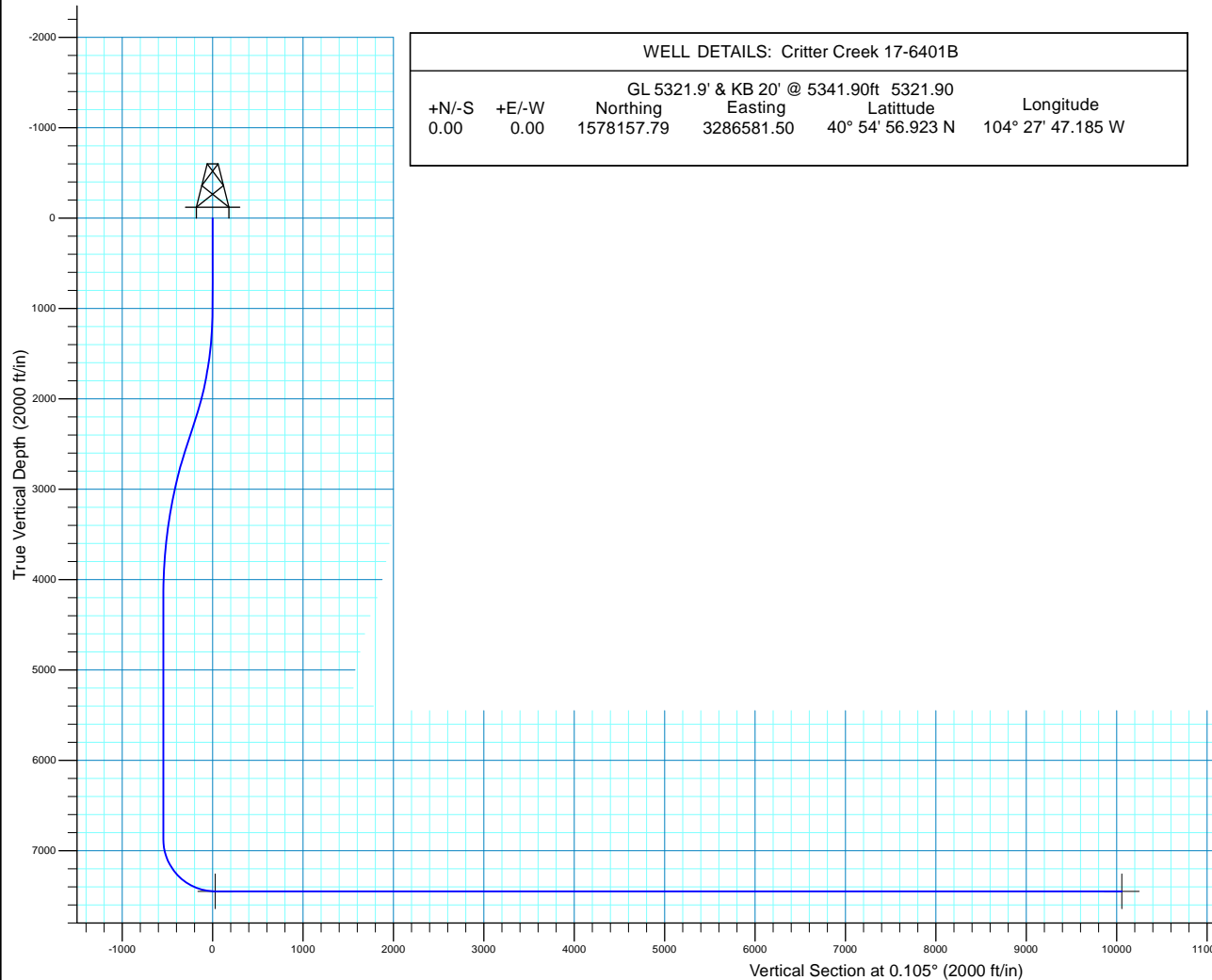



# HighPoint Resources

Weld County, CO NAD 83  
Crittter Creek 17 SW Pad  
Crittter Creek 17-6401B

OH

Plan: Plan 1

## Standard Planning Report

25 June, 2018



<b>Database:</b>	Casper District	<b>Local Co-ordinate Reference:</b>	Well Critter Creek 17-6401B
<b>Company:</b>	HighPoint Resources	<b>TVD Reference:</b>	GL 5321.9' & KB 20' @ 5341.90ft
<b>Project:</b>	Weld County, CO NAD 83	<b>MD Reference:</b>	GL 5321.9' & KB 20' @ 5341.90ft
<b>Site:</b>	Critter Creek 17 SW Pad	<b>North Reference:</b>	True
<b>Well:</b>	Critter Creek 17-6401B	<b>Survey Calculation Method:</b>	Minimum Curvature
<b>Wellbore:</b>	OH		
<b>Design:</b>	Plan 1		

<b>Project</b>	Weld County, CO NAD 83		
<b>Map System:</b>	US State Plane 1983	<b>System Datum:</b>	Mean Sea Level
<b>Geo Datum:</b>	North American Datum 1983		
<b>Map Zone:</b>	Colorado Northern Zone		

Site		Critter Creek 17 SW Pad, Site Center : Critter Creek 17-6401B			
Site Position:		Northing:	1,578,157.79 usft	Latitude:	40° 54' 56.923 N
From:	Lat/Long	Easting:	3,286,581.50 usft	Longitude:	104° 27' 47.185 W
Position Uncertainty:	0.00 ft	Slot Radius:	13.200 in	Grid Convergence:	0.67 °

Well	Critter Creek 17-6401B, 270' FSL 912' FWL Sec 17 T11N R63W					
Well Position	+N/-S	-0.01 ft	Northing:	1,578,157.78 usft	Latitude:	40° 54' 56.923 N
	+E/-W	0.00 ft	Easting:	3,286,581.50 usft	Longitude:	104° 27' 47.185 W
Position Uncertainty		0.00 ft	Wellhead Elevation:	0.00 ft	Ground Level:	5,321.90 ft

<b>Wellbore</b>	OH				
<b>Magnetics</b>	<b>Model Name</b>	<b>Sample Date</b>	<b>Declination (°)</b>	<b>Dip Angle (°)</b>	<b>Field Strength (nT)</b>
	HDGM	6/25/2018	8.32	67.18	52,748

<b>Design</b>	Plan 1			
<b>Audit Notes:</b>				
<b>Version:</b>	<b>Phase:</b>	PLAN	<b>Tie On Depth:</b>	0.00
<b>Vertical Section:</b>	<b>Depth From (TVD)</b>	<b>+N/-S</b>	<b>+E/-W</b>	<b>Direction</b>
	(ft)	(ft)	(ft)	(°)
	0.00	0.00	0.00	0.105

<b>Plan Sections</b>										
Measured Depth (ft)	Inclination (°)	Azimuth (°)	Vertical Depth (ft)	+N/-S (ft)	+E/-W (ft)	Dogleg Rate (°/100ft)	Build Rate (°/100ft)	Turn Rate (°/100ft)	TFO (°)	Target
0.00	0.00	0.000	0.00	0.00	0.00	0.00	0.00	0.00	0.00	
1,000.00	0.00	0.000	1,000.00	0.00	0.00	0.00	0.00	0.00	0.00	
2,289.99	25.80	227.005	2,246.84	-194.74	-208.86	2.00	2.00	0.00	227.00	
2,590.01	25.80	227.005	2,516.95	-283.78	-304.37	0.00	0.00	0.00	0.00	
4,310.00	0.00	0.000	4,179.40	-543.43	-582.85	1.50	-1.50	0.00	180.00	
7,008.64	0.00	0.000	6,878.04	-543.43	-582.85	0.00	0.00	0.00	0.00	
7,908.64	90.00	0.105	7,451.00	29.53	-581.80	10.00	10.00	0.01	0.11	
17,937.91	90.00	0.105	7,451.00	10,058.78	-563.33	0.00	0.00	0.00	0.00	Critter Creek 17-6401

<b>Database:</b>	Casper District	<b>Local Co-ordinate Reference:</b>	Well Critter Creek 17-6401B
<b>Company:</b>	HighPoint Resources	<b>TVD Reference:</b>	GL 5321.9' & KB 20' @ 5341.90ft
<b>Project:</b>	Weld County, CO NAD 83	<b>MD Reference:</b>	GL 5321.9' & KB 20' @ 5341.90ft
<b>Site:</b>	Critter Creek 17 SW Pad	<b>North Reference:</b>	True
<b>Well:</b>	Critter Creek 17-6401B	<b>Survey Calculation Method:</b>	Minimum Curvature
<b>Wellbore:</b>	OH		
<b>Design:</b>	Plan 1		

Planned Survey									
Measured Depth (ft)	Inclination (°)	Azimuth (°)	Vertical Depth (ft)	+N/-S (ft)	+E/-W (ft)	Vertical Section (ft)	Dogleg Rate (°/100ft)	Build Rate (°/100ft)	Turn Rate (°/100ft)
0.00	0.00	0.000	0.00	0.00	0.00	0.00	0.00	0.00	0.00
100.00	0.00	0.000	100.00	0.00	0.00	0.00	0.00	0.00	0.00
200.00	0.00	0.000	200.00	0.00	0.00	0.00	0.00	0.00	0.00
300.00	0.00	0.000	300.00	0.00	0.00	0.00	0.00	0.00	0.00
400.00	0.00	0.000	400.00	0.00	0.00	0.00	0.00	0.00	0.00
500.00	0.00	0.000	500.00	0.00	0.00	0.00	0.00	0.00	0.00
600.00	0.00	0.000	600.00	0.00	0.00	0.00	0.00	0.00	0.00
700.00	0.00	0.000	700.00	0.00	0.00	0.00	0.00	0.00	0.00
800.00	0.00	0.000	800.00	0.00	0.00	0.00	0.00	0.00	0.00
900.00	0.00	0.000	900.00	0.00	0.00	0.00	0.00	0.00	0.00
1,000.00	0.00	0.000	1,000.00	0.00	0.00	0.00	0.00	0.00	0.00
Start Build 2.00									
1,100.00	2.00	227.005	1,099.98	-1.19	-1.28	-1.19	2.00	2.00	0.00
1,200.00	4.00	227.005	1,199.84	-4.76	-5.10	-4.77	2.00	2.00	0.00
1,300.00	6.00	227.005	1,299.45	-10.70	-11.48	-10.72	2.00	2.00	0.00
1,400.00	8.00	227.005	1,398.70	-19.01	-20.39	-19.05	2.00	2.00	0.00
1,500.00	10.00	227.005	1,497.47	-29.68	-31.83	-29.74	2.00	2.00	0.00
1,600.00	12.00	227.005	1,595.62	-42.69	-45.79	-42.78	2.00	2.00	0.00
1,700.00	14.00	227.005	1,693.06	-58.03	-62.24	-58.14	2.00	2.00	0.00
1,800.00	16.00	227.005	1,789.64	-75.68	-81.17	-75.83	2.00	2.00	0.00
1,900.00	18.00	227.005	1,885.27	-95.62	-102.55	-95.80	2.00	2.00	0.00
2,000.00	20.00	227.005	1,979.82	-117.82	-126.36	-118.05	2.00	2.00	0.00
2,100.00	22.00	227.005	2,073.17	-142.25	-152.57	-142.53	2.00	2.00	0.00
2,200.00	24.00	227.005	2,165.21	-168.90	-181.15	-169.23	2.00	2.00	0.00
2,289.99	25.80	227.005	2,246.84	-194.74	-208.86	-195.12	2.00	2.00	0.00
Start 300.02 hold at 2289.99 MD									
2,300.00	25.80	227.005	2,255.85	-197.71	-212.05	-198.10	0.00	0.00	0.00
2,400.00	25.80	227.005	2,345.88	-227.39	-243.88	-227.83	0.00	0.00	0.00
2,500.00	25.80	227.005	2,435.91	-257.07	-275.71	-257.57	0.00	0.00	0.00
2,590.01	25.80	227.005	2,516.95	-283.78	-304.37	-284.34	0.00	0.00	0.00
Start Drop -1.50									
2,600.00	25.65	227.005	2,525.95	-286.74	-307.54	-287.30	1.50	-1.50	0.00
2,700.00	24.15	227.005	2,616.65	-315.45	-338.33	-316.07	1.50	-1.50	0.00
2,800.00	22.65	227.005	2,708.42	-342.53	-367.38	-343.21	1.50	-1.50	0.00
2,900.00	21.15	227.005	2,801.21	-367.97	-394.66	-368.69	1.50	-1.50	0.00
3,000.00	19.65	227.005	2,894.93	-391.74	-420.15	-392.51	1.50	-1.50	0.00
3,100.00	18.15	227.005	2,989.54	-413.83	-443.84	-414.64	1.50	-1.50	0.00
3,200.00	16.65	227.005	3,084.96	-434.22	-465.72	-435.07	1.50	-1.50	0.00
3,300.00	15.15	227.005	3,181.13	-452.90	-485.75	-453.79	1.50	-1.50	0.00
3,400.00	13.65	227.005	3,277.99	-469.86	-503.94	-470.78	1.50	-1.50	0.00
3,500.00	12.15	227.005	3,375.46	-485.08	-520.27	-486.03	1.50	-1.50	0.00
3,600.00	10.65	227.005	3,473.48	-498.56	-534.73	-499.54	1.50	-1.50	0.00
3,700.00	9.15	227.005	3,571.99	-510.28	-547.30	-511.29	1.50	-1.50	0.00
3,800.00	7.65	227.005	3,670.92	-520.25	-557.98	-521.27	1.50	-1.50	0.00
3,900.00	6.15	227.005	3,770.19	-528.44	-566.77	-529.48	1.50	-1.50	0.00
4,000.00	4.65	227.005	3,869.74	-534.86	-573.65	-535.91	1.50	-1.50	0.00
4,100.00	3.15	227.005	3,969.51	-539.49	-578.63	-540.55	1.50	-1.50	0.00
4,200.00	1.65	227.005	4,069.42	-542.35	-581.69	-543.42	1.50	-1.50	0.00
4,300.00	0.15	227.005	4,169.40	-543.42	-582.84	-544.49	1.50	-1.50	0.00
4,310.00	0.00	0.000	4,179.40	-543.43	-582.85	-544.50	1.50	-1.50	0.00
Start 2698.64 hold at 4310.00 MD									
4,400.00	0.00	0.000	4,269.40	-543.43	-582.85	-544.50	0.00	0.00	0.00
4,500.00	0.00	0.000	4,369.40	-543.43	-582.85	-544.50	0.00	0.00	0.00
4,600.00	0.00	0.000	4,469.40	-543.43	-582.85	-544.50	0.00	0.00	0.00

<b>Database:</b>	Casper District	<b>Local Co-ordinate Reference:</b>	Well Critter Creek 17-6401B
<b>Company:</b>	HighPoint Resources	<b>TVD Reference:</b>	GL 5321.9' & KB 20' @ 5341.90ft
<b>Project:</b>	Weld County, CO NAD 83	<b>MD Reference:</b>	GL 5321.9' & KB 20' @ 5341.90ft
<b>Site:</b>	Critter Creek 17 SW Pad	<b>North Reference:</b>	True
<b>Well:</b>	Critter Creek 17-6401B	<b>Survey Calculation Method:</b>	Minimum Curvature
<b>Wellbore:</b>	OH		
<b>Design:</b>	Plan 1		

Planned Survey									
Measured Depth (ft)	Inclination (°)	Azimuth (°)	Vertical Depth (ft)	+N/-S (ft)	+E/-W (ft)	Vertical Section (ft)	Dogleg Rate (°/100ft)	Build Rate (°/100ft)	Turn Rate (°/100ft)
4,700.00	0.00	0.000	4,569.40	-543.43	-582.85	-544.50	0.00	0.00	0.00
4,800.00	0.00	0.000	4,669.40	-543.43	-582.85	-544.50	0.00	0.00	0.00
4,900.00	0.00	0.000	4,769.40	-543.43	-582.85	-544.50	0.00	0.00	0.00
5,000.00	0.00	0.000	4,869.40	-543.43	-582.85	-544.50	0.00	0.00	0.00
5,100.00	0.00	0.000	4,969.40	-543.43	-582.85	-544.50	0.00	0.00	0.00
5,200.00	0.00	0.000	5,069.40	-543.43	-582.85	-544.50	0.00	0.00	0.00
5,300.00	0.00	0.000	5,169.40	-543.43	-582.85	-544.50	0.00	0.00	0.00
5,400.00	0.00	0.000	5,269.40	-543.43	-582.85	-544.50	0.00	0.00	0.00
5,500.00	0.00	0.000	5,369.40	-543.43	-582.85	-544.50	0.00	0.00	0.00
5,600.00	0.00	0.000	5,469.40	-543.43	-582.85	-544.50	0.00	0.00	0.00
5,700.00	0.00	0.000	5,569.40	-543.43	-582.85	-544.50	0.00	0.00	0.00
5,800.00	0.00	0.000	5,669.40	-543.43	-582.85	-544.50	0.00	0.00	0.00
5,900.00	0.00	0.000	5,769.40	-543.43	-582.85	-544.50	0.00	0.00	0.00
6,000.00	0.00	0.000	5,869.40	-543.43	-582.85	-544.50	0.00	0.00	0.00
6,100.00	0.00	0.000	5,969.40	-543.43	-582.85	-544.50	0.00	0.00	0.00
6,200.00	0.00	0.000	6,069.40	-543.43	-582.85	-544.50	0.00	0.00	0.00
6,300.00	0.00	0.000	6,169.40	-543.43	-582.85	-544.50	0.00	0.00	0.00
6,400.00	0.00	0.000	6,269.40	-543.43	-582.85	-544.50	0.00	0.00	0.00
6,500.00	0.00	0.000	6,369.40	-543.43	-582.85	-544.50	0.00	0.00	0.00
6,600.00	0.00	0.000	6,469.40	-543.43	-582.85	-544.50	0.00	0.00	0.00
6,700.00	0.00	0.000	6,569.40	-543.43	-582.85	-544.50	0.00	0.00	0.00
6,800.00	0.00	0.000	6,669.40	-543.43	-582.85	-544.50	0.00	0.00	0.00
6,900.00	0.00	0.000	6,769.40	-543.43	-582.85	-544.50	0.00	0.00	0.00
7,000.00	0.00	0.000	6,869.40	-543.43	-582.85	-544.50	0.00	0.00	0.00
7,008.64	0.00	0.000	6,878.04	-543.43	-582.85	-544.50	0.00	0.00	0.00
Start DLS 10.00 TFO 0.11									
7,100.00	9.14	0.105	6,969.02	-536.16	-582.84	-537.23	10.00	10.00	0.00
7,200.00	19.14	0.105	7,065.86	-511.77	-582.79	-512.84	10.00	10.00	0.00
7,300.00	29.14	0.105	7,157.01	-470.93	-582.72	-472.00	10.00	10.00	0.00
7,400.00	39.14	0.105	7,239.67	-414.89	-582.61	-415.95	10.00	10.00	0.00
7,500.00	49.14	0.105	7,311.35	-345.34	-582.49	-346.40	10.00	10.00	0.00
7,600.00	59.14	0.105	7,369.86	-264.40	-582.34	-265.47	10.00	10.00	0.00
7,700.00	69.14	0.105	7,413.43	-174.53	-582.17	-175.60	10.00	10.00	0.00
7,800.00	79.14	0.105	7,440.73	-78.46	-581.99	-79.53	10.00	10.00	0.00
7,900.00	89.14	0.105	7,450.93	20.89	-581.81	19.82	10.00	10.00	0.00
7,908.64	90.00	0.105	7,451.00	29.53	-581.80	28.46	10.00	10.00	0.00
Start 10029.27 hold at 7908.64 MD									
8,000.00	90.00	0.105	7,451.00	120.89	-581.63	119.82	0.00	0.00	0.00
8,100.00	90.00	0.105	7,451.00	220.89	-581.44	219.82	0.00	0.00	0.00
8,200.00	90.00	0.105	7,451.00	320.89	-581.26	319.82	0.00	0.00	0.00
8,300.00	90.00	0.105	7,451.00	420.89	-581.07	419.82	0.00	0.00	0.00
8,400.00	90.00	0.105	7,451.00	520.89	-580.89	519.82	0.00	0.00	0.00
8,500.00	90.00	0.105	7,451.00	620.89	-580.71	619.82	0.00	0.00	0.00
8,600.00	90.00	0.105	7,451.00	720.89	-580.52	719.82	0.00	0.00	0.00
8,700.00	90.00	0.105	7,451.00	820.89	-580.34	819.82	0.00	0.00	0.00
8,800.00	90.00	0.105	7,451.00	920.89	-580.15	919.82	0.00	0.00	0.00
8,900.00	90.00	0.105	7,451.00	1,020.89	-579.97	1,019.82	0.00	0.00	0.00
9,000.00	90.00	0.105	7,451.00	1,120.89	-579.79	1,119.82	0.00	0.00	0.00
9,100.00	90.00	0.105	7,451.00	1,220.89	-579.60	1,219.82	0.00	0.00	0.00
9,200.00	90.00	0.105	7,451.00	1,320.89	-579.42	1,319.82	0.00	0.00	0.00
9,300.00	90.00	0.105	7,451.00	1,420.89	-579.23	1,419.82	0.00	0.00	0.00
9,400.00	90.00	0.105	7,451.00	1,520.89	-579.05	1,519.82	0.00	0.00	0.00
9,500.00	90.00	0.105	7,451.00	1,620.89	-578.87	1,619.82	0.00	0.00	0.00

<b>Database:</b>	Casper District	<b>Local Co-ordinate Reference:</b>	Well Critter Creek 17-6401B
<b>Company:</b>	HighPoint Resources	<b>TVD Reference:</b>	GL 5321.9' & KB 20' @ 5341.90ft
<b>Project:</b>	Weld County, CO NAD 83	<b>MD Reference:</b>	GL 5321.9' & KB 20' @ 5341.90ft
<b>Site:</b>	Critter Creek 17 SW Pad	<b>North Reference:</b>	True
<b>Well:</b>	Critter Creek 17-6401B	<b>Survey Calculation Method:</b>	Minimum Curvature
<b>Wellbore:</b>	OH		
<b>Design:</b>	Plan 1		

Planned Survey									
Measured Depth (ft)	Inclination (°)	Azimuth (°)	Vertical Depth (ft)	+N/-S (ft)	+E/-W (ft)	Vertical Section (ft)	Dogleg Rate (°/100ft)	Build Rate (°/100ft)	Turn Rate (°/100ft)
9,600.00	90.00	0.105	7,451.00	1,720.89	-578.68	1,719.82	0.00	0.00	0.00
9,700.00	90.00	0.105	7,451.00	1,820.89	-578.50	1,819.82	0.00	0.00	0.00
9,800.00	90.00	0.105	7,451.00	1,920.89	-578.31	1,919.82	0.00	0.00	0.00
9,900.00	90.00	0.105	7,451.00	2,020.89	-578.13	2,019.82	0.00	0.00	0.00
10,000.00	90.00	0.105	7,451.00	2,120.88	-577.95	2,119.82	0.00	0.00	0.00
10,100.00	90.00	0.105	7,451.00	2,220.88	-577.76	2,219.82	0.00	0.00	0.00
10,200.00	90.00	0.105	7,451.00	2,320.88	-577.58	2,319.82	0.00	0.00	0.00
10,300.00	90.00	0.105	7,451.00	2,420.88	-577.39	2,419.82	0.00	0.00	0.00
10,400.00	90.00	0.105	7,451.00	2,520.88	-577.21	2,519.82	0.00	0.00	0.00
10,500.00	90.00	0.105	7,451.00	2,620.88	-577.02	2,619.82	0.00	0.00	0.00
10,600.00	90.00	0.105	7,451.00	2,720.88	-576.84	2,719.82	0.00	0.00	0.00
10,700.00	90.00	0.105	7,451.00	2,820.88	-576.66	2,819.82	0.00	0.00	0.00
10,800.00	90.00	0.105	7,451.00	2,920.88	-576.47	2,919.82	0.00	0.00	0.00
10,900.00	90.00	0.105	7,451.00	3,020.88	-576.29	3,019.82	0.00	0.00	0.00
11,000.00	90.00	0.105	7,451.00	3,120.88	-576.10	3,119.82	0.00	0.00	0.00
11,100.00	90.00	0.105	7,451.00	3,220.88	-575.92	3,219.82	0.00	0.00	0.00
11,200.00	90.00	0.105	7,451.00	3,320.88	-575.74	3,319.82	0.00	0.00	0.00
11,300.00	90.00	0.105	7,451.00	3,420.88	-575.55	3,419.82	0.00	0.00	0.00
11,400.00	90.00	0.105	7,451.00	3,520.88	-575.37	3,519.82	0.00	0.00	0.00
11,500.00	90.00	0.105	7,451.00	3,620.88	-575.18	3,619.82	0.00	0.00	0.00
11,600.00	90.00	0.105	7,451.00	3,720.88	-575.00	3,719.82	0.00	0.00	0.00
11,700.00	90.00	0.105	7,451.00	3,820.88	-574.82	3,819.82	0.00	0.00	0.00
11,800.00	90.00	0.105	7,451.00	3,920.88	-574.63	3,919.82	0.00	0.00	0.00
11,900.00	90.00	0.105	7,451.00	4,020.88	-574.45	4,019.82	0.00	0.00	0.00
12,000.00	90.00	0.105	7,451.00	4,120.88	-574.26	4,119.82	0.00	0.00	0.00
12,100.00	90.00	0.105	7,451.00	4,220.88	-574.08	4,219.82	0.00	0.00	0.00
12,200.00	90.00	0.105	7,451.00	4,320.88	-573.89	4,319.82	0.00	0.00	0.00
12,300.00	90.00	0.105	7,451.00	4,420.88	-573.71	4,419.82	0.00	0.00	0.00
12,400.00	90.00	0.105	7,451.00	4,520.88	-573.53	4,519.82	0.00	0.00	0.00
12,500.00	90.00	0.105	7,451.00	4,620.88	-573.34	4,619.82	0.00	0.00	0.00
12,600.00	90.00	0.105	7,451.00	4,720.88	-573.16	4,719.82	0.00	0.00	0.00
12,700.00	90.00	0.105	7,451.00	4,820.88	-572.97	4,819.82	0.00	0.00	0.00
12,800.00	90.00	0.105	7,451.00	4,920.88	-572.79	4,919.82	0.00	0.00	0.00
12,900.00	90.00	0.105	7,451.00	5,020.88	-572.61	5,019.82	0.00	0.00	0.00
13,000.00	90.00	0.105	7,451.00	5,120.88	-572.42	5,119.82	0.00	0.00	0.00
13,100.00	90.00	0.105	7,451.00	5,220.88	-572.24	5,219.82	0.00	0.00	0.00
13,200.00	90.00	0.105	7,451.00	5,320.88	-572.05	5,319.82	0.00	0.00	0.00
13,300.00	90.00	0.105	7,451.00	5,420.88	-571.87	5,419.82	0.00	0.00	0.00
13,400.00	90.00	0.105	7,451.00	5,520.88	-571.69	5,519.82	0.00	0.00	0.00
13,500.00	90.00	0.105	7,451.00	5,620.88	-571.50	5,619.82	0.00	0.00	0.00
13,600.00	90.00	0.105	7,451.00	5,720.88	-571.32	5,719.82	0.00	0.00	0.00
13,700.00	90.00	0.105	7,451.00	5,820.88	-571.13	5,819.82	0.00	0.00	0.00
13,800.00	90.00	0.105	7,451.00	5,920.88	-570.95	5,919.82	0.00	0.00	0.00
13,900.00	90.00	0.105	7,451.00	6,020.88	-570.77	6,019.82	0.00	0.00	0.00
14,000.00	90.00	0.105	7,451.00	6,120.88	-570.58	6,119.82	0.00	0.00	0.00
14,100.00	90.00	0.105	7,451.00	6,220.88	-570.40	6,219.82	0.00	0.00	0.00
14,200.00	90.00	0.105	7,451.00	6,320.88	-570.21	6,319.82	0.00	0.00	0.00
14,300.00	90.00	0.105	7,451.00	6,420.88	-570.03	6,419.82	0.00	0.00	0.00
14,400.00	90.00	0.105	7,451.00	6,520.88	-569.84	6,519.82	0.00	0.00	0.00
14,500.00	90.00	0.105	7,451.00	6,620.88	-569.66	6,619.82	0.00	0.00	0.00
14,600.00	90.00	0.105	7,451.00	6,720.88	-569.48	6,719.82	0.00	0.00	0.00
14,700.00	90.00	0.105	7,451.00	6,820.88	-569.29	6,819.82	0.00	0.00	0.00
14,800.00	90.00	0.105	7,451.00	6,920.88	-569.11	6,919.82	0.00	0.00	0.00
14,900.00	90.00	0.105	7,451.00	7,020.88	-568.92	7,019.82	0.00	0.00	0.00

<b>Database:</b>	Casper District	<b>Local Co-ordinate Reference:</b>	Well Critter Creek 17-6401B
<b>Company:</b>	HighPoint Resources	<b>TVD Reference:</b>	GL 5321.9' & KB 20' @ 5341.90ft
<b>Project:</b>	Weld County, CO NAD 83	<b>MD Reference:</b>	GL 5321.9' & KB 20' @ 5341.90ft
<b>Site:</b>	Critter Creek 17 SW Pad	<b>North Reference:</b>	True
<b>Well:</b>	Critter Creek 17-6401B	<b>Survey Calculation Method:</b>	Minimum Curvature
<b>Wellbore:</b>	OH		
<b>Design:</b>	Plan 1		

Planned Survey									
Measured Depth (ft)	Inclination (°)	Azimuth (°)	Vertical Depth (ft)	+N/-S (ft)	+E/-W (ft)	Vertical Section (ft)	Dogleg Rate (°/100ft)	Build Rate (°/100ft)	Turn Rate (°/100ft)
15,000.00	90.00	0.105	7,451.00	7,120.88	-568.74	7,119.82	0.00	0.00	0.00
15,100.00	90.00	0.105	7,451.00	7,220.88	-568.56	7,219.82	0.00	0.00	0.00
15,200.00	90.00	0.105	7,451.00	7,320.88	-568.37	7,319.82	0.00	0.00	0.00
15,300.00	90.00	0.105	7,451.00	7,420.88	-568.19	7,419.82	0.00	0.00	0.00
15,400.00	90.00	0.105	7,451.00	7,520.88	-568.00	7,519.82	0.00	0.00	0.00
15,500.00	90.00	0.105	7,451.00	7,620.88	-567.82	7,619.82	0.00	0.00	0.00
15,600.00	90.00	0.105	7,451.00	7,720.88	-567.64	7,719.82	0.00	0.00	0.00
15,700.00	90.00	0.105	7,451.00	7,820.88	-567.45	7,819.82	0.00	0.00	0.00
15,800.00	90.00	0.105	7,451.00	7,920.88	-567.27	7,919.82	0.00	0.00	0.00
15,900.00	90.00	0.105	7,451.00	8,020.88	-567.08	8,019.82	0.00	0.00	0.00
16,000.00	90.00	0.105	7,451.00	8,120.87	-566.90	8,119.82	0.00	0.00	0.00
16,100.00	90.00	0.105	7,451.00	8,220.87	-566.71	8,219.82	0.00	0.00	0.00
16,200.00	90.00	0.105	7,451.00	8,320.87	-566.53	8,319.82	0.00	0.00	0.00
16,300.00	90.00	0.105	7,451.00	8,420.87	-566.35	8,419.82	0.00	0.00	0.00
16,400.00	90.00	0.105	7,451.00	8,520.87	-566.16	8,519.82	0.00	0.00	0.00
16,500.00	90.00	0.105	7,451.00	8,620.87	-565.98	8,619.82	0.00	0.00	0.00
16,600.00	90.00	0.105	7,451.00	8,720.87	-565.79	8,719.82	0.00	0.00	0.00
16,700.00	90.00	0.105	7,451.00	8,820.87	-565.61	8,819.82	0.00	0.00	0.00
16,800.00	90.00	0.105	7,451.00	8,920.87	-565.43	8,919.82	0.00	0.00	0.00
16,900.00	90.00	0.105	7,451.00	9,020.87	-565.24	9,019.82	0.00	0.00	0.00
17,000.00	90.00	0.105	7,451.00	9,120.87	-565.06	9,119.82	0.00	0.00	0.00
17,100.00	90.00	0.105	7,451.00	9,220.87	-564.87	9,219.82	0.00	0.00	0.00
17,200.00	90.00	0.105	7,451.00	9,320.87	-564.69	9,319.82	0.00	0.00	0.00
17,300.00	90.00	0.105	7,451.00	9,420.87	-564.51	9,419.82	0.00	0.00	0.00
17,400.00	90.00	0.105	7,451.00	9,520.87	-564.32	9,519.82	0.00	0.00	0.00
17,500.00	90.00	0.105	7,451.00	9,620.87	-564.14	9,619.82	0.00	0.00	0.00
17,600.00	90.00	0.105	7,451.00	9,720.87	-563.95	9,719.82	0.00	0.00	0.00
17,700.00	90.00	0.105	7,451.00	9,820.87	-563.77	9,819.82	0.00	0.00	0.00
17,800.00	90.00	0.105	7,451.00	9,920.87	-563.59	9,919.82	0.00	0.00	0.00
17,900.00	90.00	0.105	7,451.00	10,020.87	-563.40	10,019.82	0.00	0.00	0.00
17,937.90	90.00	0.105	7,451.00	10,058.78	-563.33	10,057.73	0.00	0.00	0.00
TD at 17937.90									

Design Targets									
Target Name	Dip Angle (°)	Dip Dir. (°)	TVD (ft)	+N/-S (ft)	+E/-W (ft)	Northing (usft)	Easting (usft)	Latitude	Longitude
- hit/miss target									
- Shape									
Critter Creek 17-6401B I	0.00	0.000	7,451.00	10,058.78	-563.33	1,588,209.27	3,285,900.59	40° 56' 36.308 N	104° 27' 54.526 W
- plan hits target center									
- Point									
Critter Creek 17-6401B I	0.00	0.000	7,451.00	29.53	-581.80	1,578,180.51	3,285,999.39	40° 54' 57.215 N	104° 27' 54.763 W
- plan misses target center by 0.01ft at 7908.64ft MD (7451.00 TVD, 29.53 N, -581.80 E)									
- Point									

<b>Database:</b>	Casper District	<b>Local Co-ordinate Reference:</b>	Well Critter Creek 17-6401B
<b>Company:</b>	HighPoint Resources	<b>TVD Reference:</b>	GL 5321.9' & KB 20' @ 5341.90ft
<b>Project:</b>	Weld County, CO NAD 83	<b>MD Reference:</b>	GL 5321.9' & KB 20' @ 5341.90ft
<b>Site:</b>	Critter Creek 17 SW Pad	<b>North Reference:</b>	True
<b>Well:</b>	Critter Creek 17-6401B	<b>Survey Calculation Method:</b>	Minimum Curvature
<b>Wellbore:</b>	OH		
<b>Design:</b>	Plan 1		

Plan Annotations					
Measured Depth (ft)	Vertical Depth (ft)	Local Coordinates		Comment	
		+N/-S (ft)	+E/-W (ft)		
1,000.00	1,000.00	0.00	0.00	Start Build 2.00	
2,289.99	2,246.84	-194.74	-208.86	Start 300.02 hold at 2289.99 MD	
2,590.01	2,516.95	-283.78	-304.37	Start Drop -1.50	
4,310.00	4,179.40	-543.43	-582.85	Start 2698.64 hold at 4310.00 MD	
7,008.64	6,878.04	-543.43	-582.85	Start DLS 10.00 TFO 0.11	
7,908.64	7,451.00	29.53	-581.80	Start 10029.27 hold at 7908.64 MD	
17,937.90	7,451.00	10,058.78	-563.33	TD at 17937.90	