



Lat40°, Inc. 6250 W. 10th Street, Unit 2, Greeley, CO 970-515-5294

LOCATION DRAWING

AF08-08 PAD

SECTION: 8  
TOWNSHIP: 5N  
RANGE: 62W  
6TH. P.M.  
WELD COUNTY, CO

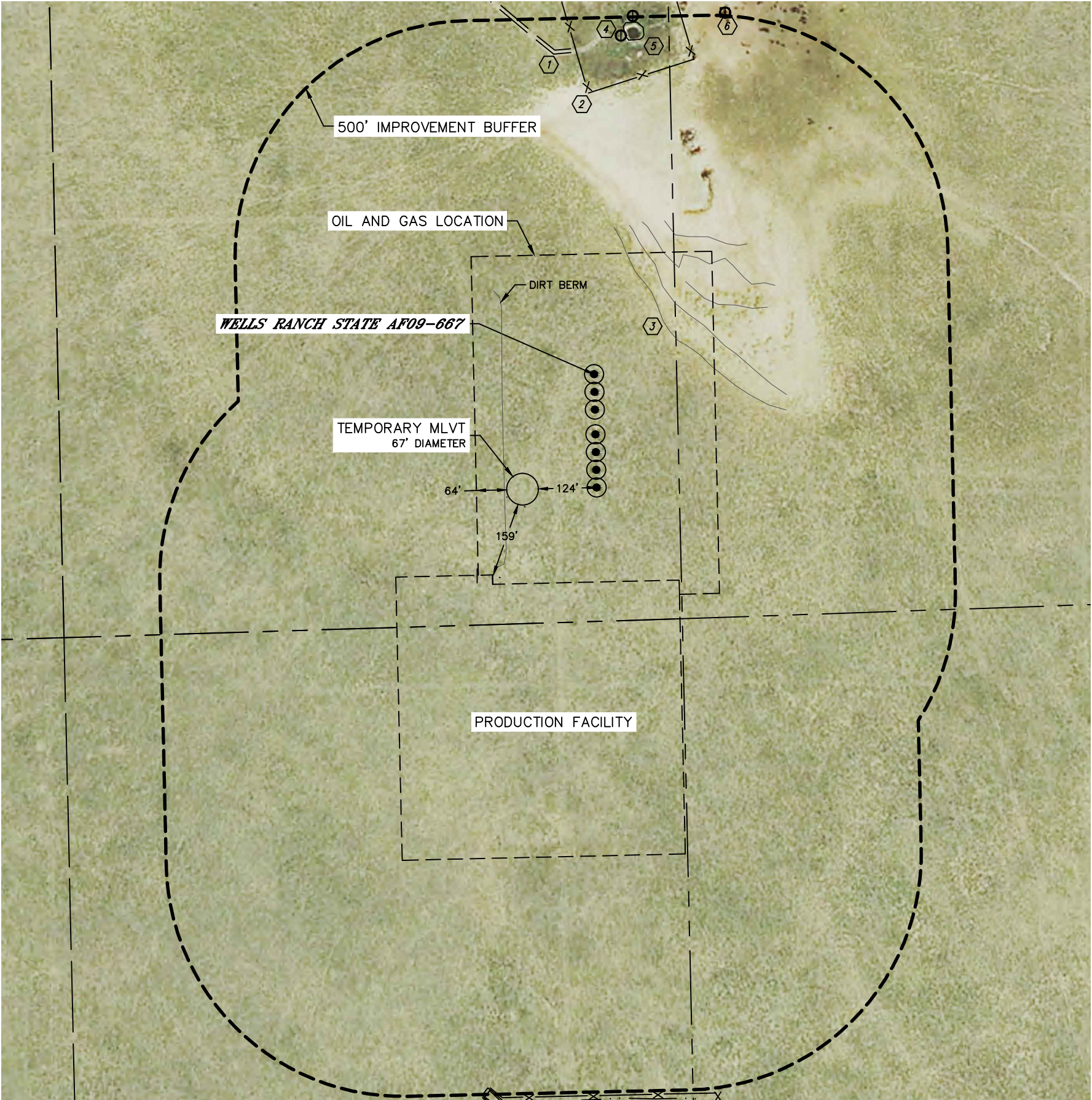

IMPROVEMENTS:  
(MEASURED FROM THE PROPOSED WELLS RANCH STATE AF09-667 WELL LOCATION)

- NO BUILDING UNITS WITHIN 500' IMPROVEMENT BUFFER**
- NO BUILDINGS WITHIN 500' IMPROVEMENT BUFFER**
- ROAD 684' NW
- FENCE 596' N
- SAND DUNE 185' NE
- WINDMILL 720' N
- CONCRETE 712' N
- CONCRETE & WATER TANK 802' N

NEAREST CULTURAL ITEMS		
MEASURED FROM THE NEAREST	PROPOSED WELL HEAD	EDGE OF PRODUCTION FACILITY
BUILDING	5280'+	5280'+
BUILDING UNIT	5280'+	5280'+
HIGH OCCUPANCY BUILDING UNIT	5280'+	5280'+
DESIGNATED OUTSIDE ACTIVITY AREA	5280'+	5280'+
PUBLIC ROAD	5280'+	5280'+
ABOVE GROUND UTILITY	±3006' S	±2224' S
RAILROAD	5280'+	5280'+
PROPERTY LINE	±175' E	±5' E

