

# L&S 3-65 12-11 PAD LOCATION DRAWING

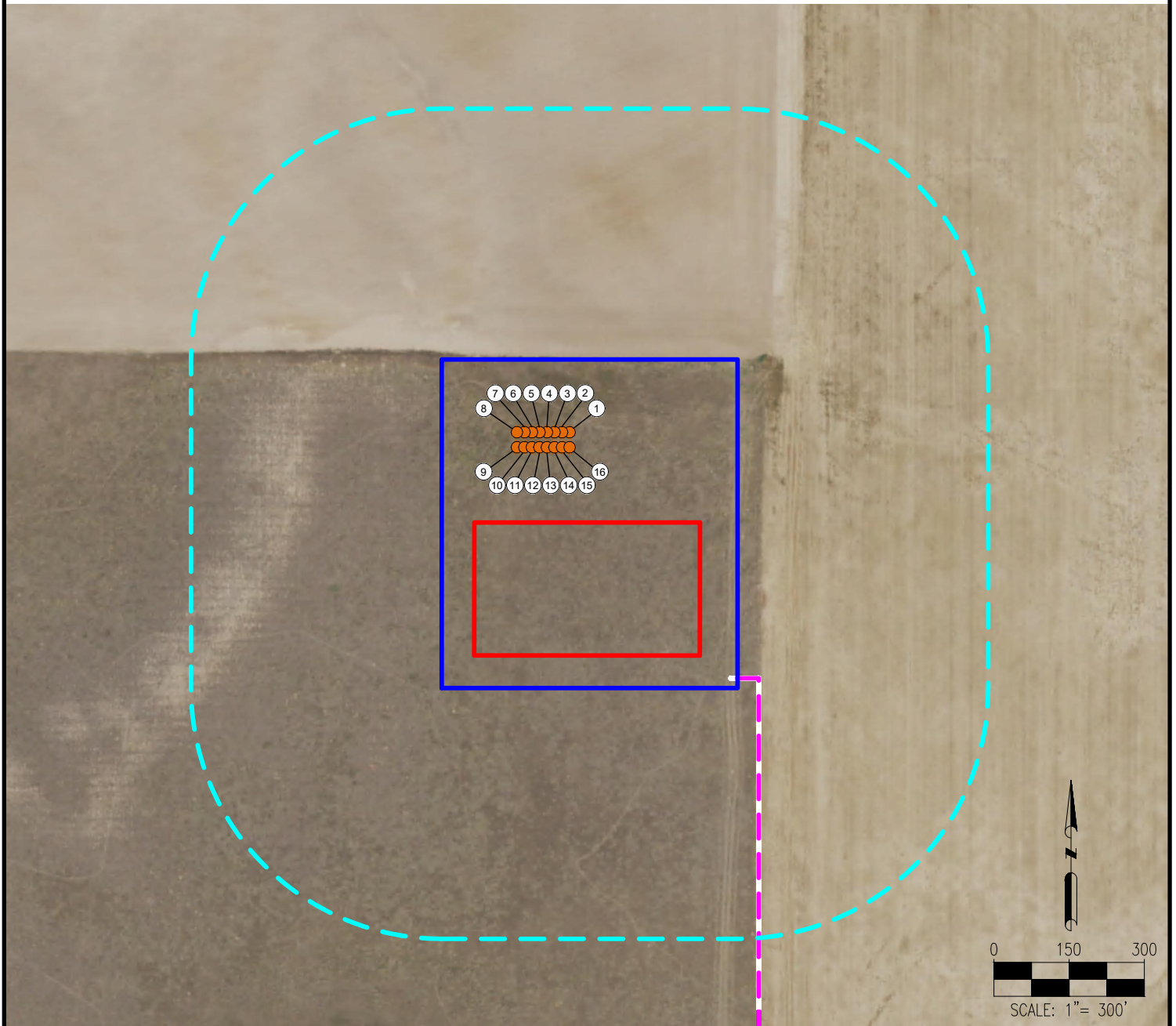

- |                       |                         |
|-----------------------|-------------------------|
| 1. L&S 3-65-12-11-1HN | 9. L&S 3-65-12-11-9HN   |
| 2. L&S 3-65-12-11-2HN | 10. L&S 3-65-12-11-10HN |
| 3. L&S 3-65-12-11-3HN | 11. L&S 3-65-12-11-11HN |
| 4. L&S 3-65-12-11-4HN | 12. L&S 3-65-12-11-12HN |
| 5. L&S 3-65-12-11-5HN | 13. L&S 3-65-12-11-13HN |
| 6. L&S 3-65-12-11-6HN | 14. L&S 3-65-12-11-14HN |
| 7. L&S 3-65-12-11-7HN | 15. L&S 3-65-12-11-15HN |
| 8. L&S 3-65-12-11-8HN | 16. L&S 3-65-12-11-16HN |

## LEGEND:

- |                        |                          |
|------------------------|--------------------------|
| = PROPOSED WELL        | = DISTURBANCE AREA       |
| = PROPOSED ACCESS ROAD | = PROPOSED FACILITY BERM |
|                        | = 500' RADIUS            |

## MEASURED FROM NEAREST WELL OR FACILITY:

BUILDING	±2032' SW
BUILDING UNIT	±2137' SW
PUBLIC ROAD (E 56TH AVE.)	±2062' S
PROPERTY LINE (Chelsea Investments LLC)	±130' E
UTILITY (POWERLINE)	±2137' W
RAILROAD	±5280' S

<b>MEASURED FROM NEAREST EDGE OF DISTURBANCE:</b>	
SURFACE WATER (LOW LYING AREA)	±726' S

## REFERENCE LOCATION

**\*\*L&S 3-65-12-11-4HN\*\***

LAT: 39.804535° N  
LONG: 104.604329° W  
ELEVATION: 5438'  
2490' FSL & 435' FEL  
PDOP: 1.5  
GPS OPERATOR: IAN CARABAJAL

## DISCLAIMER:

THIS PLOT DOES NOT REPRESENT A MONUMENTED LAND SURVEY AND SHOULD NOT BE RELIED UPON TO DETERMINE BOUNDARY LINES, PROPERTY OWNERSHIP OR OTHER PROPERTY INTERESTS. PARCEL LINES, IF DEPICTED HAVE NOT BEEN FIELD VERIFIED AND MAY BE BASED UPON PUBLICLY AVAILABLE DATA THAT ALSO HAS NOT BEEN INDEPENDENTLY VERIFIED.

## DATA SOURCE:

AERIAL IMAGERY: NAIP 2017  
WATER WELLS: COLORADO DWR  
NHD: USGS

PUBLICLY AVAILABLE DATA SOURCES HAVE NOT BEEN INDEPENDENTLY VERIFIED BY ASCENT.

## MEASURED FROM NEAREST EDGE OF DISTURBANCE:

WATER WELL	±1454' NW	SWL = 0'
PERMIT: 25635-F		RECEIPT: 02076871
WATER WELL	±1887' SW	SWL = 42'
PERMIT: 21823		RECEIPT: 9002733

## DISTURBANCE ACREAGE:

8.87 ACRES DRILLING OPERATIONS  
3.50 ACRES INTERIM RECLAIM

CURRENT SURFACE USE: DRY LAND CROP  
FUTURE SURFACE USE: DRY LAND CROP



FIELD DATE:  
06-08-18

DRAWING DATE:  
07-02-18

BY:  
SJH

CHECKED:  
IJM

SITE NAME:  
L&S 3-65 12-11 PAD

SURFACE LOCATION:

NE 1/4 SE 1/4 SEC. 12, T3S, R65W, 6TH P.M.  
ADAMS COUNTY, COLORADO

PREPARED FOR:

