

# L&S 3-65 12-11 PAD HYDROLOGY MAP

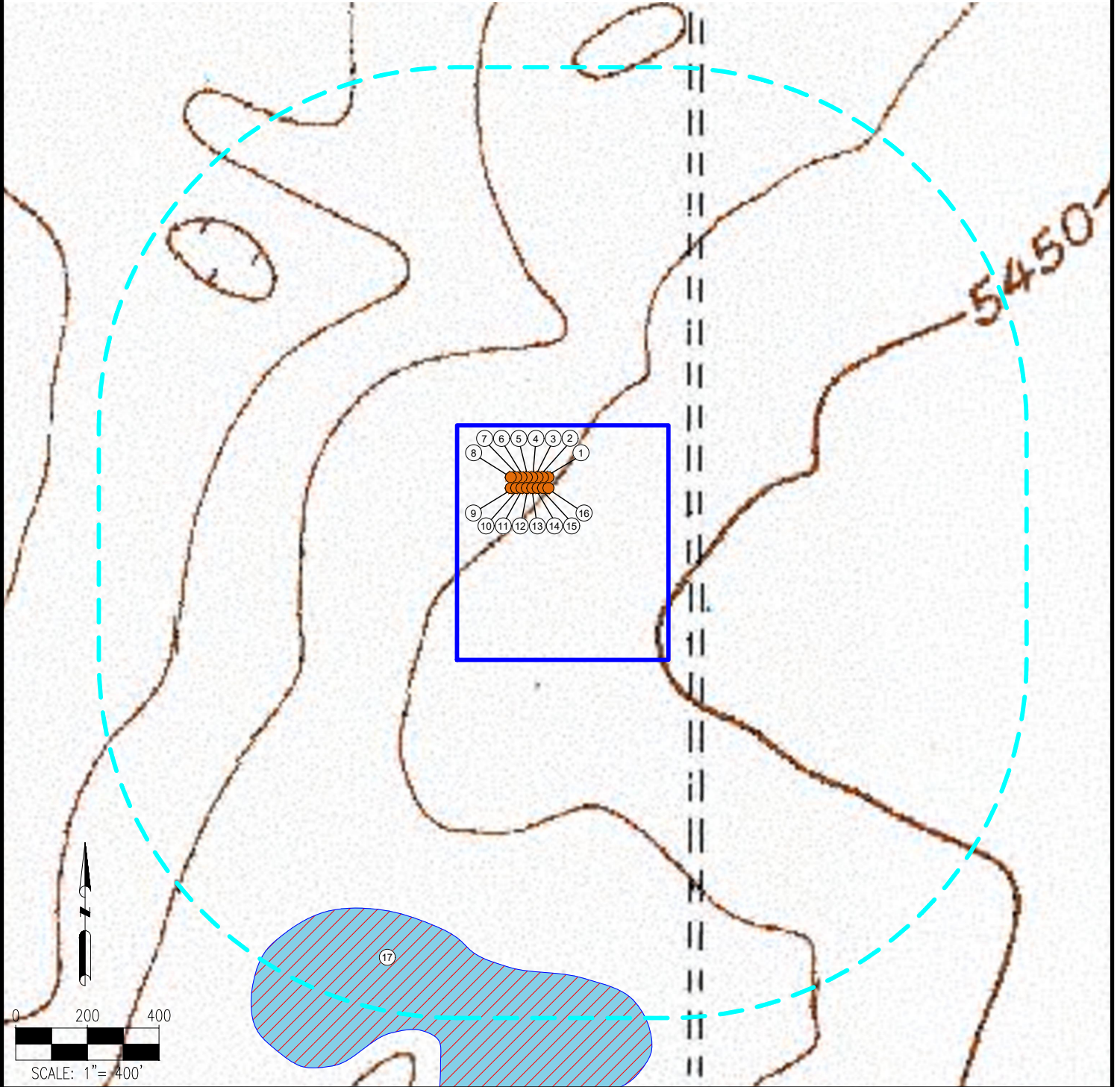

MEASUREMENTS ARE MADE FROM THE NEAREST EDGE OF THE DISTURBANCE AREA.		
1. L&S 3-65-12-11-1HN	7. L&S 3-65-12-11-7HN	13. L&S 3-65-12-11-13HN
2. L&S 3-65-12-11-2HN	8. L&S 3-65-12-11-8HN	14. L&S 3-65-12-11-14HN
3. L&S 3-65-12-11-3HN	9. L&S 3-65-12-11-9HN	15. L&S 3-65-12-11-15HN
4. L&S 3-65-12-11-4HN	10. L&S 3-65-12-11-10HN	16. L&S 3-65-12-11-16HN
5. L&S 3-65-12-11-5HN	11. L&S 3-65-12-11-11HN	17. LOW LYING AREA IS $\pm 726'$ S
6. L&S 3-65-12-11-6HN	12. L&S 3-65-12-11-12HN	

<b>LEGEND:</b> = PROPOSED WELL = LOW LYING AREA = DISTURBANCE AREA = 1000' RADIUS		DISCLAIMER: THIS PLOT DOES NOT REPRESENT A MONUMENTED LAND SURVEY AND SHOULD NOT BE RELIED UPON TO DETERMINE BOUNDARY LINES, PROPERTY OWNERSHIP OR OTHER PROPERTY INTERESTS. PARCEL LINES, IF DEPICTED HAVE NOT BEEN FIELD VERIFIED AND MAY BE BASED UPON PUBLICLY AVAILABLE DATA THAT ALSO HAS NOT BEEN INDEPENDENTLY VERIFIED.	DATA SOURCE: TOPO MAP: USGS NHD: USGS PUBLICLY AVAILABLE DATA SOURCES HAVE NOT BEEN INDEPENDENTLY VERIFIED BY ASCENT.
---	--	---	--

 7535 Hilltop Circle Denver, CO 80221 (303) 928-7128 <a href="http://www.ascentgeomatics.com">www.ascentgeomatics.com</a>	FIELD DATE: <b>06-08-18</b>	SITE NAME: <b>L&amp;S 3-65 12-11 PAD</b>	PREPARED FOR: 
	DRAWING DATE: <b>06-14-18</b> BY: <b>SJH</b>	SURFACE LOCATION: <b>NE 1/4 SE 1/4 SEC. 12, T3S, R65W, 6TH P.M.          ADAMS COUNTY, COLORADO</b>	