

# SRC ENERGY

Location: COLORADO Slot: SLOT#08 HARVESTERS STATE 5C-16-M (1733'FNL & 2334'FEL, SEC.15)  
Field: WELD COUNTY (NAD83,TRUE NORTH) Well: HARVESTERS STATE 5C-16-M  
Facility: SEC.15-T06N-R66W Wellbore: HARVESTERS STATE 5C-16-M PWB

Plot reference wellpath is HARVESTERS STATE 5C-16-M (REV-6.0) PWB	Grid System: NAD83 / Lambert Colorado SP, Northern Zone (501), US feet
True vertical depths are referenced to PRECISION 462 (20') (RKB)	* = Wellpath was transformed from a different geodetic datum
Measured depths are referenced to PRECISION 462 (20') (RKB)	North Reference: True north
PRECISION 462 (20') (RKB) to Mean Sea Level: 4822 feet	Scale: True distance
Mean Sea Level to Mud line (At Slot: SLOT#08 HARVESTERS STATE 5C-16-M (1733'FNL & 2334'FEL, SEC.15)): 0 feet	Depths are in feet
Coordinates are in feet referenced to Slot	Created by: doddiana on 2018-06-06
	Database: WellArchitectDB

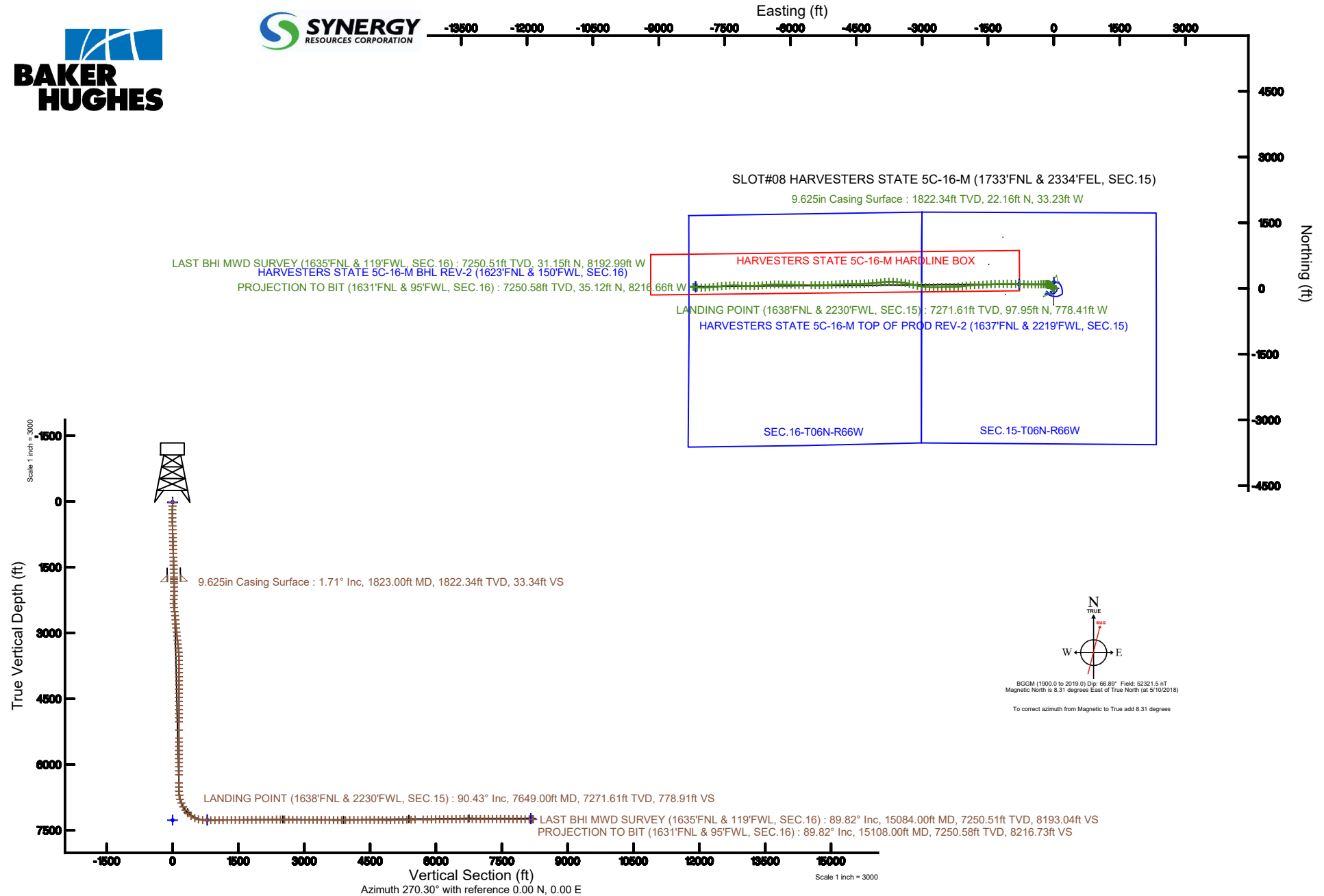



# Actual Wellpath Report

## HARVESTERS STATE 5C-16-M AWP

Page 1 of 9



### REFERENCE WELLPATH IDENTIFICATION

Operator	SRC ENERGY	Slot	SLOT#08 HARVESTERS STATE 5C-16-M (1733'FNL & 2334'FEL, SEC.15)
Area	COLORADO	Well	HARVESTERS STATE 5C-16-M
Field	WELD COUNTY (NAD83,TRUE NORTH)	Wellbore	HARVESTERS STATE 5C-16-M AWB
Facility	SEC.15-T06N-R66W		

### REPORT SETUP INFORMATION

Projection System	NAD83 / Lambert Colorado SP, Northern Zone (501), US feet	Software System	WellArchitect® 5.0
North Reference	True	User	Doddanna
Scale	0.999966	Report Generated	6/6/2018 at 3:48:14 PM
Convergence at slot	0.48° East	Database/Source file	WellArchitectDB/HARVESTERS_STATE_5C-16-M_AWP.xml

### WELLPATH LOCATION

	Local coordinates		Grid coordinates		Geographic coordinates	
	North[ft]	East[ft]	Easting[US ft]	Northing[US ft]	Latitude	Longitude
Slot Location	-139.86	-1.08	3205120.99	1422508.67	40°29'27.046"N	104°45'45.036"W
Facility Reference Pt			3205120.91	1422648.52	40°29'28.428"N	104°45'45.022"W
Field Reference Pt			3171284.48	1426358.81	40°30'07.643"N	104°53'02.634"W

### WELLPATH DATUM

Calculation method	Minimum curvature	PRECISION 462 (20') (RKB) to Facility Vertical Datum	4822.00ft
Horizontal Reference Pt	Slot	PRECISION 462 (20') (RKB) to Mean Sea Level	4822.00ft
Vertical Reference Pt	PRECISION 462 (20') (RKB)	PRECISION 462 (20') (RKB) to Mud Line at Slot (SLOT#08 HARVESTERS STATE 5C-16-M (1733'FNL & 2334'FEL, SEC.15))	4822.00ft
MD Reference Pt	PRECISION 462 (20') (RKB)	Section Origin	N 0.00, E 0.00 ft
Field Vertical Reference	Mean Sea Level	Section Azimuth	270.30°



SRC ENERGY

# Actual Wellpath Report

HARVESTERS STATE 5C-16-M AWP

Page 2 of 9

**BAKER  
HUGHES****REFERENCE WELLPATH IDENTIFICATION**

Operator	SRC ENERGY	Slot	SLOT#08 HARVESTERS STATE 5C-16-M (1733'FNL & 2334'FEL, SEC.15)
Area	COLORADO	Well	HARVESTERS STATE 5C-16-M
Field	WELD COUNTY (NAD83,TRUE NORTH)	Wellbore	HARVESTERS STATE 5C-16-M AWB
Facility	SEC.15-T06N-R66W		

**WELLPATH DATA (162 stations)** † = interpolated/extrapolated station

MD [ft]	Inclination [°]	Azimuth [°]	TVD [ft]	Vert Sect [ft]	North [ft]	East [ft]	DLS [°/100ft]	Comments
0.00†	0.000	127.120	0.00	0.00	0.00	0.00	0.00	
20.00	0.000	127.120	20.00	0.00	0.00	0.00	0.00	
102.00	1.010	127.120	102.00	-0.58	-0.44	0.58	1.23	
189.00	0.480	84.380	188.99	-1.55	-0.86	1.55	0.84	
280.00	0.740	31.460	279.98	-2.24	-0.32	2.24	0.65	
373.00	0.870	1.470	372.98	-2.56	0.89	2.57	0.47	
464.00	1.400	325.640	463.96	-1.95	2.50	1.96	0.95	
554.00	1.790	322.310	553.92	-0.45	4.52	0.48	0.45	
644.00	1.790	304.800	643.88	1.57	6.44	-1.54	0.61	
734.00	1.650	299.010	733.84	3.86	7.87	-3.82	0.25	
824.00	1.920	289.650	823.80	6.42	9.00	-6.38	0.44	
914.00	1.840	292.500	913.75	9.18	10.06	-9.13	0.14	
1004.00	1.690	293.480	1003.70	11.74	11.14	-11.68	0.17	
1094.00	1.480	295.340	1093.67	14.01	12.17	-13.95	0.24	
1184.00	1.750	292.920	1183.63	16.34	13.20	-16.27	0.31	
1274.00	1.660	292.300	1273.59	18.81	14.23	-18.74	0.10	
1364.00	1.600	285.630	1363.56	21.23	15.07	-21.15	0.22	
1454.00	1.840	290.200	1453.52	23.80	15.90	-23.72	0.31	
1544.00	1.640	296.160	1543.48	26.32	16.97	-26.23	0.30	
1634.00	2.030	312.480	1633.43	28.66	18.61	-28.56	0.72	
1724.00	1.780	303.140	1723.38	31.02	20.45	-30.91	0.44	
1772.00	1.600	304.640	1771.36	32.20	21.24	-32.09	0.39	
1863.00	1.810	318.660	1862.32	34.20	23.04	-34.08	0.51	
1956.00	3.540	4.100	1955.22	34.99	27.01	-34.85	2.81	
2050.00	4.230	18.810	2049.01	33.69	33.19	-33.52	1.28	
2144.00	4.600	37.600	2142.74	30.31	39.46	-30.10	1.58	
2236.00	5.950	40.150	2234.34	25.02	46.02	-24.78	1.49	
2330.00	7.700	337.520	2327.79	24.33	55.58	-24.04	7.70	
2423.00	9.120	272.560	2419.98	34.13	61.68	-33.81	9.77	
2516.00	6.390	255.610	2512.13	46.50	60.72	-46.19	3.80	



SRC ENERGY

# Actual Wellpath Report

HARVESTERS STATE 5C-16-M AWP

Page 3 of 9

**BAKER  
HUGHES****REFERENCE WELLPATH IDENTIFICATION**

Operator	SRC ENERGY	Slot	SLOT#08 HARVESTERS STATE 5C-16-M (1733'FNL & 2334'FEL, SEC.15)
Area	COLORADO	Well	HARVESTERS STATE 5C-16-M
Field	WELD COUNTY (NAD83,TRUE NORTH)	Wellbore	HARVESTERS STATE 5C-16-M AWP
Facility	SEC.15-T06N-R66W		

**WELLPATH DATA (162 stations)**

MD [ft]	Inclination [°]	Azimuth [°]	TVD [ft]	Vert Sect [ft]	North [ft]	East [ft]	DLS [°/100ft]	Comments
2610.00	6.620	298.340	2605.58	56.35	61.99	-56.03	5.04	
2703.00	6.400	309.720	2697.98	65.09	67.85	-64.73	1.40	
2798.00	6.550	306.440	2792.38	73.55	74.45	-73.17	0.42	
2891.00	6.410	298.500	2884.78	82.41	80.08	-82.00	0.97	
2984.00	6.390	294.000	2977.21	91.72	84.66	-91.29	0.54	
3078.00	6.260	287.330	3070.63	101.41	88.32	-100.96	0.79	
3171.00	6.520	287.380	3163.06	111.31	91.41	-110.84	0.28	
3263.00	6.460	286.940	3254.47	121.26	94.47	-120.77	0.08	
3356.00	6.570	285.480	3346.87	131.41	97.42	-130.90	0.21	
3448.00	4.750	277.690	3438.42	140.27	99.33	-139.75	2.14	
3542.00	2.940	213.490	3532.24	145.45	97.84	-144.94	4.64	
3635.00	3.690	165.750	3625.10	146.00	92.95	-145.52	2.98	
3728.00	0.070	190.550	3718.03	145.26	89.99	-144.79	3.90	
3822.00	0.060	192.800	3812.03	145.28	89.89	-144.82	0.01	
3915.00	0.040	206.030	3905.03	145.31	89.81	-144.84	0.02	
4008.00	0.060	234.800	3998.03	145.36	89.76	-144.89	0.03	
4102.00	0.060	27.550	4092.03	145.38	89.77	-144.91	0.12	
4197.00	0.090	209.610	4187.03	145.39	89.75	-144.93	0.16	
4291.00	0.100	6.990	4281.03	145.42	89.77	-144.95	0.20	
4385.00	0.130	271.300	4375.03	145.51	89.85	-145.05	0.18	
4478.00	0.090	96.930	4468.03	145.55	89.85	-145.08	0.24	
4572.00	0.030	3.290	4562.03	145.47	89.86	-145.01	0.10	
4664.00	0.140	203.600	4654.03	145.52	89.78	-145.05	0.18	
4759.00	0.030	270.490	4749.03	145.59	89.68	-145.12	0.14	
4851.00	0.040	287.420	4841.03	145.64	89.69	-145.18	0.02	
4944.00	0.030	255.290	4934.03	145.70	89.69	-145.23	0.02	
5037.00	0.040	116.910	5027.03	145.69	89.67	-145.23	0.07	
5224.00	0.030	103.980	5214.03	145.58	89.63	-145.12	0.01	
5410.00	0.110	252.110	5400.03	145.71	89.56	-145.24	0.07	
5503.00	0.030	26.270	5493.03	145.78	89.55	-145.32	0.14	



SRC ENERGY

# Actual Wellpath Report

HARVESTERS STATE 5C-16-M AWP

Page 4 of 9

**BAKER  
HUGHES****REFERENCE WELLPATH IDENTIFICATION**

Operator	SRC ENERGY	Slot	SLOT#08 HARVESTERS STATE 5C-16-M (1733'FNL & 2334'FEL, SEC.15)
Area	COLORADO	Well	HARVESTERS STATE 5C-16-M
Field	WELD COUNTY (NAD83,TRUE NORTH)	Wellbore	HARVESTERS STATE 5C-16-M AWB
Facility	SEC.15-T06N-R66W		

**WELLPATH DATA (162 stations)**

MD [ft]	Inclination [°]	Azimuth [°]	TVD [ft]	Vert Sect [ft]	North [ft]	East [ft]	DLS [°/100ft]	Comments
5596.00	0.130	205.680	5586.03	145.82	89.48	-145.35	0.17	
5690.00	0.040	178.680	5680.03	145.86	89.35	-145.40	0.10	
5783.00	0.060	261.600	5773.03	145.91	89.31	-145.45	0.07	
5876.00	0.030	251.030	5866.03	145.98	89.30	-145.52	0.03	
5968.00	0.150	300.370	5958.03	146.11	89.35	-145.64	0.14	
6062.00	0.000	97.550	6052.03	146.21	89.41	-145.75	0.16	
6155.00	0.040	262.950	6145.03	146.24	89.41	-145.78	0.04	
6248.00	0.090	241.660	6238.03	146.34	89.37	-145.88	0.06	
6433.00	0.040	292.390	6423.03	146.53	89.33	-146.07	0.04	
6526.00	0.190	287.490	6516.03	146.71	89.38	-146.24	0.16	
6620.00	0.070	308.090	6610.03	146.90	89.47	-146.44	0.13	
6713.00	7.980	275.360	6702.73	153.39	90.11	-152.92	8.52	
6807.00	15.480	288.040	6794.71	171.86	94.61	-171.37	8.39	
6899.00	21.630	271.230	6881.95	200.56	98.78	-200.05	8.80	
6992.00	28.700	266.730	6966.08	240.04	97.87	-239.53	7.87	
7086.00	35.910	267.030	7045.48	290.15	95.15	-289.66	7.67	
7179.00	45.090	268.220	7116.12	350.42	92.71	-349.94	9.91	
7273.00	54.620	268.650	7176.65	422.15	90.77	-421.69	10.14	
7368.00	66.340	270.860	7223.39	504.67	90.51	-504.20	12.50	
7461.00	75.210	271.940	7253.98	592.37	92.68	-591.90	9.60	
7554.00	86.300	271.200	7268.90	684.00	95.18	-683.51	11.95	
7649.00	90.430	272.150	7271.61	778.91	97.95	-778.41	4.46	LANDING POINT (1638'FNL & 2230'FWL, SEC.15)
7742.00	90.400	272.320	7270.93	871.86	101.58	-871.34	0.19	
7835.00	90.250	270.370	7270.40	964.84	103.76	-964.31	2.10	
7929.00	90.520	269.840	7269.77	1058.83	103.94	-1058.31	0.63	
8022.00	90.430	269.470	7269.00	1151.82	103.38	-1151.30	0.41	
8115.00	90.460	268.970	7268.28	1244.80	102.11	-1244.29	0.54	
8209.00	90.460	268.110	7267.53	1338.76	99.72	-1338.25	0.91	
8302.00	90.460	267.150	7266.78	1431.65	95.87	-1431.17	1.03	
8395.00	90.490	266.880	7266.01	1524.49	91.03	-1524.04	0.29	



SRC ENERGY

# Actual Wellpath Report

HARVESTERS STATE 5C-16-M AWP

Page 5 of 9

**BAKER  
HUGHES****REFERENCE WELLPATH IDENTIFICATION**

Operator	SRC ENERGY	Slot	SLOT#08 HARVESTERS STATE 5C-16-M (1733'FNL & 2334'FEL, SEC.15)
Area	COLORADO	Well	HARVESTERS STATE 5C-16-M
Field	WELD COUNTY (NAD83,TRUE NORTH)	Wellbore	HARVESTERS STATE 5C-16-M AWP
Facility	SEC.15-T06N-R66W		

**WELLPATH DATA (162 stations)**

MD [ft]	Inclination [°]	Azimuth [°]	TVD [ft]	Vert Sect [ft]	North [ft]	East [ft]	DLS [°/100ft]	Comments
8488.00	90.370	267.570	7265.31	1617.36	86.52	-1616.93	0.75	
8582.00	90.400	267.000	7264.68	1711.22	82.07	-1710.82	0.61	
8676.00	90.490	266.400	7263.95	1805.04	76.66	-1804.66	0.65	
8770.00	90.180	265.930	7263.40	1898.79	70.37	-1898.45	0.60	
8864.00	90.370	262.000	7262.95	1992.20	60.49	-1991.91	4.19	
8958.00	90.710	263.150	7262.06	2085.34	48.35	-2085.11	1.28	
9050.00	90.490	267.390	7261.10	2176.96	40.76	-2176.78	4.61	
9145.00	90.460	269.800	7260.31	2271.91	38.43	-2271.74	2.54	
9240.00	90.430	269.800	7259.57	2366.90	38.10	-2366.73	0.03	
9332.00	90.620	268.330	7258.73	2458.87	36.60	-2458.71	1.61	
9425.00	89.200	268.760	7258.87	2551.83	34.24	-2551.68	1.60	
9519.00	88.770	268.130	7260.54	2645.76	31.69	-2645.63	0.81	
9613.00	88.770	269.090	7262.56	2739.70	29.41	-2739.58	1.02	
9706.00	89.010	271.750	7264.36	2832.67	30.09	-2832.55	2.87	
9799.00	89.600	275.080	7265.49	2925.51	35.63	-2925.37	3.64	
9893.00	89.850	279.930	7265.94	3018.74	47.90	-3018.53	5.17	
9986.00	89.600	281.490	7266.39	3110.21	65.19	-3109.91	1.70	
10080.00	89.850	282.550	7266.84	3202.24	84.76	-3201.85	1.16	
10174.00	89.820	281.440	7267.11	3294.29	104.30	-3293.79	1.18	
10266.00	89.480	279.870	7267.67	3384.79	121.31	-3384.20	1.75	
10359.00	89.820	277.580	7268.24	3476.77	135.41	-3476.12	2.49	
10454.00	89.630	274.780	7268.69	3571.26	145.64	-3570.55	2.95	
10548.00	89.660	271.530	7269.28	3665.13	150.81	-3664.40	3.46	
10642.00	89.690	269.220	7269.81	3759.12	151.43	-3758.39	2.46	
10734.00	89.600	265.700	7270.38	3851.00	147.35	-3850.28	3.83	
10827.00	90.710	263.850	7270.13	3943.56	138.88	-3942.89	2.32	
10921.00	90.770	264.540	7268.91	4037.02	129.37	-4036.40	0.74	
11013.00	90.710	266.330	7267.73	4128.67	122.05	-4128.09	1.95	
11107.00	90.310	266.290	7266.89	4222.44	116.00	-4221.90	0.43	
11201.00	90.950	265.820	7265.86	4316.18	109.54	-4315.67	0.84	



SRC ENERGY

# Actual Wellpath Report

HARVESTERS STATE 5C-16-M AWP

Page 6 of 9

**BAKER  
HUGHES****REFERENCE WELLPATH IDENTIFICATION**

Operator	SRC ENERGY	Slot	SLOT#08 HARVESTERS STATE 5C-16-M (1733'FNL & 2334'FEL, SEC.15)
Area	COLORADO	Well	HARVESTERS STATE 5C-16-M
Field	WELD COUNTY (NAD83,TRUE NORTH)	Wellbore	HARVESTERS STATE 5C-16-M AWB
Facility	SEC.15-T06N-R66W		

**WELLPATH DATA (162 stations)**

MD [ft]	Inclination [°]	Azimuth [°]	TVD [ft]	Vert Sect [ft]	North [ft]	East [ft]	DLS [°/100ft]	Comments
11294.00	90.580	267.350	7264.61	4408.97	104.00	-4408.49	1.69	
11386.00	90.800	269.530	7263.51	4500.91	101.49	-4500.44	2.38	
11480.00	89.540	269.660	7263.23	4594.90	100.83	-4594.44	1.35	
11574.00	88.680	269.770	7264.69	4688.89	100.36	-4688.43	0.92	
11666.00	87.540	268.780	7267.72	4780.82	99.20	-4780.37	1.64	
11758.00	90.060	267.390	7269.65	4872.72	96.12	-4872.28	3.13	
11852.00	90.710	266.450	7269.02	4966.55	91.07	-4966.15	1.22	
11945.00	90.920	266.050	7267.69	5059.31	84.99	-5058.94	0.49	
12038.00	90.890	266.490	7266.22	5152.07	78.94	-5151.73	0.47	
12132.00	91.420	269.700	7264.33	5245.97	75.82	-5245.64	3.46	
12225.00	91.450	270.110	7262.00	5338.94	75.66	-5338.61	0.44	
12319.00	91.350	270.450	7259.70	5432.91	76.12	-5432.59	0.38	
12411.00	90.740	271.480	7258.03	5524.88	77.67	-5524.56	1.30	
12597.00	90.370	270.050	7256.22	5710.86	80.16	-5710.52	0.79	
12690.00	90.710	271.560	7255.35	5803.85	81.46	-5803.51	1.66	
12785.00	90.490	271.710	7254.35	5898.82	84.17	-5898.46	0.28	
12877.00	90.710	271.180	7253.39	5990.80	86.49	-5990.43	0.62	
12971.00	90.550	270.740	7252.36	6084.79	88.07	-6084.41	0.50	
13063.00	90.520	272.020	7251.50	6176.76	90.28	-6176.38	1.39	
13156.00	90.580	271.360	7250.60	6269.73	93.03	-6269.33	0.71	
13249.00	90.460	268.760	7249.76	6362.72	93.12	-6362.32	2.80	
13342.00	90.280	265.850	7249.16	6455.58	88.75	-6455.21	3.13	
13435.00	90.430	264.100	7248.58	6548.17	80.61	-6547.84	1.89	
13528.00	90.430	264.930	7247.89	6640.70	71.72	-6640.41	0.89	
13620.00	90.180	265.980	7247.40	6732.37	64.43	-6732.12	1.17	
13713.00	90.580	267.490	7246.78	6825.18	59.13	-6824.97	1.68	
13806.00	90.550	269.180	7245.86	6918.12	56.43	-6917.92	1.82	
13900.00	89.970	271.940	7245.43	7012.11	57.35	-7011.90	3.00	
13993.00	89.690	273.740	7245.71	7105.01	61.95	-7104.79	1.96	
14085.00	89.660	272.970	7246.23	7196.88	67.34	-7196.63	0.84	



SRC ENERGY

# Actual Wellpath Report

HARVESTERS STATE 5C-16-M AWP

Page 7 of 9



## REFERENCE WELLPATH IDENTIFICATION

Operator	SRC ENERGY	Slot	SLOT#08 HARVESTERS STATE 5C-16-M (1733'FNL & 2334'FEL, SEC.15)
Area	COLORADO	Well	HARVESTERS STATE 5C-16-M
Field	WELD COUNTY (NAD83,TRUE NORTH)	Wellbore	HARVESTERS STATE 5C-16-M AWB
Facility	SEC.15-T06N-R66W		

## WELLPATH DATA (162 stations)

MD [ft]	Inclination [°]	Azimuth [°]	TVD [ft]	Vert Sect [ft]	North [ft]	East [ft]	DLS [°/100ft]	Comments
14174.00	89.720	270.250	7246.71	7285.85	69.84	-7285.58	3.06	
14270.00	89.750	267.020	7247.16	7381.79	67.55	-7381.54	3.36	
14362.00	89.780	264.460	7247.54	7473.49	60.72	-7473.28	2.78	
14457.00	89.880	265.260	7247.82	7568.06	52.21	-7567.89	0.85	
14551.00	89.720	265.130	7248.15	7661.69	44.33	-7661.56	0.22	
14644.00	89.570	264.780	7248.72	7754.28	36.16	-7754.20	0.41	
14737.00	89.780	265.420	7249.25	7846.90	28.21	-7846.86	0.72	
14829.00	89.750	266.510	7249.63	7938.63	21.74	-7938.63	1.19	
14923.00	89.780	270.590	7250.01	8032.57	19.36	-8032.58	4.34	
15016.00	89.850	274.050	7250.31	8125.50	23.12	-8125.49	3.72	
15084.00	89.820	279.510	7250.51	8193.04	31.15	-8192.99	8.03	LAST BHI MWD SURVEY (1635'FNL & 119'FWL, SEC.16)
15108.00	89.820	279.510	7250.58	8216.73	35.12	-8216.66	0.00	PROJECTION TO BIT (1631'FNL & 95'FWL, SEC.16)

## HOLE & CASING SECTIONS

- Ref Wellbore: HARVESTERS STATE 5C-16-M AWB

Ref Wellpath: HARVESTERS STATE 5C-16-M AWP

String/Diameter	Start MD [ft]	End MD [ft]	Interval [ft]	Start TVD [ft]	End TVD [ft]	Start N/S [ft]	Start E/W [ft]	End N/S [ft]	End E/W [ft]
13.5in Open Hole	20.00	1823.00	1803.00	20.00	1822.34	0.00	0.00	22.16	-33.23
9.625in Casing Surface	20.00	1823.00	1803.00	20.00	1822.34	0.00	0.00	22.16	-33.23
8.5in Open Hole	1823.00	15108.00	13285.00	1822.34	7250.58	22.16	-33.23	35.12	-8216.66





SRC ENERGY

# Actual Wellpath Report

HARVESTERS STATE 5C-16-M AWP

Page 8 of 9



## REFERENCE WELLPATH IDENTIFICATION

Operator	SRC ENERGY	Slot	SLOT#08 HARVESTERS STATE 5C-16-M (1733'FNL & 2334'FEL, SEC.15)
Area	COLORADO	Well	HARVESTERS STATE 5C-16-M
Field	WELD COUNTY (NAD83, TRUE NORTH)	Wellbore	HARVESTERS STATE 5C-16-M AWB
Facility	SEC.15-T06N-R66W		

## TARGETS

Name	TVD [ft]	North [ft]	East [ft]	Grid East [US ft]	Grid North [US ft]	Latitude	Longitude	Shape
SEC.15-T06N-R66W	16.00	139.86	1.08	3205120.91	1422648.52	40°29'28.428"N	104°45'45.022"W	polygon
SEC.16-T06N-R66W	16.00	139.86	1.08	3205120.91	1422648.52	40°29'28.428"N	104°45'45.022"W	polygon
HARVESTERS STATE 5C-16-M BHL REV-2 (1623'FNL & 150'FWL, SEC.16)	7232.82	42.48	-8161.66	3196959.56	1422483.27	40°29'27.452"N	104°47'30.671"W	point
HARVESTERS STATE 5C-16-M BHL ON PLAT (1623'FNL & 150'FWL, SEC.16)	7240.00	42.48	-8161.66	3196959.56	1422483.27	40°29'27.452"N	104°47'30.671"W	point
HARVESTERS STATE 5C-16-M TOP OF PROD ON PLAT (1637'FNL & 2219'FWL, SEC.15)	7263.00	99.07	-789.10	3204331.12	1422601.16	40°29'28.025"N	104°45'55.249"W	point
HARVESTERS STATE 5C-16-M HARDLINE BOX	7270.10	0.00	0.00	3205120.99	1422508.67	40°29'27.046"N	104°45'45.036"W	polygon
HARVESTERS STATE 5C-16-M TOP OF PROD REV-2 (1637'FNL & 2219'FWL, SEC.15)	7270.10	99.07	-789.10	3204331.12	1422601.17	40°29'28.025"N	104°45'55.249"W	point

## WELLPATH COMPOSITION - Ref Wellbore: HARVESTERS STATE 5C-16-M AWB Ref Wellpath: HARVESTERS STATE 5C-16-M AWP

Start MD [ft]	End MD [ft]	Positional Uncertainty Model	Log Name/Comment	Wellbore
20.00	1772.00	BHI NaviTrak (Rotating+Axial Corr)	13 1/2" SURFACE SURVEYS <86'-1756'>	HARVESTERS STATE 5C-16-M AWB
1772.00	15084.00	BHI AutoTrak Curve (MagCAD+IFR1, Short spacing)	8 1/2" MONOBORE SURVEYS <1863'-15084'>	HARVESTERS STATE 5C-16-M AWB
15084.00	15108.00	Blind Drilling (std)	Projection to bit	HARVESTERS STATE 5C-16-M AWB



SRC ENERGY

# Actual Wellpath Report

HARVESTERS STATE 5C-16-M AWP

Page 9 of 9

**BAKER  
HUGHES****REFERENCE WELLPATH IDENTIFICATION**

Operator	SRC ENERGY	Slot	SLOT#08 HARVESTERS STATE 5C-16-M (1733'FNL & 2334'FEL, SEC.15)
Area	COLORADO	Well	HARVESTERS STATE 5C-16-M
Field	WELD COUNTY (NAD83,TRUE NORTH)	Wellbore	HARVESTERS STATE 5C-16-M AWB
Facility	SEC.15-T06N-R66W		

**WELLPATH COMMENTS**

MD [ft]	Inclination [°]	Azimuth [°]	TVD [ft]	Comment
7649.00	90.430	272.150	7271.61	LANDING POINT (1638'FNL & 2230'FWL, SEC.15)
15084.00	89.820	279.510	7250.51	LAST BHI MWD SURVEY (1635'FNL & 119'FWL, SEC.16)
15108.00	89.820	279.510	7250.58	PROJECTION TO BIT (1631'FNL & 95'FWL, SEC.16)