

SRC ENERGY

Location: COLORADO Slot: SLOT#09 HARVESTERS STATE 5N-16C-M (1753'FNL & 2334'FEL, SEC.15)
Field: WELD COUNTY (NAD83,TRUE NORTH) Well: HARVESTERS STATE 5N-16C-M
Facility: SEC.15-T06N-R66W Wellbore: HARVESTERS STATE 5N-16C-M PWB

Plot reference wellpath is HARVESTERS STATE 5N-16C-M (REV-8.0) PWP	Grid System: NAD83 / Lambert Colorado SP, Northern Zone (501), US feet
True vertical depths are referenced to PRECISION 462 (20') (RKB)	* = Wellpath was transformed from a different geodetic datum
Measured depths are referenced to PRECISION 462 (20') (RKB)	North Reference: True north
PRECISION 462 (20') (RKB) to Mean Sea Level: 4822 feet	Scale: True distance
Mean Sea Level to Mud line (At Slot: SLOT#09 HARVESTERS STATE 5N-16C-M (1753'FNL & 2334'FEL, SEC.15)): 0 feet	Depths are in feet
Coordinates are in feet referenced to Slot	Created by: doddanna on 2018-06-06
	Database: WellArchitect:DB

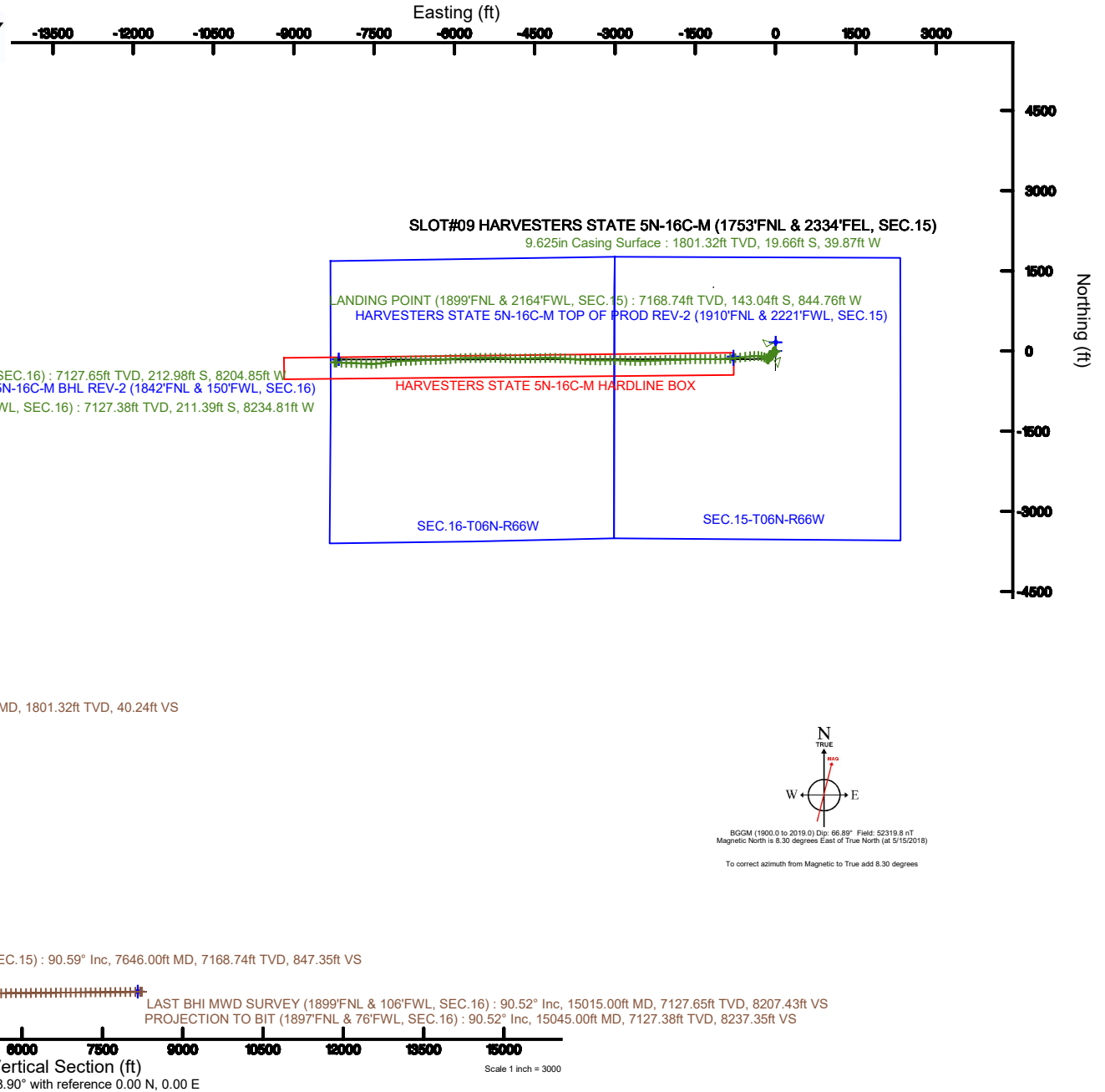



Actual Wellpath Report

HARVESTERS STATE 5N-16C-M AWP

Page 1 of 9



REFERENCE WELLPATH IDENTIFICATION			
Operator	SRC ENERGY	Slot	SLOT#09 HARVESTERS STATE 5N-16C-M (1753'FNL & 2334'FEL, SEC.15)
Area	COLORADO	Well	HARVESTERS STATE 5N-16C-M
Field	WELD COUNTY (NAD83, TRUE NORTH)	Wellbore	HARVESTERS STATE 5N-16C-M AWP
Facility	SEC.15-T06N-R66W		

REPORT SETUP INFORMATION			
Projection System	NAD83 / Lambert Colorado SP, Northern Zone (501), US feet	Software System	WellArchitect® 5.0
North Reference	True	User	Doddanna
Scale	0.999966	Report Generated	6/6/2018 at 4:05:33 PM
Convergence at slot	0.48° East	Database/Source file	WellArchitectDB/HARVESTERS_STATE_5N-16C-M_AWP.xml

WELLPATH LOCATION						
	Local coordinates		Grid coordinates		Geographic coordinates	
	North[ft]	East[ft]	Easting[US ft]	Northing[US ft]	Latitude	Longitude
Slot Location	-159.90	-1.39	3205120.85	1422488.63	40°29'26.848"N	104°45'45.040"W
Facility Reference Pt			3205120.91	1422648.52	40°29'28.428"N	104°45'45.022"W
Field Reference Pt			3171284.48	1426358.81	40°30'07.643"N	104°53'02.634"W

WELLPATH DATUM			
Calculation method	Minimum curvature	PRECISION 462 (20') (RKB) to Facility Vertical Datum	4822.00ft
Horizontal Reference Pt	Slot	PRECISION 462 (20') (RKB) to Mean Sea Level	4822.00ft
Vertical Reference Pt	PRECISION 462 (20') (RKB)	PRECISION 462 (20') (RKB) to Mud Line at Slot (SLOT#09 HARVESTERS STATE 5N-16C-M (1753'FNL & 2334'FEL, SEC.15))	4822.00ft
MD Reference Pt	PRECISION 462 (20') (RKB)	Section Origin	N 0.00, E 0.00 ft
Field Vertical Reference	Mean Sea Level	Section Azimuth	268.90°



Actual Wellpath Report

HARVESTERS STATE 5N-16C-M AWP

Page 2 of 9



REFERENCE WELLPATH IDENTIFICATION			
Operator	SRC ENERGY	Slot	SLOT#09 HARVESTERS STATE 5N-16C-M (1753'FNL & 2334'FEL, SEC.15)
Area	COLORADO	Well	HARVESTERS STATE 5N-16C-M
Field	WELD COUNTY (NAD83,TRUE NORTH)	Wellbore	HARVESTERS STATE 5N-16C-M AWP
Facility	SEC.15-T06N-R66W		

WELLPATH DATA (164 stations) † = interpolated/extrapolated station								Comments
MD [ft]	Inclination [°]	Azimuth [°]	TVD [ft]	Vert Sect [ft]	North [ft]	East [ft]	DLS [°/100ft]	
0.00†	0.000	351.560	0.00	0.00	0.00	0.00	0.00	
20.00	0.000	351.560	20.00	0.00	0.00	0.00	0.00	
102.00	0.100	351.560	102.00	0.01	0.07	-0.01	0.12	
189.00	0.160	162.060	189.00	-0.02	0.03	0.02	0.30	
280.00	0.260	229.340	280.00	0.11	-0.23	-0.10	0.27	
373.00	1.950	252.430	372.98	1.79	-0.84	-1.77	1.84	
464.00	2.130	251.250	463.92	4.88	-1.85	-4.85	0.20	
554.00	2.020	256.050	553.86	8.02	-2.77	-7.97	0.23	
644.00	1.690	248.730	643.82	10.81	-3.64	-10.75	0.45	
734.00	1.710	253.860	733.78	13.36	-4.49	-13.27	0.17	
824.00	1.430	249.470	823.74	15.71	-5.26	-15.62	0.34	
914.00	1.510	236.830	913.71	17.78	-6.30	-17.66	0.37	
1004.00	1.590	245.120	1003.68	19.92	-7.47	-19.78	0.26	
1094.00	1.540	248.050	1093.65	22.20	-8.45	-22.04	0.10	
1184.00	1.620	258.190	1183.61	24.58	-9.16	-24.41	0.32	
1274.00	2.060	237.230	1273.57	27.20	-10.30	-27.01	0.89	
1364.00	1.980	232.410	1363.51	29.83	-12.12	-29.60	0.21	
1454.00	1.830	228.280	1453.46	32.17	-14.03	-31.91	0.23	
1544.00	1.570	234.900	1543.42	34.28	-15.69	-33.99	0.36	
1634.00	1.610	237.230	1633.39	36.38	-17.09	-36.06	0.08	
1724.00	1.550	236.570	1723.35	38.49	-18.44	-38.14	0.07	
1750.00	1.500	238.140	1749.34	39.08	-18.81	-38.72	0.25	
1862.00	1.850	221.960	1861.30	41.57	-20.93	-41.18	0.52	
1955.00	3.700	213.370	1954.18	44.29	-24.56	-43.83	2.03	
2049.00	5.180	209.120	2047.90	48.15	-30.80	-47.56	1.61	
2143.00	4.920	199.280	2141.54	51.69	-38.31	-50.96	0.96	
2236.00	6.500	194.510	2234.07	54.49	-47.17	-53.60	1.77	
2329.00	6.700	199.710	2326.46	57.83	-57.37	-56.75	0.68	
2422.00	6.620	205.710	2418.83	62.18	-67.31	-60.90	0.75	
2515.00	6.610	209.170	2511.21	67.30	-76.81	-65.84	0.43	



Actual Wellpath Report

HARVESTERS STATE 5N-16C-M AWP

Page 3 of 9



REFERENCE WELLPATH IDENTIFICATION

Operator	SRC ENERGY	Slot	SLOT#09 HARVESTERS STATE 5N-16C-M (1753'FNL & 2334'FEL, SEC.15)
Area	COLORADO	Well	HARVESTERS STATE 5N-16C-M
Field	WELD COUNTY (NAD83, TRUE NORTH)	Wellbore	HARVESTERS STATE 5N-16C-M AWP
Facility	SEC.15-T06N-R66W		

WELLPATH DATA (164 stations)

MD [ft]	Inclination [°]	Azimuth [°]	TVD [ft]	Vert Sect [ft]	North [ft]	East [ft]	DLS [°/100ft]	Comments
2609.00	6.840	216.060	2604.57	73.40	-86.06	-71.77	0.89	
2702.00	7.040	223.570	2696.89	80.76	-94.67	-78.96	1.00	
2796.00	6.560	237.040	2790.23	89.37	-101.77	-87.43	1.77	
2890.00	5.170	252.070	2883.74	97.98	-105.99	-95.97	2.19	
2983.00	5.270	250.290	2976.36	106.04	-108.72	-103.97	0.20	
3076.00	3.970	230.480	3069.06	112.61	-112.21	-110.48	2.19	
3170.00	5.770	220.600	3162.72	118.30	-117.87	-116.07	2.11	
3263.00	5.990	212.460	3255.23	124.10	-125.51	-121.71	0.93	
3355.00	6.000	205.200	3346.73	128.88	-133.91	-126.34	0.82	
3448.00	5.930	203.140	3439.22	133.00	-142.73	-130.29	0.24	
3540.00	3.640	202.140	3530.90	136.11	-149.81	-133.26	2.49	
3634.00	1.300	204.730	3624.80	137.75	-153.54	-134.83	2.49	
3727.00	0.190	18.660	3717.80	138.16	-154.35	-135.22	1.60	
3821.00	0.040	311.790	3811.80	138.13	-154.18	-135.20	0.19	
3914.00	0.070	120.890	3904.80	138.10	-154.19	-135.17	0.12	
4007.00	0.100	77.210	3997.79	137.98	-154.20	-135.05	0.07	
4101.00	0.130	270.320	4091.79	138.00	-154.18	-135.07	0.24	
4195.00	0.130	300.910	4185.79	138.20	-154.13	-135.27	0.07	
4290.00	0.030	341.700	4280.79	138.30	-154.05	-135.37	0.11	
4384.00	0.140	84.410	4374.79	138.19	-154.01	-135.27	0.16	
4477.00	0.040	165.110	4467.79	138.07	-154.03	-135.14	0.15	
4571.00	0.040	253.240	4561.79	138.09	-154.07	-135.17	0.06	
4664.00	0.110	283.320	4654.79	138.21	-154.06	-135.28	0.08	
4757.00	0.140	263.270	4747.79	138.41	-154.06	-135.48	0.06	
4851.00	0.130	200.940	4841.79	138.57	-154.17	-135.64	0.15	
4944.00	0.070	341.050	4934.79	138.62	-154.21	-135.69	0.20	
5036.00	0.120	236.210	5026.79	138.72	-154.21	-135.79	0.17	
5129.00	0.030	300.310	5119.79	138.82	-154.26	-135.89	0.12	
5223.00	0.090	286.200	5213.79	138.92	-154.22	-135.99	0.07	
5316.00	0.000	97.540	5306.79	138.99	-154.20	-136.06	0.10	



SRC ENERGY

Actual Wellpath Report

HARVESTERS STATE 5N-16C-M AWP

Page 4 of 9



REFERENCE WELLPATH IDENTIFICATION

Operator	SRC ENERGY	Slot	SLOT#09 HARVESTERS STATE 5N-16C-M (1753'FNL & 2334'FEL, SEC.15)
Area	COLORADO	Well	HARVESTERS STATE 5N-16C-M
Field	WELD COUNTY (NAD83, TRUE NORTH)	Wellbore	HARVESTERS STATE 5N-16C-M AWP
Facility	SEC.15-T06N-R66W		

WELLPATH DATA (164 stations)

MD [ft]	Inclination [°]	Azimuth [°]	TVD [ft]	Vert Sect [ft]	North [ft]	East [ft]	DLS [°/100ft]	Comments
5410.00	0.030	83.120	5400.79	138.96	-154.20	-136.03	0.03	
5502.00	0.070	194.440	5492.79	138.95	-154.25	-136.02	0.09	
5595.00	0.120	191.810	5585.79	138.99	-154.40	-136.05	0.05	
5688.00	0.130	187.890	5678.79	139.03	-154.60	-136.09	0.01	
5782.00	0.000	97.540	5772.79	139.04	-154.71	-136.10	0.14	
5875.00	0.090	212.710	5865.79	139.08	-154.77	-136.14	0.10	
5968.00	0.070	251.650	5958.79	139.18	-154.85	-136.24	0.06	
6155.00	0.040	321.890	6145.79	139.33	-154.83	-136.39	0.04	
6247.00	0.100	309.780	6237.79	139.41	-154.76	-136.47	0.07	
6340.00	0.160	298.660	6330.79	139.58	-154.64	-136.64	0.07	
6432.00	0.190	293.250	6422.79	139.83	-154.52	-136.90	0.04	
6525.00	0.150	305.910	6515.79	140.07	-154.39	-137.14	0.06	
6619.00	6.810	290.760	6609.57	145.35	-152.34	-142.45	7.09	
6712.00	12.140	298.570	6701.27	158.97	-145.70	-156.21	5.88	
6805.00	19.900	299.270	6790.59	181.16	-133.27	-178.64	8.35	
6898.00	28.690	290.310	6875.30	215.68	-117.74	-213.46	10.22	
6991.00	37.070	283.210	6953.36	263.72	-103.56	-261.79	9.90	
7085.00	47.030	274.850	7023.13	325.59	-94.15	-323.84	12.14	
7178.00	56.110	266.020	7080.94	398.22	-93.95	-396.49	12.26	
7271.00	67.040	264.080	7125.15	479.69	-101.07	-477.84	11.89	
7366.00	77.650	263.380	7153.92	569.71	-110.96	-567.69	11.19	
7460.00	86.300	262.960	7167.03	662.24	-122.02	-660.02	9.21	
7554.00	90.520	263.330	7169.63	755.71	-133.23	-753.29	4.51	
7646.00	90.590	264.430	7168.74	847.35	-143.04	-844.76	1.20	LANDING POINT (1899'FNL & 2164'FWL, SEC.15)
7741.00	91.540	268.130	7166.98	942.22	-149.20	-939.53	4.02	
7834.00	90.460	269.270	7165.35	1035.20	-151.31	-1032.49	1.69	
7928.00	90.180	269.810	7164.83	1129.19	-152.06	-1126.48	0.65	
8021.00	90.280	270.120	7164.46	1222.17	-152.12	-1219.48	0.35	
8115.00	90.280	270.610	7164.00	1316.14	-151.52	-1313.48	0.52	
8208.00	90.310	269.800	7163.52	1409.12	-151.19	-1406.48	0.87	



Actual Wellpath Report

HARVESTERS STATE 5N-16C-M AWP

Page 5 of 9



REFERENCE WELLPATH IDENTIFICATION			
Operator	SRC ENERGY	Slot	SLOT#09 HARVESTERS STATE 5N-16C-M (1753'FNL & 2334'FEL, SEC.15)
Area	COLORADO	Well	HARVESTERS STATE 5N-16C-M
Field	WELD COUNTY (NAD83, TRUE NORTH)	Wellbore	HARVESTERS STATE 5N-16C-M AWP
Facility	SEC.15-T06N-R66W		

WELLPATH DATA (164 stations)								
MD [ft]	Inclination [°]	Azimuth [°]	TVD [ft]	Vert Sect [ft]	North [ft]	East [ft]	DLS [°/100ft]	Comments
8302.00	90.220	268.870	7163.08	1503.11	-152.28	-1500.47	0.99	
8395.00	90.220	268.150	7162.73	1596.11	-154.70	-1593.43	0.77	
8487.00	90.490	267.930	7162.16	1688.09	-157.84	-1685.38	0.38	
8580.00	90.580	267.980	7161.29	1781.08	-161.16	-1778.32	0.11	
8675.00	90.370	268.060	7160.50	1876.06	-164.45	-1873.26	0.24	
8769.00	90.370	268.530	7159.89	1970.06	-167.24	-1967.21	0.50	
8863.00	90.490	268.590	7159.19	2064.05	-169.60	-2061.18	0.14	
8956.00	90.400	266.360	7158.47	2157.01	-173.70	-2154.08	2.40	
9050.00	90.460	269.150	7157.76	2250.98	-177.38	-2248.00	2.97	
9143.00	90.490	269.220	7156.99	2343.98	-178.71	-2340.98	0.08	
9238.00	90.490	266.680	7156.18	2438.95	-182.10	-2435.91	2.67	
9332.00	90.680	268.710	7155.22	2532.92	-185.88	-2529.83	2.17	
9425.00	90.650	272.540	7154.14	2625.86	-184.87	-2622.80	4.12	
9517.00	90.550	270.980	7153.17	2717.74	-182.04	-2714.75	1.70	
9612.00	90.770	272.910	7152.08	2812.59	-178.82	-2809.68	2.04	
9705.00	90.710	273.320	7150.88	2905.33	-173.77	-2902.53	0.45	
9799.00	90.680	270.080	7149.74	2999.20	-170.98	-2996.47	3.45	
9892.00	89.350	268.160	7149.71	3092.19	-172.41	-3089.46	2.51	
9986.00	89.110	269.110	7150.98	3186.18	-174.65	-3183.42	1.04	
10079.00	89.080	269.990	7152.44	3279.16	-175.38	-3276.40	0.95	
10172.00	89.080	271.420	7153.94	3372.10	-174.23	-3369.38	1.54	
10266.00	89.080	272.530	7155.45	3465.96	-170.99	-3463.31	1.18	
10359.00	89.200	272.820	7156.84	3558.74	-166.65	-3556.20	0.34	
10452.00	89.140	273.230	7158.19	3651.49	-161.75	-3649.06	0.45	
10547.00	89.260	274.230	7159.52	3746.14	-155.57	-3743.85	1.06	
10641.00	89.200	275.040	7160.78	3839.67	-147.97	-3837.53	0.86	
10734.00	89.110	274.030	7162.15	3932.20	-140.62	-3930.23	1.09	
10826.00	89.020	272.790	7163.65	4023.91	-135.15	-4022.05	1.35	
10920.00	89.080	272.060	7165.21	4117.71	-131.17	-4115.96	0.78	
11013.00	89.350	270.570	7166.49	4210.62	-129.04	-4208.92	1.63	



Actual Wellpath Report

HARVESTERS STATE 5N-16C-M AWP

Page 6 of 9



REFERENCE WELLPATH IDENTIFICATION

Operator	SRC ENERGY	Slot	SLOT#09 HARVESTERS STATE 5N-16C-M (1753'FNL & 2334'FEL, SEC.15)
Area	COLORADO	Well	HARVESTERS STATE 5N-16C-M
Field	WELD COUNTY (NAD83, TRUE NORTH)	Wellbore	HARVESTERS STATE 5N-16C-M AWP
Facility	SEC.15-T06N-R66W		

WELLPATH DATA (164 stations)

MD [ft]	Inclination [°]	Azimuth [°]	TVD [ft]	Vert Sect [ft]	North [ft]	East [ft]	DLS [°/100ft]	Comments
11106.00	89.350	268.420	7167.54	4303.60	-129.86	-4301.91	2.31	
11200.00	90.580	268.070	7167.60	4397.60	-132.74	-4395.86	1.36	
11293.00	90.580	268.790	7166.66	4490.59	-135.28	-4488.82	0.77	
11386.00	90.740	268.980	7165.59	4583.58	-137.09	-4581.80	0.27	
11479.00	90.400	268.350	7164.66	4676.58	-139.26	-4674.77	0.77	
11573.00	90.650	268.220	7163.80	4770.57	-142.07	-4768.72	0.30	
11666.00	90.800	271.990	7162.62	4863.52	-141.90	-4861.69	4.06	
11758.00	90.710	272.650	7161.41	4955.35	-138.18	-4953.61	0.72	
11851.00	90.460	272.320	7160.46	5048.16	-134.15	-5046.52	0.45	
11944.00	90.550	272.220	7159.64	5141.00	-130.46	-5139.44	0.14	
12038.00	90.460	271.200	7158.81	5234.88	-127.66	-5233.39	1.09	
12130.00	90.740	269.870	7157.85	5326.84	-126.80	-5325.38	1.48	
12225.00	90.710	268.280	7156.65	5421.82	-128.33	-5420.36	1.67	
12318.00	90.460	269.230	7155.70	5514.82	-130.35	-5513.33	1.06	
12411.00	90.860	270.090	7154.63	5607.80	-130.90	-5606.32	1.02	
12503.00	90.430	270.340	7153.59	5699.77	-130.56	-5698.32	0.54	
12597.00	90.490	268.180	7152.84	5793.76	-131.77	-5792.30	2.30	
12689.00	90.490	266.280	7152.05	5885.72	-136.22	-5884.19	2.07	
12783.00	90.580	265.630	7151.17	5979.59	-142.85	-5977.95	0.70	
12877.00	90.770	265.750	7150.06	6073.43	-149.91	-6071.67	0.24	
12969.00	90.710	265.670	7148.87	6165.28	-156.79	-6163.41	0.11	
13063.00	90.680	266.960	7147.73	6259.18	-162.84	-6257.21	1.37	
13156.00	90.520	269.320	7146.76	6352.16	-165.85	-6350.15	2.54	
13248.00	90.680	269.120	7145.80	6444.15	-167.11	-6442.13	0.28	
13342.00	90.460	268.390	7144.86	6538.15	-169.15	-6536.10	0.81	
13434.00	90.460	268.150	7144.12	6630.14	-171.93	-6628.06	0.26	
13527.00	90.430	267.110	7143.40	6723.11	-175.77	-6720.98	1.12	
13620.00	90.710	267.870	7142.48	6816.08	-179.84	-6813.88	0.87	
13713.00	90.460	267.770	7141.53	6909.05	-183.38	-6906.81	0.29	
13806.00	90.620	266.840	7140.65	7002.01	-187.75	-6999.70	1.01	



Actual Wellpath Report

HARVESTERS STATE 5N-16C-M AWP

Page 7 of 9



REFERENCE WELLPATH IDENTIFICATION			
Operator	SRC ENERGY	Slot	SLOT#09 HARVESTERS STATE 5N-16C-M (1753'FNL & 2334'FEL, SEC.15)
Area	COLORADO	Well	HARVESTERS STATE 5N-16C-M
Field	WELD COUNTY (NAD83, TRUE NORTH)	Wellbore	HARVESTERS STATE 5N-16C-M AWB
Facility	SEC.15-T06N-R66W		

WELLPATH DATA (164 stations)								
MD [ft]	Inclination [°]	Azimuth [°]	TVD [ft]	Vert Sect [ft]	North [ft]	East [ft]	DLS [°/100ft]	Comments
13899.00	90.550	266.460	7139.70	7094.94	-193.19	-7092.54	0.42	
13992.00	90.400	263.590	7138.93	7187.71	-201.25	-7185.17	3.09	
14084.00	90.650	261.280	7138.09	7279.12	-213.36	-7276.36	2.53	
14177.00	90.370	261.490	7137.26	7371.31	-227.29	-7368.31	0.38	
14269.00	90.620	264.510	7136.46	7462.81	-238.50	-7459.61	3.29	
14361.00	90.770	272.730	7135.35	7554.72	-240.72	-7551.50	8.94	
14455.00	90.830	272.090	7134.03	7648.54	-236.76	-7645.40	0.68	
14549.00	90.620	273.170	7132.84	7742.33	-232.45	-7739.30	1.17	
14643.00	90.620	271.740	7131.83	7836.14	-228.43	-7833.20	1.52	
14736.00	90.580	272.710	7130.85	7928.98	-224.82	-7926.13	1.04	
14829.00	90.710	272.290	7129.81	8021.79	-220.76	-8019.03	0.47	
14922.00	90.710	272.130	7128.65	8114.63	-217.17	-8111.95	0.17	
15015.00	90.520	273.040	7127.65	8207.43	-212.98	-8204.85	1.00	LAST BHI MWD SURVEY (1899'FNL & 106'FWL, SEC.16)
15045.00	90.520	273.040	7127.38	8237.35	-211.39	-8234.81	0.00	PROJECTION TO BIT (1897'FNL & 76'FWL, SEC.16)

HOLE & CASING SECTIONS									
- Ref Wellbore: HARVESTERS STATE 5N-16C-M AWB					Ref Wellpath: HARVESTERS STATE 5N-16C-M AWP				
String/Diameter	Start MD [ft]	End MD [ft]	Interval [ft]	Start TVD [ft]	End TVD [ft]	Start N/S [ft]	Start E/W [ft]	End N/S [ft]	End E/W [ft]
13.5in Open Hole	20.00	1802.00	1782.00	20.00	1801.32	0.00	0.00	-19.66	-39.87
9.625in Casing Surface	20.00	1802.00	1782.00	20.00	1801.32	0.00	0.00	-19.66	-39.87
8.5in Open Hole	1802.00	15045.00	13243.00	1801.32	7127.38	-19.66	-39.87	-211.39	-8234.81



Actual Wellpath Report

HARVESTERS STATE 5N-16C-M AWP

Page 8 of 9



REFERENCE WELLPATH IDENTIFICATION

Operator	SRC ENERGY	Slot	SLOT#09 HARVESTERS STATE 5N-16C-M (1753'FNL & 2334'FEL, SEC.15)
Area	COLORADO	Well	HARVESTERS STATE 5N-16C-M
Field	WELD COUNTY (NAD83, TRUE NORTH)	Wellbore	HARVESTERS STATE 5N-16C-M AWB
Facility	SEC.15-T06N-R66W		

TARGETS

Name	TVD [ft]	North [ft]	East [ft]	Grid East [US ft]	Grid North [US ft]	Latitude	Longitude	Shape
SEC.15-T06N-R66W	16.00	159.90	1.39	3205120.91	1422648.52	40°29'28.428"N	104°45'45.022"W	polygon
SEC.16-T06N-R66W	16.00	159.90	1.39	3205120.91	1422648.52	40°29'28.428"N	104°45'45.022"W	polygon
HARVESTERS STATE 5N-16C-M BHL ON PLAT (1842'FNL & 150'FWL, SEC.16)	7121.00	-156.44	-8160.59	3196962.14	1422264.33	40°29'25.289"N	104°47'30.660"W	point
HARVESTERS STATE 5N-16C-M BHL REV-2 (1842'FNL & 150'FWL, SEC.16)	7126.32	-156.44	-8160.59	3196962.14	1422264.33	40°29'25.289"N	104°47'30.660"W	point
HARVESTERS STATE 5N-16C-M TOP OF PROD ON PLAT (1857'FNL & 2221'FWL, SEC.15)	7148.00	-100.98	-787.93	3204333.81	1422381.10	40°29'25.850"N	104°45'55.238"W	point
HARVESTERS STATE 5N-16C-M HARDLINE BOX	7169.87	0.00	0.00	3205120.85	1422488.63	40°29'26.848"N	104°45'45.040"W	polygon
HARVESTERS STATE 5N-16C-M TOP OF PROD REV-2 (1910'FNL & 2221'FWL, SEC.15)	7169.87	-153.94	-787.96	3204334.22	1422328.14	40°29'25.327"N	104°45'55.238"W	point

WELLPATH COMPOSITION - Ref Wellbore: HARVESTERS STATE 5N-16C-M AWB Ref Wellpath: HARVESTERS STATE 5N-16C-M AWP

Start MD [ft]	End MD [ft]	Positional Uncertainty Model	Log Name/Comment	Wellbore
20.00	1750.00	BHI NaviTrak (Rotating+Axial Corr)	13 1/2" SURFACE SECTION <86'-1734'>	HARVESTERS STATE 5N-16C-M AWB
1750.00	15015.00	BHI AutoTrak Curve (MagCAD+IFR1, Short spacing)	8 1/2" MONOBORE SURVEYS <1862'-15015'>	HARVESTERS STATE 5N-16C-M AWB
15015.00	15045.00	Blind Drilling (std)	Projection to bit	HARVESTERS STATE 5N-16C-M AWB



SRC ENERGY

Actual Wellpath Report

HARVESTERS STATE 5N-16C-M AWP

Page 9 of 9



REFERENCE WELLPATH IDENTIFICATION

Operator	SRC ENERGY	Slot	SLOT#09 HARVESTERS STATE 5N-16C-M (1753'FNL & 2334'FEL, SEC.15)
Area	COLORADO	Well	HARVESTERS STATE 5N-16C-M
Field	WELD COUNTY (NAD83, TRUE NORTH)	Wellbore	HARVESTERS STATE 5N-16C-M AWB
Facility	SEC.15-T06N-R66W		

WELLPATH COMMENTS

MD [ft]	Inclination [°]	Azimuth [°]	TVD [ft]	Comment
7646.00	90.590	264.430	7168.74	LANDING POINT (1899'FNL & 2164'FWL, SEC.15)
15015.00	90.520	273.040	7127.65	LAST BHI MWD SURVEY (1899'FNL & 106'FWL, SEC.16)
15045.00	90.520	273.040	7127.38	PROJECTION TO BIT (1897'FNL & 76'FWL, SEC.16)