

SRC ENERGY

Location: COLORADO Slot: SLOT#07 HARVESTERS STATE 31N-16B-M (1713'FNL & 2334'FEL, SEC.15)
Field: WELD COUNTY (NAD83,TRUE NORTH) Well: HARVESTERS STATE 31N-16B-M
Facility: SEC.15-T06N-R66W Wellbore: HARVESTERS STATE 31N-16B-M PWB

Plot reference wellpath is HARVESTERS STATE 31N-16B-M (REV.B.0) PWB	Grid System: NAD83 / Lambert Colorado SP, Northern Zone (501), US feet
True vertical depths are referenced to PRECISION 462 (20') (RKB)	* = Wellpath was transformed from a different geodetic datum
Measured depths are referenced to PRECISION 462 (20') (RKB)	North Reference: True north
PRECISION 462 (20') (RKB) to Mean Sea Level: 4822 feet	Scale: True distance
Mean Sea Level to Mud line (At Slot: SLOT#07 HARVESTERS STATE 31N-16B-M (1713'FNL & 2334'FEL, SEC.15)): 0 feet	Depths are in feet
Coordinates are in feet referenced to Slot	Created by: doddanna on 2018-06-06
	Database: WellArchitectDB

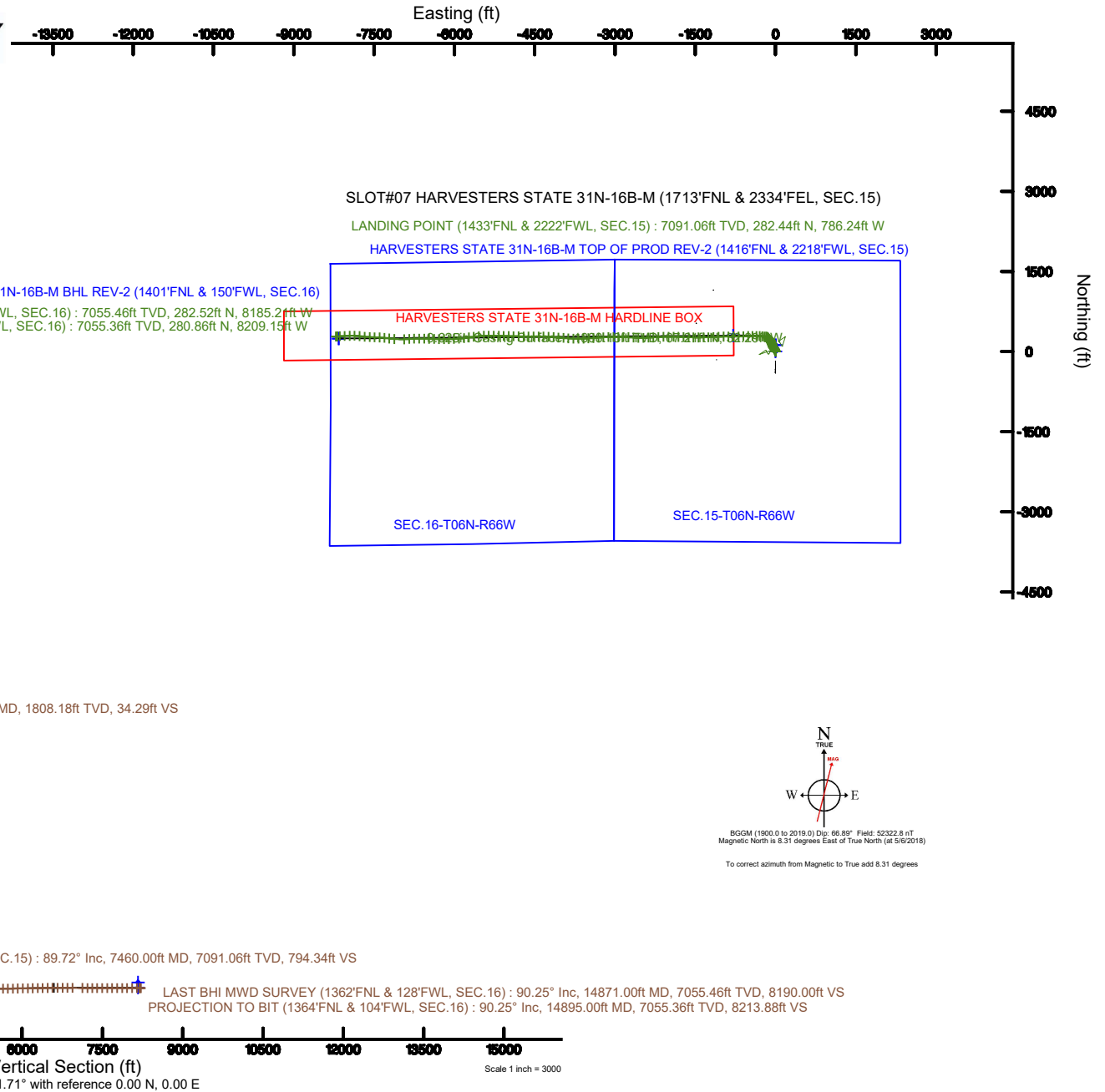



SRC ENERGY

Actual Wellpath Report

HARVESTERS STATE 31N-16B-M AWP

Page 1 of 9



REFERENCE WELLPATH IDENTIFICATION

Operator	SRC ENERGY	Slot	SLOT#07 HARVESTERS STATE 31N-16B-M (1713'FNL & 2334'FEL, SEC.15)
Area	COLORADO	Well	HARVESTERS STATE 31N-16B-M
Field	WELD COUNTY (NAD83, TRUE NORTH)	Wellbore	HARVESTERS STATE 31N-16B-M AWP
Facility	SEC.15-T06N-R66W		

REPORT SETUP INFORMATION

Projection System	NAD83 / Lambert Colorado SP, Northern Zone (501), US feet	Software System	WellArchitect® 5.0
North Reference	True	User	Doddanna
Scale	0.999966	Report Generated	6/6/2018 at 12:41:53 PM
Convergence at slot	0.48° East	Database/Source file	WellArchitectDB/HARVESTERS_STATE_31N-16B-M_AWP.xml

WELLPATH LOCATION

	Local coordinates		Grid coordinates		Geographic coordinates	
	North[ft]	East[ft]	Easting[US ft]	Northing[US ft]	Latitude	Longitude
Slot Location	-119.82	-0.77	3205121.13	1422528.71	40°29'27.244"N	104°45'45.032"W
Facility Reference Pt			3205120.91	1422648.52	40°29'28.428"N	104°45'45.022"W
Field Reference Pt			3171284.48	1426358.81	40°30'07.643"N	104°53'02.634"W

WELLPATH DATUM

Calculation method	Minimum curvature	PRECISION 462 (20') (RKB) to Facility Vertical Datum	4822.00ft
Horizontal Reference Pt	Slot	PRECISION 462 (20') (RKB) to Mean Sea Level	4822.00ft
Vertical Reference Pt	PRECISION 462 (20') (RKB)	PRECISION 462 (20') (RKB) to Mud Line at Slot (SLOT#07 HARVESTERS STATE 31N-16B-M (1713'FNL & 2334'FEL, SEC.15))	4822.00ft
MD Reference Pt	PRECISION 462 (20') (RKB)	Section Origin	N 0.00, E 0.00 ft
Field Vertical Reference	Mean Sea Level	Section Azimuth	271.71°



SRC ENERGY

Actual Wellpath Report

HARVESTERS STATE 31N-16B-M AWP

Page 2 of 9

**BAKER
HUGHES****REFERENCE WELLPATH IDENTIFICATION**

Operator	SRC ENERGY	Slot	SLOT#07 HARVESTERS STATE 31N-16B-M (1713'FNL & 2334'FEL, SEC.15)
Area	COLORADO	Well	HARVESTERS STATE 31N-16B-M
Field	WELD COUNTY (NAD83, TRUE NORTH)	Wellbore	HARVESTERS STATE 31N-16B-M AWB
Facility	SEC.15-T06N-R66W		

WELLPATH DATA (163 stations) † = interpolated/extrapolated station

MD [ft]	Inclination [°]	Azimuth [°]	TVD [ft]	Vert Sect [ft]	North [ft]	East [ft]	DLS [°/100ft]	Comments
0.00†	0.000	60.840	0.00	0.00	0.00	0.00	0.00	
20.00	0.000	60.840	20.00	0.00	0.00	0.00	0.00	
102.00	0.680	60.840	102.00	-0.42	0.24	0.42	0.83	
189.00	0.840	42.440	188.99	-1.28	0.96	1.31	0.33	
280.00	1.360	354.610	279.98	-1.58	2.53	1.65	1.11	
373.00	2.490	335.600	372.92	-0.55	5.47	0.72	1.38	
464.00	2.330	334.920	463.84	1.15	8.94	-0.88	0.18	
554.00	3.030	335.220	553.74	3.04	12.76	-2.66	0.78	
644.00	3.090	337.150	643.61	5.11	17.15	-4.60	0.13	
734.00	3.130	333.710	733.48	7.27	21.59	-6.63	0.21	
824.00	3.240	335.510	823.34	9.55	26.11	-8.77	0.17	
914.00	3.200	335.540	913.20	11.78	30.71	-10.86	0.04	
1004.00	2.810	333.690	1003.08	13.92	34.97	-12.88	0.45	
1094.00	2.550	327.190	1092.98	16.09	38.63	-14.94	0.44	
1184.00	2.330	330.040	1182.90	18.19	41.90	-16.94	0.28	
1274.00	2.400	326.040	1272.82	20.25	45.05	-18.91	0.20	
1364.00	2.740	326.720	1362.73	22.58	48.41	-21.14	0.38	
1454.00	3.130	337.710	1452.61	24.81	52.48	-23.25	0.76	
1544.00	2.990	338.200	1542.48	26.75	56.94	-25.06	0.16	
1634.00	2.850	324.570	1632.37	29.04	60.94	-27.23	0.79	
1724.00	2.590	320.980	1722.27	31.71	64.34	-29.80	0.35	
1772.00	2.540	319.710	1770.22	33.13	66.00	-31.17	0.16	
1861.00	2.330	308.420	1859.14	35.90	68.62	-33.87	0.59	
1955.00	3.670	317.380	1953.01	39.54	72.03	-37.40	1.51	
2048.00	3.870	325.530	2045.81	43.47	76.80	-41.19	0.61	
2143.00	3.960	328.530	2140.59	47.16	82.24	-44.72	0.24	
2235.00	3.970	328.780	2232.37	50.63	87.68	-48.03	0.02	
2328.00	4.130	335.680	2325.13	53.85	93.48	-51.08	0.55	
2422.00	3.330	339.350	2418.93	56.38	99.12	-53.43	0.89	
2514.00	3.170	341.760	2510.79	58.26	104.04	-55.17	0.23	



SRC ENERGY

Actual Wellpath Report

HARVESTERS STATE 31N-16B-M AWP

Page 3 of 9



REFERENCE WELLPATH IDENTIFICATION

Operator	SRC ENERGY	Slot	SLOT#07 HARVESTERS STATE 31N-16B-M (1713'FNL & 2334'FEL, SEC.15)
Area	COLORADO	Well	HARVESTERS STATE 31N-16B-M
Field	WELD COUNTY (NAD83, TRUE NORTH)	Wellbore	HARVESTERS STATE 31N-16B-M AWP
Facility	SEC.15-T06N-R66W		

WELLPATH DATA (163 stations)

MD [ft]	Inclination [°]	Azimuth [°]	TVD [ft]	Vert Sect [ft]	North [ft]	East [ft]	DLS [°/100ft]	Comments
2608.00	2.910	347.400	2604.65	59.74	108.83	-56.51	0.42	
2702.00	2.830	344.460	2698.54	61.02	113.40	-57.65	0.18	
2797.00	2.860	346.740	2793.42	62.32	117.96	-58.82	0.12	
2889.00	2.840	337.910	2885.31	63.84	122.31	-60.20	0.48	
2982.00	2.720	336.680	2978.20	65.70	126.47	-61.94	0.14	
3076.00	2.870	335.220	3072.08	67.69	130.66	-63.81	0.18	
3170.00	2.940	343.430	3165.96	69.50	135.10	-65.49	0.45	
3262.00	2.850	345.600	3257.85	70.87	139.58	-66.73	0.15	
3354.00	2.770	341.750	3349.74	72.27	143.91	-67.99	0.22	
3447.00	2.980	343.300	3442.62	73.80	148.36	-69.39	0.24	
3541.00	3.010	343.690	3536.49	75.33	153.07	-70.79	0.04	
3634.00	2.710	334.660	3629.38	77.09	157.40	-72.41	0.58	
3727.00	3.010	327.460	3722.26	79.46	161.44	-74.67	0.50	
3820.00	2.750	322.420	3815.14	82.25	165.27	-77.34	0.39	
3914.00	2.710	320.190	3909.04	85.15	168.76	-80.14	0.12	
4006.00	2.870	324.250	4000.93	88.00	172.30	-82.88	0.28	
4101.00	2.810	320.740	4095.81	90.97	176.04	-85.74	0.19	
4196.00	3.240	350.100	4190.68	93.04	180.48	-87.68	1.67	
4290.00	2.870	358.100	4284.55	93.72	185.45	-88.21	0.60	
4384.00	2.860	358.510	4378.43	94.00	190.15	-88.35	0.02	
4477.00	2.650	2.470	4471.32	94.10	194.62	-88.32	0.30	
4570.00	3.130	0.950	4564.21	94.11	199.30	-88.18	0.52	
4662.00	2.940	317.310	4656.09	95.79	203.55	-89.74	2.46	
4757.00	2.940	271.280	4750.98	99.93	205.39	-93.83	2.42	
4850.00	2.680	282.710	4843.87	104.45	205.93	-98.34	0.66	
4943.00	2.790	314.420	4936.76	108.25	207.99	-102.07	1.61	
5036.00	2.870	333.240	5029.65	111.02	211.65	-104.74	1.00	
5129.00	2.760	330.150	5122.54	113.31	215.67	-106.90	0.20	
5223.00	2.930	326.600	5216.43	115.87	219.64	-109.35	0.26	
5317.00	2.980	322.580	5310.30	118.80	223.59	-112.16	0.23	



SRC ENERGY

Actual Wellpath Report

HARVESTERS STATE 31N-16B-M AWP

Page 4 of 9



REFERENCE WELLPATH IDENTIFICATION

Operator	SRC ENERGY	Slot	SLOT#07 HARVESTERS STATE 31N-16B-M (1713'FNL & 2334'FEL, SEC.15)
Area	COLORADO	Well	HARVESTERS STATE 31N-16B-M
Field	WELD COUNTY (NAD83, TRUE NORTH)	Wellbore	HARVESTERS STATE 31N-16B-M AWP
Facility	SEC.15-T06N-R66W		

WELLPATH DATA (163 stations)

MD [ft]	Inclination [°]	Azimuth [°]	TVD [ft]	Vert Sect [ft]	North [ft]	East [ft]	DLS [°/100ft]	Comments
5409.00	2.870	312.350	5402.18	122.05	227.04	-115.31	0.58	
5501.00	2.930	313.060	5494.06	125.57	230.20	-118.73	0.08	
5595.00	2.700	320.310	5587.95	128.83	233.54	-121.90	0.45	
5688.00	2.780	307.700	5680.84	132.11	236.60	-125.09	0.65	
5781.00	2.540	304.930	5773.74	135.66	239.16	-128.56	0.29	
5874.00	2.880	321.590	5866.64	138.89	242.17	-131.70	0.92	
5967.00	3.530	331.240	5959.50	141.84	246.51	-134.53	0.91	
6061.00	3.570	327.930	6053.32	144.94	251.53	-137.48	0.22	
6154.00	3.440	321.220	6146.14	148.36	256.16	-140.76	0.46	
6246.00	3.540	322.250	6237.97	151.96	260.56	-144.23	0.13	
6339.00	3.600	328.360	6330.79	155.39	265.31	-147.52	0.41	
6432.00	3.510	325.380	6423.61	158.68	270.14	-150.67	0.22	
6525.00	8.870	307.160	6516.04	166.22	276.82	-158.00	6.07	
6619.00	15.330	272.980	6608.02	184.58	281.86	-176.23	9.99	
6711.00	22.080	269.500	6695.11	214.05	282.34	-205.70	7.43	
6805.00	28.140	276.400	6780.20	253.85	284.66	-245.44	7.15	
6898.00	36.920	274.360	6858.54	303.71	289.23	-295.19	9.51	
6991.00	47.390	270.220	6927.40	366.01	291.50	-357.45	11.64	
7084.00	56.350	269.240	6984.77	439.04	291.11	-430.52	9.67	
7178.00	67.140	268.410	7029.20	521.61	289.39	-513.18	11.50	
7271.00	72.480	267.680	7061.29	608.68	286.40	-600.38	5.79	
7366.00	80.750	268.560	7083.26	700.84	283.38	-692.67	8.75	
7460.00	89.720	270.270	7091.06	794.34	282.44	-786.24	9.71	LANDING POINT (1433'FNL & 2222'FWL, SEC.15)
7553.00	90.680	269.450	7090.74	887.29	282.21	-879.24	1.36	
7647.00	90.650	268.040	7089.64	981.16	280.15	-973.21	1.50	
7741.00	90.460	267.190	7088.73	1074.91	276.24	-1067.12	0.93	
7834.00	90.620	268.050	7087.86	1167.67	272.38	-1160.04	0.94	
7927.00	90.490	267.600	7086.96	1260.45	268.85	-1252.97	0.50	
8021.00	90.740	268.400	7085.95	1354.24	265.57	-1346.90	0.89	
8113.00	90.620	269.710	7084.86	1446.14	264.05	-1438.88	1.43	



SRC ENERGY

Actual Wellpath Report

HARVESTERS STATE 31N-16B-M AWP

Page 5 of 9



REFERENCE WELLPATH IDENTIFICATION

Operator	SRC ENERGY	Slot	SLOT#07 HARVESTERS STATE 31N-16B-M (1713'FNL & 2334'FEL, SEC.15)
Area	COLORADO	Well	HARVESTERS STATE 31N-16B-M
Field	WELD COUNTY (NAD83, TRUE NORTH)	Wellbore	HARVESTERS STATE 31N-16B-M AWB
Facility	SEC.15-T06N-R66W		

WELLPATH DATA (163 stations)

MD [ft]	Inclination [°]	Azimuth [°]	TVD [ft]	Vert Sect [ft]	North [ft]	East [ft]	DLS [°/100ft]	Comments
8207.00	90.890	271.650	7083.62	1540.11	265.17	-1532.86	2.08	
8300.00	90.520	271.850	7082.47	1633.10	268.01	-1625.81	0.45	
8394.00	90.770	272.450	7081.41	1727.09	271.53	-1719.74	0.69	
8487.00	91.390	272.000	7079.66	1820.07	275.14	-1812.65	0.82	
8581.00	91.390	271.220	7077.38	1914.04	277.78	-1906.59	0.83	
8675.00	91.080	269.550	7075.36	2007.99	278.42	-2000.56	1.81	
8768.00	90.680	267.410	7073.93	2100.83	275.95	-2093.51	2.34	
8862.00	90.920	266.730	7072.61	2194.51	271.14	-2187.38	0.77	
8957.00	89.660	266.200	7072.13	2289.11	265.29	-2282.19	1.44	
9049.00	89.780	267.910	7072.58	2380.80	260.56	-2374.07	1.86	
9144.00	89.820	268.700	7072.91	2475.63	257.75	-2469.02	0.83	
9238.00	89.910	271.370	7073.14	2569.58	257.81	-2563.01	2.84	
9331.00	90.060	274.810	7073.16	2662.54	262.82	-2655.87	3.70	
9424.00	89.750	273.240	7073.31	2755.46	269.35	-2748.63	1.72	
9518.00	89.630	271.200	7073.82	2849.45	272.99	-2842.56	2.17	
9612.00	89.820	269.640	7074.27	2943.42	273.68	-2936.55	1.67	
9704.00	90.030	269.530	7074.39	3035.36	273.01	-3028.55	0.26	
9798.00	89.750	268.160	7074.58	3129.24	271.12	-3122.53	1.49	
9891.00	89.510	266.140	7075.18	3221.94	266.49	-3215.40	2.19	
9984.00	89.660	266.520	7075.85	3314.52	260.54	-3308.21	0.44	
10078.00	89.880	266.640	7076.23	3408.15	254.93	-3402.04	0.27	
10172.00	89.600	266.550	7076.65	3501.77	249.35	-3495.88	0.31	
10265.00	89.750	267.370	7077.18	3594.45	244.42	-3588.74	0.90	
10358.00	89.420	268.730	7077.85	3687.25	241.25	-3681.68	1.50	
10453.00	89.540	272.510	7078.72	3782.21	242.28	-3776.66	3.98	
10546.00	89.570	274.870	7079.44	3875.15	248.27	-3869.45	2.54	
10640.00	89.480	274.580	7080.22	3969.02	256.01	-3963.13	0.32	
10732.00	89.510	274.960	7081.03	4060.88	263.66	-4054.81	0.41	
10825.00	89.660	274.770	7081.70	4153.74	271.55	-4147.47	0.26	
10920.00	89.600	273.680	7082.32	4248.64	278.54	-4242.21	1.15	



SRC ENERGY

Actual Wellpath Report

HARVESTERS STATE 31N-16B-M AWP

Page 6 of 9



REFERENCE WELLPATH IDENTIFICATION

Operator	SRC ENERGY	Slot	SLOT#07 HARVESTERS STATE 31N-16B-M (1713'FNL & 2334'FEL, SEC.15)
Area	COLORADO	Well	HARVESTERS STATE 31N-16B-M
Field	WELD COUNTY (NAD83, TRUE NORTH)	Wellbore	HARVESTERS STATE 31N-16B-M AWP
Facility	SEC.15-T06N-R66W		

WELLPATH DATA (163 stations)

MD [ft]	Inclination [°]	Azimuth [°]	TVD [ft]	Vert Sect [ft]	North [ft]	East [ft]	DLS [°/100ft]	Comments
11012.00	89.540	271.240	7083.01	4340.63	282.49	-4334.12	2.65	
11106.00	89.480	269.530	7083.81	4434.60	283.12	-4428.11	1.82	
11199.00	89.690	269.400	7084.48	4527.52	282.26	-4521.10	0.27	
11293.00	91.050	270.380	7083.88	4621.47	282.08	-4615.09	1.78	
11385.00	90.740	270.750	7082.44	4713.44	282.98	-4707.08	0.52	
11479.00	90.980	271.500	7081.03	4807.42	284.83	-4801.05	0.84	
11572.00	90.650	271.400	7079.71	4900.41	287.18	-4894.01	0.37	
11665.00	91.200	271.370	7078.21	4993.40	289.43	-4986.97	0.59	
11757.00	90.950	271.920	7076.48	5085.38	292.07	-5078.92	0.66	
11850.00	90.830	271.300	7075.04	5178.37	294.68	-5171.87	0.68	
11943.00	90.950	271.120	7073.59	5271.35	296.65	-5264.84	0.23	
12037.00	90.980	269.540	7072.01	5365.31	297.19	-5358.82	1.68	
12130.00	91.020	267.700	7070.38	5458.16	294.95	-5451.77	1.98	
12223.00	90.860	263.800	7068.86	5550.62	288.06	-5544.49	4.20	
12317.00	91.020	262.320	7067.32	5643.54	276.70	-5637.78	1.58	
12409.00	90.770	262.000	7065.88	5734.25	264.15	-5728.91	0.44	
12502.00	90.830	264.080	7064.58	5826.17	252.89	-5821.21	2.24	
12596.00	90.770	265.190	7063.27	5919.44	244.10	-5914.79	1.18	
12689.00	91.050	267.300	7061.79	6012.00	238.01	-6007.57	2.29	
12783.00	90.770	267.380	7060.30	6105.72	233.65	-6101.46	0.31	
12876.00	90.990	270.510	7058.87	6198.59	231.93	-6194.42	3.37	
12969.00	91.110	271.910	7057.16	6291.57	233.90	-6287.38	1.51	
13062.00	91.050	271.760	7055.41	6384.55	236.88	-6380.32	0.17	
13155.00	91.080	272.460	7053.68	6477.53	240.30	-6473.24	0.75	
13247.00	90.950	270.740	7052.05	6569.51	242.87	-6565.18	1.87	
13341.00	90.000	269.680	7051.27	6663.47	243.21	-6659.18	1.51	
13434.00	90.090	267.540	7051.20	6756.33	240.96	-6752.15	2.30	
13526.00	90.120	265.540	7051.03	6847.95	235.40	-6843.97	2.17	
13619.00	89.010	267.540	7051.74	6940.56	229.79	-6936.79	2.46	
13805.00	89.380	275.690	7054.36	7126.39	235.03	-7122.55	4.39	



SRC ENERGY

Actual Wellpath Report

HARVESTERS STATE 31N-16B-M AWP

Page 7 of 9



REFERENCE WELLPATH IDENTIFICATION

Operator	SRC ENERGY	Slot	SLOT#07 HARVESTERS STATE 31N-16B-M (1713'FNL & 2334'FEL, SEC.15)
Area	COLORADO	Well	HARVESTERS STATE 31N-16B-M
Field	WELD COUNTY (NAD83,TRUE NORTH)	Wellbore	HARVESTERS STATE 31N-16B-M AWB
Facility	SEC.15-T06N-R66W		

WELLPATH DATA (163 stations)

MD [ft]	Inclination [°]	Azimuth [°]	TVD [ft]	Vert Sect [ft]	North [ft]	East [ft]	DLS [°/100ft]	Comments
13898.00	89.020	276.880	7055.65	7219.08	245.21	-7214.98	1.34	
13991.00	89.230	276.520	7057.07	7311.72	256.06	-7307.33	0.45	
14083.00	90.060	273.810	7057.64	7403.54	264.34	-7398.94	3.08	
14176.00	90.000	270.910	7057.60	7496.53	268.17	-7491.86	3.12	
14268.00	90.220	272.610	7057.42	7588.52	270.99	-7583.81	1.86	
14360.00	90.400	276.420	7056.92	7680.39	278.23	-7675.51	4.15	
14456.00	90.150	276.800	7056.46	7776.04	289.29	-7770.87	0.47	
14550.00	90.280	271.340	7056.11	7869.93	295.95	-7864.59	5.81	
14643.00	90.030	267.720	7055.86	7962.84	295.19	-7957.57	3.90	
14735.00	90.150	267.000	7055.71	8054.58	290.95	-8049.48	0.79	
14828.00	90.030	266.200	7055.57	8147.21	285.44	-8142.31	0.87	
14871.00	90.250	266.020	7055.46	8190.00	282.52	-8185.21	0.66	LAST BHI MWD SURVEY (1362'FNL & 128'FWL, SEC.16)
14895.00	90.250	266.020	7055.36	8213.88	280.86	-8209.15	0.00	PROJECTION TO BIT (1364'FNL & 104'FWL, SEC.16)

HOLE & CASING SECTIONS

- Ref Wellbore: HARVESTERS STATE 31N-16B-M AWB Ref Wellpath: HARVESTERS STATE 31N-16B-M AWP

String/Diameter	Start MD [ft]	End MD [ft]	Interval [ft]	Start TVD [ft]	End TVD [ft]	Start N/S [ft]	Start E/W [ft]	End N/S [ft]	End E/W [ft]
13.5in Open Hole	20.00	1810.00	1790.00	20.00	1808.18	0.00	0.00	67.21	-32.29
9.625in Casing Surface	20.00	1810.00	1790.00	20.00	1808.18	0.00	0.00	67.21	-32.29
8.5in Open Hole	1810.00	14895.00	13085.00	1808.18	7055.36	67.21	-32.29	280.86	-8209.15



SRC ENERGY

Actual Wellpath Report

HARVESTERS STATE 31N-16B-M AWP

Page 8 of 9



REFERENCE WELLPATH IDENTIFICATION

Operator	SRC ENERGY	Slot	SLOT#07 HARVESTERS STATE 31N-16B-M (1713'FNL & 2334'FEL, SEC.15)
Area	COLORADO	Well	HARVESTERS STATE 31N-16B-M
Field	WELD COUNTY (NAD83, TRUE NORTH)	Wellbore	HARVESTERS STATE 31N-16B-M AWB
Facility	SEC.15-T06N-R66W		

TARGETS

Name	TVD [ft]	North [ft]	East [ft]	Grid East [US ft]	Grid North [US ft]	Latitude	Longitude	Shape
SEC.15-T06N-R66W	16.00	119.82	0.77	3205120.91	1422648.52	40°29'28.428"N	104°45'45.022"W	polygon
SEC.16-T06N-R66W	16.00	119.82	0.77	3205120.91	1422648.52	40°29'28.428"N	104°45'45.022"W	polygon
HARVESTERS STATE 31N-16B-M BHL ON PLAT (1401'FNL & 150'FWL, SEC.16)	6949.00	244.31	-8162.45	3196957.23	1422705.12	40°29'29.645"N	104°47'30.678"W	point
HARVESTERS STATE 31N-16B-M BHL REV-2 (1401'FNL & 150'FWL, SEC.16)	7045.95	244.31	-8162.45	3196957.23	1422705.12	40°29'29.645"N	104°47'30.678"W	point
HARVESTERS STATE 31N-16B-M TOP OF PROD ON PLAT (1416'FNL & 2218'FWL, SEC.15)	7078.00	299.81	-790.24	3204328.46	1422821.92	40°29'30.206"N	104°45'55.260"W	point
HARVESTERS STATE 31N-16B-M HARDLINE BOX	7092.29	0.00	0.00	3205121.13	1422528.71	40°29'27.244"N	104°45'45.032"W	polygon
HARVESTERS STATE 31N-16B-M TOP OF PROD REV-2 (1416'FNL & 2218'FWL, SEC.15)	7092.29	299.81	-790.24	3204328.46	1422821.92	40°29'30.206"N	104°45'55.260"W	point

WELLPATH COMPOSITION - Ref Wellbore: HARVESTERS STATE 31N-16B-M AWB Ref Wellpath: HARVESTERS STATE 31N-16B-M AWP

Start MD [ft]	End MD [ft]	Positional Uncertainty Model	Log Name/Comment	Wellbore
20.00	1772.00	BHI NaviTrak (Rotating+Axial Corr)	13 1/2" SURFACE SURVEYS <86-1756>	HARVESTERS STATE 31N-16B-M AWB
1772.00	14871.00	BHI AutoTrak Curve (MagCAD+IFR1, Short spacing)	8 1/2" MONOBORE SURVEYS <1861'-14871'>	HARVESTERS STATE 31N-16B-M AWB
14871.00	14895.00	Blind Drilling (std)	Projection to bit	HARVESTERS STATE 31N-16B-M AWB



SRC ENERGY

Actual Wellpath Report

HARVESTERS STATE 31N-16B-M AWP

Page 9 of 9



REFERENCE WELLPATH IDENTIFICATION

Operator	SRC ENERGY	Slot	SLOT#07 HARVESTERS STATE 31N-16B-M (1713'FNL & 2334'FEL, SEC.15)
Area	COLORADO	Well	HARVESTERS STATE 31N-16B-M
Field	WELD COUNTY (NAD83,TRUE NORTH)	Wellbore	HARVESTERS STATE 31N-16B-M AWB
Facility	SEC.15-T06N-R66W		

WELLPATH COMMENTS

MD [ft]	Inclination [°]	Azimuth [°]	TVD [ft]	Comment
7460.00	89.720	270.270	7091.06	LANDING POINT (1433'FNL & 2222'FWL, SEC.15)
14871.00	90.250	266.020	7055.46	LAST BHI MWD SURVEY (1362'FNL & 128'FWL, SEC.16)
14895.00	90.250	266.020	7055.36	PROJECTION TO BIT (1364'FNL & 104'FWL, SEC.16)