

Plot reference wellpath is HARVESTERS STATE 31C-16-M (REV-B.0) PWP	Grid System: NAD83 / Lambert Colorado SP. Northern Zone [501], US feet
True vertical depths are referenced to PRECISION 462 (20') (RKB)	* = Wellpath was transformed from a different geoidic datum
Measured depths are referenced to PRECISION 462 (20') (RKB)	North Reference: True north
PRECISION 462 (20') (RKB) to Mean Sea Level: 4822 feet	Scale: True distance
Mean Sea Level to Mud line (At Slot: SLOTR006 HARVESTERS STATE 31C-16-M (1693'FN. & 2333'FEL, SEC. 15): 0 feet	Depths are in feet
Coordinates are in feet referenced to SLOt	Created by: doddanna on 2016-06-06
	Database: WellArchitectDB

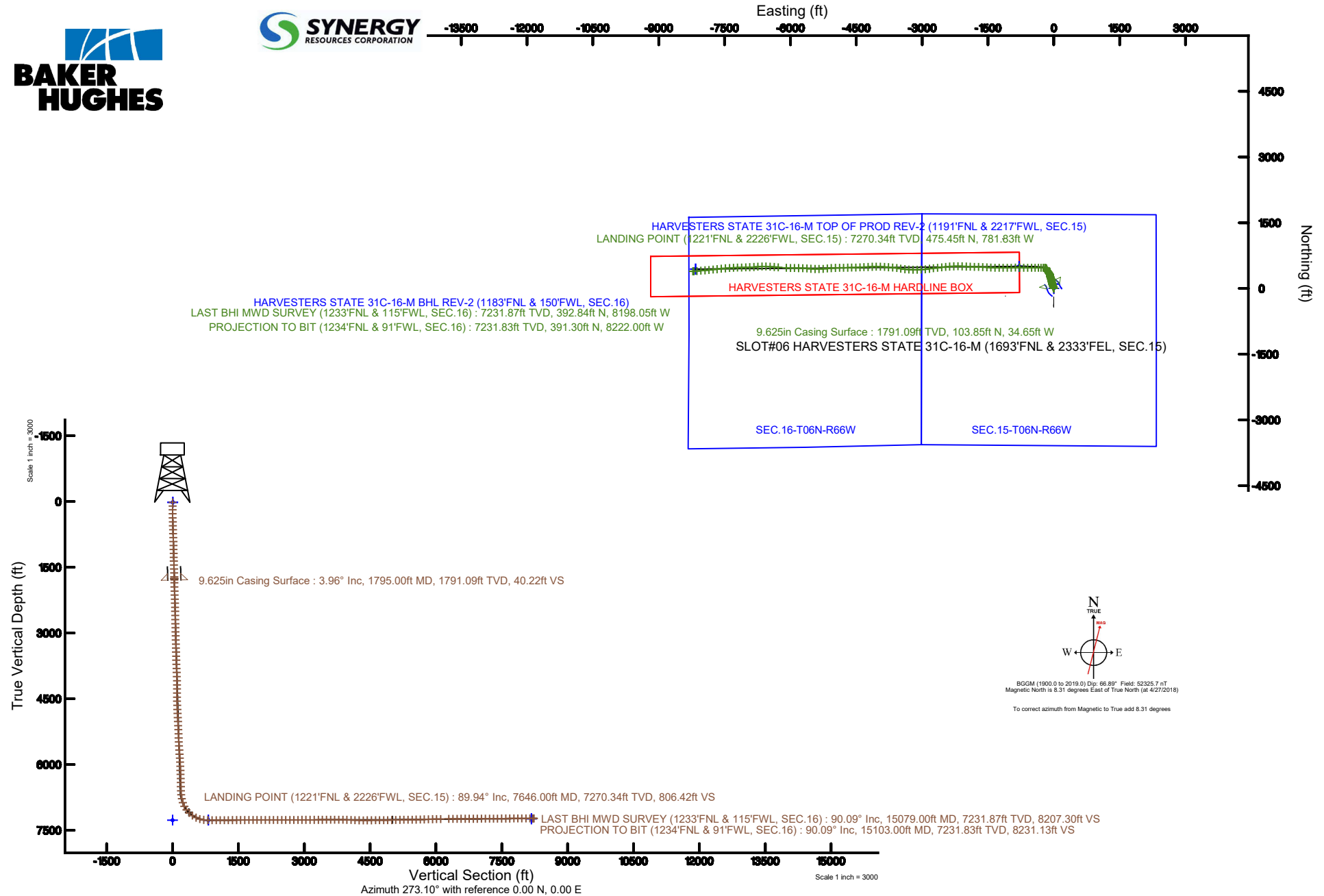



Actual Wellpath Report

HARVESTERS STATE 31C-16-M AWP

Page 1 of 9



REFERENCE WELLPATH IDENTIFICATION

Operator	SRC ENERGY	Slot	SLOT#06 HARVESTERS STATE 31C-16-M (1693'FNL & 2333'FEL, SEC.15)
Area	COLORADO	Well	HARVESTERS STATE 31C-16-M
Field	WELD COUNTY (NAD83,TRUE NORTH)	Wellbore	HARVESTERS STATE 31C-16-M AWP
Facility	SEC.15-T06N-R66W		

REPORT SETUP INFORMATION

Projection System	NAD83 / Lambert Colorado SP, Northern Zone (501), US feet	Software System	WellArchitect® 5.0
North Reference	True	User	Doddanna
Scale	0.999966	Report Generated	6/6/2018 at 12:30:22 PM
Convergence at slot	0.48° East	Database/Source file	WellArchitectDB/HARVESTERS_STATE_31C-16-M_AWP.xml

WELLPATH LOCATION

	Local coordinates		Grid coordinates		Geographic coordinates	
	North[ft]	East[ft]	Easting[US ft]	Northing[US ft]	Latitude	Longitude
Slot Location	-99.78	-0.77	3205120.97	1422548.74	40°29'27.442"N	104°45'45.032"W
Facility Reference Pt			3205120.91	1422648.52	40°29'28.428"N	104°45'45.022"W
Field Reference Pt			3171284.48	1426358.81	40°30'07.643"N	104°53'02.634"W

WELLPATH DATUM

Calculation method	Minimum curvature	PRECISION 462 (20') (RKB) to Facility Vertical Datum	4822.00ft
Horizontal Reference Pt	Slot	PRECISION 462 (20') (RKB) to Mean Sea Level	4822.00ft
Vertical Reference Pt	PRECISION 462 (20') (RKB)	PRECISION 462 (20') (RKB) to Mud Line at Slot (SLOT#06 HARVESTERS STATE 31C-16-M (1693'FNL & 2333'FEL, SEC.15))	4822.00ft
MD Reference Pt	PRECISION 462 (20') (RKB)	Section Origin	N 0.00, E 0.00 ft
Field Vertical Reference	Mean Sea Level	Section Azimuth	273.10°



Actual Wellpath Report

HARVESTERS STATE 31C-16-M AWP

Page 2 of 9



REFERENCE WELLPATH IDENTIFICATION			
Operator	SRC ENERGY	Slot	SLOT#06 HARVESTERS STATE 31C-16-M (1693'FNL & 2333'FEL, SEC.15)
Area	COLORADO	Well	HARVESTERS STATE 31C-16-M
Field	WELD COUNTY (NAD83,TRUE NORTH)	Wellbore	HARVESTERS STATE 31C-16-M AWB
Facility	SEC.15-T06N-R66W		

WELLPATH DATA (165 stations) † = interpolated/extrapolated station								
MD [ft]	Inclination [°]	Azimuth [°]	TVD [ft]	Vert Sect [ft]	North [ft]	East [ft]	DLS [°/100ft]	Comments
0.00†	0.000	300.540	0.00	0.00	0.00	0.00	0.00	
20.00	0.000	300.540	20.00	0.00	0.00	0.00	0.00	
102.00	0.580	300.540	102.00	0.37	0.21	-0.36	0.71	
189.00	0.810	310.610	188.99	1.25	0.83	-1.20	0.30	
280.00	0.860	321.540	279.98	2.21	1.79	-2.12	0.18	
373.00	3.000	345.010	372.93	3.43	4.69	-3.18	2.41	
464.00	4.240	342.780	463.74	5.34	10.20	-4.79	1.37	
554.00	4.390	341.060	553.49	7.79	16.64	-6.90	0.22	
644.00	4.650	341.180	643.21	10.44	23.35	-9.19	0.29	
734.00	4.510	340.070	732.92	13.19	30.13	-11.57	0.18	
824.00	4.390	339.240	822.65	15.96	36.67	-14.00	0.15	
914.00	4.330	341.390	912.39	18.62	43.11	-16.31	0.19	
1004.00	4.110	341.730	1002.14	21.05	49.40	-18.40	0.25	
1094.00	4.020	343.500	1091.92	23.28	55.48	-20.31	0.17	
1184.00	3.760	342.470	1181.71	25.38	61.32	-22.09	0.30	
1274.00	4.230	341.470	1271.49	27.64	67.28	-24.04	0.53	
1364.00	4.090	344.150	1361.25	29.91	73.52	-25.97	0.27	
1454.00	3.780	341.760	1451.04	32.03	79.42	-27.77	0.39	
1544.00	4.680	346.250	1540.80	34.18	85.81	-29.57	1.06	
1634.00	4.220	344.990	1630.52	36.27	92.57	-31.30	0.52	
1724.00	4.290	341.670	1720.28	38.53	98.97	-33.22	0.28	
1757.00	4.100	344.050	1753.19	39.37	101.27	-33.93	0.78	
1860.00	3.730	346.880	1855.95	41.50	108.08	-35.71	0.41	
1953.00	4.520	346.460	1948.71	43.40	114.59	-37.25	0.85	
2047.00	4.360	342.740	2042.42	45.70	121.60	-39.18	0.35	
2141.00	4.770	342.000	2136.13	48.35	128.73	-41.45	0.44	
2234.00	4.620	339.950	2228.81	51.22	135.92	-43.92	0.24	
2327.00	4.630	342.200	2321.51	54.03	143.02	-46.36	0.20	
2421.00	5.250	344.280	2415.16	56.77	150.77	-48.68	0.69	
2513.00	4.750	347.270	2506.81	59.17	158.54	-50.66	0.61	



Actual Wellpath Report

HARVESTERS STATE 31C-16-M AWP

Page 3 of 9



REFERENCE WELLPATH IDENTIFICATION

Operator	SRC ENERGY	Slot	SLOT#06 HARVESTERS STATE 31C-16-M (1693'FNL & 2333'FEL, SEC.15)
Area	COLORADO	Well	HARVESTERS STATE 31C-16-M
Field	WELD COUNTY (NAD83,TRUE NORTH)	Wellbore	HARVESTERS STATE 31C-16-M AWP
Facility	SEC.15-T06N-R66W		

WELLPATH DATA (165 stations)

MD [ft]	Inclination [°]	Azimuth [°]	TVD [ft]	Vert Sect [ft]	North [ft]	East [ft]	DLS [°/100ft]	Comments
2607.00	4.330	349.800	2600.52	61.05	165.82	-52.15	0.49	
2701.00	4.570	350.300	2694.23	62.69	173.01	-53.41	0.26	
2795.00	4.170	349.810	2787.96	64.31	180.06	-54.64	0.43	
2888.00	4.220	347.430	2880.71	66.01	186.73	-55.98	0.19	
2981.00	4.320	345.520	2973.45	67.99	193.46	-57.60	0.19	
3075.00	4.810	344.550	3067.15	70.32	200.69	-59.54	0.53	
3168.00	4.500	345.440	3159.85	72.66	207.98	-61.50	0.34	
3261.00	4.740	345.850	3252.54	74.91	215.23	-63.35	0.26	
3353.00	4.810	347.310	3344.23	77.09	222.68	-65.13	0.15	
3446.00	4.860	345.310	3436.89	79.35	230.30	-66.98	0.19	
3539.00	4.560	341.130	3529.58	81.94	237.61	-69.18	0.49	
3632.00	4.560	339.250	3622.29	84.82	244.56	-71.68	0.16	
3726.00	4.800	336.500	3715.97	88.09	251.66	-74.58	0.35	
3819.00	4.260	338.560	3808.68	91.27	258.45	-77.39	0.61	
3913.00	4.520	335.500	3902.41	94.43	265.07	-80.20	0.37	
4005.00	4.360	338.050	3994.13	97.59	271.61	-83.01	0.28	
4099.00	4.420	338.280	4087.85	100.63	278.29	-85.69	0.07	
4195.00	3.760	356.500	4183.61	102.54	284.87	-87.25	1.51	
4288.00	3.860	10.670	4276.41	102.48	290.99	-86.86	1.02	
4383.00	4.620	2.880	4371.15	102.07	297.95	-86.07	1.00	
4476.00	4.240	359.610	4463.87	102.30	305.13	-85.91	0.49	
4569.00	4.270	355.690	4556.62	102.95	312.02	-86.19	0.31	
4661.00	4.390	335.570	4648.36	105.02	318.64	-87.91	1.65	
4756.00	4.230	323.290	4743.09	108.95	324.76	-91.50	0.98	
4849.00	4.010	319.070	4835.85	113.40	329.97	-95.68	0.40	
4942.00	4.280	308.230	4928.61	118.50	334.57	-100.54	0.89	
5035.00	4.150	317.830	5021.36	123.73	339.21	-105.53	0.77	
5128.00	4.620	330.530	5114.09	128.14	344.97	-109.63	1.16	
5222.00	4.520	334.740	5207.79	131.94	351.61	-113.07	0.37	
5316.00	4.430	335.710	5301.50	135.37	358.27	-116.15	0.13	



SRC ENERGY

Actual Wellpath Report

HARVESTERS STATE 31C-16-M AWP

Page 4 of 9

**BAKER
HUGHES****REFERENCE WELLPATH IDENTIFICATION**

Operator	SRC ENERGY	Slot	SLOT#06 HARVESTERS STATE 31C-16-M (1693'FNL & 2333'FEL, SEC.15)
Area	COLORADO	Well	HARVESTERS STATE 31C-16-M
Field	WELD COUNTY (NAD83, TRUE NORTH)	Wellbore	HARVESTERS STATE 31C-16-M AWB
Facility	SEC.15-T06N-R66W		

WELLPATH DATA (165 stations)

MD [ft]	Inclination [°]	Azimuth [°]	TVD [ft]	Vert Sect [ft]	North [ft]	East [ft]	DLS [°/100ft]	Comments
5408.00	4.300	331.090	5393.24	138.83	364.53	-119.27	0.41	
5500.00	4.620	324.660	5484.96	142.96	370.57	-123.08	0.64	
5593.00	4.810	320.030	5577.65	147.95	376.62	-127.76	0.46	
5687.00	5.170	317.690	5671.29	153.66	382.77	-133.14	0.44	
5780.00	5.060	320.640	5763.92	159.41	389.04	-138.56	0.31	
5873.00	5.020	318.780	5856.56	165.03	395.27	-143.84	0.18	
5965.00	4.670	322.730	5948.23	170.27	401.28	-148.76	0.53	
6060.00	5.170	329.770	6042.88	175.12	408.05	-153.26	0.82	
6152.00	5.120	336.260	6134.51	179.25	415.39	-157.00	0.63	
6245.00	5.050	335.070	6227.15	183.05	422.90	-160.40	0.14	
6337.00	4.750	346.200	6318.81	186.06	430.27	-163.01	1.08	
6430.00	4.720	348.330	6411.49	188.16	437.76	-164.70	0.19	
6523.00	4.540	354.500	6504.19	189.68	445.17	-165.83	0.57	
6618.00	4.640	2.810	6598.89	190.27	452.75	-166.00	0.71	
6710.00	9.100	320.400	6690.25	195.22	462.08	-170.46	7.04	
6804.00	12.900	289.600	6782.59	210.34	471.34	-185.10	7.31	
6897.00	17.270	264.490	6872.45	233.98	473.50	-208.66	8.35	
6990.00	26.740	270.280	6958.59	268.61	472.28	-243.40	10.43	
7083.00	36.560	271.030	7037.66	317.31	472.88	-292.14	10.57	
7176.00	46.330	270.580	7107.29	378.74	473.72	-353.62	10.51	
7270.00	55.310	269.840	7166.62	451.44	473.96	-426.41	9.57	
7365.00	65.740	269.210	7213.30	533.86	473.25	-508.99	10.99	
7458.00	73.690	269.680	7245.51	620.85	472.41	-596.15	8.56	
7551.00	82.870	271.430	7264.38	711.72	473.32	-687.11	10.04	
7646.00	89.940	271.150	7270.34	806.42	475.45	-781.83	7.45	LANDING POINT (1221'FNL & 2226'FWL, SEC.15)
7739.00	90.030	269.070	7270.36	899.29	475.63	-874.83	2.24	
7833.00	90.150	268.250	7270.21	993.01	473.43	-968.80	0.88	
7926.00	90.000	269.090	7270.09	1085.73	471.27	-1061.78	0.92	
8020.00	89.910	270.300	7270.17	1179.56	470.77	-1155.77	1.29	
8112.00	90.370	270.580	7269.94	1271.46	471.48	-1247.77	0.59	



Actual Wellpath Report

HARVESTERS STATE 31C-16-M AWP

Page 5 of 9



REFERENCE WELLPATH IDENTIFICATION			
Operator	SRC ENERGY	Slot	SLOT#06 HARVESTERS STATE 31C-16-M (1693'FNL & 2333'FEL, SEC.15)
Area	COLORADO	Well	HARVESTERS STATE 31C-16-M
Field	WELD COUNTY (NAD83,TRUE NORTH)	Wellbore	HARVESTERS STATE 31C-16-M AWB
Facility	SEC.15-T06N-R66W		

WELLPATH DATA (165 stations)								
MD [ft]	Inclination [°]	Azimuth [°]	TVD [ft]	Vert Sect [ft]	North [ft]	East [ft]	DLS [°/100ft]	Comments
8206.00	90.250	271.510	7269.43	1365.40	473.19	-1341.75	1.00	
8299.00	90.280	273.000	7269.00	1458.38	476.85	-1434.68	1.60	
8392.00	90.150	274.070	7268.65	1551.38	482.58	-1527.50	1.16	
8486.00	90.150	273.190	7268.41	1645.37	488.54	-1621.31	0.94	
8579.00	90.180	271.440	7268.14	1738.36	492.29	-1714.23	1.88	
8674.00	90.090	270.660	7267.92	1833.30	494.03	-1809.21	0.83	
8767.00	90.220	272.290	7267.66	1926.26	496.43	-1902.18	1.76	
8861.00	90.310	272.600	7267.23	2020.25	500.44	-1996.09	0.34	
8955.00	90.150	272.710	7266.85	2114.25	504.79	-2089.99	0.21	
9048.00	90.150	269.960	7266.61	2207.19	506.96	-2182.95	2.96	
9142.00	90.150	267.880	7266.36	2300.94	505.19	-2276.93	2.21	
9237.00	90.180	265.890	7266.09	2395.37	500.02	-2371.79	2.09	
9330.00	90.220	264.810	7265.76	2487.52	492.48	-2464.48	1.16	
9422.00	90.090	263.480	7265.52	2578.40	483.10	-2556.00	1.45	
9516.00	90.250	263.710	7265.24	2671.11	472.61	-2649.41	0.30	
9610.00	90.090	263.150	7264.96	2763.77	461.86	-2742.79	0.62	
9703.00	90.150	262.070	7264.76	2855.21	449.90	-2835.02	1.16	
9796.00	90.060	264.140	7264.59	2946.79	438.73	-2927.34	2.23	
9890.00	90.150	265.910	7264.42	3039.86	430.58	-3020.98	1.89	
9983.00	90.250	269.400	7264.10	3132.42	426.78	-3113.89	3.75	
10077.00	89.970	271.060	7263.92	3226.30	427.15	-3207.88	1.79	
10171.00	90.280	273.590	7263.71	3320.29	430.97	-3301.80	2.71	
10263.00	90.180	276.770	7263.34	3412.21	439.27	-3393.41	3.46	
10356.00	90.150	278.670	7263.07	3504.91	451.76	-3485.56	2.04	
10451.00	90.090	278.060	7262.87	3599.50	465.58	-3579.55	0.65	
10545.00	90.120	275.210	7262.70	3693.32	476.44	-3672.91	3.03	
10639.00	90.120	274.500	7262.50	3787.27	484.40	-3766.57	0.76	
10731.00	89.690	273.970	7262.66	3879.25	491.19	-3858.32	0.74	
10824.00	88.150	272.280	7264.41	3972.23	496.26	-3951.16	2.46	
10918.00	87.940	269.540	7267.62	4066.10	497.75	-4045.08	2.92	



Actual Wellpath Report

HARVESTERS STATE 31C-16-M AWP

Page 6 of 9



REFERENCE WELLPATH IDENTIFICATION

Operator	SRC ENERGY	Slot	SLOT#06 HARVESTERS STATE 31C-16-M (1693'FNL & 2333'FEL, SEC.15)
Area	COLORADO	Well	HARVESTERS STATE 31C-16-M
Field	WELD COUNTY (NAD83, TRUE NORTH)	Wellbore	HARVESTERS STATE 31C-16-M AWB
Facility	SEC.15-T06N-R66W		

WELLPATH DATA (165 stations)

MD [ft]	Inclination [°]	Azimuth [°]	TVD [ft]	Vert Sect [ft]	North [ft]	East [ft]	DLS [°/100ft]	Comments
11010.00	88.030	267.370	7270.85	4157.73	495.28	-4136.99	2.36	
11104.00	88.280	266.700	7273.88	4251.16	490.42	-4230.81	0.76	
11198.00	90.250	267.520	7275.08	4344.63	485.68	-4324.68	2.27	
11291.00	90.370	267.560	7274.58	4437.19	481.69	-4417.59	0.14	
11384.00	90.740	268.530	7273.68	4529.82	478.51	-4510.53	1.12	
11478.00	90.310	268.860	7272.82	4623.54	476.37	-4604.51	0.58	
11571.00	90.090	268.750	7272.50	4716.28	474.43	-4697.48	0.26	
11663.00	90.250	270.070	7272.22	4808.09	473.49	-4789.48	1.45	
11756.00	91.350	268.770	7270.92	4900.88	472.54	-4882.46	1.83	
11849.00	91.630	267.520	7268.51	4993.50	469.54	-4975.38	1.38	
11942.00	91.320	265.990	7266.11	5085.90	464.27	-5068.20	1.68	
12035.00	90.950	264.160	7264.27	5177.96	456.29	-5160.83	2.01	
12129.00	90.770	266.930	7262.86	5271.13	448.99	-5254.53	2.95	
12222.00	90.620	268.630	7261.73	5363.71	445.39	-5347.45	1.83	
12316.00	90.770	271.300	7260.59	5457.56	445.33	-5441.43	2.84	
12408.00	91.260	273.810	7258.96	5549.53	449.43	-5533.32	2.78	
12501.00	91.600	273.970	7256.64	5642.49	455.74	-5626.07	0.40	
12594.00	91.450	272.890	7254.16	5735.46	461.30	-5718.87	1.17	
12688.00	91.880	271.460	7251.43	5829.40	464.87	-5812.76	1.59	
12782.00	91.630	270.340	7248.55	5923.29	466.34	-5906.71	1.22	
12874.00	90.990	271.770	7246.45	6015.20	468.04	-5998.66	1.70	
12968.00	90.740	272.130	7245.03	6109.17	471.23	-6092.60	0.47	
13153.00	91.230	275.080	7241.85	6294.12	482.86	-6277.18	1.62	
13246.00	90.220	274.230	7240.67	6387.07	490.41	-6369.87	1.42	
13339.00	90.550	273.760	7240.05	6480.06	496.89	-6462.64	0.62	
13432.00	90.090	272.580	7239.53	6573.06	502.03	-6555.49	1.36	
13525.00	89.940	267.300	7239.50	6665.88	501.93	-6648.46	5.68	
13617.00	90.310	265.210	7239.30	6757.22	495.93	-6740.26	2.31	
13711.00	90.250	267.070	7238.84	6850.52	489.60	-6834.04	1.98	
13803.00	90.220	266.860	7238.47	6941.99	484.73	-6925.91	0.23	



Actual Wellpath Report

HARVESTERS STATE 31C-16-M AWP

Page 7 of 9



REFERENCE WELLPATH IDENTIFICATION			
Operator	SRC ENERGY	Slot	SLOT#06 HARVESTERS STATE 31C-16-M (1693'FNL & 2333'FEL, SEC.15)
Area	COLORADO	Well	HARVESTERS STATE 31C-16-M
Field	WELD COUNTY (NAD83, TRUE NORTH)	Wellbore	HARVESTERS STATE 31C-16-M AWB
Facility	SEC.15-T06N-R66W		

WELLPATH DATA (165 stations)								
MD [ft]	Inclination [°]	Azimuth [°]	TVD [ft]	Vert Sect [ft]	North [ft]	East [ft]	DLS [°/100ft]	Comments
13896.00	90.520	268.000	7237.87	7034.53	480.56	-7018.81	1.27	
13989.00	90.310	269.160	7237.19	7127.24	478.25	-7111.78	1.27	
14082.00	90.430	268.070	7236.59	7219.95	476.00	-7204.75	1.18	
14174.00	90.520	267.180	7235.83	7311.53	472.19	-7296.67	0.97	
14266.00	90.490	266.570	7235.02	7402.98	467.18	-7388.53	0.66	
14359.00	90.310	264.830	7234.37	7495.20	460.20	-7481.26	1.88	
14454.00	90.120	263.590	7234.01	7589.06	450.62	-7575.77	1.32	
14549.00	90.310	263.950	7233.66	7682.80	440.31	-7670.21	0.43	
14641.00	90.430	264.910	7233.06	7773.74	431.38	-7761.77	1.05	
14734.00	90.090	265.020	7232.64	7865.80	423.22	-7854.41	0.38	
14826.00	90.090	264.000	7232.50	7956.77	414.42	-7945.99	1.11	
14919.00	90.180	265.070	7232.28	8048.73	405.56	-8038.56	1.15	
15013.00	90.150	265.300	7232.01	8141.83	397.67	-8132.23	0.25	
15079.00	90.090	266.310	7231.87	8207.30	392.84	-8198.05	1.53	LAST BHI MWD SURVEY (1233'FNL & 115'FWL, SEC.16)
15103.00	90.090	266.310	7231.83	8231.13	391.30	-8222.00	0.00	PROJECTION TO BIT (1234'FNL & 91'FWL, SEC.16)

HOLE & CASING SECTIONS									
- Ref Wellbore: HARVESTERS STATE 31C-16-M AWB					Ref Wellpath: HARVESTERS STATE 31C-16-M AWP				
String/Diameter	Start MD [ft]	End MD [ft]	Interval [ft]	Start TVD [ft]	End TVD [ft]	Start N/S [ft]	Start E/W [ft]	End N/S [ft]	End E/W [ft]
13.5in Open Hole	20.00	1795.00	1775.00	20.00	1791.09	0.00	0.00	103.85	-34.65
9.625in Casing Surface	20.00	1795.00	1775.00	20.00	1791.09	0.00	0.00	103.85	-34.65
8.5in Open Hole	1795.00	15103.00	13308.00	1791.09	7231.83	103.85	-34.65	391.30	-8222.00



Actual Wellpath Report

HARVESTERS STATE 31C-16-M AWP

Page 8 of 9



REFERENCE WELLPATH IDENTIFICATION

Operator	SRC ENERGY	Slot	SLOT#06 HARVESTERS STATE 31C-16-M (1693'FNL & 2333'FEL, SEC.15)
Area	COLORADO	Well	HARVESTERS STATE 31C-16-M
Field	WELD COUNTY (NAD83, TRUE NORTH)	Wellbore	HARVESTERS STATE 31C-16-M AWB
Facility	SEC.15-T06N-R66W		

TARGETS

Name	TVD [ft]	North [ft]	East [ft]	Grid East [US ft]	Grid North [US ft]	Latitude	Longitude	Shape
SEC.15-T06N-R66W	16.00	99.78	0.77	3205120.91	1422648.52	40°29'28.428"N	104°45'45.022"W	polygon
SEC.16-T06N-R66W	16.00	99.78	0.77	3205120.91	1422648.52	40°29'28.428"N	104°45'45.022"W	polygon
HARVESTERS STATE 31C-16-M BHL REV-2 (1183'FNL & 150'FWL, SEC.16)	7235.32	442.50	-8162.94	3196954.93	1422923.32	40°29'31.801"N	104°47'30.685"W	point
HARVESTERS STATE 31C-16-M BHL ON PLAT (1183'FNL & 150'FWL, SEC.16)	7243.00	442.50	-8162.94	3196954.93	1422923.32	40°29'31.801"N	104°47'30.685"W	point
HARVESTERS STATE 31C-16-M TOP OF PROD ON PLAT (1195'FNL & 2217'FWL, SEC.15)	7270.00	500.91	-790.51	3204326.35	1423043.04	40°29'32.392"N	104°45'55.264"W	point
HARVESTERS STATE 31C-16-M HARDLINE BOX	7270.26	0.00	0.00	3205120.97	1422548.74	40°29'27.442"N	104°45'45.032"W	polygon
HARVESTERS STATE 31C-16-M TOP OF PROD REV-2 (1191'FNL & 2217'FWL, SEC.15)	7270.26	504.91	-790.51	3204326.32	1423047.04	40°29'32.431"N	104°45'55.264"W	point

WELLPATH COMPOSITION - Ref Wellbore: HARVESTERS STATE 31C-16-M AWB Ref Wellpath: HARVESTERS STATE 31C-16-M AWP

Start MD [ft]	End MD [ft]	Positional Uncertainty Model	Log Name/Comment	Wellbore
20.00	1757.00	BHI NaviTrak (Rotating+Axial Corr)	13 1/2" SURFACE SURVEYS <86'-1741'>	HARVESTERS STATE 31C-16-M AWB
1757.00	15079.00	BHI AutoTrak Curve (IFR1, Short)	8 1/2" MONOBORE SURVEYS <1860-15079>	HARVESTERS STATE 31C-16-M AWB
15079.00	15103.00	Blind Drilling (std)	Projection to bit	HARVESTERS STATE 31C-16-M AWB



SRC ENERGY

Actual Wellpath Report

HARVESTERS STATE 31C-16-M AWP

Page 9 of 9



REFERENCE WELLPATH IDENTIFICATION

Operator	SRC ENERGY	Slot	SLOT#06 HARVESTERS STATE 31C-16-M (1693'FNL & 2333'FEL, SEC.15)
Area	COLORADO	Well	HARVESTERS STATE 31C-16-M
Field	WELD COUNTY (NAD83, TRUE NORTH)	Wellbore	HARVESTERS STATE 31C-16-M AWB
Facility	SEC.15-T06N-R66W		

WELLPATH COMMENTS

MD [ft]	Inclination [°]	Azimuth [°]	TVD [ft]	Comment
7646.00	89.940	271.150	7270.34	LANDING POINT (1221'FNL & 2226'FWL, SEC.15)
15079.00	90.090	266.310	7231.87	LAST BHI MWD SURVEY (1233'FNL & 115'FWL, SEC.16)
15103.00	90.090	266.310	7231.83	PROJECTION TO BIT (1234'FNL & 91'FWL, SEC.16)