

# SRC ENERGY

Location: COLORADO Slot: SLOT#02 HARVESTERS STATE 30N-16B-M (1613'FNL & 2333'FEL, SEC.15)  
 Field: WELD COUNTY (NAD83,TRUE NORTH) Well: HARVESTERS STATE 30N-16B-M  
 Facility: SEC.15-T06N-R66W Wellbore: HARVESTERS STATE 30N-16B-M PWB

Plot reference wellpath is HARVESTERS STATE 30N-16B-M (REV-B.0) PWP	Grid System: NAD83 / Lambert Colorado SP, Northern Zone (501), US feet
True vertical depths are referenced to PRECISION 462 (20) (RKB)	* = Wellpath was transformed from a different geodetic datum
Measured depths are referenced to PRECISION 462 (20) (RKB)	North Reference: True north
PRECISION 462 (20) (RKB) to Mean Sea Level: 4822 feet	Scale: True distance
Mean Sea Level to Mud line (At Slot: SLOT#02 HARVESTERS STATE 30N-16B-M (1613'FNL & 2333'FEL, SEC.15)): 0 feet	Depths are in feet
Coordinates are in feet referenced to Slot	Created by: doddanna on 2018-06-26
	Database: WellArchitectDB2

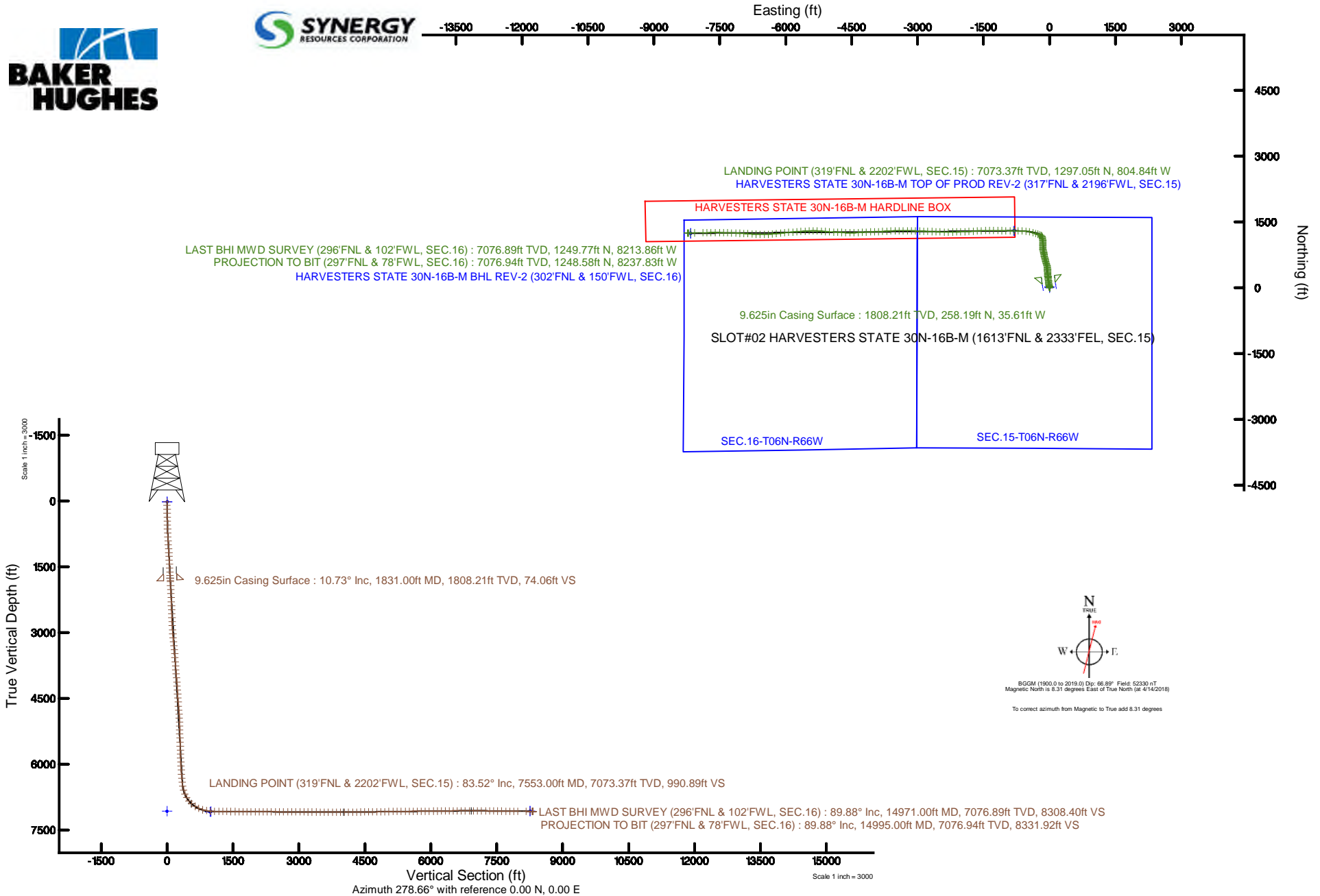



# Actual Wellpath Report

## HARVESTERS STATE 30N-16B-M AWP

Page 1 of 9



### REFERENCE WELLPATH IDENTIFICATION

Operator	SRC ENERGY	Slot	SLOT#02 HARVESTERS STATE 30N-16B-M (1613'FNL & 2333'FEL, SEC.15)
Area	COLORADO	Well	HARVESTERS STATE 30N-16B-M
Field	WELD COUNTY (NAD83,TRUE NORTH)	Wellbore	HARVESTERS STATE 30N-16B-M AWP
Facility	SEC.15-T06N-R66W		

### REPORT SETUP INFORMATION

Projection System	NAD83 / Lambert Colorado SP, Northern Zone (501), US feet	Software System	WellArchitect® 5.0
North Reference	True	User	Doddanna
Scale	0.999966	Report Generated	6/26/2018 at 11:01:55 AM
Convergence at slot	0.48° East	Database/Source file	WellArchitectDB2/HARVESTERS_STATE_30N-16B-M_AWP.xml

### WELLPATH LOCATION

	Local coordinates		Grid coordinates		Geographic coordinates	
	North[ft]	East[ft]	Easting[US ft]	Northing[US ft]	Latitude	Longitude
Slot Location	-19.63	0.00	3205121.07	1422628.89	40°29'28.234"N	104°45'45.022"W
Facility Reference Pt			3205120.91	1422648.52	40°29'28.428"N	104°45'45.022"W
Field Reference Pt			3171284.48	1426358.81	40°30'07.643"N	104°53'02.634"W

### WELLPATH DATUM

Calculation method	Minimum curvature	PRECISION 462 (20') (RKB) to Facility Vertical Datum	4822.00ft
Horizontal Reference Pt	Slot	PRECISION 462 (20') (RKB) to Mean Sea Level	4822.00ft
Vertical Reference Pt	PRECISION 462 (20') (RKB)	PRECISION 462 (20') (RKB) to Mud Line at Slot (SLOT#02 HARVESTERS STATE 30N-16B-M (1613'FNL & 2333'FEL, SEC.15))	4822.00ft
MD Reference Pt	PRECISION 462 (20') (RKB)	Section Origin	N 0.00, E 0.00 ft
Field Vertical Reference	Mean Sea Level	Section Azimuth	278.66°



# Actual Wellpath Report

## HARVESTERS STATE 30N-16B-M AWP

Page 2 of 9



REFERENCE WELLPATH IDENTIFICATION			
Operator	SRC ENERGY	Slot	SLOT#02 HARVESTERS STATE 30N-16B-M (1613'FNL & 2333'FEL, SEC.15)
Area	COLORADO	Well	HARVESTERS STATE 30N-16B-M
Field	WELD COUNTY (NAD83,TRUE NORTH)	Wellbore	HARVESTERS STATE 30N-16B-M AWB
Facility	SEC.15-T06N-R66W		

WELLPATH DATA (164 stations) † = interpolated/extrapolated station								
MD [ft]	Inclination [°]	Azimuth [°]	TVD [ft]	Vert Sect [ft]	North [ft]	East [ft]	DLS [°/100ft]	Comments
0.00†	0.000	358.540	0.00	0.00	0.00	0.00	0.00	
20.00	0.000	358.540	20.00	0.00	0.00	0.00	0.00	
102.00	1.040	358.540	102.00	0.13	0.74	-0.02	1.27	
189.00	2.130	358.350	188.96	0.56	3.15	-0.09	1.25	
280.00	3.710	351.620	279.84	1.72	7.75	-0.56	1.77	
373.00	4.250	340.890	372.62	4.21	13.99	-2.13	0.99	
464.00	4.290	354.320	463.37	6.62	20.56	-3.57	1.10	
554.00	5.660	356.730	553.03	8.38	28.34	-4.16	1.54	
644.00	6.930	350.380	642.48	11.00	38.12	-5.32	1.61	
734.00	8.500	349.280	731.66	14.91	50.01	-7.46	1.75	
824.00	9.340	347.510	820.58	19.75	63.68	-10.28	0.98	
914.00	10.060	349.830	909.29	24.92	78.55	-13.25	0.91	
1004.00	10.900	350.640	997.79	30.09	94.68	-16.02	0.95	
1094.00	11.160	351.430	1086.12	35.30	111.69	-18.70	0.33	
1184.00	11.710	352.570	1174.34	40.41	129.36	-21.18	0.66	
1274.00	11.720	353.570	1262.46	45.32	147.50	-23.38	0.23	
1364.00	11.630	354.340	1350.60	49.94	165.61	-25.30	0.20	
1454.00	11.840	353.820	1438.72	54.55	183.82	-27.19	0.26	
1544.00	11.000	353.820	1526.94	59.11	201.53	-29.11	0.93	
1634.00	11.630	355.300	1615.19	63.40	219.11	-30.78	0.77	
1724.00	11.950	352.330	1703.29	68.12	237.39	-32.76	0.76	
1778.00	11.290	352.020	1756.18	71.20	248.16	-34.24	1.23	
1860.00	10.420	352.750	1836.71	75.54	263.47	-36.29	1.07	
1954.00	11.400	352.910	1929.01	80.39	281.12	-38.51	1.04	
2048.00	11.470	353.930	2021.15	85.28	299.63	-40.65	0.23	
2141.00	11.560	355.550	2112.28	89.75	318.12	-42.35	0.36	
2234.00	11.600	356.270	2203.38	93.87	336.74	-43.68	0.16	
2328.00	11.570	357.100	2295.47	97.78	355.58	-44.77	0.18	
2420.00	11.480	358.100	2385.61	101.31	373.95	-45.54	0.24	
2514.00	11.480	359.520	2477.73	104.51	392.65	-45.93	0.30	



# Actual Wellpath Report

## HARVESTERS STATE 30N-16B-M AWP

Page 3 of 9



REFERENCE WELLPATH IDENTIFICATION			
Operator	SRC ENERGY	Slot	SLOT#02 HARVESTERS STATE 30N-16B-M (1613'FNL & 2333'FEL, SEC.15)
Area	COLORADO	Well	HARVESTERS STATE 30N-16B-M
Field	WELD COUNTY (NAD83,TRUE NORTH)	Wellbore	HARVESTERS STATE 30N-16B-M AWP
Facility	SEC.15-T06N-R66W		

### WELLPATH DATA (164 stations)

MD [ft]	Inclination [°]	Azimuth [°]	TVD [ft]	Vert Sect [ft]	North [ft]	East [ft]	DLS [°/100ft]	Comments
2608.00	11.550	0.020	2569.84	107.40	411.41	-46.01	0.13	
2703.00	11.430	357.420	2662.94	110.67	430.33	-46.43	0.56	
2795.00	11.340	355.200	2753.13	114.55	448.45	-47.59	0.49	
2888.00	11.450	352.270	2844.30	119.28	466.71	-49.60	0.63	
2982.00	11.240	349.290	2936.46	124.95	484.95	-52.56	0.66	
3075.00	11.220	345.260	3027.68	131.55	502.61	-56.54	0.84	
3168.00	11.420	342.470	3118.87	139.20	520.14	-61.62	0.63	
3260.00	11.330	342.380	3209.07	147.22	537.44	-67.10	0.10	
3353.00	11.390	342.150	3300.24	155.37	554.88	-72.68	0.08	
3446.00	11.400	341.760	3391.41	163.62	572.36	-78.37	0.08	
3540.00	11.040	342.080	3483.61	171.85	589.74	-84.05	0.39	
3633.00	11.330	346.360	3574.85	179.30	607.09	-88.94	0.95	
3726.00	11.220	348.890	3666.05	185.83	624.85	-92.84	0.54	
3820.00	11.560	349.060	3758.20	192.08	643.07	-96.39	0.36	
3912.00	11.680	347.710	3848.32	198.50	661.22	-100.12	0.32	
4006.00	11.510	340.530	3940.40	206.32	679.36	-105.27	1.54	
4102.00	11.470	340.510	4034.48	215.34	697.39	-111.65	0.04	
4196.00	11.360	347.000	4126.62	223.17	715.22	-116.85	1.37	
4290.00	11.210	352.000	4218.81	229.20	733.29	-120.21	1.05	
4383.00	11.380	351.180	4310.01	234.55	751.31	-122.87	0.25	
4476.00	11.570	351.560	4401.15	240.05	769.60	-125.65	0.22	
4568.00	11.550	350.470	4491.28	245.63	787.81	-128.52	0.24	
4663.00	11.180	346.270	4584.42	252.11	806.13	-132.29	0.95	
4756.00	11.210	346.960	4675.65	258.89	823.70	-136.46	0.15	
4849.00	11.180	343.930	4766.88	266.00	841.17	-141.00	0.63	
4942.00	11.300	345.800	4858.10	273.31	858.67	-145.73	0.41	
5035.00	11.170	353.710	4949.32	279.17	876.46	-148.95	1.66	
5129.00	11.420	1.110	5041.51	282.74	894.81	-149.77	1.56	
5223.00	11.640	0.210	5133.61	285.36	913.60	-149.56	0.30	
5315.00	11.490	2.640	5223.74	287.68	932.03	-149.10	0.55	



# Actual Wellpath Report

## HARVESTERS STATE 30N-16B-M AWP

Page 4 of 9



REFERENCE WELLPATH IDENTIFICATION			
Operator	SRC ENERGY	Slot	SLOT#02 HARVESTERS STATE 30N-16B-M (1613'FNL & 2333'FEL, SEC.15)
Area	COLORADO	Well	HARVESTERS STATE 30N-16B-M
Field	WELD COUNTY (NAD83,TRUE NORTH)	Wellbore	HARVESTERS STATE 30N-16B-M AWB
Facility	SEC.15-T06N-R66W		

### WELLPATH DATA (164 stations)

MD [ft]	Inclination [°]	Azimuth [°]	TVD [ft]	Vert Sect [ft]	North [ft]	East [ft]	DLS [°/100ft]	Comments
5407.00	11.210	0.780	5313.94	289.87	950.13	-148.56	0.50	
5500.00	11.180	355.570	5405.18	293.15	968.16	-149.13	1.09	
5594.00	11.480	356.890	5497.35	297.12	986.58	-150.34	0.42	
5687.00	11.570	359.740	5588.47	300.45	1005.15	-150.89	0.62	
5780.00	11.240	2.780	5679.64	302.83	1023.53	-150.49	0.74	
5873.00	11.410	2.100	5770.82	304.80	1041.77	-149.71	0.23	
5967.00	11.390	357.020	5862.97	307.74	1060.34	-149.85	1.07	
6060.00	11.520	354.440	5954.12	311.87	1078.75	-151.23	0.57	
6152.00	11.420	351.130	6044.28	316.87	1096.89	-153.52	0.72	
6245.00	11.320	347.640	6135.46	322.92	1114.91	-156.90	0.75	
6338.00	11.320	345.630	6226.65	329.76	1132.66	-161.12	0.42	
6430.00	11.530	345.680	6316.83	336.88	1150.32	-165.63	0.23	
6525.00	11.390	345.700	6409.93	344.24	1168.61	-170.30	0.15	
6617.00	12.570	321.790	6499.98	355.10	1185.29	-178.74	5.50	
6711.00	16.910	291.640	6591.00	375.93	1198.39	-197.81	9.23	
6804.00	22.800	289.050	6678.43	406.86	1209.27	-227.44	6.40	
6897.00	30.430	289.920	6761.52	447.74	1223.20	-266.67	8.21	
6990.00	39.650	287.510	6837.58	500.27	1240.19	-317.22	10.02	
7083.00	48.770	286.260	6904.18	564.39	1258.95	-379.23	9.85	
7177.00	56.490	283.290	6961.20	638.61	1277.88	-451.42	8.59	
7272.00	64.690	274.130	7007.88	721.17	1290.12	-533.06	12.03	
7366.00	74.520	270.970	7040.61	808.64	1293.96	-620.96	10.92	
7459.00	80.750	271.050	7060.51	898.63	1295.56	-711.75	6.70	
7553.00	83.520	270.790	7073.37	990.89	1297.05	-804.84	2.96	LANDING POINT (319'FNL & 2202'FWL, SEC.15)
7647.00	89.600	271.000	7079.01	1083.82	1298.52	-898.62	6.47	
7740.00	89.510	271.660	7079.73	1176.06	1300.68	-991.59	0.72	
7833.00	89.940	271.390	7080.18	1268.34	1303.15	-1084.55	0.55	
7927.00	89.570	271.030	7080.58	1361.54	1305.14	-1178.53	0.55	
8019.00	89.750	270.590	7081.13	1452.68	1306.44	-1270.52	0.52	
8113.00	89.750	268.970	7081.54	1545.55	1306.08	-1364.52	1.72	



# Actual Wellpath Report

## HARVESTERS STATE 30N-16B-M AWP

Page 5 of 9



REFERENCE WELLPATH IDENTIFICATION			
Operator	SRC ENERGY	Slot	SLOT#02 HARVESTERS STATE 30N-16B-M (1613'FNL & 2333'FEL, SEC.15)
Area	COLORADO	Well	HARVESTERS STATE 30N-16B-M
Field	WELD COUNTY (NAD83,TRUE NORTH)	Wellbore	HARVESTERS STATE 30N-16B-M AWP
Facility	SEC.15-T06N-R66W		

### WELLPATH DATA (164 stations)

MD [ft]	Inclination [°]	Azimuth [°]	TVD [ft]	Vert Sect [ft]	North [ft]	East [ft]	DLS [°/100ft]	Comments
8206.00	89.320	268.990	7082.29	1637.22	1304.42	-1457.50	0.46	
8299.00	89.750	267.600	7083.05	1728.70	1301.65	-1550.45	1.56	
8393.00	89.780	267.200	7083.43	1820.89	1297.39	-1644.35	0.43	
8486.00	89.630	265.810	7083.91	1911.81	1291.72	-1737.18	1.50	
8581.00	89.570	264.850	7084.57	2004.24	1283.99	-1831.86	1.01	
8674.00	90.000	268.990	7084.92	2095.28	1278.99	-1924.70	4.48	
8768.00	89.780	269.510	7085.10	2188.01	1277.76	-2018.69	0.60	
8862.00	89.940	268.070	7085.33	2280.62	1275.77	-2112.67	1.54	
8955.00	89.660	268.500	7085.66	2372.10	1272.99	-2205.63	0.55	
9050.00	89.630	269.470	7086.25	2465.75	1271.31	-2300.61	1.02	
9144.00	89.630	271.000	7086.85	2558.73	1271.69	-2394.61	1.63	
9237.00	89.510	271.970	7087.55	2651.00	1274.10	-2487.57	1.05	
9329.00	89.570	272.840	7088.29	2742.45	1277.96	-2579.49	0.95	
9424.00	89.820	271.930	7088.80	2836.88	1281.92	-2674.40	0.99	
9517.00	89.600	272.280	7089.27	2929.27	1285.33	-2767.34	0.44	
9610.00	89.690	272.520	7089.84	3021.71	1289.23	-2860.25	0.28	
9704.00	89.570	272.370	7090.45	3115.16	1293.24	-2954.17	0.20	
9797.00	89.660	272.660	7091.08	3207.62	1297.32	-3047.07	0.33	
9890.00	89.780	271.440	7091.53	3300.00	1300.65	-3140.01	1.32	
9984.00	89.600	269.600	7092.04	3393.05	1301.50	-3234.00	1.97	
10078.00	89.850	269.430	7092.49	3485.86	1300.70	-3328.00	0.32	
10170.00	89.540	269.570	7092.98	3576.68	1299.90	-3419.99	0.37	
10263.00	89.600	268.870	7093.68	3668.42	1298.63	-3512.98	0.76	
10359.00	89.660	267.490	7094.30	3762.82	1295.59	-3608.93	1.44	
10452.00	89.660	266.430	7094.85	3853.88	1290.65	-3701.79	1.14	
10546.00	89.600	267.150	7095.46	3945.87	1285.39	-3795.64	0.77	
10638.00	89.540	267.500	7096.15	4036.07	1281.10	-3887.54	0.39	
10731.00	90.770	268.250	7095.90	4127.43	1277.65	-3980.47	1.55	
10825.00	90.710	267.930	7094.68	4219.83	1274.52	-4074.41	0.35	
10918.00	90.830	267.030	7093.43	4311.05	1270.43	-4167.31	0.98	



# Actual Wellpath Report

## HARVESTERS STATE 30N-16B-M AWP

Page 6 of 9



REFERENCE WELLPATH IDENTIFICATION			
Operator	SRC ENERGY	Slot	SLOT#02 HARVESTERS STATE 30N-16B-M (1613'FNL & 2333'FEL, SEC.15)
Area	COLORADO	Well	HARVESTERS STATE 30N-16B-M
Field	WELD COUNTY (NAD83,TRUE NORTH)	Wellbore	HARVESTERS STATE 30N-16B-M AWB
Facility	SEC.15-T06N-R66W		

### WELLPATH DATA (164 stations)

MD [ft]	Inclination [°]	Azimuth [°]	TVD [ft]	Vert Sect [ft]	North [ft]	East [ft]	DLS [°/100ft]	Comments
11011.00	90.950	267.970	7091.99	4402.29	1266.37	-4260.21	1.02	
11105.00	90.830	265.690	7090.53	4494.27	1261.17	-4354.05	2.43	
11198.00	90.830	267.190	7089.18	4585.15	1255.40	-4446.86	1.61	
11291.00	90.710	270.910	7087.93	4676.83	1253.86	-4539.82	4.00	
11385.00	90.860	273.180	7086.64	4770.19	1257.21	-4633.75	2.42	
11478.00	91.260	272.940	7084.92	4862.73	1262.18	-4726.60	0.50	
11570.00	90.920	272.450	7083.17	4954.21	1266.50	-4818.48	0.65	
11663.00	90.920	273.250	7081.68	5046.72	1271.12	-4911.35	0.86	
11756.00	90.650	272.830	7080.40	5139.27	1276.06	-5004.21	0.54	
11849.00	90.620	274.440	7079.37	5231.90	1281.95	-5097.02	1.73	
11942.00	90.620	275.310	7078.37	5324.69	1289.85	-5189.67	0.94	
12036.00	90.490	273.990	7077.46	5418.46	1297.47	-5283.36	1.41	
12129.00	90.430	268.760	7076.71	5510.67	1299.70	-5376.30	5.62	
12223.00	90.280	266.940	7076.13	5603.00	1296.18	-5470.22	1.94	
12315.00	90.490	266.960	7075.51	5693.08	1291.28	-5562.09	0.23	
12408.00	90.550	266.230	7074.66	5784.03	1285.76	-5654.92	0.79	
12501.00	90.550	265.630	7073.77	5874.74	1279.16	-5747.68	0.65	
12595.00	90.680	265.300	7072.76	5966.25	1271.73	-5841.38	0.38	
12689.00	90.580	265.400	7071.73	6057.72	1264.11	-5935.07	0.15	
12781.00	90.430	264.080	7070.92	6147.01	1255.67	-6026.68	1.44	
12875.00	90.860	264.060	7069.86	6237.98	1245.96	-6120.17	0.46	
12968.00	90.920	264.130	7068.41	6327.98	1236.40	-6212.66	0.10	
13061.00	90.740	265.270	7067.07	6418.22	1227.81	-6305.25	1.24	
13153.00	90.650	267.010	7065.95	6508.03	1221.61	-6397.03	1.89	
13246.00	90.460	269.470	7065.05	6599.48	1218.76	-6489.98	2.65	
13339.00	90.120	270.900	7064.58	6691.47	1219.06	-6582.97	1.58	
13432.00	90.250	272.750	7064.28	6783.80	1222.02	-6675.92	1.99	
13524.00	90.770	273.760	7063.46	6875.39	1227.24	-6767.77	1.23	
13618.00	89.510	273.740	7063.23	6969.04	1233.39	-6861.57	1.34	
13711.00	89.420	272.560	7064.10	7061.61	1238.50	-6954.42	1.27	



# Actual Wellpath Report

## HARVESTERS STATE 30N-16B-M AWP

Page 7 of 9



REFERENCE WELLPATH IDENTIFICATION			
Operator	SRC ENERGY	Slot	SLOT#02 HARVESTERS STATE 30N-16B-M (1613'FNL & 2333'FEL, SEC.15)
Area	COLORADO	Well	HARVESTERS STATE 30N-16B-M
Field	WELD COUNTY (NAD83,TRUE NORTH)	Wellbore	HARVESTERS STATE 30N-16B-M AWB
Facility	SEC.15-T06N-R66W		

### WELLPATH DATA (164 stations)

MD [ft]	Inclination [°]	Azimuth [°]	TVD [ft]	Vert Sect [ft]	North [ft]	East [ft]	DLS [°/100ft]	Comments
13803.00	89.420	273.320	7065.03	7153.14	1243.22	-7046.29	0.83	
13896.00	89.140	272.480	7066.20	7245.67	1247.93	-7139.17	0.95	
13989.00	88.980	271.620	7067.72	7338.03	1251.25	-7232.09	0.94	
14081.00	89.050	271.470	7069.31	7429.31	1253.73	-7324.05	0.18	
14174.00	89.170	271.110	7070.75	7521.53	1255.83	-7417.01	0.41	
14266.00	89.480	271.630	7071.83	7612.78	1258.02	-7508.98	0.66	
14361.00	89.600	269.680	7072.60	7706.85	1259.11	-7603.96	2.06	
14456.00	89.540	269.090	7073.31	7800.61	1258.09	-7698.96	0.62	
14549.00	89.510	268.960	7074.08	7892.29	1256.51	-7791.94	0.14	
14641.00	89.480	269.190	7074.89	7983.01	1255.02	-7883.92	0.25	
14827.00	89.660	269.340	7076.29	8166.51	1252.64	-8069.90	0.13	
14920.00	89.780	269.150	7076.74	8258.26	1251.41	-8162.89	0.24	
14971.00	89.880	267.160	7076.89	8308.40	1249.77	-8213.86	3.91	LAST BHI MWD SURVEY (296'FNL & 102'FWL, SEC.16)
14995.00	89.880	267.160	7076.94	8331.92	1248.58	-8237.83	0.00	PROJECTION TO BIT (297'FNL & 78'FWL, SEC.16)

HOLE & CASING SECTIONS - Ref Wellbore: HARVESTERS STATE 30N-16B-M AWB      Ref Wellpath: HARVESTERS STATE 30N-16B-M AWP									
String/Diameter	Start MD [ft]	End MD [ft]	Interval [ft]	Start TVD [ft]	End TVD [ft]	Start N/S [ft]	Start E/W [ft]	End N/S [ft]	End E/W [ft]
13.5in Open Hole	20.00	1831.00	1811.00	20.00	1808.21	0.00	0.00	258.19	-35.61
9.625in Casing Surface	20.00	1831.00	1811.00	20.00	1808.21	0.00	0.00	258.19	-35.61
8.5in Open Hole	1831.00	14995.00	13164.00	1808.21	7076.94	258.19	-35.61	1248.58	-8237.83



# Actual Wellpath Report

## HARVESTERS STATE 30N-16B-M AWP

Page 8 of 9



REFERENCE WELLPATH IDENTIFICATION			
Operator	SRC ENERGY	Slot	SLOT#02 HARVESTERS STATE 30N-16B-M (1613'FNL & 2333'FEL, SEC.15)
Area	COLORADO	Well	HARVESTERS STATE 30N-16B-M
Field	WELD COUNTY (NAD83,TRUE NORTH)	Wellbore	HARVESTERS STATE 30N-16B-M AWB
Facility	SEC.15-T06N-R66W		

TARGETS								
Name	TVD [ft]	North [ft]	East [ft]	Grid East [US ft]	Grid North [US ft]	Latitude	Longitude	Shape
SEC.15-T06N-R66W	16.00	19.63	0.00	3205120.91	1422648.52	40°29'28.428"N	104°45'45.022"W	polygon
SEC.16-T06N-R66W	16.00	19.63	0.00	3205120.91	1422648.52	40°29'28.428"N	104°45'45.022"W	polygon
HARVESTERS STATE 30N-16B-M BHL ON PLAT (302'FNL & 150'FWL, SEC.16)	7067.00	1243.27	-8165.92	3196945.39	1423804.16	40°29'40.506"N	104°47'30.718"W	point
HARVESTERS STATE 30N-16B-M BHL REV-2 (302'FNL & 150'FWL, SEC.16)	7074.28	1243.22	-8165.92	3196945.39	1423804.11	40°29'40.505"N	104°47'30.718"W	point
HARVESTERS STATE 30N-16B-M HARDLINE BOX	7074.28	0.00	0.00	3205121.07	1422628.89	40°29'28.234"N	104°45'45.022"W	polygon
HARVESTERS STATE 30N-16B-M TOP OF PROD REV-2 (317'FNL & 2196'FWL, SEC.15)	7079.47	1298.77	-810.42	3204299.91	1423920.83	40°29'41.068"N	104°45'55.512"W	point
HARVESTERS STATE 30N-16B-M TOP OF PROD ON PLAT (317'FNL & 2216'FWL, SEC.15)	7088.00	1298.77	-790.42	3204319.91	1423920.99	40°29'41.068"N	104°45'55.253"W	point

WELLPATH COMPOSITION - Ref Wellbore: HARVESTERS STATE 30N-16B-M AWB					Ref Wellpath: HARVESTERS STATE 30N-16B-M AWP
Start MD [ft]	End MD [ft]	Positional Uncertainty Model	Log Name/Comment		Wellbore
20.00	1778.00	BHI NaviTrak (Standard)	13 1/2" SURFACE SURVEYS <86-1762>		HARVESTERS STATE 30N-16B-M AWB
1778.00	14971.00	BHI AutoTrak Curve (IFR1, Short)	8 1/2" MONOBORE SURVEYS <1860'-14971'>		HARVESTERS STATE 30N-16B-M AWB
14971.00	14995.00	Blind Drilling (std)	Projection to bit		HARVESTERS STATE 30N-16B-M AWB



# Actual Wellpath Report

## HARVESTERS STATE 30N-16B-M AWP

Page 9 of 9



REFERENCE WELLPATH IDENTIFICATION			
Operator	SRC ENERGY	Slot	SLOT#02 HARVESTERS STATE 30N-16B-M (1613'FNL & 2333'FEL, SEC.15)
Area	COLORADO	Well	HARVESTERS STATE 30N-16B-M
Field	WELD COUNTY (NAD83,TRUE NORTH)	Wellbore	HARVESTERS STATE 30N-16B-M AWB
Facility	SEC.15-T06N-R66W		

WELLPATH COMMENTS				
MD [ft]	Inclination [°]	Azimuth [°]	TVD [ft]	Comment
7553.00	83.520	270.790	7073.37	LANDING POINT (319'FNL & 2202'FWL, SEC.15)
14971.00	89.880	267.160	7076.89	LAST BHI MWD SURVEY (296'FNL & 102'FWL, SEC.16)
14995.00	89.880	267.160	7076.94	PROJECTION TO BIT (297'FNL & 78'FWL, SEC.16)