

BAYSWATER E & P LLC

Location: COLORADO Slot: SLOT#09 G & D HANKS S-27-28HN (1228°FSL & 1575°FEL, SEC.27)
 Field: WELD COUNTY (NAD83/TRUE NORTH) Well: G & D HANKS S-27-28HN
 Facility: SEC.27-T07N-R66W Wellbore: G & D HANKS S-27-28HN PWB

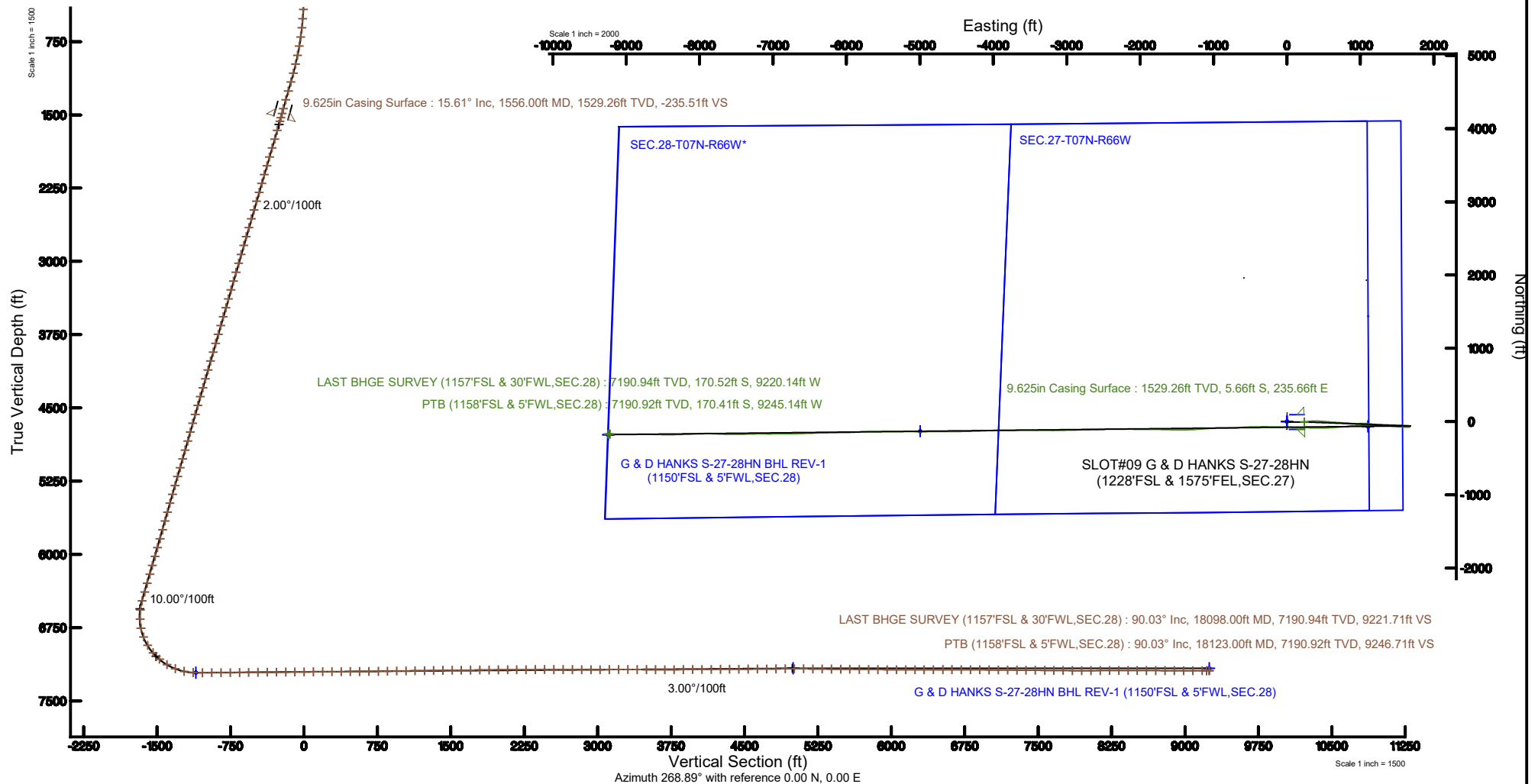

Plot reference wellpath is G & D HANKS S-27-28HN PWB (REV-C.0)	Grid System: NAD83 / Lambert Colorado SP, Northern Zone (501), US feet
True vertical depths are referenced to TRUE 38 (4876'GL + 25'KB @ 4901'RKB) (RKB)	North Reference: True north
Measured depths are referenced to TRUE 38 (4876'GL + 25'KB @ 4901'RKB) (RKB)	Scale: True distance
TRUE 38 (4876'GL + 25'KB @ 4901'RKB) (RKB) to Mean Sea Level: 4901 feet	Depths are in feet
Mean Sea Level to Ground level (At Slot: SLOT#09 G & D HANKS S-27-28HN (1228°FSL & 1575°FEL, SEC.27)): 0 feet	Created by: amuntime on 2018-06-20
Coordinates are in feet referenced to Slot	Database: WA DENVER



Actual Wellpath Report

G & D HANKS S-27-28HN AWP

Page n of nn



REFERENCE WELLPATH IDENTIFICATION

Operator	BAYSWATER E & P LLC	Slot	SLOT#09 G & D HANKS S-27-28HN (1228'FSL & 1575'FEL, SEC.27)
Area	COLORADO	Well	G & D HANKS S-27-28HN
Field	WELD COUNTY (NAD83/TRUE NORTH)	Wellbore	G & D HANKS S-27-28HN AWB
Facility	SEC.27-T07N-R66W		

REPORT SETUP INFORMATION

Projection System	NAD83 / Lambert Colorado SP, Northern Zone (501), US feet	Software System	WellArchitect® 5.1
North Reference	True	User	Amuntime
Scale	0.999970	Report Generated	6/20/2018 at 9:08:59 AM
Convergence at slot	0.48° East	Database/Source file	WA DENVER/G__D_HANKS_S-27-28HN_AWP.xml

WELLPATH LOCATION

	Local coordinates		Grid coordinates		Geographic coordinates	
	North[ft]	East[ft]	Easting[US ft]	Northing[US ft]	Latitude	Longitude
Slot Location	-120.23	-0.28	3205703.88	1441182.31	40°32'31.520"N	104°45'35.474"W
Facility Reference Pt			3205703.16	1441302.53	40°32'32.708"N	104°45'35.471"W
Field Reference Pt			3174587.00	1430859.71	40°30'51.890"N	104°52'19.470"W

WELLPATH DATUM

Calculation method	Minimum curvature	TRUE 38 (4876'GL + 25'KB @ 4901'RKB) (RKB) to Facility Vertical Datum	4901.00ft
Horizontal Reference Pt	Slot	TRUE 38 (4876'GL + 25'KB @ 4901'RKB) (RKB) to Mean Sea Level	4901.00ft
Vertical Reference Pt	TRUE 38 (4876'GL + 25'KB @ 4901'RKB) (RKB)	TRUE 38 (4876'GL + 25'KB @ 4901'RKB) (RKB) to Ground Level at Slot (SLOT#09 G & D HANKS S-27-28HN (1228'FSL & 1575'FEL, SEC.27))	4901.00ft
MD Reference Pt	TRUE 38 (4876'GL + 25'KB @ 4901'RKB) (RKB)	Section Origin	N 0.00, E 0.00 ft
Field Vertical Reference	Mean Sea Level	Section Azimuth	268.94°

Actual Wellpath Report

G & D HANKS S-27-28HN AWP

Page n of nn



REFERENCE WELLPATH IDENTIFICATION

Operator	BAYSWATER E & P LLC	Slot	SLOT#09 G & D HANKS S-27-28HN (1228'FSL & 1575'FEL, SEC.27)
Area	COLORADO	Well	G & D HANKS S-27-28HN
Field	WELD COUNTY (NAD83/TRUE NORTH)	Wellbore	G & D HANKS S-27-28HN AWP
Facility	SEC.27-T07N-R66W		

WELLPATH DATA (195 stations) † = interpolated/extrapolated station

MD [ft]	Inclination [°]	Azimuth [°]	TVD [ft]	Vert Sect [ft]	North [ft]	East [ft]	Latitude	Longitude	DLS [°/100ft]	Comments
0.00†	0.000	151.600	0.00	0.00	0.00	0.00	40°32'31.520"N	104°45'35.474"W	0.00	
25.00	0.000	151.600	25.00	0.00	0.00	0.00	40°32'31.520"N	104°45'35.474"W	0.00	
137.00	0.920	151.600	137.00	-0.41	-0.79	0.43	40°32'31.513"N	104°45'35.469"W	0.82	
232.00	0.830	143.460	231.98	-1.16	-2.01	1.20	40°32'31.500"N	104°45'35.459"W	0.16	
327.00	1.560	109.300	326.96	-2.77	-2.99	2.83	40°32'31.491"N	104°45'35.438"W	1.04	
421.00	2.830	96.780	420.89	-6.27	-3.69	6.34	40°32'31.484"N	104°45'35.392"W	1.44	
516.00	4.610	96.890	515.69	-12.38	-4.43	12.46	40°32'31.477"N	104°45'35.313"W	1.87	
610.00	6.370	95.230	609.25	-21.30	-5.36	21.41	40°32'31.467"N	104°45'35.197"W	1.88	
705.00	7.870	92.040	703.52	-33.04	-6.07	33.15	40°32'31.460"N	104°45'35.045"W	1.63	
799.00	9.710	90.120	796.41	-47.39	-6.31	47.51	40°32'31.458"N	104°45'34.859"W	1.98	
894.00	11.600	92.020	889.77	-64.94	-6.67	65.07	40°32'31.455"N	104°45'34.632"W	2.02	
988.00	13.350	90.660	981.55	-85.22	-7.12	85.37	40°32'31.450"N	104°45'34.369"W	1.89	
1083.00	14.720	89.360	1073.71	-108.26	-7.12	108.41	40°32'31.450"N	104°45'34.070"W	1.48	
1177.00	15.970	89.430	1164.36	-133.13	-6.85	133.28	40°32'31.453"N	104°45'33.748"W	1.33	
1272.00	16.270	89.560	1255.62	-159.51	-6.62	159.66	40°32'31.455"N	104°45'33.406"W	0.32	
1366.00	15.330	89.320	1346.07	-185.10	-6.37	185.25	40°32'31.457"N	104°45'33.075"W	1.00	
1460.00	15.380	89.130	1436.71	-209.99	-6.04	210.14	40°32'31.461"N	104°45'32.753"W	0.08	
1510.00	15.360	90.000	1484.93	-223.24	-5.94	223.39	40°32'31.462"N	104°45'32.581"W	0.46	
1595.00	15.840	85.280	1566.80	-246.08	-4.98	246.21	40°32'31.471"N	104°45'32.285"W	1.60	
1690.00	16.190	81.850	1658.11	-272.16	-2.04	272.24	40°32'31.500"N	104°45'31.948"W	1.06	
1784.00	16.390	81.050	1748.34	-298.30	1.88	298.31	40°32'31.539"N	104°45'31.610"W	0.32	
1879.00	16.430	83.830	1839.47	-324.96	5.41	324.91	40°32'31.574"N	104°45'31.266"W	0.83	
1974.00	16.330	89.450	1930.62	-351.70	6.99	351.63	40°32'31.589"N	104°45'30.920"W	1.67	
2068.00	16.350	90.860	2020.82	-378.13	6.91	378.07	40°32'31.589"N	104°45'30.577"W	0.42	
2163.00	16.350	90.870	2111.98	-404.86	6.51	404.81	40°32'31.585"N	104°45'30.231"W	0.00	
2257.00	16.270	91.490	2202.20	-431.24	5.97	431.20	40°32'31.579"N	104°45'29.889"W	0.20	
2352.00	16.360	93.420	2293.37	-457.87	4.82	457.86	40°32'31.568"N	104°45'29.544"W	0.58	
2446.00	16.320	94.140	2383.58	-484.22	3.08	484.25	40°32'31.551"N	104°45'29.202"W	0.22	
2540.00	16.270	94.370	2473.80	-510.49	1.12	510.55	40°32'31.531"N	104°45'28.861"W	0.09	
2635.00	16.270	95.800	2565.00	-536.95	-1.24	537.06	40°32'31.508"N	104°45'28.518"W	0.42	

Actual Wellpath Report

G & D HANKS S-27-28HN AWP

Page n of nn



REFERENCE WELLPATH IDENTIFICATION

Operator	BAYSWATER E & P LLC	Slot	SLOT#09 G & D HANKS S-27-28HN (1228'FSL & 1575'FEL, SEC.27)
Area	COLORADO	Well	G & D HANKS S-27-28HN
Field	WELD COUNTY (NAD83/TRUE NORTH)	Wellbore	G & D HANKS S-27-28HN AWB
Facility	SEC.27-T07N-R66W		

WELLPATH DATA (195 stations)

MD [ft]	Inclination [°]	Azimuth [°]	TVD [ft]	Vert Sect [ft]	North [ft]	East [ft]	Latitude	Longitude	DLS [°/100ft]	Comments
2729.00	16.120	95.370	2655.27	-562.99	-3.79	563.15	40°32'31.483"N	104°45'28.180"W	0.20	
2824.00	16.090	94.530	2746.54	-589.19	-6.06	589.41	40°32'31.460"N	104°45'27.840"W	0.25	
2919.00	16.050	94.220	2837.83	-615.37	-8.07	615.63	40°32'31.441"N	104°45'27.500"W	0.10	
3014.00	16.060	93.180	2929.12	-641.56	-9.76	641.84	40°32'31.424"N	104°45'27.161"W	0.30	
3109.00	15.970	92.040	3020.43	-667.71	-10.96	668.03	40°32'31.412"N	104°45'26.822"W	0.34	
3204.00	16.070	93.820	3111.75	-693.86	-12.30	694.21	40°32'31.399"N	104°45'26.483"W	0.53	
3298.00	16.020	94.270	3202.08	-719.74	-14.13	720.12	40°32'31.381"N	104°45'26.147"W	0.14	
3392.00	16.080	93.820	3292.42	-745.62	-15.96	746.05	40°32'31.363"N	104°45'25.811"W	0.15	
3487.00	16.000	93.630	3383.72	-771.78	-17.67	772.24	40°32'31.346"N	104°45'25.472"W	0.10	
3582.00	16.040	94.480	3475.03	-797.89	-19.52	798.39	40°32'31.327"N	104°45'25.133"W	0.25	
3677.00	15.940	93.320	3566.36	-823.97	-21.30	824.50	40°32'31.310"N	104°45'24.795"W	0.35	
3771.00	15.950	94.870	3656.74	-849.68	-23.15	850.25	40°32'31.292"N	104°45'24.461"W	0.45	
3866.00	16.000	95.730	3748.07	-875.67	-25.56	876.29	40°32'31.268"N	104°45'24.124"W	0.25	
3960.00	16.080	94.500	3838.41	-901.49	-27.88	902.15	40°32'31.245"N	104°45'23.789"W	0.37	
4055.00	16.120	90.860	3929.69	-927.76	-29.11	928.46	40°32'31.233"N	104°45'23.448"W	1.06	
4150.00	16.180	88.790	4020.94	-954.18	-29.03	954.88	40°32'31.233"N	104°45'23.106"W	0.61	
4245.00	16.080	85.690	4112.20	-980.55	-27.76	981.23	40°32'31.246"N	104°45'22.765"W	0.91	
4339.00	16.020	85.130	4202.54	-1006.49	-25.68	1007.14	40°32'31.266"N	104°45'22.429"W	0.18	
4434.00	15.910	89.450	4293.88	-1032.59	-24.44	1033.22	40°32'31.279"N	104°45'22.091"W	1.26	
4529.00	16.030	92.450	4385.21	-1058.71	-24.88	1059.34	40°32'31.274"N	104°45'21.753"W	0.88	
4623.00	15.950	94.490	4475.58	-1084.52	-26.44	1085.19	40°32'31.259"N	104°45'21.418"W	0.60	
4718.00	15.930	96.400	4566.93	-1110.43	-28.92	1111.16	40°32'31.234"N	104°45'21.082"W	0.55	
4813.00	15.880	98.160	4658.29	-1136.19	-32.22	1136.98	40°32'31.202"N	104°45'20.748"W	0.51	
4907.00	15.890	97.700	4748.70	-1161.60	-35.77	1162.46	40°32'31.167"N	104°45'20.417"W	0.13	
5002.00	15.920	96.700	4840.06	-1187.37	-39.03	1188.29	40°32'31.134"N	104°45'20.083"W	0.29	
5097.00	15.960	97.250	4931.41	-1213.20	-42.20	1214.18	40°32'31.103"N	104°45'19.748"W	0.16	
5192.00	15.880	97.530	5022.77	-1238.98	-45.55	1240.03	40°32'31.070"N	104°45'19.413"W	0.12	
5286.00	15.890	92.730	5113.18	-1264.53	-47.85	1265.63	40°32'31.047"N	104°45'19.081"W	1.40	
5380.00	16.040	89.420	5203.56	-1290.36	-48.33	1291.47	40°32'31.043"N	104°45'18.746"W	0.98	
5475.00	15.960	90.700	5294.88	-1316.54	-48.35	1317.65	40°32'31.042"N	104°45'18.407"W	0.38	

Actual Wellpath Report

G & D HANKS S-27-28HN AWP

Page n of nn



REFERENCE WELLPATH IDENTIFICATION

Operator	BAYSWATER E & P LLC	Slot	SLOT#09 G & D HANKS S-27-28HN (1228'FSL & 1575'FEL, SEC.27)
Area	COLORADO	Well	G & D HANKS S-27-28HN
Field	WELD COUNTY (NAD83/TRUE NORTH)	Wellbore	G & D HANKS S-27-28HN AWP
Facility	SEC.27-T07N-R66W		

WELLPATH DATA (195 stations)

MD [ft]	Inclination [°]	Azimuth [°]	TVD [ft]	Vert Sect [ft]	North [ft]	East [ft]	Latitude	Longitude	DLS [°/100ft]	Comments
5569.00	16.010	93.000	5385.24	-1342.39	-49.19	1343.52	40°32'31.034"N	104°45'18.072"W	0.68	
5663.00	15.890	96.230	5475.63	-1368.08	-51.27	1369.26	40°32'31.013"N	104°45'17.739"W	0.95	
5758.00	15.760	99.890	5567.03	-1393.65	-54.89	1394.90	40°32'30.978"N	104°45'17.407"W	1.06	
5852.00	15.690	100.320	5657.51	-1418.64	-59.36	1419.98	40°32'30.933"N	104°45'17.082"W	0.14	
5947.00	16.020	100.380	5748.90	-1444.09	-64.03	1445.51	40°32'30.887"N	104°45'16.751"W	0.35	
6041.00	16.050	97.650	5839.24	-1469.64	-68.09	1471.15	40°32'30.847"N	104°45'16.419"W	0.80	
6136.00	15.990	93.150	5930.55	-1495.68	-70.56	1497.23	40°32'30.823"N	104°45'16.081"W	1.31	
6230.00	15.890	92.660	6020.94	-1521.43	-71.87	1523.01	40°32'30.810"N	104°45'15.747"W	0.18	
6325.00	16.330	92.340	6112.21	-1547.74	-73.02	1549.35	40°32'30.798"N	104°45'15.406"W	0.47	
6420.00	16.160	92.760	6203.42	-1574.26	-74.20	1575.90	40°32'30.787"N	104°45'15.062"W	0.22	
6515.00	16.150	93.050	6294.67	-1600.63	-75.54	1602.30	40°32'30.773"N	104°45'14.721"W	0.09	
6609.00	16.230	91.470	6384.94	-1626.79	-76.57	1628.48	40°32'30.763"N	104°45'14.381"W	0.48	
6704.00	16.190	88.070	6476.16	-1653.30	-76.47	1654.99	40°32'30.764"N	104°45'14.038"W	1.00	
6798.00	6.030	54.640	6568.36	-1670.54	-73.16	1672.17	40°32'30.797"N	104°45'13.815"W	12.37	
6893.00	0.990	269.420	6663.20	-1673.85	-70.27	1675.43	40°32'30.825"N	104°45'13.773"W	7.23	
6987.00	11.080	288.370	6756.56	-1664.49	-67.43	1666.02	40°32'30.854"N	104°45'13.895"W	10.80	
7081.00	21.550	281.640	6846.66	-1639.06	-61.08	1640.46	40°32'30.916"N	104°45'14.226"W	11.30	
7176.00	32.030	271.250	6931.39	-1596.73	-57.00	1598.05	40°32'30.957"N	104°45'14.776"W	12.04	
7270.00	40.080	270.520	7007.32	-1541.48	-56.18	1542.78	40°32'30.965"N	104°45'15.491"W	8.58	
7364.00	49.950	272.210	7073.69	-1475.14	-54.51	1476.40	40°32'30.981"N	104°45'16.351"W	10.58	
7458.00	59.160	270.110	7128.15	-1398.71	-53.04	1399.92	40°32'30.996"N	104°45'17.342"W	9.96	
7552.00	68.210	270.340	7169.78	-1314.56	-52.71	1315.75	40°32'30.999"N	104°45'18.432"W	9.63	
7646.00	77.650	271.610	7197.34	-1224.86	-51.15	1226.01	40°32'31.015"N	104°45'19.594"W	10.13	
7740.00	87.010	271.620	7209.87	-1131.90	-48.53	1132.99	40°32'31.041"N	104°45'20.799"W	9.96	
7835.00	90.250	267.600	7212.14	-1036.97	-49.18	1038.05	40°32'31.034"N	104°45'22.029"W	5.43	
7930.00	90.090	267.010	7211.86	-942.01	-53.65	943.16	40°32'30.990"N	104°45'23.258"W	0.64	
8025.00	90.340	263.700	7211.50	-847.21	-61.34	848.48	40°32'30.914"N	104°45'24.484"W	3.49	
8120.00	90.650	264.300	7210.68	-752.57	-71.27	754.01	40°32'30.816"N	104°45'25.708"W	0.71	
8215.00	90.620	265.980	7209.63	-657.79	-79.32	659.36	40°32'30.737"N	104°45'26.934"W	1.77	
8309.00	90.770	267.510	7208.49	-563.86	-84.65	565.52	40°32'30.684"N	104°45'28.149"W	1.64	

Actual Wellpath Report

G & D HANKS S-27-28HN AWP

Page n of nn



REFERENCE WELLPATH IDENTIFICATION

Operator	BAYSWATER E & P LLC	Slot	SLOT#09 G & D HANKS S-27-28HN (1228'FSL & 1575'FEL, SEC.27)
Area	COLORADO	Well	G & D HANKS S-27-28HN
Field	WELD COUNTY (NAD83/TRUE NORTH)	Wellbore	G & D HANKS S-27-28HN AWP
Facility	SEC.27-T07N-R66W		

WELLPATH DATA (195 stations)

MD [ft]	Inclination [°]	Azimuth [°]	TVD [ft]	Vert Sect [ft]	North [ft]	East [ft]	Latitude	Longitude	DLS [°/100ft]	Comments
8403.00	90.550	269.960	7207.41	-469.88	-86.73	471.56	40°32'30.663"N	104°45'29.367"W	2.62	
8497.00	90.520	271.000	7206.53	-375.92	-85.94	377.57	40°32'30.671"N	104°45'30.584"W	1.11	
8592.00	90.550	271.410	7205.64	-281.00	-83.94	282.59	40°32'30.691"N	104°45'31.814"W	0.43	
8687.00	90.340	271.630	7204.91	-186.10	-81.42	187.63	40°32'30.716"N	104°45'33.044"W	0.32	
8781.00	90.830	271.820	7203.95	-92.21	-78.59	93.68	40°32'30.744"N	104°45'34.261"W	0.56	
8876.00	90.460	271.170	7202.88	2.69	-76.11	-1.29	40°32'30.768"N	104°45'35.491"W	0.79	
8970.00	90.400	271.380	7202.17	96.61	-74.02	-95.26	40°32'30.789"N	104°45'36.708"W	0.23	
9065.00	90.580	271.150	7201.36	191.53	-71.93	-190.23	40°32'30.810"N	104°45'37.938"W	0.31	
9160.00	90.250	270.470	7200.67	286.47	-70.58	-285.22	40°32'30.823"N	104°45'39.169"W	0.80	
9254.00	90.180	268.530	7200.32	380.46	-71.40	-379.21	40°32'30.815"N	104°45'40.386"W	2.07	
9348.00	90.310	269.250	7199.92	474.46	-73.22	-473.19	40°32'30.797"N	104°45'41.603"W	0.78	
9443.00	90.280	267.030	7199.43	569.44	-76.31	-568.13	40°32'30.766"N	104°45'42.833"W	2.34	
9538.00	90.890	266.350	7198.46	664.37	-81.79	-662.97	40°32'30.712"N	104°45'44.062"W	0.96	
9633.00	90.800	268.230	7197.05	759.31	-86.28	-757.85	40°32'30.668"N	104°45'45.291"W	1.98	
9727.00	90.920	268.780	7195.64	853.30	-88.73	-851.81	40°32'30.643"N	104°45'46.508"W	0.60	
9822.00	90.920	268.810	7194.12	948.28	-90.73	-946.77	40°32'30.624"N	104°45'47.738"W	0.03	
9916.00	90.770	267.510	7192.73	1042.26	-93.75	-1040.71	40°32'30.594"N	104°45'48.954"W	1.39	
10010.00	90.770	266.290	7191.47	1136.19	-98.83	-1134.56	40°32'30.544"N	104°45'50.170"W	1.30	
10105.00	90.770	266.030	7190.19	1231.07	-105.19	-1229.34	40°32'30.481"N	104°45'51.398"W	0.27	
10199.00	90.890	267.830	7188.83	1325.00	-110.23	-1323.19	40°32'30.431"N	104°45'52.613"W	1.92	
10294.00	90.860	269.480	7187.38	1419.99	-112.46	-1418.15	40°32'30.409"N	104°45'53.843"W	1.74	
10388.00	90.280	270.850	7186.44	1513.96	-112.19	-1512.15	40°32'30.411"N	104°45'55.061"W	1.58	
10482.00	90.430	271.350	7185.86	1607.89	-110.38	-1606.13	40°32'30.429"N	104°45'56.278"W	0.56	
10576.00	90.520	271.350	7185.08	1701.80	-108.17	-1700.10	40°32'30.451"N	104°45'57.495"W	0.10	
10671.00	90.680	270.970	7184.09	1796.73	-106.24	-1795.07	40°32'30.470"N	104°45'58.725"W	0.43	
10766.00	90.580	270.220	7183.04	1891.68	-105.26	-1890.06	40°32'30.480"N	104°45'59.956"W	0.80	
10860.00	90.430	269.940	7182.21	1985.66	-105.13	-1984.06	40°32'30.481"N	104°46'01.173"W	0.34	
10955.00	90.460	270.720	7181.48	2080.63	-104.58	-2079.05	40°32'30.486"N	104°46'02.403"W	0.82	
11049.00	90.120	270.710	7181.00	2174.58	-103.41	-2173.04	40°32'30.498"N	104°46'03.621"W	0.36	
11143.00	90.400	270.190	7180.57	2268.55	-102.67	-2267.04	40°32'30.505"N	104°46'04.838"W	0.63	

Actual Wellpath Report

G & D HANKS S-27-28HN AWP

Page n of nn



REFERENCE WELLPATH IDENTIFICATION

Operator	BAYSWATER E & P LLC	Slot	SLOT#09 G & D HANKS S-27-28HN (1228'FSL & 1575'FEL, SEC.27)
Area	COLORADO	Well	G & D HANKS S-27-28HN
Field	WELD COUNTY (NAD83/TRUE NORTH)	Wellbore	G & D HANKS S-27-28HN AWP
Facility	SEC.27-T07N-R66W		

WELLPATH DATA (195 stations)

MD [ft]	Inclination [°]	Azimuth [°]	TVD [ft]	Vert Sect [ft]	North [ft]	East [ft]	Latitude	Longitude	DLS [°/100ft]	Comments
11238.00	90.520	270.320	7179.81	2363.52	-102.25	-2362.03	40°32'30.509"N	104°46'06.069"W	0.19	
11333.00	90.000	267.930	7179.38	2458.51	-103.70	-2457.02	40°32'30.495"N	104°46'07.299"W	2.57	
11428.00	89.940	267.590	7179.43	2553.49	-107.41	-2551.94	40°32'30.458"N	104°46'08.529"W	0.36	
11523.00	89.780	268.870	7179.66	2648.48	-110.34	-2646.90	40°32'30.429"N	104°46'09.759"W	1.36	
11617.00	89.780	269.060	7180.02	2742.48	-112.04	-2740.88	40°32'30.412"N	104°46'10.976"W	0.20	
11711.00	89.750	268.690	7180.41	2836.48	-113.89	-2834.86	40°32'30.393"N	104°46'12.193"W	0.39	
11806.00	90.000	269.040	7180.62	2931.48	-115.77	-2929.84	40°32'30.375"N	104°46'13.423"W	0.45	
11900.00	90.580	268.430	7180.14	3025.47	-117.84	-3023.82	40°32'30.354"N	104°46'14.641"W	0.90	
11994.00	90.310	268.730	7179.41	3119.47	-120.17	-3117.78	40°32'30.331"N	104°46'15.858"W	0.43	
12089.00	89.970	270.420	7179.18	3214.46	-120.88	-3212.78	40°32'30.324"N	104°46'17.088"W	1.81	
12184.00	89.910	271.080	7179.28	3309.41	-119.63	-3307.77	40°32'30.336"N	104°46'18.319"W	0.70	
12279.00	89.750	271.120	7179.56	3404.34	-117.81	-3402.75	40°32'30.354"N	104°46'19.549"W	0.17	
12373.00	89.880	270.350	7179.86	3498.30	-116.60	-3496.74	40°32'30.366"N	104°46'20.766"W	0.83	
12467.00	89.880	269.420	7180.06	3592.28	-116.79	-3590.74	40°32'30.364"N	104°46'21.984"W	0.99	
12562.00	89.820	269.340	7180.31	3687.28	-117.82	-3685.73	40°32'30.353"N	104°46'23.214"W	0.11	
12657.00	90.310	269.490	7180.20	3782.28	-118.79	-3780.73	40°32'30.344"N	104°46'24.445"W	0.54	
12751.00	90.370	268.920	7179.64	3876.27	-120.10	-3874.72	40°32'30.331"N	104°46'25.662"W	0.61	
12846.00	90.400	269.160	7179.01	3971.27	-121.69	-3969.70	40°32'30.315"N	104°46'26.892"W	0.25	
12940.00	90.400	268.510	7178.35	4065.27	-123.60	-4063.68	40°32'30.296"N	104°46'28.110"W	0.69	
13035.00	90.340	267.890	7177.74	4160.26	-126.58	-4158.63	40°32'30.266"N	104°46'29.339"W	0.66	
13129.00	90.490	268.330	7177.05	4254.24	-129.68	-4252.58	40°32'30.235"N	104°46'30.556"W	0.49	
13223.00	90.400	268.690	7176.32	4348.24	-132.13	-4346.54	40°32'30.211"N	104°46'31.773"W	0.39	
13318.00	90.520	268.680	7175.56	4443.24	-134.31	-4441.51	40°32'30.189"N	104°46'33.003"W	0.13	
13413.00	90.400	269.740	7174.80	4538.23	-135.62	-4536.50	40°32'30.176"N	104°46'34.234"W	1.12	
13507.00	90.490	269.940	7174.07	4632.22	-135.88	-4630.50	40°32'30.173"N	104°46'35.451"W	0.23	
13602.00	90.620	269.950	7173.15	4727.20	-135.97	-4725.49	40°32'30.172"N	104°46'36.682"W	0.14	
13696.00	90.430	269.200	7172.29	4821.19	-136.67	-4819.49	40°32'30.165"N	104°46'37.899"W	0.82	
13791.00	90.370	269.500	7171.62	4916.18	-137.75	-4914.48	40°32'30.154"N	104°46'39.130"W	0.32	
13885.00	90.120	270.190	7171.22	5010.17	-138.00	-5008.48	40°32'30.152"N	104°46'40.347"W	0.78	
13979.00	89.350	270.970	7171.66	5104.13	-137.05	-5102.47	40°32'30.161"N	104°46'41.564"W	1.17	

Actual Wellpath Report

G & D HANKS S-27-28HN AWP

Page n of nn



REFERENCE WELLPATH IDENTIFICATION

Operator	BAYSWATER E & P LLC	Slot	SLOT#09 G & D HANKS S-27-28HN (1228'FSL & 1575'FEL, SEC.27)
Area	COLORADO	Well	G & D HANKS S-27-28HN
Field	WELD COUNTY (NAD83/TRUE NORTH)	Wellbore	G & D HANKS S-27-28HN AWP
Facility	SEC.27-T07N-R66W		

WELLPATH DATA (195 stations)

MD [ft]	Inclination [°]	Azimuth [°]	TVD [ft]	Vert Sect [ft]	North [ft]	East [ft]	Latitude	Longitude	DLS [°/100ft]	Comments
14074.00	89.380	270.590	7172.71	5199.07	-135.75	-5197.45	40°32'30.174"N	104°46'42.795"W	0.40	
14169.00	89.290	270.390	7173.81	5294.03	-134.94	-5292.44	40°32'30.181"N	104°46'44.025"W	0.23	
14264.00	89.380	270.150	7174.92	5389.00	-134.49	-5387.44	40°32'30.186"N	104°46'45.256"W	0.27	
14358.00	89.450	269.290	7175.87	5482.99	-134.95	-5481.43	40°32'30.181"N	104°46'46.473"W	0.92	
14452.00	89.420	269.600	7176.80	5576.98	-135.86	-5575.42	40°32'30.172"N	104°46'47.690"W	0.33	
14548.00	89.290	269.180	7177.88	5672.97	-136.89	-5671.41	40°32'30.161"N	104°46'48.934"W	0.46	
14643.00	89.570	267.700	7178.83	5767.96	-139.47	-5766.37	40°32'30.136"N	104°46'50.164"W	1.59	
14738.00	89.690	267.150	7179.44	5862.92	-143.74	-5861.27	40°32'30.093"N	104°46'51.393"W	0.59	
14833.00	89.480	268.130	7180.13	5957.89	-147.65	-5956.18	40°32'30.054"N	104°46'52.622"W	1.05	
14928.00	89.600	269.390	7180.89	6052.89	-149.71	-6051.16	40°32'30.034"N	104°46'53.852"W	1.33	
15022.00	90.220	269.810	7181.04	6146.88	-150.36	-6145.15	40°32'30.027"N	104°46'55.070"W	0.80	
15117.00	90.280	269.470	7180.63	6241.87	-150.96	-6240.15	40°32'30.021"N	104°46'56.300"W	0.36	
15211.00	90.090	267.960	7180.32	6335.87	-153.07	-6334.12	40°32'30.000"N	104°46'57.518"W	1.62	
15306.00	90.120	267.750	7180.15	6430.85	-156.62	-6429.06	40°32'29.964"N	104°46'58.747"W	0.22	
15401.00	90.030	268.570	7180.02	6525.84	-159.68	-6524.01	40°32'29.934"N	104°46'59.977"W	0.87	
15495.00	90.150	267.970	7179.88	6619.83	-162.51	-6617.96	40°32'29.906"N	104°47'01.194"W	0.65	
15589.00	89.510	268.770	7180.15	6713.83	-165.19	-6711.92	40°32'29.879"N	104°47'02.411"W	1.09	
15684.00	89.570	269.790	7180.92	6808.82	-166.38	-6806.91	40°32'29.867"N	104°47'03.641"W	1.08	
15779.00	89.600	270.190	7181.61	6903.80	-166.40	-6901.91	40°32'29.867"N	104°47'04.872"W	0.42	
15874.00	89.450	268.620	7182.39	6998.79	-167.38	-6996.90	40°32'29.857"N	104°47'06.102"W	1.66	
15968.00	89.450	271.420	7183.30	7092.76	-167.35	-7090.88	40°32'29.857"N	104°47'07.319"W	2.98	
16063.00	89.660	269.290	7184.03	7187.73	-166.76	-7185.87	40°32'29.862"N	104°47'08.550"W	2.25	
16158.00	89.380	268.550	7184.83	7282.72	-168.55	-7280.85	40°32'29.844"N	104°47'09.780"W	0.83	
16252.00	89.540	268.660	7185.71	7376.72	-170.84	-7374.82	40°32'29.821"N	104°47'10.997"W	0.21	
16347.00	89.510	268.920	7186.50	7471.71	-172.85	-7469.80	40°32'29.801"N	104°47'12.227"W	0.28	
16442.00	89.510	270.530	7187.31	7566.70	-173.30	-7564.79	40°32'29.796"N	104°47'13.458"W	1.69	
16536.00	89.420	271.440	7188.19	7660.63	-171.69	-7658.77	40°32'29.812"N	104°47'14.675"W	0.97	
16631.00	89.540	272.930	7189.05	7755.47	-168.07	-7753.69	40°32'29.848"N	104°47'15.905"W	1.57	
16725.00	89.350	272.010	7189.97	7849.29	-164.01	-7847.60	40°32'29.887"N	104°47'17.121"W	1.00	
16820.00	90.370	269.780	7190.20	7944.23	-162.53	-7942.58	40°32'29.902"N	104°47'18.351"W	2.58	

Actual Wellpath Report

G & D HANKS S-27-28HN AWP

Page n of nn



REFERENCE WELLPATH IDENTIFICATION

Operator	BAYSWATER E & P LLC	Slot	SLOT#09 G & D HANKS S-27-28HN (1228'FSL & 1575'FEL,SEC.27)
Area	COLORADO	Well	G & D HANKS S-27-28HN
Field	WELD COUNTY (NAD83/TRUE NORTH)	Wellbore	G & D HANKS S-27-28HN AWB
Facility	SEC.27-T07N-R66W		

WELLPATH DATA (195 stations)

MD [ft]	Inclination [°]	Azimuth [°]	TVD [ft]	Vert Sect [ft]	North [ft]	East [ft]	Latitude	Longitude	DLS °/100ft	Comments
16915.00	90.000	266.320	7189.89	8039.20	-165.76	-8037.51	40°32'29.869"N	104°47'19.581"W	3.66	
17010.00	90.180	267.240	7189.74	8134.13	-171.10	-8132.36	40°32'29.816"N	104°47'20.809"W	0.99	
17105.00	90.250	268.520	7189.39	8229.11	-174.61	-8227.29	40°32'29.781"N	104°47'22.039"W	1.35	
17199.00	90.090	268.390	7189.11	8323.11	-177.15	-8321.26	40°32'29.756"N	104°47'23.256"W	0.22	
17294.00	89.940	269.460	7189.08	8418.11	-178.93	-8416.24	40°32'29.738"N	104°47'24.486"W	1.14	
17388.00	89.850	271.750	7189.25	8512.06	-177.94	-8510.23	40°32'29.748"N	104°47'25.704"W	2.44	
17483.00	89.820	271.670	7189.53	8606.95	-175.10	-8605.19	40°32'29.775"N	104°47'26.933"W	0.09	
17578.00	89.940	271.150	7189.73	8701.86	-172.76	-8700.16	40°32'29.798"N	104°47'28.164"W	0.56	
17672.00	89.910	269.960	7189.85	8795.82	-171.85	-8794.15	40°32'29.807"N	104°47'29.381"W	1.27	
17767.00	89.780	270.150	7190.11	8890.81	-171.76	-8889.15	40°32'29.807"N	104°47'30.612"W	0.24	
17862.00	89.970	270.020	7190.31	8985.79	-171.62	-8984.15	40°32'29.808"N	104°47'31.842"W	0.24	
17956.00	89.630	269.800	7190.64	9079.77	-171.77	-9078.15	40°32'29.807"N	104°47'33.060"W	0.43	
18051.00	90.000	271.060	7190.95	9174.74	-171.06	-9173.14	40°32'29.813"N	104°47'34.290"W	1.38	
18098.00	90.030	270.250	7190.94	9221.72	-170.52	-9220.14	40°32'29.818"N	104°47'34.899"W	1.72	LAST BHGE SURVEY (1157'FSL & 30'FWL,SEC.28)
18123.00	90.030	270.250	7190.92	9246.71	-170.41	-9245.14	40°32'29.819"N	104°47'35.223"W	0.00	PTB (1158'FSL & 5'FWL,SEC.28)

HOLE & CASING SECTIONS - Ref Wellbore: G & D HANKS S-27-28HN AWB Ref Wellpath: G & D HANKS S-27-28HN AWP

String/Diameter	Start MD [ft]	End MD [ft]	Interval [ft]	Start TVD [ft]	End TVD [ft]	Start N/S [ft]	Start E/W [ft]	End N/S [ft]	End E/W [ft]
13.5in Open Hole	25.00	1556.00	1531.00	25.00	1529.26	0.00	0.00	-5.66	235.66
9.625in Casing Surface	25.00	1556.00	1531.00	25.00	1529.26	0.00	0.00	-5.66	235.66
8.5in Open Hole	1556.00	18123.00	16567.00	1529.26	7190.92	-5.66	235.66	-170.41	-9245.14

Actual Wellpath Report

G & D HANKS S-27-28HN AWP

Page n of nn



REFERENCE WELLPATH IDENTIFICATION

Operator	BAYSWATER E & P LLC	Slot	SLOT#09 G & D HANKS S-27-28HN (1228'FSL & 1575'FEL, SEC.27)
Area	COLORADO	Well	G & D HANKS S-27-28HN
Field	WELD COUNTY (NAD83/TRUE NORTH)	Wellbore	G & D HANKS S-27-28HN AWB
Facility	SEC.27-T07N-R66W		

TARGETS

Name	TVD [ft]	North [ft]	East [ft]	Grid East [US ft]	Grid North [US ft]	Latitude	Longitude	Shape
G & D HANKS S-27-28HN WP1 (-2265'SS @ 6100'FLP)	7166.00	-131.89	-4995.01	3200710.30	1441008.74	40°32'30.212"N	104°46'40.173"W	point
G & D HANKS S-27-28HN BHL REV-1 (1150'FSL & 5'FWL, SEC.28)	7166.00	-178.65	-9245.33	3196460.66	1440926.51	40°32'29.738"N	104°47'35.225"W	point
G & D HANKS S-27-28HN LP REV-1 (1150'FSL & 470'FEL, SEC.27)	7211.00	-64.78	1104.83	3206809.18	1441126.75	40°32'30.880"N	104°45'21.164"W	point
G & D HANKS S-27-28HN LP PLAT (1150'FSL & 470'FEL, SEC.27)	7213.00	-64.78	1104.83	3206809.18	1441126.75	40°32'30.880"N	104°45'21.164"W	point
G & D HANKS S-27-28HN BHL PLAT (1150'FSL & 5'FWL, SEC.28)	7336.00	-178.60	-9245.32	3196460.68	1440926.55	40°32'29.738"N	104°47'35.225"W	point
SEC.27,28-T07N-R66W HDL (460'FEL & 5'FWL)	9999.00	0.00	0.00	3205703.88	1441182.31	40°32'31.520"N	104°45'35.474"W	polygon
SEC.27-T07N-R66W	9999.00	0.00	0.00	3205703.88	1441182.31	40°32'31.520"N	104°45'35.474"W	polygon
SEC.28-T07N-R66W*	9999.00	0.00	0.00	3205703.88	1441182.31	40°32'31.520"N	104°45'35.474"W	polygon

WELLPATH COMPOSITION - Ref Wellbore: G & D HANKS S-27-28HN AWB Ref Wellpath: G & D HANKS S-27-28HN AWP

Start MD [ft]	End MD [ft]	Positional Uncertainty Model	Log Name/Comment	Wellbore
25.00	1510.00	BHI NaviTrak (Standard)	13.5" Surface NaviTrak (Standard) <137-1510>	G & D HANKS S-27-28HN AWB
1510.00	18098.00	BHI AutoTrak Curve (Short)	8.5" Monobore BHI AutoTrak Curve (Short) <1595-18098>	G & D HANKS S-27-28HN AWB
18098.00	18123.00	Blind Drilling (std)	Projection to bit	G & D HANKS S-27-28HN AWB