

K:\SHERIDAN\RESOURCES\2018\01\21.MCNEAR.T6N.R66W_SEC.9\DWG\SCIPERSEDED\INTERIM_20180717\FACILITY UPDATE\MCNEAR.dwg, 7/24/2018 11:16:59 AM, shen



NOTES:

1. EQUIPMENT PLACEMENT IS APPROXIMATE AND SUBJECT TO MINOR MODIFICATION DUE TO SPECIFIC CIRCUMSTANCES.

DATA SOURCES:
- AERIAL COURTESY OF ESRI, INC.



LOVELAND OFFICE
1635 Foxtrail Drive, Suite 204
Loveland, Colorado 80538
Phone 970-776-4331

SHERIDAN OFFICE
1095 Saberton Avenue
Sheridan, Wyoming 82801
Phone 307-674-0609



SRC ENERGY
1675 Broadway, Suite 2600
Denver, Colorado 80202

SCALE:
DATE SURVEYED:
DATE:
DRAFTER:
REVISED:

1" = 200'
3/14/18
3/21/18
CDJ
7/24/18

FACILITY LOCATION DRAWING (A)
MCNEAR 10-9 PAD
LOCATED IN SECTION 9, T6N, R66W, 6TH P.M.
WELD COUNTY, COLORADO

K:\SYSTEM RESOURCES\2018_21_MCNEAR_T6N_R66W_SEC_9D\GIS\MCDRAW.dwg, 3/20/2018 11:21:13 PM, Steven

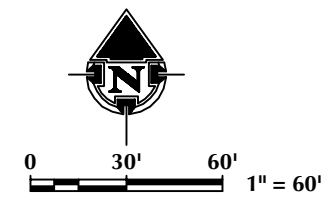
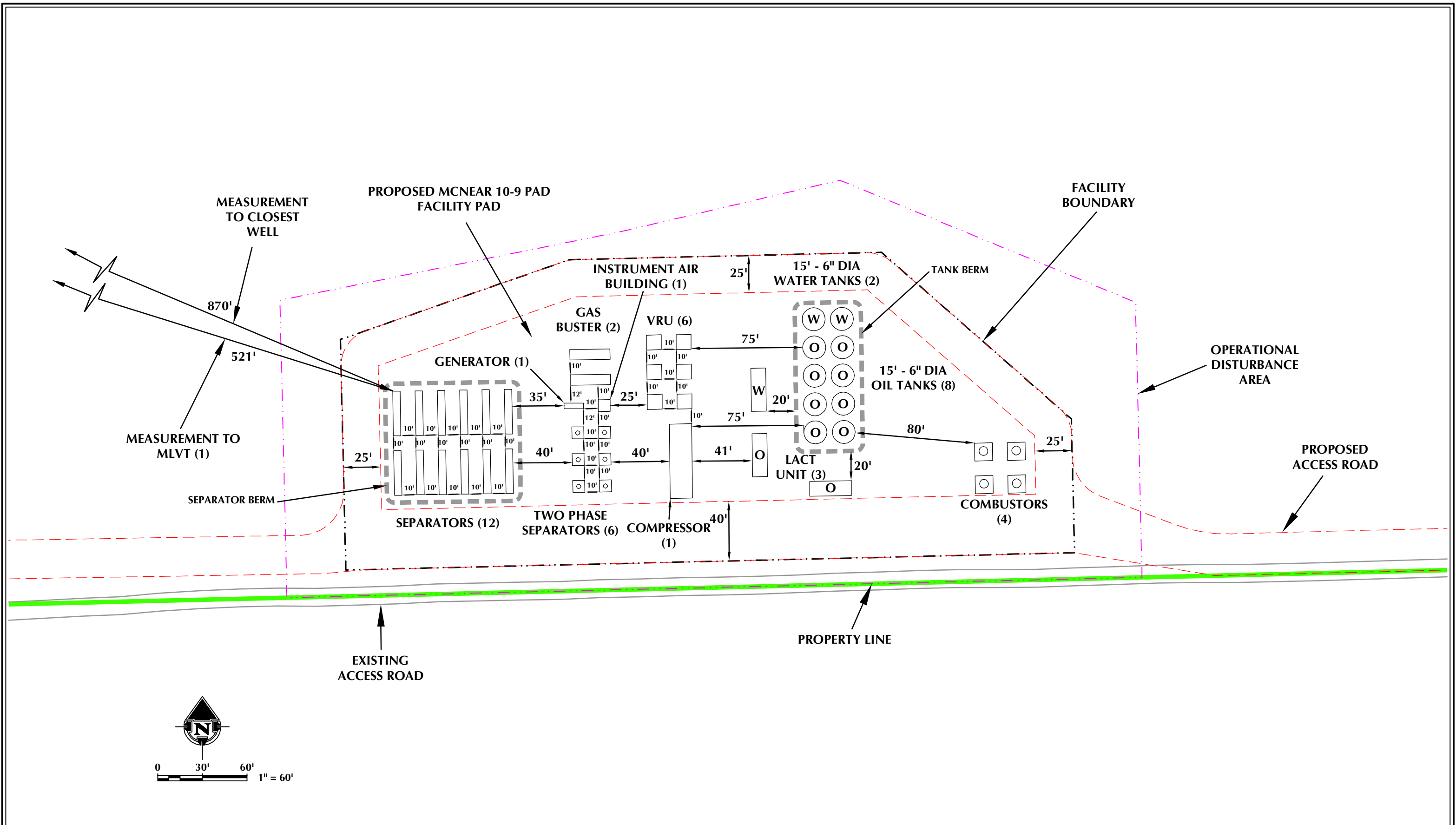

<p>NOTES:</p> <p>1. EQUIPMENT PLACEMENT IS APPROXIMATE AND SUBJECT TO MINOR MODIFICATION DUE TO SPECIFIC CIRCUMSTANCES.</p>		<p>609 CONSULTING, LLC</p> <p>LOVELAND OFFICE 1635 Foxtrail Drive, Suite 204 Loveland, Colorado 80538 Phone 970-776-4331</p> <p>SHERIDAN OFFICE 1095 Saberton Avenue Sheridan, Wyoming 82801 Phone 307-674-0609</p>	<p>SRC ENERGY</p> <p>1675 Broadway, Suite 2600 Denver, Colorado 80202</p>	<p>SCALE: 1" = 60'</p> <p>DATE SURVEYED: 3/14/18</p> <p>DATE: 3/21/18</p> <p>DRAFTER: CDJ</p> <p>REVISED:</p>	<p>FACILITY LOCATION DRAWING (B)</p> <p>MCNEAR 10-9 PAD</p> <p>LOCATED IN SECTION 9, T6N, R66W, 6TH P.M.</p> <p>WELD COUNTY, COLORADO</p>
------------------------------------------------------------------------------------------------------------------------------------	--	----------------------------------------------------------------------------------------------------------------------------------------------------------------------------------------------------------------------------------------------------	--------------------------------------------------------------------------------------	---------------------------------------------------------------------------------------------------------------	--------------------------------------------------------------------------------------------------------------------------------------------------

FACILITY LOCATION DRAWING (C)
MCNEAR 10-9 PAD
PRODUCTION FACILITY & MISC. EQUIPMENT

# MLVTs	1
# VRUs	6
# Compressors	1
# LACT Units	3
# Combustors	4
# Gas Busters	2
# Oil Tanks	8
# Water Tanks	2
# Generators	1
# Single Separators	12
# Two Phase Separators	6
# Instrument Buildings	1
# Gas Lift Skids	1
* No existing facility equipment within disturbance area *	

WELLS

Proposed:
MCNEAR 25C-7-L, MCNEAR 25N-7A-L, MCNEAR 7N-7C-L,
MCNEAR 7N-7B-L, MCNEAR 7C-7-L, MCNEAR 21N-7A-L,
MCNEAR 21N-7C-L, MCNEAR 2C-7-L, MCNEAR 2N-7C-L,
MCNEAR 2N-7A-L, MCNEAR 28C-7-L & MCNEAR 28N-7B-L

* No existing wells within disturbance area *