

T11N

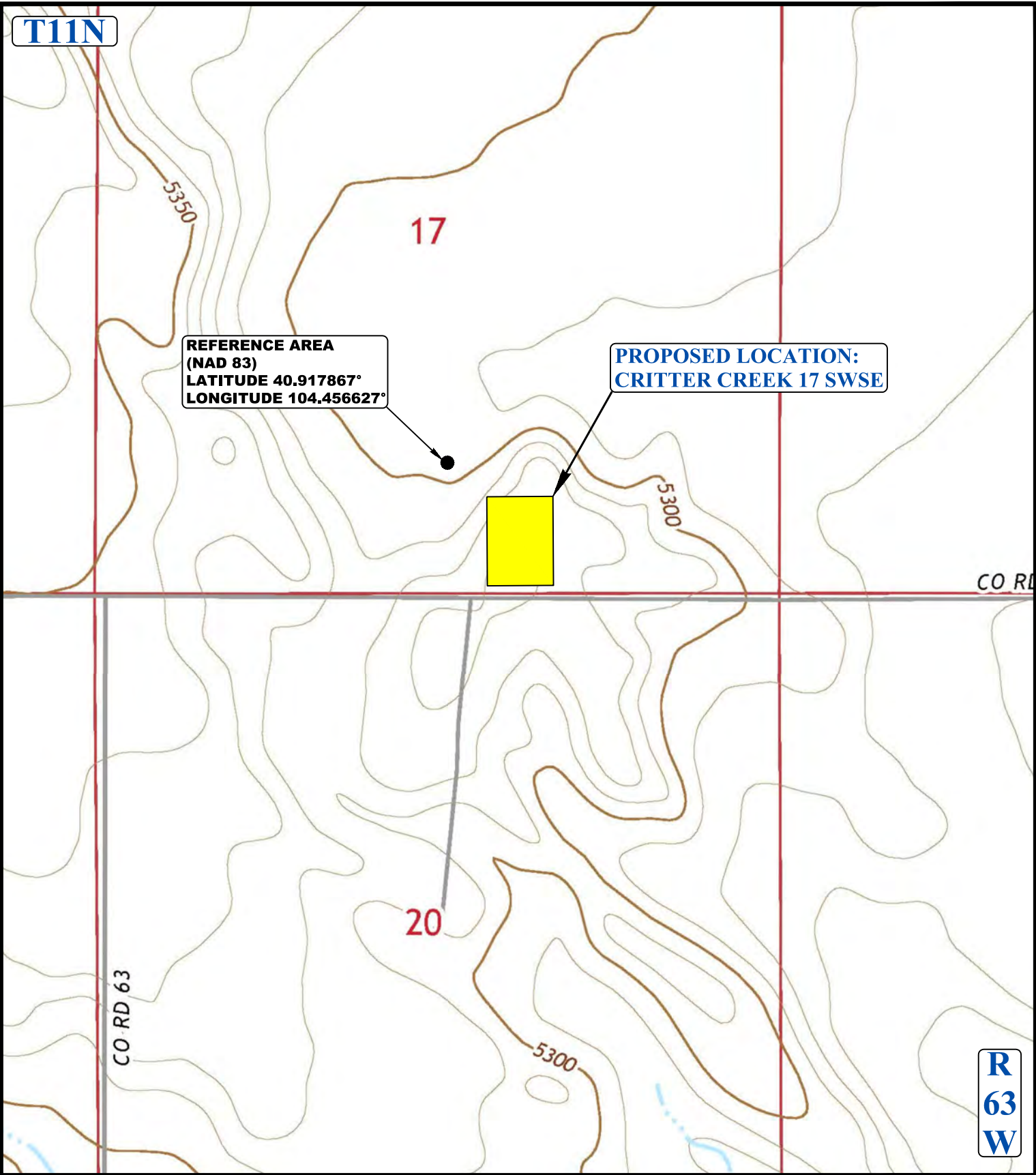

REFERENCE AREA
 (NAD 83)
 LATITUDE 40.917867°
 LONGITUDE 104.456627°

PROPOSED LOCATION:
CRITTER CREEK 17 SWSE

CO RD

CO RD 63

**R
63
W**



HIGHPOINT OPERATING CORPORATION

CRITTER CREEK 17 SWSE PAD
 SW 1/4 SE 1/4, SECTION 17, T11N, R63W, 6th P.M.
 WELD COUNTY, COLORADO

SURVEYED BY	J.F., N.W.	07-03-18	SCALE
DRAWN BY	C.C.	07-05-18	1 : 12,000

REFERENCE AREA MAP **REF TOPO**



UELS, LLC
 Corporate Office * 85 South 200 East
 Vernal, UT 84078 * (435) 789-1017