

LINE TABLE			
LINE	DIRECTION	LENGTH	FEATURE
L1	SOUTH	395'	FENCE
L2	SOUTH	397'	FIBER OPTIC LINE
L3	SOUTH	422'	EXISTING ROAD
L4	SOUTH	457'	SECTION LINE
L5	SOUTH	459'	FENCE
L6	N53°W	598'	POWER LINE

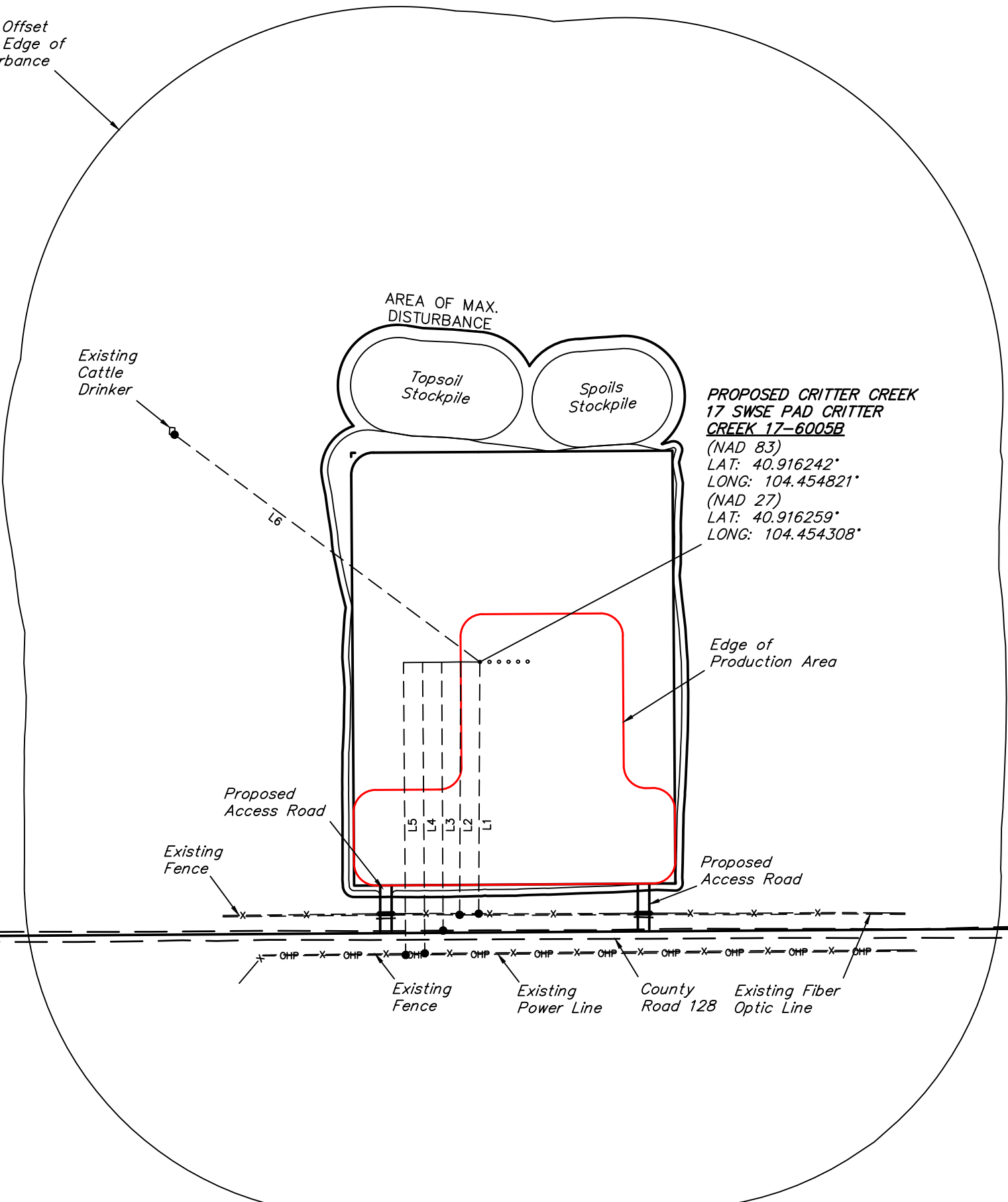

500' Offset from Edge of Disturbance



**PROPOSED CRITTER CREEK
17 SWSE PAD CRITTER
CREEK 17-6005B**
(NAD 83)
LAT: 40.916242°
LONG: 104.454821°
(NAD 27)
LAT: 40.916259°
LONG: 104.454308°

Section 17.
Section 20

PLANT COMMUNITY	
<input type="checkbox"/>	DISTURBED GRASSLAND
<input checked="" type="checkbox"/>	NATIVE GRASSLAND
<input type="checkbox"/>	SHRUB LAND
<input type="checkbox"/>	PLAINS RIPARIAN
<input type="checkbox"/>	MOUNTAIN RIPARIAN
<input type="checkbox"/>	FOREST LAND
<input type="checkbox"/>	WETLANDS AQUATIC
<input type="checkbox"/>	ALPINE
<input type="checkbox"/>	OTHER (Describe): _____

CURRENT LAND USE					
CROP LAND:	<input type="checkbox"/> IRRIGATED	<input type="checkbox"/> DRY LAND	<input type="checkbox"/> IMPROVED PASTURE	<input type="checkbox"/> HAY MEADOW	<input type="checkbox"/> CRP
NON-CROP LAND:	<input checked="" type="checkbox"/> RANGELAND	<input type="checkbox"/> TIMBER	<input type="checkbox"/> RECREATIONAL	<input type="checkbox"/> OTHER (Describe) _____	
SUBDIVIDED:	<input type="checkbox"/> INDUSTRIAL	<input type="checkbox"/> COMMERCIAL	<input type="checkbox"/> RESIDENTIAL	_____	

FUTURE LAND USE					
CROP LAND:	<input type="checkbox"/> IRRIGATED	<input type="checkbox"/> DRY LAND	<input type="checkbox"/> IMPROVED PASTURE	<input type="checkbox"/> HAY MEADOW	<input type="checkbox"/> CRP
NON-CROP LAND:	<input checked="" type="checkbox"/> RANGELAND	<input type="checkbox"/> TIMBER	<input type="checkbox"/> RECREATIONAL	<input type="checkbox"/> OTHER (Describe) _____	
SUBDIVIDED:	<input type="checkbox"/> INDUSTRIAL	<input type="checkbox"/> COMMERCIAL	<input type="checkbox"/> RESIDENTIAL	_____	

NOTES:

HIGHPOINT OPERATING CORPORATION

**CRITTER CREEK 17 SWSE PAD
SW 1/4 SE 1/4, SECTION 17, T11N, R63W, 6th P.M.
WELD COUNTY, COLORADO**



UELS, LLC
Corporate Office * 85 South 200 East
Vernal, UT 84078 * (435) 789-1017

SURVEYED BY	JAMES FRESHWATER, N.W.	07-03-18	SCALE
DRAWN BY	C.C.	07-05-18	1" = 200'
LOCATION DRAWING		FIGURE #5	