



July 5, 2018

Ms. Julie Murphy, Director
Colorado Oil and Gas Conservation Commission
1120 Lincoln Street, Suite 801
Denver, Colorado 80203

RE: COGCC Rule 318A.e.: Proposed Spacing Unit
Lochbuie Land 25H-D166 Pad: NWNW Section 25, Township 1 North, Range 66 West
Proposed Wells: [Lochbuie Land 2A-25H-D166, 401673105; Lochbuie Land 2B-25H-D166,
401673107, Lochbuie Land 2C-25H-D166, 401673111]
Weld County, Colorado

Dear Director Murphy:

Crestone Peak Resources Operating LLC (CPR) is planning to drill the above referenced well in accordance with the provisions of COGCC Rule 318A.e(6), CPR's proposed spacing unit configuration consists of:

Township 1 North, Range 66 West
S2S2 of Section 24
N2N2 of Section 25

Containing 320 acres, more or less, for the Niobrara and Codell formations

CPR is not the only owner within the proposed spacing unit, and as such provided notice to the remaining owner(s) within said proposed spacing unit as required under COGCC Rule 318A.e(6). The required thirty (30) day notice period has elapsed absent the receipt by CPR of an objection to said proposal by the owner(s) within the Proposed Spacing Unit for the subject well.

Enclosed is a copy of the map illustrating the proposed wellbore spacing unit to assist you in your review of the proposed Application for Permit to Drill for the **Lochbuie Land** Well(s).

Crestone Peak Resources respectfully requests that the COGCC review the enclosed information and approve the Application for Permit to Drill the captioned well(s). Many thanks for your time and attention to this matter.

Respectfully,

Meghan Campbell
Regulatory Analyst

Enclosure: Proposed Spacing Unit Exhibit

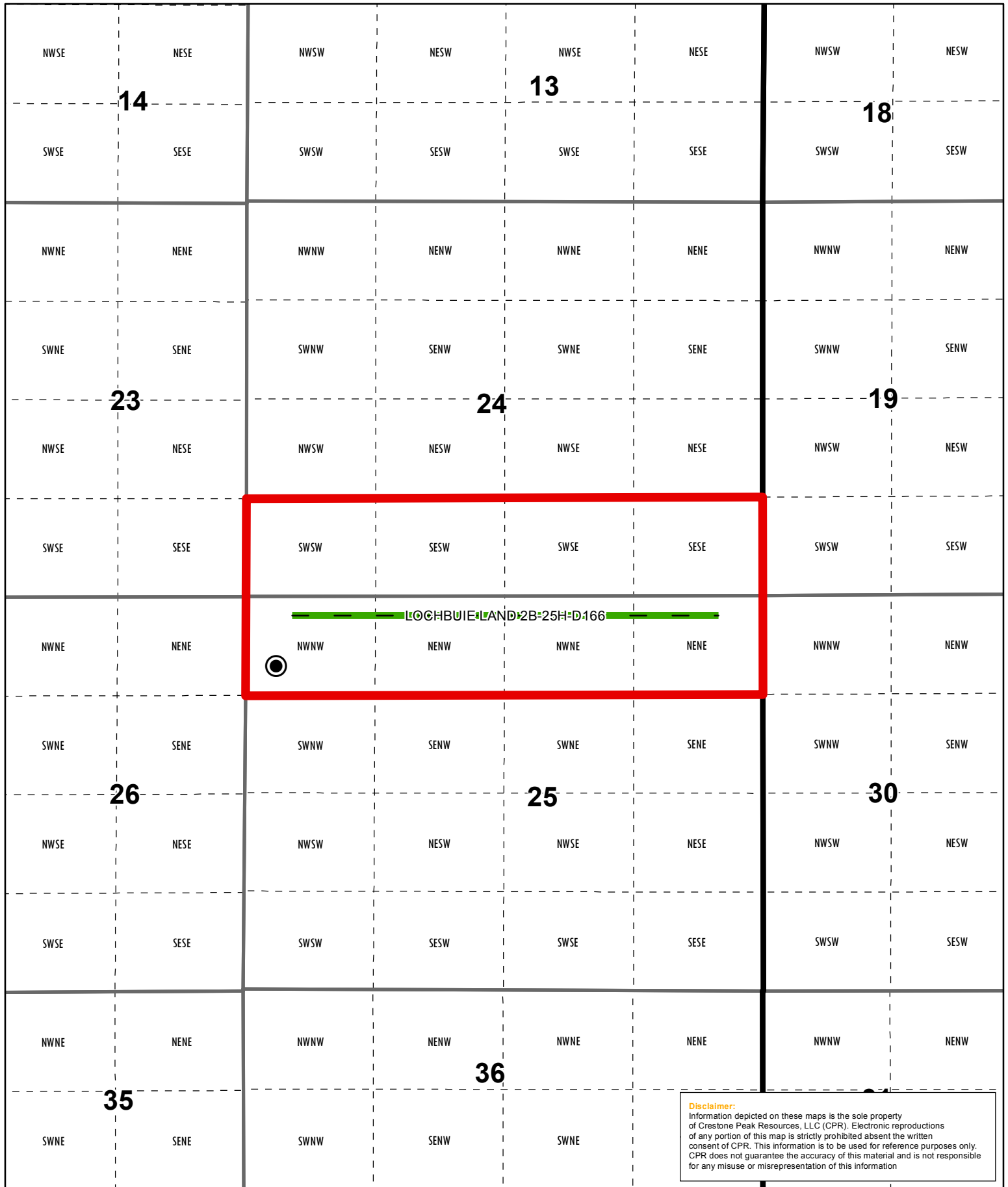

Disclaimer:
 Information depicted on these maps is the sole property of Crestone Peak Resources, LLC (CPR). Electronic reproductions of any portion of this map is strictly prohibited absent the written consent of CPR. This information is to be used for reference purposes only. CPR does not guarantee the accuracy of this material and is not responsible for any misuse or misrepresentation of this information.

- Section QQ
- Crestone Well
- CO Township
- CO Section
- Preliminary Proposed Spacing Unit
- Spaced Wellbore

Proposed Spacing Unit LOCHBUIE LAND 2B-25H-D166

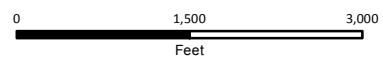

5/31/2018
 ©Crestone Peak Resources GIS
 Created by Julie Long

Coordinate System: GCS North American 1983