

**RECEIVED**  
**STATE OF COLORADO**  
**OIL AND GAS CONSERVATION COMMISSION**  
**DEPARTMENT OF NATURAL RESOURCES**  
 SUBMIT ORIGINAL AND 1 COPY

FOR OFFICE USE			
ET	FE	UC	SE

**SUNDRY NOTICES AND REPORTS ON WELLS**

(Do not use this form for proposals to drill or to deepen of plug back to a different reservoir.  
 Use "APPLICATION FOR PERMIT-" for such proposals.)

1. <input checked="" type="checkbox"/> OIL WELL <input type="checkbox"/> GAS WELL <input type="checkbox"/> COALBED METHANE <input type="checkbox"/> INJECTION WELL <input type="checkbox"/> OTHER		5. FEDERAL/INDIAN OR STATE LEASE NO.
2. NAME OF OPERATOR <b>Gerrity Oil &amp; Gas Corporation</b>		6. PERMIT NO. <b>92-654</b>
3. ADDRESS OF OPERATOR <b>4100 E. Mississippi Ave., #1200</b>		7. API NO. <b>05-123-15848</b>
CITY STATE ZIP CODE <b>Denver CO 80222</b>		8. WELL NAME <b>Bohlender</b>
4. LOCATION OF WELL (Report location clearly and in accordance with any State requirements. See also space 14 below.) At surface <b>1658' FNL and 990' FWL Sec. 20</b> At proposed production zone <b>same</b>		9. WELL NUMBER <b>D #20-2J</b>
12. COUNTY <b>Weld</b>		10. FIELD OR WILDCAT <b>Wattenberg</b>
		11. QTR. QTR. SEC., T.R. AND MERIDIAN <b>SWNW Sec. 20-T3N-R64W</b>

Check Appropriate Box To Indicate Nature of Notice, Report or Notification

<b>13A. NOTICE OF INTENTION TO:</b> <input type="checkbox"/> PLUG AND ABANDON <input type="checkbox"/> MULTIPLE COMPLETION <input checked="" type="checkbox"/> COMMINGLE ZONES <input checked="" type="checkbox"/> FRACTURE TREAT <input type="checkbox"/> REPAIR WELL <input type="checkbox"/> OTHER:	<b>13B. SUBSEQUENT REPORT OF:</b> <input type="checkbox"/> FINAL PLUG AND ABANDONMENT SUBMIT 3RD PARTY CEMENT VERIFICATION AND JOB LOG) <input type="checkbox"/> ABANDONED LOCATION (WELL NEVER DRILLED - SITE MUST BE RESTORED WITHIN 6 MONTHS) <input type="checkbox"/> REPAIRED WELL <input type="checkbox"/> OTHER: *Use Form 5 - Well Completion or Recompletion Report and Log for subsequent report of Multiple/Commingle Completions and Recompletions	<b>13C. NOTIFICATION OF:</b> <input type="checkbox"/> SHUT-IN/TEMPORARILY ABANDONES DATE: (REQUIRED EVERY 6 MONTHS) <input type="checkbox"/> PRODUCTION RESUMED DATE: <input type="checkbox"/> LOCATION CHANGE (SUBMIT NEW PLAT) <input type="checkbox"/> WELL NAME CHANGE <input type="checkbox"/> OTHER:
--	--	--

14. DESCRIBE PROPOSED OR COMPLETED OPERATIONS ON THIS FORM (Clearly state all pertinent details, and give pertinent dates, including estimated date of starting any proposed work. If well is directionally drilled, give subsurface locations and measured and true vertical depths for all markers and zones pertinent)

15. DATE OF WORK

This well is currently producing from the Codell formation. Gerrity Oil & Gas plans to recomplete the well in the Sussex formation and after adequate testing, will commingle production from both zones.

The Codell will be isolated with a sand plug approx. 150' above the top Codell perforation. The Sussex will be perforated from 4370'-4410' OA and frac'd with approx. 70,000 gals. Gel with 244,000# sand. After testing the sand plug will be removed and production from both zones will be commingled. We plan to begin this work within the next thirty (30) days.

16. I hereby certify that the foregoing is true and correct

SIGNED

*Clayton L. Miller*

PHONE NO. ( 303 ) 757-1110

NAME (PRINT) **Clayton L. Miller**

TITLE **Production Manager**

DATE **03/03/93**

(This space for Federal or State office use)

APPROVED

**Sr. Petroleum Engineer**  
 TITLE **O & G Conservation Commission**

DATE **SEP 2 1993**

CONDITIONS OF APPROVAL, IF ANY:



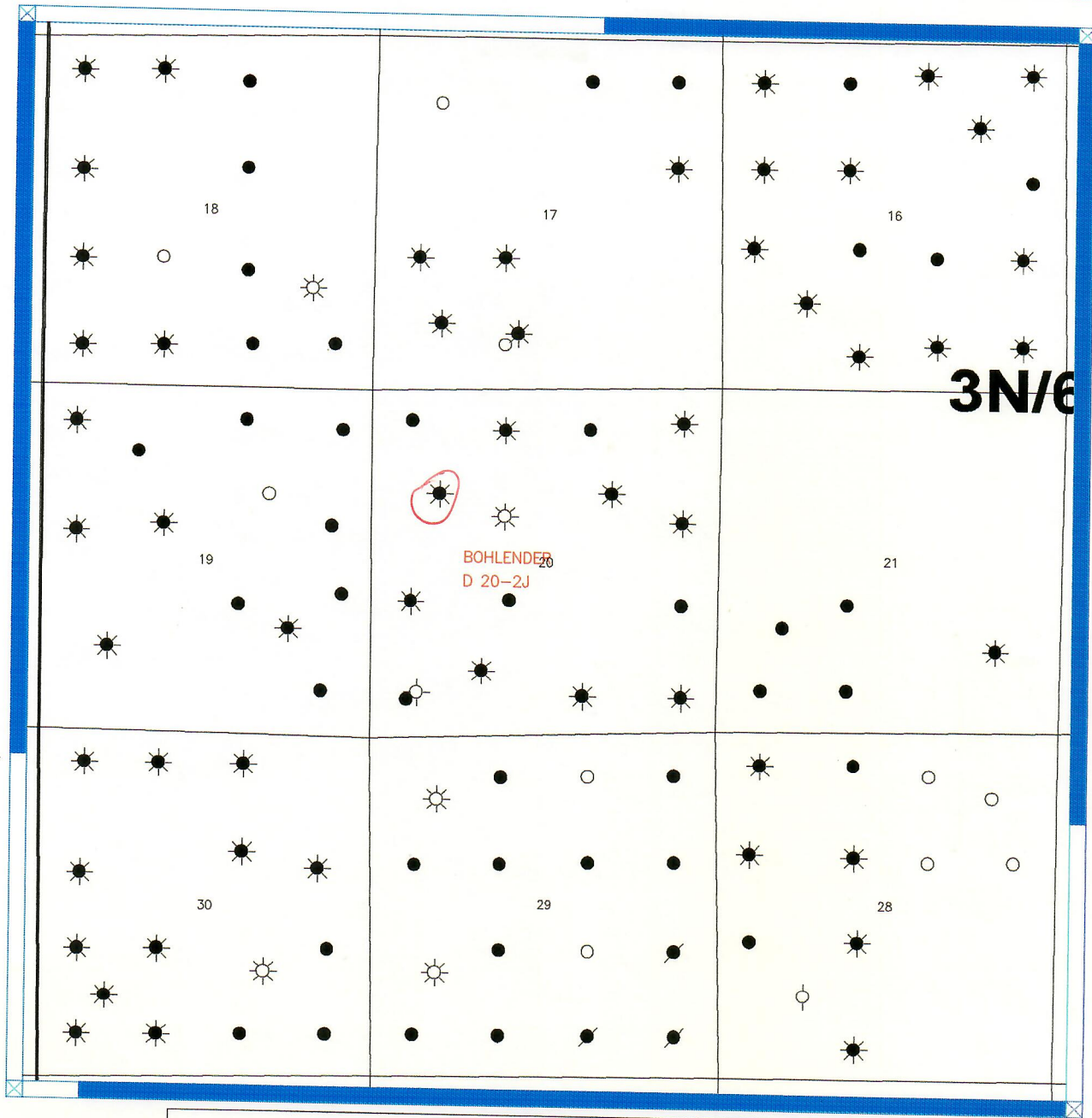

Gerrity Oil & Gas Corporation

DJ  
BOHLENDER D 20-2J  
SEC. 20 - TOWNSHIP 3 NORTH - RANGE 64 W

PAULA PORTER

2/1/94





STATE OF COLORADO  
OIL AND GAS CONSERVATION COMMISSION  
DEPARTMENT OF NATURAL RESOURCES

**CERTIFICATION OF CLEARANCE AND/OR CHANGE OF OPERATOR**  
(Please submit original and 3 copies per well)

FOR OFFICE USE ONLY  
ETI FEI UC

OGCC LEASE NO <b>63571</b>	LEASE NAME <b>Bohlender D</b>	WELL NO <b>#20-2J</b>	API NO. <b>05-123-15848</b>
FIELD NAME & NO <b>Wattenberg 90750</b>	COUNTY <b>Weld</b>	LOCATION ( . . . SEC. TWP. ANG) <b>SWNW Sec. 20 T3N-R64W</b>	
OPERATOR NAME <b>Gerrity Oil &amp; Gas Corporation</b>		OGCC OPR. NO <b>33870</b>	AREA CODE PHONE NUMBER <b>(303 ) 757-1110</b>
OPERATOR ADDRESS <b>4100 E. Mississippi Ave., #1200</b>		** PREVIOUS OPERATOR	
CITY <b>Denver</b>	STATE <b>CO</b>	ZIP CODE <b>80222</b>	EFFECTIVE DATE OF CHANGE
			NEW OPERATOR BOND STATUS <input type="checkbox"/> BLANKET <input type="checkbox"/> SINGLE <input type="checkbox"/> RIDER

\*Complete only if this well is part of a previously producing lease.  
\*\*Complete only if change of operator or change of company name.

<b>PRODUCING FORMATION(S)</b> (A separate FORM 10 must be submitted for each producing formation of a Multiple Completion.)	
<b>Codell</b>	
CURRENT WELL STATUS <b>Producing</b>	DATE SHUT IN OR PRODUCTION RESUMED

<b>TYPE OF COMPLETION</b> (More than one may apply)	
<input checked="" type="checkbox"/> NEW COMPLETION	<input type="checkbox"/> COMMINGLED COMPLETION
<input type="checkbox"/> RECOMPLETION	<input type="checkbox"/> MULTIPLE COMPLETION
New Well Test Data on 24 hr. Basis: Test Date <b>8/23/92</b>	
<b>30</b> Bbls. Oil	<b>323</b> Mcf Gas <b>3</b> Bbls. Wtr

<b>OIL TRANSPORTER (First Purchaser)</b>			
NAME <b>Total Petroleum Company</b>		OGCC NO. <b>89000</b>	
ADDRESS <b>P. O. Box 500</b>			
CITY <b>Denver</b>	STATE <b>CO</b>	ZIP CODE <b>80201</b>	
AREA CODE PHONE NUMBER <b>(303 ) 291-2301</b>	DATE OF FIRST PRODUCTION <b>8/20/92</b>		

<b>GAS GATHERER (First Purchaser)</b>			
NAME <b>Assoc. Natural Gas, Inc.</b>		OGCC NO. <b>04680</b>	
ADDRESS <b>370 Seventeenth St., #900</b>			
CITY <b>Denver</b>	STATE <b>CO</b>	ZIP CODE <b>80202</b>	
AREA CODE PHONE NUMBER <b>(303 ) 595-3331</b>	DATE OF FIRST SALES <b>8/20/92</b>		

<b>ROYALTY OWNER</b>			
<input type="checkbox"/> STATE		<input type="checkbox"/> FEDERAL	
<input type="checkbox"/> INDIAN		<input checked="" type="checkbox"/> FEE	
State, Federal or Indian Lease # _____			
TOTAL ACRES IN LEASE <b>160</b>	ACRES ASSIGNED TO WELL <b>320</b>	<input type="checkbox"/> Standup <input checked="" type="checkbox"/> Laydown	

<b>METHOD OF WATER DISPOSAL</b>			
FACILITY NUMBER _____			
<input type="checkbox"/> CENTRAL PIT		<input type="checkbox"/> COMMERCIAL PIT	
<input checked="" type="checkbox"/> ON-SITE PIT		<input type="checkbox"/> INJECTION WELL	
<input type="checkbox"/> N/A			

Remarks: This well produces into the same tank battery as the following: #20-2J (same)

The undersigned certifies that the rules and regulations of the Oil and Gas Conservation Commission of the State of Colorado have been complied with except as noted above and that the transporter(s) is (are) authorized to transport the oil and/or gas produced from the above described well and that this authorization will be valid until further notice to the transporter named herein or until cancelled by the Colorado Oil and Gas Conservation Commission.

NAME (PRINT) Paula K. Porter TITLE Drilling Technician DATE 1/20/93

SIGNED Paula K Porter

(THIS SPACE FOR STATE OFFICE USE ONLY)

APPROVED BY

Susan McCannan

TITLE

**DIRECTOR**  
O & G Cons. Comm.

DATE **AUG 12 1993**

RECEIVED  
OIL & GAS CON. COMM.



STATE OF COLORADO  
OIL AND GAS CONSERVATION COMMISSION  
DEPARTMENT OF NATURAL RESOURCES

CERTIFICATION OF CLEARANCE AND/OR CHANGE OF OPERATOR

(Please submit original and 3 copies per well)

OGCC LEASE NO <b>63571</b>		LEASE NAME <b>Bohlender D</b>		WELL NO <b>#20-2J</b>	API NO. <b>05-123-15848</b>
FIELD NAME & NO <b>Wattenberg 90750</b>		COUNTY <b>Weld</b>	LOCATION (T. R. SEC. TWP. RANG.) <b>S4NW Sec. 20 T3N-R64W</b>		
OPERATOR NAME <b>Gerrity Oil &amp; Gas Corporation</b>			OGCC OPR NO <b>33870</b>	AREA CODE <b>(303)</b>	PHONE NUMBER <b>757-1110</b>
OPERATOR ADDRESS <b>4100 E. Mississippi Ave., #1200</b>			** PREVIOUS OPERATOR		
CITY <b>Denver</b>	STATE <b>CO</b>	ZIP CODE <b>80222</b>	EFFECTIVE DATE OF CHANGE	NEW OPERATOR BOND STATUS <input type="checkbox"/> BLANKET <input type="checkbox"/> SINGLE <input type="checkbox"/> RIDER	

\* Complete only if this well is part of a previously producing lease.  
\*\* Complete only if change of operator or change of company name.

PRODUCING FORMATION(S) (A separate FORM 10 must be submitted for each producing formation of a Multiple Completion.) <b>Codell</b>	
CURRENT WELL STATUS <b>Producing</b>	DATE SHUT IN OR PRODUCTION RESUMED

TYPE OF COMPLETION (More than one may apply)	
<input checked="" type="checkbox"/> NEW COMPLETION	<input type="checkbox"/> COMMINGLED COMPLETION
<input type="checkbox"/> RECOMPLETION	<input type="checkbox"/> MULTIPLE COMPLETION
New Well Test Data on 24 hr. Basis: Test Date <b>8/23/92</b> <b>30</b> Bbls. Oil <b>323</b> Mcf Gas <b>3</b> Bbls. Wtr	

OIL TRANSPORTER (First Purchaser)			
NAME <b>Total Petroleum Company</b>		OGCC NO. <b>89000</b>	
ADDRESS <b>P. O. Box 500</b>			
CITY <b>Denver</b>	STATE <b>CO</b>	ZIP CODE <b>80201</b>	
AREA CODE <b>(303)</b>	PHONE NUMBER <b>291-2301</b>	DATE OF FIRST PRODUCTION <b>8/20/92</b>	

GAS GATHERER (First Purchaser)			
NAME <b>Assoc. Natural Gas, Inc.</b>		OGCC NO. <b>04680</b>	
ADDRESS <b>370 Seventeenth St., #900</b>			
CITY <b>Denver</b>	STATE <b>CO</b>	ZIP CODE <b>80202</b>	
AREA CODE <b>(303)</b>	PHONE NUMBER <b>595-3331</b>	DATE OF FIRST SALES <b>8/20/92</b>	

ROYALTY OWNER			
<input type="checkbox"/> STATE		<input type="checkbox"/> FEDERAL	
<input type="checkbox"/> INDIAN		<input checked="" type="checkbox"/> FEE	
State, Federal or Indian Lease # _____			
TOTAL ACRES IN LEASE <b>160</b>	ACRES ASSIGNED TO WELL <b>320</b>	<input type="checkbox"/> Standup <input checked="" type="checkbox"/> Laydown	

METHOD OF WATER DISPOSAL	
FACILITY NUMBER _____	
<input type="checkbox"/> CENTRAL PIT	<input type="checkbox"/> COMMERCIAL PIT
<input checked="" type="checkbox"/> ON-SITE PIT	<input type="checkbox"/> INJECTION WELL
<input type="checkbox"/> N/A	

Remarks: This well produces into the same tank battery as the following: #20-2J (same)

The undersigned certifies that the rules and regulations of the Oil and Gas Conservation Commission of the State of Colorado have been complied with except as noted above and that the transporter(s) is (are) authorized to transport the oil and/or gas produced from the above described well and that this authorization will be valid until further notice to the transporter named herein or until cancelled by the Colorado Oil and Gas Conservation Commission.

NAME (PRINT) Paula K. Porter TITLE Drilling Technician DATE 1/20/93

SIGNED Paula K. Porter

(THIS SPACE FOR STATE OFFICE USE ONLY)

APPROVED BY

Susan McCannan

TITLE

DIRECTOR

O & G Cons. Comm.

DATE

**AUG 12 1993**



STATE OF COLORADO  
OIL AND GAS CONSERVATION COMMISSION  
DEPARTMENT OF NATURAL RESOURCES

**CERTIFICATION OF CLEARANCE AND/OR CHANGE OF OPERATOR**  
(Please submit original and 3 copies per well)

OGCC LEASE NO <b>63871</b>	LEASE NAME <b>Bohlender D</b>	WELL NO <b>#20-2J</b>	API NO. <b>05-123-15848</b>
FIELD NAME & NO <b>Wattenberg 90750</b>	COUNTY <b>Weld</b>	LOCATION (T. R. SEC. TWP. RANG.) <b>SWNW Sec. 20 T3N-R64W</b>	
OPERATOR NAME <b>Gerrity Oil &amp; Gas Corporation</b>		OGCC OPR. NO. <b>33870</b>	AREA CODE PHONE NUMBER <b>(303 ) 757-1110</b>
OPERATOR ADDRESS <b>4100 E. Mississippi Ave., #1200</b>		** PREVIOUS OPERATOR	
CITY <b>Denver</b>	STATE <b>CO</b>	ZIP CODE <b>80222</b>	EFFECTIVE DATE OF CHANGE
			NEW OPERATOR BOND STATUS <input type="checkbox"/> BLANKET <input type="checkbox"/> SINGLE <input type="checkbox"/> RIDER

\*Complete only if this well is part of a previously producing lease.  
\*\*Complete only if change of operator or change of company name.

<b>PRODUCING FORMATION(S)</b> (A separate FORM 10 must be submitted for each producing formation of a Multiple Completion.)	
<b>Codell</b>	
CURRENT WELL STATUS <b>Producing</b>	DATE SHUT IN OR PRODUCTION RESUMED

<b>TYPE OF COMPLETION</b> (More than one may apply)	
<input checked="" type="checkbox"/> NEW COMPLETION	<input type="checkbox"/> COMMINGLED COMPLETION
<input type="checkbox"/> RECOMPLETION	<input type="checkbox"/> MULTIPLE COMPLETION
New Well Test Data on 24 hr. Basis: Test Date <b>8/23/92</b>	
<b>30</b> Bbls. Oil	<b>323</b> Mcf Gas <b>3</b> Bbls. Wtr

<b>OIL TRANSPORTER (First Purchaser)</b>			
NAME <b>Total Petroleum Company</b>		OGCC NO. <b>89000</b>	
ADDRESS <b>P. O. Box 500</b>			
CITY <b>Denver</b>	STATE <b>CO</b>	ZIP CODE <b>80201</b>	
AREA CODE PHONE NUMBER <b>(303 ) 291-2301</b>	DATE OF FIRST PRODUCTION <b>8/20/92</b>		

<b>GAS GATHERER (First Purchaser)</b>			
NAME <b>Assoc. Natural Gas, Inc.</b>		OGCC NO. <b>04680</b>	
ADDRESS <b>370 Seventeenth St., #900</b>			
CITY <b>Denver</b>	STATE <b>CO</b>	ZIP CODE <b>80202</b>	
AREA CODE PHONE NUMBER <b>(303 ) 595-3331</b>	DATE OF FIRST SALES <b>8/20/92</b>		

<b>ROYALTY OWNER</b>			
<input type="checkbox"/> STATE	<input type="checkbox"/> FEDERAL		
<input type="checkbox"/> INDIAN	<input checked="" type="checkbox"/> FEE		
State, Federal or Indian Lease # _____			
TOTAL ACRES IN LEASE <b>160</b>	ACRES ASSIGNED TO WELL <b>320</b>	<input type="checkbox"/> Standup	<input checked="" type="checkbox"/> Laydown

<b>METHOD OF WATER DISPOSAL</b>	
FACILITY NUMBER _____	
<input type="checkbox"/> CENTRAL PIT	<input type="checkbox"/> COMMERCIAL PIT
<input checked="" type="checkbox"/> ON-SITE PIT	<input type="checkbox"/> INJECTION WELL
<input type="checkbox"/> N/A	

Remarks: **This well produces into the same tank battery as the following: #20-2J (same)**

The undersigned certifies that the rules and regulations of the Oil and Gas Conservation Commission of the State of Colorado have been complied with except as noted above and that the transporter(s) is (are) authorized to transport the oil and/or gas produced from the above described well and that this authorization will be valid until further notice to the transporter named herein or until cancelled by the Colorado Oil and Gas Conservation Commission.

NAME (PRINT) **Paula K. Porter** TITLE **Drilling Technician** DATE **1/20/93**  
SIGNED **Paula K. Porter**

(THIS SPACE FOR STATE OFFICE USE ONLY)

APPROVED BY **Susan McLannon**

TITLE **DIRECTOR**  
**O & G Cons. Comm.**

DATE **AUG 12 1993**



G E R R I T Y  
O I L & G A S  
C O R P O R A T I O N

August 27, 1993

Ms. Susan McCannon, Acting Director  
OIL AND GAS CONSERVATION COMMISSION  
State of Colorado  
1580 Logan Street, Suite 380  
Denver, Colorado 80203

RECEIVED

SEP - 1 1993

COLO. OIL & GAS CONS. COMM.

Re: Request for Consent to Exception Location  
Bohlender D20-2J  
Township 3 North, Range 64 West, 6th P.M.  
Section 20: NW ¼  
Weld County, Colorado

Dear Ms. McCannon:

Gerrity Oil & Gas Corporation ("Gerrity") desires to complete the captioned well (the "Well") in the Sussex formation and requests that the Director approve the Well as an exception location for the Sussex formation.

The Well was drilled to a depth sufficient to test the Dakota formation pursuant to Cause Number 407-125. Gerrity Oil & Gas Corporation is the owner toward whom the Well is located. The Well does not encroach upon offset leases for production from the Sussex formation. Gerrity intends to commingle production from the Sussex formation with production from the Codell and Niobrara formations. Ownership of formations is common so allocation of production is not required.

We appreciate your consideration of this request. Please do not hesitate to telephone with any questions which may arise.

Respectfully,

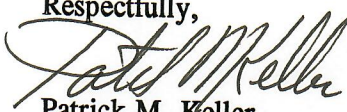
  
Patrick M. Keller  
Landman

PMK/kkp



G E R R I T Y  
O I L & G A S  
C O R P O R A T I O N

August 27, 1993

RECEIVED  
SEP - 1 1993  
COLO. OIL & GAS CONS. COMM.

Ms. Susan McCannon, Acting Director  
OIL AND GAS CONSERVATION COMMISSION  
State of Colorado  
1580 Logan Street, Suite 380  
Denver, Colorado 80203

Re: Request for Consent to Exception Location  
Bohlender D20-2J  
Township 3 North, Range 64 West, 6th P.M.  
Section 20: NW¼  
Weld County, Colorado

Dear Ms. McCannon:

Gerrity Oil & Gas Corporation ("Gerrity") desires to complete the captioned well (the "Well") in the Sussex formation and requests that the Director approve the Well as an exception location for the Sussex formation.

The Well was drilled to a depth sufficient to test the Dakota formation pursuant to Cause Number 407-125. Gerrity Oil & Gas Corporation is the owner toward whom the Well is located. The Well does not encroach upon offset leases for production from the Sussex formation. Gerrity intends to commingle production from the Sussex formation with production from the Codell and Niobrara formations. Ownership of formations is common so allocation of production is not required.

We appreciate your consideration of this request. Please do not hesitate to telephone with any questions which may arise.

Respectfully,

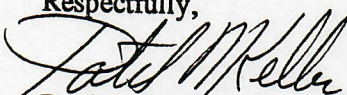

Patrick M. Keller  
Landman

PMK/kkp