

AUFRECHT N2-23

VICINITY

02077902

LOCATION

SE 1/4 SEC. 2, T.5N., R.67W

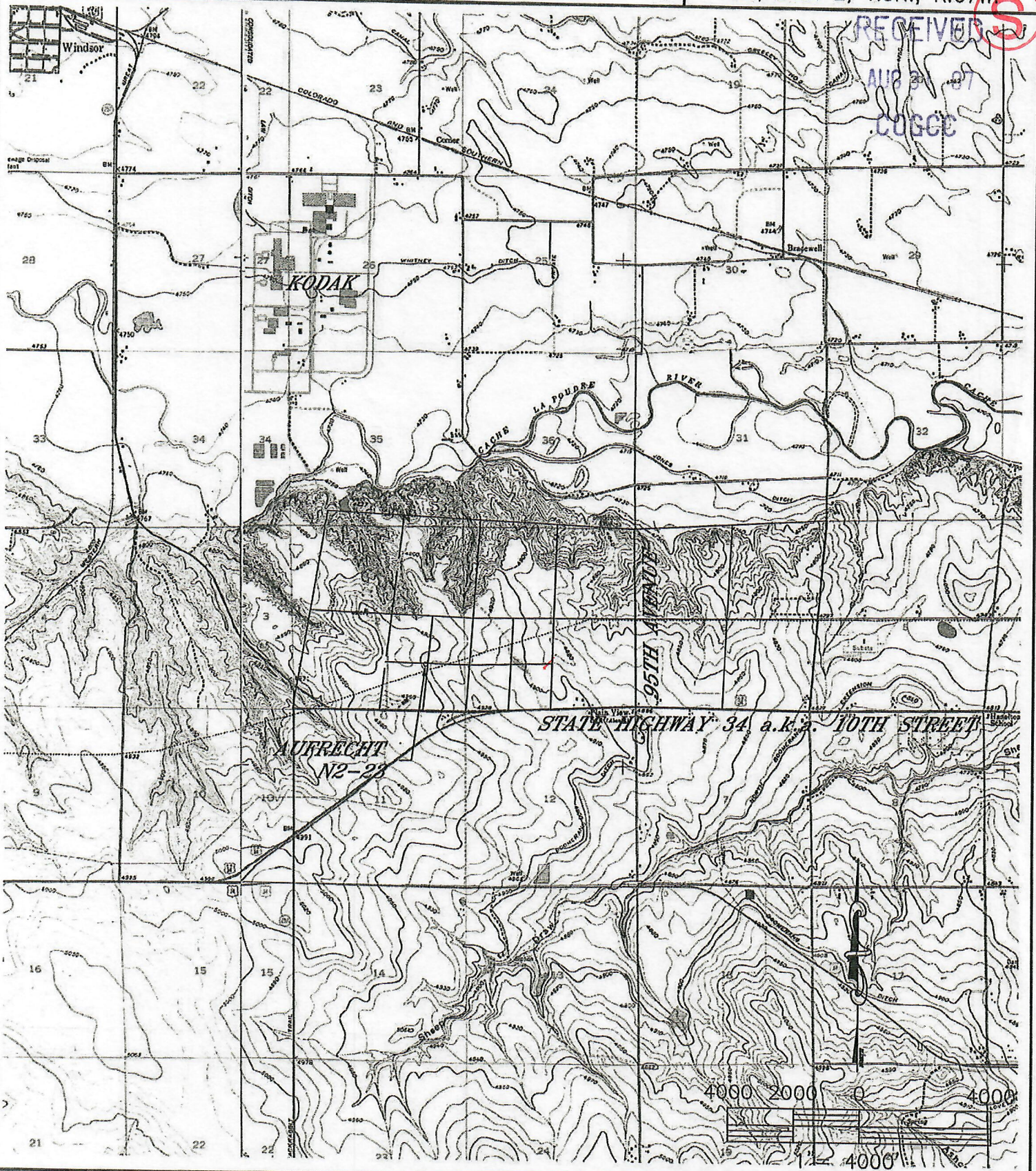

**KING SURVEYORS, INC.**

650 Garden Drive | Windsor, Colorado 80550

phone: (970) 686-5011 | fax: (970) 686-5821

www.kingsurveyors.com

**PROJECT NO: 2005541**

**DATE: 7-31-07**

**CLIENT: NOBLE ENERGY**

**DWG: 2005541WELL.dwg**

**FIELD OPERATOR: BEN ADSIT**

**DATE OF WORK: 7-26-07**



AUFRECHT N2-23

# IMPROVEMENTS

LOCATION  
SE $\frac{1}{4}$  SEC. 2 T.5N R.67W.

AUG 31 07

COGCC

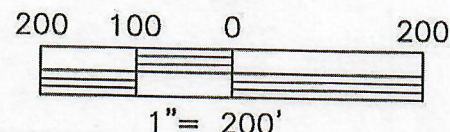
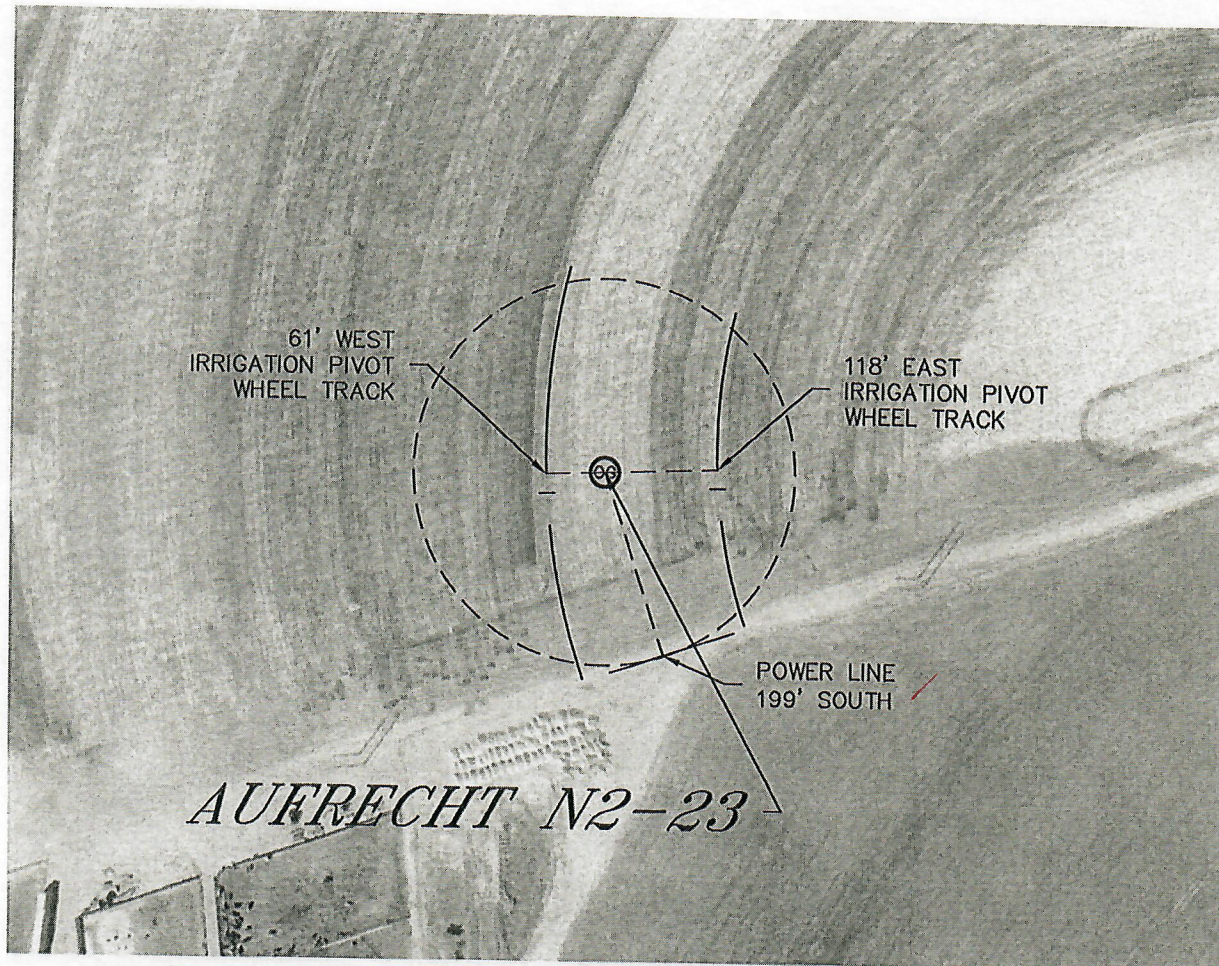

**KING SURVEYORS, INC.**

650 Garden Drive | Windsor, Colorado 80550

phone: (970) 686-5011 | fax: (970) 686-5821

[www.kingsurveyors.com](http://www.kingsurveyors.com)

**PROJECT NO:** 2005541

**DATE:** 7-31-07

**CLIENT:** NOBLE ENERGY

**DWG:** 2005541WELL.dwg

**FIELD OPERATOR:** BEN ADSIT

**DATE OF WORK:** 7-26-07