

# Great Western Operating Company, LLC

<b>Location</b>	Colorado	<b>Slot</b>	W14 - Sharp 2635-1-15HC
<b>Field</b>	Wattenburg	<b>Well</b>	Sharp 2635-1-15HC
<b>Installation</b>	Sharp	<b>Wellbore</b>	Sharp 2635-1-15HC (PWB)

Created by admin  
Date plotted 21-Jun-2018  
Plot reference is Sharp 2635-1-15HC (PWB).  
Ref wellpath is Sharp 2635-1-15HC (PWP#1).  
Coordinates are in Feet reference W14 - Sharp 2635-1-15HC.  
True Vertical Depths are reference Rig Datum.  
Measured Depths are reference Rig Datum.  
Rig Datum: Planned Datum #1  
Rig Datum to Mean Sea Level: 5039.00 ft.  
Plot North is aligned to TRUE North.

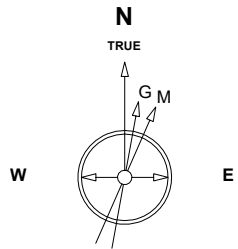

Scale 1 cm = 400 ft

East (Feet) ->



Jun-21-2018  
EMM-2015 [2000.0-2020.0] Dip: 66.28 deg Field: 51974.1 nT  
Lat: N39 56 38.5080 Long: W104 50 45.7440 Elev: 5019.00 ft  
Magnetic North is 8.20 deg East of TRUE North  
To correct azimuth from Magnetic to TRUE add 8.20 deg

TPZ: 8917 / 7767 MD/TVD, 460 FNL, 2590 FWL Sec 26

T1S, R67W, Sec 23  
T1S, R67W, Sec 24

800

0

-800

-1600

-2400

-3200

-4000

-4800

-5600

-6400

-7200

-8000

-8800

-9600

-10400

-11200

-12000

North (Feet)

Scale 1 cm = 400 ft

Scale 1 cm = 800 ft

True Vertical Depth (Feet)

## WELL PROFILE DATA

Point	MD	Inc	Azi	TVD	North	East	deg/100ft	V. Sect
Tie on	0.00	0.00	0.00	0.00	S 0.00	W 0.00		-0.00
KOP	2314.00	0.00	269.30	2314.00	S 0.00	W 0.00	0.00	-0.00
End of Build	3314.10	30.00	269.30	3269.02	S 3.11	W 255.91	3.00	73.90
End of Hold	7797.28	30.00	269.30	7151.44	S 30.39	W 2497.54	0.00	721.25
Target TPZ: 8...Sec 26	8916.87	90.00	180.17	7767.00	S 745.52	W 2855.04	8.00	1507.44
T.D. & Target BHL... 35	18165.69	90.00	180.17	7767.00	S 9994.30	W 2882.19	0.00	10401.59

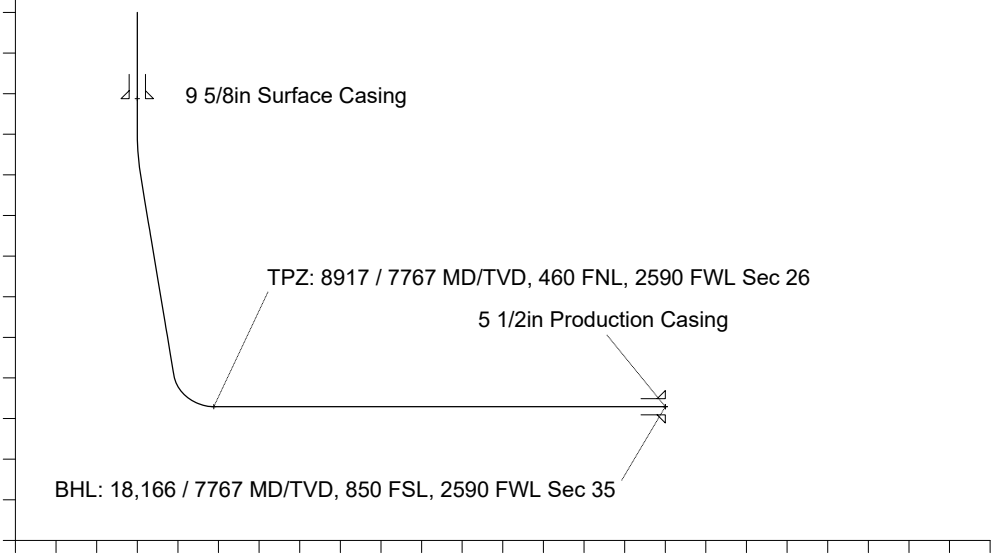

Scale 1 cm = 800 ft

Vertical Section (Feet) ->

Azimuth 196.09 with reference 0.00 N, 0.00 E from W14 - Sharp 2635-1-15HC

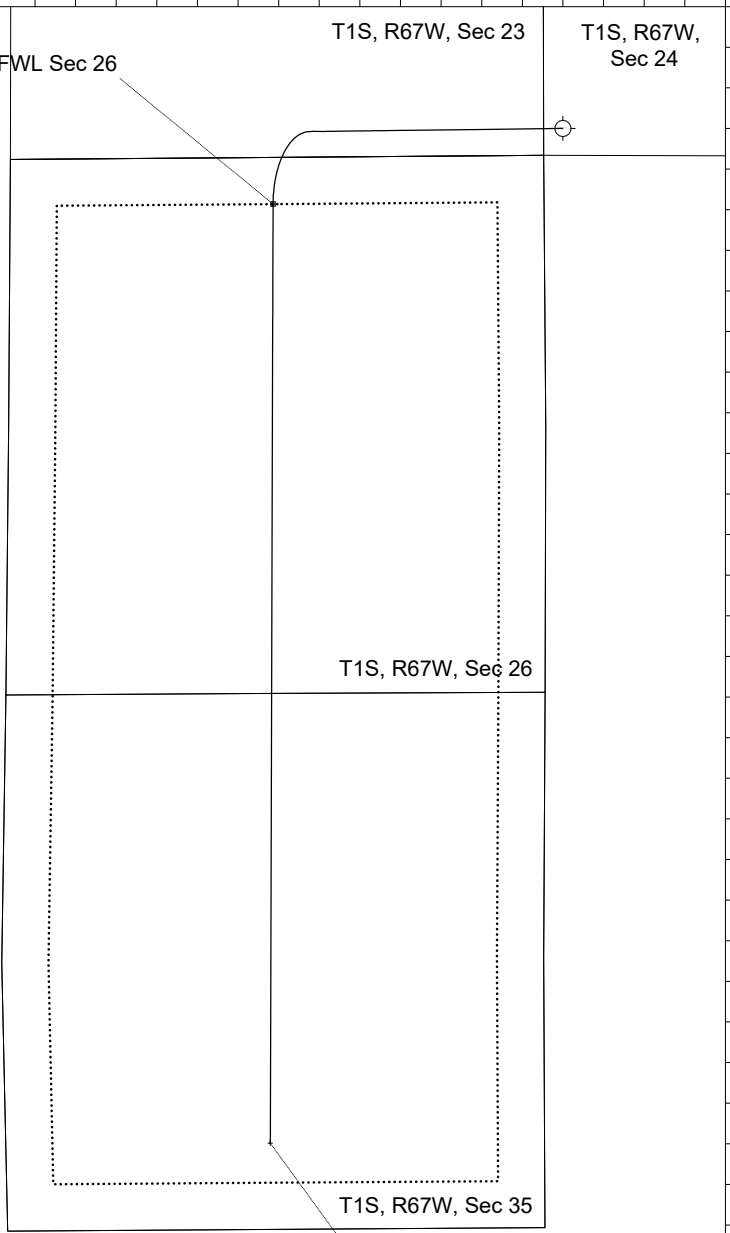

BHL: 18,166 / 7767 MD/TVD, 850 FSL, 2590 FWL Sec 35