

LOCATION DRAWING RESOLUTION 12-65-25-25-2NH

HORIZONTAL MULTI-WELL PAD

SW1/4 SW1/4 SECTION 25, TOWNSHIP 12 NORTH, RANGE 65 WEST, 6TH P.M.

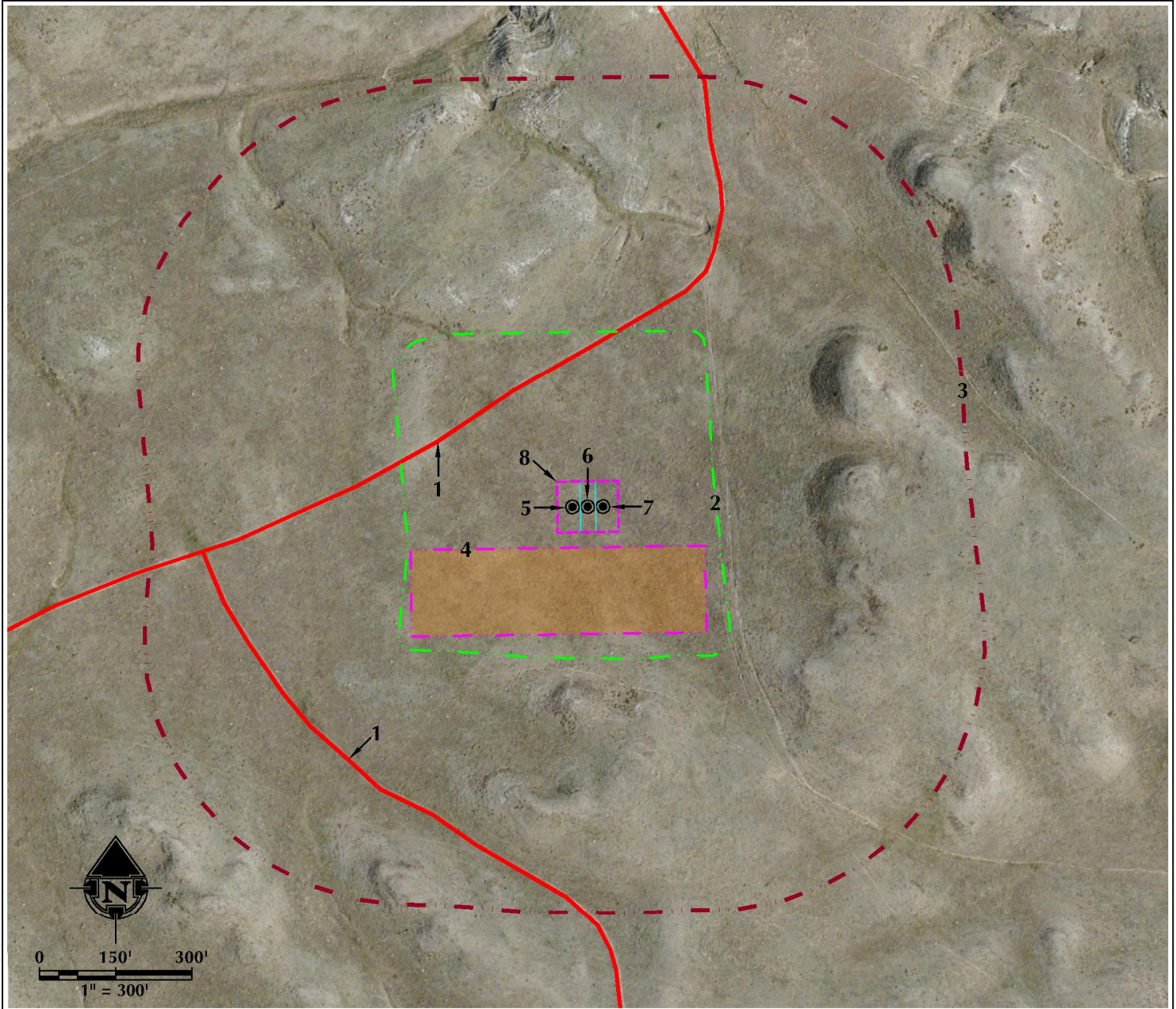

LEGEND

- EXISTING WELL
- PROPOSED WELL
- WATER WELL
- EXISTING FENCE
- PUBLIC ROAD
- PRIVATE ROAD
- 500' BUFFER
- DISTURBANCE AREA
- PUMP JACK AREA
- PROPOSED FACILITY
- EPL - EXISTING PIPELINE
- DITCH/CANAL/DRAINAGE
- DHP
- OVERHEAD POWER LINE
- EXISTING FACILITY
- EXISTING BUILDINGS
- RESIDENCE/BUILDING UNIT

* REFERENCE LOCATION *

ALL MEASUREMENTS ARE MADE FROM
REFERENCE WELL: RESOLUTION 12-65-25-25-2NH
LAT: 40.972650° LONG: -104.616460° (NAD83)
EXISTING GROUND ELEVATION = 5864.0'
WELL FOOTAGES: 543' FSL & 780' FWL

SURFACE USE: RANGELAND

NEAREST BUILDING UNIT: 5280+

PREPARED FOR:

Anadarko E&P Onshore LLC



609 CONSULTING, LLC

LOVELAND OFFICE
1615 Foxtrail Drive, Suite 204
Loveland, Colorado 80538
Phone 970-776-4331

SHERIDAN OFFICE
1095 Saberton Avenue
Sheridan, Wyoming 82801
Phone 307-674-0609

DATE SURVEYED: 11/23/15

DATE: 12/3/15

DRAFTER: SJM

REVISED:

11/23/15

12/3/15

SJM

DATA SOURCES:

- AERIAL COURTESY OF ESRI, INC.
- WATER WELLS COURTESY OF
COLORADO DIVISION OF WATER
RESOURCES