

Location:	COLORADO	Slot:	SLOT#28 STATE NORTH PLATTE K-35-36MRLNB (539'FSL & 2552'FEL, SEC.26)
Field:	WELD COUNTY	Well:	STATE NORTH PLATTE K-35-36MRLNB
Facility:	SEC.26-T5N-R63W	Wellbore:	STATE NORTH PLATTE K-35-36MRLNB PWB

Plot reference wellpath is STATE NORTH PLATTE K-35-36MRLNB PWP (REV-E.0)		Grid System: NAD83 / Lambert Colorado SP, Northern Zone (501), US feet
True vertical depths are referenced to RIG (4550'GL + 17'RXB) (RKB)		* - Wellpath was transformed from a different geodetic datum
Measured depths are referenced to RIG (4550'GL + 17'RXB) (RKB)		North Reference: True north
RIG (4550'GL + 17'RXB) (RKB) to Mean Sea Level: 4561 feet		Scale: True distance
Mean Sea Level to Mud line (At Slot: SLOT#28 STATE NORTH PLATTE K-35-36MRLNB (539'FSL & 2552'FEL, SEC.28): 0 feet		Depths are in feet
Coordinates are in feet referenced to Slot		Created by: ingmjmr on 2018-05-30
		Database: Denver

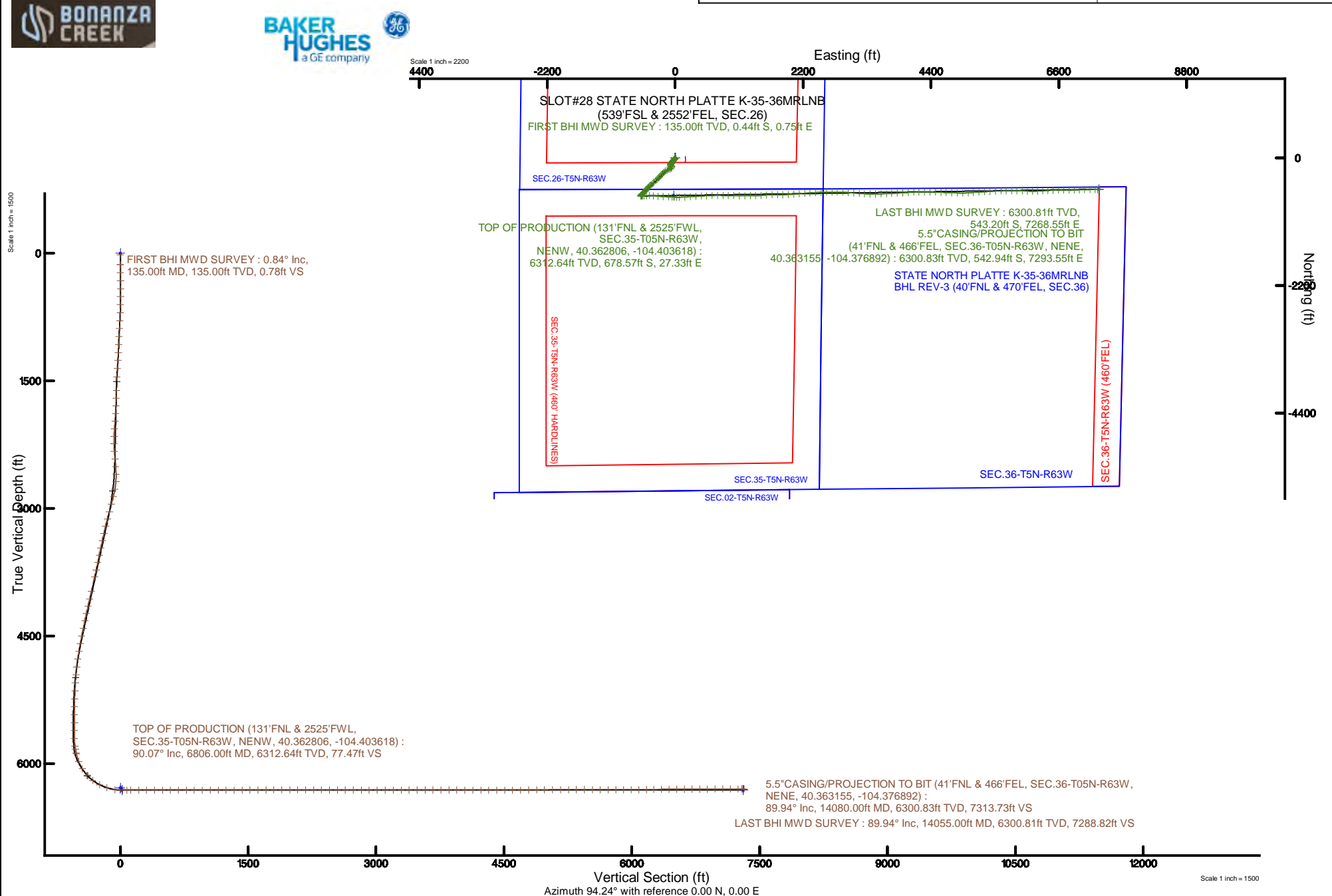



Actual Wellpath Report

STATE NORTH PLATTE K-35-36MRLNB AWP

Page 1 of 10



REFERENCE WELLPATH IDENTIFICATION			
Operator	BONANZA CREEK OIL COMPANY	Slot	SLOT#28 STATE NORTH PLATTE K-35-36MRLNB (539'FSL & 2552'FEL, SEC.26)
Area	COLORADO	Well	STATE NORTH PLATTE K-35-36MRLNB
Field	WELD COUNTY	Wellbore	STATE NORTH PLATTE K-35-36MRLNB AWP
Facility	SEC.26-T5N-R63W		

REPORT SETUP INFORMATION			
Projection System	NAD83 / Lambert Colorado SP, Northern Zone (501), US feet	Software System	WellArchitect® 5.0
North Reference	True	User	Ingmjmr
Scale	0.999959	Report Generated	5/30/2018 at 11:22:27 AM
Convergence at slot	0.71° East	Database/Source file	Denver/STATE_NORTH_PLATTE_K-35-36MRLNB_AWP.xml

WELLPATH LOCATION						
	Local coordinates		Grid coordinates		Geographic coordinates	
	North[ft]	East[ft]	Easting[US ft]	Northing[US ft]	Latitude	Longitude
Slot Location	-4223.76	1658.35	3305660.95	1377571.68	40°21'52.726"N	104°24'11.012"W
Facility Reference Pt			3303950.84	1381774.54	40°22'34.464"N	104°24'32.436"W
Field Reference Pt			3224525.77	1254425.87	40°01'44.400"N	104°41'53.556"W

WELLPATH DATUM			
Calculation method	Minimum curvature	RIG (4550'GL + 17'RKB) (RKB) to Facility Vertical Datum	4567.00ft
Horizontal Reference Pt	Slot	RIG (4550'GL + 17'RKB) (RKB) to Mean Sea Level	4567.00ft
Vertical Reference Pt	RIG (4550'GL + 17'RKB) (RKB)	RIG (4550'GL + 17'RKB) (RKB) to Mud Line at Slot (SLOT#28 STATE NORTH PLATTE K-35-36MRLNB (539'FSL & 2552'FEL, SEC.26))	4567.00ft
MD Reference Pt	RIG (4550'GL + 17'RKB) (RKB)	Section Origin	N 0.00, E 0.00 ft
Field Vertical Reference	Mean Sea Level	Section Azimuth	94.24°



Actual Wellpath Report

STATE NORTH PLATTE K-35-36MRLNB AWP

Page 2 of 10



REFERENCE WELLPATH IDENTIFICATION			
Operator	BONANZA CREEK OIL COMPANY	Slot	SLOT#28 STATE NORTH PLATTE K-35-36MRLNB (539'FSL & 2552'FEL, SEC.26)
Area	COLORADO	Well	STATE NORTH PLATTE K-35-36MRLNB
Field	WELD COUNTY	Wellbore	STATE NORTH PLATTE K-35-36MRLNB AWP
Facility	SEC.26-T5N-R63W		

WELLPATH DATA (157 stations) † = interpolated/extrapolated station										
MD [ft]	Inclination [°]	Azimuth [°]	TVD [ft]	Vert Sect [ft]	North [ft]	East [ft]	Latitude	Longitude	DLS [°/100ft]	Comments
0.00†	0.000	120.400	0.00	0.00	0.00	0.00	40°21'52.726"N	104°24'11.012"W	0.00	
17.00	0.000	120.400	17.00	0.00	0.00	0.00	40°21'52.726"N	104°24'11.012"W	0.00	
135.00	0.840	120.400	135.00	0.78	-0.44	0.75	40°21'52.721"N	104°24'11.003"W	0.71	FIRST BHI MWD SURVEY
229.00	0.620	106.240	228.99	1.89	-0.93	1.83	40°21'52.716"N	104°24'10.989"W	0.30	
323.00	0.260	66.280	322.99	2.58	-0.99	2.51	40°21'52.716"N	104°24'10.980"W	0.48	
417.00	0.190	42.490	416.98	2.86	-0.78	2.81	40°21'52.718"N	104°24'10.976"W	0.12	
511.00	0.800	215.250	510.98	2.62	-1.21	2.54	40°21'52.714"N	104°24'10.980"W	1.05	
605.00	1.840	211.950	604.96	1.58	-3.02	1.36	40°21'52.696"N	104°24'10.995"W	1.11	
699.00	3.350	213.340	698.86	-0.46	-6.60	-0.95	40°21'52.660"N	104°24'11.025"W	1.61	
793.00	4.990	218.690	792.61	-4.10	-12.08	-5.01	40°21'52.606"N	104°24'11.077"W	1.79	
887.00	5.440	217.660	886.22	-8.87	-18.80	-10.29	40°21'52.540"N	104°24'11.145"W	0.49	
981.00	5.270	215.560	979.81	-13.57	-25.84	-15.52	40°21'52.470"N	104°24'11.213"W	0.28	
1075.00	5.050	216.970	1073.42	-18.05	-32.66	-20.52	40°21'52.403"N	104°24'11.278"W	0.27	
1169.00	4.810	214.140	1167.08	-22.25	-39.22	-25.22	40°21'52.338"N	104°24'11.338"W	0.36	
1262.00	6.090	221.530	1259.66	-27.18	-46.15	-30.68	40°21'52.270"N	104°24'11.409"W	1.57	
1356.00	6.390	223.110	1353.10	-33.48	-53.70	-37.56	40°21'52.195"N	104°24'11.498"W	0.37	
1459.00	5.310	223.490	1455.56	-40.10	-61.34	-44.76	40°21'52.119"N	104°24'11.591"W	1.05	
1621.00	5.160	195.860	1616.91	-46.31	-73.79	-51.91	40°21'51.996"N	104°24'11.683"W	1.54	
1711.00	4.850	195.450	1706.57	-47.86	-81.35	-54.03	40°21'51.922"N	104°24'11.710"W	0.35	
1801.00	4.780	214.770	1796.26	-50.50	-88.10	-57.18	40°21'51.855"N	104°24'11.751"W	1.80	
1890.00	4.990	232.880	1884.94	-55.29	-93.48	-62.38	40°21'51.802"N	104°24'11.818"W	1.74	
1979.00	5.570	240.480	1973.56	-61.79	-97.94	-69.23	40°21'51.758"N	104°24'11.907"W	1.02	
2070.00	5.460	225.020	2064.14	-68.29	-103.18	-76.13	40°21'51.706"N	104°24'11.996"W	1.63	
2159.00	5.930	202.070	2152.72	-72.46	-110.43	-80.86	40°21'51.634"N	104°24'12.057"W	2.59	
2248.00	6.390	175.280	2241.22	-73.10	-119.63	-82.18	40°21'51.543"N	104°24'12.074"W	3.24	
2338.00	6.660	144.940	2330.66	-69.01	-128.90	-78.77	40°21'51.452"N	104°24'12.030"W	3.80	
2427.00	7.000	118.430	2419.05	-60.79	-135.71	-71.03	40°21'51.385"N	104°24'11.930"W	3.53	
2517.00	5.510	143.770	2508.53	-52.98	-141.80	-63.65	40°21'51.324"N	104°24'11.835"W	3.45	
2607.00	9.960	175.920	2597.73	-49.05	-153.06	-60.54	40°21'51.213"N	104°24'11.795"W	6.72	
2696.00	12.490	209.690	2685.11	-52.07	-169.12	-64.77	40°21'51.054"N	104°24'11.849"W	7.78	



Actual Wellpath Report

STATE NORTH PLATTE K-35-36MRLNB AWP

Page 3 of 10



REFERENCE WELLPATH IDENTIFICATION			
Operator	BONANZA CREEK OIL COMPANY	Slot	SLOT#28 STATE NORTH PLATTE K-35-36MRLNB (539'FSL & 2552'FEL, SEC.26)
Area	COLORADO	Well	STATE NORTH PLATTE K-35-36MRLNB
Field	WELD COUNTY	Wellbore	STATE NORTH PLATTE K-35-36MRLNB AWB
Facility	SEC.26-T5N-R63W		

WELLPATH DATA (157 stations)										
MD [ft]	Inclination [°]	Azimuth [°]	TVD [ft]	Vert Sect [ft]	North [ft]	East [ft]	Latitude	Longitude	DLS [°/100ft]	Comments
2787.00	12.590	231.840	2773.99	-63.63	-183.80	-77.45	40°21'50.909"N	104°24'12.013"W	5.25	
2877.00	14.990	250.170	2861.43	-81.51	-193.82	-96.12	40°21'50.810"N	104°24'12.254"W	5.51	
2969.00	15.890	249.840	2950.11	-103.84	-202.20	-119.13	40°21'50.728"N	104°24'12.551"W	0.98	
3061.00	17.460	246.820	3038.24	-127.56	-211.97	-143.65	40°21'50.631"N	104°24'12.868"W	1.95	
3153.00	18.870	233.840	3125.69	-151.15	-226.19	-168.36	40°21'50.490"N	104°24'13.187"W	4.65	
3243.00	18.820	228.150	3210.87	-172.31	-244.46	-190.92	40°21'50.310"N	104°24'13.479"W	2.04	
3334.00	18.840	224.070	3297.01	-191.90	-264.81	-212.08	40°21'50.109"N	104°24'13.752"W	1.45	
3424.00	18.910	224.790	3382.17	-210.68	-285.60	-232.46	40°21'49.903"N	104°24'14.015"W	0.27	
3513.00	19.100	223.200	3466.32	-229.21	-306.45	-252.59	40°21'49.697"N	104°24'14.275"W	0.62	
3601.00	18.060	222.040	3549.73	-246.63	-327.08	-271.58	40°21'49.493"N	104°24'14.521"W	1.25	
3692.00	18.030	222.370	3636.25	-263.96	-347.96	-290.51	40°21'49.287"N	104°24'14.765"W	0.12	
3784.00	18.020	225.840	3723.74	-282.20	-368.39	-310.32	40°21'49.085"N	104°24'15.021"W	1.17	
3871.00	18.030	228.490	3806.47	-300.53	-386.69	-330.06	40°21'48.904"N	104°24'15.276"W	0.94	
4050.00	17.940	228.570	3976.73	-339.12	-423.29	-371.47	40°21'48.543"N	104°24'15.811"W	0.05	
4141.00	18.200	230.190	4063.24	-359.13	-441.67	-392.89	40°21'48.361"N	104°24'16.088"W	0.62	
4232.00	18.020	226.990	4149.73	-378.89	-460.37	-414.10	40°21'48.176"N	104°24'16.362"W	1.11	
4324.00	18.060	224.060	4237.21	-397.69	-480.32	-434.43	40°21'47.979"N	104°24'16.624"W	0.99	
4413.00	17.870	225.480	4321.87	-415.52	-499.81	-453.76	40°21'47.787"N	104°24'16.874"W	0.54	
4507.00	18.150	223.420	4411.27	-434.28	-520.56	-474.10	40°21'47.582"N	104°24'17.137"W	0.74	
4601.00	18.010	222.150	4500.63	-452.45	-541.96	-493.92	40°21'47.370"N	104°24'17.393"W	0.44	
4695.00	16.790	219.960	4590.33	-469.31	-563.15	-512.39	40°21'47.161"N	104°24'17.632"W	1.47	
4790.00	15.390	219.780	4681.60	-484.64	-583.35	-529.27	40°21'46.961"N	104°24'17.850"W	1.47	
4884.00	13.920	223.930	4772.54	-499.11	-601.08	-545.10	40°21'46.786"N	104°24'18.054"W	1.92	
4978.00	10.430	225.350	4864.42	-511.93	-615.21	-559.00	40°21'46.646"N	104°24'18.234"W	3.73	
5073.00	6.990	222.020	4958.31	-521.13	-625.55	-568.99	40°21'46.544"N	104°24'18.363"W	3.66	
5167.00	4.630	220.430	5051.82	-526.87	-632.69	-575.28	40°21'46.474"N	104°24'18.444"W	2.52	
5261.00	4.890	213.790	5145.49	-531.09	-638.91	-579.97	40°21'46.412"N	104°24'18.505"W	0.65	
5355.00	5.640	212.300	5239.10	-535.24	-646.14	-584.66	40°21'46.341"N	104°24'18.565"W	0.81	
5449.00	3.930	196.770	5332.77	-538.11	-653.13	-588.06	40°21'46.272"N	104°24'18.609"W	2.27	
5543.00	2.000	134.320	5426.66	-537.55	-657.36	-587.82	40°21'46.230"N	104°24'18.606"W	3.71	



Actual Wellpath Report

STATE NORTH PLATTE K-35-36MRLNB AWP

Page 4 of 10



REFERENCE WELLPATH IDENTIFICATION			
Operator	BONANZA CREEK OIL COMPANY	Slot	SLOT#28 STATE NORTH PLATTE K-35-36MRLNB (539'FSL & 2552'FEL, SEC.26)
Area	COLORADO	Well	STATE NORTH PLATTE K-35-36MRLNB
Field	WELD COUNTY	Wellbore	STATE NORTH PLATTE K-35-36MRLNB AWB
Facility	SEC.26-T5N-R63W		

WELLPATH DATA (157 stations) † = interpolated/extrapolated station										
MD [ft]	Inclination [°]	Azimuth [°]	TVD [ft]	Vert Sect [ft]	North [ft]	East [ft]	Latitude	Longitude	DLS [°/100ft]	Comments
5636.00	0.490	277.840	5519.64	-536.71	-658.44	-587.05	40°21'46.219"N	104°24'18.596"W	2.59	
5730.00	0.090	0.030	5613.64	-537.11	-658.31	-587.45	40°21'46.220"N	104°24'18.601"W	0.52	
5824.00	0.120	216.880	5707.64	-537.17	-658.32	-587.51	40°21'46.220"N	104°24'18.602"W	0.21	
5915.00	7.270	80.150	5798.40	-531.63	-657.41	-581.88	40°21'46.229"N	104°24'18.529"W	8.09	
5947.00	10.570	75.920	5830.01	-526.88	-656.35	-577.04	40°21'46.240"N	104°24'18.467"W	10.51	
5994.00	13.070	81.830	5876.01	-517.60	-654.54	-567.60	40°21'46.258"N	104°24'18.345"W	5.90	
6007.00	13.720	88.280	5888.66	-514.63	-654.29	-564.60	40°21'46.260"N	104°24'18.306"W	12.53	
6099.00	20.980	88.720	5976.41	-487.35	-653.59	-537.19	40°21'46.267"N	104°24'17.952"W	7.89	
6194.00	30.700	87.240	6061.81	-446.25	-652.04	-495.87	40°21'46.282"N	104°24'17.418"W	10.25	
6288.00	41.260	90.280	6137.78	-391.35	-651.03	-440.74	40°21'46.292"N	104°24'16.706"W	11.39	
6381.00	53.370	93.870	6200.72	-323.18	-653.71	-372.58	40°21'46.266"N	104°24'15.826"W	13.32	
6475.00	63.660	95.350	6249.75	-243.13	-660.20	-292.80	40°21'46.202"N	104°24'14.795"W	11.03	
6570.00	71.230	93.850	6286.17	-155.46	-667.20	-205.41	40°21'46.133"N	104°24'13.666"W	8.10	
6664.00	81.690	93.230	6308.14	-64.21	-672.82	-114.32	40°21'46.077"N	104°24'12.489"W	11.15	
6726.00	89.880	92.870	6312.70	-2.45	-676.11	-52.63	40°21'46.044"N	104°24'11.692"W	13.22	
6758.00	90.090	92.140	6312.71	29.54	-677.51	-20.66	40°21'46.031"N	104°24'11.279"W	2.37	
6806.00†	90.075	90.394	6312.64	77.47	-678.57	27.33	40°21'46.020"N	104°24'10.659"W	3.64	TOP OF PRODUCTION (131'FNL & 2525'FWL, SEC.35-T05N-R63W, NENW, 40.362806, -104.403618)
6852.00	90.060	88.720	6312.58	123.32	-678.21	73.32	40°21'46.024"N	104°24'10.065"W	3.64	
6945.00	89.940	86.450	6312.58	215.68	-674.30	166.23	40°21'46.062"N	104°24'08.865"W	2.44	
7039.00	90.250	86.860	6312.43	308.86	-668.81	260.07	40°21'46.117"N	104°24'07.653"W	0.55	
7133.00	89.940	86.920	6312.27	402.09	-663.71	353.93	40°21'46.167"N	104°24'06.440"W	0.34	
7227.00	89.880	86.990	6312.42	495.33	-658.72	447.80	40°21'46.216"N	104°24'05.228"W	0.10	
7321.00	89.910	86.910	6312.59	588.57	-653.72	541.67	40°21'46.266"N	104°24'04.015"W	0.09	
7414.00	89.850	88.300	6312.79	680.94	-649.83	634.58	40°21'46.304"N	104°24'02.815"W	1.50	
7508.00	90.340	90.020	6312.63	774.57	-648.45	728.57	40°21'46.318"N	104°24'01.601"W	1.90	
7601.00	90.150	90.530	6312.23	867.34	-648.90	821.57	40°21'46.313"N	104°24'00.399"W	0.59	
7695.00	90.060	90.110	6312.06	961.12	-649.42	915.57	40°21'46.308"N	104°23'59.185"W	0.46	
7789.00	89.850	90.620	6312.13	1054.90	-650.02	1009.56	40°21'46.302"N	104°23'57.971"W	0.59	
7883.00	90.000	92.180	6312.26	1148.79	-652.32	1103.53	40°21'46.279"N	104°23'56.757"W	1.67	
7976.00	90.090	89.090	6312.18	1241.59	-653.35	1196.52	40°21'46.269"N	104°23'55.555"W	3.32	



Actual Wellpath Report

STATE NORTH PLATTE K-35-36MRLNB AWP

Page 5 of 10



REFERENCE WELLPATH IDENTIFICATION

Operator	BONANZA CREEK OIL COMPANY	Slot	SLOT#28 STATE NORTH PLATTE K-35-36MRLNB (539'FSL & 2552'FEL, SEC.26)
Area	COLORADO	Well	STATE NORTH PLATTE K-35-36MRLNB
Field	WELD COUNTY	Wellbore	STATE NORTH PLATTE K-35-36MRLNB AWB
Facility	SEC.26-T5N-R63W		

WELLPATH DATA (157 stations)

MD [ft]	Inclination [°]	Azimuth [°]	TVD [ft]	Vert Sect [ft]	North [ft]	East [ft]	Latitude	Longitude	DLS [°/100ft]	Comments
8070.00	90.090	89.390	6312.04	1335.23	-652.10	1290.51	40°21'46.281"N	104°23'54.341"W	0.32	
8164.00	90.000	89.860	6311.96	1428.93	-651.49	1384.51	40°21'46.287"N	104°23'53.127"W	0.51	
8258.00	90.180	86.000	6311.81	1522.34	-648.09	1478.43	40°21'46.321"N	104°23'51.914"W	4.11	
8351.00	90.180	85.010	6311.52	1614.26	-640.80	1571.14	40°21'46.393"N	104°23'50.716"W	1.06	
8445.00	90.090	87.870	6311.30	1707.38	-634.97	1664.95	40°21'46.450"N	104°23'49.504"W	3.04	
8539.00	90.220	93.520	6311.05	1801.16	-636.11	1758.90	40°21'46.439"N	104°23'48.290"W	6.01	
8633.00	89.940	88.380	6310.91	1894.97	-637.67	1852.86	40°21'46.424"N	104°23'47.077"W	5.48	
8727.00	90.030	85.790	6310.94	1988.23	-632.89	1946.73	40°21'46.471"N	104°23'45.864"W	2.76	
8821.00	89.910	85.100	6310.99	2081.12	-625.42	2040.43	40°21'46.545"N	104°23'44.654"W	0.75	
8915.00	90.030	85.900	6311.04	2174.03	-618.05	2134.14	40°21'46.617"N	104°23'43.443"W	0.86	
9009.00	89.970	85.530	6311.04	2266.99	-611.02	2227.88	40°21'46.687"N	104°23'42.232"W	0.40	
9103.00	90.000	86.030	6311.06	2359.97	-604.11	2321.62	40°21'46.755"N	104°23'41.021"W	0.53	
9197.00	89.820	86.890	6311.21	2453.10	-598.30	2415.44	40°21'46.812"N	104°23'39.809"W	0.93	
9291.00	89.940	87.960	6311.41	2546.43	-594.08	2509.34	40°21'46.854"N	104°23'38.596"W	1.15	
9385.00	89.780	90.210	6311.64	2640.04	-592.58	2603.33	40°21'46.869"N	104°23'37.382"W	2.40	
9478.00	90.030	88.800	6311.79	2732.72	-591.77	2696.32	40°21'46.876"N	104°23'36.181"W	1.54	
9572.00	89.820	90.350	6311.91	2826.41	-591.08	2790.31	40°21'46.883"N	104°23'34.966"W	1.66	
9666.00	90.060	91.960	6312.01	2920.27	-592.97	2884.29	40°21'46.864"N	104°23'33.752"W	1.73	
9760.00	89.940	93.690	6312.01	3014.24	-597.60	2978.17	40°21'46.818"N	104°23'32.539"W	1.84	
9854.00	89.850	95.670	6312.18	3108.23	-605.27	3071.86	40°21'46.743"N	104°23'31.329"W	2.11	
9947.00	90.120	94.150	6312.21	3201.22	-613.23	3164.51	40°21'46.664"N	104°23'30.132"W	1.66	
10041.00	90.090	93.180	6312.04	3295.21	-619.24	3258.32	40°21'46.604"N	104°23'28.920"W	1.03	
10135.00	90.090	91.390	6311.89	3389.15	-622.99	3352.24	40°21'46.567"N	104°23'27.707"W	1.90	
10229.00	90.180	88.850	6311.67	3482.90	-623.19	3446.23	40°21'46.565"N	104°23'26.493"W	2.70	
10323.00	90.090	87.920	6311.45	3576.41	-620.54	3540.19	40°21'46.591"N	104°23'25.279"W	0.99	
10416.00	90.000	87.500	6311.37	3668.81	-616.82	3633.12	40°21'46.628"N	104°23'24.079"W	0.46	
10510.00	89.880	87.140	6311.47	3762.12	-612.43	3727.02	40°21'46.671"N	104°23'22.866"W	0.40	
10604.00	89.970	86.830	6311.59	3855.37	-607.48	3820.89	40°21'46.720"N	104°23'21.653"W	0.34	
10698.00	89.850	86.640	6311.74	3948.56	-602.13	3914.73	40°21'46.772"N	104°23'20.441"W	0.24	
10792.00	89.880	86.720	6311.96	4041.74	-596.68	4008.57	40°21'46.826"N	104°23'19.228"W	0.09	



Actual Wellpath Report

STATE NORTH PLATTE K-35-36MRLNB AWP

Page 6 of 10



REFERENCE WELLPATH IDENTIFICATION			
Operator	BONANZA CREEK OIL COMPANY	Slot	SLOT#28 STATE NORTH PLATTE K-35-36MRLNB (539'FSL & 2552'FEL, SEC.26)
Area	COLORADO	Well	STATE NORTH PLATTE K-35-36MRLNB
Field	WELD COUNTY	Wellbore	STATE NORTH PLATTE K-35-36MRLNB AWB
Facility	SEC.26-T5N-R63W		

WELLPATH DATA (157 stations)										
MD [ft]	Inclination [°]	Azimuth [°]	TVD [ft]	Vert Sect [ft]	North [ft]	East [ft]	Latitude	Longitude	DLS [°/100ft]	Comments
10886.00	89.880	86.600	6312.16	4134.92	-591.21	4102.41	40°21'46.880"N	104°23'18.016"W	0.13	
10980.00	90.030	89.030	6312.23	4228.32	-587.62	4196.34	40°21'46.915"N	104°23'16.803"W	2.59	
11074.00	89.970	90.580	6312.23	4322.04	-587.30	4290.34	40°21'46.918"N	104°23'15.589"W	1.65	
11166.00	89.720	91.710	6312.48	4413.90	-589.14	4382.32	40°21'46.900"N	104°23'14.400"W	1.26	
11260.00	89.970	92.110	6312.74	4507.82	-592.28	4476.26	40°21'46.869"N	104°23'13.187"W	0.50	
11354.00	89.910	92.080	6312.84	4601.76	-595.71	4570.20	40°21'46.835"N	104°23'11.973"W	0.07	
11448.00	90.680	91.780	6312.35	4695.68	-598.88	4664.14	40°21'46.803"N	104°23'10.760"W	0.88	
11542.00	90.710	90.670	6311.21	4789.54	-600.89	4758.11	40°21'46.783"N	104°23'09.546"W	1.18	
11635.00	90.460	93.810	6310.26	4882.46	-604.52	4851.03	40°21'46.747"N	104°23'08.345"W	3.39	
11729.00	90.460	88.820	6309.51	4976.31	-606.68	4944.97	40°21'46.726"N	104°23'07.132"W	5.31	
11823.00	90.620	85.930	6308.62	5069.62	-602.37	5038.86	40°21'46.768"N	104°23'05.919"W	3.08	
11917.00	90.520	86.490	6307.69	5162.69	-596.16	5132.65	40°21'46.829"N	104°23'04.707"W	0.61	
12012.00	90.120	86.720	6307.16	5256.85	-590.53	5227.48	40°21'46.885"N	104°23'03.482"W	0.49	
12106.00	90.280	86.660	6306.83	5350.03	-585.11	5321.32	40°21'46.938"N	104°23'02.270"W	0.18	
12200.00	89.880	86.820	6306.70	5443.23	-579.76	5415.17	40°21'46.991"N	104°23'01.058"W	0.46	
12294.00	89.750	87.020	6307.00	5536.46	-574.71	5509.03	40°21'47.040"N	104°22'59.845"W	0.25	
12388.00	89.820	86.790	6307.35	5629.69	-569.64	5602.89	40°21'47.090"N	104°22'58.632"W	0.26	
12482.00	89.970	90.150	6307.52	5723.20	-567.13	5696.85	40°21'47.115"N	104°22'57.419"W	3.58	
12573.00	89.910	88.290	6307.62	5813.84	-565.89	5787.83	40°21'47.127"N	104°22'56.243"W	2.05	
12665.00	89.970	89.260	6307.72	5905.42	-563.92	5879.81	40°21'47.146"N	104°22'55.055"W	1.06	
12755.00	90.030	95.550	6307.72	5995.33	-567.70	5969.69	40°21'47.109"N	104°22'53.894"W	6.99	
12842.00	90.150	93.340	6307.58	6082.32	-574.44	6056.42	40°21'47.042"N	104°22'52.774"W	2.54	
12931.00	90.920	90.050	6306.75	6171.22	-577.07	6145.36	40°21'47.016"N	104°22'51.625"W	3.80	
13019.00	90.950	86.890	6305.31	6258.75	-574.72	6233.31	40°21'47.039"N	104°22'50.489"W	3.59	
13108.00	90.890	85.480	6303.88	6346.86	-568.80	6322.10	40°21'47.097"N	104°22'49.342"W	1.59	
13198.00	91.080	86.190	6302.34	6435.88	-562.26	6411.85	40°21'47.161"N	104°22'48.182"W	0.82	
13289.00	89.940	87.870	6301.53	6526.15	-557.55	6502.72	40°21'47.208"N	104°22'47.008"W	2.23	
13379.00	89.970	90.070	6301.60	6615.76	-555.93	6592.70	40°21'47.223"N	104°22'45.846"W	2.44	
13469.00	89.940	89.810	6301.67	6705.51	-555.84	6682.70	40°21'47.224"N	104°22'44.683"W	0.29	
13561.00	90.030	88.780	6301.69	6797.16	-554.71	6774.69	40°21'47.235"N	104°22'43.495"W	1.12	



Actual Wellpath Report

STATE NORTH PLATTE K-35-36MRLNB AWP

Page 7 of 10



REFERENCE WELLPATH IDENTIFICATION			
Operator	BONANZA CREEK OIL COMPANY	Slot	SLOT#28 STATE NORTH PLATTE K-35-36MRLNB (539'FSL & 2552'FEL, SEC.26)
Area	COLORADO	Well	STATE NORTH PLATTE K-35-36MRLNB
Field	WELD COUNTY	Wellbore	STATE NORTH PLATTE K-35-36MRLNB AWP
Facility	SEC.26-T5N-R63W		

WELLPATH DATA (157 stations)										
MD [ft]	Inclination [°]	Azimuth [°]	TVD [ft]	Vert Sect [ft]	North [ft]	East [ft]	Latitude	Longitude	DLS [°/100ft]	Comments
13653.00	90.180	88.180	6301.52	6888.70	-552.27	6866.66	40°21'47.259"N	104°22'42.307"W	0.67	
13743.00	90.310	89.110	6301.14	6978.27	-550.14	6956.63	40°21'47.280"N	104°22'41.144"W	1.04	
13831.00	89.970	88.300	6300.92	7065.85	-548.15	7044.61	40°21'47.299"N	104°22'40.008"W	1.00	
13922.00	89.970	88.600	6300.97	7156.39	-545.69	7135.57	40°21'47.323"N	104°22'38.833"W	0.33	
14012.00	90.180	89.000	6300.85	7245.98	-543.80	7225.55	40°21'47.341"N	104°22'37.670"W	0.50	
14055.00	89.940	89.400	6300.81	7288.82	-543.20	7268.55	40°21'47.347"N	104°22'37.115"W	1.08	LAST BHI MWD SURVEY
14080.00	89.940	89.400	6300.83	7313.73	-542.94	7293.55	40°21'47.350"N	104°22'36.792"W	0.00	5.5"CASING/PROJECTION TO BIT (41'FNL & 466'FEL, SEC.36-T05N-R63W, NENE, 40.363155, -104.376892)

HOLE & CASING SECTIONS - Ref Wellbore: STATE NORTH PLATTE K-35-36MRLNB AWP Ref Wellpath: STATE NORTH PLATTE K-35-36MRLNB AWP									
String/Diameter	Start MD [ft]	End MD [ft]	Interval [ft]	Start TVD [ft]	End TVD [ft]	Start N/S [ft]	Start E/W [ft]	End N/S [ft]	End E/W [ft]
9.625in Casing Surface	17.00	1502.00	1485.00	17.00	1498.38	0.00	0.00	-64.34	-47.27
8.5in Open Hole	1502.00	14080.00	12578.00	1498.38	6300.83	-64.34	-47.27	-542.94	7293.55



Actual Wellpath Report

STATE NORTH PLATTE K-35-36MRLNB AWP

Page 8 of 10



REFERENCE WELLPATH IDENTIFICATION			
Operator	BONANZA CREEK OIL COMPANY	Slot	SLOT#28 STATE NORTH PLATTE K-35-36MRLNB (539'FSL & 2552'FEL, SEC.26)
Area	COLORADO	Well	STATE NORTH PLATTE K-35-36MRLNB
Field	WELD COUNTY	Wellbore	STATE NORTH PLATTE K-35-36MRLNB AWB
Facility	SEC.26-T5N-R63W		

TARGETS								
Name	TVD [ft]	North [ft]	East [ft]	Grid East [US ft]	Grid North [US ft]	Latitude	Longitude	Shape
SEC.26-T05N-R63W	-19.00	4183.20	-1533.84	3304075.56	1381735.41	40°22'34.062"N	104°24'30.831"W	polygon
SEC.02-T4N-R63W	-5.00	912.26	-1123.83	3304525.98	1378469.93	40°22'01.740"N	104°24'25.531"W	polygon
SEC.35-T5N-R63W	-5.00	912.26	-1123.83	3304525.98	1378469.93	40°22'01.740"N	104°24'25.531"W	polygon
SEC.36-T5N-R63W	0.00	0.34	0.26	3305661.21	1377572.03	40°21'52.729"N	104°24'11.009"W	polygon
SEC.36-T5N-R63W (460'FEL)	6285.00	0.34	0.26	3305661.21	1377572.03	40°21'52.729"N	104°24'11.009"W	polygon
STATE NORTH PLATTE K-35-36MRLNB BHL REV-3 (40'FNL & 470'FEL, SEC.36)	6312.00	-540.54	7288.27	3312955.04	1377121.36	40°21'47.374"N	104°22'36.860"W	point
STATE NORTH PLATTE K-35-36MRLNB LP REV-3 (110'FNL & 2570'FEL, SEC.35)	6312.00	-649.05	-26.91	3305642.08	1376922.37	40°21'46.312"N	104°24'11.360"W	point
SEC.02-T4N-R63W 460'SETBACK	6539.00	912.26	-1123.82	3304525.98	1378469.93	40°22'01.740"N	104°24'25.531"W	polygon
SEC.26-T05N-R63W 460' SETBACK	6539.00	4183.20	-1533.84	3304075.56	1381735.41	40°22'34.062"N	104°24'30.831"W	polygon
SEC.35-T5N-R63W 460'SETBACK	6539.00	912.26	-1123.82	3304525.98	1378469.93	40°22'01.740"N	104°24'25.531"W	polygon



Actual Wellpath Report

STATE NORTH PLATTE K-35-36MRLNB AWP

Page 9 of 10



REFERENCE WELLPATH IDENTIFICATION			
Operator	BONANZA CREEK OIL COMPANY	Slot	SLOT#28 STATE NORTH PLATTE K-35-36MRLNB (539'FSL & 2552'FEL, SEC.26)
Area	COLORADO	Well	STATE NORTH PLATTE K-35-36MRLNB
Field	WELD COUNTY	Wellbore	STATE NORTH PLATTE K-35-36MRLNB AWB
Facility	SEC.26-T5N-R63W		

WELLPATH COMPOSITION - Ref Wellbore: STATE NORTH PLATTE K-35-36MRLNB AWB Ref Wellpath: STATE NORTH PLATTE K-35-36MRLNB AWP				
Start MD [ft]	End MD [ft]	Positional Uncertainty Model	Log Name/Comment	Wellbore
17.00	1459.00	Custom BHI NaviTrak (Standard Rotating+Axial Corr) (Rockies 0.03Gt model)	BHI MWD NAVITRAK +SR+AC+ROCKIES <135-1459>	STATE NORTH PLATTE K-35-36MRLNB AWB
1459.00	14055.00	BHI AutoTrak Curve (Axial Corr, Short spacing)	BHI ATCURVE +AC+SS <1621-14055>	STATE NORTH PLATTE K-35-36MRLNB AWB
14055.00	14080.00	Blind Drilling (std)	Projection to bit	STATE NORTH PLATTE K-35-36MRLNB AWB



Actual Wellpath Report

STATE NORTH PLATTE K-35-36MRLNB AWP

Page 10 of 10



REFERENCE WELLPATH IDENTIFICATION			
Operator	BONANZA CREEK OIL COMPANY	Slot	SLOT#28 STATE NORTH PLATTE K-35-36MRLNB (539'FSL & 2552'FEL, SEC.26)
Area	COLORADO	Well	STATE NORTH PLATTE K-35-36MRLNB
Field	WELD COUNTY	Wellbore	STATE NORTH PLATTE K-35-36MRLNB AWB
Facility	SEC.26-T5N-R63W		

WELLPATH COMMENTS				
MD [ft]	Inclination [°]	Azimuth [°]	TVD [ft]	Comment
135.00	0.840	120.400	135.00	FIRST BHI MWD SURVEY
6806.00	90.075	90.394	6312.64	TOP OF PRODUCTION (131'FNL & 2525'FWL, SEC.35-T05N-R63W, NENW, 40.362806, -104.403618)
14055.00	89.940	89.400	6300.81	LAST BHI MWD SURVEY
14080.00	89.940	89.400	6300.83	5.5"CASING/PROJECTION TO BIT (41'FNL & 466'FEL, SEC.36-T05N-R63W, NENE, 40.363155, -104.376892)

COMMENTS	
Wellpath general comments	
TOP OF PRODUCTION (131'FNL & 2525'FWL, SEC.35-T05N-R63W, NENW, 40.362806, -104.403618)	
5.5"CASING/PROJECTION TO BIT (41'FNL & 466'FEL, SEC.36-T05N-R63W, NENE, 40.363155, -104.376892)	