



FRANE SURVEYING INC.

Physical Address: 34834 Annie Cir.
Mail to: Box 2372, Elizabeth, CO 80107
Ph. 303-243-0037
www.franesurveying.com
Job # 18-131-Bogenhagen #1

Frane Surveying, in accordance with a request from **Kuenzler Flora Reserve Corporation**, has determined the location of **Bogenhagen #1 (re-entry)** to be **658 feet FSL**, and **1977 feet FWL**, (90° off Section lines) of **SECTION 31**, Township **14s**, Range **46w** of the 6th Principal Meridian, **Cheyenne County**, Colorado.

Date: Staked on 06/05/18 drawn on 06/07/18.

Re:

Staked by Elijah Frane

Drawn:

Drawn by Elijah Frane

1000' Hydrology Map

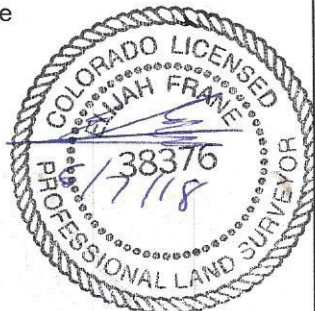

There are no apparent surface water areas or riparian areas within 1000' of proposed well pad.

Kuenzler Flora Reserve
SE 1/4 SEC. 31-14S-46W
BOGENHAGEN #1 (RE-ENTRY)
CHEYENNE Co, COLORADO

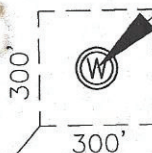

R=1000'