



# Kerr-McGee Oil & Gas Onshore LP

A subsidiary of Anadarko Petroleum Corporation

1099 18<sup>th</sup> Street  
Denver, CO 80202  
720-929-6000

June 8, 2018

Julie Murphy  
Director, Colorado Oil and Gas Conservation Commission  
Department of Natural Resources  
The Chancery Building  
1120 Lincoln Street, Suite 801  
Denver, CO 80203

**Re: 30 Day Certification Letter - 318A.e**

Castle Pines 19-2HZ (Doc No. 401627421)

Township 2 North, Range 66 West

Section 19: SESE

Unit Acreage: 800 Acres

Proposed Spacing Unit:

01N66W: SEC 06: NENW, NWNE;

02N66W: SEC 31: E2W2, W2E2;

02N66W: SEC 30: E2W2, W2E2;

02N66W: SEC 19: SESW, SWSE;

Weld County, Colorado

Dear Director Murphy:

Kerr-McGee Oil and Gas Onshore LP ("KMG") hereby certifies that a thirty (30) day notice has been given by certified mail to all mineral owners in the proposed wellbore spacing unit. We have not received any objections to this spacing unit or location. KMG hereby respectfully requests approval of this well.

If you have any questions or issues regarding this permit, please contact me at (720) 929-6092.

Sincerely,

**Kerr-McGee Oil and Gas Onshore LP**

A handwritten signature in blue ink, appearing to read 'Craig Richardson'.

Craig Richardson  
Regulatory Analyst

DISTANCE FROM COMPLETED  
PORTION OF WELLBORE TO  
NEAREST UNIT BOUNDARY= 736'

# CASTLE PINES 19-2HZ WELLBORE SPACING UNIT

**SURFACE LOCATION: NAD 83**  
GROUND ELEVATION= 4873.6'  
LATITUDE= 40.117681°  
LONGITUDE= -104.814613°  
LATITUDE= 40°07'03.653"  
LONGITUDE= -104°48'52.605"  
**HEEL LOCATION: NAD 83**  
LATITUDE= 40.117942°  
LONGITUDE= -104.819759°  
LATITUDE= 40°07'04.590"  
LONGITUDE= -104°49'11.132"  
**BOTTOM HOLE LOCATION: NAD 83**  
LATITUDE= 40.087912°  
LONGITUDE= -104.819747°  
LATITUDE= 40°05'16.483"  
LONGITUDE= -104°49'11.089"

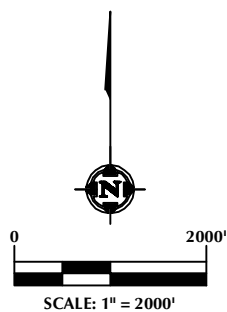

## NOTES:

1. DRAWING LATITUDE AND LONGITUDE COORDINATES ARE NAD 83 (2011)(EPOCH:2010).
2. ELEVATION BASED ON NAVD88 (GEOID12B).
3. BASIS OF BEARING DERIVED FROM COLORADO COORDINATE SYSTEM OF 1983 NORTH ZONE.
4. ALL MEASURED DISTANCES ARE GRID. COMBINED SCALE FACTOR: .99973013 CALCULATED FROM THE W. 1/4 CORNER OF SECTION 18, T2N, R66W.

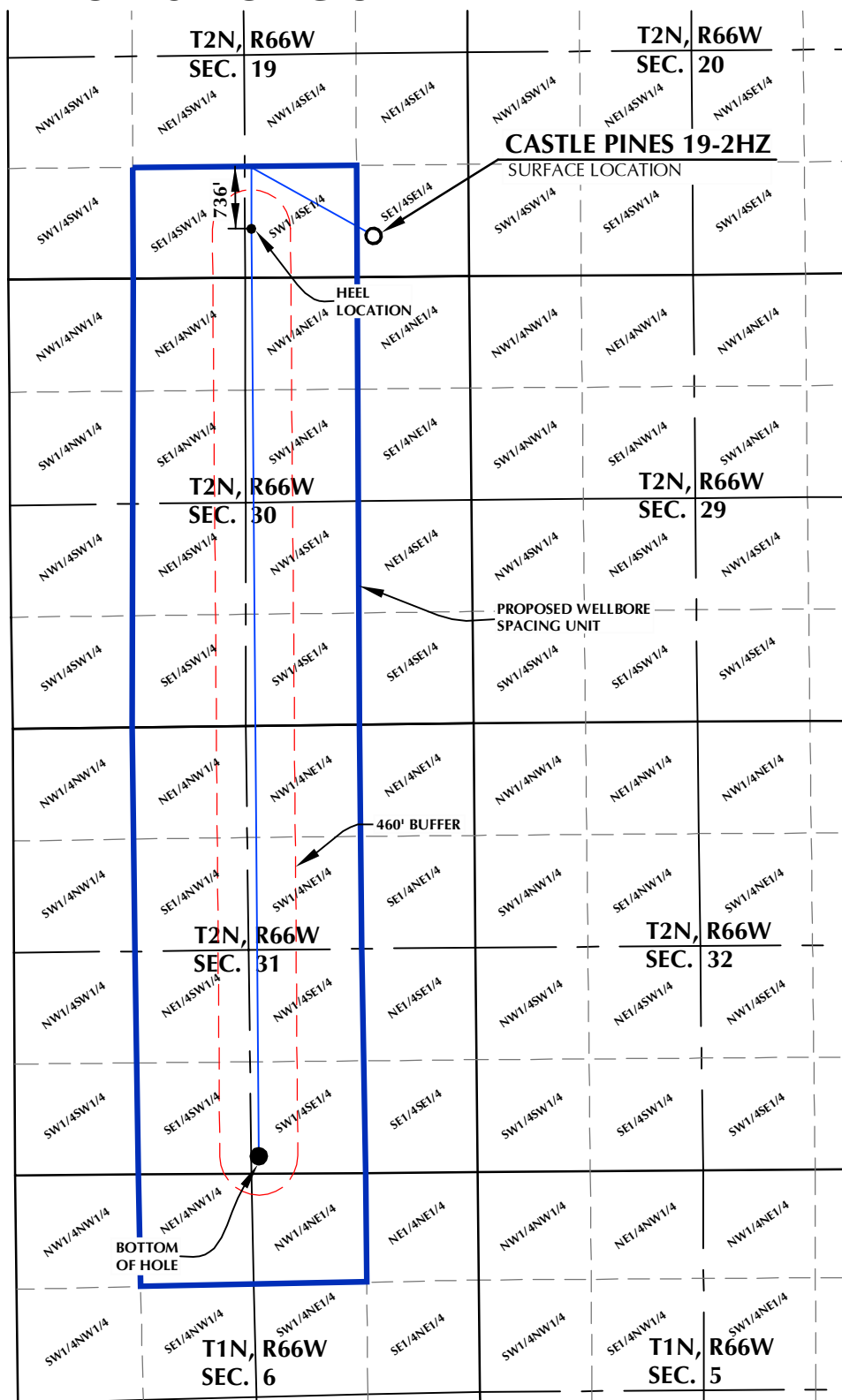

## WELL PAD - CASTLE PINES 16-19HZ

CASTLE PINES 19-2HZ  
WELLBORE SPACING UNIT  
484' FSL & 1123' FEL SESE (SURFACE)  
578' FSL & 2562' FEL SWSE (HEEL)  
LOCATED IN SECTION 19  
200' FSL & 2579' FEL SWSE (BOTTOM)  
LOCATED IN SECTION 31  
T2N, R66W, 6TH P.M.  
WELD COUNTY, COLORADO

**Kerr-McGee Oil &  
Gas Onshore L.P.**  
1099 18th Street  
Denver, Colorado 80202



## CONSULTING, LLC

**SHERIDAN OFFICE**  
1095 Saberton Avenue  
Sheridan, Wyoming 82801  
Phone 307-674-0609

**LOVELAND OFFICE**  
1635 Foxtrail Drive, Suite 204  
Loveland, Colorado 80538  
Phone 970-776-4331

|               |         |                |        |
|---------------|---------|----------------|--------|
| DRAFTED BY:   | LMO     | CHECKED BY:    | RKF    |
| DATE DRAFTED: | 3/15/18 | DATE SURVEYED: | 1/5/18 |
| REVISED:      |         | FILE NAME:     | 16-175 |