

# Great Western Operating Company, LLC

**Location** Colorado  
**Field** Wattenburg  
**Installation** Postle West  
**Slot** N12 - Postle IC 09-059HNX  
**Well** Postle IC 09-059HNX  
**Wellbore** Postle IC 09-059HNX (PWB)

Created by admin  
Date plotted 30-Jun-2017  
Plot reference is Postle IC 09-059HNX (PWB).  
Ref wellpath is Postle IC 09-059HNX (PWP#1).  
Coordinates are in Feet reference N12 - Postle IC 09-059HNX.  
True Vertical Depths are reference Rig Datum.  
Measured Depths are reference Rig Datum.  
Rig Datum: Planned Datum #1  
Rig Datum to Mean Sea Level: 4996.90 ft.  
Plot North is aligned to TRUE North.

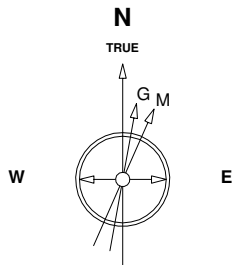

Scale 1 cm = 400 ft

East (Feet) ->

-13600 -12800 -12000 -11200 -10400 -9600 -8800 -8000 -7200 -6400 -5600 -4800 -4000 -3200 -2400 -1600 -800 0 800 1600

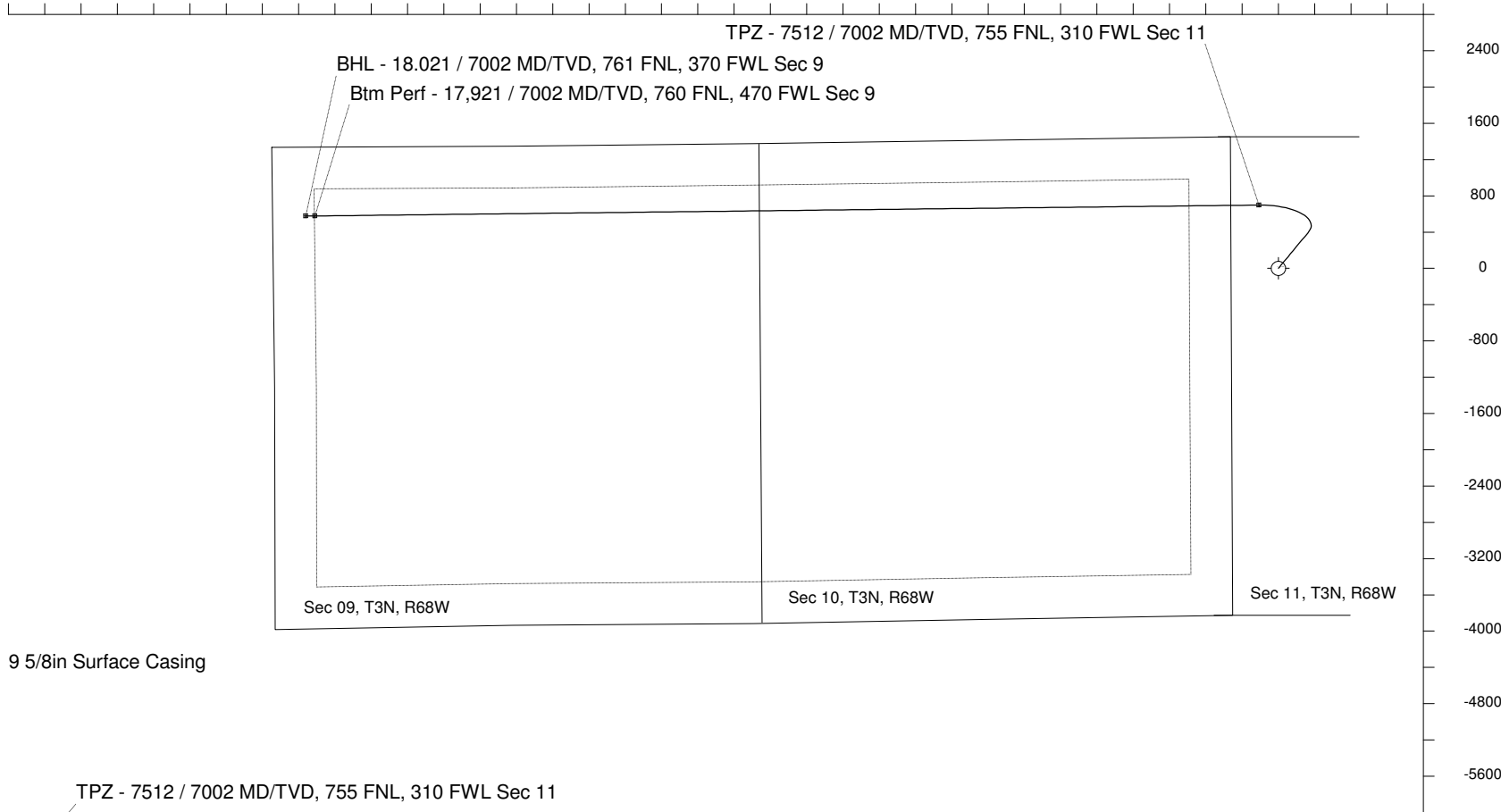

7-Aug-2014  
IGRF Model [1900.0-2020.0] Dip: 66.77 deg Field: 52617.4 nT  
Lat: N40 14 38.2488 Long: W104 58 42.6288 Elev: 4976.90 ft  
Magnetic North is 8.62 deg East of TRUE North  
To correct azimuth from Magnetic to TRUE add 8.62 deg

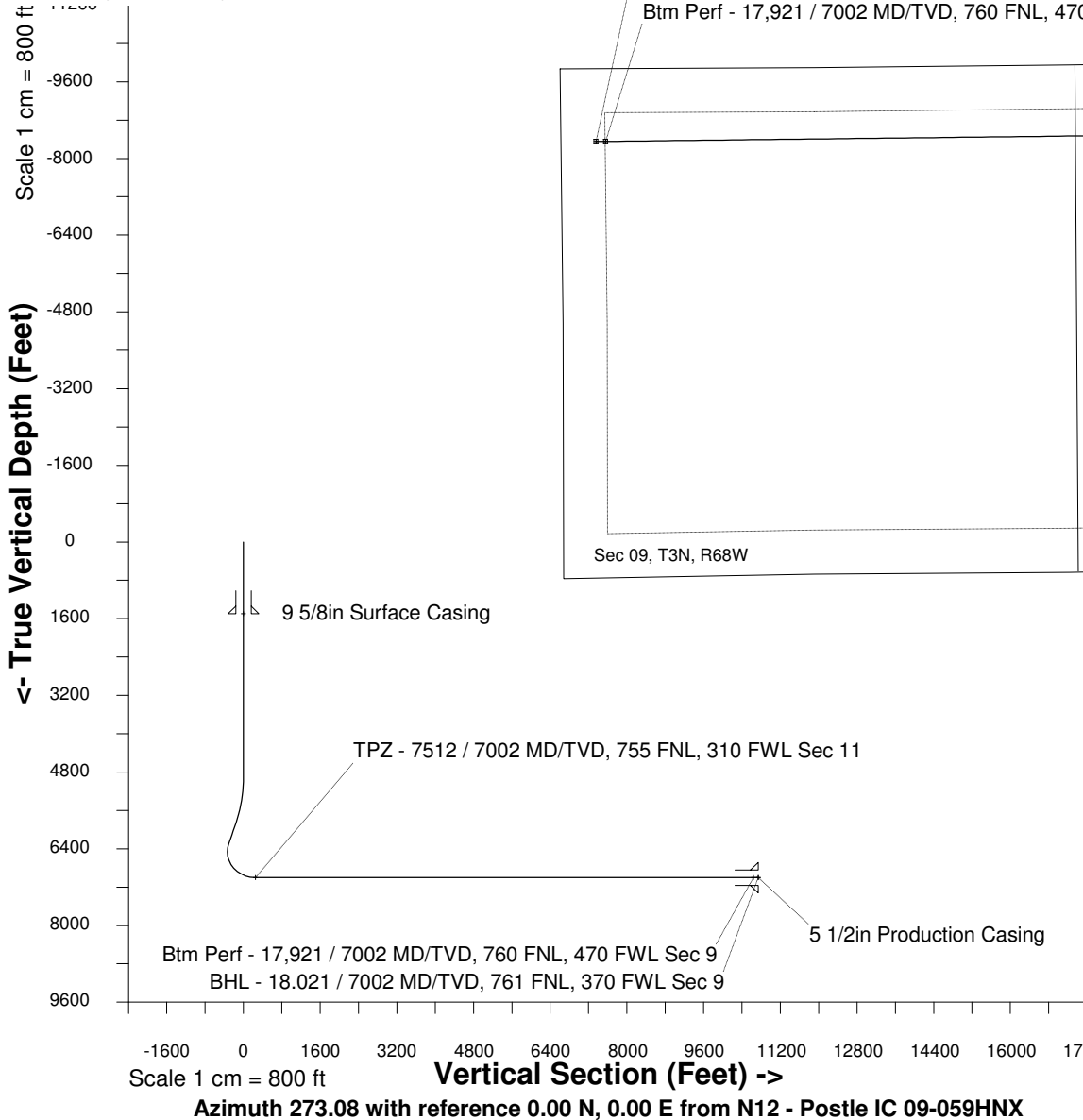

## WELL PROFILE DATA

Point	MD	Inc	Azi	TVD	North	East	deg/100ft	V. Sect
Tie on	0.00	0.00	0.00	0.00	S 0.00	W 0.00		0.00
KOP	4897.00	0.00	39.74	4897.00	S 0.00	W 0.00	0.00	0.00
End of Build	5896.85	30.00	39.74	5851.80	N 196.70	E 163.53	9.84	-152.72
End of Hold	6423.07	30.00	39.74	6307.54	N 399.00	E 331.70	0.00	-309.77
Target TPZ - ...Sec 11	7512.12	90.00	269.34	7002.00	N 698.00	W 213.83	32.81	251.05
Target Btm Pe... Sec 9	17920.92	90.00	269.34	7002.00	N 577.88	W 10621.94	0.00	10637.65
End of Turn	17923.01	90.00	269.61	7002.00	N 577.86	W 10624.03	42.65	10639.73
T.D. & Target BHL...c 9	18020.86	90.00	269.61	7002.00	N 577.19	W 10721.88	0.00	10737.40