

HYDROLOGY MAP
RINN VALLEY WEST PAD

SE 1/4 SE 1/4 SECTION 18, TOWNSHIP 2 NORTH, RANGE 68 WEST, 6TH P.M.

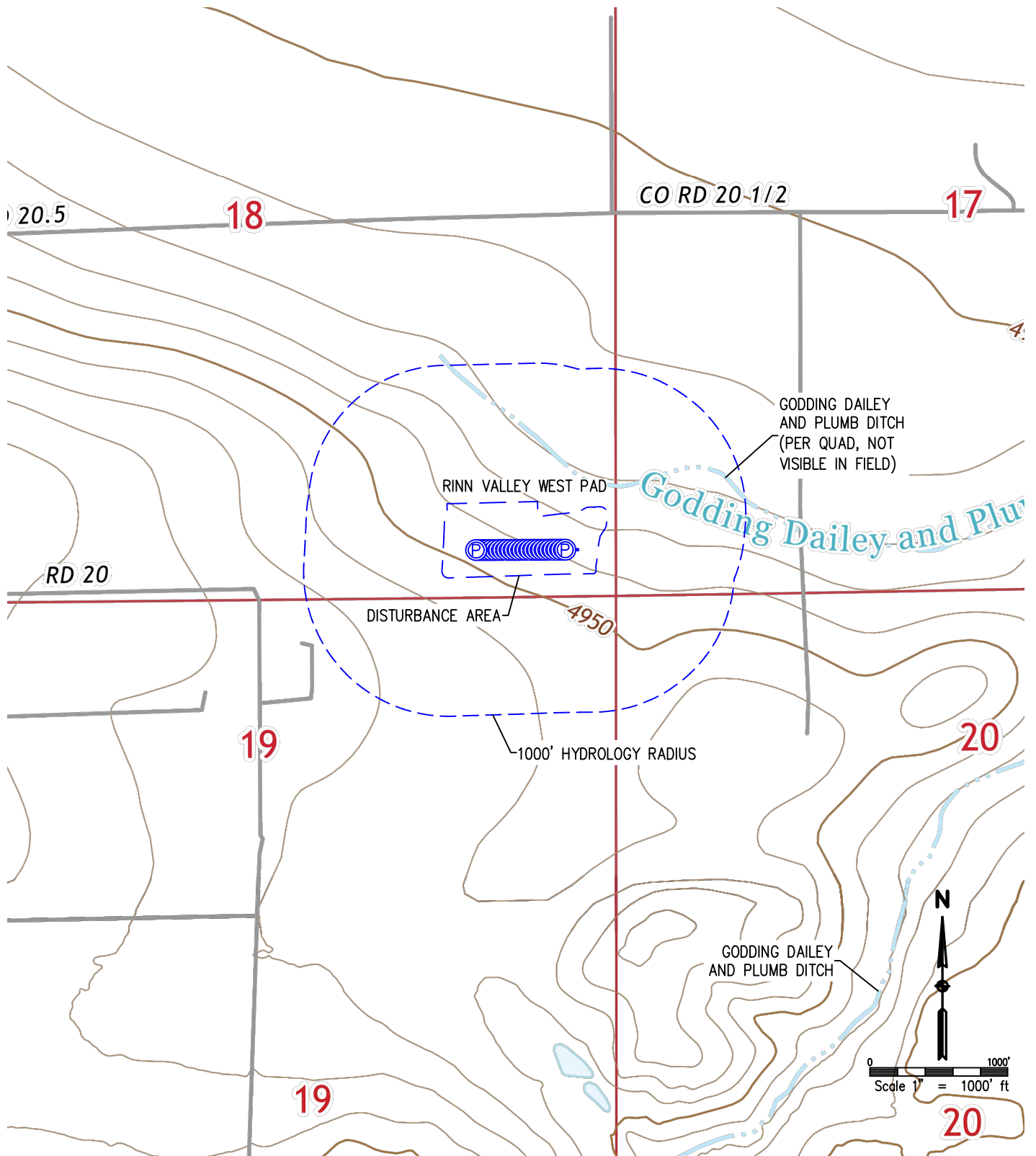

LEGEND

- 1000' HYDROLOGY RADIUS
- WETLAND AREA



DRAWN BY DAM	CHECKED BY AAD
INITIAL SUBMITTAL 3/9/2018	REVISED NA
DRAWING SIZE 8.5" X 11"	JOB NO. EXT02N68W17-01
SHEET 1	OF 1

BASELINE
Engineering - Planning - Surveying

4007 S. LINCOLN AVENUE, SUITE 405 - LOVELAND, COLORADO 80537
P: 970.353.7800 - F: 970.353.7801 - www.baselinecorp.com