

SRC ENERGY

Location: COLORADO Slot: SLOT#02 BOOMERANG 25N-3A-L (1332°FNL & 2327°FWL, SEC.05)
Field: WELD COUNTY (NAD83, TRUE NORTH) Well: BOOMERANG 25N-3A-L
Facility: SEC.05-T05N-R66W Wellbore: BOOMERANG 25N-3A-L PWB

Plot reference wellpath is BOOMERANG 25N-3A-L PWB (REV.B.0)	Grid System: NAD83 / Lambert Colorado SP, Northern Zone (501), US feet
True vertical depths are referenced to PRECISION 462 (20') (RKB)	* = Wellpath was transformed from a different geodetic datum
Measured depths are referenced to PRECISION 462 (20') (RKB)	North Reference: True north
PRECISION 462 (20') (RKB) to Mean Sea Level: 4789 feet	Scale: True distance
Mean Sea Level to Mud line (At Slot: SLOT#02 BOOMERANG 25N-3A-L (1332°FNL & 2327°FWL, SEC.05)): 0 feet	Depths are in feet
Coordinates are in feet referenced to Slot	Created by: dodanna on 2018-04-26
	Database: WellArchitectDB

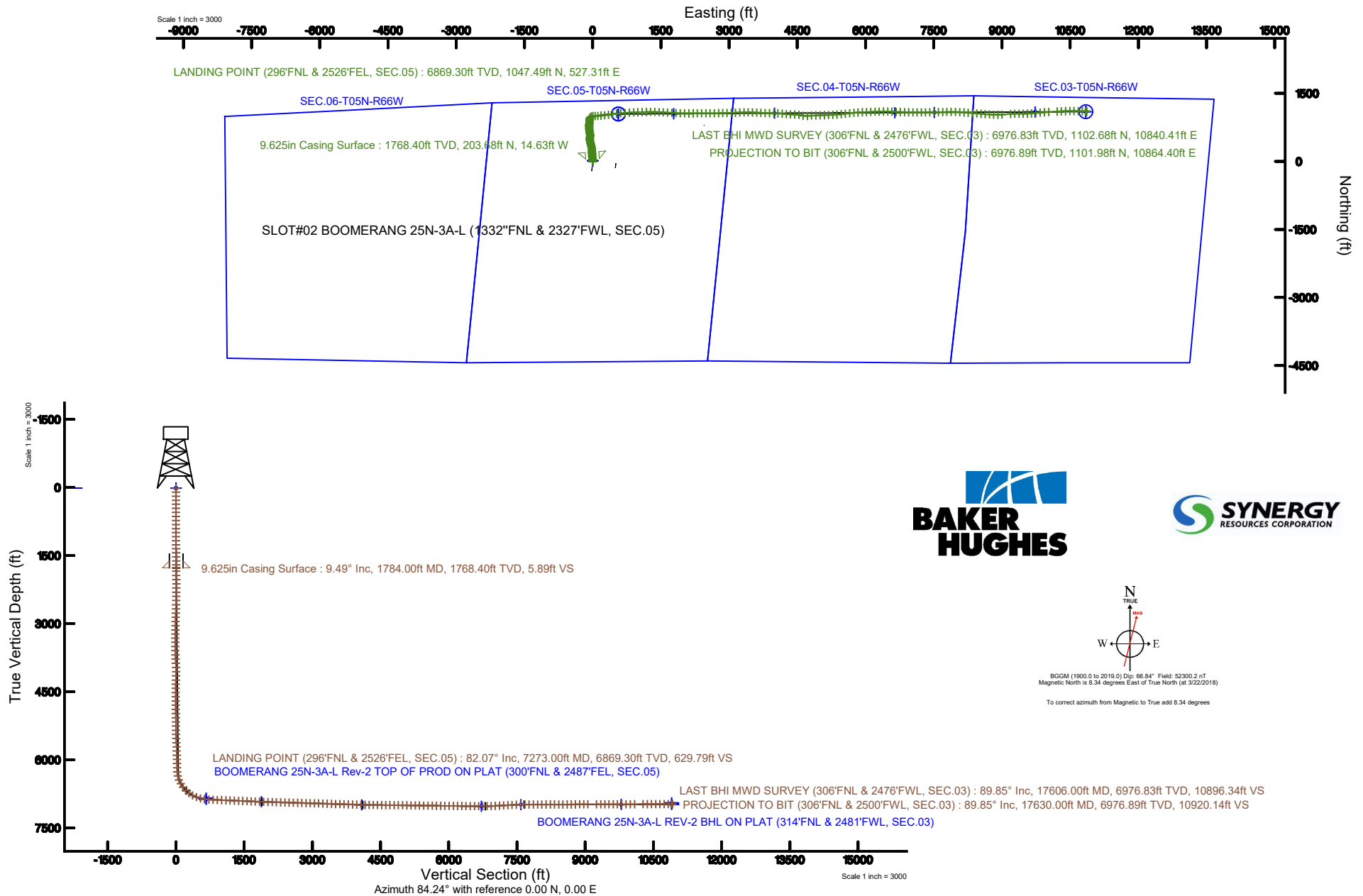



SRC ENERGY

Actual Wellpath Report

BOOMERANG 25N-3A-L AWP

Page 1 of 10



REFERENCE WELLPATH IDENTIFICATION

Operator	SRC ENERGY	Slot	SLOT#02 BOOMERANG 25N-3A-L (1332"FNL & 2327'FWL, SEC.05)
Area	COLORADO	Well	BOOMERANG 25N-3A-L
Field	WELD COUNTY (NAD83, TRUE NORTH)	Wellbore	BOOMERANG 25N-3A-L AWB
Facility	SEC.05-T05N-R66W		

REPORT SETUP INFORMATION

Projection System	NAD83 / Lambert Colorado SP, Northern Zone (501), US feet	Software System	WellArchitect® 5.0
North Reference	True	User	Doddanna
Scale	0.999962	Report Generated	4/26/2018 at 11:03:44 AM
Convergence at slot	0.45° East	Database/Source file	WellArchitectDB/BOOMERANG_25N-3A-L_AWP.xml

WELLPATH LOCATION

	Local coordinates		Grid coordinates		Geographic coordinates	
	North[ft]	East[ft]	Easting[US ft]	Northing[US ft]	Latitude	Longitude
Slot Location	-14.98	-1.70	3193874.88	1401523.92	40°26'00.582"N	104°48'12.726"W
Facility Reference Pt			3193876.47	1401538.91	40°26'00.730"N	104°48'12.704"W
Field Reference Pt			3171284.48	1426358.81	40°30'07.643"N	104°53'02.634"W

WELLPATH DATUM

Calculation method	Minimum curvature	PRECISION 462 (20') (RKB) to Facility Vertical Datum	4789.00ft
Horizontal Reference Pt	Slot	PRECISION 462 (20') (RKB) to Mean Sea Level	4789.00ft
Vertical Reference Pt	PRECISION 462 (20') (RKB)	PRECISION 462 (20') (RKB) to Mud Line at Slot (SLOT#02 BOOMERANG 25N-3A-L (1332"FNL & 2327'FWL, SEC.05))	4789.00ft
MD Reference Pt	PRECISION 462 (20') (RKB)	Section Origin	N 0.00, E 0.00 ft
Field Vertical Reference	Mean Sea Level	Section Azimuth	84.24°



SRC ENERGY

Actual Wellpath Report

BOOMERANG 25N-3A-L AWP

Page 2 of 10

**BAKER
HUGHES****REFERENCE WELLPATH IDENTIFICATION**

Operator	SRC ENERGY	Slot	SLOT#02 BOOMERANG 25N-3A-L (1332"FNL & 2327'FWL, SEC.05)
Area	COLORADO	Well	BOOMERANG 25N-3A-L
Field	WELD COUNTY (NAD83, TRUE NORTH)	Wellbore	BOOMERANG 25N-3A-L AWP
Facility	SEC.05-T05N-R66W		

WELLPATH DATA (191 stations) † = interpolated/extrapolated station

MD [ft]	Inclination [°]	Azimuth [°]	TVD [ft]	Vert Sect [ft]	North [ft]	East [ft]	DLS [°/100ft]	Comments
0.00†	0.000	118.210	0.00	0.00	0.00	0.00	0.00	
20.00	0.000	118.210	20.00	0.00	0.00	0.00	0.00	
102.00	0.860	118.210	102.00	0.51	-0.29	0.54	1.05	
192.00	0.290	81.650	191.99	1.30	-0.58	1.36	0.72	
285.00	0.450	41.880	284.99	1.80	-0.27	1.84	0.32	
371.00	1.900	350.220	370.97	1.95	1.39	1.82	1.93	
461.00	3.820	351.150	460.86	1.69	5.82	1.11	2.13	
551.00	5.190	354.450	550.58	1.54	12.83	0.25	1.55	
641.00	6.440	354.090	640.11	1.54	21.91	-0.66	1.39	
731.00	8.340	355.040	729.36	1.62	33.43	-1.74	2.12	
821.00	8.810	356.290	818.35	1.96	46.81	-2.75	0.56	
911.00	9.350	355.790	907.22	2.40	60.98	-3.74	0.61	
1001.00	9.920	355.560	995.95	2.78	76.00	-4.87	0.63	
1091.00	9.680	354.430	1084.64	2.98	91.26	-6.21	0.34	
1181.00	9.320	353.910	1173.41	2.97	106.04	-7.72	0.41	
1271.00	9.810	356.810	1262.16	3.27	120.94	-8.92	0.76	
1361.00	9.340	357.490	1350.90	4.03	135.89	-9.66	0.54	
1451.00	8.950	355.630	1439.76	4.61	150.17	-10.52	0.54	
1541.00	9.500	356.060	1528.59	5.02	164.56	-11.56	0.62	
1631.00	9.050	354.680	1617.42	5.31	179.01	-12.73	0.56	
1721.00	9.380	356.150	1706.26	5.61	193.38	-13.88	0.45	
1784.00	9.490	355.490	1768.40	5.89	203.68	-14.63	0.24	
1863.00	9.270	357.220	1846.35	6.36	216.53	-15.45	0.45	
1958.00	9.490	347.0	1940.08	8.02	231.99	-15.35	1.10	
2050.00	9.520	358.880	2030.82	9.85	247.16	-15.04	0.82	
2143.00	9.480	353.880	2122.54	10.42	262.47	-16.00	0.89	
2236.00	9.380	350.450	2214.29	9.88	277.56	-18.08	0.61	
2330.00	9.400	350.680	2307.03	8.89	292.69	-20.59	0.05	
2423.00	9.480	350.020	2398.77	7.86	307.72	-23.15	0.14	
2516.00	9.480	347.070	2490.50	6.34	322.73	-26.19	0.52	



SRC ENERGY

Actual Wellpath Report

BOOMERANG 25N-3A-L AWP

Page 3 of 10

**BAKER
HUGHES****REFERENCE WELLPATH IDENTIFICATION**

Operator	SRC ENERGY	Slot	SLOT#02 BOOMERANG 25N-3A-L (1332"FNL & 2327'FWL, SEC.05)
Area	COLORADO	Well	BOOMERANG 25N-3A-L
Field	WELD COUNTY (NAD83,TRUE NORTH)	Wellbore	BOOMERANG 25N-3A-L AWB
Facility	SEC.05-T05N-R66W		

WELLPATH DATA (191 stations)

MD [ft]	Inclination [°]	Azimuth [°]	TVD [ft]	Vert Sect [ft]	North [ft]	East [ft]	DLS [°/100ft]	Comments
2609.00	9.550	344.440	2582.22	4.07	337.63	-29.97	0.47	
2703.00	9.540	345.540	2674.92	1.56	352.68	-34.01	0.19	
2798.00	9.360	345.700	2768.63	-0.77	367.79	-37.88	0.19	
2892.00	9.430	340.580	2861.37	-3.73	382.46	-42.33	0.89	
2986.00	9.360	343.420	2954.11	-6.98	397.05	-47.07	0.50	
3077.00	9.210	346.960	3043.92	-9.29	411.24	-50.83	0.65	
3172.00	9.430	348.460	3137.66	-11.04	426.27	-54.10	0.34	
3265.00	9.440	352.150	3229.41	-12.08	441.29	-56.67	0.65	
3358.00	9.230	353.050	3321.18	-12.52	456.25	-58.61	0.28	
3450.00	9.280	355.870	3411.98	-12.46	470.97	-60.04	0.50	
3544.00	9.150	354.260	3504.77	-12.24	485.97	-61.33	0.31	
3637.00	9.280	355.410	3596.56	-12.08	500.80	-62.67	0.24	
3730.00	9.540	4.600	3688.32	-10.54	515.96	-62.65	1.64	
3823.00	9.550	16.570	3780.04	-6.23	531.03	-59.83	2.13	
3918.00	9.580	13.040	3873.72	-0.69	546.29	-55.80	0.62	
4013.00	9.570	6.610	3967.40	3.55	561.84	-53.11	1.13	
4107.00	9.440	353.560	4060.12	5.14	577.26	-53.07	2.29	
4200.00	9.590	343.520	4151.85	3.61	592.27	-56.13	1.79	
4294.00	9.520	343.690	4244.54	0.73	607.24	-60.53	0.08	
4387.00	9.560	345.640	4336.26	-1.84	622.10	-64.61	0.35	
4479.00	9.460	351.320	4426.99	-3.36	636.97	-67.64	1.03	
4574.00	9.610	354.650	4520.68	-3.70	652.59	-69.56	0.60	
4667.00	9.350	355.820	4612.41	-3.44	667.85	-70.84	0.35	
4761.00	9.530	355.960	4705.14	-3.00	683.23	-71.94	0.19	
4855.00	9.430	356.870	4797.86	-2.41	698.68	-72.91	0.19	
4949.00	9.480	356.720	4890.58	-1.72	714.10	-73.77	0.06	
5042.00	9.330	357.080	4982.33	-1.01	729.27	-74.59	0.17	
5135.00	9.510	356.490	5074.07	-0.34	744.47	-75.45	0.22	
5228.00	9.300	356.320	5165.82	0.24	759.64	-76.40	0.23	
5321.00	9.380	356.440	5257.59	0.80	774.70	-77.35	0.09	



SRC ENERGY

Actual Wellpath Report

BOOMERANG 25N-3A-L AWP

Page 4 of 10

**BAKER
HUGHES****REFERENCE WELLPATH IDENTIFICATION**

Operator	SRC ENERGY	Slot	SLOT#02 BOOMERANG 25N-3A-L (1332"FNL & 2327'FWL, SEC.05)
Area	COLORADO	Well	BOOMERANG 25N-3A-L
Field	WELD COUNTY (NAD83, TRUE NORTH)	Wellbore	BOOMERANG 25N-3A-L AWB
Facility	SEC.05-T05N-R66W		

WELLPATH DATA (191 stations)

MD [ft]	Inclination [°]	Azimuth [°]	TVD [ft]	Vert Sect [ft]	North [ft]	East [ft]	DLS [°/100ft]	Comments
5414.00	9.470	359.110	5349.34	1.74	789.91	-77.94	0.48	
5507.00	9.300	7.130	5441.10	4.07	805.02	-77.13	1.42	
5600.00	9.540	11.620	5532.84	8.04	820.03	-74.64	0.83	
5693.00	9.490	8.850	5624.56	12.28	835.15	-71.91	0.50	
5785.00	9.360	3.020	5715.32	15.34	850.12	-70.35	1.05	
5878.00	9.190	358.110	5807.11	16.99	865.09	-70.20	0.87	
5971.00	9.590	7.850	5898.87	19.32	880.19	-69.39	1.76	
6065.00	9.540	4.160	5991.56	22.50	895.71	-67.75	0.65	
6158.00	9.400	1.950	6083.30	24.85	910.99	-66.93	0.42	
6251.00	9.440	356.720	6175.04	26.20	926.20	-67.11	0.92	
6344.00	11.560	7.380	6266.49	28.65	943.05	-66.35	3.08	
6438.00	20.100	33.370	6356.95	41.02	965.95	-56.23	11.60	
6531.00	22.260	64.010	6443.92	67.72	987.08	-31.52	11.99	
6624.00	28.160	86.390	6528.22	106.29	996.21	6.33	11.95	
6716.00	36.740	89.190	6605.79	155.50	997.97	55.60	9.47	
6809.00	44.840	86.620	6676.14	216.07	1000.30	116.25	8.89	
6902.00	54.440	84.410	6736.30	286.83	1005.94	186.80	10.48	
6995.00	63.000	83.430	6784.55	366.24	1014.38	265.76	9.25	
7088.00	70.160	82.160	6821.49	451.49	1025.10	350.36	7.80	
7181.00	73.910	82.620	6850.17	539.89	1036.81	438.03	4.06	
7273.00	82.070	83.710	6869.30	629.79	1047.49	527.31	8.94	LANDING POINT (296'FNL & 2526'FEL, SEC.05)
7367.00	87.780	84.320	6877.61	723.38	1057.25	620.39	6.11	
7459.00	87.630	85.830	6881.29	815.29	1065.14	711.97	1.65	
7554.00	87.630	86.460	6885.22	910.16	1071.52	806.68	0.66	
7649.00	87.540	86.710	6889.22	1004.99	1077.18	901.42	0.28	
7742.00	87.600	87.760	6893.17	1097.78	1081.66	994.23	1.13	
7836.00	87.570	88.630	6897.13	1191.47	1084.62	1088.10	0.93	
7929.00	87.630	88.970	6901.02	1284.10	1086.56	1181.00	0.37	
8023.00	87.750	89.330	6904.81	1377.68	1087.96	1274.91	0.40	
8117.00	87.510	90.690	6908.70	1471.12	1087.94	1368.83	1.47	



SRC ENERGY

Actual Wellpath Report

BOOMERANG 25N-3A-L AWP

Page 5 of 10

**BAKER
HUGHES****REFERENCE WELLPATH IDENTIFICATION**

Operator	SRC ENERGY	Slot	SLOT#02 BOOMERANG 25N-3A-L (1332"FNL & 2327'FWL, SEC.05)
Area	COLORADO	Well	BOOMERANG 25N-3A-L
Field	WELD COUNTY (NAD83, TRUE NORTH)	Wellbore	BOOMERANG 25N-3A-L AWB
Facility	SEC.05-T05N-R66W		

WELLPATH DATA (191 stations)

MD [ft]	Inclination [°]	Azimuth [°]	TVD [ft]	Vert Sect [ft]	North [ft]	East [ft]	DLS [°/100ft]	Comments
8210.00	87.720	92.410	6912.57	1563.28	1085.43	1461.71	1.86	
8303.00	87.750	93.920	6916.24	1655.08	1080.30	1554.49	1.62	
8396.00	87.570	93.940	6920.04	1746.67	1073.93	1647.20	0.19	
8489.00	87.750	93.370	6923.84	1838.34	1068.01	1739.93	0.64	
8583.00	88.430	92.900	6926.97	1931.16	1062.87	1833.73	0.88	
8677.00	88.180	91.720	6929.75	2024.19	1059.08	1927.62	1.28	
8770.00	88.430	90.590	6932.50	2116.47	1057.21	2020.55	1.24	
8864.00	88.220	90.050	6935.25	2209.90	1056.68	2114.51	0.62	
8959.00	88.340	89.940	6938.10	2304.38	1056.69	2209.47	0.17	
9052.00	88.310	89.460	6940.82	2396.92	1057.18	2302.43	0.52	
9146.00	88.220	89.660	6943.67	2490.47	1057.90	2396.38	0.23	
9239.00	88.400	89.560	6946.41	2583.02	1058.53	2489.34	0.22	
9332.00	88.400	90.030	6949.01	2675.55	1058.86	2582.30	0.51	
9425.00	88.180	89.330	6951.78	2768.09	1059.38	2675.26	0.79	
9518.00	88.250	88.890	6954.68	2860.70	1060.83	2768.20	0.48	
9611.00	88.180	89.110	6957.58	2953.34	1062.45	2861.14	0.25	
9704.00	88.460	88.450	6960.30	3046.01	1064.43	2954.08	0.77	
9798.00	88.430	88.050	6962.85	3139.74	1067.30	3048.00	0.43	
9892.00	88.030	86.960	6965.76	3233.54	1071.39	3141.87	1.23	
9984.00	88.090	87.460	6968.87	3325.37	1075.86	3233.71	0.55	
10079.00	88.250	89.260	6971.90	3420.07	1078.58	3328.61	1.90	
10172.00	88.220	90.600	6974.77	3512.56	1078.69	3421.57	1.44	
10265.00	88.250	91.560	6977.63	3604.86	1076.94	3514.51	1.03	
10359.00	88.280	92.280	6980.48	3697.97	1073.79	3608.41	0.77	
10452.00	88.280	92.510	6983.27	3789.99	1069.91	3701.29	0.25	
10547.00	88.180	92.880	6986.21	3883.91	1065.44	3796.14	0.40	
10642.00	88.090	92.550	6989.30	3977.82	1060.95	3890.98	0.36	
10734.00	88.060	91.030	6992.39	4068.97	1058.08	3982.88	1.65	
10826.00	89.320	91.670	6994.49	4160.24	1055.91	4074.83	1.54	
10918.00	89.290	95.530	6995.61	4250.99	1050.13	4166.62	4.20	



SRC ENERGY

Actual Wellpath Report

BOOMERANG 25N-3A-L AWP

Page 6 of 10

**BAKER
HUGHES****REFERENCE WELLPATH IDENTIFICATION**

Operator	SRC ENERGY	Slot	SLOT#02 BOOMERANG 25N-3A-L (1332"FNL & 2327'FWL, SEC.05)
Area	COLORADO	Well	BOOMERANG 25N-3A-L
Field	WELD COUNTY (NAD83, TRUE NORTH)	Wellbore	BOOMERANG 25N-3A-L AWB
Facility	SEC.05-T05N-R66W		

WELLPATH DATA (191 stations)

MD [ft]	Inclination [°]	Azimuth [°]	TVD [ft]	Vert Sect [ft]	North [ft]	East [ft]	DLS [°/100ft]	Comments
11011.00	89.350	96.810	6996.71	4341.97	1040.14	4259.07	1.38	
11102.00	89.450	93.040	6997.66	4431.37	1032.33	4349.72	4.14	
11197.00	89.510	88.540	6998.53	4525.72	1031.02	4444.68	4.74	
11289.00	89.630	100.590	6999.22	4616.06	1023.71	4536.22	13.10	
11383.00	90.120	101.970	6999.43	4705.93	1005.32	4628.40	1.56	
11476.00	89.660	84.320	6999.61	4797.45	1000.24	4720.89	18.98	
11569.00	89.110	87.130	7000.60	4890.40	1007.17	4813.62	3.08	
11664.00	89.260	88.140	7001.95	4985.23	1011.09	4908.53	1.07	
11759.00	89.140	88.200	7003.28	5079.99	1014.13	5003.47	0.14	
11851.00	89.020	88.310	7004.76	5171.75	1016.93	5095.41	0.18	
11944.00	88.990	87.840	7006.37	5264.53	1020.05	5188.35	0.51	
12036.00	89.020	86.580	7007.97	5356.39	1024.53	5280.22	1.37	
12129.00	88.830	85.730	7009.72	5449.32	1030.76	5372.99	0.94	
12222.00	89.350	84.520	7011.19	5542.30	1038.67	5465.64	1.42	
12316.00	89.320	83.010	7012.28	5636.29	1048.87	5559.08	1.61	
12409.00	89.420	84.000	7013.31	5729.27	1059.39	5651.48	1.07	
12502.00	89.260	84.050	7014.38	5822.27	1069.07	5743.96	0.18	
12595.00	89.230	86.880	7015.60	5915.23	1076.42	5836.66	3.04	
12688.00	89.380	87.560	7016.73	6008.09	1080.93	5929.54	0.75	
12781.00	89.540	87.350	7017.61	6100.94	1085.06	6022.44	0.28	
12874.00	89.420	87.630	7018.45	6193.79	1089.14	6115.35	0.33	
12967.00	89.540	88.210	7019.30	6286.59	1092.51	6208.28	0.64	
13059.00	89.380	88.730	7020.16	6378.34	1094.97	6300.25	0.59	
13153.00	89.660	89.050	7020.95	6472.02	1096.79	6394.23	0.45	
13247.00	89.540	90.610	7021.61	6565.57	1097.07	6488.22	1.66	
13340.00	90.150	92.980	7021.86	6657.76	1094.16	6581.17	2.63	
13432.00	90.000	92.510	7021.74	6748.75	1089.75	6673.06	0.54	
13525.00	89.970	91.710	7021.76	6840.87	1086.33	6766.00	0.86	
13617.00	92.150	91.590	7020.06	6932.08	1083.68	6857.94	2.37	
13709.00	92.740	91.420	7016.14	7023.26	1081.26	6949.82	0.67	



SRC ENERGY

Actual Wellpath Report

BOOMERANG 25N-3A-L AWP

Page 7 of 10

**BAKER
HUGHES****REFERENCE WELLPATH IDENTIFICATION**

Operator	SRC ENERGY	Slot	SLOT#02 BOOMERANG 25N-3A-L (1332"FNL & 2327'FWL, SEC.05)
Area	COLORADO	Well	BOOMERANG 25N-3A-L
Field	WELD COUNTY (NAD83, TRUE NORTH)	Wellbore	BOOMERANG 25N-3A-L AWB
Facility	SEC.05-T05N-R66W		

WELLPATH DATA (191 stations)

MD [ft]	Inclination [°]	Azimuth [°]	TVD [ft]	Vert Sect [ft]	North [ft]	East [ft]	DLS [°/100ft]	Comments
13802.00	93.020	90.960	7011.46	7115.46	1079.33	7042.68	0.58	
13895.00	92.950	90.850	7006.62	7207.70	1077.87	7135.55	0.14	
13987.00	92.860	90.100	7001.96	7299.04	1077.11	7227.42	0.82	
14081.00	92.830	89.320	6997.29	7392.49	1077.58	7321.31	0.83	
14174.00	93.200	88.930	6992.40	7485.03	1079.00	7414.17	0.58	
14269.00	92.090	88.580	6988.02	7579.63	1081.06	7509.04	1.23	
14363.00	90.400	89.040	6985.97	7673.31	1083.01	7603.00	1.86	
14457.00	90.180	88.900	6985.50	7766.98	1084.70	7696.98	0.28	
14551.00	90.250	87.950	6985.15	7860.73	1087.29	7790.94	1.01	
14644.00	90.180	88.740	6984.80	7953.49	1089.97	7883.90	0.85	
14738.00	90.150	91.350	6984.53	8047.00	1089.90	7977.89	2.78	
14833.00	90.150	94.370	6984.28	8140.92	1085.16	8072.76	3.18	
14927.00	89.940	95.730	6984.20	8233.25	1076.88	8166.40	1.46	
15021.00	89.750	93.480	6984.46	8325.71	1069.34	8260.09	2.40	
15115.00	89.940	94.470	6984.71	8418.35	1062.82	8353.86	1.07	
15208.00	90.180	95.480	6984.61	8509.72	1054.76	8446.51	1.12	
15302.00	89.970	94.870	6984.49	8602.01	1046.28	8540.12	0.69	
15395.00	90.370	94.180	6984.22	8693.52	1038.94	8632.83	0.86	
15488.00	90.710	93.790	6983.34	8785.17	1032.48	8725.60	0.56	
15581.00	91.140	91.530	6981.84	8877.15	1028.16	8818.48	2.47	
15673.00	91.080	90.470	6980.06	8968.49	1026.56	8910.45	1.15	
15766.00	89.260	86.090	6979.78	9061.23	1029.35	9003.38	5.10	
15953.00	89.600	85.240	6981.64	9248.17	1043.48	9189.84	0.49	
16046.00	89.690	87.350	6982.22	9341.10	1049.49	9282.64	2.27	
16138.00	90.000	91.730	6982.46	9432.68	1050.23	9374.61	4.77	
16230.00	90.030	90.070	6982.44	9524.06	1048.78	9466.60	1.80	
16323.00	89.880	87.330	6982.51	9616.77	1050.89	9559.56	2.95	
16416.00	89.850	85.880	6982.73	9709.69	1056.40	9652.40	1.56	
16510.00	90.030	85.100	6982.83	9803.66	1063.79	9746.10	0.85	
16604.00	89.880	84.250	6982.91	9897.66	1072.52	9839.70	0.92	



Actual Wellpath Report

BOOMERANG 25N-3A-L AWP

Page 8 of 10



REFERENCE WELLPATH IDENTIFICATION

Operator	SRC ENERGY	Slot	SLOT#02 BOOMERANG 25N-3A-L (1332"FNL & 2327'FWL, SEC.05)
Area	COLORADO	Well	BOOMERANG 25N-3A-L
Field	WELD COUNTY (NAD83,TRUE NORTH)	Wellbore	BOOMERANG 25N-3A-L AWB
Facility	SEC.05-T05N-R66W		

WELLPATH DATA (191 stations)

MD [ft]	Inclination [°]	Azimuth [°]	TVD [ft]	Vert Sect [ft]	North [ft]	East [ft]	DLS [°/100ft]	Comments
16699.00	91.510	85.780	6981.75	9992.64	1080.77	9934.33	2.35	
16793.00	91.320	87.100	6979.43	10086.54	1086.61	10028.11	1.42	
16979.00	89.720	87.110	6977.74	10272.29	1096.00	10213.86	0.86	
17072.00	89.820	85.940	6978.12	10365.21	1101.64	10306.69	1.26	
17165.00	90.400	87.530	6977.94	10458.12	1106.93	10399.53	1.82	
17259.00	90.220	89.460	6977.43	10551.86	1109.40	10493.50	2.06	
17351.00	90.150	91.200	6977.13	10643.33	1108.87	10585.49	1.89	
17444.00	90.220	91.930	6976.83	10735.57	1106.33	10678.45	0.79	
17537.00	89.940	90.760	6976.70	10827.86	1104.15	10771.43	1.29	
17606.00	89.850	91.680	6976.83	10896.34	1102.68	10840.41	1.34	LAST BHI MWD SURVEY (306'FNL & 2476'FWL, SEC.03)
17630.00	89.850	91.680	6976.89	10920.14	1101.98	10864.40	0.00	PROJECTION TO BIT (306'FNL & 2500'FWL, SEC.03)

HOLE & CASING SECTIONS

- Ref Wellbore: BOOMERANG 25N-3A-L AWB Ref Wellpath: BOOMERANG 25N-3A-L AWP

String/Diameter	Start MD [ft]	End MD [ft]	Interval [ft]	Start TVD [ft]	End TVD [ft]	Start N/S [ft]	Start E/W [ft]	End N/S [ft]	End E/W [ft]
13.5in Open Hole	20.00	1784.00	1764.00	20.00	1768.40	0.00	0.00	203.68	-14.63
9.625in Casing Surface	20.00	1784.00	1764.00	20.00	1768.40	0.00	0.00	203.68	-14.63
8.5in Open Hole	1784.00	17630.00	15846.00	1768.40	6976.89	203.68	-14.63	1101.98	10864.40

TARGETS

Name	TVD [ft]	North [ft]	East [ft]	Grid East [US ft]	Grid North [US ft]	Latitude	Longitude	Shape
SEC.03-T05N-R66W	15.00	14.98	1.70	3193876.47	1401538.91	40°26'00.730"N	104°48'12.704"W	polygon
SEC.04-T05N-R66W	15.00	14.98	1.70	3193876.47	1401538.91	40°26'00.730"N	104°48'12.704"W	polygon
SEC.05-T05N-R66W	15.00	14.98	1.70	3193876.47	1401538.91	40°26'00.730"N	104°48'12.704"W	polygon
SEC.06-T05N-R66W	15.00	14.98	1.70	3193876.47	1401538.91	40°26'00.730"N	104°48'12.704"W	polygon
BOOMERANG 25N-3A-L TOP OF PROD ON PLAT (300'FNL & 2487'FEL, SEC.05)	6845.00	1043.06	566.18	3194432.83	1402571.36	40°26'10.889"N	104°48'05.404"W	circle
BOOMERANG 25N-3A-L Rev-2 TOP OF PROD ON PLAT (300'FNL & 2487'FEL, SEC.05)	6873.48	1043.06	566.18	3194432.83	1402571.36	40°26'10.889"N	104°48'05.404"W	circle
BOOMERANG 25N-3A-L Target 1	6925.34	1049.08	1780.79	3195647.31	1402586.92	40°26'10.948"N	104°47'49.696"W	point
BOOMERANG 25N-3A-L BHL ON PLAT (314'FNL & 2481'FWL, SEC.03)	6951.00	1094.23	10845.91	3204711.43	1402703.26	40°26'11.371"N	104°45'52.463"W	circle
BOOMERANG 25N-3A-L REV-2 BHL ON PLAT (314'FNL & 2481'FWL, SEC.03)	6985.50	1094.21	10845.90	3204711.42	1402703.24	40°26'11.371"N	104°45'52.463"W	circle
BOOMERANG 25N-3A-L Target 5	6985.50	1087.50	9733.10	3203598.75	1402687.79	40°26'11.309"N	104°46'06.854"W	point
BOOMERANG 25N-3A-L Target 4	6987.70	1077.00	7515.95	3201381.84	1402659.88	40°26'11.213"N	104°46'35.527"W	point

TARGETS

Name	TVD [ft]	North [ft]	East [ft]	Grid East [US ft]	Grid North [US ft]	Latitude	Longitude	Shape
BOOMERANG 25N-3A-L Target 2	6993.40	1060.11	3997.78	3197864.05	1402615.36	40°26'11.054"N	104°47'21.025"W	point

TARGETS

Name	TVD [ft]	North [ft]	East [ft]	Grid East [US ft]	Grid North [US ft]	Latitude	Longitude	Shape
BOOMERANG 25N-3A-L Target 3	7024.10	1072.77	6642.87	3200508.86	1402648.79	40°26'11.174"N	104°46'46.818"W	point



Actual Wellpath Report

BOOMERANG 25N-3A-L AWP

Page 9 of 10



REFERENCE WELLPATH IDENTIFICATION			
Operator	SRC ENERGY	Slot	SLOT#02 BOOMERANG 25N-3A-L (1332"FNL & 2327'FWL, SEC.05)
Area	COLORADO	Well	BOOMERANG 25N-3A-L
Field	WELD COUNTY (NAD83, TRUE NORTH)	Wellbore	BOOMERANG 25N-3A-L AWB
Facility	SEC.05-T05N-R66W		

WELLPATH COMPOSITION - Ref Wellbore: BOOMERANG 25N-3A-L AWB Ref Wellpath: BOOMERANG 25N-3A-L AWP				
Start MD [ft]	End MD [ft]	Positional Uncertainty Model	Log Name/Comment	Wellbore
20.00	1784.00	BHI NaviTrak (Standard)	13 1/2" SURFACE SECTION <86-1768>	BOOMERANG 25N-3A-L AWB
1784.00	17606.00	BHI AutoTrak Curve (IFR1, Short)	8 1/2" MONOBORE SURVEYS <1863'-17606'>	BOOMERANG 25N-3A-L AWB
17606.00	17630.00	Blind Drilling (std)	Projection to bit	BOOMERANG 25N-3A-L AWB



Actual Wellpath Report

BOOMERANG 25N-3A-L AWP

Page 10 of 10



REFERENCE WELLPATH IDENTIFICATION

Operator	SRC ENERGY	Slot	SLOT#02 BOOMERANG 25N-3A-L (1332"FNL & 2327'FWL, SEC.05)
Area	COLORADO	Well	BOOMERANG 25N-3A-L
Field	WELD COUNTY (NAD83, TRUE NORTH)	Wellbore	BOOMERANG 25N-3A-L AWB
Facility	SEC.05-T05N-R66W		

WELLPATH COMMENTS

MD [ft]	Inclination [°]	Azimuth [°]	TVD [ft]	Comment
7273.00	82.070	83.710	6869.30	LANDING POINT (296'FNL & 2526'FEL, SEC.05)
17606.00	89.850	91.680	6976.83	LAST BHI MWD SURVEY (306'FNL & 2476'FWL, SEC.03)
17630.00	89.850	91.680	6976.89	PROJECTION TO BIT (306'FNL & 2500'FWL, SEC.03)