

# SRC ENERGY

Location: COLORADO Slot: SLOT#01 BOOMERANG 25N-3B-L (1317'FNL & 2327'FWL, SEC.05)  
Field: WELD COUNTY (NAD83, TRUE NORTH) Well: BOOMERANG 25N-3B-L  
Facility: SEC.05-T05N-R66W Wellbore: BOOMERANG 25N-3B-L PWB

|  |  |
|--|--|
| Plot reference wellpath is BOOMERANG 25N-3B-L PWP (REV.B.0)  | Grid System: NAD83 / Lambert Colorado SP, Northern Zone (501), US feet |
| True vertical depths are referenced to PRECISION 462 (20') (RKB)                                       | * = Wellpath was transformed from a different geodetic datum           |
| Measured depths are referenced to PRECISION 462 (20') (RKB)  | North Reference: True north  |
| PRECISION 462 (20') (RKB) to Mean Sea Level: 4789 feet   | Scale: True distance   |
| Mean Sea Level to Mud line (At Slot: SLOT#01 BOOMERANG 25N-3B-L (1317'FNL & 2327'FWL, SEC.05)): 0 feet | Depths are in feet   |
| Coordinates are in feet referenced to Slot   | Created by: doddanna on 2018-04-12                                     |
|  | Database: WellArchitectDB  |

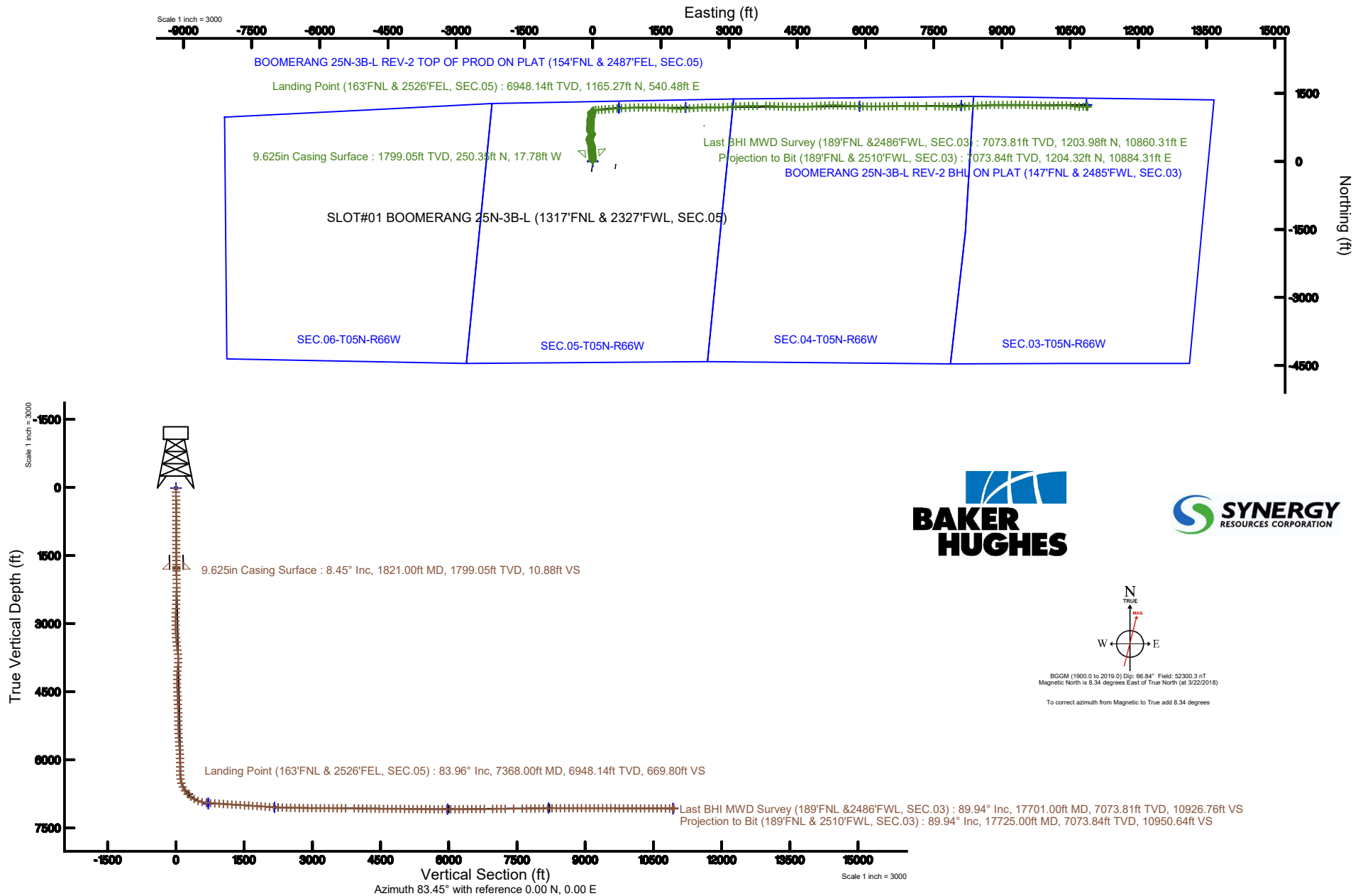



SRC ENERGY

# Actual Wellpath Report

BOOMERANG 25N-3B-L AWP

Page 1 of 11

**BAKER  
HUGHES**

## REFERENCE WELLPATH IDENTIFICATION

|          |                                 |          |  |
|----------|---------------------------------|----------|--|
| Operator | SRC ENERGY                      | Slot     | SLOT#01 BOOMERANG 25N-3B-L (1317'FNL & 2327'FWL, SEC.05) |
| Area     | COLORADO                        | Well     | BOOMERANG 25N-3B-L                                       |
| Field    | WELD COUNTY (NAD83, TRUE NORTH) | Wellbore | BOOMERANG 25N-3B-L AWB                                   |
| Facility | SEC.05-T05N-R66W                |          |  |

## REPORT SETUP INFORMATION

|                     |   |                      |  |
|---------------------|---|----------------------|--|
| Projection System   | NAD83 / Lambert Colorado SP, Northern Zone (501), US feet | Software System      | WellArchitect® 5.0                         |
| North Reference     | True  | User                 | Doddanna                                   |
| Scale               | 0.999962  | Report Generated     | 4/12/2018 at 1:55:00 PM                    |
| Convergence at slot | 0.45° East  | Database/Source file | WellArchitectDB/BOOMERANG_25N-3B-L_AWP.xml |

## WELLPATH LOCATION

|                       | Local coordinates |          | Grid coordinates |                 | Geographic coordinates |                 |
|-----------------------|-------------------|----------|------------------|-----------------|------------------------|-----------------|
|                       | North[ft]         | East[ft] | Easting[US ft]   | Northing[US ft] | Latitude               | Longitude       |
| Slot Location         | 0.00              | 0.00     | 3193876.47       | 1401538.91      | 40°26'00.730"N         | 104°48'12.704"W |
| Facility Reference Pt |                   |          | 3193876.47       | 1401538.91      | 40°26'00.730"N         | 104°48'12.704"W |
| Field Reference Pt    |                   |          | 3171284.48       | 1426358.81      | 40°30'07.643"N         | 104°53'02.634"W |

## WELLPATH DATUM

|                          |                           |  |                   |
|--------------------------|---------------------------|--|-------------------|
| Calculation method       | Minimum curvature         | PRECISION 462 (20') (RKB) to Facility Vertical Datum   | 4789.00ft         |
| Horizontal Reference Pt  | Slot                      | PRECISION 462 (20') (RKB) to Mean Sea Level  | 4789.00ft         |
| Vertical Reference Pt    | PRECISION 462 (20') (RKB) | PRECISION 462 (20') (RKB) to Mud Line at Slot (SLOT#01 BOOMERANG 25N-3B-L (1317'FNL & 2327'FWL, SEC.05)) | 4789.00ft         |
| MD Reference Pt          | PRECISION 462 (20') (RKB) | Section Origin   | N 0.00, E 0.00 ft |
| Field Vertical Reference | Mean Sea Level            | Section Azimuth  | 83.45°            |



SRC ENERGY

# Actual Wellpath Report

BOOMERANG 25N-3B-L AWP

Page 2 of 11

**BAKER  
HUGHES****REFERENCE WELLPATH IDENTIFICATION**

|          |                                 |          |  |
|----------|---------------------------------|----------|--|
| Operator | SRC ENERGY                      | Slot     | SLOT#01 BOOMERANG 25N-3B-L (1317'FNL & 2327'FWL, SEC.05) |
| Area     | COLORADO                        | Well     | BOOMERANG 25N-3B-L                                       |
| Field    | WELD COUNTY (NAD83, TRUE NORTH) | Wellbore | BOOMERANG 25N-3B-L AWB                                   |
| Facility | SEC.05-T05N-R66W                |          |  |

**WELLPATH DATA (190 stations)** † = interpolated/extrapolated station

| MD<br>[ft] | Inclination<br>[°] | Azimuth<br>[°] | TVD<br>[ft] | Vert Sect<br>[ft] | North<br>[ft] | East<br>[ft] | DLS<br>[°/100ft] | Comments |
|------------|--------------------|----------------|-------------|-------------------|---------------|--------------|------------------|----------|
| 0.00†      | 0.000              | 101.420        | 0.00        | 0.00              | 0.00          | 0.00         | 0.00             |          |
| 20.00      | 0.000              | 101.420        | 20.00       | 0.00              | 0.00          | 0.00         | 0.00             |          |
| 102.00     | 1.710              | 101.420        | 101.99      | 1.16              | -0.24         | 1.20         | 2.09             |          |
| 192.00     | 1.000              | 86.720         | 191.96      | 3.23              | -0.46         | 3.30         | 0.87             |          |
| 285.00     | 2.590              | 2.150          | 284.92      | 4.35              | 1.68          | 4.19         | 2.89             |          |
| 371.00     | 4.210              | 352.780        | 370.77      | 4.61              | 6.76          | 3.87         | 1.99             |          |
| 461.00     | 4.560              | 355.440        | 460.51      | 4.70              | 13.60         | 3.17         | 0.45             |          |
| 551.00     | 7.150              | 356.310        | 550.03      | 5.10              | 22.76         | 2.52         | 2.88             |          |
| 641.00     | 8.530              | 357.140        | 639.19      | 5.81              | 35.01         | 1.83         | 1.54             |          |
| 731.00     | 9.810              | 354.990        | 728.04      | 6.44              | 49.32         | 0.82         | 1.47             |          |
| 821.00     | 10.860             | 355.110        | 816.57      | 6.89              | 65.41         | -0.57        | 1.17             |          |
| 911.00     | 10.640             | 354.210        | 904.99      | 7.25              | 82.12         | -2.13        | 0.31             |          |
| 1001.00    | 10.660             | 353.510        | 993.44      | 7.36              | 98.66         | -3.91        | 0.15             |          |
| 1091.00    | 11.200             | 353.100        | 1081.81     | 7.32              | 115.60        | -5.90        | 0.61             |          |
| 1181.00    | 11.590             | 353.120        | 1170.04     | 7.21              | 133.26        | -8.03        | 0.43             |          |
| 1271.00    | 11.520             | 353.550        | 1258.21     | 7.17              | 151.16        | -10.12       | 0.12             |          |
| 1361.00    | 11.670             | 354.770        | 1346.38     | 7.40              | 169.16        | -11.96       | 0.32             |          |
| 1451.00    | 11.090             | 355.120        | 1434.61     | 7.86              | 186.85        | -13.53       | 0.65             |          |
| 1541.00    | 10.790             | 356.760        | 1522.97     | 8.60              | 203.88        | -14.74       | 0.48             |          |
| 1631.00    | 9.870              | 356.790        | 1611.51     | 9.53              | 220.00        | -15.65       | 1.02             |          |
| 1721.00    | 9.300              | 355.870        | 1700.25     | 10.29             | 234.95        | -16.61       | 0.66             |          |
| 1769.00    | 8.910              | 355.590        | 1747.65     | 10.59             | 242.52        | -17.17       | 0.82             |          |
| 1864.00    | 8.070              | 355.510        | 1841.61     | 11.10             | 256.51        | -18.26       | 0.88             |          |
| 1958.00    | 11.540             | 4.140          | 1934.23     | 13.08             | 272.47        | -18.10       | 4.00             |          |
| 2051.00    | 11.450             | 1.980          | 2025.36     | 16.18             | 290.97        | -17.11       | 0.47             |          |
| 2144.00    | 10.580             | 353.390        | 2116.65     | 17.54             | 308.68        | -17.77       | 1.99             |          |
| 2236.00    | 10.240             | 345.390        | 2207.14     | 16.38             | 324.98        | -20.81       | 1.61             |          |
| 2330.00    | 10.350             | 344.380        | 2299.63     | 13.88             | 341.20        | -25.19       | 0.22             |          |
| 2423.00    | 10.400             | 343.530        | 2391.11     | 11.11             | 357.30        | -29.82       | 0.17             |          |
| 2516.00    | 10.300             | 341.730        | 2482.60     | 7.98              | 373.24        | -34.80       | 0.36             |          |



SRC ENERGY

# Actual Wellpath Report

BOOMERANG 25N-3B-L AWP

Page 3 of 11

**BAKER  
HUGHES****REFERENCE WELLPATH IDENTIFICATION**

|          |                                |          |  |
|----------|--------------------------------|----------|--|
| Operator | SRC ENERGY                     | Slot     | SLOT#01 BOOMERANG 25N-3B-L (1317'FNL & 2327'FWL, SEC.05) |
| Area     | COLORADO                       | Well     | BOOMERANG 25N-3B-L                                       |
| Field    | WELD COUNTY (NAD83,TRUE NORTH) | Wellbore | BOOMERANG 25N-3B-L AWB                                   |
| Facility | SEC.05-T05N-R66W               |          |  |

**WELLPATH DATA (190 stations)**

| MD<br>[ft] | Inclination<br>[°] | Azimuth<br>[°] | TVD<br>[ft] | Vert Sect<br>[ft] | North<br>[ft] | East<br>[ft] | DLS<br>[°/100ft] | Comments |
|------------|--------------------|----------------|-------------|-------------------|---------------|--------------|------------------|----------|
| 2610.00    | 10.260             | 339.470        | 2575.09     | 4.25              | 389.06        | -40.37       | 0.43             |          |
| 2704.00    | 10.340             | 340.510        | 2667.57     | 0.33              | 404.85        | -46.12       | 0.22             |          |
| 2799.00    | 10.310             | 340.820        | 2761.03     | -3.44             | 420.92        | -51.76       | 0.07             |          |
| 2892.00    | 10.380             | 343.080        | 2852.52     | -6.77             | 436.80        | -56.93       | 0.44             |          |
| 2986.00    | 10.440             | 347.620        | 2944.98     | -9.16             | 453.22        | -61.22       | 0.87             |          |
| 3078.00    | 10.390             | 355.730        | 3035.47     | -9.67             | 469.63        | -63.63       | 1.59             |          |
| 3172.00    | 10.210             | 6.730          | 3127.96     | -7.42             | 486.36        | -63.28       | 2.10             |          |
| 3265.00    | 10.440             | 13.510         | 3219.46     | -2.64             | 502.74        | -60.35       | 1.33             |          |
| 3358.00    | 10.720             | 21.490         | 3310.88     | 4.31              | 518.98        | -55.21       | 1.60             |          |
| 3451.00    | 10.140             | 27.810         | 3402.35     | 13.00             | 534.27        | -48.22       | 1.38             |          |
| 3544.00    | 10.870             | 31.300         | 3493.79     | 23.00             | 549.01        | -39.85       | 1.04             |          |
| 3637.00    | 10.890             | 34.020         | 3585.12     | 34.09             | 563.78        | -30.38       | 0.55             |          |
| 3731.00    | 11.440             | 28.400         | 3677.34     | 45.21             | 579.34        | -20.98       | 1.30             |          |
| 3824.00    | 11.620             | 5.580          | 3768.51     | 52.46             | 596.78        | -15.68       | 4.88             |          |
| 3918.00    | 11.870             | 326.430        | 3860.69     | 50.06             | 614.29        | -20.11       | 8.32             |          |
| 4013.00    | 11.360             | 319.840        | 3953.75     | 40.44             | 629.58        | -31.54       | 1.50             |          |
| 4107.00    | 11.410             | 332.500        | 4045.91     | 31.98             | 644.91        | -41.81       | 2.65             |          |
| 4200.00    | 11.340             | 343.880        | 4137.10     | 27.17             | 661.85        | -48.60       | 2.41             |          |
| 4294.00    | 11.520             | 352.570        | 4229.24     | 25.49             | 680.04        | -52.38       | 1.84             |          |
| 4387.00    | 11.440             | 359.750        | 4320.38     | 26.36             | 698.47        | -53.62       | 1.54             |          |
| 4480.00    | 11.410             | 359.670        | 4411.54     | 28.37             | 716.89        | -53.71       | 0.04             |          |
| 4574.00    | 11.480             | 3.090          | 4503.67     | 30.94             | 735.53        | -53.26       | 0.73             |          |
| 4667.00    | 11.250             | 6.150          | 4594.85     | 34.48             | 753.79        | -51.79       | 0.69             |          |
| 4761.00    | 11.440             | 7.730          | 4687.01     | 38.80             | 772.15        | -49.55       | 0.39             |          |
| 4855.00    | 11.450             | 7.490          | 4779.14     | 43.36             | 790.63        | -47.08       | 0.05             |          |
| 4949.00    | 10.160             | 0.780          | 4871.48     | 46.68             | 808.18        | -45.75       | 1.91             |          |
| 5042.00    | 10.220             | 359.270        | 4963.01     | 48.56             | 824.63        | -45.75       | 0.29             |          |
| 5135.00    | 10.000             | 359.850        | 5054.57     | 50.30             | 840.95        | -45.87       | 0.26             |          |
| 5229.00    | 10.180             | 359.680        | 5147.11     | 52.11             | 857.42        | -45.94       | 0.19             |          |
| 5322.00    | 10.140             | 356.300        | 5238.66     | 53.40             | 873.81        | -46.52       | 0.64             |          |



SRC ENERGY

# Actual Wellpath Report

BOOMERANG 25N-3B-L AWP

Page 4 of 11

**BAKER  
HUGHES****REFERENCE WELLPATH IDENTIFICATION**

|          |                                 |          |  |
|----------|---------------------------------|----------|--|
| Operator | SRC ENERGY                      | Slot     | SLOT#01 BOOMERANG 25N-3B-L (1317'FNL & 2327'FWL, SEC.05) |
| Area     | COLORADO                        | Well     | BOOMERANG 25N-3B-L                                       |
| Field    | WELD COUNTY (NAD83, TRUE NORTH) | Wellbore | BOOMERANG 25N-3B-L AWB                                   |
| Facility | SEC.05-T05N-R66W                |          |  |

**WELLPATH DATA (190 stations)**

| MD<br>[ft] | Inclination<br>[°] | Azimuth<br>[°] | TVD<br>[ft] | Vert Sect<br>[ft] | North<br>[ft] | East<br>[ft] | DLS<br>[°/100ft] | Comments                                   |
|------------|--------------------|----------------|-------------|-------------------|---------------|--------------|------------------|--|
| 5415.00    | 10.340             | 357.440        | 5330.18     | 54.39             | 890.31        | -47.42       | 0.31             |  |
| 5507.00    | 10.130             | 6.060          | 5420.72     | 56.73             | 906.61        | -46.93       | 1.68             |  |
| 5601.00    | 10.310             | 15.880         | 5513.23     | 61.74             | 922.92        | -43.76       | 1.86             |  |
| 5693.00    | 10.310             | 16.850         | 5603.75     | 68.15             | 938.72        | -39.12       | 0.19             |  |
| 5786.00    | 10.190             | 17.800         | 5695.26     | 74.85             | 954.52        | -34.19       | 0.22             |  |
| 5878.00    | 10.400             | 12.750         | 5785.78     | 80.95             | 970.37        | -29.87       | 1.01             |  |
| 5971.00    | 10.330             | 4.940          | 5877.27     | 85.38             | 986.86        | -27.30       | 1.51             |  |
| 6065.00    | 10.270             | 4.050          | 5969.76     | 88.60             | 1003.62       | -25.98       | 0.18             |  |
| 6158.00    | 10.190             | 0.370          | 6061.28     | 91.12             | 1020.11       | -25.34       | 0.71             |  |
| 6252.00    | 10.210             | 355.410        | 6153.79     | 92.40             | 1036.73       | -25.96       | 0.93             |  |
| 6345.00    | 10.360             | 353.310        | 6245.30     | 92.66             | 1053.25       | -27.59       | 0.43             |  |
| 6438.00    | 10.810             | 1.310          | 6336.72     | 93.84             | 1070.28       | -28.37       | 1.65             |  |
| 6532.00    | 15.010             | 22.620         | 6428.38     | 100.98            | 1090.35       | -23.48       | 6.68             |  |
| 6624.00    | 18.610             | 55.230         | 6516.62     | 119.77            | 1109.76       | -6.79        | 10.80            |  |
| 6716.00    | 25.400             | 76.960         | 6602.01     | 152.40            | 1122.62       | 24.57        | 11.41            |  |
| 6809.00    | 34.520             | 82.180         | 6682.51     | 198.67            | 1130.73       | 70.22        | 10.19            |  |
| 6903.00    | 43.150             | 89.040         | 6755.70     | 257.42            | 1134.90       | 128.88       | 10.25            |  |
| 6995.00    | 52.370             | 88.440         | 6817.48     | 325.17            | 1136.42       | 196.90       | 10.03            |  |
| 7088.00    | 62.320             | 84.660         | 6867.61     | 403.25            | 1141.27       | 274.93       | 11.23            |  |
| 7181.00    | 70.740             | 83.930         | 6904.61     | 488.47            | 1149.76       | 359.73       | 9.08             |  |
| 7274.00    | 75.640             | 84.850         | 6931.50     | 577.45            | 1158.45       | 448.31       | 5.35             |  |
| 7368.00    | 83.960             | 86.670         | 6948.14     | 669.80            | 1165.27       | 540.48       | 9.05             | Landing Point (163'FNL & 2526'FEL, SEC.05) |
| 7460.00    | 86.340             | 86.250         | 6955.91     | 761.34            | 1170.93       | 631.97       | 2.63             |  |
| 7554.00    | 86.430             | 86.510         | 6961.84     | 855.03            | 1176.85       | 725.60       | 0.29             |  |
| 7649.00    | 86.270             | 87.590         | 6967.89     | 949.65            | 1181.73       | 820.28       | 1.15             |  |
| 7743.00    | 86.430             | 88.750         | 6973.87     | 1043.14           | 1184.72       | 914.04       | 1.24             |  |
| 7836.00    | 86.430             | 88.990         | 6979.66     | 1135.55           | 1186.55       | 1006.84      | 0.26             |  |
| 7930.00    | 86.580             | 89.980         | 6985.39     | 1228.85           | 1187.40       | 1100.66      | 1.06             |  |
| 8023.00    | 86.240             | 89.830         | 6991.22     | 1321.08           | 1187.55       | 1193.48      | 0.40             |  |
| 8117.00    | 86.490             | 90.280         | 6997.18     | 1414.27           | 1187.46       | 1287.29      | 0.55             |  |



SRC ENERGY

# Actual Wellpath Report

BOOMERANG 25N-3B-L AWP

Page 5 of 11

**BAKER  
HUGHES****REFERENCE WELLPATH IDENTIFICATION**

|          |                                 |          |  |
|----------|---------------------------------|----------|--|
| Operator | SRC ENERGY                      | Slot     | SLOT#01 BOOMERANG 25N-3B-L (1317'FNL & 2327'FWL, SEC.05) |
| Area     | COLORADO                        | Well     | BOOMERANG 25N-3B-L                                       |
| Field    | WELD COUNTY (NAD83, TRUE NORTH) | Wellbore | BOOMERANG 25N-3B-L AWB                                   |
| Facility | SEC.05-T05N-R66W                |          |  |

**WELLPATH DATA (190 stations)**

| MD<br>[ft] | Inclination<br>[°] | Azimuth<br>[°] | TVD<br>[ft] | Vert Sect<br>[ft] | North<br>[ft] | East<br>[ft] | DLS<br>[°/100ft] | Comments |
|------------|--------------------|----------------|-------------|-------------------|---------------|--------------|------------------|----------|
| 8211.00    | 86.210             | 91.090         | 7003.16     | 1507.33           | 1186.34       | 1381.09      | 0.91             |          |
| 8303.00    | 86.400             | 91.850         | 7009.09     | 1598.24           | 1183.98       | 1472.87      | 0.85             |          |
| 8396.00    | 86.240             | 92.060         | 7015.06     | 1690.03           | 1180.82       | 1565.62      | 0.28             |          |
| 8490.00    | 86.340             | 95.230         | 7021.14     | 1782.34           | 1174.86       | 1659.22      | 3.37             |          |
| 8584.00    | 86.150             | 94.860         | 7027.30     | 1874.23           | 1166.61       | 1752.66      | 0.44             |          |
| 8677.00    | 86.240             | 91.720         | 7033.47     | 1965.65           | 1161.28       | 1845.29      | 3.37             |          |
| 8771.00    | 86.240             | 89.330         | 7039.64     | 2058.72           | 1160.42       | 1939.07      | 2.54             |          |
| 8864.00    | 86.340             | 87.510         | 7045.66     | 2151.18           | 1162.98       | 2031.84      | 1.96             |          |
| 8959.00    | 88.310             | 87.220         | 7050.09     | 2245.85           | 1167.34       | 2126.63      | 2.10             |          |
| 9052.00    | 88.430             | 86.440         | 7052.73     | 2338.65           | 1172.49       | 2219.45      | 0.85             |          |
| 9146.00    | 88.030             | 86.660         | 7055.64     | 2432.47           | 1178.14       | 2313.24      | 0.49             |          |
| 9239.00    | 88.180             | 87.110         | 7058.71     | 2525.25           | 1183.19       | 2406.05      | 0.51             |          |
| 9333.00    | 88.030             | 89.460         | 7061.82     | 2618.86           | 1186.00       | 2499.95      | 2.50             |          |
| 9426.00    | 89.820             | 89.670         | 7063.57     | 2711.31           | 1186.71       | 2592.92      | 1.94             |          |
| 9519.00    | 89.750             | 89.260         | 7063.92     | 2803.80           | 1187.58       | 2685.92      | 0.45             |          |
| 9611.00    | 89.660             | 88.370         | 7064.39     | 2895.39           | 1189.48       | 2777.90      | 0.97             |          |
| 9705.00    | 89.800             | 86.870         | 7064.83     | 2989.14           | 1193.38       | 2871.81      | 1.60             |          |
| 9798.00    | 89.600             | 86.730         | 7065.32     | 3081.98           | 1198.57       | 2964.67      | 0.26             |          |
| 9892.00    | 89.690             | 86.830         | 7065.90     | 3175.82           | 1203.85       | 3058.52      | 0.14             |          |
| 9984.00    | 89.630             | 87.290         | 7066.45     | 3267.63           | 1208.57       | 3150.39      | 0.50             |          |
| 10079.00   | 89.480             | 88.220         | 7067.19     | 3362.36           | 1212.29       | 3245.32      | 0.99             |          |
| 10172.00   | 89.750             | 88.520         | 7067.81     | 3455.02           | 1214.94       | 3338.28      | 0.43             |          |
| 10265.00   | 89.820             | 88.860         | 7068.16     | 3547.63           | 1217.06       | 3431.25      | 0.37             |          |
| 10360.00   | 89.600             | 89.210         | 7068.64     | 3642.18           | 1218.66       | 3526.24      | 0.44             |          |
| 10452.00   | 89.600             | 88.970         | 7069.28     | 3733.73           | 1220.13       | 3618.22      | 0.26             |          |
| 10642.00   | 89.290             | 90.010         | 7071.12     | 3922.67           | 1221.82       | 3808.20      | 0.57             |          |
| 10734.00   | 89.350             | 91.920         | 7072.22     | 4013.87           | 1220.27       | 3900.18      | 2.08             |          |
| 10826.00   | 89.170             | 93.860         | 7073.40     | 4104.61           | 1215.63       | 3992.05      | 2.12             |          |
| 10918.00   | 89.110             | 93.120         | 7074.78     | 4195.19           | 1210.03       | 4083.87      | 0.81             |          |
| 11011.00   | 89.140             | 91.640         | 7076.20     | 4287.05           | 1206.17       | 4176.77      | 1.59             |          |



SRC ENERGY

# Actual Wellpath Report

BOOMERANG 25N-3B-L AWP

Page 6 of 11

**BAKER  
HUGHES****REFERENCE WELLPATH IDENTIFICATION**

|          |                                 |          |  |
|----------|---------------------------------|----------|--|
| Operator | SRC ENERGY                      | Slot     | SLOT#01 BOOMERANG 25N-3B-L (1317'FNL & 2327'FWL, SEC.05) |
| Area     | COLORADO                        | Well     | BOOMERANG 25N-3B-L                                       |
| Field    | WELD COUNTY (NAD83, TRUE NORTH) | Wellbore | BOOMERANG 25N-3B-L AWB                                   |
| Facility | SEC.05-T05N-R66W                |          |  |

**WELLPATH DATA (190 stations)**

| MD<br>[ft] | Inclination<br>[°] | Azimuth<br>[°] | TVD<br>[ft] | Vert Sect<br>[ft] | North<br>[ft] | East<br>[ft] | DLS<br>[°/100ft] | Comments |
|------------|--------------------|----------------|-------------|-------------------|---------------|--------------|------------------|----------|
| 11103.00   | 89.140             | 91.140         | 7077.59     | 4378.16           | 1203.94       | 4268.74      | 0.54             |          |
| 11198.00   | 89.260             | 93.320         | 7078.91     | 4472.03           | 1200.24       | 4363.65      | 2.30             |          |
| 11290.00   | 89.450             | 91.620         | 7079.95     | 4562.89           | 1196.28       | 4455.55      | 1.86             |          |
| 11383.00   | 89.600             | 88.560         | 7080.72     | 4655.25           | 1196.13       | 4548.54      | 3.29             |          |
| 11476.00   | 89.660             | 86.640         | 7081.32     | 4748.00           | 1200.02       | 4641.45      | 2.07             |          |
| 11570.00   | 89.480             | 86.940         | 7082.03     | 4841.84           | 1205.29       | 4735.30      | 0.37             |          |
| 11664.00   | 89.660             | 86.500         | 7082.73     | 4935.68           | 1210.67       | 4829.15      | 0.51             |          |
| 11759.00   | 89.420             | 86.120         | 7083.49     | 5030.56           | 1216.78       | 4923.95      | 0.47             |          |
| 11851.00   | 89.260             | 86.230         | 7084.55     | 5122.45           | 1222.92       | 5015.73      | 0.21             |          |
| 11944.00   | 89.200             | 86.860         | 7085.80     | 5215.31           | 1228.52       | 5108.56      | 0.68             |          |
| 12037.00   | 89.600             | 88.320         | 7086.78     | 5308.06           | 1232.43       | 5201.47      | 1.63             |          |
| 12129.00   | 89.450             | 90.200         | 7087.54     | 5399.58           | 1233.62       | 5293.45      | 2.05             |          |
| 12223.00   | 89.450             | 91.780         | 7088.44     | 5492.76           | 1232.00       | 5387.43      | 1.68             |          |
| 12316.00   | 89.420             | 91.780         | 7089.36     | 5584.77           | 1229.11       | 5480.38      | 0.03             |          |
| 12409.00   | 89.630             | 91.750         | 7090.13     | 5676.79           | 1226.24       | 5573.33      | 0.23             |          |
| 12502.00   | 89.420             | 92.020         | 7090.90     | 5768.78           | 1223.18       | 5666.28      | 0.37             |          |
| 12595.00   | 89.480             | 92.810         | 7091.79     | 5860.64           | 1219.26       | 5759.19      | 0.85             |          |
| 12689.00   | 89.420             | 92.410         | 7092.70     | 5953.44           | 1214.98       | 5853.09      | 0.43             |          |
| 12781.00   | 90.890             | 92.380         | 7092.45     | 6044.32           | 1211.14       | 5945.01      | 1.60             |          |
| 12874.00   | 90.620             | 91.120         | 7091.22     | 6136.34           | 1208.30       | 6037.95      | 1.39             |          |
| 12967.00   | 90.860             | 90.610         | 7090.02     | 6228.55           | 1206.90       | 6130.93      | 0.61             |          |
| 13059.00   | 90.680             | 89.390         | 7088.78     | 6319.94           | 1206.90       | 6222.92      | 1.34             |          |
| 13153.00   | 90.650             | 88.750         | 7087.69     | 6413.49           | 1208.42       | 6316.91      | 0.68             |          |
| 13247.00   | 90.550             | 88.560         | 7086.71     | 6507.09           | 1210.63       | 6410.87      | 0.23             |          |
| 13340.00   | 90.740             | 88.510         | 7085.66     | 6599.72           | 1213.01       | 6503.84      | 0.21             |          |
| 13432.00   | 90.460             | 88.870         | 7084.70     | 6691.33           | 1215.11       | 6595.81      | 0.50             |          |
| 13525.00   | 89.750             | 89.680         | 7084.53     | 6783.85           | 1216.29       | 6688.80      | 1.16             |          |
| 13709.00   | 90.650             | 90.300         | 7083.89     | 6966.65           | 1216.32       | 6872.80      | 0.59             |          |
| 13802.00   | 90.490             | 89.850         | 7082.96     | 7059.03           | 1216.20       | 6965.79      | 0.51             |          |
| 13895.00   | 90.650             | 89.420         | 7082.04     | 7151.48           | 1216.79       | 7058.78      | 0.49             |          |



SRC ENERGY

# Actual Wellpath Report

BOOMERANG 25N-3B-L AWP

Page 7 of 11

**BAKER  
HUGHES****REFERENCE WELLPATH IDENTIFICATION**

|          |                                |          |  |
|----------|--------------------------------|----------|--|
| Operator | SRC ENERGY                     | Slot     | SLOT#01 BOOMERANG 25N-3B-L (1317'FNL & 2327'FWL, SEC.05) |
| Area     | COLORADO                       | Well     | BOOMERANG 25N-3B-L                                       |
| Field    | WELD COUNTY (NAD83,TRUE NORTH) | Wellbore | BOOMERANG 25N-3B-L AWP                                   |
| Facility | SEC.05-T05N-R66W               |          |  |

**WELLPATH DATA (190 stations)**

| MD<br>[ft] | Inclination<br>[°] | Azimuth<br>[°] | TVD<br>[ft] | Vert Sect<br>[ft] | North<br>[ft] | East<br>[ft] | DLS<br>[°/100ft] | Comments |
|------------|--------------------|----------------|-------------|-------------------|---------------|--------------|------------------|----------|
| 13987.00   | 90.620             | 90.370         | 7081.02     | 7242.89           | 1216.96       | 7150.78      | 1.03             |          |
| 14174.00   | 90.740             | 90.310         | 7078.80     | 7428.53           | 1215.85       | 7337.76      | 0.07             |          |
| 14363.00   | 90.490             | 90.890         | 7076.77     | 7616.05           | 1213.87       | 7526.74      | 0.33             |          |
| 14457.00   | 90.580             | 90.990         | 7075.89     | 7709.25           | 1212.33       | 7620.72      | 0.14             |          |
| 14552.00   | 90.520             | 92.330         | 7074.98     | 7803.27           | 1209.57       | 7715.68      | 1.41             |          |
| 14644.00   | 90.830             | 92.630         | 7073.89     | 7894.12           | 1205.59       | 7807.58      | 0.47             |          |
| 14738.00   | 90.680             | 91.170         | 7072.66     | 7987.09           | 1202.48       | 7901.52      | 1.56             |          |
| 14833.00   | 90.860             | 89.480         | 7071.38     | 8081.40           | 1201.94       | 7996.51      | 1.79             |          |
| 14927.00   | 90.920             | 88.530         | 7069.92     | 8174.94           | 1203.57       | 8090.48      | 1.01             |          |
| 15021.00   | 90.710             | 87.370         | 7068.58     | 8268.64           | 1206.93       | 8184.41      | 1.25             |          |
| 15115.00   | 90.860             | 86.370         | 7067.29     | 8362.47           | 1212.07       | 8278.26      | 1.08             |          |
| 15208.00   | 90.890             | 85.890         | 7065.87     | 8455.35           | 1218.34       | 8371.04      | 0.52             |          |
| 15302.00   | 89.970             | 85.900         | 7065.17     | 8549.27           | 1225.07       | 8464.79      | 0.98             |          |
| 15395.00   | 89.750             | 85.120         | 7065.40     | 8642.20           | 1232.35       | 8557.50      | 0.87             |          |
| 15488.00   | 89.780             | 86.330         | 7065.78     | 8735.13           | 1239.28       | 8650.24      | 1.30             |          |
| 15581.00   | 90.120             | 89.440         | 7065.86     | 8827.84           | 1242.71       | 8743.17      | 3.36             |          |
| 15673.00   | 90.090             | 90.070         | 7065.69     | 8919.28           | 1243.11       | 8835.17      | 0.69             |          |
| 15767.00   | 90.060             | 89.580         | 7065.57     | 9012.70           | 1243.40       | 8929.17      | 0.52             |          |
| 15861.00   | 89.850             | 89.610         | 7065.64     | 9106.16           | 1244.06       | 9023.16      | 0.23             |          |
| 15953.00   | 89.850             | 88.970         | 7065.88     | 9197.68           | 1245.20       | 9115.16      | 0.70             |          |
| 16046.00   | 89.690             | 89.890         | 7066.25     | 9290.18           | 1246.12       | 9208.15      | 1.00             |          |
| 16138.00   | 89.820             | 90.080         | 7066.65     | 9381.58           | 1246.15       | 9300.15      | 0.25             |          |
| 16230.00   | 89.720             | 90.620         | 7067.02     | 9472.91           | 1245.59       | 9392.14      | 0.60             |          |
| 16323.00   | 89.630             | 91.390         | 7067.54     | 9565.10           | 1243.96       | 9485.13      | 0.83             |          |
| 16416.00   | 89.660             | 92.660         | 7068.12     | 9657.06           | 1240.67       | 9578.07      | 1.37             |          |
| 16510.00   | 89.290             | 91.930         | 7068.98     | 9749.94           | 1236.91       | 9671.99      | 0.87             |          |
| 16604.00   | 89.510             | 92.710         | 7069.97     | 9842.81           | 1233.10       | 9765.90      | 0.86             |          |
| 16700.00   | 89.420             | 93.240         | 7070.86     | 9937.48           | 1228.12       | 9861.77      | 0.56             |          |
| 16794.00   | 89.720             | 91.970         | 7071.57     | 10030.28          | 1223.85       | 9955.67      | 1.39             |          |
| 16887.00   | 89.540             | 89.710         | 7072.17     | 10122.50          | 1222.48       | 10048.65     | 2.44             |          |





SRC ENERGY

# Actual Wellpath Report

BOOMERANG 25N-3B-L AWP

Page 8 of 11

**BAKER  
HUGHES****REFERENCE WELLPATH IDENTIFICATION**

|          |                                 |          |  |
|----------|---------------------------------|----------|--|
| Operator | SRC ENERGY                      | Slot     | SLOT#01 BOOMERANG 25N-3B-L (1317'FNL & 2327'FWL, SEC.05) |
| Area     | COLORADO                        | Well     | BOOMERANG 25N-3B-L                                       |
| Field    | WELD COUNTY (NAD83, TRUE NORTH) | Wellbore | BOOMERANG 25N-3B-L AWB                                   |
| Facility | SEC.05-T05N-R66W                |          |  |

**WELLPATH DATA (190 stations)**

| MD<br>[ft] | Inclination<br>[°] | Azimuth<br>[°] | TVD<br>[ft] | Vert Sect<br>[ft] | North<br>[ft] | East<br>[ft] | DLS<br>[°/100ft] | Comments   |
|------------|--------------------|----------------|-------------|-------------------|---------------|--------------|------------------|--|
| 16980.00   | 89.880             | 87.500         | 7072.64     | 10215.12          | 1224.75       | 10141.62     | 2.40             |  |
| 17073.00   | 89.850             | 85.460         | 7072.86     | 10307.99          | 1230.46       | 10234.43     | 2.19             |  |
| 17165.00   | 90.000             | 88.630         | 7072.98     | 10399.79          | 1235.20       | 10326.30     | 3.45             |  |
| 17259.00   | 90.030             | 94.100         | 7072.95     | 10492.86          | 1232.96       | 10420.24     | 5.82             |  |
| 17351.00   | 90.030             | 98.980         | 7072.91     | 10582.45          | 1222.49       | 10511.61     | 5.30             |  |
| 17444.00   | 89.780             | 97.350         | 7073.06     | 10672.40          | 1209.28       | 10603.67     | 1.77             |  |
| 17538.00   | 89.750             | 91.510         | 7073.45     | 10764.64          | 1202.02       | 10697.34     | 6.21             |  |
| 17631.00   | 89.910             | 88.120         | 7073.72     | 10857.05          | 1202.32       | 10790.33     | 3.65             |  |
| 17701.00   | 89.940             | 89.170         | 7073.81     | 10926.76          | 1203.98       | 10860.31     | 1.50             | Last BHI MWD Survey (189'FNL & 2486'FWL, SEC.03) |
| 17725.00   | 89.940             | 89.170         | 7073.84     | 10950.64          | 1204.32       | 10884.31     | 0.00             | Projection to Bit (189'FNL & 2510'FWL, SEC.03)   |

**HOLE & CASING SECTIONS - Ref Wellbore: BOOMERANG 25N-3B-L AWB      Ref Wellpath: BOOMERANG 25N-3B-L AWP**

| String/Diameter        | Start MD<br>[ft] | End MD<br>[ft] | Interval<br>[ft] | Start TVD<br>[ft] | End TVD<br>[ft] | Start N/S<br>[ft] | Start E/W<br>[ft] | End N/S<br>[ft] | End E/W<br>[ft] |
|------------------------|------------------|----------------|------------------|-------------------|-----------------|-------------------|-------------------|-----------------|-----------------|
| 13.5in Open Hole       | 20.00            | 1821.00        | 1801.00          | 20.00             | 1799.05         | 0.00              | 0.00              | 250.35          | -17.78          |
| 9.625in Casing Surface | 20.00            | 1821.00        | 1801.00          | 20.00             | 1799.05         | 0.00              | 0.00              | 250.35          | -17.78          |
| 8.5in Open Hole        | 1821.00          | 17725.00       | 15904.00         | 1799.05           | 7073.84         | 250.35            | -17.78            | 1204.32         | 10884.31        |



# Actual Wellpath Report

BOOMERANG 25N-3B-L AWP

Page 9 of 11



## REFERENCE WELLPATH IDENTIFICATION

|          |                                 |          |  |
|----------|---------------------------------|----------|--|
| Operator | SRC ENERGY                      | Slot     | SLOT#01 BOOMERANG 25N-3B-L (1317'FNL & 2327'FWL, SEC.05) |
| Area     | COLORADO                        | Well     | BOOMERANG 25N-3B-L                                       |
| Field    | WELD COUNTY (NAD83, TRUE NORTH) | Wellbore | BOOMERANG 25N-3B-L AWB                                   |
| Facility | SEC.05-T05N-R66W                |          |  |

## TARGETS

| Name  | TVD<br>[ft] | North<br>[ft] | East<br>[ft] | Grid East<br>[US ft] | Grid North<br>[US ft] | Latitude       | Longitude       | Shape   |
|---|-------------|---------------|--------------|----------------------|-----------------------|----------------|-----------------|---------|
| SEC.03-T05N-R66W  | 15.00       | 0.00          | 0.00         | 3193876.47           | 1401538.91            | 40°26'00.730"N | 104°48'12.704"W | polygon |
| SEC.04-T05N-R66W  | 15.00       | 0.00          | 0.00         | 3193876.47           | 1401538.91            | 40°26'00.730"N | 104°48'12.704"W | polygon |
| SEC.05-T05N-R66W  | 15.00       | 0.00          | 0.00         | 3193876.47           | 1401538.91            | 40°26'00.730"N | 104°48'12.704"W | polygon |
| SEC.06-T05N-R66W  | 15.00       | 0.00          | 0.00         | 3193876.47           | 1401538.91            | 40°26'00.730"N | 104°48'12.704"W | polygon |
| BOOMERANG 25N-3B-L REV-2 TOP<br>OF PROD ON PLAT (154'FNL &<br>2487'FEL, SEC.05) | 6953.10     | 1174.52       | 579.01       | 3194446.21           | 1402717.89            | 40°26'12.336"N | 104°48'05.216"W | circle  |
| BOOMERANG 25N-3B-L TOP OF<br>PROD ON PLAT (154'FNL &<br>2487'FEL, SEC.05)       | 6970.00     | 1174.52       | 579.01       | 3194446.21           | 1402717.89            | 40°26'12.336"N | 104°48'05.216"W | circle  |
| BOOMERANG 25N-3B-L TARGET 1   | 7047.40     | 1184.75       | 2048.99      | 3195916.01           | 1402739.67            | 40°26'12.436"N | 104°47'46.206"W | point   |
| BOOMERANG 25N-3B-L TARGET 3   | 7063.60     | 1226.95       | 8109.09      | 3201975.35           | 1402829.46            | 40°26'12.841"N | 104°46'27.834"W | point   |
| BOOMERANG 25N-3B-L REV-2 BHL<br>ON PLAT (147'FNL & 2485'FWL,<br>SEC.03)         | 7073.80     | 1246.12       | 10859.20     | 3204725.11           | 1402870.23            | 40°26'13.020"N | 104°45'52.268"W | circle  |
| BOOMERANG 25N-3B-L BHL ON<br>PLAT (147'FNL & 2485'FWL,<br>SEC.03)               | 7076.00     | 1246.12       | 10859.17     | 3204725.08           | 1402870.23            | 40°26'13.020"N | 104°45'52.268"W | circle  |
| BOOMERANG 25N-3B-L TARGET 2   | 7088.00     | 1211.37       | 5871.98      | 3199738.52           | 1402796.32            | 40°26'12.693"N | 104°46'56.765"W | point   |



SRC ENERGY

# Actual Wellpath Report

BOOMERANG 25N-3B-L AWP

Page 10 of 11

**BAKER  
HUGHES****REFERENCE WELLPATH IDENTIFICATION**

|          |                                |          |  |
|----------|--------------------------------|----------|--|
| Operator | SRC ENERGY                     | Slot     | SLOT#01 BOOMERANG 25N-3B-L (1317'FNL & 2327'FWL, SEC.05) |
| Area     | COLORADO                       | Well     | BOOMERANG 25N-3B-L                                       |
| Field    | WELD COUNTY (NAD83,TRUE NORTH) | Wellbore | BOOMERANG 25N-3B-L AWB                                   |
| Facility | SEC.05-T05N-R66W               |          |  |

**WELLPATH COMPOSITION - Ref Wellbore: BOOMERANG 25N-3B-L AWB      Ref Wellpath: BOOMERANG 25N-3B-L AWP**

| Start MD<br>[ft] | End MD<br>[ft] | Positional Uncertainty Model     | Log Name/Comment  | Wellbore               |
|------------------|----------------|----------------------------------|---|------------------------|
| 20.00            | 1769.00        | BHI NaviTrak (Standard)          | 13 1/2" SURFACE SECTION <86-1753>                                 | BOOMERANG 25N-3B-L AWB |
| 1769.00          | 17701.00       | BHI AutoTrak Curve (IFR1, Short) | BHI/ATC BHI AutoTrak Curve (IFR1, Short) 8.5" Hole <1864'-17701'> | BOOMERANG 25N-3B-L AWB |
| 17701.00         | 17725.00       | Blind Drilling (std)             | Projection to bit   | BOOMERANG 25N-3B-L AWB |



SRC ENERGY

# Actual Wellpath Report

BOOMERANG 25N-3B-L AWP

Page 11 of 11

**BAKER  
HUGHES****REFERENCE WELLPATH IDENTIFICATION**

|          |                                |          |  |
|----------|--------------------------------|----------|--|
| Operator | SRC ENERGY                     | Slot     | SLOT#01 BOOMERANG 25N-3B-L (1317'FNL & 2327'FWL, SEC.05) |
| Area     | COLORADO                       | Well     | BOOMERANG 25N-3B-L                                       |
| Field    | WELD COUNTY (NAD83,TRUE NORTH) | Wellbore | BOOMERANG 25N-3B-L AWP                                   |
| Facility | SEC.05-T05N-R66W               |          |  |

**WELLPATH COMMENTS**

| MD<br>[ft] | Inclination<br>[°] | Azimuth<br>[°] | TVD<br>[ft] | Comment  |
|------------|--------------------|----------------|-------------|--|
| 7368.00    | 83.960             | 86.670         | 6948.14     | Landing Point (163'FNL & 2526'FEL, SEC.05)       |
| 17701.00   | 89.940             | 89.170         | 7073.81     | Last BHI MWD Survey (189'FNL & 2486'FWL, SEC.03) |
| 17725.00   | 89.940             | 89.170         | 7073.84     | Projection to Bit (189'FNL & 2510'FWL, SEC.03)   |