

SRC ENERGY

Location: COLORADO Slot: SLOT#04 BOOMERANG 32C-6-M (1362°FNL & 2327°FWL, SEC.05)
Field: WELD COUNTY (NAD83, TRUE NORTH) Well: BOOMERANG 32C-6-M
Facility: SEC.05-T05N-R66W Wellbore: BOOMERANG 32C-6-M PWB

Plot reference wellpath is BOOMERANG 32C-6-M (REV-B.0) PWP	Grid System: NAD83 / Lambert Colorado SP, Northern Zone (501), US feet
True vertical depths are referenced to PRECISION 462 (20') (RKB)	* = Wellpath was transformed from a different geodetic datum
Measured depths are referenced to PRECISION 462 (20') (RKB)	North Reference: True north
PRECISION 462 (20') (RKB) to Mean Sea Level: 4789 feet	Scale: True distance
Mean Sea Level to Mud line (At Slot: SLOT#04 BOOMERANG 32C-6-M (1362°FNL & 2327°FWL, SEC.05)): 0 feet	Depths are in feet
Coordinates are in feet referenced to Slot	Created by: doddanna on 2018-04-12
	Database: WellArchitectDB

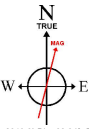
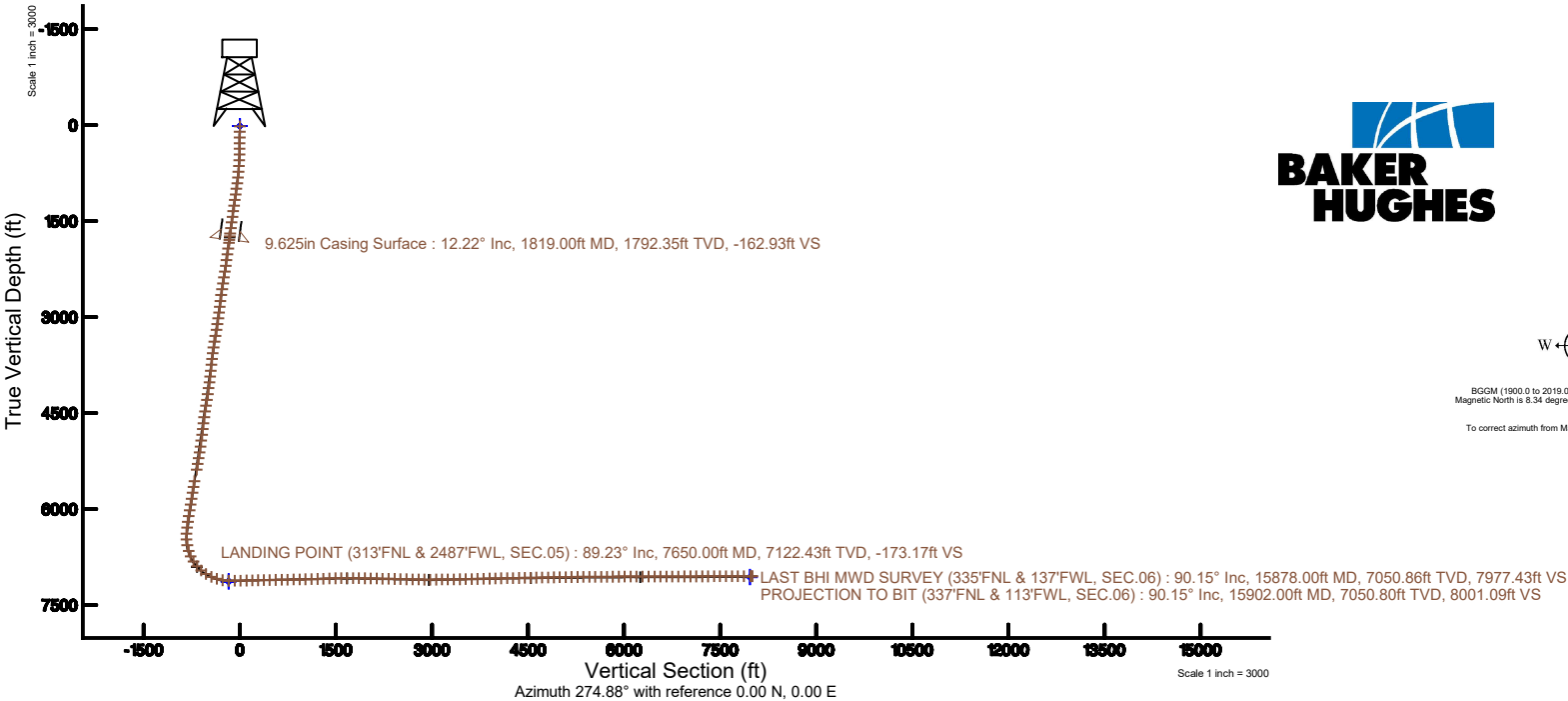
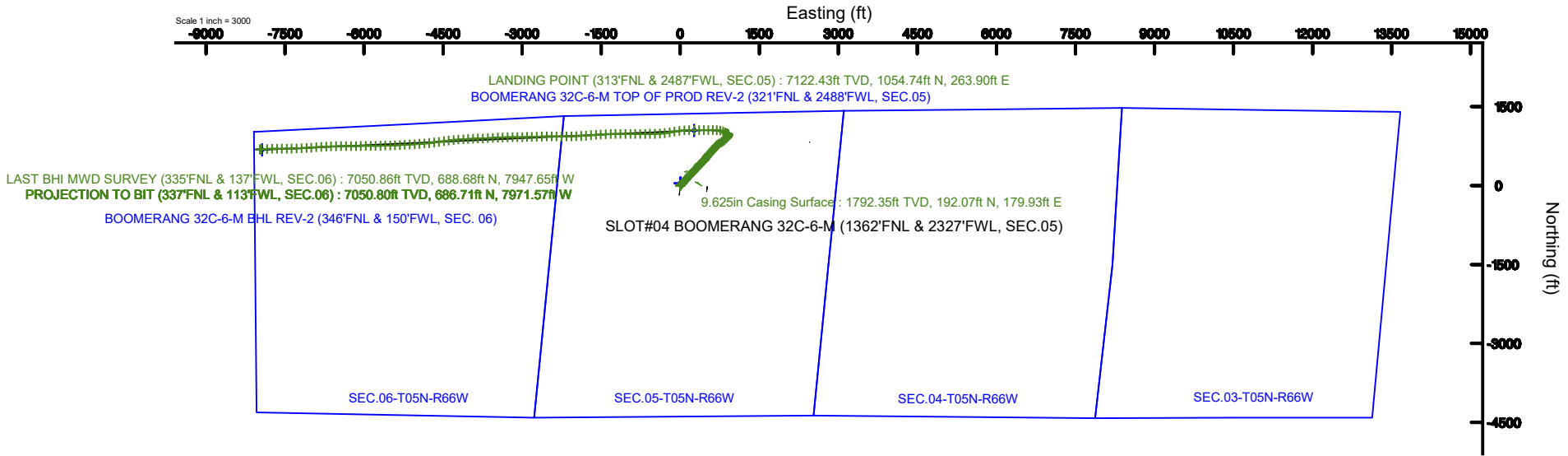

BGGM (1900.0 to 2019.0) Dip: 66.84° Field: 52301.2 nT
Magnetic North is 8.34 degrees East of True North (at 3/19/2018)
To correct azimuth from Magnetic to True add 8.34 degrees



SRC ENERGY

Actual Wellpath Report

BOOMERANG 32C-6-M AWP

Page 1 of 10

**BAKER
HUGHES**

REFERENCE WELLPATH IDENTIFICATION

Operator	SRC ENERGY	Slot	SLOT#04 BOOMERANG 32C-6-M (1362'FNL & 2327'FWL, SEC.05)
Area	COLORADO	Well	BOOMERANG 32C-6-M
Field	WELD COUNTY (NAD83,TRUE NORTH)	Wellbore	BOOMERANG 32C-6-M AWB
Facility	SEC.05-T05N-R66W		

REPORT SETUP INFORMATION

Projection System	NAD83 / Lambert Colorado SP, Northern Zone (501), US feet	Software System	WellArchitect® 5.0
North Reference	True	User	Doddanna
Scale	0.999962	Report Generated	4/12/2018 at 2:25:48 PM
Convergence at slot	0.45° East	Database/Source file	WellArchitectDB/BOOMERANG_32C-6-M_AWP.xml

WELLPATH LOCATION

	Local coordinates		Grid coordinates		Geographic coordinates	
	North[ft]	East[ft]	Easting[US ft]	Northing[US ft]	Latitude	Longitude
Slot Location	-44.83	-4.49	3193872.34	1401494.05	40°26'00.287"N	104°48'12.762"W
Facility Reference Pt			3193876.47	1401538.91	40°26'00.730"N	104°48'12.704"W
Field Reference Pt			3171284.48	1426358.81	40°30'07.643"N	104°53'02.634"W

WELLPATH DATUM

Calculation method	Minimum curvature	PRECISION 462 (20') (RKB) to Facility Vertical Datum	4789.00ft
Horizontal Reference Pt	Slot	PRECISION 462 (20') (RKB) to Mean Sea Level	4789.00ft
Vertical Reference Pt	PRECISION 462 (20') (RKB)	PRECISION 462 (20') (RKB) to Mud Line at Slot (SLOT#04 BOOMERANG 32C-6-M (1362'FNL & 2327'FWL, SEC.05))	4789.00ft
MD Reference Pt	PRECISION 462 (20') (RKB)	Section Origin	N 0.00, E 0.00 ft
Field Vertical Reference	Mean Sea Level	Section Azimuth	274.88°



Actual Wellpath Report

BOOMERANG 32C-6-M AWP

Page 2 of 10



REFERENCE WELLPATH IDENTIFICATION			
Operator	SRC ENERGY	Slot	SLOT#04 BOOMERANG 32C-6-M (1362'FNL & 2327'FWL, SEC.05)
Area	COLORADO	Well	BOOMERANG 32C-6-M
Field	WELD COUNTY (NAD83,TRUE NORTH)	Wellbore	BOOMERANG 32C-6-M AWB
Facility	SEC.05-T05N-R66W		

WELLPATH DATA (173 stations) † = interpolated/extrapolated station								
MD [ft]	Inclination [°]	Azimuth [°]	TVD [ft]	Vert Sect [ft]	North [ft]	East [ft]	DLS [°/100ft]	Comments
0.00†	0.000	114.640	0.00	0.00	0.00	0.00	0.00	
20.00	0.000	114.640	20.00	0.00	0.00	0.00	0.00	
102.00	0.720	114.640	102.00	-0.48	-0.21	0.47	0.88	
192.00	0.650	53.270	191.99	-1.40	-0.15	1.39	0.78	
285.00	0.540	51.350	284.99	-2.11	0.44	2.16	0.12	
371.00	1.140	40.280	370.98	-2.90	1.35	3.03	0.72	
461.00	2.080	44.120	460.94	-4.45	3.21	4.74	1.05	
551.00	4.570	41.160	550.78	-7.61	7.08	8.24	2.77	
641.00	7.090	41.660	640.31	-13.05	13.93	14.29	2.80	
731.00	8.210	46.110	729.51	-20.62	22.53	22.62	1.41	
821.00	9.530	45.130	818.43	-29.66	32.24	32.53	1.48	
911.00	11.150	42.770	906.97	-39.82	43.89	43.72	1.86	
1001.00	13.400	42.670	994.90	-51.56	57.95	56.70	2.50	
1091.00	13.090	42.810	1082.51	-64.21	73.09	70.69	0.35	
1181.00	12.840	43.960	1170.21	-76.78	87.77	84.56	0.40	
1271.00	13.220	43.620	1257.90	-89.53	102.42	98.60	0.43	
1361.00	13.110	42.570	1345.53	-102.21	117.38	112.60	0.29	
1451.00	12.510	43.100	1433.29	-114.48	132.02	126.17	0.68	
1541.00	13.340	41.630	1521.01	-126.72	146.90	139.73	0.99	
1631.00	12.770	41.480	1608.68	-138.86	162.11	153.21	0.63	
1721.00	12.080	41.830	1696.58	-150.45	176.58	166.08	0.77	
1764.00	12.320	41.960	1738.60	-155.92	183.34	172.15	0.56	
1865.00	12.140	40.990	1837.31	-168.68	199.37	186.32	0.27	
1959.00	13.210	42.570	1929.02	-181.07	214.74	200.07	1.20	
2052.00	13.150	42.060	2019.57	-193.96	230.42	214.35	0.14	
2145.00	13.290	41.670	2110.11	-206.75	246.26	228.54	0.18	
2237.00	13.100	41.500	2199.68	-219.30	261.97	242.48	0.21	
2331.00	13.300	43.540	2291.19	-232.41	277.78	256.99	0.54	
2424.00	13.290	47.310	2381.70	-246.30	292.79	272.21	0.93	
2517.00	13.030	48.110	2472.26	-260.70	307.03	287.87	0.34	



Actual Wellpath Report

BOOMERANG 32C-6-M AWP

Page 3 of 10



REFERENCE WELLPATH IDENTIFICATION			
Operator	SRC ENERGY	Slot	SLOT#04 BOOMERANG 32C-6-M (1362'FNL & 2327'FWL, SEC.05)
Area	COLORADO	Well	BOOMERANG 32C-6-M
Field	WELD COUNTY (NAD83,TRUE NORTH)	Wellbore	BOOMERANG 32C-6-M AWB
Facility	SEC.05-T05N-R66W		

WELLPATH DATA (173 stations)								
MD [ft]	Inclination [°]	Azimuth [°]	TVD [ft]	Vert Sect [ft]	North [ft]	East [ft]	DLS [°/100ft]	Comments
2610.00	13.420	50.570	2562.80	-275.60	320.89	304.01	0.74	
2705.00	13.340	42.310	2655.23	-290.15	336.00	319.91	2.01	
2800.00	13.150	28.670	2747.72	-301.17	353.59	332.47	3.29	
2893.00	13.230	37.200	2838.28	-311.13	371.35	343.98	2.09	
2987.00	12.780	39.890	2929.87	-322.84	387.89	357.15	0.80	
3079.00	13.000	45.290	3019.55	-335.39	402.98	371.03	1.33	
3173.00	12.990	49.340	3111.14	-349.64	417.30	386.56	0.97	
3266.00	13.190	50.230	3201.73	-364.51	430.90	402.65	0.31	
3359.00	13.040	53.100	3292.30	-379.88	443.99	419.19	0.72	
3452.00	13.290	49.820	3382.86	-395.26	457.19	435.75	0.85	
3545.00	13.100	45.300	3473.41	-409.64	471.50	451.41	1.13	
3638.00	13.030	38.950	3564.01	-422.35	487.06	465.49	1.54	
3732.00	13.190	36.950	3655.56	-433.98	503.87	478.60	0.51	
3825.00	13.090	30.440	3746.13	-444.16	521.43	490.31	1.59	
3919.00	13.180	28.210	3837.67	-452.99	540.06	500.77	0.55	
4014.00	13.090	32.930	3930.18	-462.34	558.63	511.74	1.13	
4108.00	13.000	39.570	4021.76	-473.36	575.72	524.26	1.60	
4201.00	13.030	45.740	4112.38	-486.17	591.10	538.44	1.49	
4295.00	12.890	45.280	4203.98	-499.90	605.87	553.48	0.19	
4388.00	12.960	46.160	4294.63	-513.50	620.39	568.37	0.22	
4481.00	12.980	48.210	4385.26	-527.55	634.58	583.68	0.50	
4575.00	13.020	45.360	4476.85	-541.67	649.05	599.08	0.68	
4668.00	12.960	39.220	4567.47	-554.35	664.49	613.13	1.48	
4762.00	13.110	38.340	4659.05	-566.17	681.02	626.41	0.26	
4856.00	13.010	36.470	4750.62	-577.59	697.89	639.31	0.46	
4950.00	13.030	37.610	4842.20	-588.86	714.79	652.07	0.27	
5043.00	13.000	40.350	4932.81	-600.60	731.07	665.24	0.66	
5136.00	12.990	45.170	5023.44	-613.43	746.41	679.42	1.17	
5230.00	12.970	47.390	5115.03	-627.39	761.00	694.68	0.53	
5323.00	13.030	49.150	5205.65	-641.76	774.92	710.29	0.43	



SRC ENERGY

Actual Wellpath Report

BOOMERANG 32C-6-M AWP

Page 4 of 10

**BAKER
HUGHES****REFERENCE WELLPATH IDENTIFICATION**

Operator	SRC ENERGY	Slot	SLOT#04 BOOMERANG 32C-6-M (1362'FNL & 2327'FWL, SEC.05)
Area	COLORADO	Well	BOOMERANG 32C-6-M
Field	WELD COUNTY (NAD83,TRUE NORTH)	Wellbore	BOOMERANG 32C-6-M AWP
Facility	SEC.05-T05N-R66W		

WELLPATH DATA (173 stations)

MD [ft]	Inclination [°]	Azimuth [°]	TVD [ft]	Vert Sect [ft]	North [ft]	East [ft]	DLS [°/100ft]	Comments
5416.00	12.780	53.270	5296.30	-656.77	787.93	726.47	1.03	
5508.00	12.850	59.890	5386.02	-672.76	799.15	743.47	1.60	
5694.00	12.420	59.470	5567.51	-706.00	819.69	778.59	0.24	
5787.00	13.020	56.310	5658.23	-722.35	830.58	795.93	0.99	
5879.00	12.960	52.680	5747.88	-738.09	842.58	812.75	0.89	
5972.00	12.860	50.870	5838.53	-753.26	855.44	829.08	0.45	
6066.00	13.030	48.900	5930.14	-768.15	869.00	845.18	0.50	
6159.00	13.130	47.140	6020.73	-782.53	883.08	860.82	0.44	
6253.00	13.320	44.730	6112.23	-796.65	898.04	876.27	0.62	
6346.00	13.160	40.050	6202.76	-809.61	913.75	890.62	1.16	
6439.00	13.310	34.560	6293.30	-821.01	930.67	903.50	1.36	
6532.00	13.320	27.240	6383.80	-830.39	949.02	914.48	1.81	
6625.00	11.410	344.370	6474.83	-831.24	967.44	916.91	9.84	
6717.00	11.910	301.010	6565.10	-819.51	981.12	906.30	9.32	
6810.00	17.940	299.600	6654.92	-797.86	993.15	885.60	6.50	
6904.00	25.540	296.240	6742.17	-765.79	1009.28	854.79	8.19	
6996.00	33.970	292.290	6821.98	-722.71	1027.84	813.14	9.40	
7089.00	41.140	282.030	6895.73	-667.44	1044.10	759.06	10.21	
7182.00	48.930	271.630	6961.49	-601.89	1051.50	693.91	11.50	
7275.00	57.830	270.240	7016.91	-527.51	1052.66	619.35	9.64	
7369.00	66.550	271.380	7060.73	-444.66	1053.87	536.30	9.34	
7461.00	73.780	270.670	7091.92	-358.37	1055.41	449.83	7.89	
7555.00	79.820	268.990	7113.38	-267.26	1055.12	358.36	6.66	
7650.00	89.230	270.540	7122.43	-173.17	1054.74	263.90	10.04	LANDING POINT (313'FNL & 2487'FWL, SEC.05)
7744.00	91.170	269.180	7122.10	-79.54	1054.51	169.91	2.52	
7837.00	91.200	264.150	7120.18	12.45	1049.10	77.12	5.41	
7931.00	91.170	261.150	7118.24	104.29	1037.08	-16.08	3.19	
8024.00	91.260	260.720	7116.26	194.53	1022.43	-107.90	0.47	
8118.00	91.290	261.790	7114.17	285.86	1008.14	-200.78	1.14	
8212.00	91.140	262.880	7112.18	377.59	995.61	-293.92	1.17	



SRC ENERGY

Actual Wellpath Report

BOOMERANG 32C-6-M AWP

Page 5 of 10

**BAKER
HUGHES****REFERENCE WELLPATH IDENTIFICATION**

Operator	SRC ENERGY	Slot	SLOT#04 BOOMERANG 32C-6-M (1362'FNL & 2327'FWL, SEC.05)
Area	COLORADO	Well	BOOMERANG 32C-6-M
Field	WELD COUNTY (NAD83,TRUE NORTH)	Wellbore	BOOMERANG 32C-6-M AWB
Facility	SEC.05-T05N-R66W		

WELLPATH DATA (173 stations)

MD [ft]	Inclination [°]	Azimuth [°]	TVD [ft]	Vert Sect [ft]	North [ft]	East [ft]	DLS [°/100ft]	Comments
8304.00	91.080	265.400	7110.40	467.95	986.22	-385.41	2.74	
8397.00	91.200	268.900	7108.55	560.07	981.60	-478.26	3.76	
8491.00	91.230	270.230	7106.55	653.65	980.88	-572.24	1.41	
8585.00	91.170	269.130	7104.58	747.24	980.36	-666.22	1.17	
8678.00	91.170	269.280	7102.68	839.76	979.07	-759.19	0.16	
8772.00	91.110	269.460	7100.81	933.31	978.04	-853.16	0.20	
8865.00	91.110	270.170	7099.01	1025.93	977.73	-946.14	0.76	
8960.00	91.260	271.010	7097.05	1120.64	978.71	-1041.12	0.90	
9053.00	92.340	271.060	7094.13	1213.38	980.39	-1134.06	1.16	
9147.00	92.490	269.050	7090.17	1306.96	980.48	-1227.97	2.14	
9240.00	92.460	268.430	7086.15	1399.34	978.44	-1320.86	0.67	
9334.00	91.140	266.980	7083.20	1492.55	974.68	-1414.73	2.09	
9427.00	91.230	266.540	7081.27	1584.60	969.42	-1507.56	0.48	
9520.00	90.490	266.500	7079.88	1676.60	963.78	-1600.38	0.80	
9612.00	89.020	263.320	7080.27	1767.20	955.62	-1692.00	3.81	
9706.00	88.890	266.030	7081.99	1859.68	946.89	-1785.57	2.89	
9799.00	88.800	267.270	7083.86	1951.71	941.46	-1878.39	1.34	
9893.00	88.770	268.170	7085.85	2044.95	937.72	-1972.30	0.96	
9985.00	88.650	267.700	7087.92	2136.25	934.41	-2064.21	0.53	
10080.00	88.860	269.420	7089.99	2230.65	932.02	-2159.16	1.82	
10173.00	88.770	270.360	7091.91	2323.27	931.84	-2252.14	1.02	
10266.00	88.680	269.940	7093.98	2415.93	932.09	-2345.11	0.46	
10360.00	88.740	270.080	7096.10	2509.57	932.10	-2439.09	0.16	
10453.00	88.740	269.920	7098.14	2602.21	932.10	-2532.07	0.17	
10548.00	88.580	268.700	7100.36	2696.73	930.96	-2627.03	1.29	
10643.00	88.800	268.230	7102.54	2791.11	928.42	-2721.97	0.55	
10735.00	88.710	268.040	7104.54	2882.45	925.42	-2813.90	0.23	
10827.00	90.950	268.350	7104.81	2973.82	922.52	-2905.85	2.46	
10919.00	91.110	268.870	7103.15	3065.26	920.29	-2997.81	0.59	
11012.00	90.950	269.380	7101.48	3157.77	918.87	-3090.78	0.57	



SRC ENERGY

Actual Wellpath Report

BOOMERANG 32C-6-M AWP

Page 6 of 10

**BAKER
HUGHES****REFERENCE WELLPATH IDENTIFICATION**

Operator	SRC ENERGY	Slot	SLOT#04 BOOMERANG 32C-6-M (1362'FNL & 2327'FWL, SEC.05)
Area	COLORADO	Well	BOOMERANG 32C-6-M
Field	WELD COUNTY (NAD83,TRUE NORTH)	Wellbore	BOOMERANG 32C-6-M AWB
Facility	SEC.05-T05N-R66W		

WELLPATH DATA (173 stations)

MD [ft]	Inclination [°]	Azimuth [°]	TVD [ft]	Vert Sect [ft]	North [ft]	East [ft]	DLS [°/100ft]	Comments
11104.00	90.550	269.720	7100.28	3249.37	918.15	-3182.77	0.57	
11199.00	89.510	268.790	7100.23	3343.91	916.92	-3277.76	1.47	
11291.00	91.450	269.040	7099.46	3435.40	915.17	-3369.73	2.13	
11384.00	91.230	266.600	7097.28	3527.66	911.64	-3462.63	2.63	
11477.00	90.980	265.720	7095.49	3619.57	905.41	-3555.41	0.98	
11571.00	91.450	265.420	7093.50	3712.31	898.15	-3649.11	0.59	
11665.00	91.600	271.300	7090.99	3805.63	895.46	-3742.99	6.26	
11760.00	91.600	267.080	7088.34	3900.10	894.12	-3837.92	4.44	
11852.00	91.020	265.620	7086.24	3991.05	888.27	-3929.71	1.71	
11945.00	91.140	267.600	7084.48	4083.06	882.77	-4022.53	2.13	
12038.00	91.010	267.460	7082.74	4175.28	878.76	-4115.42	0.21	
12130.00	90.980	265.640	7081.14	4266.30	873.22	-4207.24	1.98	
12224.00	91.080	263.600	7079.45	4358.77	864.41	-4300.81	2.17	
12317.00	91.230	263.040	7077.58	4449.87	853.60	-4393.16	0.62	
12410.00	91.260	262.630	7075.55	4540.80	842.00	-4485.41	0.44	
12503.00	90.370	261.550	7074.23	4631.48	829.20	-4577.51	1.50	
12596.00	91.290	262.850	7072.88	4722.19	816.58	-4669.64	1.71	
12690.00	91.230	264.080	7070.82	4814.31	805.89	-4763.00	1.31	
12782.00	91.260	265.310	7068.82	4904.84	797.38	-4854.58	1.34	
12875.00	91.390	266.390	7066.67	4996.66	790.66	-4947.31	1.17	
12968.00	90.370	267.050	7065.24	5088.70	785.34	-5040.15	1.31	
13060.00	90.550	266.180	7064.50	5179.74	779.90	-5131.99	0.97	
13154.00	90.550	266.600	7063.60	5272.71	773.99	-5225.79	0.45	
13248.00	90.400	266.620	7062.82	5365.73	768.43	-5319.63	0.16	
13341.00	90.370	266.950	7062.19	5457.80	763.21	-5412.48	0.36	
13433.00	90.430	268.450	7061.55	5549.07	759.52	-5504.40	1.63	
13526.00	90.490	268.860	7060.81	5641.52	757.34	-5597.37	0.45	
13618.00	90.580	269.150	7059.95	5733.03	755.74	-5689.35	0.33	
13711.00	90.430	269.340	7059.13	5825.58	754.51	-5782.34	0.26	
13803.00	90.620	269.710	7058.28	5917.17	753.75	-5874.33	0.45	



SRC ENERGY

Actual Wellpath Report

BOOMERANG 32C-6-M AWP

Page 7 of 10

**BAKER
HUGHES****REFERENCE WELLPATH IDENTIFICATION**

Operator	SRC ENERGY	Slot	SLOT#04 BOOMERANG 32C-6-M (1362'FNL & 2327'FWL, SEC.05)
Area	COLORADO	Well	BOOMERANG 32C-6-M
Field	WELD COUNTY (NAD83,TRUE NORTH)	Wellbore	BOOMERANG 32C-6-M AWB
Facility	SEC.05-T05N-R66W		

WELLPATH DATA (173 stations)

MD [ft]	Inclination [°]	Azimuth [°]	TVD [ft]	Vert Sect [ft]	North [ft]	East [ft]	DLS [°/100ft]	Comments
13896.00	90.460	269.270	7057.41	6009.75	752.92	-5967.32	0.50	
13988.00	90.400	269.210	7056.72	6101.31	751.70	-6059.31	0.09	
14082.00	89.970	269.050	7056.41	6194.83	750.28	-6153.30	0.49	
14175.00	90.060	269.680	7056.39	6287.40	749.24	-6246.30	0.68	
14270.00	90.120	269.430	7056.24	6381.99	748.51	-6341.29	0.27	
14364.00	90.000	269.150	7056.14	6475.54	747.34	-6435.29	0.32	
14458.00	90.060	268.800	7056.09	6569.04	745.66	-6529.27	0.38	
14553.00	90.120	267.530	7055.94	6663.39	742.62	-6624.22	1.34	
14645.00	90.370	267.140	7055.55	6754.59	738.34	-6716.12	0.50	
14739.00	90.430	266.750	7054.89	6847.69	733.33	-6809.98	0.42	
14834.00	90.180	266.470	7054.39	6941.70	727.71	-6904.82	0.40	
14928.00	90.060	264.540	7054.19	7034.44	720.35	-6998.52	2.06	
15022.00	90.310	266.360	7053.89	7127.16	712.89	-7092.22	1.95	
15116.00	90.150	267.680	7053.51	7220.28	708.00	-7186.09	1.41	
15210.00	90.180	267.830	7053.24	7313.55	704.32	-7280.02	0.16	
15304.00	90.120	268.010	7052.99	7406.85	700.91	-7373.96	0.20	
15396.00	90.250	270.510	7052.70	7498.40	699.72	-7465.94	2.72	
15489.00	90.180	270.590	7052.35	7591.14	700.62	-7558.94	0.11	
15582.00	90.150	269.040	7052.08	7683.77	700.31	-7651.93	1.67	
15675.00	90.280	268.520	7051.73	7776.24	698.33	-7744.91	0.58	
15768.00	90.280	267.780	7051.28	7868.60	695.33	-7837.86	0.80	
15878.00	90.150	265.290	7050.86	7977.43	688.68	-7947.65	2.27	LAST BHI MWD SURVEY (335'FNL & 137'FWL, SEC.06)
15902.00	90.150	265.290	7050.80	8001.09	686.71	-7971.57	0.00	PROJECTION TO BIT (337'FNL & 113'FWL, SEC.06)



Actual Wellpath Report

BOOMERANG 32C-6-M AWP

Page 8 of 10



REFERENCE WELLPATH IDENTIFICATION			
Operator	SRC ENERGY	Slot	SLOT#04 BOOMERANG 32C-6-M (1362'FNL & 2327'FWL, SEC.05)
Area	COLORADO	Well	BOOMERANG 32C-6-M
Field	WELD COUNTY (NAD83,TRUE NORTH)	Wellbore	BOOMERANG 32C-6-M AWB
Facility	SEC.05-T05N-R66W		

HOLE & CASING SECTIONS									
- Ref Wellbore: BOOMERANG 32C-6-M AWB					Ref Wellpath: BOOMERANG 32C-6-M AWP				
String/Diameter	Start MD [ft]	End MD [ft]	Interval [ft]	Start TVD [ft]	End TVD [ft]	Start N/S [ft]	Start E/W [ft]	End N/S [ft]	End E/W [ft]
13.5in Open Hole	20.00	1819.00	1799.00	20.00	1792.35	0.00	0.00	192.07	179.93
9.625in Casing Surface	20.00	1819.00	1799.00	20.00	1792.35	0.00	0.00	192.07	179.93
8.5in Open Hole	1819.00	15902.00	14083.00	1792.35	7050.80	192.07	179.93	686.71	-7971.57

TARGETS								
Name	TVD [ft]	North [ft]	East [ft]	Grid East [US ft]	Grid North [US ft]	Latitude	Longitude	Shape
SEC.03-T05N-R66W	15.00	44.83	4.49	3193876.47	1401538.91	40°26'00.730"N	104°48'12.704"W	polygon
SEC.04-T05N-R66W	15.00	44.83	4.49	3193876.47	1401538.91	40°26'00.730"N	104°48'12.704"W	polygon
SEC.05-T05N-R66W	15.00	44.83	4.49	3193876.47	1401538.91	40°26'00.730"N	104°48'12.704"W	polygon
SEC.06-T05N-R66W	15.00	44.83	4.49	3193876.47	1401538.91	40°26'00.730"N	104°48'12.704"W	polygon
BOOMERANG 32C-6-M BHL REV-2 (346'FNL & 150'FWL, SEC. 06)	7061.56	677.79	-7934.58	3185932.99	1402109.47	40°26'06.972"N	104°49'55.373"W	circle
BOOMERANG 32C-6-M BHL ON PLAT (346'FNL & 150'FWL, SEC. 06)	7068.00	677.79	-7934.58	3185932.99	1402109.47	40°26'06.972"N	104°49'55.373"W	circle
BOOMERANG 32C-6-M TOP OF PROD REV-2 (321'FNL & 2488'FWL, SEC.05)	7124.13	1046.29	265.00	3194129.09	1402542.35	40°26'10.626"N	104°48'09.335"W	circle
BOOMERANG 32C-6-M TOP OF PROD ON PLAT (321'FNL & 2488'FWL, SEC.05)	7140.00	1046.29	265.00	3194129.09	1402542.35	40°26'10.626"N	104°48'09.335"W	circle



Actual Wellpath Report

BOOMERANG 32C-6-M AWP

Page 9 of 10



REFERENCE WELLPATH IDENTIFICATION			
Operator	SRC ENERGY	Slot	SLOT#04 BOOMERANG 32C-6-M (1362'FNL & 2327'FWL, SEC.05)
Area	COLORADO	Well	BOOMERANG 32C-6-M
Field	WELD COUNTY (NAD83,TRUE NORTH)	Wellbore	BOOMERANG 32C-6-M AWB
Facility	SEC.05-T05N-R66W		

WELLPATH COMPOSITION - Ref Wellbore: BOOMERANG 32C-6-M AWB Ref Wellpath: BOOMERANG 32C-6-M AWP				
Start MD [ft]	End MD [ft]	Positional Uncertainty Model	Log Name/Comment	Wellbore
20.00	1764.00	BHI NaviTrak (Standard)	13 1/2" SURFACE SECTION <86-1748>	BOOMERANG 32C-6-M AWB
1764.00	15878.00	BHI AutoTrak Curve (IFR1, Short)	8 1/2" MONOBORE SURVEYS <1865'-15878'>	BOOMERANG 32C-6-M AWB
15878.00	15902.00	Blind Drilling (std)	Projection to bit	BOOMERANG 32C-6-M AWB



SRC ENERGY

Actual Wellpath Report

BOOMERANG 32C-6-M AWP

Page 10 of 10



**BAKER
HUGHES**

REFERENCE WELLPATH IDENTIFICATION

Operator	SRC ENERGY	Slot	SLOT#04 BOOMERANG 32C-6-M (1362'FNL & 2327'FWL, SEC.05)
Area	COLORADO	Well	BOOMERANG 32C-6-M
Field	WELD COUNTY (NAD83,TRUE NORTH)	Wellbore	BOOMERANG 32C-6-M AWB
Facility	SEC.05-T05N-R66W		

WELLPATH COMMENTS

MD [ft]	Inclination [°]	Azimuth [°]	TVD [ft]	Comment
7650.00	89.230	270.540	7122.43	LANDING POINT (313'FNL & 2487'FWL, SEC.05)
15878.00	90.150	265.290	7050.86	LAST BHI MWD SURVEY (335'FNL & 137'FWL, SEC.06)
15902.00	90.150	265.290	7050.80	PROJECTION TO BIT (337'FNL & 113'FWL, SEC.06)