

# SRC ENERGY

Location: COLORADO Slot: SLOT#16 BOOMERANG 28C-3-L (1541'FNL & 2327'FWL, SEC.05)  
Field: WELD COUNTY (NAD83, TRUE NORTH) Well: BOOMERANG 28C-3-L  
Facility: SEC.05-T05N-R66W Wellbore: BOOMERANG 28C-3-L PWB

Plot reference wellpath is BOOMERANG 28C-3-L PWB (REV-C.0)	Grid System: NAD83 / Lambert Colorado SP, Northern Zone (501), US feet
True vertical depths are referenced to PRECISION 462' (20') (RKB)	* = Wellpath was transformed from a different geodetic datum
Measured depths are referenced to PRECISION 462' (20') (RKB)	North Reference: True north
PRECISION 462' (20') (RKB) to Mean Sea Level: 4789 feet	Scale: True distance
Mean Sea Level to Mud line (At Slot: SLOT#16 BOOMERANG 28C-3-L (1541'FNL & 2327'FWL, SEC.05)): 0 feet	Depths are in feet
Coordinates are in feet referenced to Slot	Created by: doddanna on 2018-04-12
	Database: WellArchitectDB

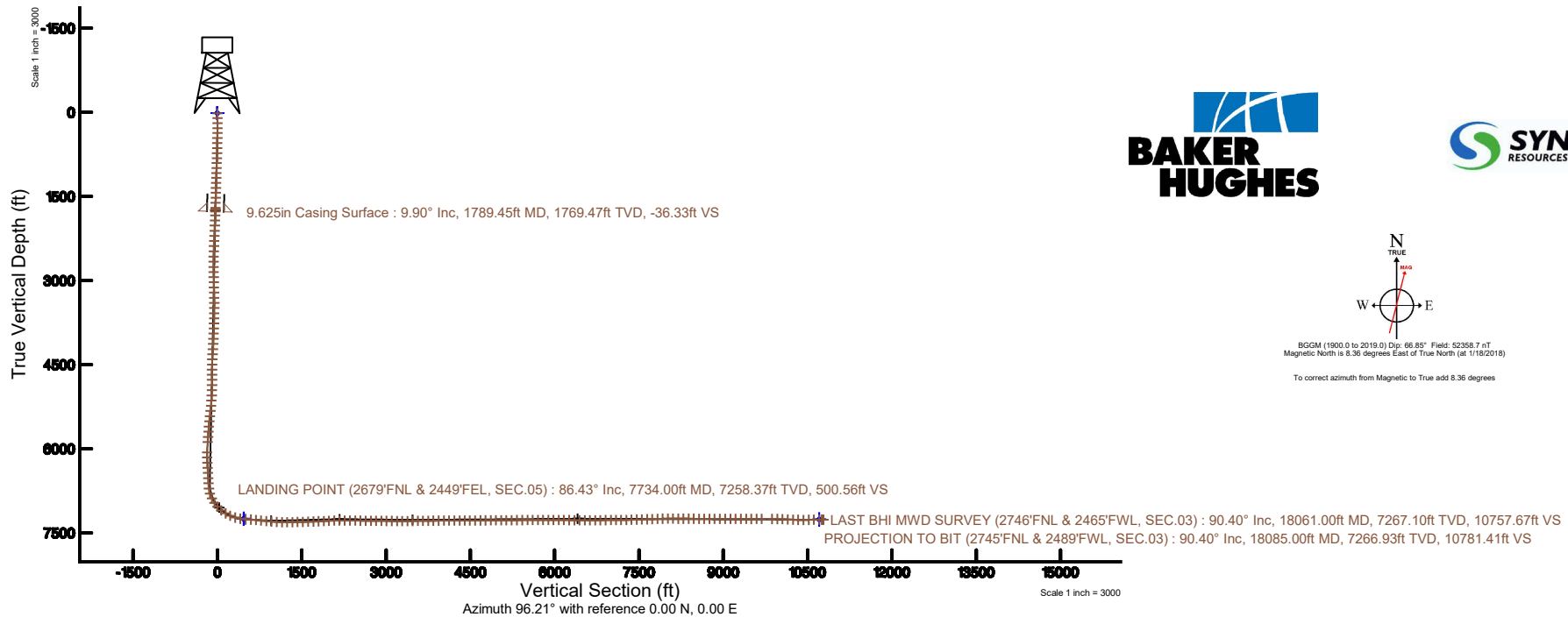

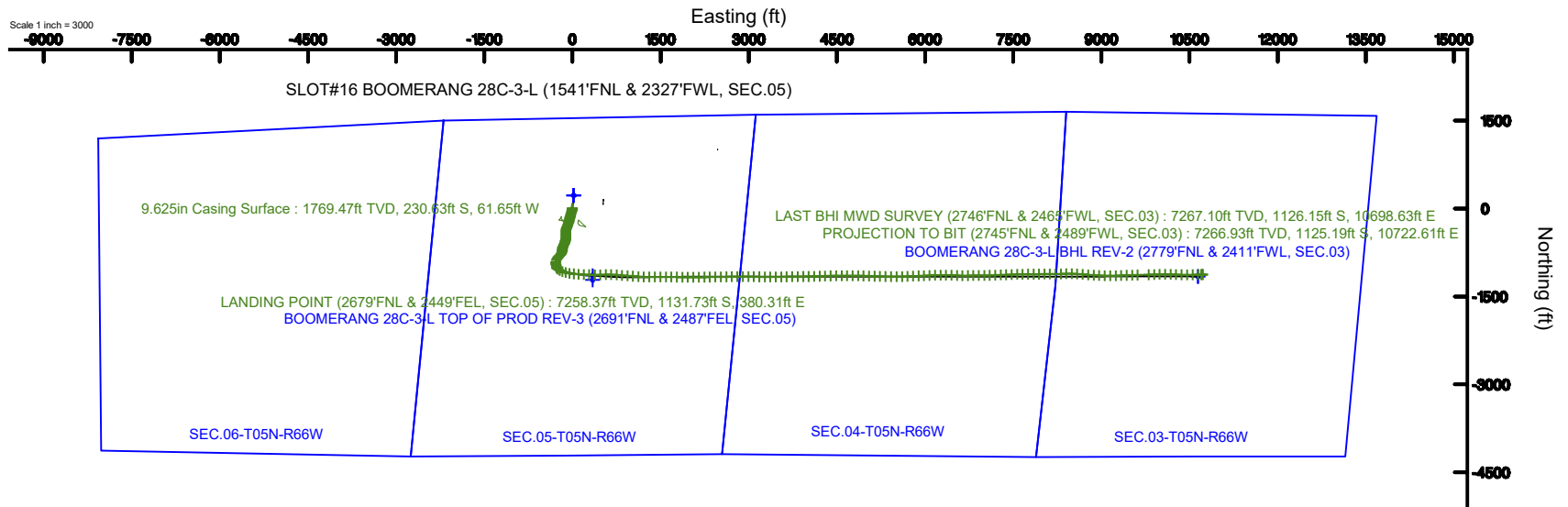

# Actual Wellpath Report

BOOMERANG 28C-3-L AWP

Page 1 of 10



## REFERENCE WELLPATH IDENTIFICATION

Operator	SRC ENERGY	Slot	SLOT#16 BOOMERANG 28C-3-L (1541'FNL & 2327'FWL, SEC.05)
Area	COLORADO	Well	BOOMERANG 28C-3-L
Field	WELD COUNTY (NAD83,TRUE NORTH)	Wellbore	BOOMERANG 28C-3-L AWB
Facility	SEC.05-T05N-R66W		

## REPORT SETUP INFORMATION

Projection System	NAD83 / Lambert Colorado SP, Northern Zone (501), US feet	Software System	WellArchitect® 5.0
North Reference	True	User	Doddanna
Scale	0.999962	Report Generated	4/12/2018 at 2:11:43 PM
Convergence at slot	0.45° East	Database/Source file	WellArchitectDB/BOOMERANG_28C-3-L_AWP.xml

## WELLPATH LOCATION

	Local coordinates		Grid coordinates		Geographic coordinates	
	North[ft]	East[ft]	Easting[US ft]	Northing[US ft]	Latitude	Longitude
Slot Location	-224.05	-22.04	3193856.19	1401314.70	40°25'58.516"N	104°48'12.989"W
Facility Reference Pt			3193876.47	1401538.91	40°26'00.730"N	104°48'12.704"W
Field Reference Pt			3171284.48	1426358.81	40°30'07.643"N	104°53'02.634"W

## WELLPATH DATUM

Calculation method	Minimum curvature	PRECISION 462' (20') (RKB) to Facility Vertical Datum	4789.00ft
Horizontal Reference Pt	Slot	PRECISION 462' (20') (RKB) to Mean Sea Level	4789.00ft
Vertical Reference Pt	PRECISION 462' (20') (RKB)	PRECISION 462' (20') (RKB) to Mud Line at Slot (SLOT#16 BOOMERANG 28C-3-L (1541'FNL & 2327'FWL, SEC.05))	4789.00ft
MD Reference Pt	PRECISION 462' (20') (RKB)	Section Origin	N 0.00, E 0.00 ft
Field Vertical Reference	Mean Sea Level	Section Azimuth	96.21°



SRC ENERGY

# Actual Wellpath Report

BOOMERANG 28C-3-L AWP

Page 2 of 10

**BAKER  
HUGHES****REFERENCE WELLPATH IDENTIFICATION**

Operator	SRC ENERGY	Slot	SLOT#16 BOOMERANG 28C-3-L (1541'FNL & 2327'FWL, SEC.05)
Area	COLORADO	Well	BOOMERANG 28C-3-L
Field	WELD COUNTY (NAD83,TRUE NORTH)	Wellbore	BOOMERANG 28C-3-L AWB
Facility	SEC.05-T05N-R66W		

**WELLPATH DATA (196 stations) † = interpolated/extrapolated station**

MD [ft]	Inclination [°]	Azimuth [°]	TVD [ft]	Vert Sect [ft]	North [ft]	East [ft]	DLS [°/100ft]	Comments
0.00†	0.000	138.550	0.00	0.00	0.00	0.00	0.00	
20.00	0.000	138.550	20.00	0.00	0.00	0.00	0.00	
102.00	0.640	138.550	102.00	0.34	-0.34	0.30	0.78	
192.00	0.610	156.630	191.99	0.95	-1.16	0.83	0.22	
285.00	1.890	193.550	284.97	1.00	-3.11	0.66	1.56	
371.00	3.220	196.740	370.88	0.37	-6.80	-0.37	1.55	
461.00	5.550	194.980	460.61	-0.75	-13.42	-2.22	2.59	
551.00	6.930	193.720	550.08	-2.13	-22.90	-4.63	1.54	
641.00	8.040	193.700	639.31	-3.65	-34.29	-7.41	1.23	
731.00	9.380	197.050	728.27	-5.85	-47.42	-11.05	1.59	
821.00	9.970	196.920	816.99	-8.68	-61.88	-15.47	0.66	
911.00	9.530	196.430	905.69	-11.45	-76.48	-19.84	0.50	
1001.00	11.220	195.610	994.21	-14.20	-92.07	-24.31	1.88	
1091.00	11.070	195.580	1082.52	-17.04	-108.82	-28.98	0.17	
1181.00	10.770	195.050	1170.89	-19.73	-125.26	-33.49	0.35	
1271.00	10.800	196.230	1259.30	-22.49	-141.48	-38.03	0.25	
1361.00	10.550	195.610	1347.74	-25.30	-157.51	-42.60	0.31	
1451.00	10.110	193.700	1436.28	-27.68	-173.12	-46.69	0.62	
1541.00	10.060	193.870	1524.89	-29.76	-188.43	-50.45	0.06	
1631.00	10.040	194.520	1613.51	-31.94	-203.65	-54.30	0.13	
1721.00	10.370	195.740	1702.09	-34.41	-219.05	-58.46	0.44	
1751.00	10.110	194.810	1731.61	-35.25	-224.19	-59.87	1.03	
1858.00	9.540	198.680	1837.04	-38.57	-241.67	-65.11	0.81	
1950.00	9.610	200.620	1927.76	-42.12	-256.08	-70.25	0.36	
2042.00	9.610	201.440	2018.47	-46.05	-270.41	-75.76	0.15	
2137.00	9.530	198.760	2112.15	-49.84	-285.24	-81.19	0.48	
2229.00	9.470	200.830	2202.88	-53.41	-299.53	-86.33	0.38	
2322.00	9.570	201.790	2294.60	-57.41	-313.86	-91.92	0.20	
2415.00	9.560	199.320	2386.31	-61.24	-328.32	-97.35	0.44	
2509.00	9.460	196.200	2479.02	-64.35	-343.11	-102.09	0.56	



SRC ENERGY

# Actual Wellpath Report

BOOMERANG 28C-3-L AWP

Page 3 of 10

**BAKER  
HUGHES****REFERENCE WELLPATH IDENTIFICATION**

Operator	SRC ENERGY	Slot	SLOT#16 BOOMERANG 28C-3-L (1541'FNL & 2327'FWL, SEC.05)
Area	COLORADO	Well	BOOMERANG 28C-3-L
Field	WELD COUNTY (NAD83,TRUE NORTH)	Wellbore	BOOMERANG 28C-3-L AWB
Facility	SEC.05-T05N-R66W		

**WELLPATH DATA (196 stations)**

MD [ft]	Inclination [°]	Azimuth [°]	TVD [ft]	Vert Sect [ft]	North [ft]	East [ft]	DLS [°/100ft]	Comments
2604.00	9.520	194.460	2572.72	-66.83	-358.21	-106.23	0.31	
2698.00	9.540	188.410	2665.43	-68.25	-373.44	-109.31	1.07	
2791.00	9.600	182.900	2757.13	-68.09	-388.81	-110.83	0.99	
2884.00	9.490	182.140	2848.85	-67.10	-404.22	-111.50	0.18	
2976.00	9.680	178.600	2939.56	-65.54	-419.53	-111.60	0.67	
3069.00	9.360	178.640	3031.28	-63.50	-434.91	-111.23	0.34	
3162.00	9.500	177.960	3123.02	-61.41	-450.14	-110.78	0.19	
3255.00	9.480	176.490	3214.75	-59.01	-465.45	-110.03	0.26	
3349.00	9.420	179.170	3307.48	-56.76	-480.87	-109.45	0.47	
3441.00	9.480	183.980	3398.23	-55.54	-495.96	-109.86	0.86	
3535.00	9.490	191.030	3490.95	-55.89	-511.29	-111.88	1.24	
3628.00	9.500	191.740	3582.67	-57.27	-526.33	-114.91	0.13	
3720.00	9.670	193.480	3673.39	-58.98	-541.27	-118.26	0.37	
3812.00	9.540	196.160	3764.10	-61.28	-556.11	-122.18	0.51	
3906.00	9.540	197.600	3856.80	-64.16	-571.02	-126.71	0.25	
3998.00	9.600	199.520	3947.52	-67.43	-585.51	-131.57	0.35	
4091.00	9.550	201.280	4039.22	-71.22	-600.01	-136.96	0.32	
4185.00	9.460	202.980	4131.93	-75.48	-614.39	-142.81	0.31	
4279.00	9.490	205.410	4224.65	-80.25	-628.50	-149.15	0.43	
4372.00	9.540	208.200	4316.37	-85.66	-642.22	-156.08	0.50	
4464.00	9.510	204.260	4407.11	-90.87	-655.87	-162.81	0.71	
4556.00	9.410	196.230	4497.86	-94.53	-670.02	-168.03	1.44	
4649.00	9.500	187.190	4589.60	-95.98	-684.93	-171.12	1.60	
4741.00	9.410	182.810	4680.35	-95.67	-699.98	-172.44	0.79	
4834.00	9.510	184.130	4772.09	-94.94	-715.23	-173.36	0.26	
4927.00	9.490	190.970	4863.81	-95.29	-730.42	-175.38	1.21	
5021.00	9.470	197.240	4956.53	-97.41	-745.42	-179.14	1.10	
5114.00	9.460	203.700	5048.27	-101.17	-759.72	-184.48	1.14	
5208.00	9.180	211.360	5141.03	-106.68	-773.20	-191.49	1.35	
5302.00	9.490	217.280	5233.79	-113.87	-785.77	-200.09	1.07	



# Actual Wellpath Report

## BOOMERANG 28C-3-L AWP

Page 4 of 10



REFERENCE WELLPATH IDENTIFICATION			
Operator	SRC ENERGY	Slot	SLOT#16 BOOMERANG 28C-3-L (1541'FNL & 2327'FWL, SEC.05)
Area	COLORADO	Well	BOOMERANG 28C-3-L
Field	WELD COUNTY (NAD83,TRUE NORTH)	Wellbore	BOOMERANG 28C-3-L AWB
Facility	SEC.05-T05N-R66W		

WELLPATH DATA (196 stations)								
MD [ft]	Inclination [°]	Azimuth [°]	TVD [ft]	Vert Sect [ft]	North [ft]	East [ft]	DLS [°/100ft]	Comments
5396.00	9.400	222.180	5326.52	-122.37	-797.62	-209.93	0.86	
5491.00	9.420	228.870	5420.24	-132.20	-808.48	-221.00	1.15	
5583.00	9.390	228.250	5511.00	-142.33	-818.43	-232.27	0.11	
5677.00	9.540	219.200	5603.73	-151.70	-829.58	-242.91	1.59	
5771.00	9.440	210.820	5696.45	-159.15	-842.23	-251.79	1.47	
5866.00	10.440	207.720	5790.02	-165.55	-856.55	-259.78	1.19	
5958.00	11.590	209.760	5880.33	-172.30	-871.95	-268.25	1.32	
6147.00	10.270	192.420	6065.94	-181.71	-904.89	-281.30	1.87	
6241.00	11.570	183.730	6158.25	-182.21	-922.49	-283.72	2.23	
6336.00	11.670	173.630	6251.31	-179.70	-941.54	-283.27	2.14	
6428.00	10.240	161.870	6341.64	-174.30	-958.56	-279.69	2.88	
6521.00	9.960	162.720	6433.20	-167.69	-974.10	-274.73	0.34	
6615.00	10.040	170.000	6525.78	-162.16	-989.93	-270.89	1.35	
6708.00	10.030	173.860	6617.35	-158.16	-1005.97	-268.62	0.72	
6802.00	11.200	145.560	6709.81	-150.46	-1021.65	-262.58	5.62	
6895.00	18.700	126.250	6799.65	-131.63	-1037.94	-245.41	9.58	
6988.00	27.350	117.580	6885.18	-98.76	-1056.69	-214.38	9.97	
7081.00	33.660	112.010	6965.28	-54.01	-1076.26	-171.50	7.43	
7173.00	42.480	104.790	7037.68	1.38	-1093.79	-117.69	10.73	
7265.00	51.240	98.290	7100.56	68.11	-1106.93	-52.00	10.82	
7358.00	59.040	94.440	7153.69	144.34	-1115.26	23.77	9.05	
7451.00	66.470	93.870	7196.23	226.91	-1121.23	106.18	8.01	
7545.00	73.070	92.870	7228.72	314.95	-1126.40	194.18	7.09	
7639.00	82.120	91.480	7248.89	406.43	-1129.86	285.82	9.74	
7734.00	86.430	90.790	7258.37	500.56	-1131.73	380.31	4.59	LANDING POINT (2679'FNL & 2449'FEL, SEC.05)
7828.00	86.390	88.480	7264.25	593.75	-1131.13	474.12	2.45	
7922.00	84.380	88.440	7271.82	686.59	-1128.61	567.77	2.14	
8014.00	84.420	91.870	7280.80	777.62	-1128.86	659.32	3.71	
8107.00	84.450	93.960	7289.82	870.03	-1133.57	751.76	2.24	
8200.00	84.390	94.640	7298.86	962.53	-1140.51	844.05	0.73	



SRC ENERGY

# Actual Wellpath Report

BOOMERANG 28C-3-L AWP

Page 5 of 10

**BAKER  
HUGHES****REFERENCE WELLPATH IDENTIFICATION**

Operator	SRC ENERGY	Slot	SLOT#16 BOOMERANG 28C-3-L (1541'FNL & 2327'FWL, SEC.05)
Area	COLORADO	Well	BOOMERANG 28C-3-L
Field	WELD COUNTY (NAD83,TRUE NORTH)	Wellbore	BOOMERANG 28C-3-L AWB
Facility	SEC.05-T05N-R66W		

**WELLPATH DATA (196 stations)**

MD [ft]	Inclination [°]	Azimuth [°]	TVD [ft]	Vert Sect [ft]	North [ft]	East [ft]	DLS [°/100ft]	Comments
8293.00	86.030	94.230	7306.62	1055.16	-1147.67	936.45	1.82	
8386.00	88.610	94.310	7310.97	1148.00	-1154.59	1029.08	2.78	
8479.00	90.620	93.680	7311.60	1240.92	-1161.07	1121.85	2.26	
8572.00	91.420	92.060	7309.94	1333.74	-1165.72	1214.71	1.94	
8665.00	91.480	90.560	7307.59	1426.37	-1167.85	1307.65	1.61	
8759.00	91.540	90.020	7305.11	1519.84	-1168.32	1401.62	0.58	
8853.00	91.350	89.820	7302.74	1613.24	-1168.19	1495.59	0.29	
8949.00	92.890	90.100	7299.19	1708.60	-1168.13	1591.52	1.63	
9041.00	92.830	90.240	7294.60	1799.97	-1168.40	1683.41	0.17	
9134.00	92.890	90.820	7289.96	1892.40	-1169.26	1776.29	0.63	
9228.00	93.140	91.180	7285.02	1985.88	-1170.90	1870.14	0.47	
9321.00	91.350	91.020	7281.37	2078.44	-1172.68	1963.05	1.93	
9413.00	89.420	89.360	7280.75	2169.92	-1172.99	2055.04	2.77	
9508.00	89.570	88.990	7281.59	2264.20	-1171.62	2150.03	0.42	
9602.00	89.600	89.320	7282.27	2357.49	-1170.23	2244.01	0.35	
9696.00	89.570	89.150	7282.95	2450.79	-1168.98	2338.00	0.18	
9790.00	89.420	89.350	7283.78	2544.09	-1167.75	2431.99	0.27	
9885.00	89.480	89.200	7284.69	2638.39	-1166.54	2526.98	0.17	
9978.00	89.450	89.020	7285.56	2730.67	-1165.10	2619.96	0.20	
10071.00	89.540	89.220	7286.38	2822.96	-1163.67	2712.95	0.24	
10164.00	89.320	89.720	7287.31	2915.31	-1162.81	2805.94	0.59	
10257.00	89.410	89.760	7288.34	3007.71	-1162.39	2898.93	0.11	
10351.00	89.480	90.560	7289.25	3101.18	-1162.65	2992.93	0.85	
10445.00	89.450	90.640	7290.13	3194.73	-1163.64	3086.92	0.09	
10539.00	89.350	90.750	7291.11	3288.29	-1164.78	3180.91	0.16	
10632.00	90.890	91.130	7290.92	3380.89	-1166.30	3273.89	1.71	
10725.00	90.950	90.900	7289.42	3473.49	-1167.95	3366.86	0.26	
10818.00	91.050	89.170	7287.80	3565.94	-1168.01	3459.85	1.86	
10911.00	90.520	88.830	7286.52	3658.19	-1166.38	3552.82	0.68	
11005.00	90.680	88.610	7285.54	3751.38	-1164.28	3646.79	0.29	



SRC ENERGY

# Actual Wellpath Report

BOOMERANG 28C-3-L AWP

Page 6 of 10

**BAKER  
HUGHES****REFERENCE WELLPATH IDENTIFICATION**

Operator	SRC ENERGY	Slot	SLOT#16 BOOMERANG 28C-3-L (1541'FNL & 2327'FWL, SEC.05)
Area	COLORADO	Well	BOOMERANG 28C-3-L
Field	WELD COUNTY (NAD83,TRUE NORTH)	Wellbore	BOOMERANG 28C-3-L AWB
Facility	SEC.05-T05N-R66W		

**WELLPATH DATA (196 stations)**

MD [ft]	Inclination [°]	Azimuth [°]	TVD [ft]	Vert Sect [ft]	North [ft]	East [ft]	DLS [°/100ft]	Comments
11097.00	90.710	88.930	7284.42	3842.60	-1162.31	3738.77	0.35	
11190.00	90.250	89.310	7283.65	3934.89	-1160.88	3831.75	0.64	
11285.00	90.280	89.950	7283.21	4029.26	-1160.27	3926.75	0.67	
11379.00	90.370	89.180	7282.67	4122.62	-1159.55	4020.74	0.82	
11473.00	90.310	88.690	7282.12	4215.86	-1157.81	4114.72	0.53	
11567.00	90.310	88.230	7281.61	4309.00	-1155.28	4208.69	0.49	
11659.00	90.220	88.120	7281.18	4400.10	-1152.35	4300.64	0.15	
11752.00	90.580	88.520	7280.53	4492.21	-1149.62	4393.60	0.58	
11847.00	90.340	89.660	7279.77	4586.48	-1148.11	4488.58	1.23	
11939.00	90.460	89.680	7279.13	4677.87	-1147.58	4580.58	0.13	
12032.00	90.520	90.090	7278.33	4770.30	-1147.40	4673.57	0.45	
12125.00	90.370	90.060	7277.61	4862.77	-1147.52	4766.57	0.16	
12219.00	90.400	90.610	7276.98	4956.27	-1148.07	4860.57	0.59	
12312.00	90.370	91.170	7276.35	5048.87	-1149.51	4953.55	0.60	
12405.00	90.430	91.730	7275.70	5141.54	-1151.87	5046.52	0.61	
12499.00	90.370	91.790	7275.05	5235.26	-1154.75	5140.47	0.09	
12593.00	90.620	91.540	7274.23	5328.96	-1157.49	5234.43	0.38	
12688.00	90.550	91.520	7273.26	5423.64	-1160.02	5329.39	0.08	
12782.00	90.680	90.840	7272.26	5517.27	-1161.96	5423.37	0.74	
12876.00	90.430	89.820	7271.35	5610.77	-1162.50	5517.36	1.12	
12969.00	90.280	89.390	7270.77	5703.15	-1161.86	5610.36	0.49	
13061.00	90.370	86.220	7270.25	5794.15	-1158.33	5702.27	3.45	
13155.00	88.980	87.140	7270.78	5886.84	-1152.89	5796.11	1.77	
13248.00	88.980	89.160	7272.44	5978.90	-1149.89	5889.04	2.17	
13341.00	91.630	87.420	7271.94	6071.00	-1147.11	5981.99	3.41	
13436.00	88.740	87.090	7271.63	6164.83	-1142.57	6076.87	3.06	
13531.00	88.920	88.020	7273.57	6258.73	-1138.51	6171.76	1.00	
13624.00	89.750	88.910	7274.65	6350.87	-1136.02	6264.72	1.31	
13716.00	89.750	90.320	7275.06	6442.26	-1135.40	6356.72	1.53	
13810.00	89.720	92.230	7275.49	6535.91	-1137.50	6450.69	2.03	



# Actual Wellpath Report

## BOOMERANG 28C-3-L AWP

Page 7 of 10



### REFERENCE WELLPATH IDENTIFICATION

Operator	SRC ENERGY	Slot	SLOT#16 BOOMERANG 28C-3-L (1541'FNL & 2327'FWL, SEC.05)
Area	COLORADO	Well	BOOMERANG 28C-3-L
Field	WELD COUNTY (NAD83,TRUE NORTH)	Wellbore	BOOMERANG 28C-3-L AWB
Facility	SEC.05-T05N-R66W		

### WELLPATH DATA (196 stations)

MD [ft]	Inclination [°]	Azimuth [°]	TVD [ft]	Vert Sect [ft]	North [ft]	East [ft]	DLS [°/100ft]	Comments
13903.00	89.750	93.440	7275.92	6628.74	-1142.10	6543.57	1.30	
13996.00	90.580	90.790	7275.65	6721.49	-1145.53	6636.50	2.99	
14089.00	90.620	88.970	7274.68	6813.92	-1145.33	6729.49	1.96	
14181.00	90.710	88.900	7273.61	6905.17	-1143.62	6821.47	0.12	
14276.00	90.000	88.890	7273.02	6999.39	-1141.79	6916.45	0.75	
14368.00	90.590	89.320	7272.55	7090.69	-1140.35	7008.43	0.79	
14461.00	90.860	90.050	7271.37	7183.07	-1139.84	7101.42	0.84	
14554.00	90.890	87.410	7269.95	7275.26	-1137.78	7194.38	2.84	
14648.00	91.910	87.730	7267.65	7368.17	-1133.80	7288.27	1.14	
14740.00	91.910	87.660	7264.59	7459.10	-1130.10	7380.14	0.08	
14834.00	91.940	88.230	7261.43	7552.07	-1126.73	7474.03	0.61	
14927.00	91.850	88.290	7258.35	7644.13	-1123.91	7566.93	0.12	
15020.00	91.910	88.700	7255.30	7736.23	-1121.47	7659.85	0.45	
15113.00	91.850	89.650	7252.25	7828.48	-1120.13	7752.79	1.02	
15207.00	91.850	90.370	7249.22	7921.88	-1120.14	7846.74	0.77	
15299.00	89.910	89.020	7247.81	8013.27	-1119.65	7938.72	2.57	
15392.00	89.850	89.640	7248.00	8105.60	-1118.57	8031.72	0.67	
15485.00	89.820	90.210	7248.27	8198.04	-1118.45	8124.72	0.61	
15578.00	89.880	89.400	7248.51	8290.46	-1118.13	8217.71	0.87	
15671.00	89.720	87.540	7248.84	8382.60	-1115.65	8310.68	2.01	
15763.00	89.690	89.450	7249.31	8473.77	-1113.23	8402.64	2.08	
15857.00	89.750	90.750	7249.77	8567.23	-1113.39	8496.64	1.38	
15949.00	89.750	92.940	7250.17	8658.95	-1116.36	8588.58	2.38	
16043.00	89.780	94.860	7250.56	8752.87	-1122.75	8682.36	2.04	
16136.00	89.820	94.790	7250.88	8845.84	-1130.57	8775.03	0.09	
16231.00	89.720	93.670	7251.26	8940.79	-1137.58	8869.77	1.18	
16325.00	89.780	92.890	7251.67	9034.66	-1142.96	8963.61	0.83	
16418.00	89.820	91.380	7252.00	9127.42	-1146.42	9056.54	1.62	
16512.00	89.690	89.450	7252.40	9220.94	-1147.10	9150.54	2.06	
16606.00	89.780	88.750	7252.83	9314.21	-1145.63	9244.52	0.75	





# Actual Wellpath Report

## BOOMERANG 28C-3-L AWP

Page 8 of 10



### REFERENCE WELLPATH IDENTIFICATION

Operator	SRC ENERGY	Slot	SLOT#16 BOOMERANG 28C-3-L (1541'FNL & 2327'FWL, SEC.05)
Area	COLORADO	Well	BOOMERANG 28C-3-L
Field	WELD COUNTY (NAD83,TRUE NORTH)	Wellbore	BOOMERANG 28C-3-L AWB
Facility	SEC.05-T05N-R66W		

### WELLPATH DATA (196 stations)

MD [ft]	Inclination [°]	Azimuth [°]	TVD [ft]	Vert Sect [ft]	North [ft]	East [ft]	DLS [°/100ft]	Comments
16699.00	89.820	87.880	7253.16	9406.33	-1142.89	9337.48	0.94	
16792.00	89.850	87.870	7253.43	9498.34	-1139.44	9430.42	0.03	
16886.00	90.920	88.690	7252.79	9591.44	-1136.62	9524.37	1.43	
16978.00	89.660	88.780	7252.33	9682.65	-1134.59	9616.34	1.37	
17166.00	89.720	88.100	7253.35	9868.92	-1129.47	9804.27	0.36	
17260.00	88.830	88.010	7254.54	9961.96	-1126.28	9898.21	0.95	
17353.00	87.660	89.010	7257.38	10054.08	-1123.86	9991.13	1.65	
17447.00	87.690	90.220	7261.20	10147.38	-1123.23	10085.05	1.29	
17540.00	86.740	90.610	7265.72	10239.79	-1123.91	10177.94	1.10	
17634.00	88.860	92.020	7269.32	10333.37	-1126.06	10271.83	2.71	
17728.00	90.620	92.760	7269.75	10427.16	-1129.98	10365.75	2.03	
17822.00	90.490	89.300	7268.84	10520.75	-1131.67	10459.71	3.68	
17916.00	90.400	88.980	7268.11	10614.03	-1130.26	10553.70	0.35	
18008.00	90.400	88.240	7267.47	10705.22	-1128.03	10645.67	0.80	
18061.00	90.400	87.700	7267.10	10757.67	-1126.15	10698.63	1.02	LAST BHI MWD SURVEY (2746'FNL & 2465'FWL, SEC.03)
18085.00	90.400	87.700	7266.93	10781.41	-1125.19	10722.61	0.00	PROJECTION TO BIT (2745'FNL & 2489'FWL, SEC.03)

### HOLE & CASING SECTIONS

- Ref Wellbore: BOOMERANG 28C-3-L AWB      Ref Wellpath: BOOMERANG 28C-3-L AWP

String/Diameter	Start MD [ft]	End MD [ft]	Interval [ft]	Start TVD [ft]	End TVD [ft]	Start N/S [ft]	Start E/W [ft]	End N/S [ft]	End E/W [ft]
13.5in Open Hole	20.00	1789.45	1769.45	20.00	1769.47	0.00	0.00	-230.63	-61.65
9.625in Casing Surface	20.00	1789.45	1769.45	20.00	1769.47	0.00	0.00	-230.63	-61.65
8.5in Open Hole	1789.45	18085.00	16295.55	1769.47	7266.93	-230.63	-61.65	-1125.19	10722.61



# Actual Wellpath Report

## BOOMERANG 28C-3-L AWP

Page 9 of 10



### REFERENCE WELLPATH IDENTIFICATION

Operator	SRC ENERGY	Slot	SLOT#16 BOOMERANG 28C-3-L (1541'FNL & 2327'FWL, SEC.05)
Area	COLORADO	Well	BOOMERANG 28C-3-L
Field	WELD COUNTY (NAD83,TRUE NORTH)	Wellbore	BOOMERANG 28C-3-L AWB
Facility	SEC.05-T05N-R66W		

### TARGETS

Name	TVD [ft]	North [ft]	East [ft]	Grid East [US ft]	Grid North [US ft]	Latitude	Longitude	Shape
SEC.03-T05N-R66W	15.00	224.05	22.04	3193876.47	1401538.91	40°26'00.730"N	104°48'12.704"W	polygon
SEC.04-T05N-R66W	15.00	224.05	22.04	3193876.47	1401538.91	40°26'00.730"N	104°48'12.704"W	polygon
SEC.05-T05N-R66W	15.00	224.05	22.04	3193876.47	1401538.91	40°26'00.730"N	104°48'12.704"W	polygon
SEC.06-T05N-R66W	15.00	224.05	22.04	3193876.47	1401538.91	40°26'00.730"N	104°48'12.704"W	polygon
BOOMERANG 28C-3-L TOP OF PROD ON PLAT (2766'FNL & 2487'FEL, SEC.05)	7244.00	-1219.03	343.59	3194209.33	1400098.46	40°25'46.470"N	104°48'08.546"W	point
BOOMERANG 28C-3-L TOP OF PROD REV-3 (2691'FNL & 2487'FEL, SEC.05)	7253.85	-1144.03	342.17	3194207.32	1400173.44	40°25'47.211"N	104°48'08.564"W	circle
BOOMERANG 28C-3-L BHL ON PLAT (2779'FNL & 2411'FWL, SEC.03)	7255.00	-1158.86	10644.37	3204508.90	1400239.52	40°25'47.042"N	104°45'55.346"W	point
BOOMERANG 28C-3-L BHL REV-2 (2779'FNL & 2411'FWL, SEC.03)	7267.32	-1158.86	10644.37	3204508.90	1400239.52	40°25'47.042"N	104°45'55.346"W	circle

### WELLPATH COMPOSITION - Ref Wellbore: BOOMERANG 28C-3-L AWB Ref Wellpath: BOOMERANG 28C-3-L AWP

Start MD [ft]	End MD [ft]	Positional Uncertainty Model	Log Name/Comment	Wellbore
20.00	1751.00	BHI NaviTrak (Standard)	13 1/2" SURFACE SECTION <86-1735>	BOOMERANG 28C-3-L AWB
1751.00	18061.00	BHI AutoTrak Curve (IFR1, Short)	8 1/2" ATC MONOBORE SURVEYS <1858'-18061'>	BOOMERANG 28C-3-L AWB
18061.00	18085.00	Blind Drilling (std)	Projection to bit	BOOMERANG 28C-3-L AWB



SRC ENERGY

# Actual Wellpath Report

BOOMERANG 28C-3-L AWP

Page 10 of 10



**BAKER  
HUGHES**

## REFERENCE WELLPATH IDENTIFICATION

Operator	SRC ENERGY	Slot	SLOT#16 BOOMERANG 28C-3-L (1541'FNL & 2327'FWL, SEC.05)
Area	COLORADO	Well	BOOMERANG 28C-3-L
Field	WELD COUNTY (NAD83,TRUE NORTH)	Wellbore	BOOMERANG 28C-3-L AWB
Facility	SEC.05-T05N-R66W		

## WELLPATH COMMENTS

MD [ft]	Inclination [°]	Azimuth [°]	TVD [ft]	Comment
7734.00	86.430	90.790	7258.37	LANDING POINT (2679'FNL & 2449'FEL, SEC.05)
18061.00	90.400	87.700	7267.10	LAST BHI MWD SURVEY (2746'FNL & 2465'FWL, SEC.03)
18085.00	90.400	87.700	7266.93	PROJECTION TO BIT (2745'FNL & 2489'FWL, SEC.03)