

SRC ENERGY

Location: COLORADO Slot: SLOT#09 BOOMERANG 33C-6-M (1436'FNL & 2327'FWL, SEC.05)
Field: WELD COUNTY (NAD83, TRUE NORTH) Well: BOOMERANG 33C-6-M
Facility: SEC.05-T05N-R66W Wellbore: BOOMERANG 33C-6-M PWB

Plot reference wellpath is BOOMERANG 33C-6-M PWB (REV-B.0)	Grid System: NAD83 / Lambert Colorado SP, Northern Zone (501), US feet
True vertical depths are referenced to PRECISION 462 (20') (RKB)	* = Wellpath was transformed from a different geodetic datum
Measured depths are referenced to PRECISION 462 (20') (RKB)	North Reference: True north
PRECISION 462 (20') (RKB) to Mean Sea Level: 4789 feet	Scale: True distance
Mean Sea Level to Mud line (At Slot: SLOT#09 BOOMERANG 33C-6-M (1436'FNL & 2327'FWL, SEC.05)): 0 feet	Depths are in feet
Coordinates are in feet referenced to Slot	Created by: doddanna on 2018-04-13
	Database: WellArchitectDB

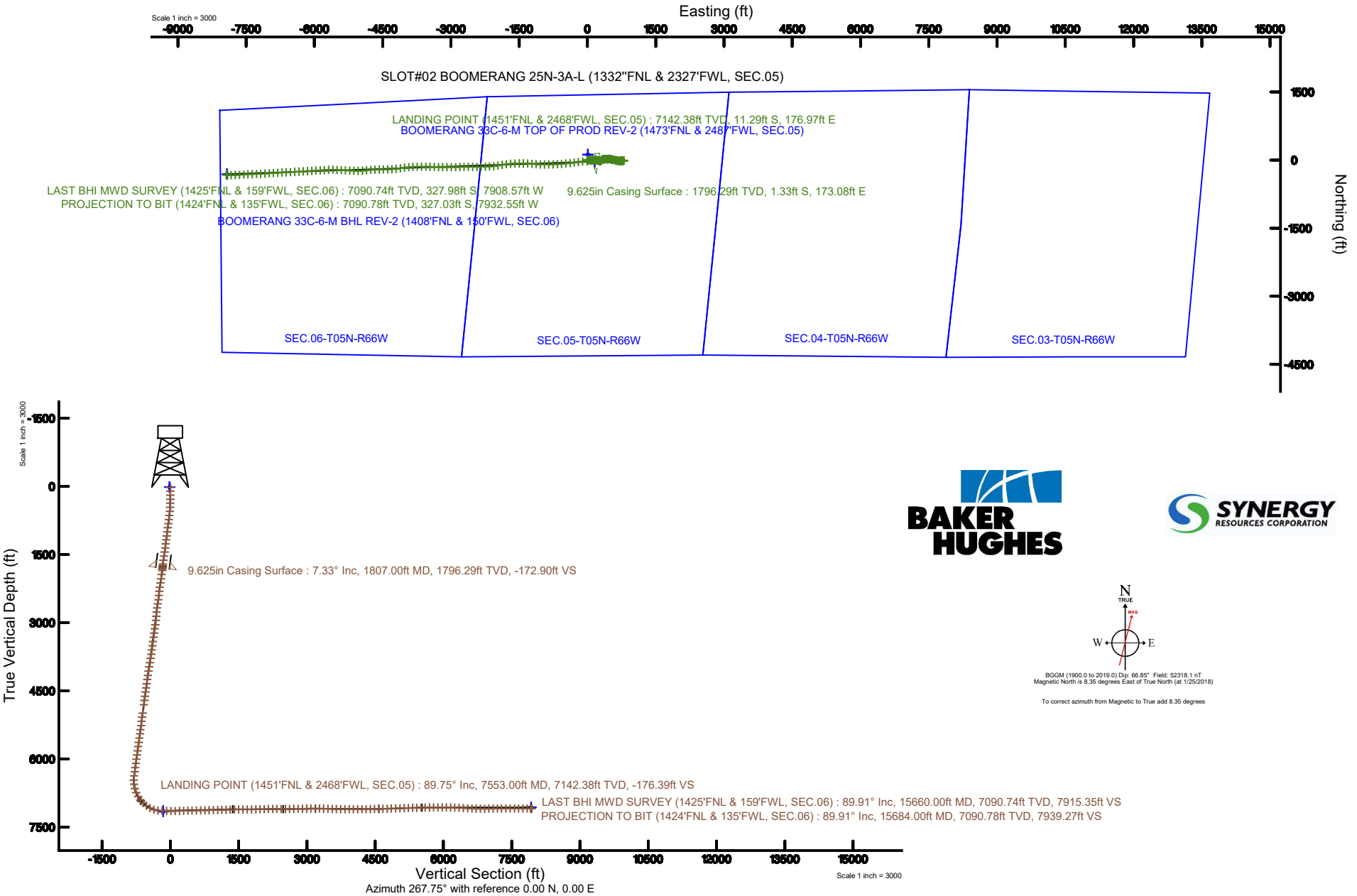



SRC ENERGY

Actual Wellpath Report

BOOMERANG 33C-6-M AWP

Page 1 of 10

**BAKER
HUGHES**

REFERENCE WELLPATH IDENTIFICATION

Operator	SRC ENERGY	Slot	SLOT#09 BOOMERANG 33C-6-M (1436'FNL & 2327'FWL, SEC.05)
Area	COLORADO	Well	BOOMERANG 33C-6-M
Field	WELD COUNTY (NAD83,TRUE NORTH)	Wellbore	BOOMERANG 33C-6-M AWB
Facility	SEC.05-T05N-R66W		

REPORT SETUP INFORMATION

Projection System	NAD83 / Lambert Colorado SP, Northern Zone (501), US feet	Software System	WellArchitect® 5.0
North Reference	True	User	Doddanna
Scale	0.999962	Report Generated	4/13/2018 at 8:31:45 AM
Convergence at slot	0.45° East	Database/Source file	WellArchitectDB/BOOMERANG_33C-6-M_AWP.xml

WELLPATH LOCATION

	Local coordinates		Grid coordinates		Geographic coordinates	
	North[ft]	East[ft]	Easting[US ft]	Northing[US ft]	Latitude	Longitude
Slot Location	-119.52	-11.75	3193865.65	1401419.32	40°25'59.549"N	104°48'12.856"W
Facility Reference Pt			3193876.47	1401538.91	40°26'00.730"N	104°48'12.704"W
Field Reference Pt			3171284.48	1426358.81	40°30'07.643"N	104°53'02.634"W

WELLPATH DATUM

Calculation method	Minimum curvature	PRECISION 462 (20') (RKB) to Facility Vertical Datum	4789.00ft
Horizontal Reference Pt	Slot	PRECISION 462 (20') (RKB) to Mean Sea Level	4789.00ft
Vertical Reference Pt	PRECISION 462 (20') (RKB)	PRECISION 462 (20') (RKB) to Mud Line at Slot (SLOT#09 BOOMERANG 33C-6-M (1436'FNL & 2327'FWL, SEC.05))	4789.00ft
MD Reference Pt	PRECISION 462 (20') (RKB)	Section Origin	N 0.00, E 0.00 ft
Field Vertical Reference	Mean Sea Level	Section Azimuth	267.75°



Actual Wellpath Report

BOOMERANG 33C-6-M AWP

Page 2 of 10



REFERENCE WELLPATH IDENTIFICATION			
Operator	SRC ENERGY	Slot	SLOT#09 BOOMERANG 33C-6-M (1436'FNL & 2327'FWL, SEC.05)
Area	COLORADO	Well	BOOMERANG 33C-6-M
Field	WELD COUNTY (NAD83,TRUE NORTH)	Wellbore	BOOMERANG 33C-6-M AWB
Facility	SEC.05-T05N-R66W		

WELLPATH DATA (172 stations) † = interpolated/extrapolated station								
MD [ft]	Inclination [°]	Azimuth [°]	TVD [ft]	Vert Sect [ft]	North [ft]	East [ft]	DLS [°/100ft]	Comments
0.00†	0.000	148.310	0.00	0.00	0.00	0.00	0.00	
20.00	0.000	148.310	20.00	0.00	0.00	0.00	0.00	
102.00	0.880	148.310	102.00	-0.31	-0.54	0.33	1.07	
192.00	0.620	149.320	191.99	-0.88	-1.54	0.94	0.29	
285.00	0.100	209.790	284.99	-1.08	-2.05	1.16	0.62	
371.00	1.490	88.150	370.98	-2.16	-2.07	2.24	1.80	
461.00	3.400	84.430	460.89	-5.99	-1.78	6.07	2.13	
551.00	5.110	83.340	550.64	-12.65	-1.05	12.70	1.90	
641.00	6.570	89.590	640.17	-21.79	-0.55	21.83	1.77	
731.00	7.250	90.860	729.52	-32.61	-0.60	32.66	0.77	
821.00	7.600	90.470	818.76	-44.23	-0.73	44.29	0.39	
911.00	7.380	89.950	907.99	-55.95	-0.78	56.02	0.26	
1001.00	7.840	93.350	997.20	-67.83	-1.13	67.93	0.71	
1091.00	7.860	93.840	1086.36	-80.06	-1.90	80.20	0.08	
1181.00	7.300	92.970	1175.57	-91.87	-2.61	92.05	0.64	
1271.00	7.060	92.660	1264.87	-103.08	-3.16	103.28	0.27	
1361.00	7.290	91.440	1354.16	-114.29	-3.56	114.52	0.31	
1451.00	7.910	87.350	1443.37	-126.18	-3.42	126.41	0.91	
1541.00	7.930	87.450	1532.51	-138.58	-2.86	138.80	0.03	
1631.00	7.400	87.490	1621.71	-150.58	-2.33	150.79	0.59	
1721.00	7.110	88.480	1710.99	-161.95	-1.93	162.15	0.35	
1754.00	7.390	86.840	1743.72	-166.11	-1.76	166.31	1.06	
1828.00	7.300	85.660	1817.12	-175.57	-1.14	175.75	0.24	
1860.00	7.470	87.460	1848.85	-179.68	-0.89	179.86	0.90	
1952.00	8.270	98.460	1939.99	-192.16	-1.60	192.38	1.85	
2045.00	8.420	102.080	2032.00	-205.33	-4.01	205.65	0.59	
2139.00	8.020	96.380	2125.04	-218.49	-6.18	218.90	0.97	
2233.00	8.210	109.140	2218.11	-231.22	-9.11	231.75	1.92	
2325.00	7.540	119.100	2309.24	-242.49	-14.20	243.24	1.65	
2418.00	8.490	127.110	2401.34	-253.01	-21.31	254.04	1.57	



SRC ENERGY

Actual Wellpath Report

BOOMERANG 33C-6-M AWP

Page 3 of 10

**BAKER
HUGHES****REFERENCE WELLPATH IDENTIFICATION**

Operator	SRC ENERGY	Slot	SLOT#09 BOOMERANG 33C-6-M (1436'FNL & 2327'FWL, SEC.05)
Area	COLORADO	Well	BOOMERANG 33C-6-M
Field	WELD COUNTY (NAD83,TRUE NORTH)	Wellbore	BOOMERANG 33C-6-M AWB
Facility	SEC.05-T05N-R66W		

WELLPATH DATA (172 stations)

MD [ft]	Inclination [°]	Azimuth [°]	TVD [ft]	Vert Sect [ft]	North [ft]	East [ft]	DLS [°/100ft]	Comments
2510.00	8.410	110.620	2492.35	-264.46	-27.78	265.76	2.63	
2602.00	8.980	86.690	2583.32	-277.85	-29.73	279.23	3.95	
2695.00	10.060	58.200	2675.09	-292.18	-25.03	293.38	5.14	
2787.00	9.010	30.540	2765.87	-303.07	-14.58	303.88	5.06	
2881.00	8.230	29.440	2858.80	-310.59	-2.39	310.93	0.85	
2973.00	8.330	45.450	2949.86	-318.98	8.03	318.91	2.50	
3067.00	8.110	66.180	3042.91	-330.19	15.48	329.83	3.14	
3160.00	7.970	77.060	3135.00	-342.62	19.58	342.12	1.64	
3254.00	8.080	80.700	3228.08	-355.58	22.10	354.99	0.55	
3349.00	7.900	84.340	3322.16	-368.73	23.82	368.08	0.57	
3443.00	7.750	86.260	3415.29	-381.51	24.88	380.83	0.32	
3537.00	7.540	93.150	3508.45	-393.99	24.95	393.31	1.00	
3630.00	8.400	97.840	3600.55	-406.75	23.69	406.13	1.16	
3724.00	8.880	91.660	3693.49	-420.75	22.54	420.19	1.11	
3819.00	9.020	85.130	3787.34	-435.50	22.96	434.94	1.08	
3912.00	9.050	82.720	3879.18	-450.07	24.51	449.46	0.41	
4005.00	9.200	82.800	3971.01	-464.76	26.37	464.09	0.16	
4100.00	8.920	92.270	4064.83	-479.67	27.03	478.98	1.60	
4194.00	9.050	104.420	4157.68	-494.02	24.90	493.43	2.02	
4288.00	8.030	104.840	4250.64	-507.38	21.37	506.93	1.09	
4382.00	8.240	111.060	4343.69	-519.84	17.27	519.57	0.96	
4474.00	8.090	102.020	4434.76	-532.17	13.55	532.05	1.40	
4567.00	8.100	96.770	4526.84	-544.99	11.42	544.96	0.79	
4661.00	8.070	96.390	4619.90	-558.05	9.90	558.09	0.07	
4754.00	8.060	108.390	4711.99	-570.60	7.12	570.76	1.81	
4848.00	7.890	107.270	4805.08	-582.85	3.13	583.18	0.25	
5035.00	8.040	101.880	4990.28	-607.63	-3.38	608.23	0.41	
5127.00	7.960	104.530	5081.39	-619.97	-6.30	620.70	0.41	
5219.00	7.920	109.590	5172.50	-631.95	-10.02	632.83	0.76	
5311.00	8.080	108.630	5263.61	-643.88	-14.21	644.93	0.23	



SRC ENERGY

Actual Wellpath Report

BOOMERANG 33C-6-M AWP

Page 4 of 10

**BAKER
HUGHES**

REFERENCE WELLPATH IDENTIFICATION			
Operator	SRC ENERGY	Slot	SLOT#09 BOOMERANG 33C-6-M (1436'FNL & 2327'FWL, SEC.05)
Area	COLORADO	Well	BOOMERANG 33C-6-M
Field	WELD COUNTY (NAD83,TRUE NORTH)	Wellbore	BOOMERANG 33C-6-M AWB
Facility	SEC.05-T05N-R66W		

WELLPATH DATA (172 stations)

MD [ft]	Inclination [°]	Azimuth [°]	TVD [ft]	Vert Sect [ft]	North [ft]	East [ft]	DLS [°/100ft]	Comments
5403.00	8.110	108.070	5354.69	-656.01	-18.29	657.23	0.09	
5497.00	7.870	98.280	5447.78	-668.55	-21.28	669.90	1.47	
5590.00	7.920	90.080	5539.91	-681.21	-22.20	682.61	1.21	
5685.00	7.910	94.670	5634.00	-694.24	-22.74	695.67	0.67	
5779.00	7.900	93.450	5727.11	-707.09	-23.66	708.56	0.18	
5873.00	7.890	89.830	5820.22	-719.97	-24.03	721.46	0.53	
5967.00	7.850	85.600	5913.33	-732.83	-23.52	734.32	0.62	
6059.00	7.940	83.570	6004.46	-745.44	-22.32	746.89	0.32	
6152.00	7.940	84.230	6096.57	-758.26	-20.96	759.67	0.10	
6245.00	7.850	84.200	6188.69	-771.01	-19.67	772.38	0.10	
6338.00	7.890	85.140	6280.81	-783.73	-18.49	785.06	0.14	
6431.00	7.840	83.720	6372.94	-796.43	-17.25	797.72	0.22	
6523.00	2.350	47.800	6464.56	-804.14	-15.30	805.36	6.62	
6617.00	9.610	294.300	6558.13	-798.59	-10.76	799.62	11.45	
6710.00	15.560	281.570	6648.87	-779.51	-5.06	780.31	7.02	
6805.00	21.150	264.790	6739.07	-749.98	-4.06	750.71	8.04	
6899.00	29.560	270.810	6823.95	-709.81	-5.27	710.56	9.35	
6993.00	38.270	273.340	6901.89	-657.58	-3.24	658.21	9.39	
7085.00	46.440	272.690	6969.81	-595.91	-0.01	596.37	8.89	
7179.00	51.750	275.550	7031.35	-525.35	5.16	525.55	6.10	
7273.00	62.180	269.740	7082.56	-446.97	8.55	446.98	12.24	
7365.00	74.060	262.480	7116.82	-361.87	2.55	362.05	14.83	
7458.00	82.340	266.130	7135.83	-271.09	-6.43	271.55	9.70	
7553.00	89.750	267.980	7142.38	-176.39	-11.29	176.97	8.04	LANDING POINT (1451'FNL & 2468'FWL, SEC.05)
7647.00	87.880	266.590	7144.32	-82.42	-15.74	83.10	2.48	
7742.00	89.880	264.310	7146.18	12.47	-23.28	-11.57	3.19	
7836.00	91.200	263.510	7145.29	106.25	-33.25	-105.03	1.64	
7930.00	91.290	262.590	7143.25	199.91	-44.62	-198.32	0.98	
8023.00	91.290	262.680	7141.15	292.52	-56.54	-290.52	0.10	
8115.00	91.320	263.410	7139.06	384.18	-67.68	-381.82	0.79	



SRC ENERGY

Actual Wellpath Report

BOOMERANG 33C-6-M AWP

Page 5 of 10

**BAKER
HUGHES**

REFERENCE WELLPATH IDENTIFICATION			
Operator	SRC ENERGY	Slot	SLOT#09 BOOMERANG 33C-6-M (1436'FNL & 2327'FWL, SEC.05)
Area	COLORADO	Well	BOOMERANG 33C-6-M
Field	WELD COUNTY (NAD83,TRUE NORTH)	Wellbore	BOOMERANG 33C-6-M AWB
Facility	SEC.05-T05N-R66W		

WELLPATH DATA (172 stations)

MD [ft]	Inclination [°]	Azimuth [°]	TVD [ft]	Vert Sect [ft]	North [ft]	East [ft]	DLS [°/100ft]	Comments
8209.00	91.380	264.680	7136.84	477.96	-77.42	-475.29	1.35	
8302.00	91.290	265.820	7134.68	570.84	-85.12	-567.94	1.23	
8396.00	91.170	266.830	7132.66	664.79	-91.15	-661.73	1.08	
8490.00	91.390	268.050	7130.56	758.76	-95.34	-755.61	1.32	
8584.00	91.350	268.620	7128.31	852.73	-98.08	-849.54	0.61	
8677.00	91.360	270.050	7126.11	945.67	-99.15	-942.51	1.54	
8770.00	91.200	271.510	7124.04	1038.51	-97.89	-1035.47	1.58	
8862.00	91.320	274.020	7122.01	1130.13	-93.45	-1127.33	2.73	
8956.00	92.030	275.340	7119.26	1223.40	-85.79	-1220.98	1.59	
9049.00	91.970	273.700	7116.02	1315.70	-78.46	-1313.63	1.76	
9142.00	92.120	271.690	7112.70	1408.29	-74.09	-1406.46	2.17	
9235.00	89.940	268.880	7111.03	1501.17	-73.63	-1499.43	3.82	
9330.00	90.090	267.830	7111.00	1596.16	-76.36	-1594.39	1.12	
9425.00	89.910	265.750	7111.00	1691.14	-81.68	-1689.24	2.20	
9518.00	91.080	263.080	7110.20	1783.97	-90.73	-1781.78	3.13	
9612.00	91.020	260.140	7108.48	1877.40	-104.44	-1874.75	3.13	
9704.00	91.050	258.290	7106.81	1968.36	-121.65	-1965.11	2.01	
9798.00	91.200	264.250	7104.97	2061.70	-135.91	-2057.96	6.34	
9891.00	91.170	267.320	7103.04	2154.62	-142.74	-2150.67	3.30	
9984.00	89.780	266.450	7102.27	2247.60	-147.79	-2243.53	1.76	
10077.00	89.940	268.100	7102.50	2340.59	-152.22	-2336.42	1.78	
10170.00	90.000	270.460	7102.55	2433.55	-153.38	-2429.41	2.54	
10263.00	90.860	271.520	7101.85	2526.40	-151.78	-2522.39	1.47	
10357.00	90.890	270.730	7100.42	2620.23	-149.93	-2616.36	0.84	
10450.00	90.710	268.640	7099.12	2713.16	-150.44	-2709.34	2.26	
10544.00	91.020	266.880	7097.70	2807.14	-154.12	-2803.26	1.90	
10639.00	91.020	269.050	7096.01	2902.12	-157.49	-2898.18	2.28	
10733.00	90.950	270.150	7094.39	2996.06	-158.15	-2992.16	1.17	
10826.00	90.830	270.030	7092.95	3088.97	-158.00	-3085.15	0.18	
10920.00	89.910	270.720	7092.34	3182.87	-157.38	-3179.14	1.22	



SRC ENERGY

Actual Wellpath Report

BOOMERANG 33C-6-M AWP

Page 6 of 10

**BAKER
HUGHES**

REFERENCE WELLPATH IDENTIFICATION			
Operator	SRC ENERGY	Slot	SLOT#09 BOOMERANG 33C-6-M (1436'FNL & 2327'FWL, SEC.05)
Area	COLORADO	Well	BOOMERANG 33C-6-M
Field	WELD COUNTY (NAD83,TRUE NORTH)	Wellbore	BOOMERANG 33C-6-M AWP
Facility	SEC.05-T05N-R66W		

WELLPATH DATA (172 stations)

MD [ft]	Inclination [°]	Azimuth [°]	TVD [ft]	Vert Sect [ft]	North [ft]	East [ft]	DLS [°/100ft]	Comments
11013.00	89.820	272.000	7092.56	3275.68	-155.18	-3272.11	1.38	
11106.00	88.180	272.290	7094.18	3368.39	-151.70	-3365.03	1.79	
11200.00	88.210	271.260	7097.14	3462.11	-148.79	-3458.94	1.10	
11293.00	87.380	270.340	7100.72	3554.91	-147.49	-3551.86	1.33	
11387.00	88.740	269.950	7103.90	3648.77	-147.25	-3645.80	1.51	
11481.00	88.520	269.680	7106.15	3742.68	-147.56	-3739.78	0.37	
11575.00	89.850	267.280	7107.49	3836.66	-150.05	-3833.72	2.92	
11668.00	90.000	264.480	7107.61	3929.60	-156.73	-3926.47	3.02	
11761.00	90.000	261.740	7107.61	4022.29	-167.88	-4018.79	2.95	
11855.00	90.060	260.930	7107.56	4115.70	-182.05	-4111.72	0.86	
11948.00	89.910	263.930	7107.58	4208.28	-194.30	-4203.90	3.23	
12041.00	91.320	267.210	7106.58	4301.20	-201.48	-4296.60	3.84	
12133.00	91.320	268.800	7104.47	4393.17	-204.68	-4388.52	1.73	
12227.00	91.320	268.480	7102.30	4487.13	-206.91	-4482.47	0.34	
12319.00	91.420	269.330	7100.10	4579.09	-208.67	-4574.42	0.93	
12411.00	91.480	268.500	7097.77	4671.04	-210.41	-4666.38	0.90	
12504.00	91.420	265.260	7095.42	4763.98	-215.47	-4759.20	3.48	
12597.00	91.910	263.810	7092.72	4856.79	-224.32	-4851.73	1.65	
12691.00	91.820	264.020	7089.66	4950.53	-234.28	-4945.15	0.24	
12784.00	91.750	269.250	7086.76	5043.44	-239.74	-5037.91	5.62	
12878.00	91.880	272.220	7083.78	5137.25	-238.53	-5131.85	3.16	
12971.00	91.750	274.300	7080.83	5229.77	-233.25	-5224.65	2.24	
13064.00	91.790	273.750	7077.96	5322.17	-226.72	-5317.37	0.59	
13157.00	91.760	273.360	7075.08	5414.65	-220.96	-5410.15	0.42	
13250.00	91.940	272.680	7072.08	5507.21	-216.06	-5502.97	0.76	
13342.00	90.710	271.070	7069.95	5598.94	-213.05	-5594.89	2.20	
13435.00	90.460	267.080	7069.00	5691.89	-214.55	-5687.86	4.30	
13529.00	90.990	265.890	7067.81	5785.86	-220.31	-5781.67	1.39	
13621.00	91.110	266.580	7066.13	5877.81	-226.35	-5873.45	0.76	
13714.00	90.060	265.620	7065.18	5970.77	-232.68	-5966.23	1.53	



Actual Wellpath Report

BOOMERANG 33C-6-M AWP

Page 7 of 10



REFERENCE WELLPATH IDENTIFICATION			
Operator	SRC ENERGY	Slot	SLOT#09 BOOMERANG 33C-6-M (1436'FNL & 2327'FWL, SEC.05)
Area	COLORADO	Well	BOOMERANG 33C-6-M
Field	WELD COUNTY (NAD83,TRUE NORTH)	Wellbore	BOOMERANG 33C-6-M AWB
Facility	SEC.05-T05N-R66W		

WELLPATH DATA (172 stations)								
MD [ft]	Inclination [°]	Azimuth [°]	TVD [ft]	Vert Sect [ft]	North [ft]	East [ft]	DLS [°/100ft]	Comments
13806.00	89.080	266.260	7065.87	6062.72	-239.19	-6058.00	1.27	
13900.00	88.980	266.950	7067.46	6156.68	-244.76	-6151.82	0.74	
13993.00	87.140	266.960	7070.61	6249.62	-249.70	-6244.63	1.98	
14086.00	86.830	267.200	7075.50	6342.48	-254.43	-6337.38	0.42	
14179.00	87.010	266.430	7080.49	6435.34	-259.59	-6430.10	0.85	
14274.00	86.890	266.220	7085.55	6530.17	-265.67	-6524.77	0.25	
14369.00	86.740	267.780	7090.83	6625.01	-270.63	-6619.49	1.65	
14461.00	89.290	267.430	7094.01	6716.95	-274.47	-6711.35	2.80	
14556.00	89.450	265.840	7095.06	6811.92	-280.05	-6806.18	1.68	
14649.00	90.860	266.340	7094.81	6904.88	-286.39	-6898.96	1.61	
14742.00	89.880	266.270	7094.21	6997.85	-292.38	-6991.76	1.06	
14835.00	91.320	265.170	7093.23	7090.78	-299.32	-7084.49	1.95	
14929.00	90.090	267.060	7092.08	7184.73	-305.69	-7178.26	2.40	
15021.00	90.000	269.350	7092.00	7276.72	-308.57	-7270.21	2.49	
15115.00	90.680	269.250	7091.45	7370.68	-309.72	-7364.20	0.73	
15209.00	90.090	265.640	7090.81	7464.66	-313.91	-7458.09	3.89	
15303.00	90.030	266.110	7090.72	7558.61	-320.67	-7551.85	0.50	
15396.00	90.000	267.090	7090.69	7651.59	-326.19	-7644.68	1.05	
15490.00	90.060	268.500	7090.64	7745.59	-329.80	-7738.61	1.50	
15583.00	89.940	271.010	7090.64	7838.53	-330.20	-7831.60	2.70	
15660.00	89.910	272.290	7090.74	7915.35	-327.98	-7908.57	1.66	LAST BHI MWD SURVEY (1425'FNL & 159'FWL, SEC.06)
15684.00	89.910	272.290	7090.78	7939.27	-327.03	-7932.55	0.00	PROJECTION TO BIT (1424'FNL & 135'FWL, SEC.06)



Actual Wellpath Report

BOOMERANG 33C-6-M AWP

Page 8 of 10



REFERENCE WELLPATH IDENTIFICATION			
Operator	SRC ENERGY	Slot	SLOT#09 BOOMERANG 33C-6-M (1436'FNL & 2327'FWL, SEC.05)
Area	COLORADO	Well	BOOMERANG 33C-6-M
Field	WELD COUNTY (NAD83,TRUE NORTH)	Wellbore	BOOMERANG 33C-6-M AWP
Facility	SEC.05-T05N-R66W		

HOLE & CASING SECTIONS									
- Ref Wellbore: BOOMERANG 33C-6-M AWP					Ref Wellpath: BOOMERANG 33C-6-M AWP				
String/Diameter	Start MD [ft]	End MD [ft]	Interval [ft]	Start TVD [ft]	End TVD [ft]	Start N/S [ft]	Start E/W [ft]	End N/S [ft]	End E/W [ft]
13.5in Open Hole	20.00	1807.00	1787.00	20.00	1796.29	0.00	0.00	-1.33	173.08
9.625in Casing Surface	20.00	1807.00	1787.00	20.00	1796.29	0.00	0.00	-1.33	173.08
8.5in Open Hole	1807.00	15684.00	13877.00	1796.29	7090.78	-1.33	173.08	-327.03	-7932.55

TARGETS								
Name	TVD [ft]	North [ft]	East [ft]	Grid East [US ft]	Grid North [US ft]	Latitude	Longitude	Shape
SEC.03-T05N-R66W	15.00	119.52	11.75	3193876.47	1401538.91	40°26'00.730"N	104°48'12.704"W	polygon
SEC.04-T05N-R66W	15.00	119.52	11.75	3193876.47	1401538.91	40°26'00.730"N	104°48'12.704"W	polygon
SEC.05-T05N-R66W	15.00	119.52	11.75	3193876.47	1401538.91	40°26'00.730"N	104°48'12.704"W	polygon
SEC.06-T05N-R66W	15.00	119.52	11.75	3193876.47	1401538.91	40°26'00.730"N	104°48'12.704"W	polygon
BOOMERANG 33C-6-M BHL REV-2 (1408'FNL & 150'FWL, SEC.06)	7063.09	-310.62	-7917.60	3185951.05	1401046.53	40°25'56.467"N	104°49'55.243"W	circle
BOOMERANG 33C-6-M BHL ON PLAT (1408'FNL & 150'FWL, SEC.06)	7065.00	-310.62	-7917.60	3185951.05	1401046.53	40°25'56.467"N	104°49'55.243"W	point
BOOMERANG 33C-6-M TOP OF PROD REV-2 (1473'FNL & 2487'FWL, SEC.05)	7140.47	-33.50	158.14	3194024.04	1401387.06	40°25'59.218"N	104°48'10.811"W	circle
BOOMERAND 33C-6-M TOP OF PROD ON PLAT (1473'FNL & 2487'FWL, SEC.05)	7159.00	-33.50	158.14	3194024.04	1401387.06	40°25'59.218"N	104°48'10.811"W	point



Actual Wellpath Report

BOOMERANG 33C-6-M AWP

Page 9 of 10



REFERENCE WELLPATH IDENTIFICATION			
Operator	SRC ENERGY	Slot	SLOT#09 BOOMERANG 33C-6-M (1436'FNL & 2327'FWL, SEC.05)
Area	COLORADO	Well	BOOMERANG 33C-6-M
Field	WELD COUNTY (NAD83,TRUE NORTH)	Wellbore	BOOMERANG 33C-6-M AWB
Facility	SEC.05-T05N-R66W		

WELLPATH COMPOSITION - Ref Wellbore: BOOMERANG 33C-6-M AWB Ref Wellpath: BOOMERANG 33C-6-M AWP				
Start MD [ft]	End MD [ft]	Positional Uncertainty Model	Log Name/Comment	Wellbore
20.00	1754.00	BHI NaviTrak (Standard)	13 1/2" SURFACE SERCTION <86-1738>	BOOMERANG 33C-6-M AWB
1754.00	15660.00	BHI AutoTrak Curve (IFR1, Short)	8 1/2" BHI MONOBORE SURVEYS <1828'-15660'>	BOOMERANG 33C-6-M AWB
15660.00	15684.00	Blind Drilling (std)	Projection to bit	BOOMERANG 33C-6-M AWB



Actual Wellpath Report

BOOMERANG 33C-6-M AWP

Page 10 of 10



REFERENCE WELLPATH IDENTIFICATION			
Operator	SRC ENERGY	Slot	SLOT#09 BOOMERANG 33C-6-M (1436'FNL & 2327'FWL, SEC.05)
Area	COLORADO	Well	BOOMERANG 33C-6-M
Field	WELD COUNTY (NAD83,TRUE NORTH)	Wellbore	BOOMERANG 33C-6-M AWP
Facility	SEC.05-T05N-R66W		

WELLPATH COMMENTS				
MD [ft]	Inclination [°]	Azimuth [°]	TVD [ft]	Comment
7553.00	89.750	267.980	7142.38	LANDING POINT (1451'FNL & 2468'FWL, SEC.05)
15660.00	89.910	272.290	7090.74	LAST BHI MWD SURVEY (1425'FNL & 159'FWL, SEC.06)
15684.00	89.910	272.290	7090.78	PROJECTION TO BIT (1424'FNL & 135'FWL, SEC.06)