

Location:	COLORADO	Slot:	SLOT#04 STATE ANTELOPE T44-2-14XRLNB (330°FNL & 778°FEL, SEC.11)
Field:	WELD COUNTY	Well:	STATE ANTELOPE T44-2-14XRLNB
Facility:	SEC.11-T5N-R62W	Wellbore:	STATE ANTELOPE T44-2-14XRLNB PWB
Plot reference wellpath is STATE ANTELOPE T44-2-14XRLNB PWP (REV-A.0)		Grid System: NAD83 / Lambert Colorado SP, Northern Zone (501), US feet	
True vertical depths are referenced to RIG (17KB) (RKB)		North Reference: True north	
Measured depths are referenced to RIG (17KB) (RKB)		Scale: True distance	
RIG (17KB) (RKB) to Mean Sea Level: 4653 feet		Depths are in feet	
Mean Sea Level to Mud line (At Slot: SLOT#04 STATE ANTELOPE T44-2-14XRLNB (330FNL & 778FEL, SEC.11): 0 feet		Created by: bushjash on 2017-12-01	
Coordinates are in feet referenced to Slot		Database: Denver	

Location Information						
Facility Name			Grid East (US ft)	Grid North (US ft)	Latitude	Longitude
SEC.11-TSN-R62W			3338697.261	1398848.454	40°25'18.709"N	104°11'700.609"W
Slot	Local N (ft)	Local E (ft)	Grid East (US ft)	Grid North (US ft)	Latitude	Longitude
SLOT#04 STATE ANTELOPE T44-2-14XRLNB (330FNL & 778FEL, SEC.11)	-59.91	2.86	3338690.944	1398788.592	40°25'18.117"N	104°11'700.572"W
RIG (17Kb) (R0Kb) to Mud line (A Slot: SLOT#04 STATE ANTELOPE T44-2-14XRLNB (330FNL & 778FEL, SEC.11))					4653R	
Mean Sea Level to Mud line (A Slot: SLOT#04 STATE ANTELOPE T44-2-14XRLNB (330FNL & 778FEL, SEC.11))					0R	
RIG (17Kb) (R0Kb) to Mean Sea Level					4653R	

Well Profile Data								
Design Comment	MD (ft)	Inc (°)	Az (°)	TVD (ft)	Local N (ft)	Local E (ft)	DLS (°/100ft)	VS (ft)
Tie On	17.00	0.000	347.844	17.00	0.00	0.00	0.00	0.00
End of Tangent	800.00	0.000	347.844	800.00	0.00	0.00	0.00	0.00
End of Build (XS)	1605.36	16.107	347.844	1594.79	109.94	-23.68	2.00	-109.19
End of Tangent (XS)	5613.88	16.107	347.844	5445.96	1197.10	-257.87	0.00	-1188.99
End of 3D Arc (XS)	6671.27	90.000	179.959	6173.00	645.60	-301.53	10.00	-636.43
End of Tangent (XS)	17288.18	90.000	179.959	6173.00	-9971.31	-293.90	0.00	9975.64

Hole and Casing Sections										
Name	Start MD (ft)	End MD (ft)	Interval (ft)	Start TVD (ft)	End TVD (ft)	Start Local N (ft)	Start Local E (ft)	End Local N (ft)	End Local E (ft)	Wellbore
9.625in Casing Surface	17.00	1550.00	1533.00	17.00	1541.46	0.00	0.00	95.43	-20.56	STATE ANTELOPE T44-2-14XRLNB PWB
8.5in Open Hole	1550.00	17288.18	15738.18	1541.46	N/A	95.43	-20.56	N/A	N/A	STATE ANTELOPE T44-2-14XRLNB PWB

Survey Program					
Start MD (ft)	End MD (ft)	Tool	Model	Log Name/Comment	Wellbore
17.00	1550.00	BHI NavTrak	BHI NavTrak (Standard)		STATE ANTELOPE T44-2-14XRLNB PWB
1550.00	17288.18	BHI AutoTrak Curve	BHI AutoTrak Curve (Standard)		STATE ANTELOPE T44-2-14XRLNB PWB

Bottom Hole Location									
MD (ft)	Inc (°)	Az (°)	TVD (ft)	Local N (ft)	Local E (ft)	Grid East (US ft)	Grid North (US ft)	Latitude	Longitude
17288.18	90.000	179.959	6173.00	-9971.31	-293.90	338533.87	1388814.60	40°23'39.584"N	104°17'04.370"W

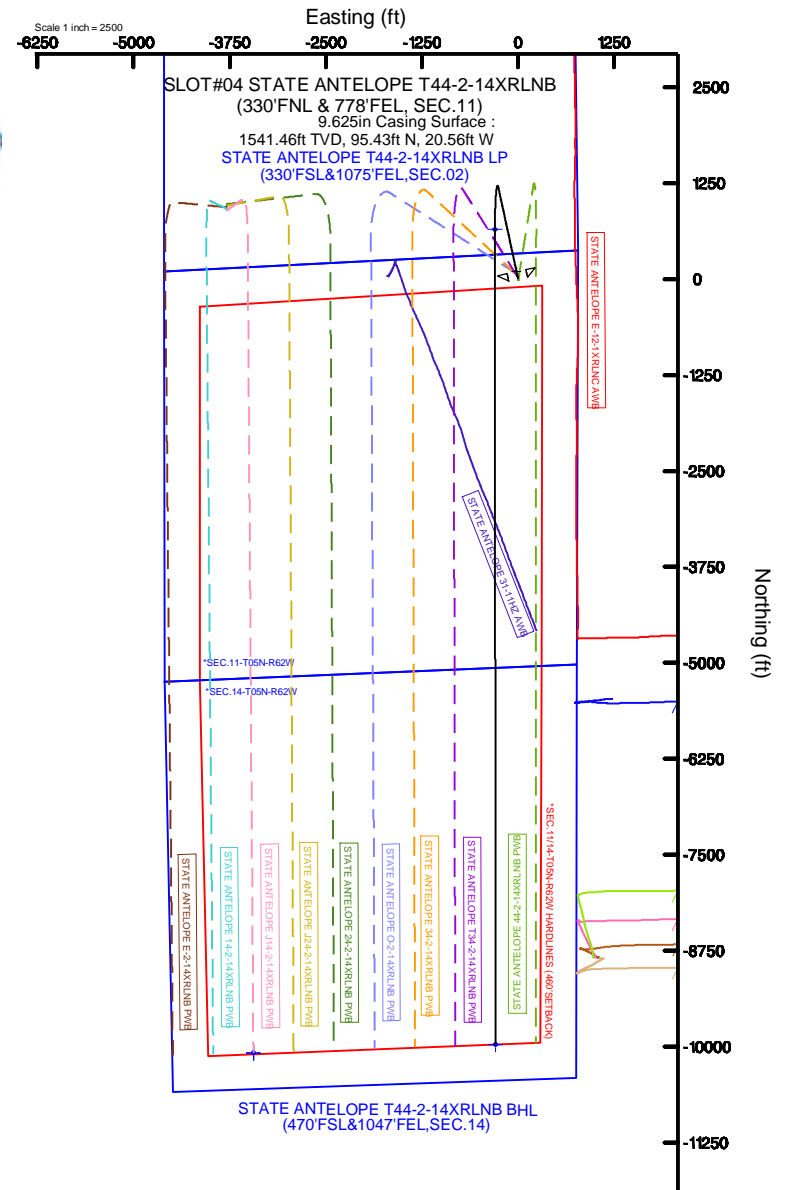
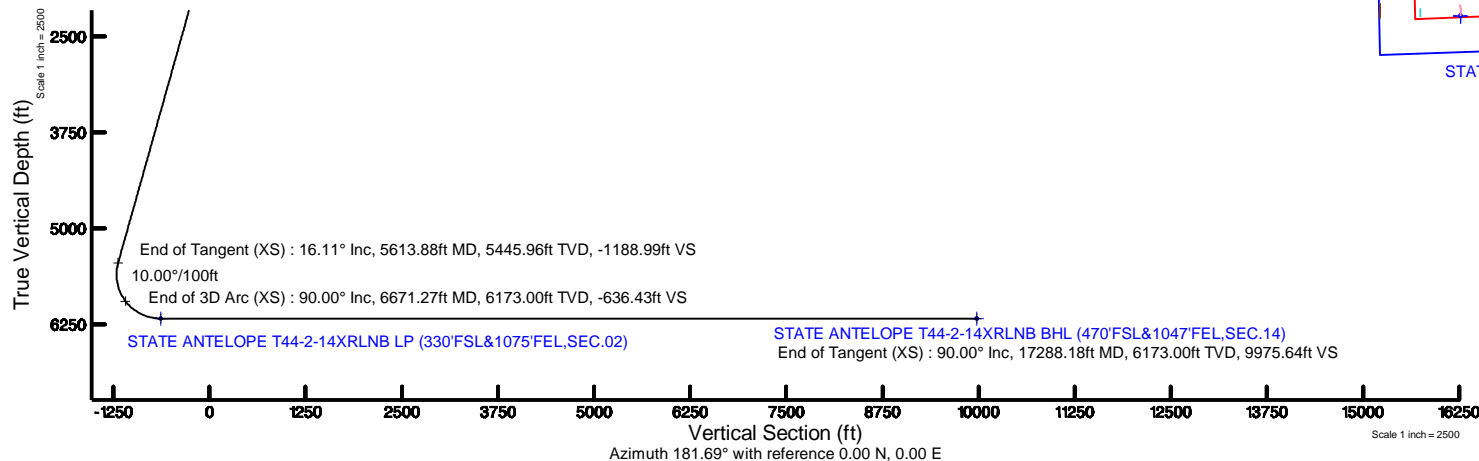

BGGM (1900.0 to 2019.0) Dip: 67.07° Field: 52889.8 nT  
Magnetic North is 8.44 degrees East of True North (at 1/29/2014)

To correct azimuth from Magnetic to True add 8.44 degrees



# Planned Wellpath Report

STATE ANTELOPE T44-2-14XRLNB PWP (REV-A.0)  
Page 1 of 8



## REFERENCE WELLPATH IDENTIFICATION

Operator	BONANZA CREEK OIL COMPANY	Slot	SLOT#04 STATE ANTELOPE T44-2-14XRLNB (330'FNL & 778'FEL, SEC.11)
Area	COLORADO	Well	STATE ANTELOPE T44-2-14XRLNB
Field	WELD COUNTY	Wellbore	STATE ANTELOPE T44-2-14XRLNB PWB
Facility	SEC.11-T5N-R62W		

## REPORT SETUP INFORMATION

Projection System	NAD83 / Lambert Colorado SP, Northern Zone (501), US feet	Software System	WellArchitect® 5.0
North Reference	True	User	Ingmjmr
Scale	0.999961	Report Generated	12/1/2017 at 11:02:06 AM
Convergence at slot	0.79° East	Database/Source file	Denver/STATE_ANTELOPE_T44-2-14XRLNB_PWP__REV-A.0_.xml

## WELLPATH LOCATION

	Local coordinates		Grid coordinates		Geographic coordinates	
	North[ft]	East[ft]	Easting[US ft]	Northing[US ft]	Latitude	Longitude
Slot Location	-59.91	2.86	3338690.94	1398788.59	40°25'18.117"N	104°17'00.572"W
Facility Reference Pt			3338687.26	1398848.45	40°25'18.709"N	104°17'00.609"W
Field Reference Pt			3224525.77	1254425.87	40°01'44.400"N	104°41'53.556"W

## WELLPATH DATUM

Calculation method	Minimum curvature	RIG (17'KB) (RKB) to Facility Vertical Datum	4653.00ft
Horizontal Reference Pt	Slot	RIG (17'KB) (RKB) to Mean Sea Level	4653.00ft
Vertical Reference Pt	RIG (17'KB) (RKB)	RIG (17'KB) (RKB) to Mud Line at Slot (SLOT#04 STATE ANTELOPE T44-2-14XRLNB (330'FNL & 778'FEL, SEC.11))	4653.00ft
MD Reference Pt	RIG (17'KB) (RKB)	Section Origin	N 0.00, E 0.00 ft
Field Vertical Reference	Mean Sea Level	Section Azimuth	181.69°



# Planned Wellpath Report

STATE ANTELOPE T44-2-14XRLNB PWP (REV-A.0)

Page 2 of 8



REFERENCE WELLPATH IDENTIFICATION			
Operator	BONANZA CREEK OIL COMPANY	Slot	SLOT#04 STATE ANTELOPE T44-2-14XRLNB (330'FNL & 778'FEL, SEC.11)
Area	COLORADO	Well	STATE ANTELOPE T44-2-14XRLNB
Field	WELD COUNTY	Wellbore	STATE ANTELOPE T44-2-14XRLNB PWB
Facility	SEC.11-T5N-R62W		

WELLPATH DATA (179 stations) † = interpolated/extrapolated station										
MD [ft]	Inclination [°]	Azimuth [°]	TVD [ft]	Vert Sect [ft]	North [ft]	East [ft]	Latitude	Longitude	DLS [°/100ft]	Comments
0.00†	0.000	347.844	0.00	0.00	0.00	0.00	40°25'18.117"N	104°17'00.572"W	0.00	
17.00	0.000	347.844	17.00	0.00	0.00	0.00	40°25'18.117"N	104°17'00.572"W	0.00	Tie On
117.00†	0.000	347.844	117.00	0.00	0.00	0.00	40°25'18.117"N	104°17'00.572"W	0.00	
217.00†	0.000	347.844	217.00	0.00	0.00	0.00	40°25'18.117"N	104°17'00.572"W	0.00	
317.00†	0.000	347.844	317.00	0.00	0.00	0.00	40°25'18.117"N	104°17'00.572"W	0.00	
417.00†	0.000	347.844	417.00	0.00	0.00	0.00	40°25'18.117"N	104°17'00.572"W	0.00	
517.00†	0.000	347.844	517.00	0.00	0.00	0.00	40°25'18.117"N	104°17'00.572"W	0.00	
617.00†	0.000	347.844	617.00	0.00	0.00	0.00	40°25'18.117"N	104°17'00.572"W	0.00	
717.00†	0.000	347.844	717.00	0.00	0.00	0.00	40°25'18.117"N	104°17'00.572"W	0.00	
800.00	0.000	347.844	800.00	0.00	0.00	0.00	40°25'18.117"N	104°17'00.572"W	0.00	End of Tangent
817.00†	0.340	347.844	817.00	-0.05	0.05	-0.01	40°25'18.117"N	104°17'00.572"W	2.00	
917.00†	2.340	347.844	916.97	-2.32	2.34	-0.50	40°25'18.140"N	104°17'00.579"W	2.00	
1017.00†	4.340	347.844	1016.79	-7.98	8.03	-1.73	40°25'18.196"N	104°17'00.594"W	2.00	
1117.00†	6.340	347.844	1116.35	-17.01	17.13	-3.69	40°25'18.286"N	104°17'00.620"W	2.00	
1217.00†	8.340	347.844	1215.53	-29.42	29.62	-6.38	40°25'18.410"N	104°17'00.654"W	2.00	
1317.00†	10.340	347.844	1314.20	-45.17	45.48	-9.80	40°25'18.566"N	104°17'00.699"W	2.00	
1417.00†	12.340	347.844	1412.24	-64.26	64.70	-13.94	40°25'18.756"N	104°17'00.752"W	2.00	
1517.00†	14.340	347.844	1509.54	-86.66	87.26	-18.80	40°25'18.979"N	104°17'00.815"W	2.00	
1605.36	16.107	347.844	1594.79	-109.19	109.94	-23.68	40°25'19.203"N	104°17'00.878"W	2.00	End of Build (XS)
1617.00†	16.107	347.844	1605.98	-112.33	113.09	-24.36	40°25'19.235"N	104°17'00.887"W	0.00	
1717.00†	16.107	347.844	1702.05	-139.27	140.22	-30.20	40°25'19.503"N	104°17'00.963"W	0.00	
1817.00†	16.107	347.844	1798.13	-166.20	167.34	-36.05	40°25'19.771"N	104°17'01.038"W	0.00	
1917.00†	16.107	347.844	1894.20	-193.14	194.46	-41.89	40°25'20.039"N	104°17'01.114"W	0.00	
2017.00†	16.107	347.844	1990.27	-220.08	221.58	-47.73	40°25'20.307"N	104°17'01.189"W	0.00	
2117.00†	16.107	347.844	2086.35	-247.02	248.70	-53.57	40°25'20.575"N	104°17'01.265"W	0.00	
2217.00†	16.107	347.844	2182.42	-273.95	275.82	-59.41	40°25'20.843"N	104°17'01.340"W	0.00	
2317.00†	16.107	347.844	2278.50	-300.89	302.94	-65.26	40°25'21.111"N	104°17'01.416"W	0.00	
2417.00†	16.107	347.844	2374.57	-327.83	330.07	-71.10	40°25'21.379"N	104°17'01.491"W	0.00	
2517.00†	16.107	347.844	2470.65	-354.76	357.19	-76.94	40°25'21.647"N	104°17'01.567"W	0.00	
2617.00†	16.107	347.844	2566.72	-381.70	384.31	-82.78	40°25'21.915"N	104°17'01.642"W	0.00	



# Planned Wellpath Report

STATE ANTELOPE T44-2-14XRLNB PWP (REV-A.0)

Page 3 of 8



REFERENCE WELLPATH IDENTIFICATION			
Operator	BONANZA CREEK OIL COMPANY	Slot	SLOT#04 STATE ANTELOPE T44-2-14XRLNB (330'FNL & 778'FEL, SEC.11)
Area	COLORADO	Well	STATE ANTELOPE T44-2-14XRLNB
Field	WELD COUNTY	Wellbore	STATE ANTELOPE T44-2-14XRLNB PWB
Facility	SEC.11-T5N-R62W		

WELLPATH DATA (179 stations) † = interpolated/extrapolated station										
MD [ft]	Inclination [°]	Azimuth [°]	TVD [ft]	Vert Sect [ft]	North [ft]	East [ft]	Latitude	Longitude	DLS [°/100ft]	Comments
2717.00†	16.107	347.844	2662.80	-408.64	411.43	-88.63	40°25'22.183"N	104°17'01.718"W	0.00	
2817.00†	16.107	347.844	2758.87	-435.58	438.55	-94.47	40°25'22.451"N	104°17'01.793"W	0.00	
2917.00†	16.107	347.844	2854.94	-462.51	465.67	-100.31	40°25'22.719"N	104°17'01.869"W	0.00	
3017.00†	16.107	347.844	2951.02	-489.45	492.79	-106.15	40°25'22.987"N	104°17'01.945"W	0.00	
3117.00†	16.107	347.844	3047.09	-516.39	519.92	-111.99	40°25'23.255"N	104°17'02.020"W	0.00	
3217.00†	16.107	347.844	3143.17	-543.33	547.04	-117.84	40°25'23.523"N	104°17'02.096"W	0.00	
3317.00†	16.107	347.844	3239.24	-570.26	574.16	-123.68	40°25'23.791"N	104°17'02.171"W	0.00	
3417.00†	16.107	347.844	3335.32	-597.20	601.28	-129.52	40°25'24.059"N	104°17'02.247"W	0.00	
3517.00†	16.107	347.844	3431.39	-624.14	628.40	-135.36	40°25'24.327"N	104°17'02.322"W	0.00	
3617.00†	16.107	347.844	3527.47	-651.08	655.52	-141.20	40°25'24.595"N	104°17'02.398"W	0.00	
3717.00†	16.107	347.844	3623.54	-678.01	682.64	-147.05	40°25'24.863"N	104°17'02.473"W	0.00	
3817.00†	16.107	347.844	3719.61	-704.95	709.76	-152.89	40°25'25.131"N	104°17'02.549"W	0.00	
3917.00†	16.107	347.844	3815.69	-731.89	736.89	-158.73	40°25'25.399"N	104°17'02.624"W	0.00	
4017.00†	16.107	347.844	3911.76	-758.83	764.01	-164.57	40°25'25.667"N	104°17'02.700"W	0.00	
4117.00†	16.107	347.844	4007.84	-785.76	791.13	-170.42	40°25'25.935"N	104°17'02.775"W	0.00	
4217.00†	16.107	347.844	4103.91	-812.70	818.25	-176.26	40°25'26.203"N	104°17'02.851"W	0.00	
4317.00†	16.107	347.844	4199.99	-839.64	845.37	-182.10	40°25'26.471"N	104°17'02.927"W	0.00	
4417.00†	16.107	347.844	4296.06	-866.58	872.49	-187.94	40°25'26.739"N	104°17'03.002"W	0.00	
4517.00†	16.107	347.844	4392.14	-893.51	899.61	-193.78	40°25'27.007"N	104°17'03.078"W	0.00	
4617.00†	16.107	347.844	4488.21	-920.45	926.74	-199.63	40°25'27.275"N	104°17'03.153"W	0.00	
4717.00†	16.107	347.844	4584.28	-947.39	953.86	-205.47	40°25'27.543"N	104°17'03.229"W	0.00	
4817.00†	16.107	347.844	4680.36	-974.33	980.98	-211.31	40°25'27.811"N	104°17'03.304"W	0.00	
4917.00†	16.107	347.844	4776.43	-1001.26	1008.10	-217.15	40°25'28.079"N	104°17'03.380"W	0.00	
5017.00†	16.107	347.844	4872.51	-1028.20	1035.22	-223.00	40°25'28.347"N	104°17'03.455"W	0.00	
5117.00†	16.107	347.844	4968.58	-1055.14	1062.34	-228.84	40°25'28.615"N	104°17'03.531"W	0.00	
5217.00†	16.107	347.844	5064.66	-1082.08	1089.46	-234.68	40°25'28.883"N	104°17'03.606"W	0.00	
5317.00†	16.107	347.844	5160.73	-1109.01	1116.59	-240.52	40°25'29.151"N	104°17'03.682"W	0.00	
5417.00†	16.107	347.844	5256.81	-1135.95	1143.71	-246.36	40°25'29.419"N	104°17'03.758"W	0.00	
5517.00†	16.107	347.844	5352.88	-1162.89	1170.83	-252.21	40°25'29.687"N	104°17'03.833"W	0.00	
5613.88	16.107	347.844	5445.96	-1188.99	1197.10	-257.87	40°25'29.946"N	104°17'03.906"W	0.00	End of Tangent (XS)



# Planned Wellpath Report

STATE ANTELOPE T44-2-14XRLNB PWP (REV-A.0)

Page 4 of 8



REFERENCE WELLPATH IDENTIFICATION			
Operator	BONANZA CREEK OIL COMPANY	Slot	SLOT#04 STATE ANTELOPE T44-2-14XRLNB (330'FNL & 778'FEL, SEC.11)
Area	COLORADO	Well	STATE ANTELOPE T44-2-14XRLNB
Field	WELD COUNTY	Wellbore	STATE ANTELOPE T44-2-14XRLNB PWB
Facility	SEC.11-T5N-R62W		

WELLPATH DATA (179 stations) † = interpolated/extrapolated station										
MD [ft]	Inclination [°]	Azimuth [°]	TVD [ft]	Vert Sect [ft]	North [ft]	East [ft]	Latitude	Longitude	DLS [°/100ft]	Comments
5617.00†	15.803	347.594	5448.96	-1189.82	1197.94	-258.05	40°25'29.955"N	104°17'03.909"W	10.00	
5717.00†	6.438	327.472	5547.00	-1207.71	1216.01	-264.00	40°25'30.133"N	104°17'03.986"W	10.00	
5817.00†	5.737	217.061	5646.69	-1208.27	1216.75	-270.05	40°25'30.140"N	104°17'04.064"W	10.00	
5917.00†	14.971	193.058	5744.99	-1191.49	1200.14	-275.99	40°25'29.976"N	104°17'04.141"W	10.00	
6017.00†	24.801	187.495	5838.92	-1157.87	1166.68	-281.66	40°25'29.646"N	104°17'04.214"W	10.00	
6117.00†	34.725	184.975	5925.62	-1108.45	1117.38	-286.88	40°25'29.159"N	104°17'04.281"W	10.00	
6217.00†	44.679	183.473	6002.47	-1044.71	1053.75	-291.49	40°25'28.530"N	104°17'04.341"W	10.00	
6317.00†	54.648	182.423	6067.11	-968.60	977.72	-295.35	40°25'27.778"N	104°17'04.391"W	10.00	
6417.00†	64.623	181.606	6117.60	-882.43	891.60	-298.35	40°25'26.927"N	104°17'04.430"W	10.00	
6517.00†	74.602	180.915	6152.39	-788.81	798.01	-300.39	40°25'26.003"N	104°17'04.456"W	10.00	
6617.00†	84.583	180.288	6170.44	-690.60	699.79	-301.42	40°25'25.032"N	104°17'04.469"W	10.00	
6671.27	90.000	179.959	6173.00†	-636.43	645.60	-301.53	40°25'24.496"N	104°17'04.471"W	10.00	End of 3D Arc (XS)
6717.00†	90.000	179.959	6173.00	-590.72	599.87	-301.50	40°25'24.045"N	104°17'04.470"W	0.00	
6817.00†	90.000	179.959	6173.00	-490.77	499.87	-301.43	40°25'23.056"N	104°17'04.469"W	0.00	
6917.00†	90.000	179.959	6173.00	-390.81	399.87	-301.36	40°25'22.068"N	104°17'04.468"W	0.00	
7017.00†	90.000	179.959	6173.00	-290.86	299.87	-301.28	40°25'21.080"N	104°17'04.468"W	0.00	
7117.00†	90.000	179.959	6173.00	-190.91	199.87	-301.21	40°25'20.092"N	104°17'04.467"W	0.00	
7217.00†	90.000	179.959	6173.00	-90.95	99.87	-301.14	40°25'19.104"N	104°17'04.466"W	0.00	
7317.00†	90.000	179.959	6173.00	9.00	-0.13	-301.07	40°25'18.116"N	104°17'04.465"W	0.00	
7417.00†	90.000	179.959	6173.00	108.96	-100.13	-301.00	40°25'17.128"N	104°17'04.464"W	0.00	
7517.00†	90.000	179.959	6173.00	208.91	-200.13	-300.92	40°25'16.139"N	104°17'04.463"W	0.00	
7617.00†	90.000	179.959	6173.00	308.87	-300.13	-300.85	40°25'15.151"N	104°17'04.462"W	0.00	
7717.00†	90.000	179.959	6173.00	408.82	-400.13	-300.78	40°25'14.163"N	104°17'04.461"W	0.00	
7817.00†	90.000	179.959	6173.00	508.78	-500.13	-300.71	40°25'13.175"N	104°17'04.460"W	0.00	
7917.00†	90.000	179.959	6173.00	608.73	-600.13	-300.64	40°25'12.187"N	104°17'04.459"W	0.00	
8017.00†	90.000	179.959	6173.00	708.68	-700.13	-300.57	40°25'11.199"N	104°17'04.458"W	0.00	
8117.00†	90.000	179.959	6173.00	808.64	-800.13	-300.49	40°25'10.210"N	104°17'04.457"W	0.00	
8217.00†	90.000	179.959	6173.00	908.59	-900.13	-300.42	40°25'09.222"N	104°17'04.456"W	0.00	
8317.00†	90.000	179.959	6173.00	1008.55	-1000.13	-300.35	40°25'08.234"N	104°17'04.455"W	0.00	
8417.00†	90.000	179.959	6173.00	1108.50	-1100.13	-300.28	40°25'07.246"N	104°17'04.454"W	0.00	



# Planned Wellpath Report

## STATE ANTELOPE T44-2-14XRLNB PWP (REV-A.0)

Page 5 of 8



REFERENCE WELLPATH IDENTIFICATION			
Operator	BONANZA CREEK OIL COMPANY	Slot	SLOT#04 STATE ANTELOPE T44-2-14XRLNB (330'FNL & 778'FEL, SEC.11)
Area	COLORADO	Well	STATE ANTELOPE T44-2-14XRLNB
Field	WELD COUNTY	Wellbore	STATE ANTELOPE T44-2-14XRLNB PWB
Facility	SEC.11-T5N-R62W		

WELLPATH DATA (179 stations) † = interpolated/extrapolated station										
MD [ft]	Inclination [°]	Azimuth [°]	TVD [ft]	Vert Sect [ft]	North [ft]	East [ft]	Latitude	Longitude	DLS [°/100ft]	Comments
8517.00†	90.000	179.959	6173.00	1208.46	-1200.13	-300.21	40°25'06.258"N	104°17'04.453"W	0.00	
8617.00†	90.000	179.959	6173.00	1308.41	-1300.13	-300.13	40°25'05.270"N	104°17'04.452"W	0.00	
8717.00†	90.000	179.959	6173.00	1408.37	-1400.13	-300.06	40°25'04.281"N	104°17'04.451"W	0.00	
8817.00†	90.000	179.959	6173.00	1508.32	-1500.13	-299.99	40°25'03.293"N	104°17'04.450"W	0.00	
8917.00†	90.000	179.959	6173.00	1608.27	-1600.13	-299.92	40°25'02.305"N	104°17'04.450"W	0.00	
9017.00†	90.000	179.959	6173.00	1708.23	-1700.13	-299.85	40°25'01.317"N	104°17'04.449"W	0.00	
9117.00†	90.000	179.959	6173.00	1808.18	-1800.13	-299.77	40°25'00.329"N	104°17'04.448"W	0.00	
9217.00†	90.000	179.959	6173.00	1908.14	-1900.13	-299.70	40°24'59.341"N	104°17'04.447"W	0.00	
9317.00†	90.000	179.959	6173.00	2008.09	-2000.13	-299.63	40°24'58.352"N	104°17'04.446"W	0.00	
9417.00†	90.000	179.959	6173.00	2108.05	-2100.13	-299.56	40°24'57.364"N	104°17'04.445"W	0.00	
9517.00†	90.000	179.959	6173.00	2208.00	-2200.13	-299.49	40°24'56.376"N	104°17'04.444"W	0.00	
9617.00†	90.000	179.959	6173.00	2307.96	-2300.13	-299.42	40°24'55.388"N	104°17'04.443"W	0.00	
9717.00†	90.000	179.959	6173.00	2407.91	-2400.13	-299.34	40°24'54.400"N	104°17'04.442"W	0.00	
9817.00†	90.000	179.959	6173.00	2507.86	-2500.13	-299.27	40°24'53.412"N	104°17'04.441"W	0.00	
9917.00†	90.000	179.959	6173.00	2607.82	-2600.13	-299.20	40°24'52.423"N	104°17'04.440"W	0.00	
10017.00†	90.000	179.959	6173.00	2707.77	-2700.13	-299.13	40°24'51.435"N	104°17'04.439"W	0.00	
10117.00†	90.000	179.959	6173.00	2807.73	-2800.13	-299.06	40°24'50.447"N	104°17'04.438"W	0.00	
10217.00†	90.000	179.959	6173.00	2907.68	-2900.13	-298.98	40°24'49.459"N	104°17'04.437"W	0.00	
10317.00†	90.000	179.959	6173.00	3007.64	-3000.13	-298.91	40°24'48.471"N	104°17'04.436"W	0.00	
10417.00†	90.000	179.959	6173.00	3107.59	-3100.13	-298.84	40°24'47.483"N	104°17'04.435"W	0.00	
10517.00†	90.000	179.959	6173.00	3207.55	-3200.13	-298.77	40°24'46.495"N	104°17'04.434"W	0.00	
10617.00†	90.000	179.959	6173.00	3307.50	-3300.13	-298.70	40°24'45.506"N	104°17'04.433"W	0.00	
10717.00†	90.000	179.959	6173.00	3407.45	-3400.13	-298.62	40°24'44.518"N	104°17'04.433"W	0.00	
10817.00†	90.000	179.959	6173.00	3507.41	-3500.13	-298.55	40°24'43.530"N	104°17'04.432"W	0.00	
10917.00†	90.000	179.959	6173.00	3607.36	-3600.13	-298.48	40°24'42.542"N	104°17'04.431"W	0.00	
11017.00†	90.000	179.959	6173.00	3707.32	-3700.13	-298.41	40°24'41.554"N	104°17'04.430"W	0.00	
11117.00†	90.000	179.959	6173.00	3807.27	-3800.13	-298.34	40°24'40.566"N	104°17'04.429"W	0.00	
11217.00†	90.000	179.959	6173.00	3907.23	-3900.13	-298.27	40°24'39.577"N	104°17'04.428"W	0.00	
11317.00†	90.000	179.959	6173.00	4007.18	-4000.13	-298.19	40°24'38.589"N	104°17'04.427"W	0.00	
11417.00†	90.000	179.959	6173.00	4107.14	-4100.13	-298.12	40°24'37.601"N	104°17'04.426"W	0.00	





# Planned Wellpath Report

## STATE ANTELOPE T44-2-14XRLNB PWP (REV-A.0)

Page 6 of 8



REFERENCE WELLPATH IDENTIFICATION			
Operator	BONANZA CREEK OIL COMPANY	Slot	SLOT#04 STATE ANTELOPE T44-2-14XRLNB (330'FNL & 778'FEL, SEC.11)
Area	COLORADO	Well	STATE ANTELOPE T44-2-14XRLNB
Field	WELD COUNTY	Wellbore	STATE ANTELOPE T44-2-14XRLNB PWB
Facility	SEC.11-T5N-R62W		

WELLPATH DATA (179 stations) † = interpolated/extrapolated station										
MD [ft]	Inclination [°]	Azimuth [°]	TVD [ft]	Vert Sect [ft]	North [ft]	East [ft]	Latitude	Longitude	DLS [°/100ft]	Comments
11517.00†	90.000	179.959	6173.00	4207.09	-4200.13	-298.05	40°24'36.613"N	104°17'04.425"W	0.00	
11617.00†	90.000	179.959	6173.00	4307.04	-4300.13	-297.98	40°24'35.625"N	104°17'04.424"W	0.00	
11717.00†	90.000	179.959	6173.00	4407.00	-4400.13	-297.91	40°24'34.637"N	104°17'04.423"W	0.00	
11817.00†	90.000	179.959	6173.00	4506.95	-4500.13	-297.83	40°24'33.648"N	104°17'04.422"W	0.00	
11917.00†	90.000	179.959	6173.00	4606.91	-4600.13	-297.76	40°24'32.660"N	104°17'04.421"W	0.00	
12017.00†	90.000	179.959	6173.00	4706.86	-4700.13	-297.69	40°24'31.672"N	104°17'04.420"W	0.00	
12117.00†	90.000	179.959	6173.00	4806.82	-4800.13	-297.62	40°24'30.684"N	104°17'04.419"W	0.00	
12217.00†	90.000	179.959	6173.00	4906.77	-4900.13	-297.55	40°24'29.696"N	104°17'04.418"W	0.00	
12317.00†	90.000	179.959	6173.00	5006.73	-5000.13	-297.47	40°24'28.708"N	104°17'04.417"W	0.00	
12417.00†	90.000	179.959	6173.00	5106.68	-5100.13	-297.40	40°24'27.719"N	104°17'04.416"W	0.00	
12517.00†	90.000	179.959	6173.00	5206.63	-5200.13	-297.33	40°24'26.731"N	104°17'04.416"W	0.00	
12617.00†	90.000	179.959	6173.00	5306.59	-5300.13	-297.26	40°24'25.743"N	104°17'04.415"W	0.00	
12717.00†	90.000	179.959	6173.00	5406.54	-5400.13	-297.19	40°24'24.755"N	104°17'04.414"W	0.00	
12817.00†	90.000	179.959	6173.00	5506.50	-5500.13	-297.12	40°24'23.767"N	104°17'04.413"W	0.00	
12917.00†	90.000	179.959	6173.00	5606.45	-5600.13	-297.04	40°24'22.779"N	104°17'04.412"W	0.00	
13017.00†	90.000	179.959	6173.00	5706.41	-5700.13	-296.97	40°24'21.790"N	104°17'04.411"W	0.00	
13117.00†	90.000	179.959	6173.00	5806.36	-5800.13	-296.90	40°24'20.802"N	104°17'04.410"W	0.00	
13217.00†	90.000	179.959	6173.00	5906.32	-5900.13	-296.83	40°24'19.814"N	104°17'04.409"W	0.00	
13317.00†	90.000	179.959	6173.00	6006.27	-6000.13	-296.76	40°24'18.826"N	104°17'04.408"W	0.00	
13417.00†	90.000	179.959	6173.00	6106.22	-6100.13	-296.68	40°24'17.838"N	104°17'04.407"W	0.00	
13517.00†	90.000	179.959	6173.00	6206.18	-6200.13	-296.61	40°24'16.850"N	104°17'04.406"W	0.00	
13617.00†	90.000	179.959	6173.00	6306.13	-6300.13	-296.54	40°24'15.861"N	104°17'04.405"W	0.00	
13717.00†	90.000	179.959	6173.00	6406.09	-6400.13	-296.47	40°24'14.873"N	104°17'04.404"W	0.00	
13817.00†	90.000	179.959	6173.00	6506.04	-6500.13	-296.40	40°24'13.885"N	104°17'04.403"W	0.00	
13917.00†	90.000	179.959	6173.00	6606.00	-6600.13	-296.33	40°24'12.897"N	104°17'04.402"W	0.00	
14017.00†	90.000	179.959	6173.00	6705.95	-6700.13	-296.25	40°24'11.909"N	104°17'04.401"W	0.00	
14117.00†	90.000	179.959	6173.00	6805.91	-6800.13	-296.18	40°24'10.921"N	104°17'04.400"W	0.00	
14217.00†	90.000	179.959	6173.00	6905.86	-6900.13	-296.11	40°24'09.932"N	104°17'04.399"W	0.00	
14317.00†	90.000	179.959	6173.00	7005.81	-7000.13	-296.04	40°24'08.944"N	104°17'04.399"W	0.00	
14417.00†	90.000	179.959	6173.00	7105.77	-7100.13	-295.97	40°24'07.956"N	104°17'04.398"W	0.00	



# Planned Wellpath Report

STATE ANTELOPE T44-2-14XRLNB PWP (REV-A.0)

Page 7 of 8



REFERENCE WELLPATH IDENTIFICATION			
Operator	BONANZA CREEK OIL COMPANY	Slot	SLOT#04 STATE ANTELOPE T44-2-14XRLNB (330'FNL & 778'FEL, SEC.11)
Area	COLORADO	Well	STATE ANTELOPE T44-2-14XRLNB
Field	WELD COUNTY	Wellbore	STATE ANTELOPE T44-2-14XRLNB PWB
Facility	SEC.11-T5N-R62W		

WELLPATH DATA (179 stations) † = interpolated/extrapolated station										
MD [ft]	Inclination [°]	Azimuth [°]	TVD [ft]	Vert Sect [ft]	North [ft]	East [ft]	Latitude	Longitude	DLS [°/100ft]	Comments
14517.00†	90.000	179.959	6173.00	7205.72	-7200.13	-295.89	40°24'06.968"N	104°17'04.397"W	0.00	
14617.00†	90.000	179.959	6173.00	7305.68	-7300.13	-295.82	40°24'05.980"N	104°17'04.396"W	0.00	
14717.00†	90.000	179.959	6173.00	7405.63	-7400.13	-295.75	40°24'04.992"N	104°17'04.395"W	0.00	
14817.00†	90.000	179.959	6173.00	7505.59	-7500.13	-295.68	40°24'04.004"N	104°17'04.394"W	0.00	
14917.00†	90.000	179.959	6173.00	7605.54	-7600.13	-295.61	40°24'03.015"N	104°17'04.393"W	0.00	
15017.00†	90.000	179.959	6173.00	7705.50	-7700.13	-295.53	40°24'02.027"N	104°17'04.392"W	0.00	
15117.00†	90.000	179.959	6173.00	7805.45	-7800.13	-295.46	40°24'01.039"N	104°17'04.391"W	0.00	
15217.00†	90.000	179.959	6173.00	7905.40	-7900.13	-295.39	40°24'00.051"N	104°17'04.390"W	0.00	
15317.00†	90.000	179.959	6173.00	8005.36	-8000.13	-295.32	40°23'59.063"N	104°17'04.389"W	0.00	
15417.00†	90.000	179.959	6173.00	8105.31	-8100.13	-295.25	40°23'58.075"N	104°17'04.388"W	0.00	
15517.00†	90.000	179.959	6173.00	8205.27	-8200.13	-295.18	40°23'57.086"N	104°17'04.387"W	0.00	
15617.00†	90.000	179.959	6173.00	8305.22	-8300.13	-295.10	40°23'56.098"N	104°17'04.386"W	0.00	
15717.00†	90.000	179.959	6173.00	8405.18	-8400.13	-295.03	40°23'55.110"N	104°17'04.385"W	0.00	
15817.00†	90.000	179.959	6173.00	8505.13	-8500.13	-294.96	40°23'54.122"N	104°17'04.384"W	0.00	
15917.00†	90.000	179.959	6173.00	8605.09	-8600.13	-294.89	40°23'53.134"N	104°17'04.383"W	0.00	
16017.00†	90.000	179.959	6173.00	8705.04	-8700.13	-294.82	40°23'52.146"N	104°17'04.382"W	0.00	
16117.00†	90.000	179.959	6173.00	8804.99	-8800.13	-294.74	40°23'51.157"N	104°17'04.382"W	0.00	
16217.00†	90.000	179.959	6173.00	8904.95	-8900.13	-294.67	40°23'50.169"N	104°17'04.381"W	0.00	
16317.00†	90.000	179.959	6173.00	9004.90	-9000.13	-294.60	40°23'49.181"N	104°17'04.380"W	0.00	
16417.00†	90.000	179.959	6173.00	9104.86	-9100.13	-294.53	40°23'48.193"N	104°17'04.379"W	0.00	
16517.00†	90.000	179.959	6173.00	9204.81	-9200.13	-294.46	40°23'47.205"N	104°17'04.378"W	0.00	
16617.00†	90.000	179.959	6173.00	9304.77	-9300.13	-294.38	40°23'46.217"N	104°17'04.377"W	0.00	
16717.00†	90.000	179.959	6173.00	9404.72	-9400.13	-294.31	40°23'45.228"N	104°17'04.376"W	0.00	
16817.00†	90.000	179.959	6173.00	9504.68	-9500.13	-294.24	40°23'44.240"N	104°17'04.375"W	0.00	
16917.00†	90.000	179.959	6173.00	9604.63	-9600.13	-294.17	40°23'43.252"N	104°17'04.374"W	0.00	
17017.00†	90.000	179.959	6173.00	9704.58	-9700.13	-294.10	40°23'42.264"N	104°17'04.373"W	0.00	
17117.00†	90.000	179.959	6173.00	9804.54	-9800.13	-294.03	40°23'41.276"N	104°17'04.372"W	0.00	
17217.00†	90.000	179.959	6173.00	9904.49	-9900.13	-293.95	40°23'40.288"N	104°17'04.371"W	0.00	
17288.18	90.000	179.959	6173.00 <sup>2</sup>	9975.64	-9971.31	-293.90	40°23'39.584"N	104°17'04.370"W	0.00	End of Tangent (XS)



HOLE & CASING SECTIONS									
- Ref Wellbore: STATE ANTELOPE T44-2-14XRLNB PWB      Ref Wellpath: STATE ANTELOPE T44-2-14XRLNB PWP (REV-A.0)									
String/Diameter	Start MD [ft]	End MD [ft]	Interval [ft]	Start TVD [ft]	End TVD [ft]	Start N/S [ft]	Start E/W [ft]	End N/S [ft]	End E/W [ft]
9.625in Casing Surface	17.00	1550.00	1533.00	17.00	1541.46	0.00	0.00	95.43	-20.56
8.5in Open Hole	1550.00	17288.18	15738.18	1541.46	N/A	95.43	-20.56	N/A	N/A

TARGETS									
Name	MD [ft]	TVD [ft]	North [ft]	East [ft]	Grid East [US ft]	Grid North [US ft]	Latitude	Longitude	Shape
*SEC.02-T05N-R62W		29.00	4090.10	-4272.30	3334363.11	1402819.53	40°25'58.530"N	104°17'55.820"W	polygon
*SEC.11-T05N-R62W		29.00	-10080.60	-3442.60	3335387.09	1388662.13	40°23'38.502"N	104°17'45.065"W	polygon
*SEC.14-T05N-R62W		29.00	-10080.60	-3442.60	3335387.09	1388662.13	40°23'38.502"N	104°17'45.065"W	polygon
2) STATE ANTELOPE T44-2-14XRLNB BHL (470'FSL&1047'FEL,SEC.14)	17288.18	6173.00	-9971.31	-293.90	3338533.87	1388814.60	40°23'39.584"N	104°17'04.370"W	point
1) STATE ANTELOPE T44-2-14XRLNB LP (330'FSL&1075'FEL,SEC.02)	6671.27	6173.00	645.60	-301.53	3338380.60	1399429.96	40°25'24.496"N	104°17'04.471"W	point
*SEC.11/14-T05N-R62W HARDLINES (460'SETBACK)		6213.00	-10080.60	-3442.60	3335387.09	1388662.13	40°23'38.502"N	104°17'45.065"W	polygon

SURVEY PROGRAM - Ref Wellbore: STATE ANTELOPE T44-2-14XRLNB PWB      Ref Wellpath: STATE ANTELOPE T44-2-14XRLNB PWP (REV-A.0)									
Start MD [ft]	End MD [ft]	Positional Uncertainty Model			Log Name/Comment		Wellbore		
17.00	1550.00	BHI NaviTrak (Standard)					STATE ANTELOPE T44-2-14XRLNB PWB		
1550.00	17288.18	BHI AutoTrak Curve (Standard)					STATE ANTELOPE T44-2-14XRLNB PWB		



# Planned Wellpath Report

STATE ANTELOPE T44-2-14XRLNB PWP (REV-A.0)

Page 8 of 8



REFERENCE WELLPATH IDENTIFICATION			
Operator	BONANZA CREEK OIL COMPANY	Slot	SLOT#04 STATE ANTELOPE T44-2-14XRLNB (330'FNL & 778'FEL, SEC.11)
Area	COLORADO	Well	STATE ANTELOPE T44-2-14XRLNB
Field	WELD COUNTY	Wellbore	STATE ANTELOPE T44-2-14XRLNB PWB
Facility	SEC.11-T5N-R62W		

DESIGN COMMENTS				
MD [ft]	Inclination [°]	Azimuth [°]	TVD [ft]	Comment
17.00	0.000	347.844	17.00	Tie On
800.00	0.000	347.844	800.00	End of Tangent
1605.36	16.107	347.844	1594.79	End of Build (XS)
5613.88	16.107	347.844	5445.96	End of Tangent (XS)
6671.27	90.000	179.959	6173.00	End of 3D Arc (XS)
17288.18	90.000	179.959	6173.00	End of Tangent (XS)